

# Alumi-Loc Installation Kit Instructions

## Parts List:

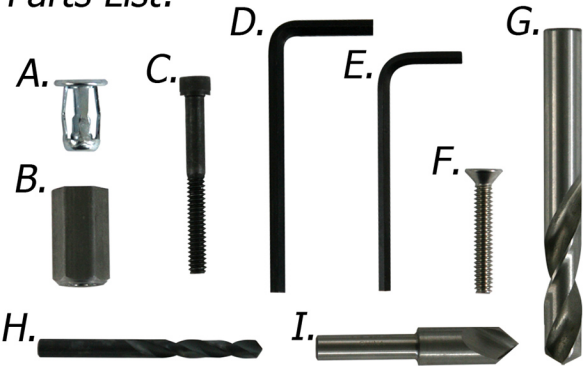

- A. (8) Jack Nuts 10-24
- B. (1) Jack Nut Hex Tool
- C. (1) Hex Cap Screw 10-24 x 1-1/2"
- D. (1) 5/32" Hex Wrench
- E. (1) 1/8" Hex Wrench
- F. (8) Stainless Flathead Screws 10-24 x 1-1/2"
- G. (1) 3/8" Drill Bit
- H. (1) 3/16" Drill Bit
- I. (1) 3/8"-82 Countersink Tool

1/2" wrench and power drill required for installation (not included)

**Step 1:** Center Alumi-Loc on tailgate making sure hook is tight against tailgate. Mark 8 holes spread out evenly across Alumi-Loc. (Using all 8 screws is recommended.)

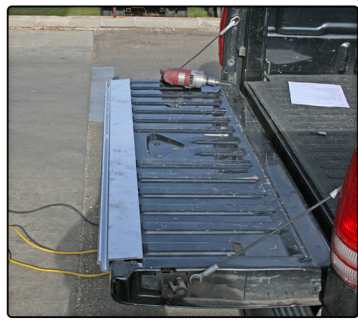

**Step 2:** Drill pilot holes through tailgate bracket into tailgate using the (H.) 3/16" Drill Bit. (Note: it helps to insert a small screw or nail into the end pilot holes to keep bracket from sliding when drilling the pilot holes)



**Step 3:** Remove tailgate bracket and drill 3/8" holes through the tailgate using (G.) 3/8" Drill Bit. (Do not drill all the way through tailgate!)



**Step 4:** Install all (A.) Jack Nuts into tailgate using the (B.) Jack Nut Hex Tool (tapered side of tool toward jack nut). Use 1/2" wrench (not included) and (D.) 5/32" Hex Wrench & (C.) Hex Cap Screw to crimp the jack nuts into tailgate. Be sure to keep down pressure on the jack nut hex tool to insure the jack nut is flush with tailgate when crimping.

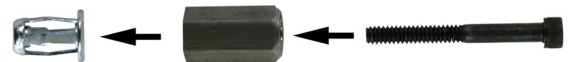

**Step 5:** Countersink all holes in the tailgate bracket using (I.) 3/8" countersink drill bit.

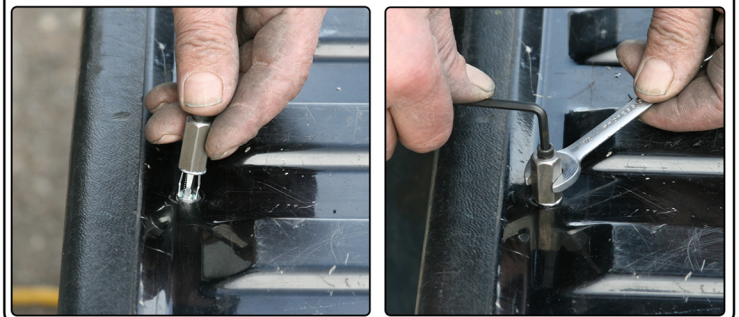
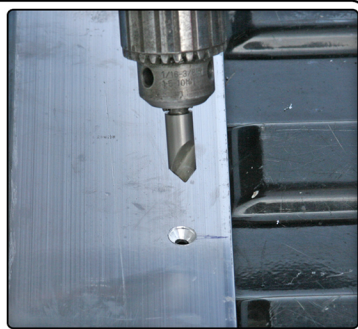

**Step 6:** 1. Install bracket onto tailgate using the supplied (F.) 1-1/2" long stainless screws. Start all 8 screws by hand then tighten using (E.) 1/8" hex wrench

