

Instructions for Use



Up and down adjustment



Revolve adjustment

Thank you for purchasing our products. Please read this manual before assembly. And please assemble in order. After the assembly, keep the instruction properly. Ensure that all the components are included (12 kinds in total).

Accessories List

(1) Backrest

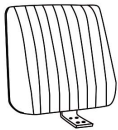

(2) Seat Cushion



(3) Base Plate

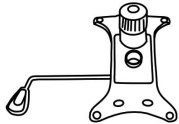

(4) Base Tube

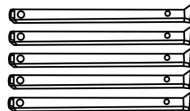

(5) Central Base Tube



(6) Decorative Cover



(7) Air Rod



(8) 5 Casters



(9) T-Handle Wrench

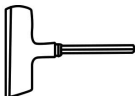

(10) 4 Screws (M6×20mm)



(11) 4 Screws (M6×35mm)



(12) 5 Screws (M6×14mm)



Notice

- This is a chair designed for only one person. Do not seat two or more persons on this chair.
- Do not stand on the chair.
- Do not sit in a reverse position or on the outer edge of the seat cushion.
- Check the screws every 6 months to ensure they are tight. Do not use the chair if the screws are loose.
- Please assemble the chair according to the provided instructions.

Assembly Instruction

Please assemble in a wide and flat place.

Step 1

Use 5 M6×14mm screws (12) to connect the split base tube (4) and the central base tube (5) with T-handle wrench (9).

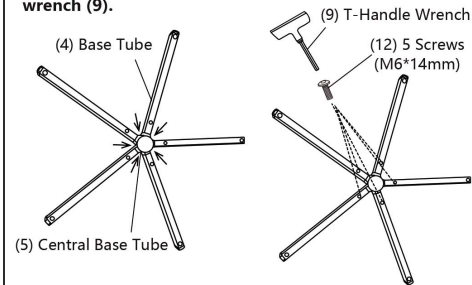

Step 2

Insert the 5 casters (8) into the base tube (4).

Attention: Direction of casters when pressing in

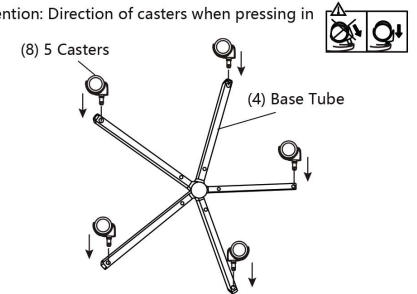

Step 3

Place the Air rod (7) and decorative cover (6) into the central base tube (5).

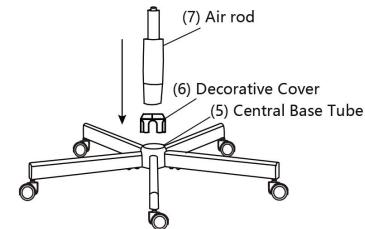

Step 4

Attach base plate (3) to the bottom of seat cushion (2). Tighten the screws M6×20mm (10) firmly with T-handle wrench (9).

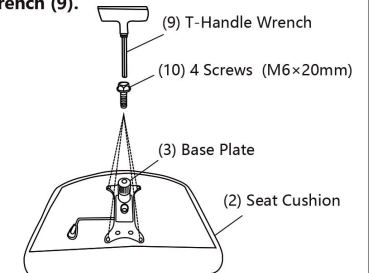

Step 5

Attach the bottom of backrest (1) to the back of seat cushion (2). Tighten the screws M6×35mm (11) firmly with T-handle wrench (9).

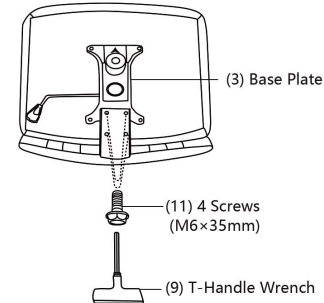

Step 6

To connect the seat and the base, insert the air rod (7) into the hole on the base plate (3). The installation is now complete.

