

ASSEMBLY INSTRUCTIONS

Bench

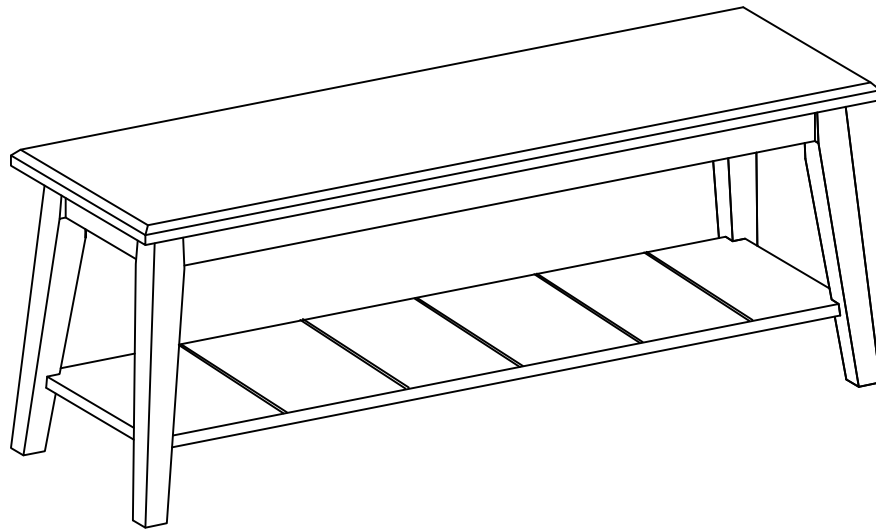

NOTE TO CUSTOMERS:

- For ease and speed of assembly we recommend that before you commence each step of the assembly that you identify all the parts required to complete that step.
- We recommend that where possible you allow sufficient space to assemble the item as close as possible to the place where it will be once assembled.
- For the protection of your furniture we recommend that the product is placed on protected surfaces during assembly to prevent any damage.
- During assembly do not over tighten, as this may damage the product.
- Please ensure you retain all the product packaging until the item completely assembled.
- Please periodically check all fittings and re-tighten as necessary.
- Please never allow any liquids to remain on your furniture as absorption can cause the wood to warp or finish to de-laminate.
- It is recommended that this item should be assembled by two adults.

Wooden Parts:

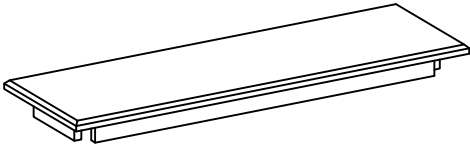

A1: Top Panel 1PC

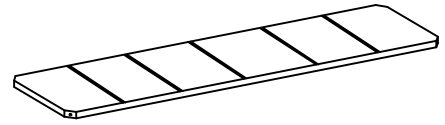

A2: Shelf 1PC

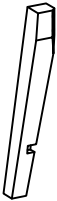

A3: Leg 4PCS

Hardware List:

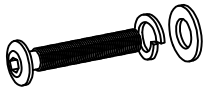

B1: Bolt with washer
8sets



B2: Screw
4pcs



B3: Allen Wrench
1pc

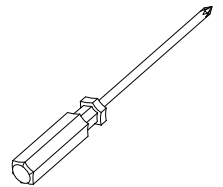

Phillips screwdriver
(not included)

**Step 1: Assemble three Legs A3 to Top Panel A1 using Bolts with washers B1.
Please do not tighten Bolts B1 at this step.**

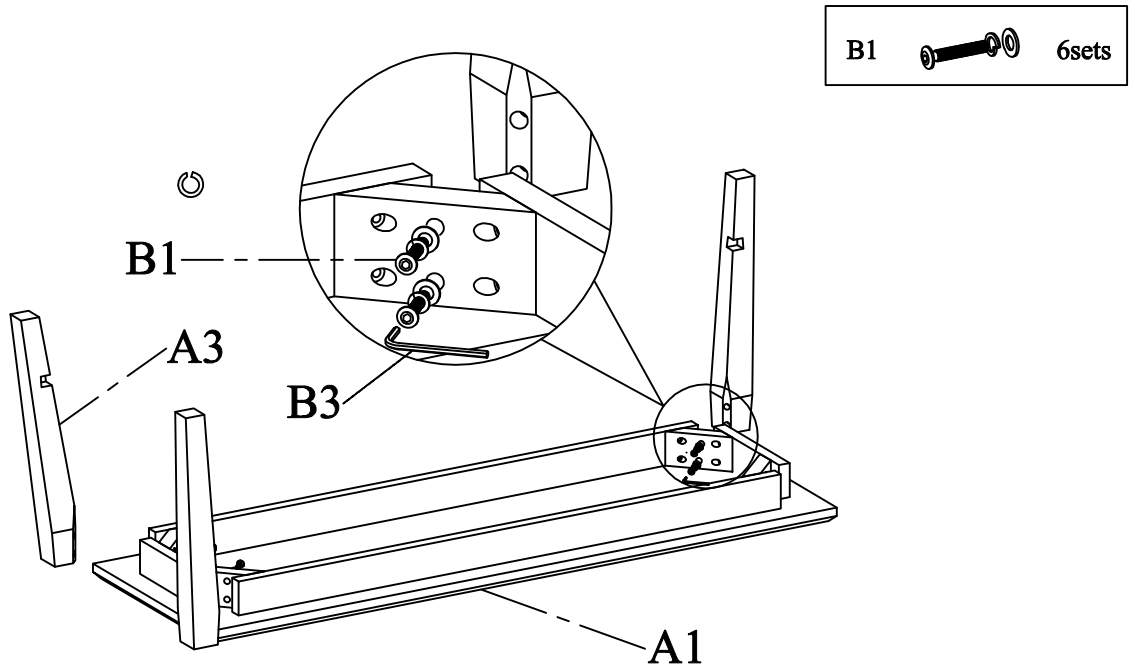

**Step 2: Insert Shelf A2 into the grooves on Legs A3, then assemble the last Leg A3 to Top Panel A1 using Bolts with Washers B1.
Please tighten Bolts B1 at this step.**

Note: It is recommended that this step should be assembled by two persons.

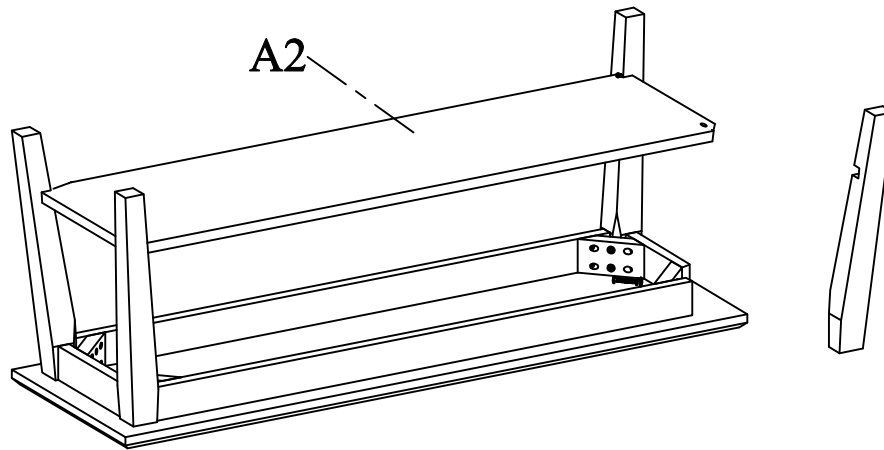
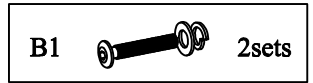

Step 3: Tighten Shelf A2 to Legs A3 using Screws B2.

