

Parts List - Liste des pièces - Lista de partes

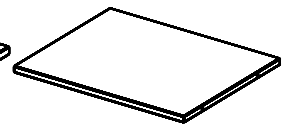
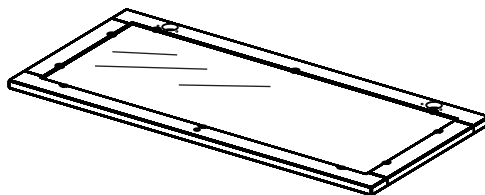
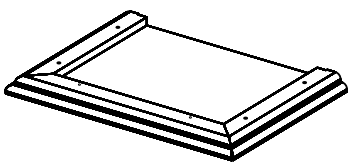

A	Top Panel Panneau supérieur Panel superior			
Quantity Quantité Cantidad	1	Missing Manquant Ausente		

B	Rail Rail Riel			
Quantity Quantité Cantidad	1	Missing Manquant Ausente		

C	Door Porte Puerta			
Quantity Quantité Cantidad	1	Missing Manquant Ausente		

D	Shelf Étagère Estante			
Quantity Quantité Cantidad	2	Missing Manquant Ausente		

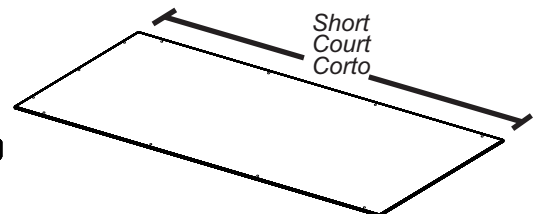
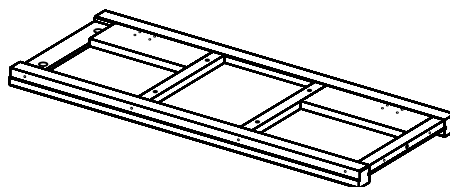
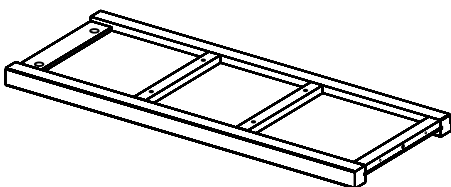

E	Left Panel (Upper) Panneau gauche (supérieur) Panel izquierdo (arriba)			
Quantity Quantité Cantidad	1	Missing Manquant Ausente		

F	Right Panel (Upper) Panneau droit (supérieur) Panel derecho (arriba)			
Quantity Quantité Cantidad	1	Missing Manquant Ausente		

G	Back Panel (Upper) Panneau arrière (supérieur) Panel trasero (arriba)			
Quantity Quantité Cantidad	1	Missing Manquant Ausente		

Parts List - Liste des pièces - Lista de partes

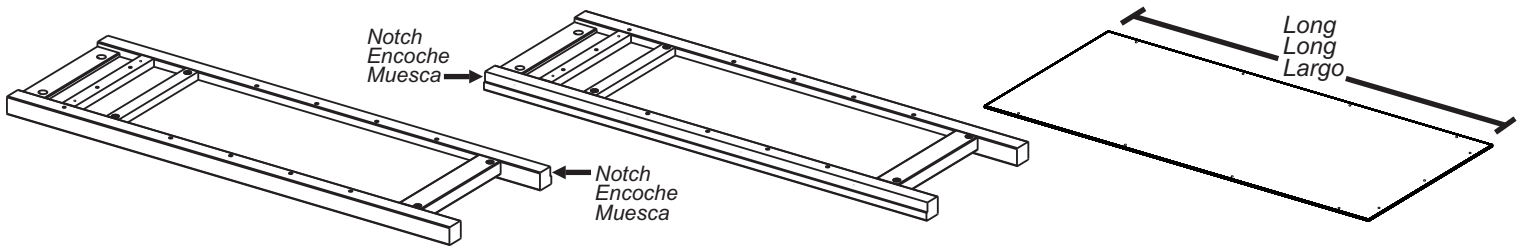

H	Left Panel (Lower) Panneau gauche (inférieur) Panel Izquierdo (abajo)
Quantity Quantité Cantidad	1 Missing Manquant Ausente

I	Right Panel (Lower) Panneau droit (inférieur) Panel Derecho (abajo)
Quantity Quantité Cantidad	1 Missing Manquant Ausente

J	Back Panel (Lower) Panneau arrière (inférieur) Panel trasero (abajo)
Quantity Quantité Cantidad	1 Missing Manquant Ausente

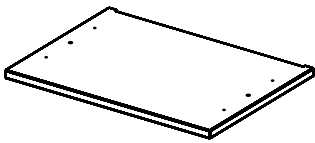

K	Upper Base Base supérieur Base de arriba
Quantity Quantité Cantidad	1 Missing Manquant Ausente

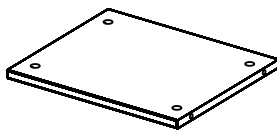

L	Lower Panel Panneau inférieur Panel de abajo
Quantity Quantité Cantidad	2 Missing Manquant Ausente

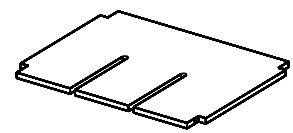

M	Dividing Panel (horizontal) Séparateur de compartiments (horizontal) Panel de separadora (horizontal)
Quantity Quantité Cantidad	4 Missing Manquant Ausente

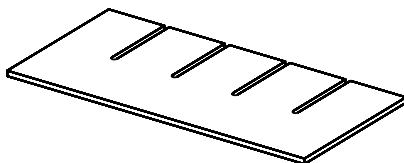

N	Dividing Panel (Vertical) Panneau de séparation (vertical) Panel de separadora (vertical)
Quantity Quantité Cantidad	2 Missing Manquant Ausente

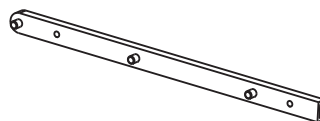

O	Drawer Rail Glissière de tiroir Brasadera
Quantity Quantité Cantidad	2 Missing Manquant Ausente

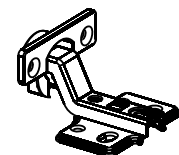

P	Door Hinge Charnière de porte Bisagra del puerta
Quantity Quantité Cantidad	2 Missing Manquant Ausente

Parts List - Liste des pièces - Lista de partes

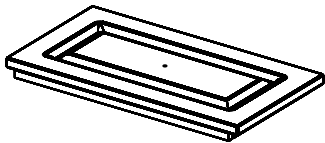

Q	Front Panel (Drawer) Panneau Avant (tiroir) Panel Delantero (cajón)
Quantity Quantité Cantidad	1 Missing Manquant Ausente

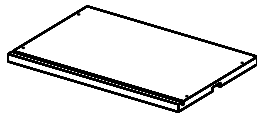

R	Side Panel (Drawer) Panneau Latéral (tiroir) Panel (cajón)
Quantity Quantité Cantidad	2 Missing Manquant Ausente



S	Back Panel (Drawer) Panneau Arrière (tiroir) Panel Posterior (cajón)
Quantity Quantité Cantidad	1 Missing Manquant Ausente

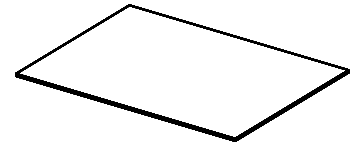

T	Bottom Board (Drawer) Conseil Inférieur (tiroir) Tablero Inferior (cajón)
Quantity Quantité Cantidad	1 Missing Manquant Ausente



U	Metal Knob Bouton en métal Tirador del Metal
Quantity Quantité Cantidad	2 Missing Manquant Ausente

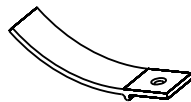

V	Drawer Stopper Tiroir bouchon Clavija para el Cajon
Quantity Quantité Cantidad	1 Missing Manquant Ausente



W1	Cam Lock* Serrure batteuse* Cam-lock*
Quantity Quantité Cantidad	16 Missing Manquant Ausente

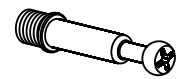

W2	Cam Lock Screw* Vis à blocage rapide* Tornillo para cam-lock*
Quantity Quantité Cantidad	16 Missing Manquant Ausente



X	Wood Dowel Goujon en bois Clavija de madera
Quantity Quantité Cantidad	26 Missing Manquant Ausente



Y1	Phillips Screw* (Long) Vis phillips* (long) Tornillo phillips* (long)
Quantity Quantité Cantidad	14 Missing Manquant Ausente



Y2	Flat-Head Screw* Vis à tête plate* Tornillo de cabeza plana*
Quantity Quantité Cantidad	17 Missing Manquant Ausente



Y3	Round Head Screw* Vis à tête ronde* Tornillo de cabeza redonda*
Quantity Quantité Cantidad	25 Missing Manquant Ausente



Y4	Bolt* Cheville* Tornillo torneado*
Quantity Quantité Cantidad	2 Missing Manquant Ausente

Care instructions: To clean, wipe with wet cloth and dry thoroughly. Use mild soap if necessary. Avoid use of commercial waxes or polishes or abrasive cleaning materials.

Instructions d'entretien: Pour nettoyer, essuyez avec un linge humide et séchez à fond. Utilisez un savon doux au besoin. Évitez d'utiliser des cires ou produits à polir de type commercial ou des matériaux de nettoyage abrasifs.

Instrucciones para el cuidado: Para limpiar, frótelo con algo húmedo y séquelo bien. Use un jabón suave si es necesario. Evite el uso de ceras o pulidores comerciales o materiales abrasivos.

* Screw Driver is required and not included in the package. * Un tournevis est nécessaire mais n'est pas inclus avec cet ensemble. * Se requiere desarmador de cruz y no viene incluido.

Assembly Instructions - Instructions d'assemblage - Instrucciones de ensamblaje

1

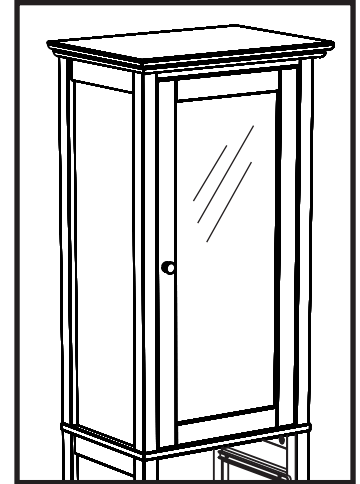
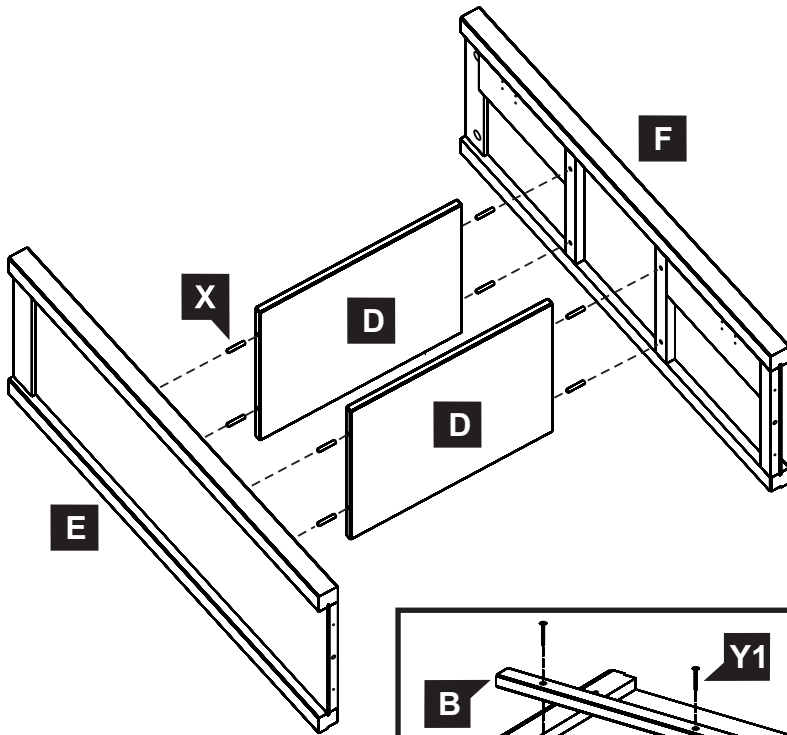

2

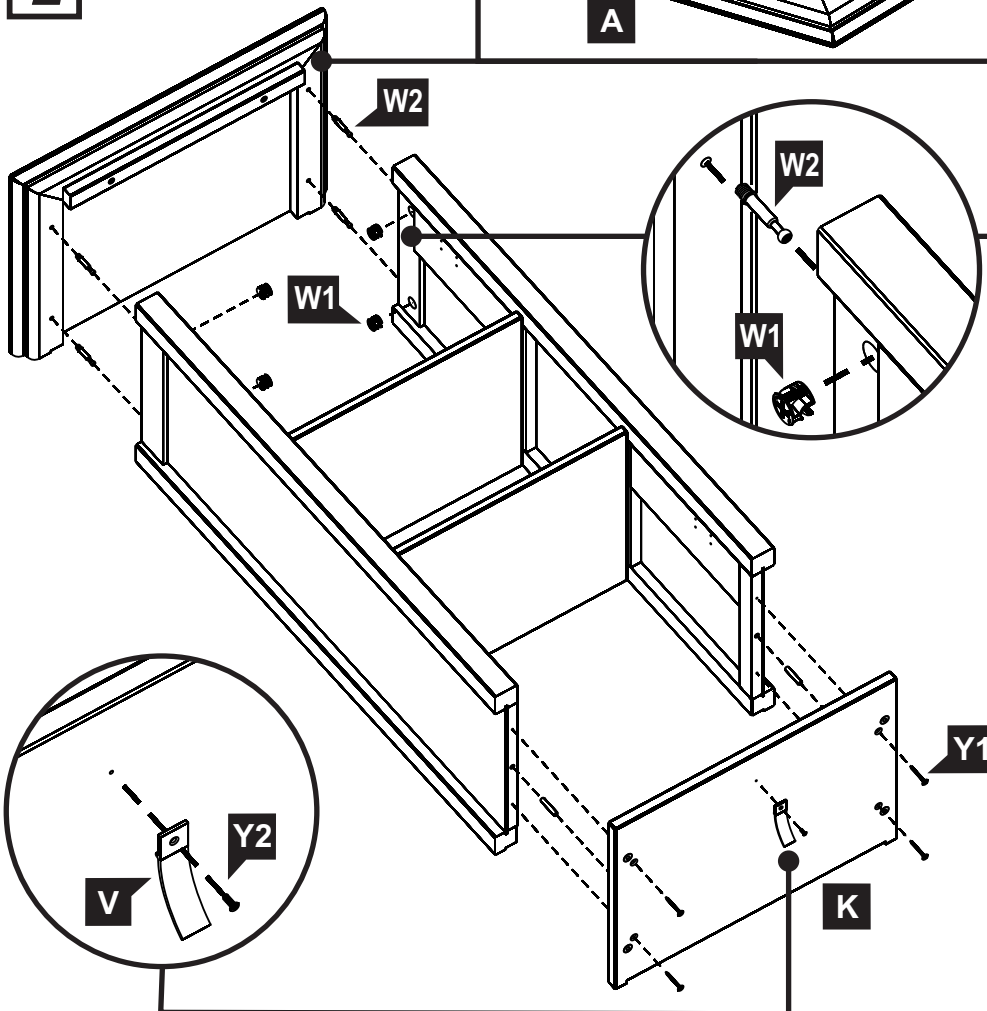
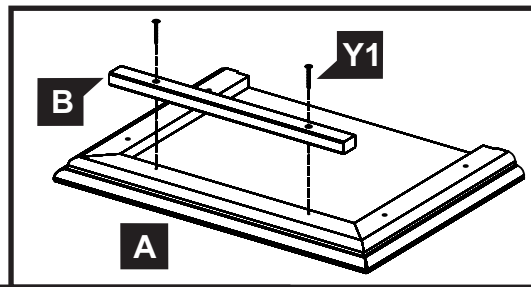

REF. 1

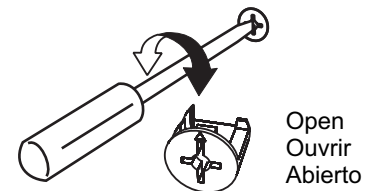

Open
Ouvrir
Abierto

Note:
Insert cam-lock in open position.
Rotate to open position with screw driver if necessary.

Remarque:
Insérez la serrure batteuse en position ouverte.
Tourner en position ouverte avec le tournevis si nécessaire.

Nota:
Inserta el "cam-lock" en posición abierta.
Volteé en posición abierta con desarmador si es necesario.

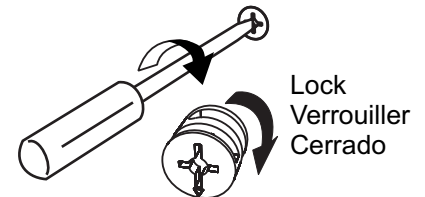

Lock
Verrouiller
Cerrado

Turn to lock with screw-driver.
Warning: Do Not over tighten cam-lock.

Tourner pour verrouiller avec tournevis.
Avertissement : Ne pas trop serrer serrure batteuse.

Volteé para cerrar con desarmador.
Advertencia: No sobre-apriete cam-lock.

Assembly Instructions - Instructions d'assemblage - Instrucciones de ensamblaje

3

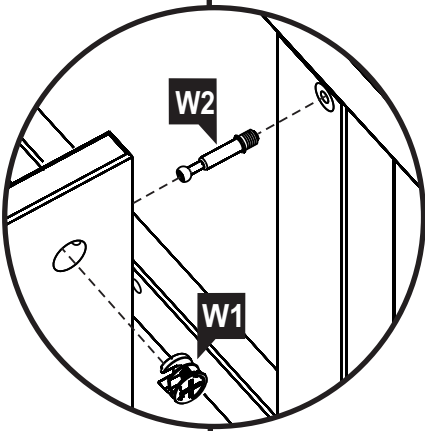
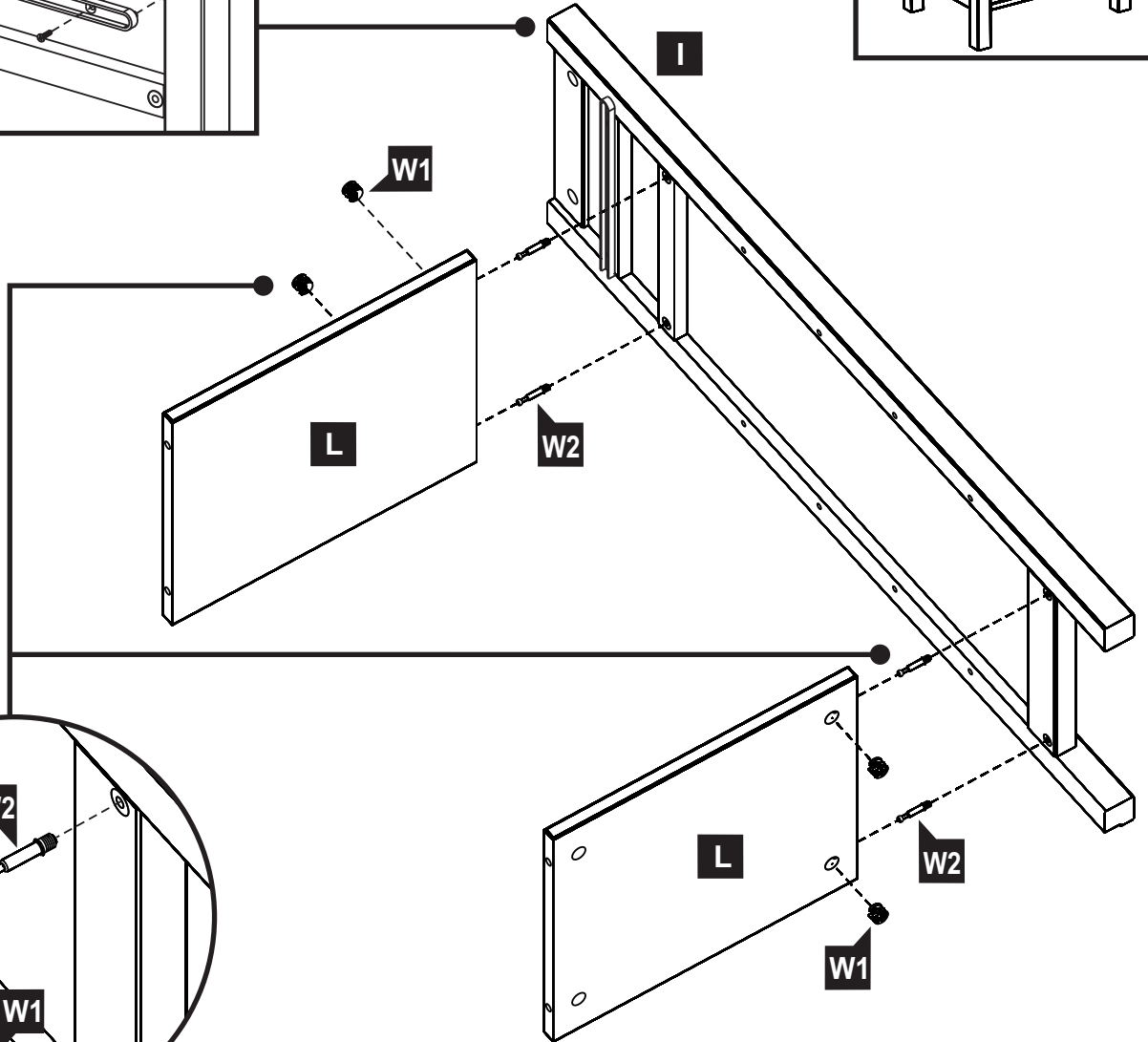
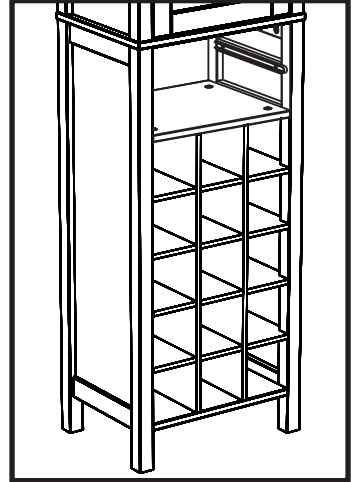
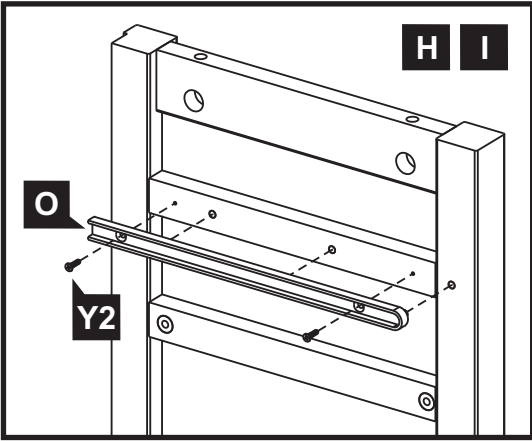

REF. 1

W1  W2 

Assembly Instructions - Instructions d'assemblage - Instrucciones de ensamblaje

4

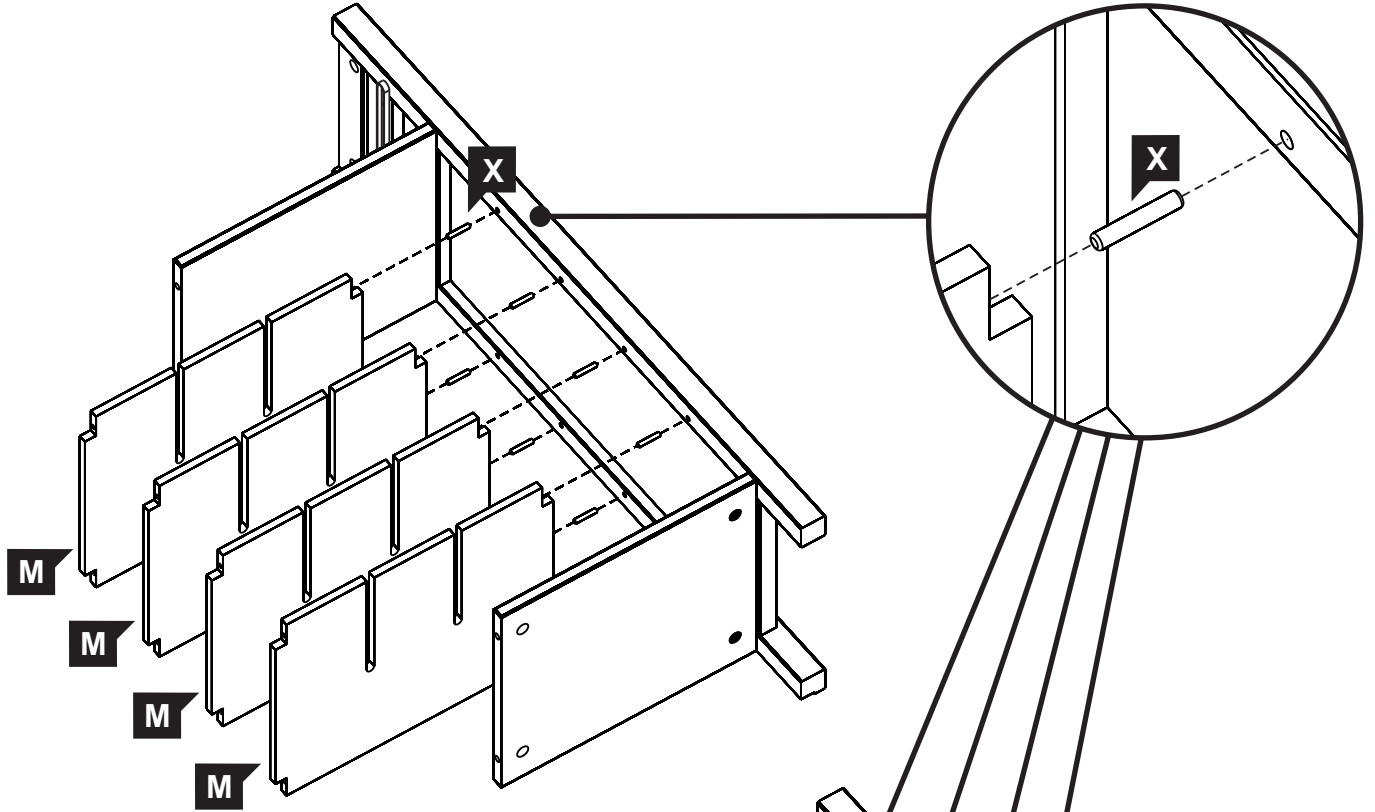

5

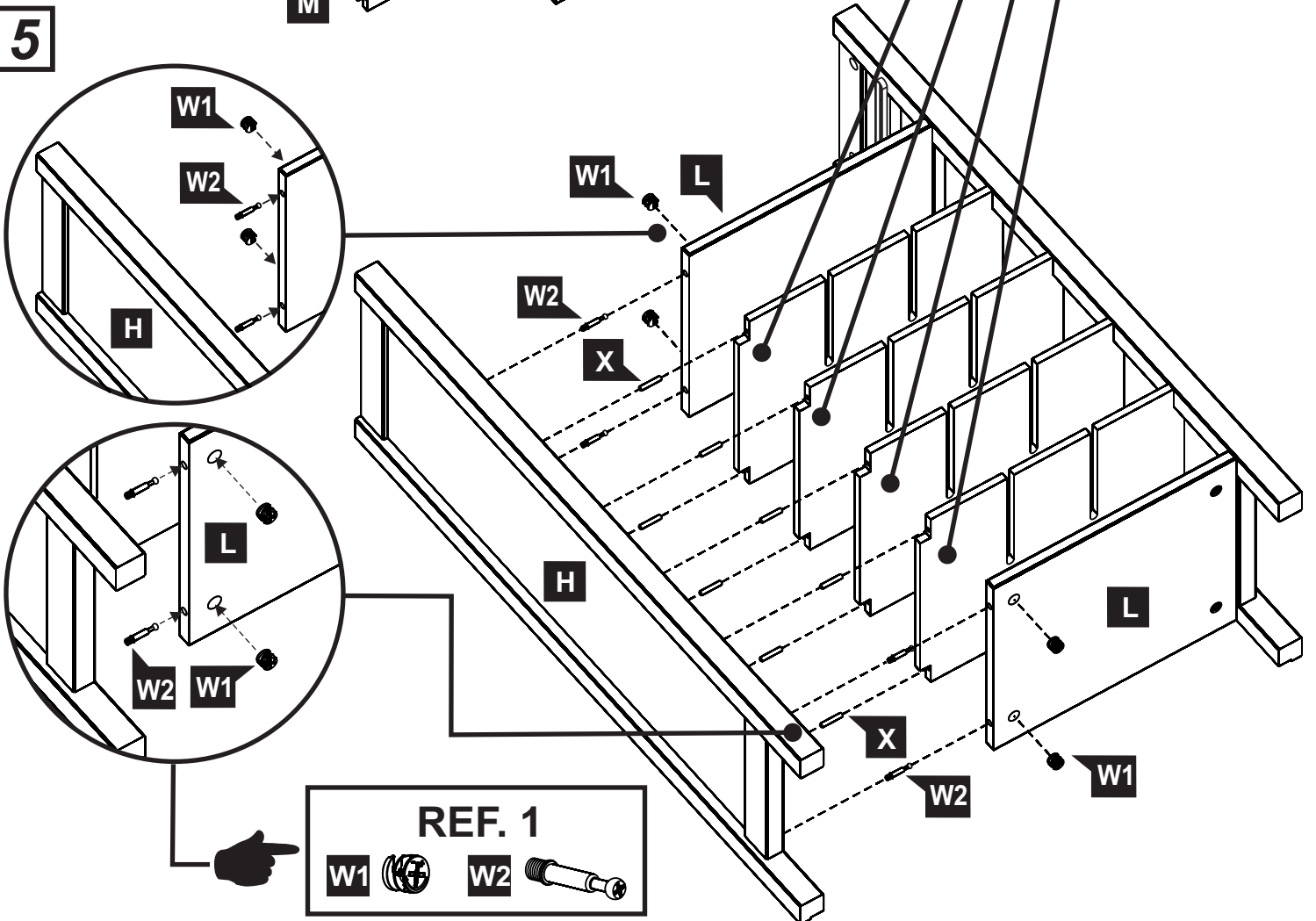

6

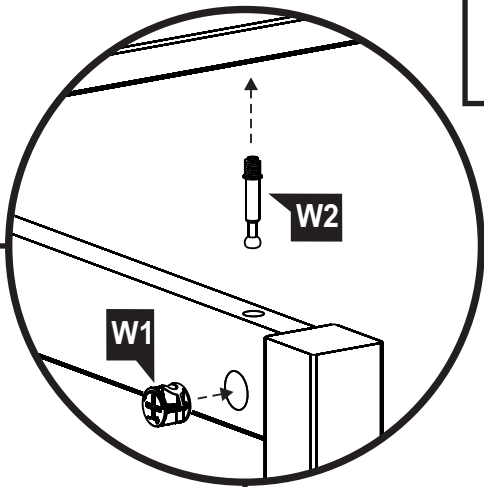
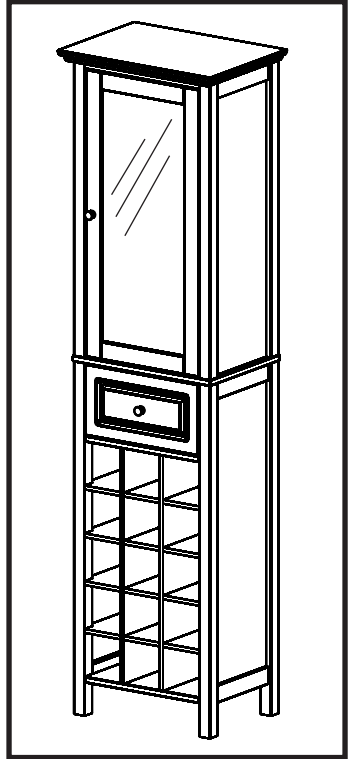
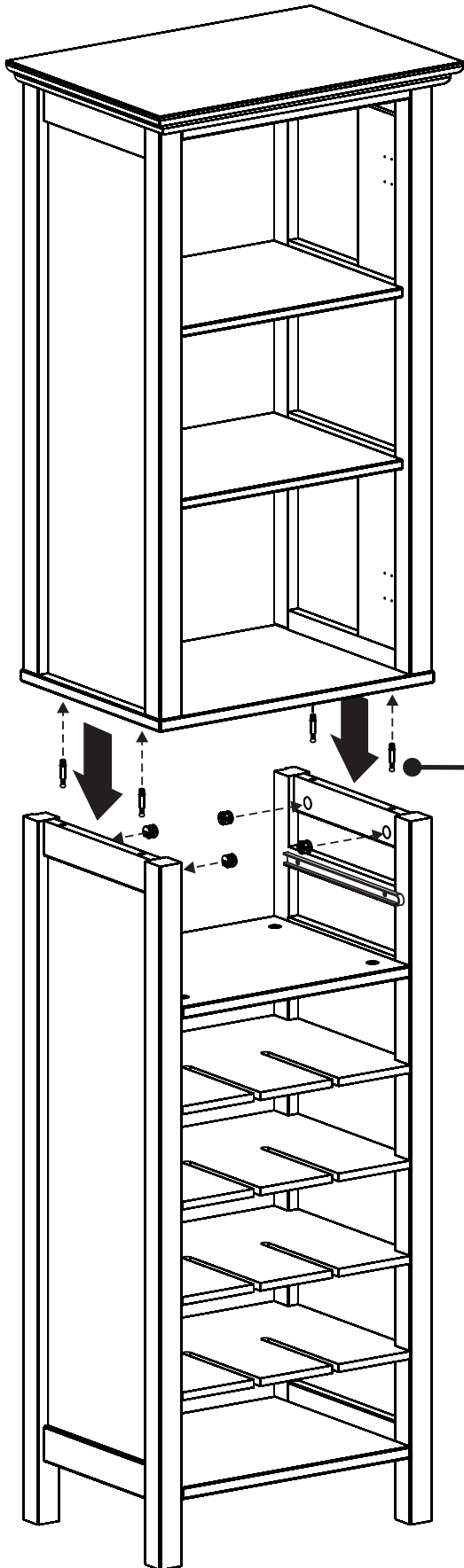

REF. 1

W1	
W2	



Assembly Instructions - Instructions d'assemblage - Instrucciones de ensamblaje

7

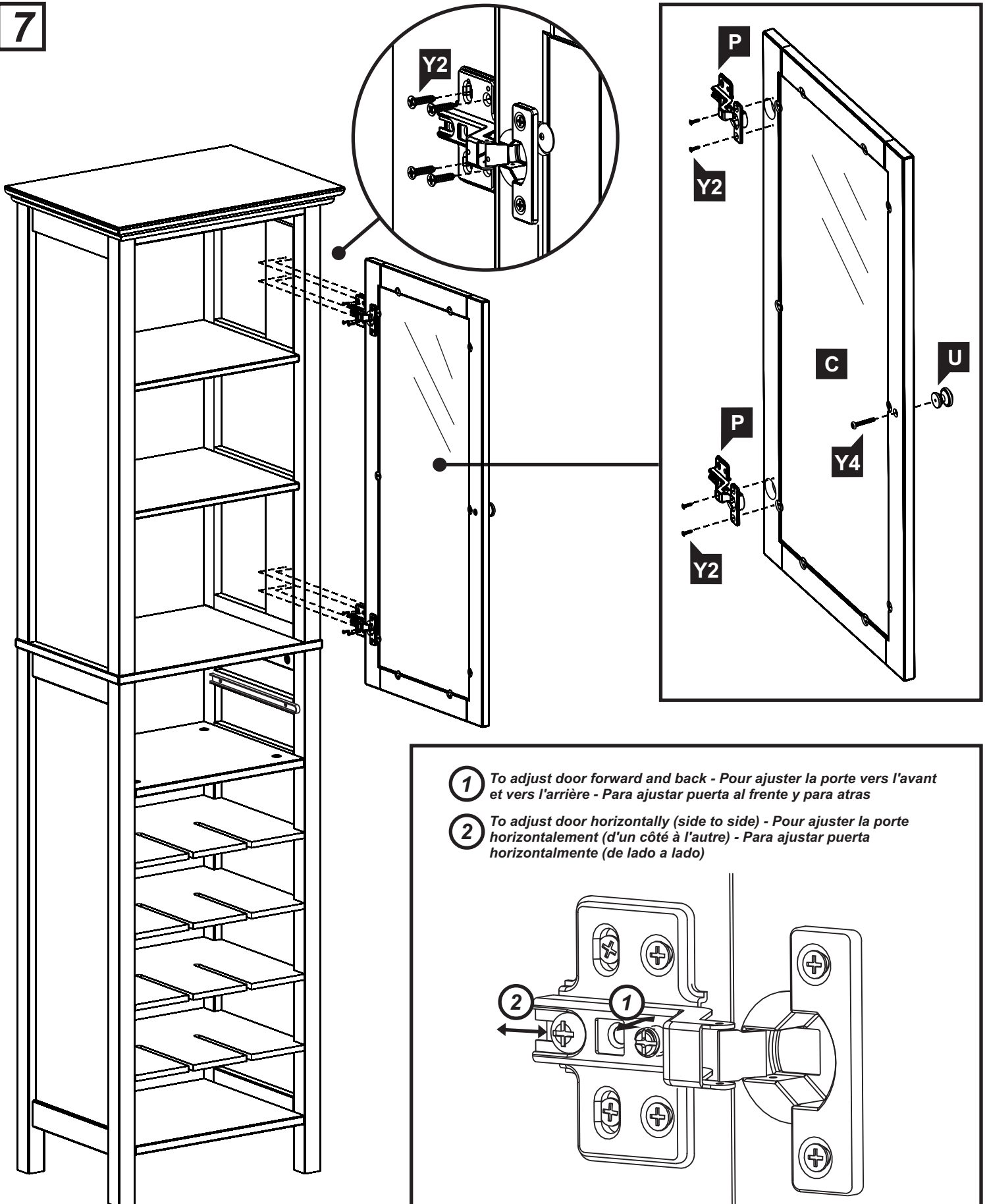

8

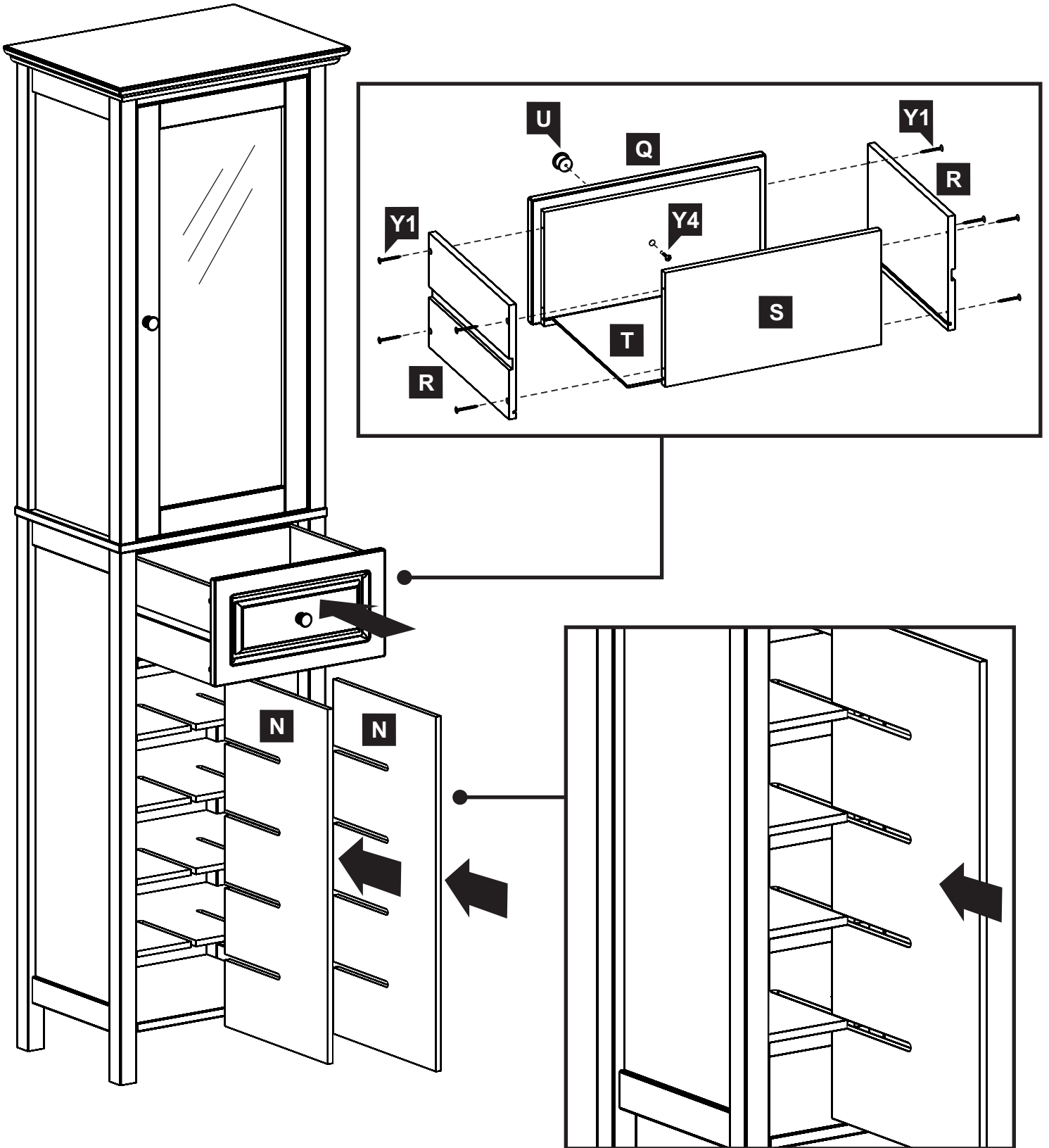

9

