

SIMMONS®

REST AIRE®

SET-UP INSTRUCTIONS

Thank you for your recent purchase. Please register your product online today at www.boydsleep.com/register

Please read all instructions for REST AIRE® and Simmons® Attached Pump prior to inflation.

1. Carefully unpack contents of carton.
2. Remove REST AIRE® from its convenient duffel bag.
3. Place mattress in unobstructed area free of sharp objects and unfold.

NOTE: Read separate Attached Pump instructions prior to operation.

4. Plug inset pump into a grounded 120 volt AC electrical outlet (a).
5. Inflate mattress by turning knob from off position to inflate position (b). **Ensure that the dial clicks into the "INFLATE" position.**



6. Inflate REST AIRE® mattress to full capacity. To avoid stretching or bulging do not overinflate. **DO NOT LEAVE PUMP UNATTENDED.**
7. After mattress is fully inflated turn knob back to off position (c). **Ensure that the dial clicks into the "OFF" position and arrow is pointing to "OFF" to prevent loss of air.**
8. To achieve desired firmness level, lie on the REST AIRE® mattress and turn mattress knob slowly towards the deflate position (d). (If too much air escapes, turn knob to inflate position.)



NOTE: Do not turn knob all the way to the deflate position or mattress will begin deflation process

9. If the REST AIRE® requires adjustment, repeat step 8.
10. Your REST AIRE® is now ready to use. Make up bed as desired with sheets and bedding.

TO DEFLATE AND STORE

1. Plug pump into a grounded 120 volt AC electrical outlet (a).
2. Deflate mattress by turning knob from off position to deflate position (e). **Ensure that the dial clicks into the "DEFLATE" position.**
3. When mattress is completely deflated turn knob to off position (f). **Ensure that the dial clicks into the "OFF" position and arrow is pointing to "OFF".**

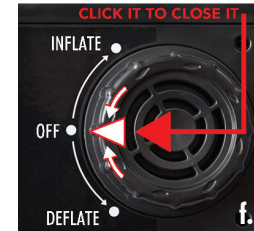

4. The REST AIRE® mattress is now ready for storage.
5. Roll and place REST AIRE® mattress in the convenient duffel bag.

WARNING: Attached Pump will burn out if left in "deflate" position after mattress is deflated. Monitor deflation progress. **DO NOT LEAVE PUMP UNATTENDED.**

Thank you for purchasing the REST AIRE®. To help us serve you best, please take a moment to complete the information below. Cut on dotted line and mail this important card to validate your warranty registration.

Please print

Mr. ☐ Mrs. ☐ Ms. ☐ Miss ☐ _____
First M.I. Last

Address

email Cell Phone

Name of store where purchased: _____ Date of purchase: ____/____/____
Month/Day/Year

1. Check the 3 most important reasons influencing your purchase of the REST AIRE®

<input type="checkbox"/> Product packaging	<input type="checkbox"/> Warranty and service	<input type="checkbox"/> Prior experience
<input type="checkbox"/> A product feature	<input type="checkbox"/> TV Advertisement	<input type="checkbox"/> Received as gift
<input type="checkbox"/> Purpose and style	<input type="checkbox"/> Magazine advertisement	<input type="checkbox"/> Recommendation of family/friend
<input type="checkbox"/> Convenience	<input type="checkbox"/> Newspaper advertisement	<input type="checkbox"/> Recommendation of salesperson
<input type="checkbox"/> Quality and durability	<input type="checkbox"/> In-store display	<input type="checkbox"/> Value for price
2. Check the reason you purchased REST AIRE®

<input type="checkbox"/> Gift	<input type="checkbox"/> School	<input type="checkbox"/> Comfort	<input type="checkbox"/> Vacation
<input type="checkbox"/> Travel	<input type="checkbox"/> Health	<input type="checkbox"/> Convenience	<input type="checkbox"/> Other
3. Who will use the REST AIRE® as an extra bed?

<input type="checkbox"/> Guests	<input type="checkbox"/> Children	<input type="checkbox"/> Yourself
---------------------------------	-----------------------------------	-----------------------------------
4. How often will you or someone else use the REST AIRE®?

<input type="checkbox"/> Daily	<input type="checkbox"/> Weekly	<input type="checkbox"/> Monthly	<input type="checkbox"/> Other
--------------------------------	---------------------------------	----------------------------------	--------------------------------
5. Do you intend to use the REST AIRE® to replace your own current sleep surface?

<input type="checkbox"/> Yes	<input type="checkbox"/> No
------------------------------	-----------------------------
6. What is your present income level?

<input type="checkbox"/> under \$15,000	<input type="checkbox"/> \$15,000-\$25,000	<input type="checkbox"/> \$25,000-\$50,000
<input type="checkbox"/> \$50,000-\$75,000	<input type="checkbox"/> \$75,000-\$100,000	<input type="checkbox"/> over \$100,000

*This bed is warranted as a temporary sleep surface. Please refer to opposite side under REST AIRE® "USES".

LIMITED 3 YEAR WARRANTY

REST AIRE® warrants to the original purchaser only when the REST AIRE® is used for normal indoor temporary sleeping purposes, that the mattress will be fully guaranteed against defects in material and workmanship for a period of 3 months from the date of purchase, provided further that the REST AIRE® has been operated and cared for according to the provided instructions and uses. Warranty does not cover punctures caused by misuse.

If defect occurs in months 4 - 12 from the original purchase date the manufacturer will offer a credit of 50% of the current manufacturer's Suggested Retail Price for the mattress. This credit is to be applied towards the purchase of a replacement REST AIRE® mattress directly from the original manufacturer. Shipping and handling charges to ship the replacement mattress are the responsibility of the consumer.

The pump is guaranteed to the original purchaser against defects in materials and workmanship for a period of 36 months from the date of original purchase provided that the pump has been operated according to the provided instructions. If defect in the pump occur in months 4 - 36 from the original purchase date, the manufacturer will offer a credit of 50% of the current manufacturer's Suggested Retail Price. This credit is to be applied towards the purchase of a replacement mattress directly from the original manufacturer. Shipping and handling charges to ship the replacement are the responsibility of the consumer.

Our obligation under this warranty shall be limited to the repair or exchange of any part which may prove defective under the conditions and during the periods described above.

This warranty shall not apply if upon inspection we find:

1. Any product or part has been damaged by alteration.
2. Any product or part has been subject to accident, misuse, abuse or has been operated contrary to the provided instructions or uses.

To submit a request for warranty replacement go to www.expressbedshelp.com and follow the detailed instructions on how to process a warranty claim. A copy of the Original Receipt is required as proof of purchase that validates the warranty.

This is the entire exclusive express limited warranty. The manufacturer neither makes nor is responsible for any other warranties, either expressed or implied, including those of retailing dealers. Any and all liability for breach of warranty, as well as damages for incidental, special or consequential losses are expressly denied.

This warranty applies only to product(s) purchased from an authorized retailer.

SIMMONS
REST AIRE®

2440 Adie Road
St. Louis, MO 63043

Affix
postage
here.

CARE AND MAINTENANCE

Mattresses are constructed of heavy duty vinyl designed for optimum comfort when used at normal household temperatures.

WARNING:

*Avoid extreme cold, as vinyl will become brittle. Do not overinflate.
Do not use high pressure or compressed air inflation systems.
Avoid sharp objects. Do not use hair dryer to inflate.*

WARNING: FLAMMABLE

VINYL IS FLAMMABLE. Do not locate bed near fire, fireplace or any other heat source, such as a space heater. Avoid placing bed over a heat emitting floor vent.

PVC, the material used to make air mattresses, will naturally stretch and expand during use. After being inflated for several hours and/or having been slept on, the air mattress may lose some of its initial firmness and feel softer because the PVC has naturally expanded. This expansion is normal and not the result of a leak. To regain your desired firmness level, add air to the mattress using the pump that was provided with the mattress.

Clean only with mild soap and water. Harsh cleaners can damage materials. Use repair kit to patch any holes, tears or punctures. Store at room temperature only AFTER cleaned and dried. Do not store outdoors or in a garage.

USES

Use the REST AIRE® any time an extra temporary sleep surface is needed. The REST AIRE® is intended for normal indoor use only. The REST AIRE® is not intended to be used in place of your present everyday sleep surface.



0-15 Months

! WARNING

Risk of Suffocation

- Infants have suffocated on inflatable mattresses. Never place an infant 15 months and younger to sleep on an inflatable mattress.
- When used by children over 15 months old:
 - Provide at least a shoulder width space between mattress and walls, dressers or other vertical objects to avoid entrapment.
 - Always keep mattress fully inflated when in use.

See instructions for additional warnings.