



Broken Egg Wall Art

Installation Guide

phillips
collection

every piece a conversation

Broken Egg Wall Art

Wall Mounting

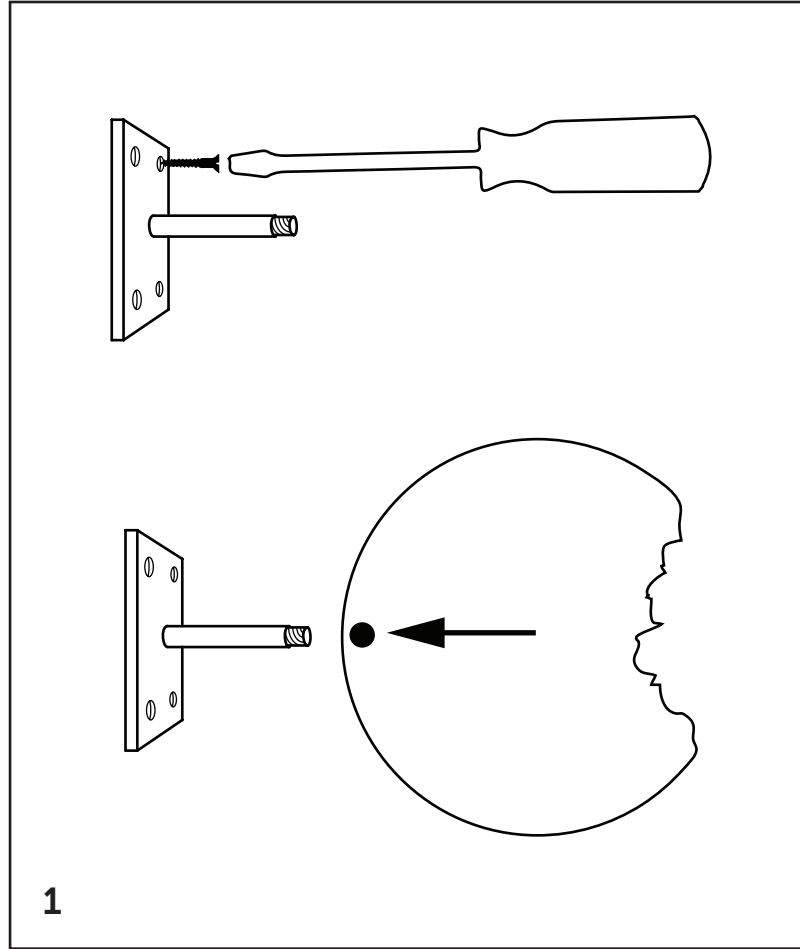
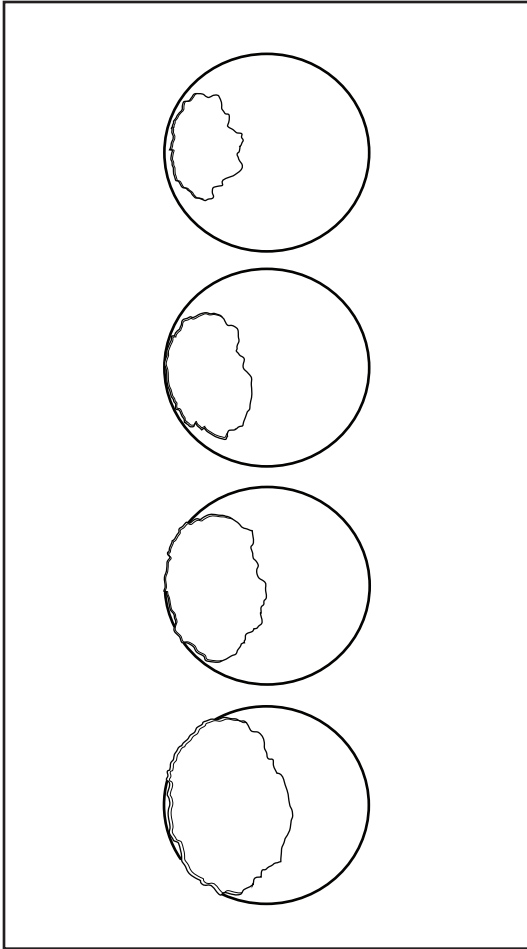

1 Attach the wall hanger on wall surface using screws.

Attach the Broken Egg Wall Art to the hanger by turning its clockwire to tighten.

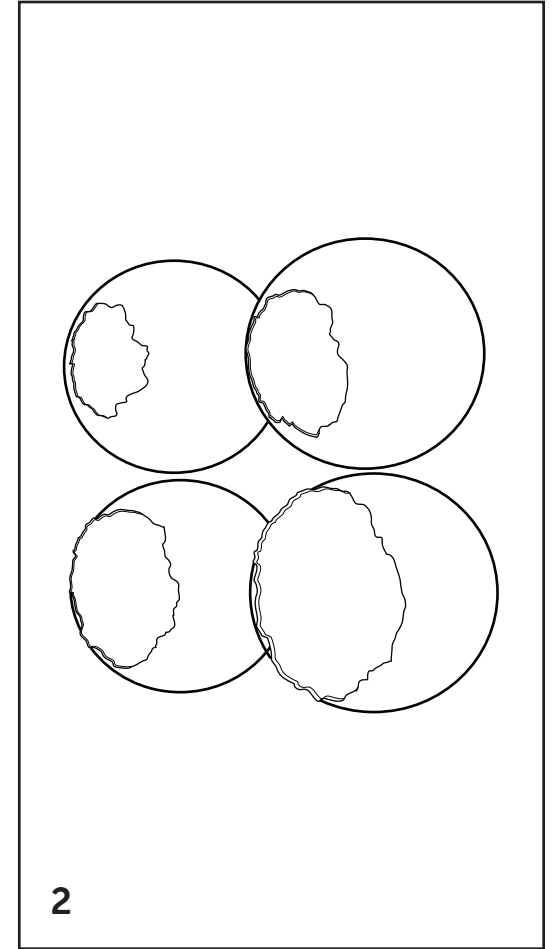

2 Repeat until rest of Broken Egg Wall Art is mounted.

(screws not included)

