

ASSEMBLY INSTRUCTION

RECTANGULAR KNOTTY STORAGE TABLE

Thank you for purchasing this quality product. Be sure to check all packing material carefully for small parts which may have some loose inside the carton during shipment. Identify and count all parts and compare with the parts List Below :

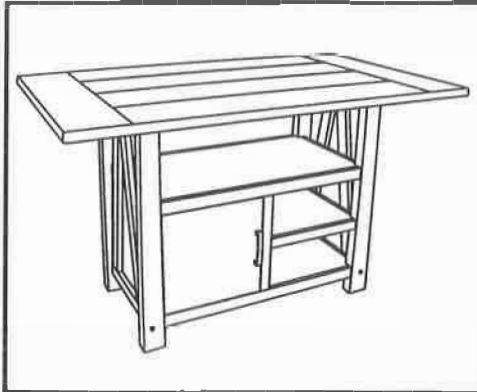

HARDWARE LIST #1

NO.	SKETCH	HARDWARE	Q'TY
A		JCBC Bolt	12 pcs
B		Large Flat Washer	4 pcs
C		Small Flat Washer	8 pcs
D		Lock Washer	12 pcs
E		Allen Key	1 pce
F		Wood Plug	8 pcs
G		Shelf Pin Spoon	4 pcs

PARTS LIST

SKETCH				
DESCRIPTION	Table Top	Side Frame #1	Side Frame #2	
SKETCH				
DESCRIPTION	Front Frame #1	Front Frame #2	Side Panel	Inner Panel
SKETCH				
DESCRIPTION	Bottom Panel	Top Panel	Shelf Panel #1	Shelf Panel #2

HARDWARE LIST #2

NO.	SKETCH	HARDWARE	Q'TY
I		Iron Handle	2 pcs
J		Truss Head Screw	4 pcs

NOTE: THE UNIT SHOULD BE ASSEMBLED BY 2 OR MORE PEOPLE.

ASSEMBLY STEP

STEP 1

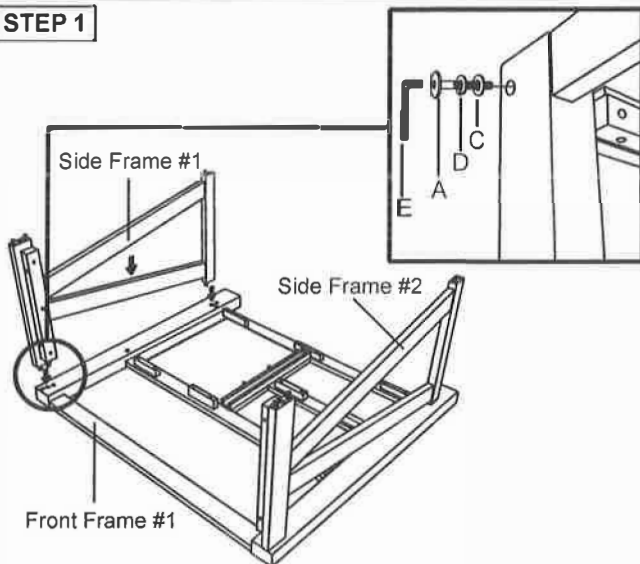

STEP 2

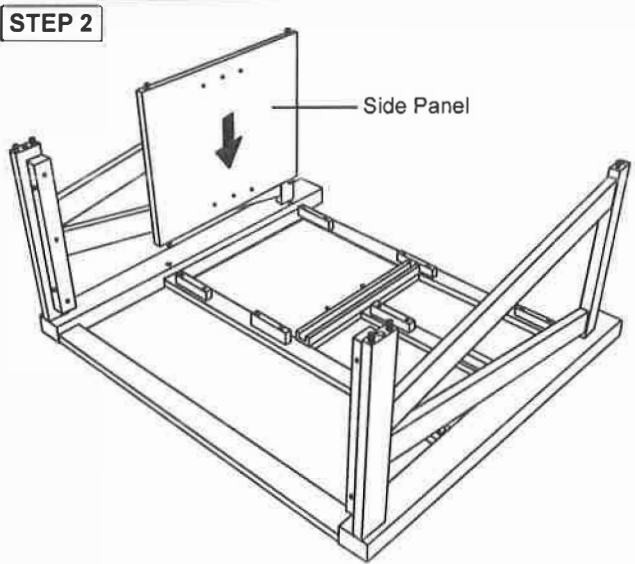

STEP 3

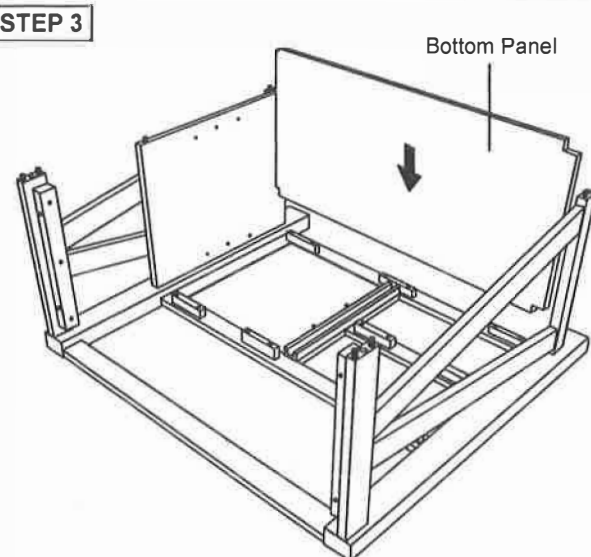

STEP 4

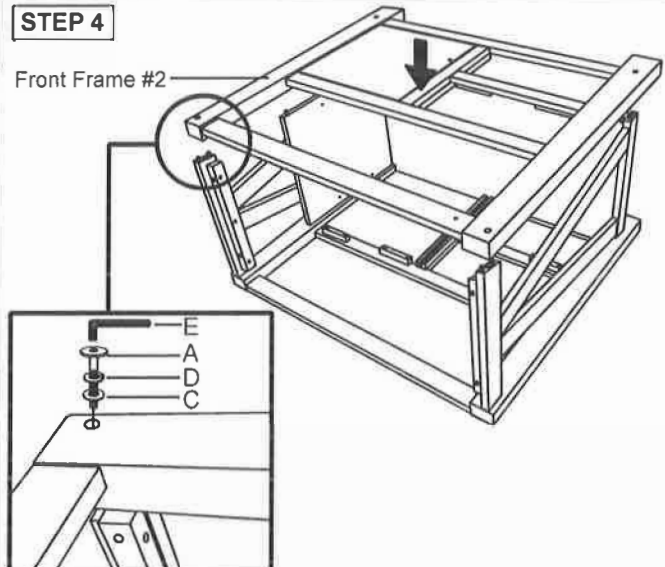

ASSEMBLY INSTRUCTION

Step 5

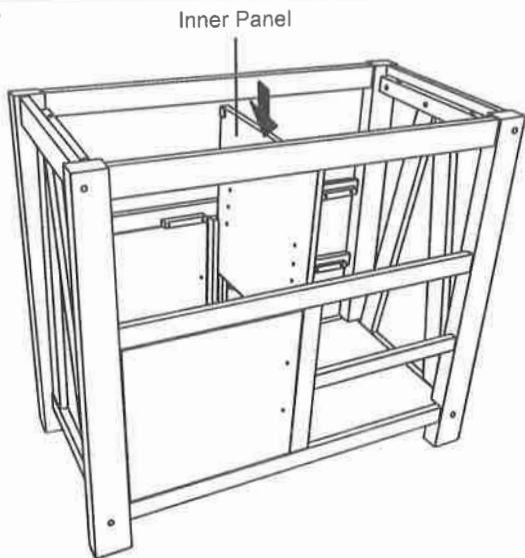

Step 6

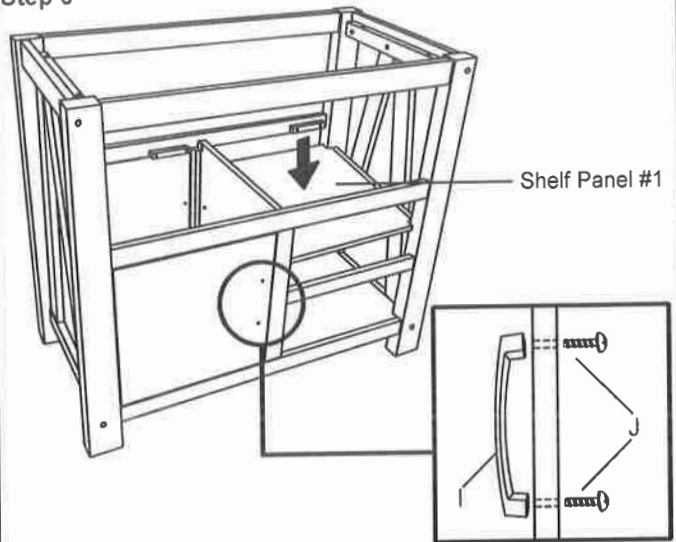

Step 7

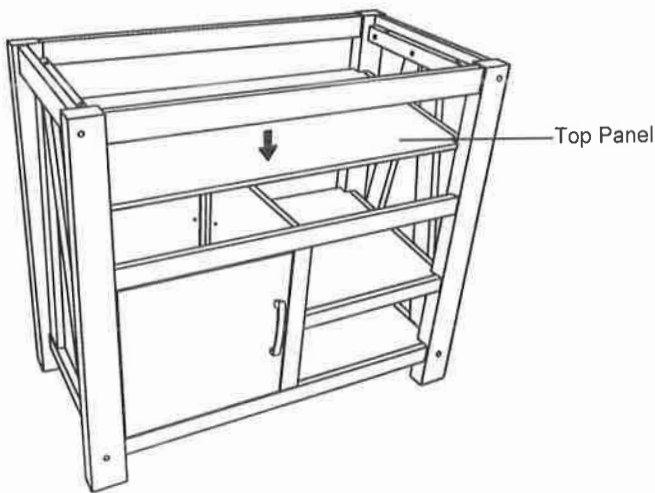

Step 8

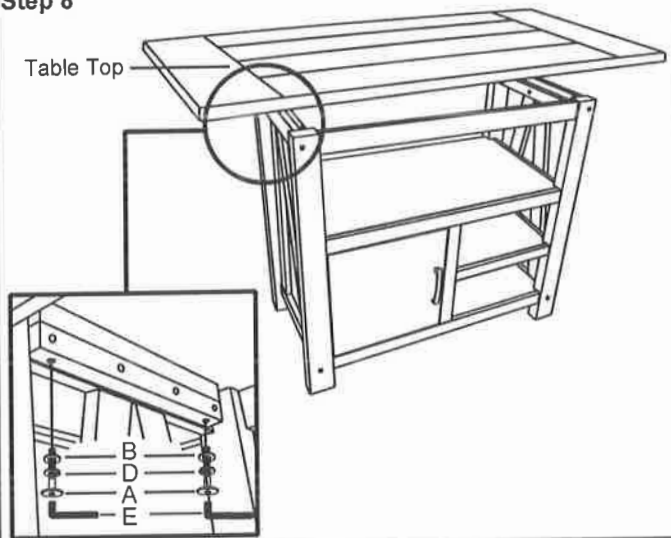

Step 9

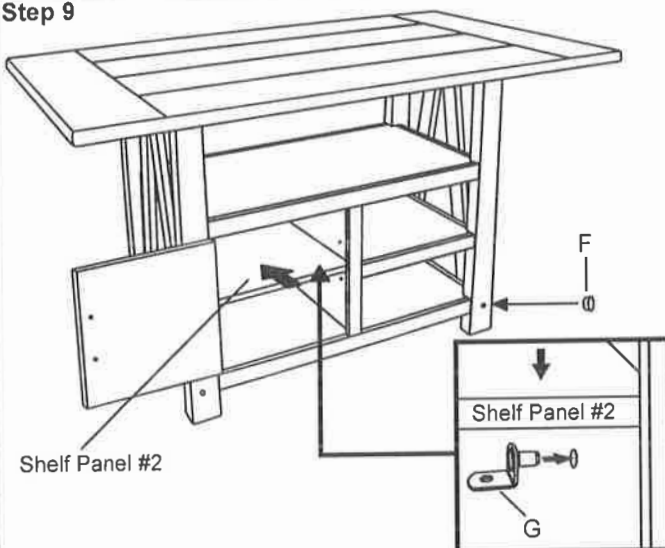

Complete View