

ASSEMBLY INSTRUCTION

30" ROUND TABLE

LIST OF PARTS		
No	Qty	Description
A	1 pc.	TABLE TOP
B	4 pcs.	LEG
C	6 pcs.	FLAT WASHER
D	6 pcs.	LOCK WASHER
E	6 pcs.	NUT
F	1 pc.	KEY WRENCH

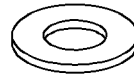

C

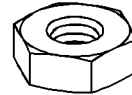

E



D



F

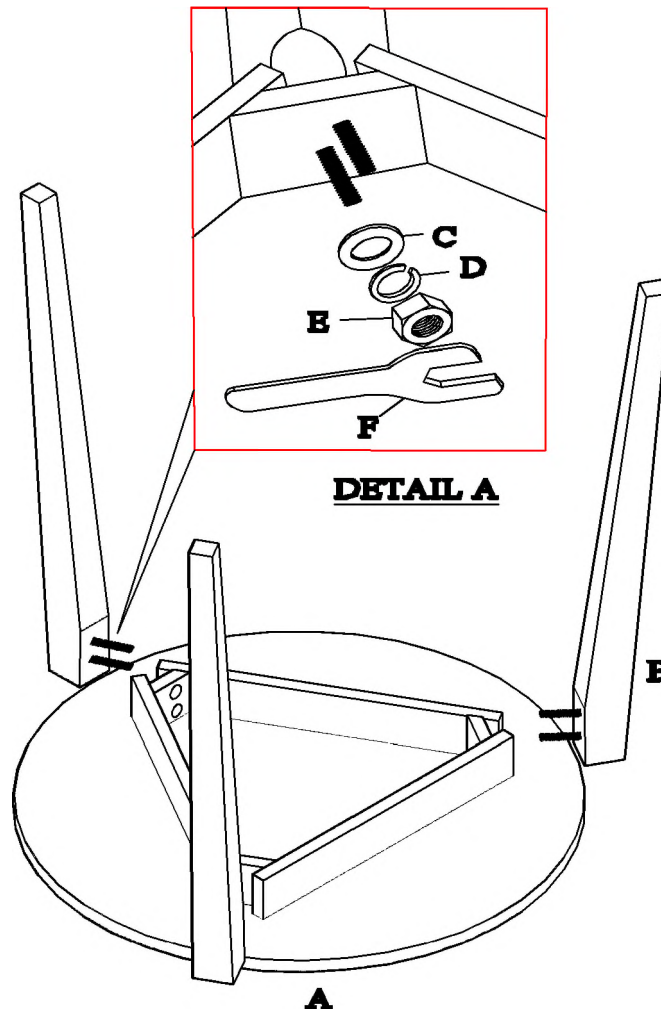

DETAIL A

STEP: 1

- PLACE TABLE TOP (A) UP-SIDE-DOWN ON CARPETING OR CARTON FOR PROTECTION.
- ALIGN AND PLACE 4 LEGS (B) INTO EACH CORNER OF TOP (A) AS SHOWN IN ILLUSTRATION.
- PLACE FLAT WASHER (C), LOCK WASHER (D) AND NUT (E) INTO THE THREADED ON THE BOLT.
- FULLY TIGHTEN ALL NUTS (E) WITH THE KEY WRENCH (F) TURNING CLOCKWISE UNTIL SECURE.
(SEE DETAIL : A)