

# ASSEMBLY INSTRUCTION

DINING TABLE

Thank you for purchasing this product. Please take time to read and follow the instructions below. Check that you have all parts and hardware before assembly. Parts apparently missing are often found in the packing materials. If you do not have all the parts listed, have your dealer contact us and they will be sent to you immediately.

It is recommended to install protective pads under all legs and supports to avoid damage or scratches when placing furniture on a wood floor or other hard surface, and to limit indentation and prevent discoloration if placing on carpet.

PARTS LIST		
A	Table Top	1 pc
B	Legs	4 pcs

HARDWARE LIST			
1	JCBB M8 x 60 MM		8 pcs + 1 pc
2	Spring Washer M8		8 pcs + 1 pc
3	Flat Washer M8		8 pcs + 1 pc
4	Allen Key M5		1 pc

## STEP 1

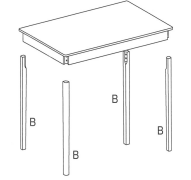

## STEP 2

It is recommended that you place paper or cloth on the floor when the Part "A" is in contact with the floor to avoid wear/scratches.

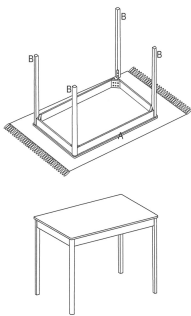
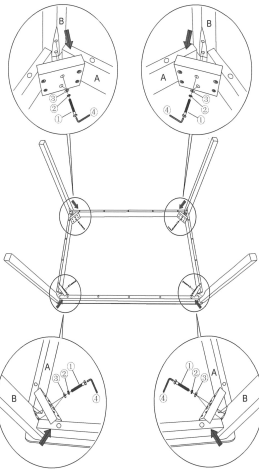

COMPLETED ASSEMBLY

Pg 1 of 1

# ASSEMBLY INSTRUCTION

DINING CHAIR

Thank you for purchasing this product. Please take time to read and follow the instructions below. Check that you have all parts and hardware before assembly. Parts apparently missing are often found in the packing materials. If you do not have all the parts listed, have your dealer contact us and they will be sent to you immediately.

It is recommended to install protective pads under all legs and supports to avoid damage or scratches when placing furniture on a wood floor or other hard surface, and to limit indentation and prevent discoloration if placing on carpet.

PARTS LIST		
C	Left Frame	4 pcs
D	Right Frame	4 pcs
E	Front / Back Stretcher	8 pcs
F	Back Rest	4 pcs
G	Back Rest (Small)	4 pcs
H	Cushion Seat	4 pcs

HARDWARE LIST			
5	O6 x 50mm		24 pcs + 1 pc
6	O6 x 12mm		24 pcs + 1 pc
7	O4mm x 32mm		16 pcs + 1 pc
8	M4 Allen Key		1 pc

## STEP 1

When installing part ⑤, please place it as shown in the figure.

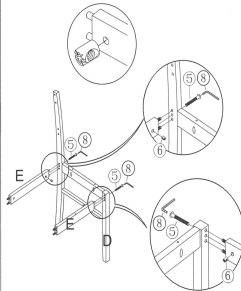

## STEP 2

When installing part ⑥, please place it as shown in the figure.

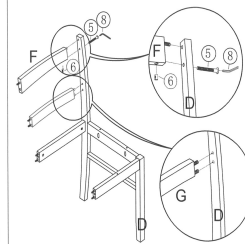

Pg 1 of 2

## STEP 3

When installing part ⑧, please place it as shown in the figure.

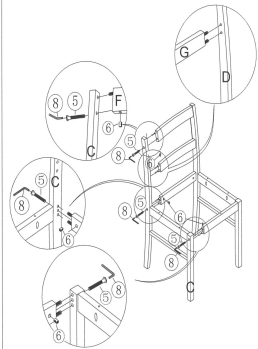

## STEP 4

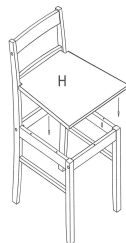

## STEP 5

A flatter item can be selected as a support under Part I (as shown in the figure) to avoid wear/scratches.

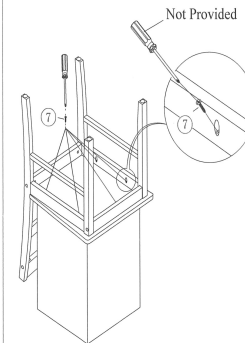

COMPLETED ASSEMBLY

Pg 2 of 2