

# Kennel

2.3m x 2.3m / 7.5ft x 7.5ft

## Assembly Guide

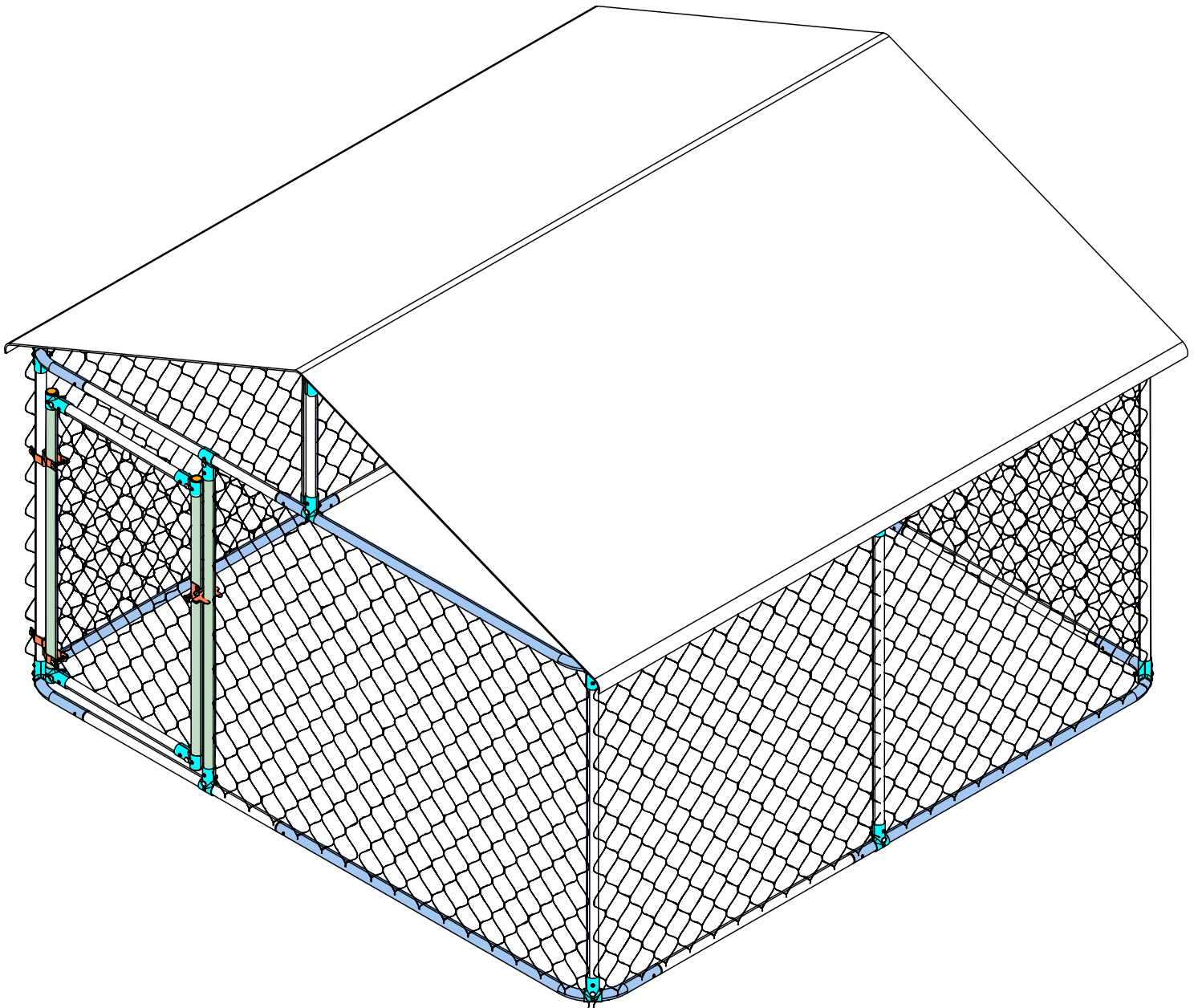

Designed by  
Manufactured by

## SAFETY

- Read all the safety information and instructions.
- Make sure you have all the parts before the assembling
- Do not assemble the kennel on a stormy day. It will be damaged.
- Always wear work gloves, long sleeves, and safety goggles when assembling.
- Keep children and pets away from the assembly site.
- When using a ladder, make sure the ground is stable enough to hold the ladder.
- Remove snow from the roof after each snowfall.
- Do not walk on the roof, even if you can.

## TOOLS

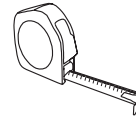
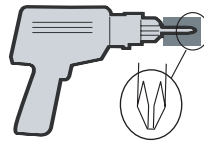
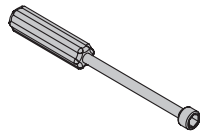

## PART LIST

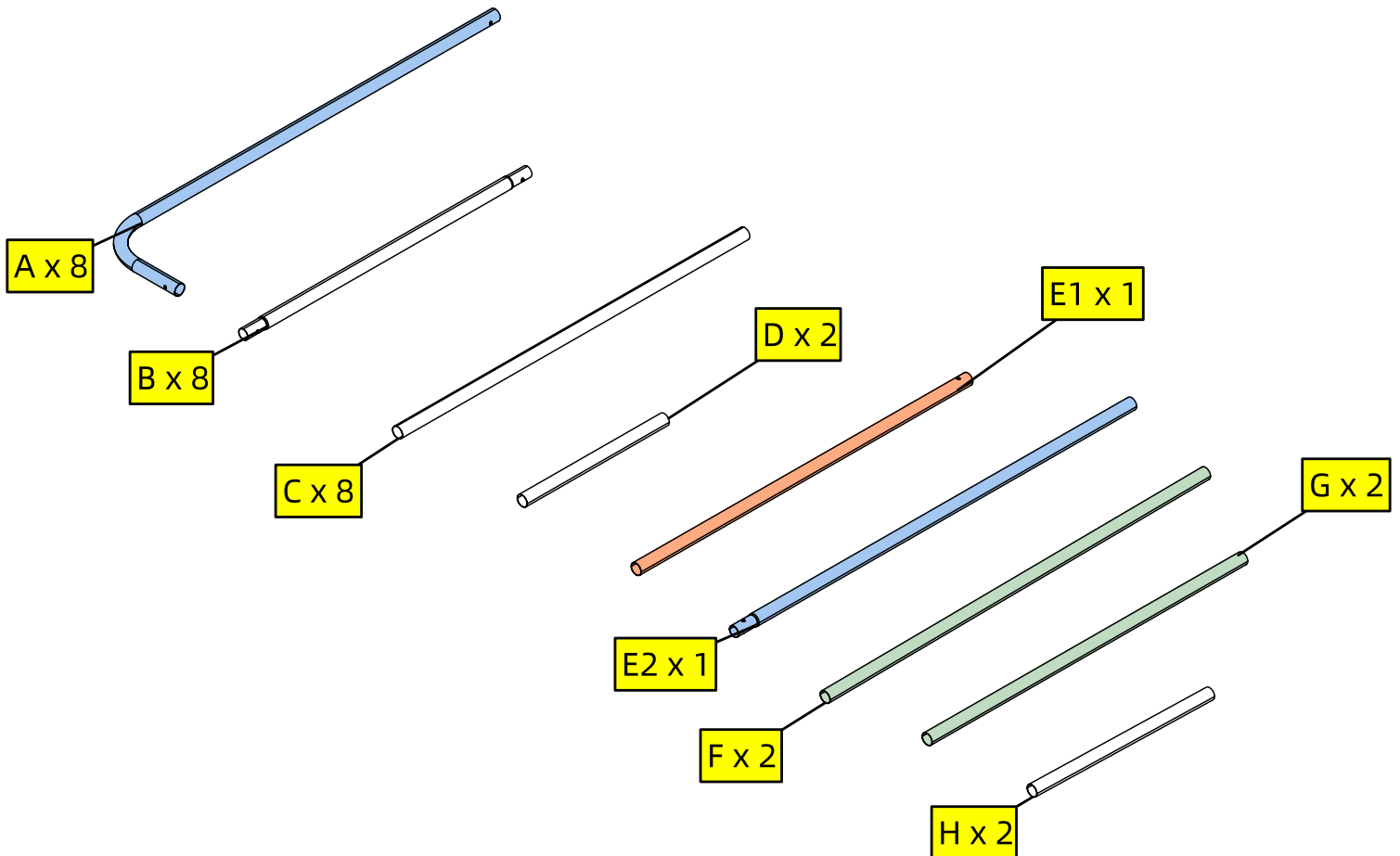

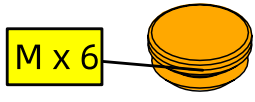

M x 6

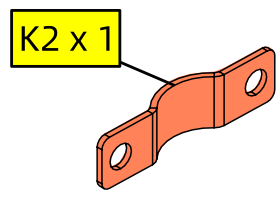

K2 x 1

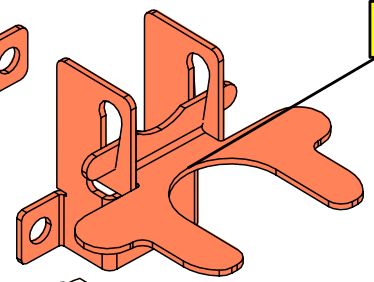

K1 x 1

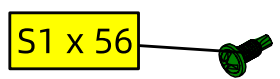

S1 x 56

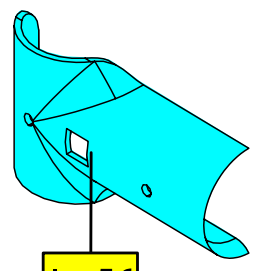

I x 56

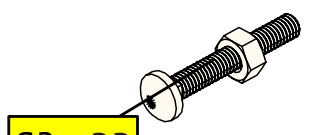

S2 x 32

\*S2 refers to the bolt and nut.

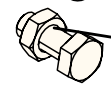

S3 x 2

\*S3 refers to the bolt and nut.

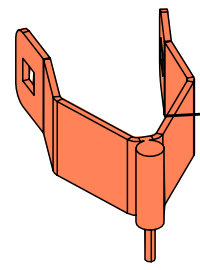

L2 x 2

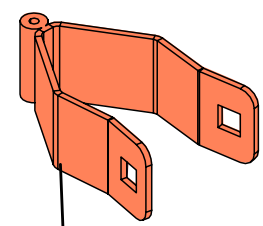

L1 x 2

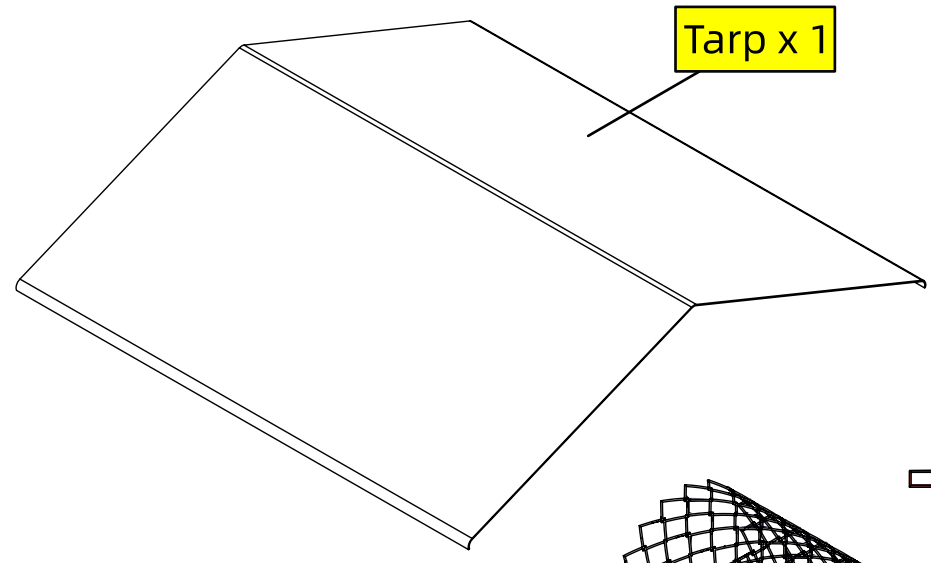

Tarp x 1

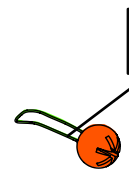

O x 14

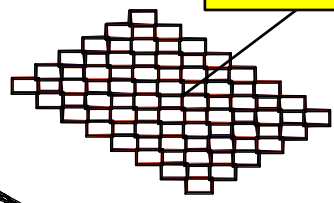

Door Mesh x 1

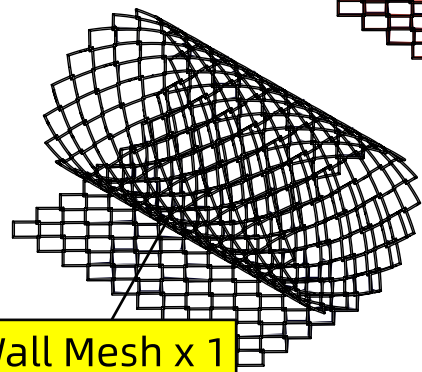

Wall Mesh x 1

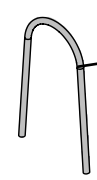

Q x 8

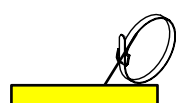

P x 200

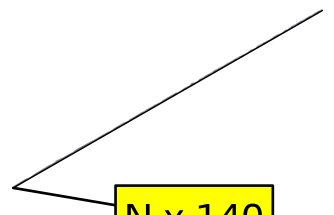

N x 140

| Part | Qty |
|------|-----|
| A    | 8   |
| B    | 8   |

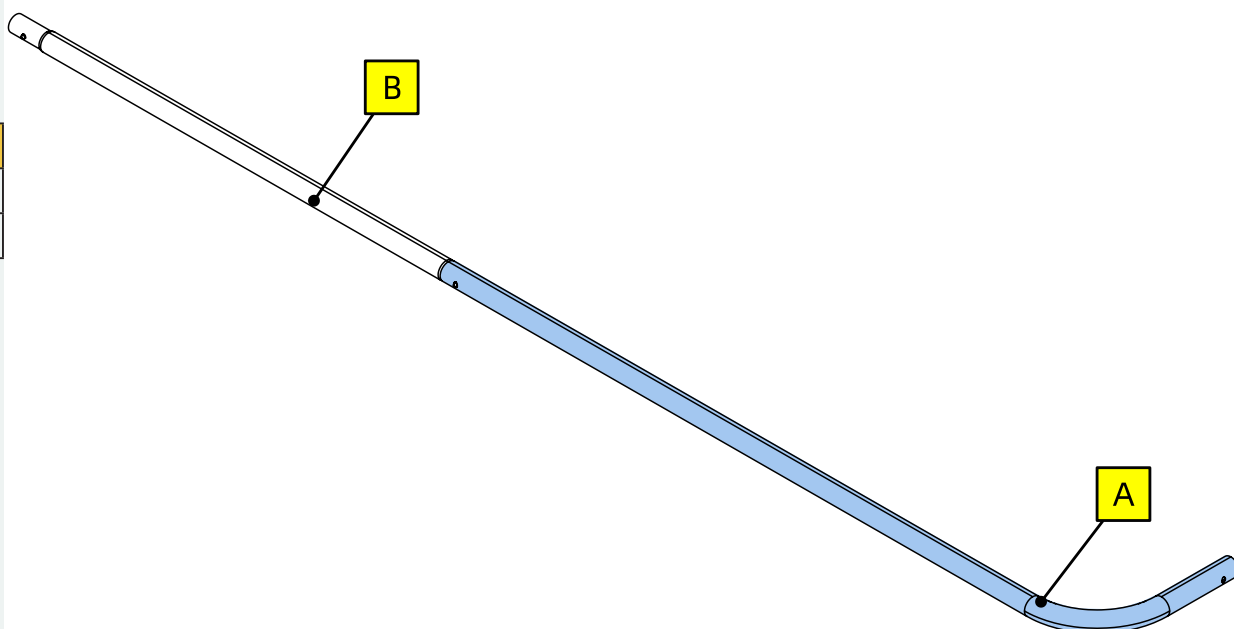

### Note

**A** This is a part marker.

**1** This is a step marker.

Connect all 8 sets of A and B.

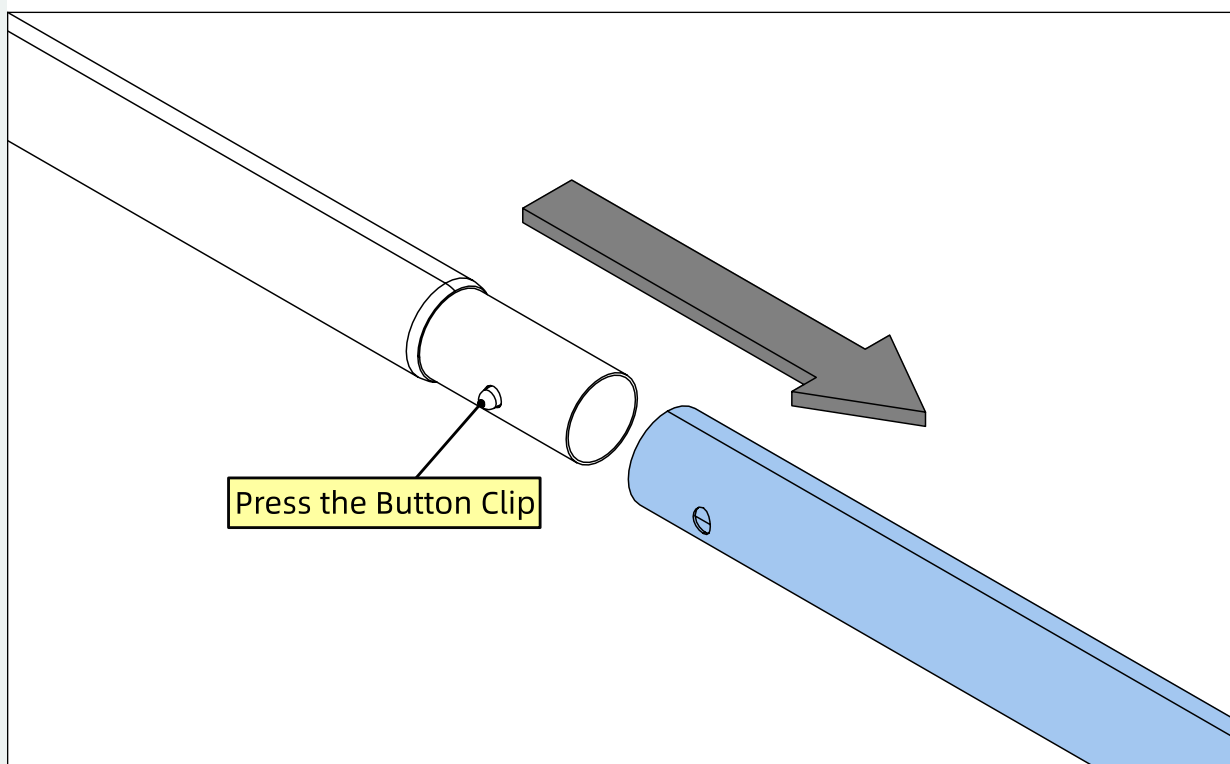

### Note

For this product, tubes are connected using button clips and Panel T Clamps (Part No. 1, which will be discussed later). Button clips are already inserted inside tubes. When connecting, press the button clip and insert one tube into another.

Forcing the tubes inside each other might also work but you are risking damaging the Clip.

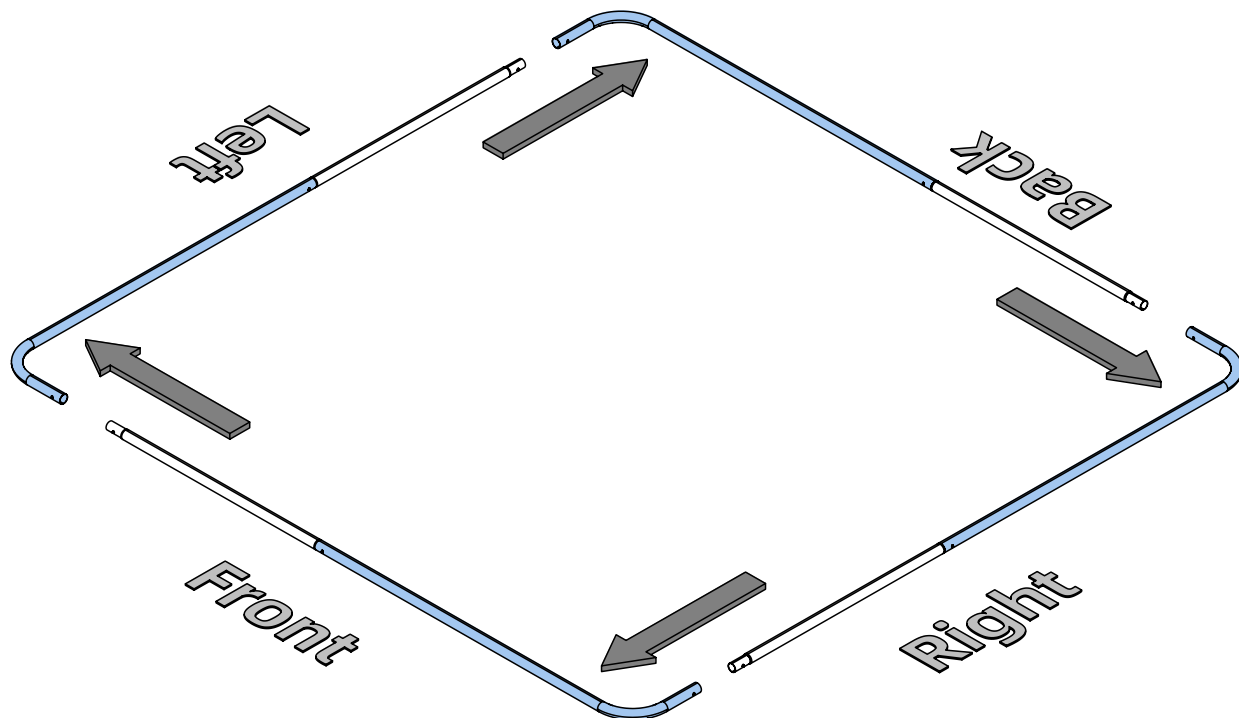

| Part | Qty |
|------|-----|
| A+B  | 8   |

### Note

**BACK** This is an orientation marker.

Repeat this step till you get two sets of rectangular frames.

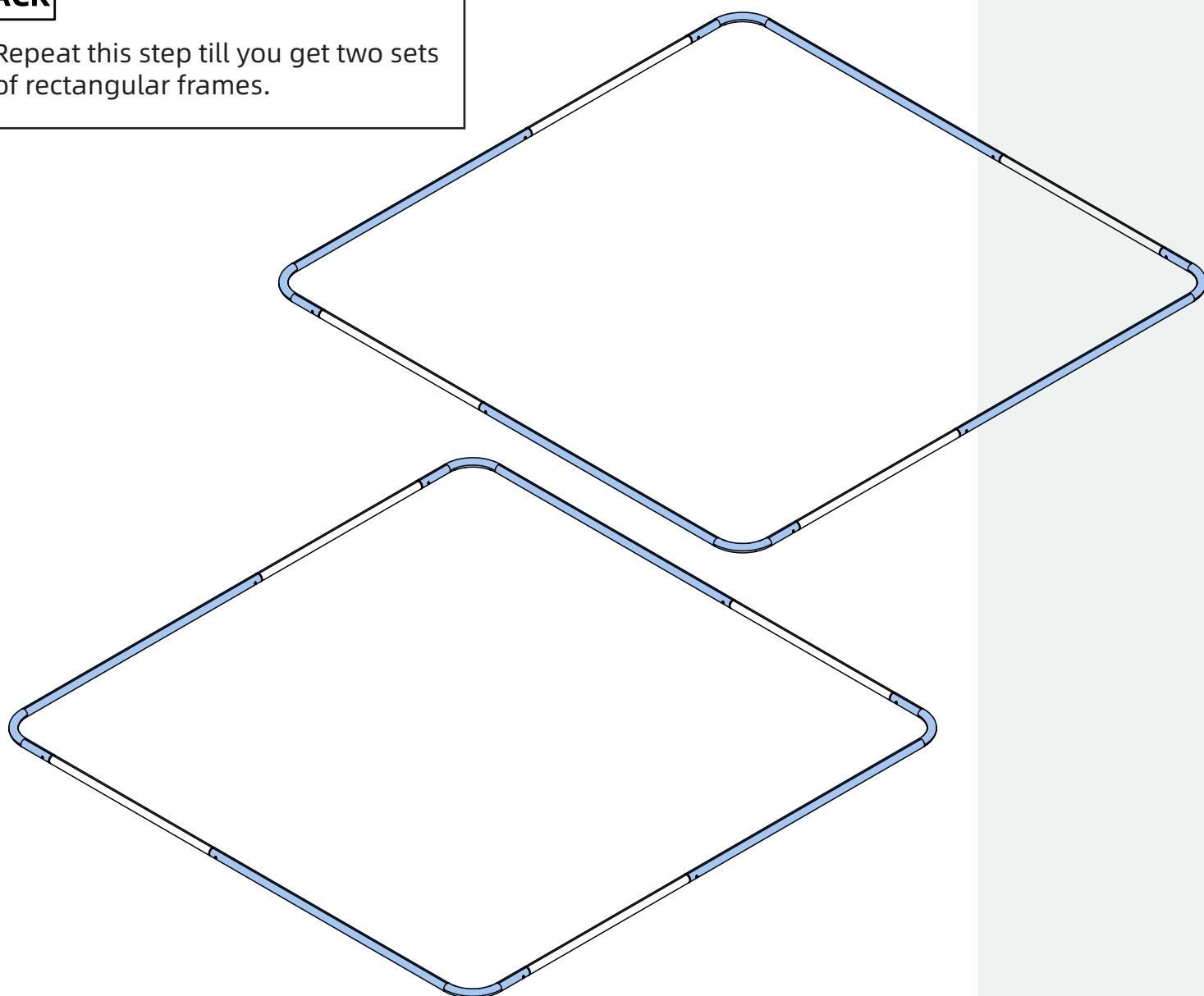

| Part | Qty |
|------|-----|
| I    | 14  |
| S1   | 6   |
| S2   | 7   |

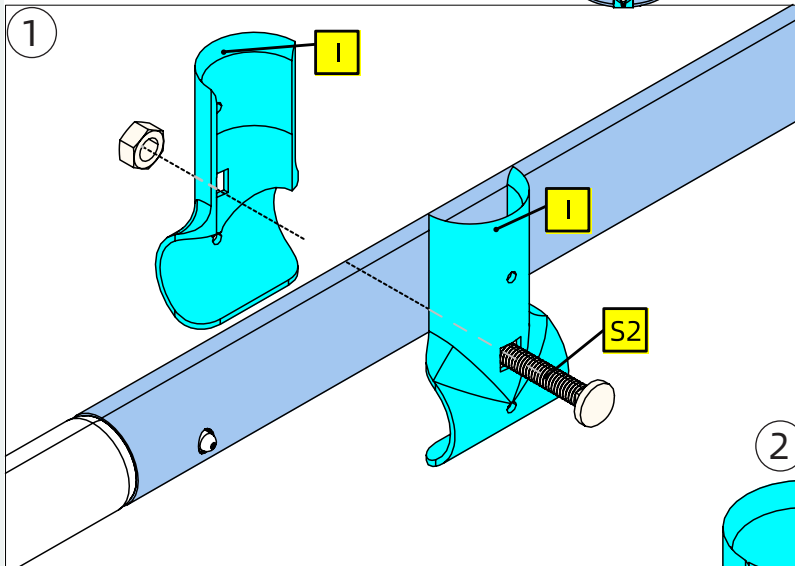
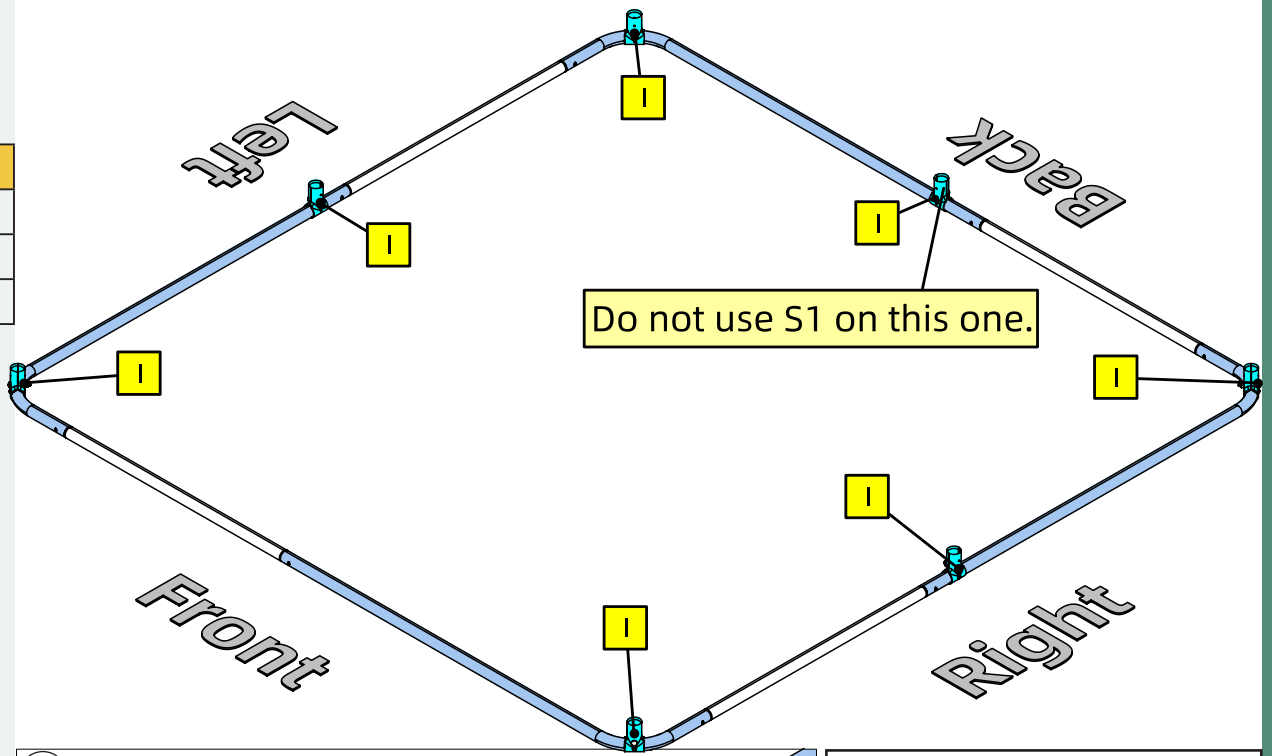

### Note

Connect two I together using S2.

### Note

For this step you will need a power tool with a Philip head bit to drive S1 into the tubes. Notice that you will not find predrilled holes on the tubes for S1.

To find a location for the S1's screw hole, position Part I two inches away from the edge of the button clip, and put them on tube A.

For the four pairs of Part I at the four corners, position them at the center of the corners.

Do not worry too much about pinpointing the exact location for Part I. The location contributes little to the overall stability of this product.

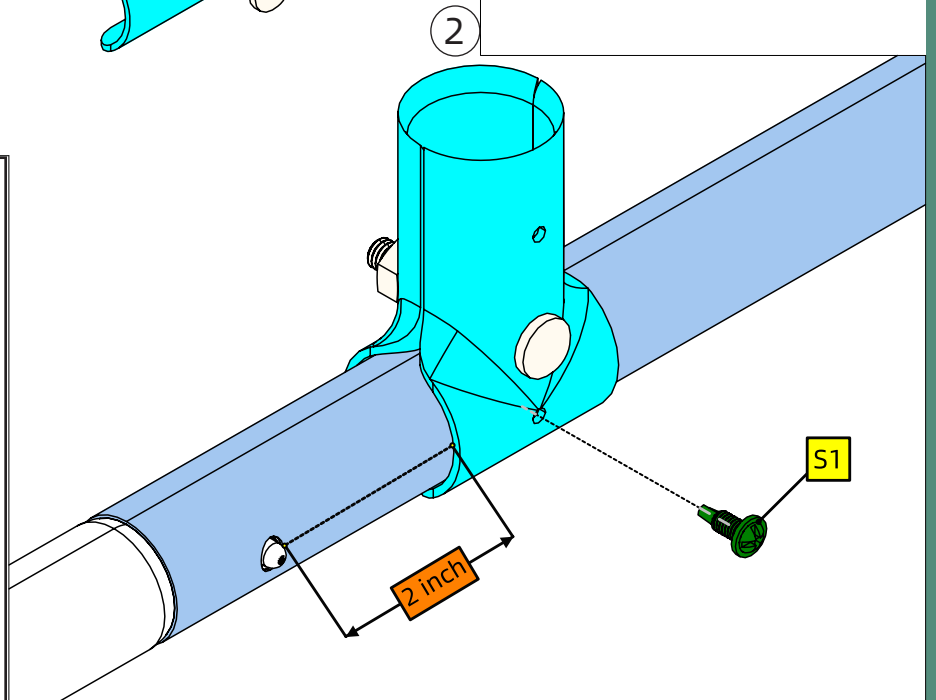

### Note

Do not use S1 on the Part I at the back.

| Part | Qty |
|------|-----|
| C    | 7   |
| S1   | 6   |

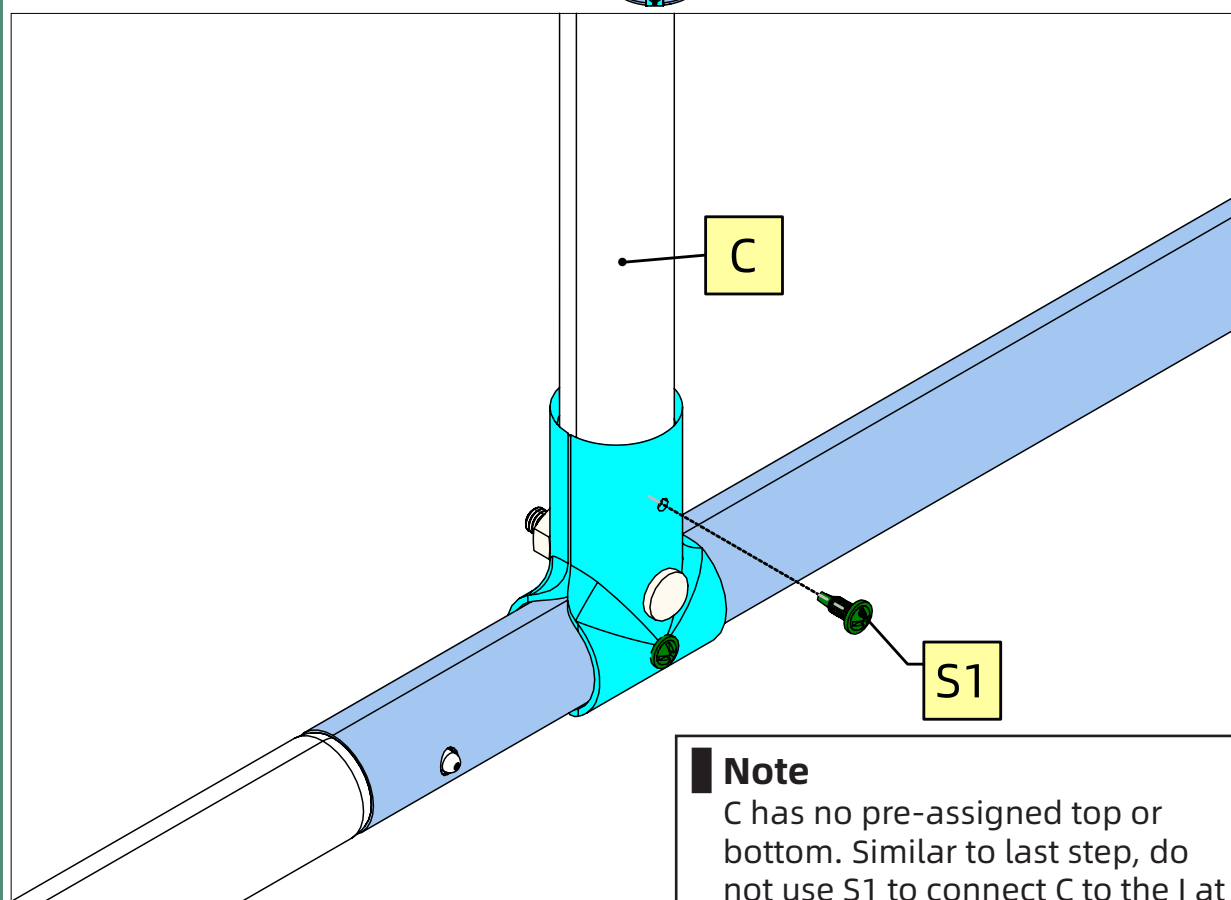
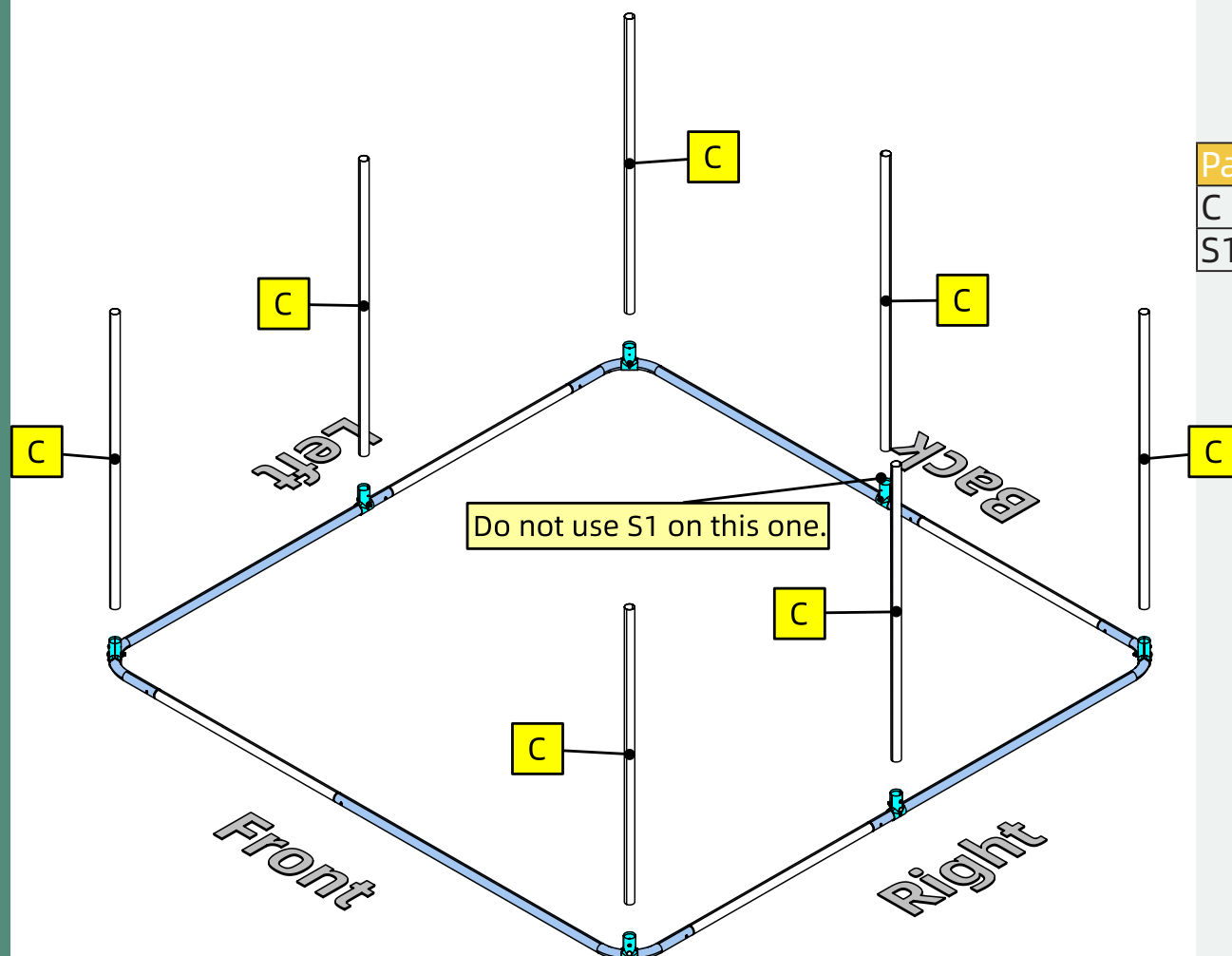

#### Note

C has no pre-assigned top or bottom. Similar to last step, do not use S1 to connect C to the I at the back.

| Part | Qty |
|------|-----|
| A+B  | 1   |
| I    | 4   |
| S2   | 2   |

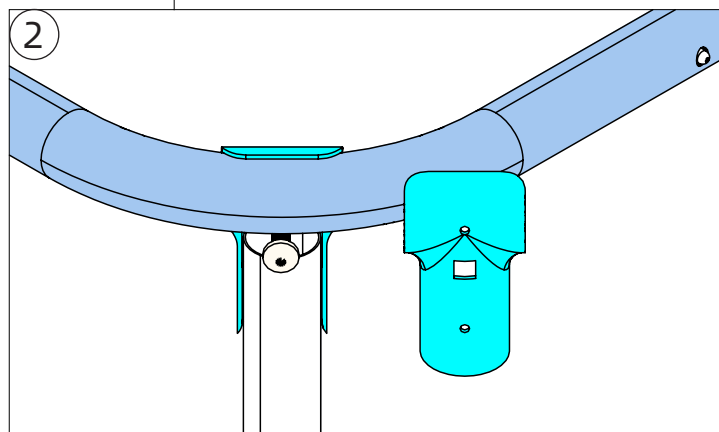
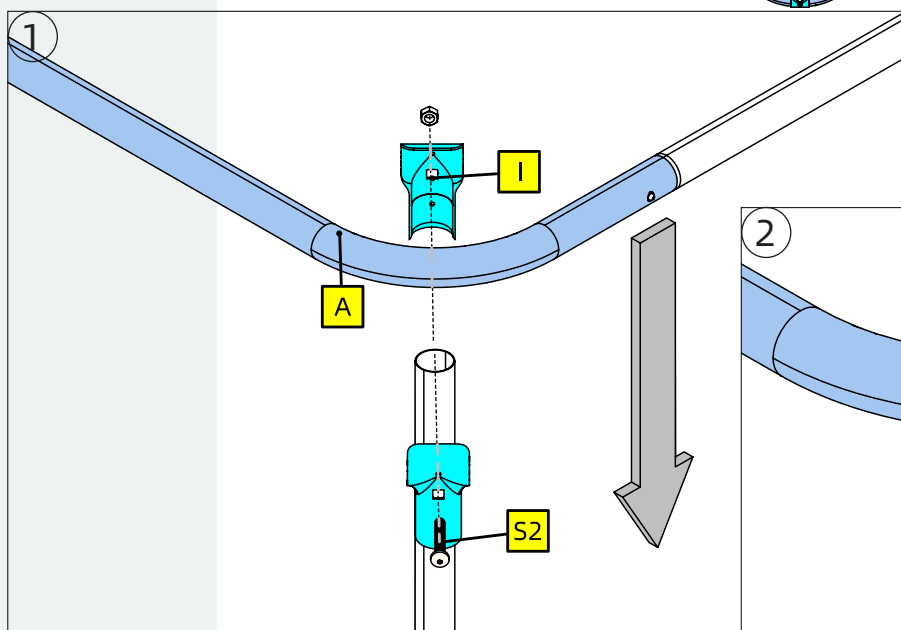
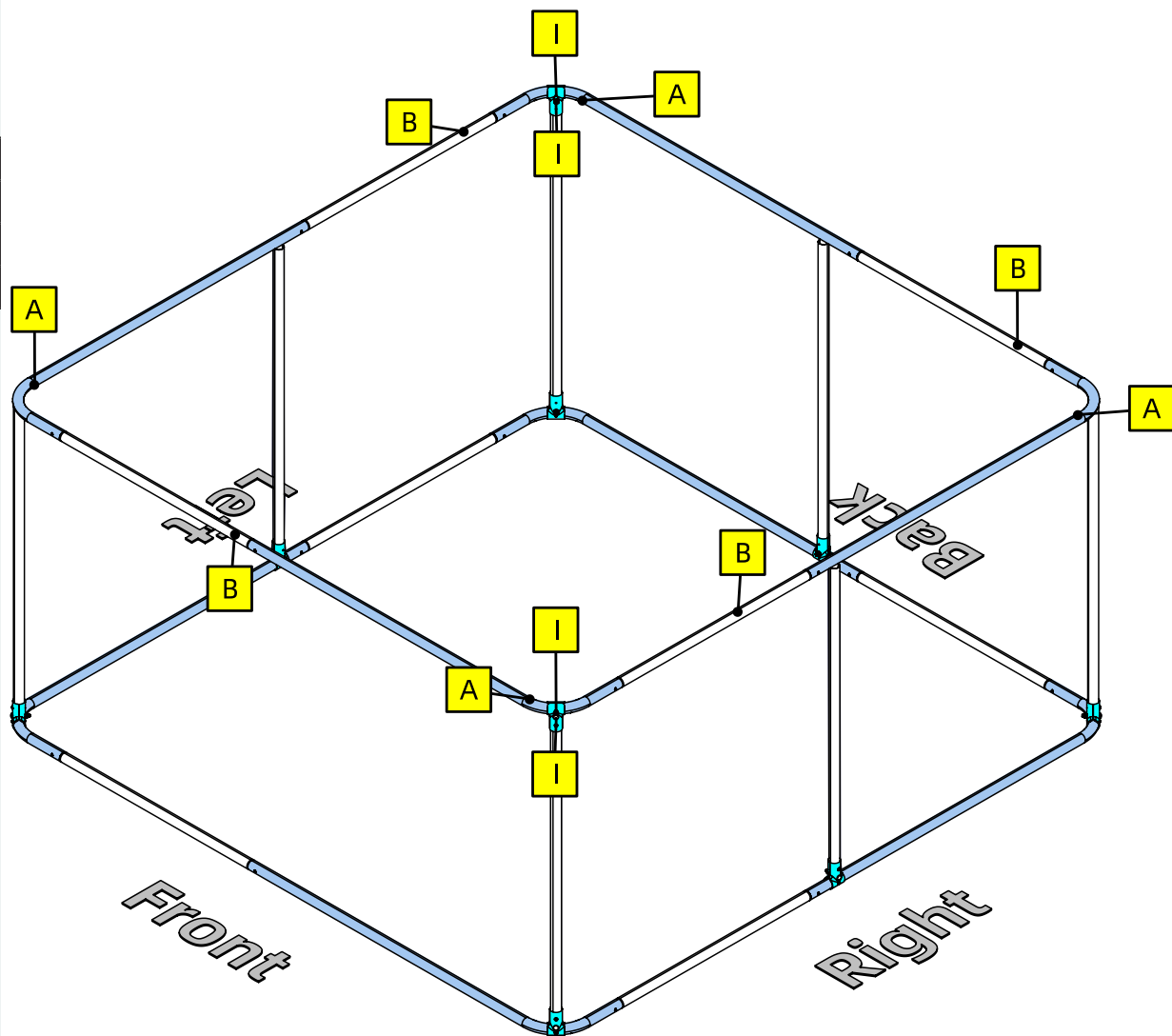

### Note

A+B refers to the rectangular frame assembled in Step 2. You will need at least two people for this step, with each person standing at the diagonal corner, lifting the A+B frame to the top. Ideally, have a third person help you lift up the A+B frame while the two assemble the two pairs of I with S2. That said, two people can definitely finish this step. The drawing on the bottom right shows you how the A+B frame rests on the S2. Fix only two pairs of I and DO not drive any S1 screw to any of the tubes yet.



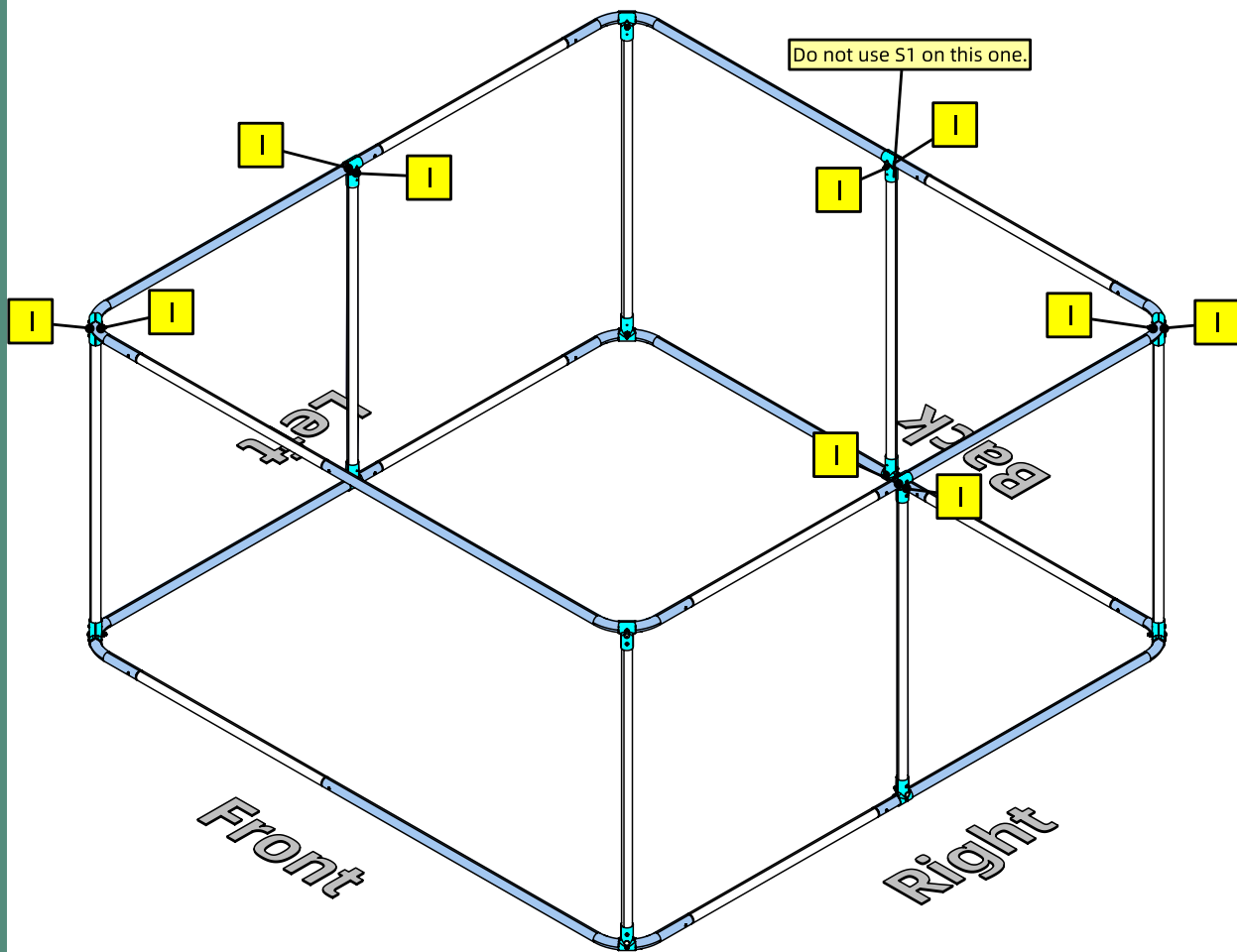

| Part | Qty |
|------|-----|
| I    | 10  |
| S2   | 5   |
| S1   | 10  |

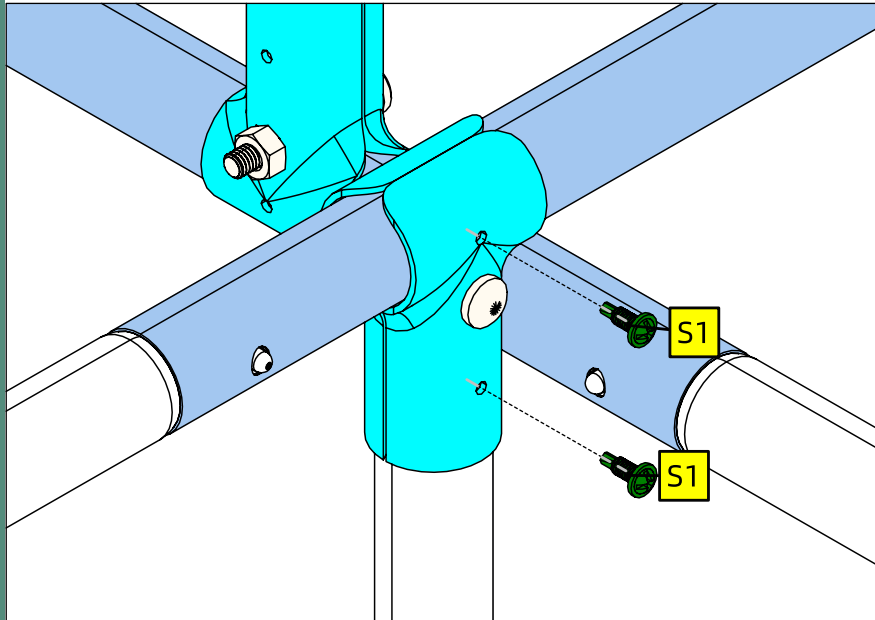

### Note

Attach five pairs of I to the five C erected in step 4 using S2, and use S1 to fasten I to A+B frame and C. Before doing so, however, make sure that all the C tubes are perfectly vertical.

Also drive two S1 into Part I assembled in last step.

Do not use S1 on the I at the back.

| Part | Qty |
|------|-----|
| I    | 4   |
| S2   | 2   |
| E1   | 1   |
| E2   | 1   |
| M    | 2   |
| S1   | 4   |

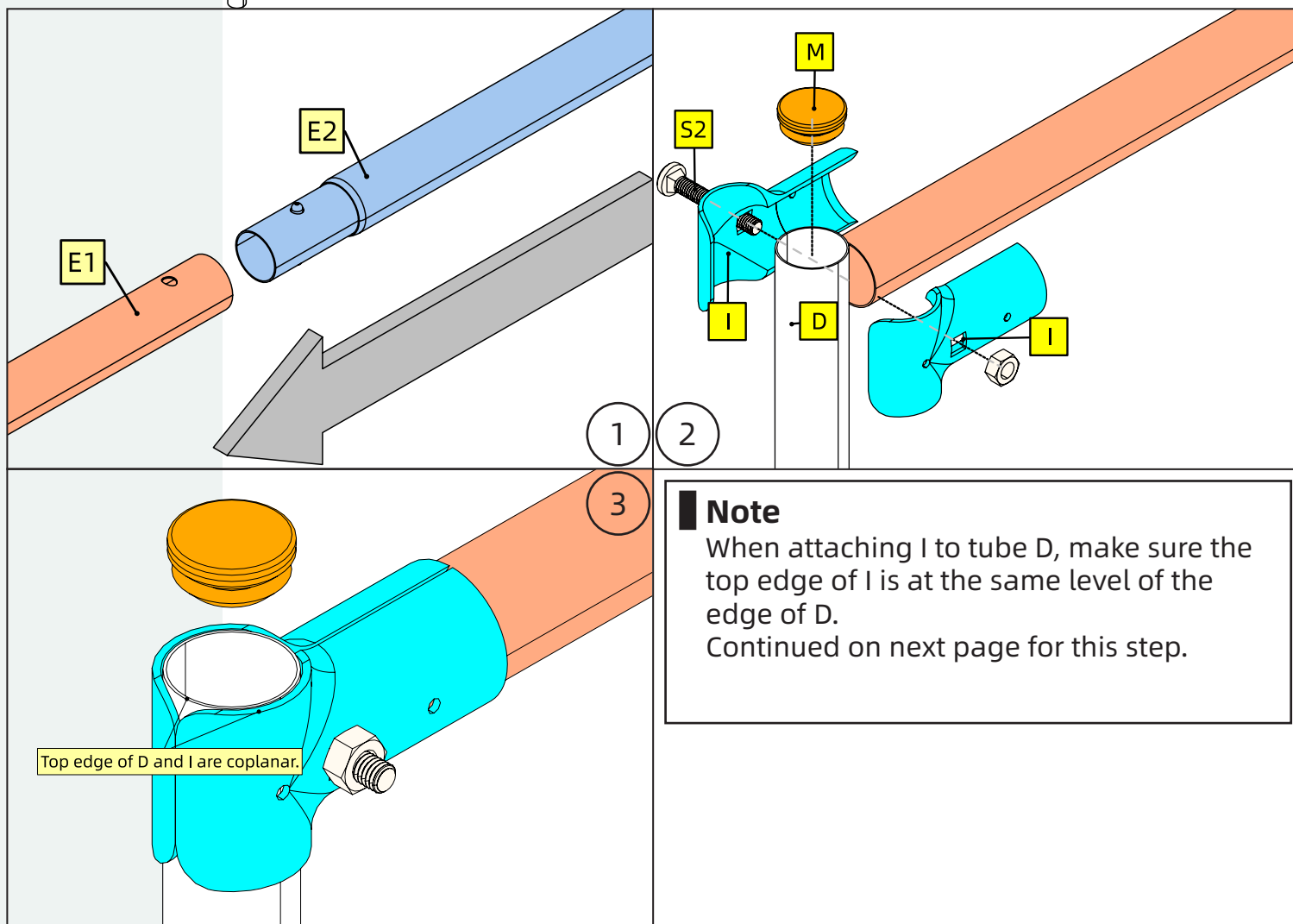
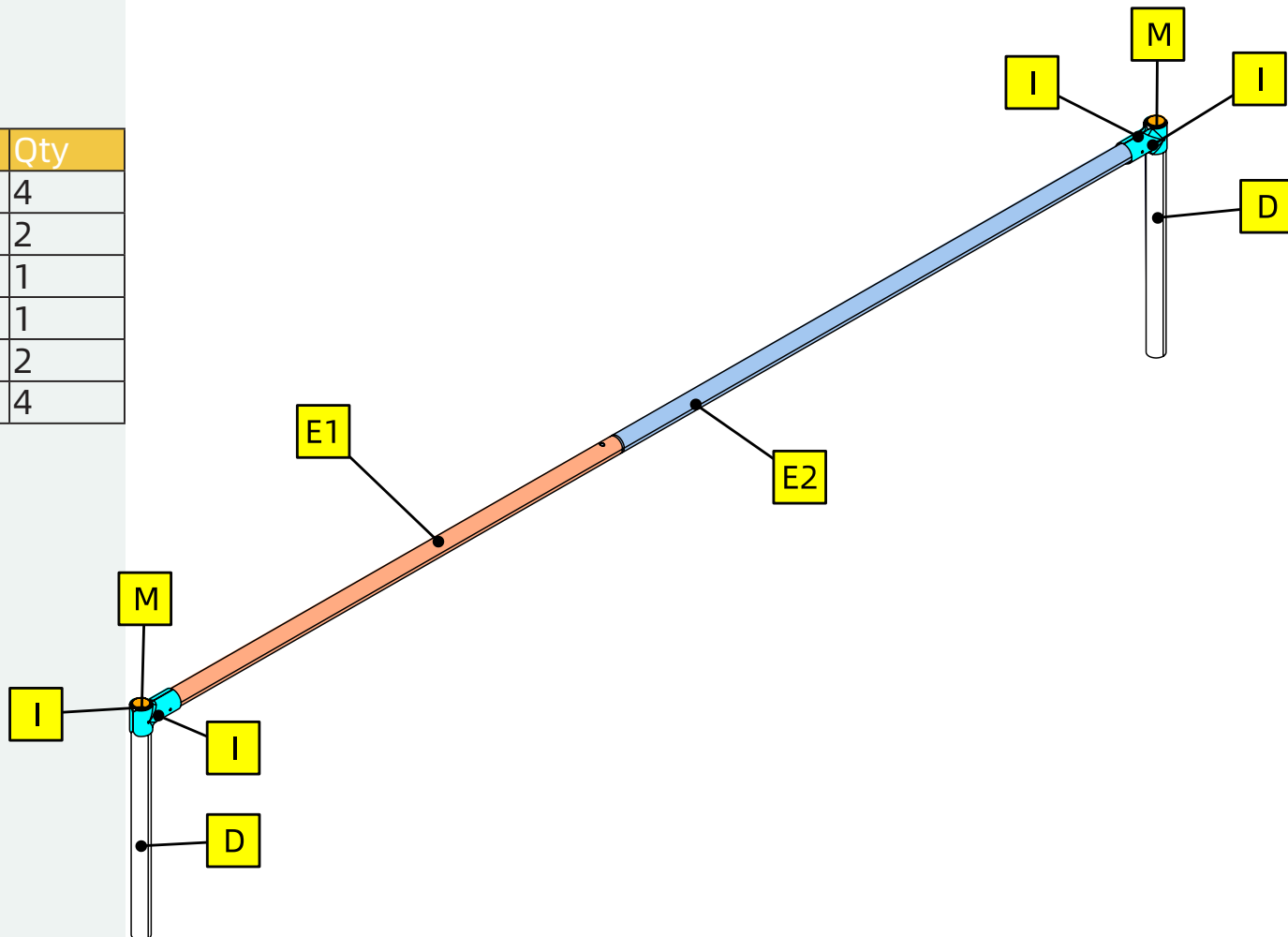

### Note

When attaching I to tube D, make sure the top edge of I is at the same level of the edge of D.  
Continued on next page for this step.

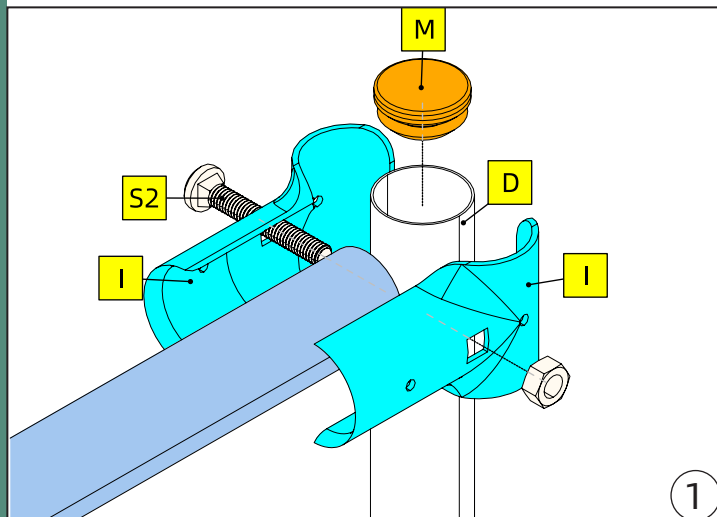

1

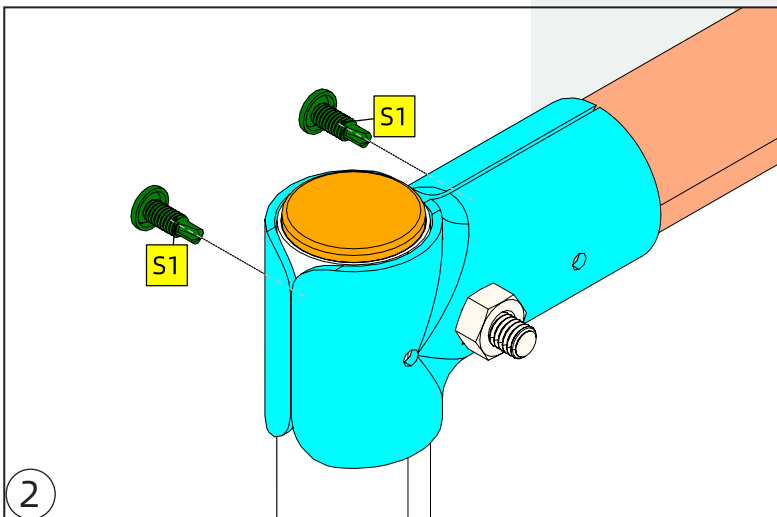

2

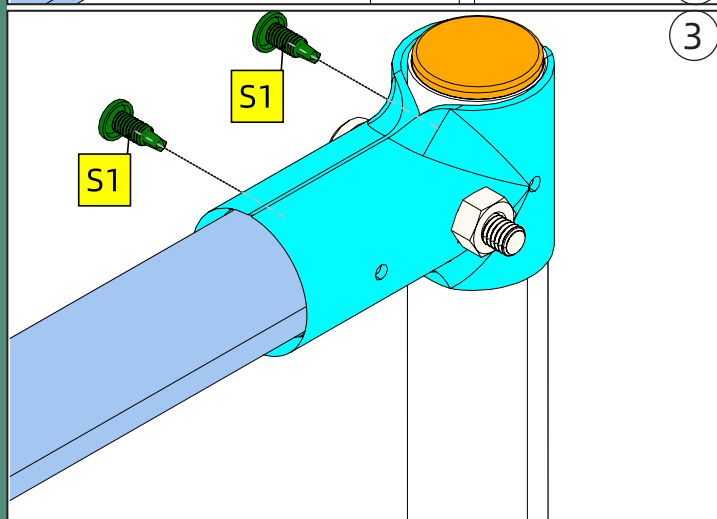

3

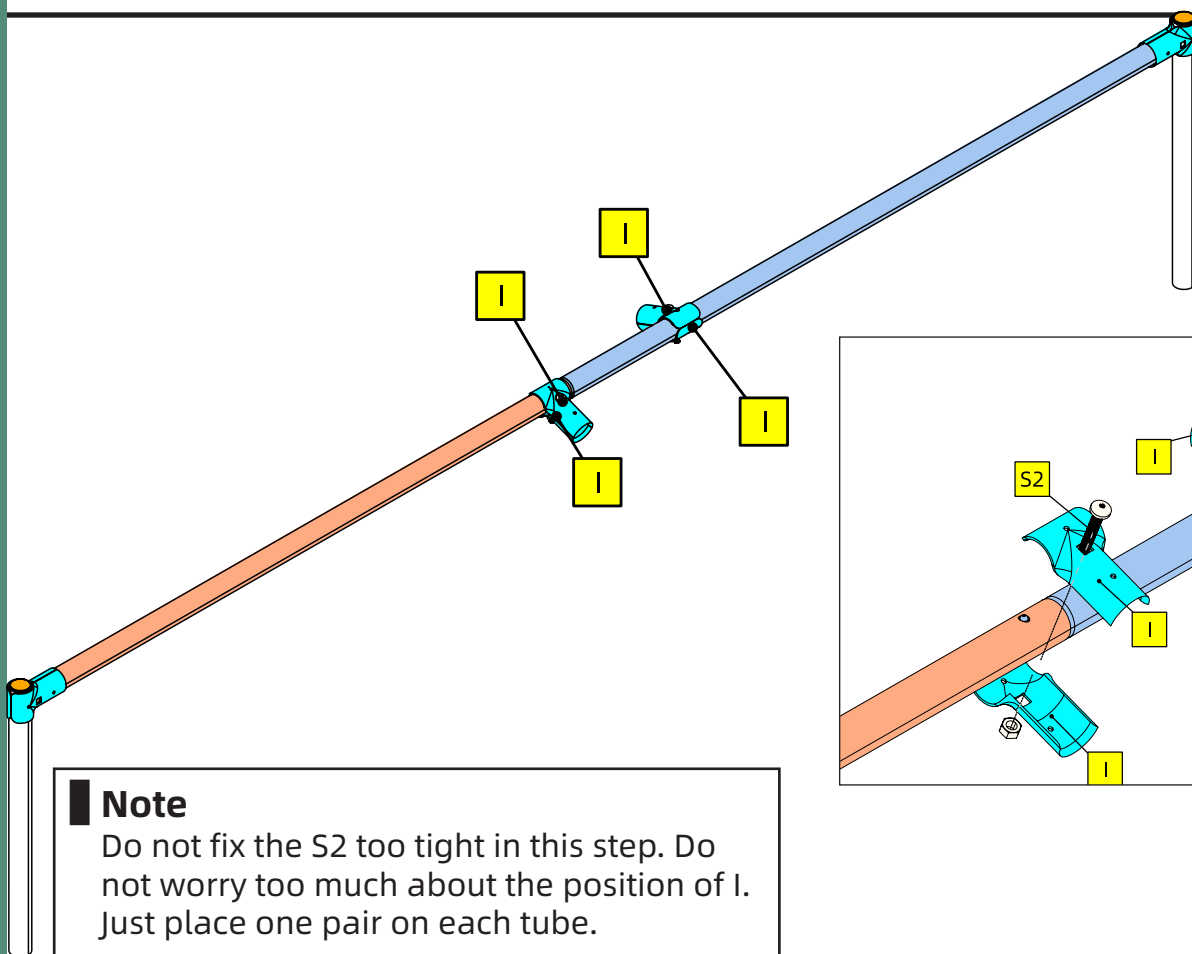

8

| Part | Qty |
|------|-----|
| I    | 4   |
| S2   | 2   |

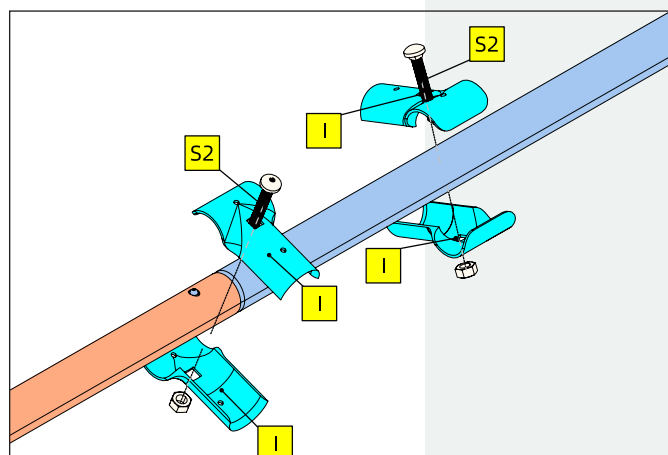

### Note

Do not fix the S2 too tight in this step. Do not worry too much about the position of I. Just place one pair on each tube.

| Part | Qty |
|------|-----|
| I    | 4   |
| S2   | 2   |

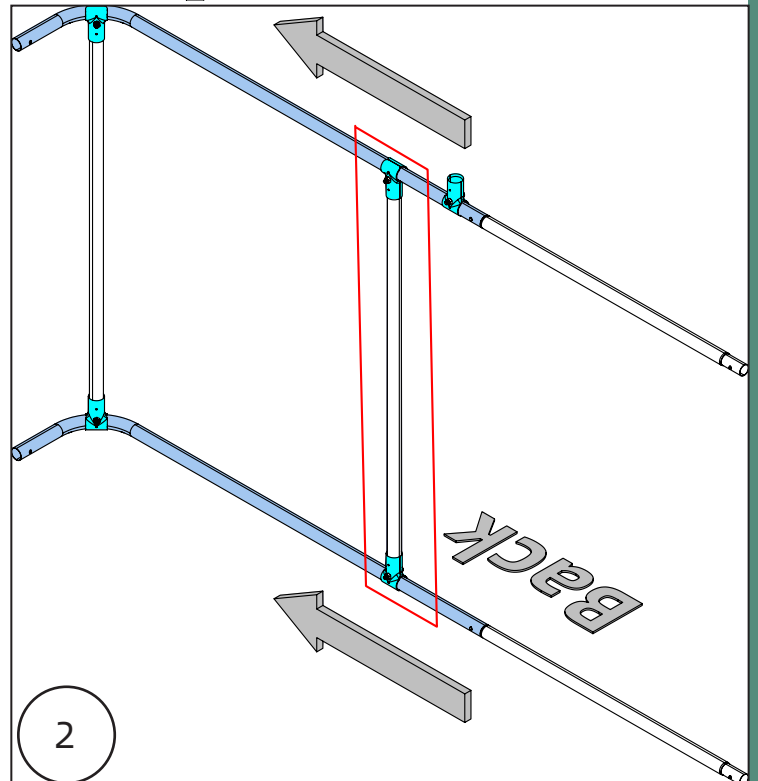
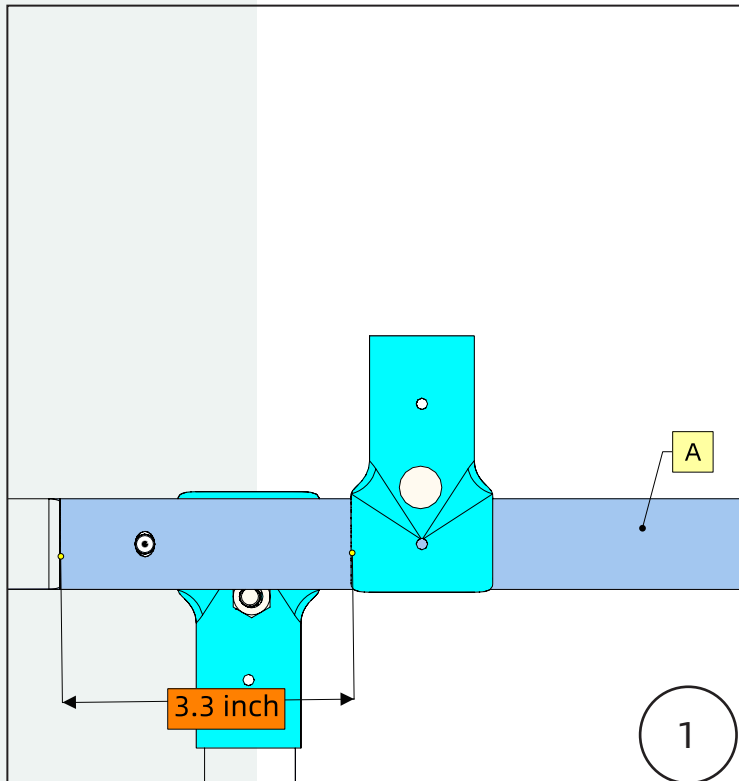
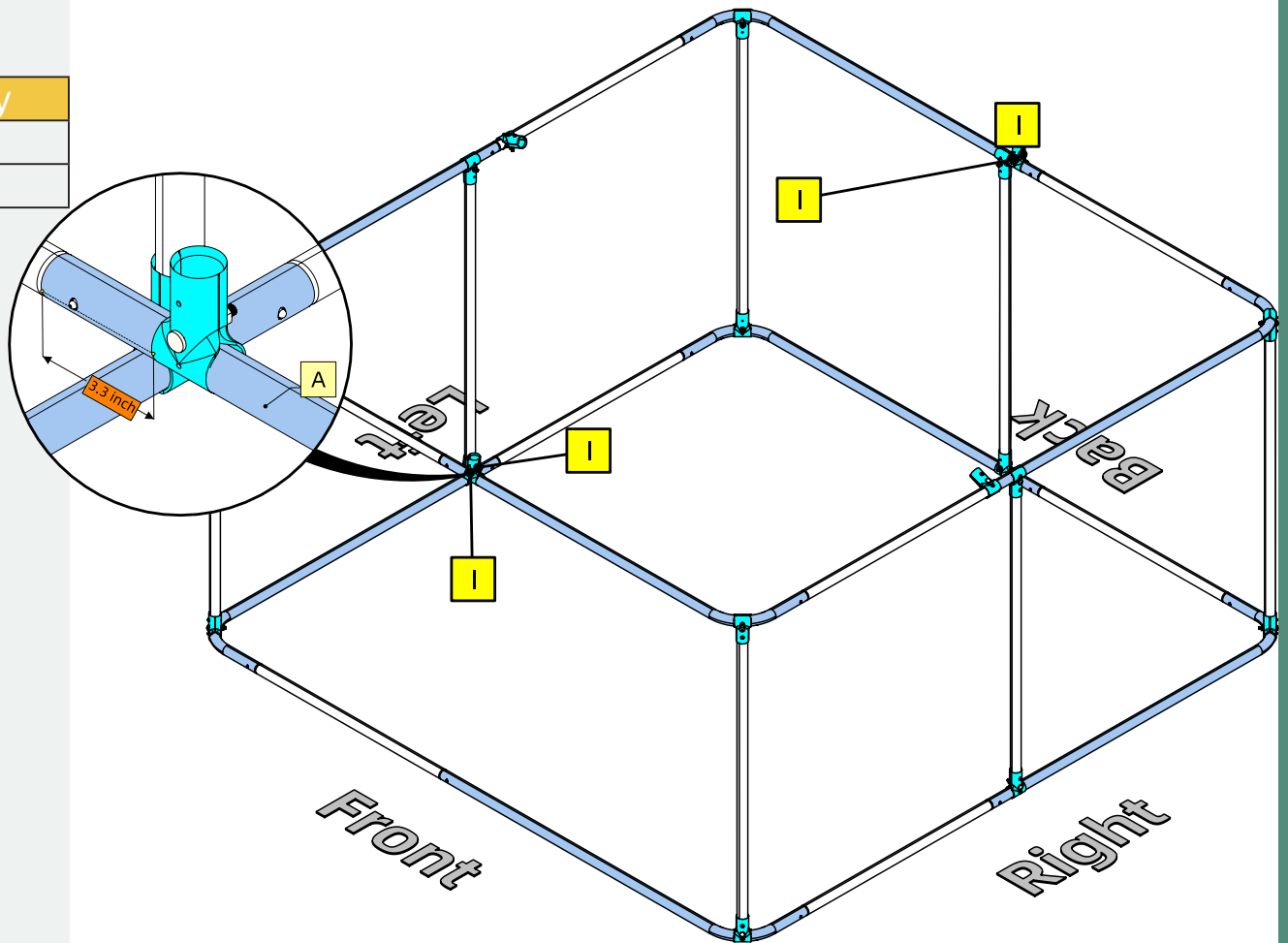

### Note

Do not fix the S2 too tight in this step. When attach I to tube A, make sure the left edge of I is about 3.3inch away from the edge of tube A. This applies to both pairs of I. If the pair of I at the back is in the way, slide the I, vertical tube away to the right, as shown in drawing 2.

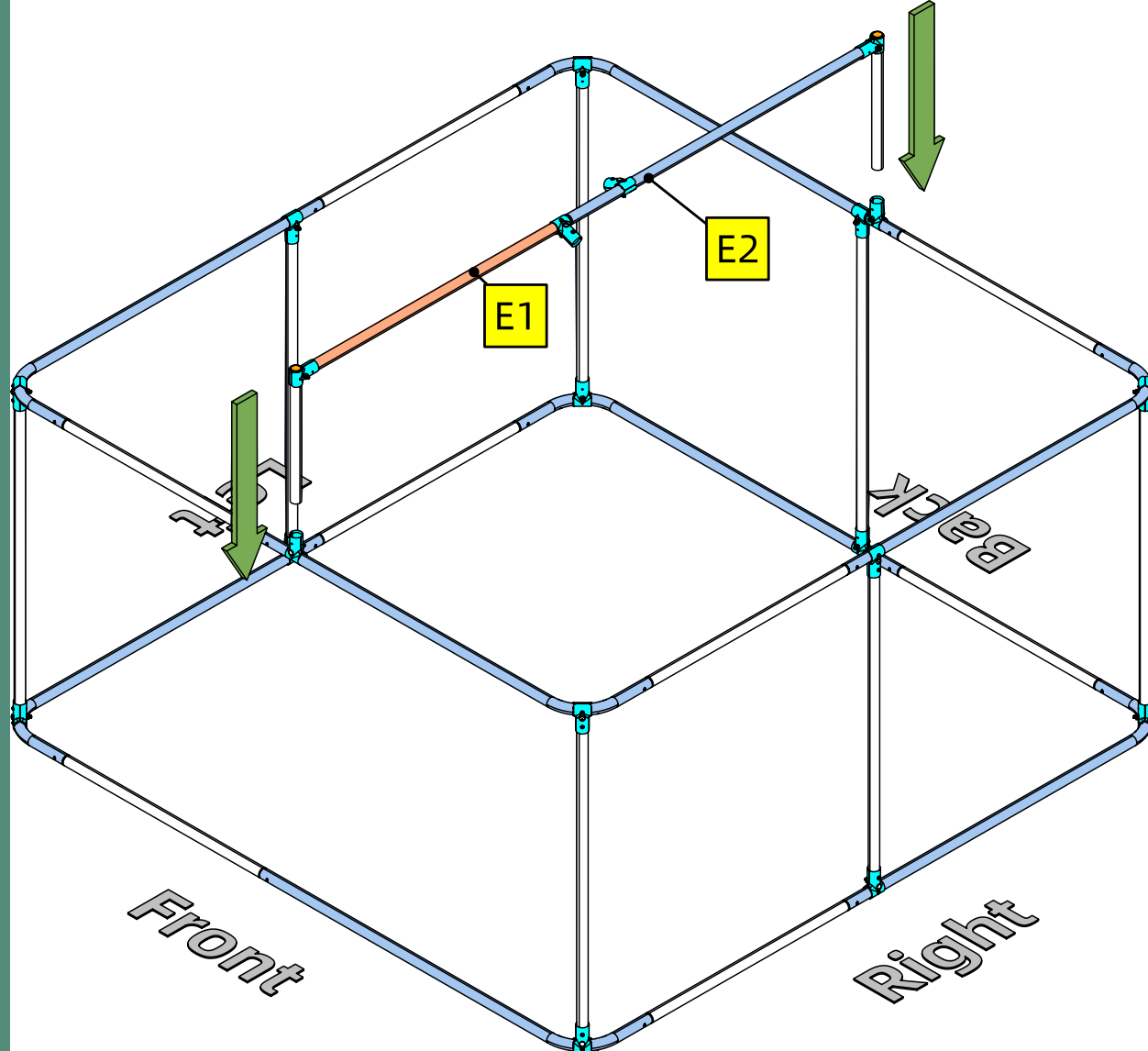

| Part  | Qty |
|-------|-----|
| E1+E2 | 1   |

**Note**

E1+E2 refers to the frame assembled in Step 7 and 8.  
DO Not use S1 in this step.

| Part | Qty |
|------|-----|
| I    | 4   |
| S2   | 2   |
| F    | 2   |

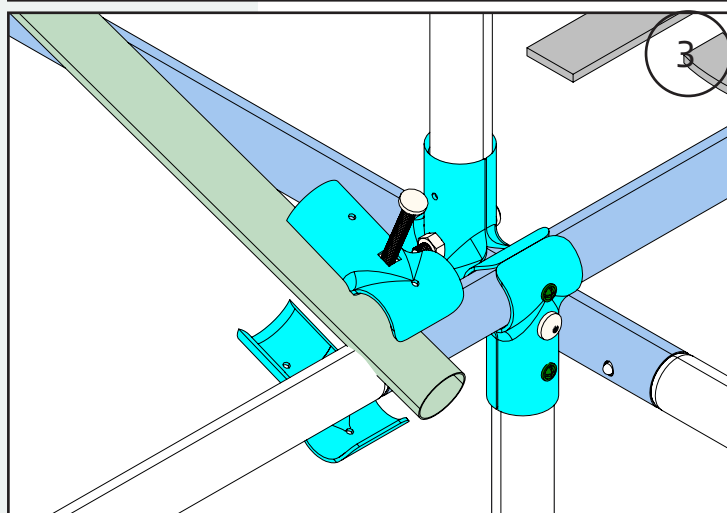
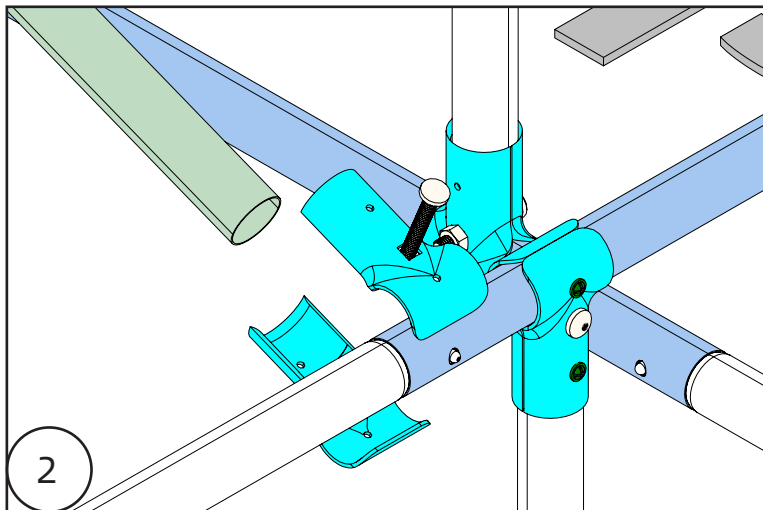
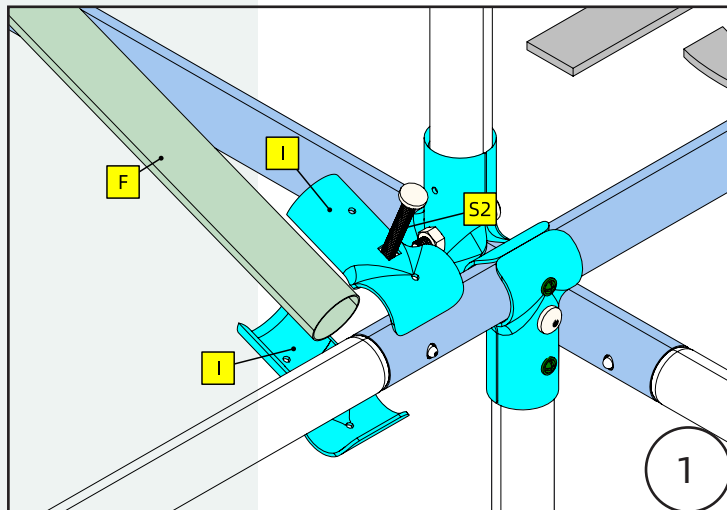
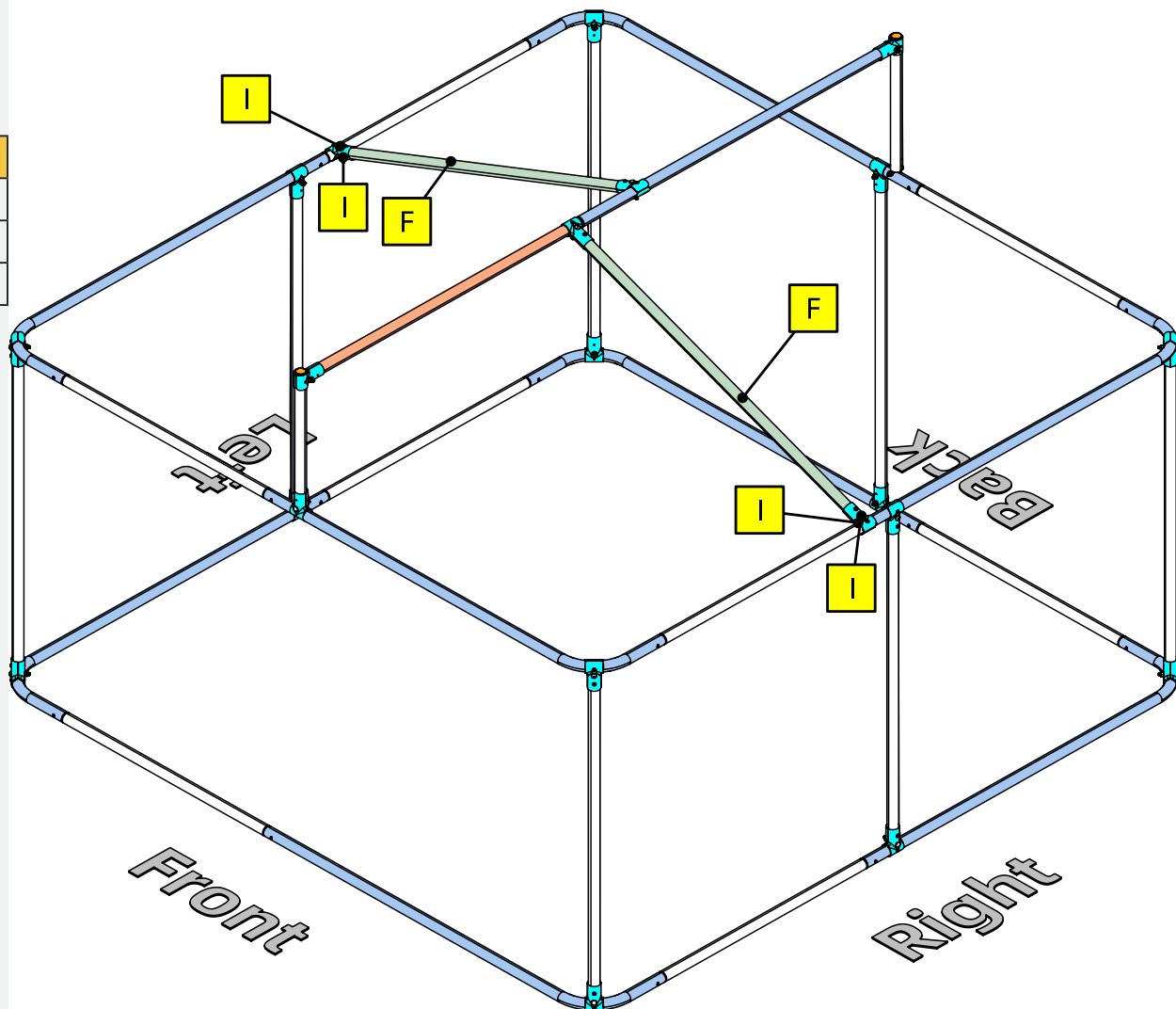

### Note

Align the two pairs of I to be assembled in this step with the two pairs of I on E1+E2, then slide the tube F inside.

Drawing 2 and 3 depict two situations where the F tube might be too long or too short.

These situations are caused by the incorrect location of I installed in Step 9. These situations are rare to happen but if they do happen, try slide the two pairs of I installed in step 9 together with the E1+E2 frame to left or right to adjust their location.

| Part | Qty |
|------|-----|
| Tarp | 1   |
| O    | 14  |
| S2   | 8   |

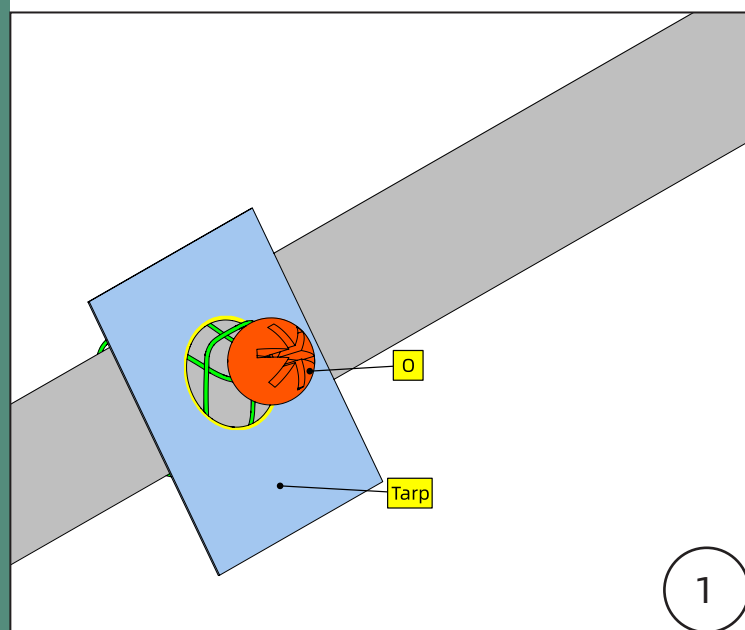
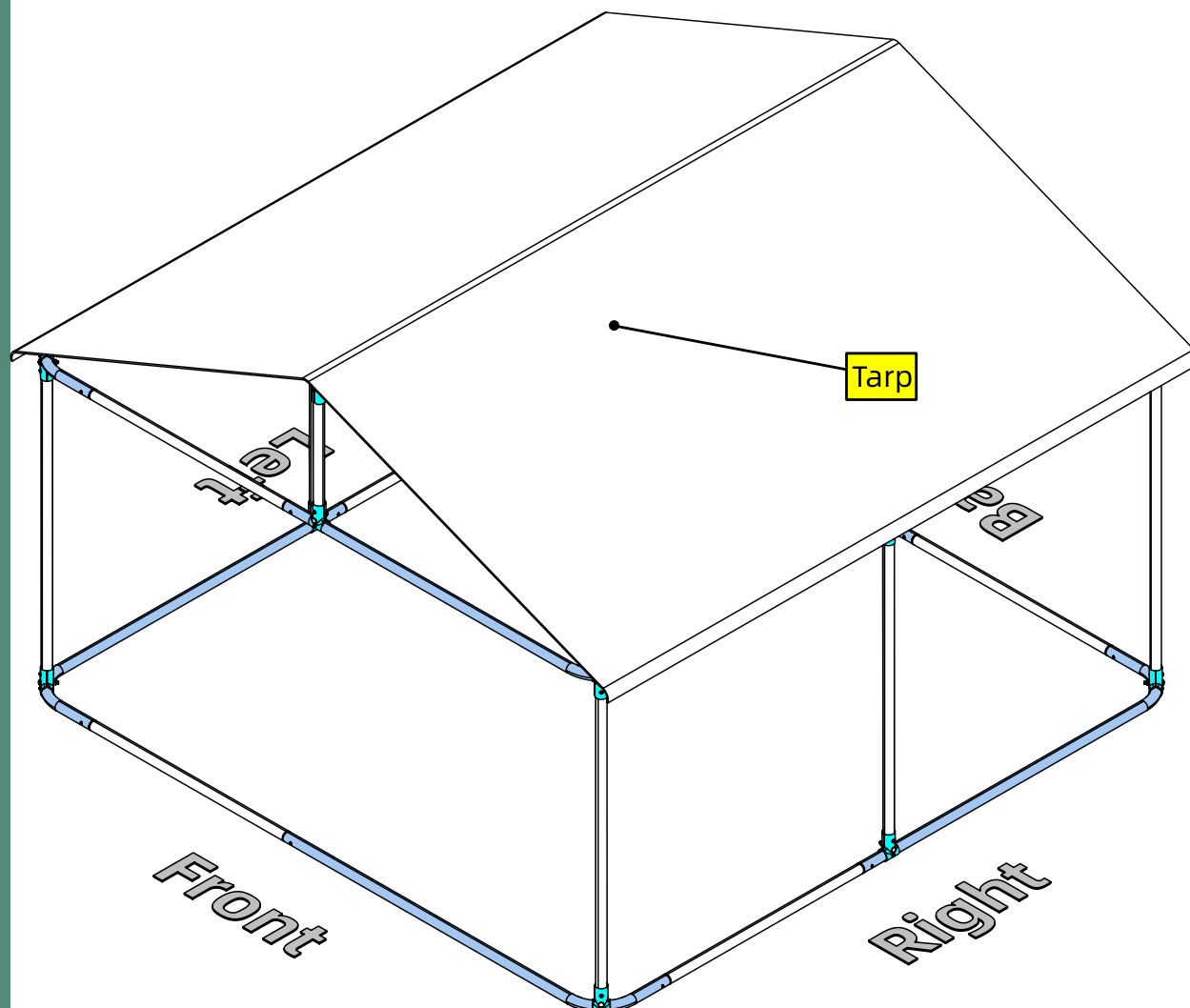

1

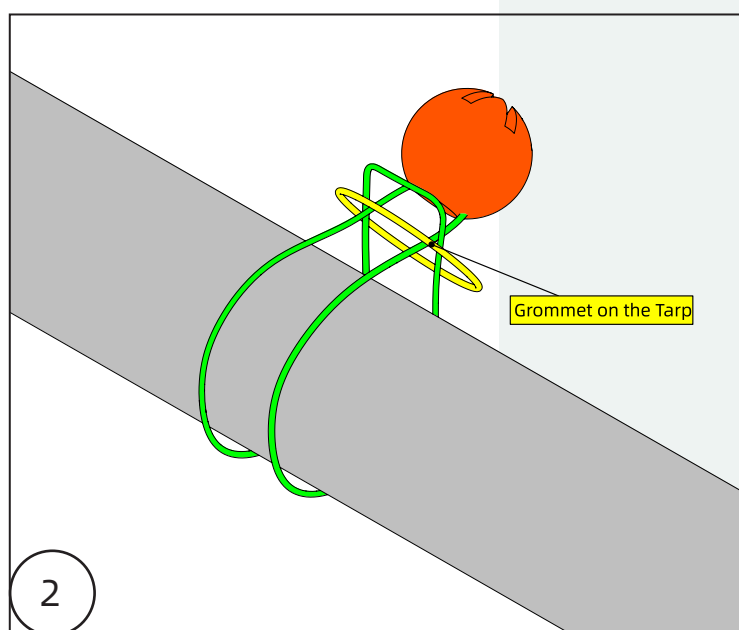

2

### Note

Drive eight S1 into the unused screw holes on I in last step.

Use bungee cords, Part No. O, to fasten the tarp onto the frame.

There are 14 grommets on the tarp, six on each side and one on the front and back.

Drawing 2 showcases how to knot the bungee cords.

| Part | Qty |
|------|-----|
| I    | 8   |
| S2   | 4   |
| S1   | 8   |
| M    | 4   |
| G    | 2   |
| H    | 2   |

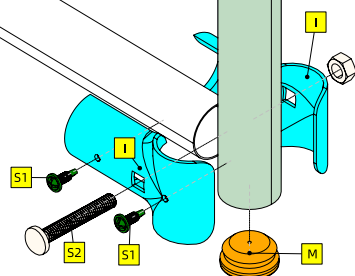
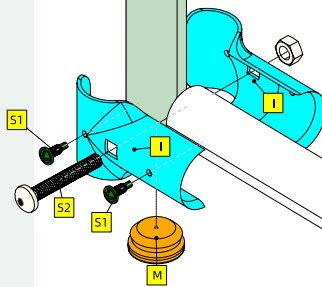
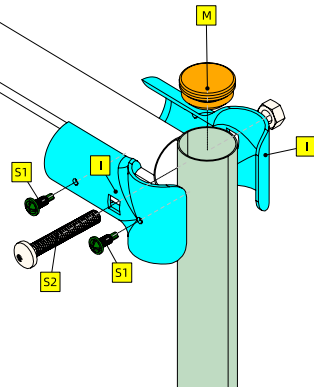
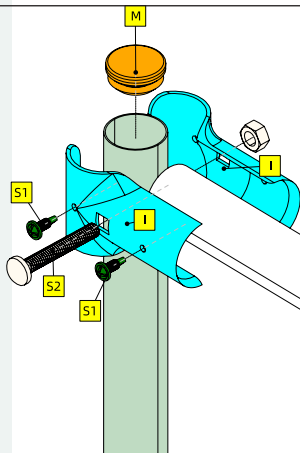
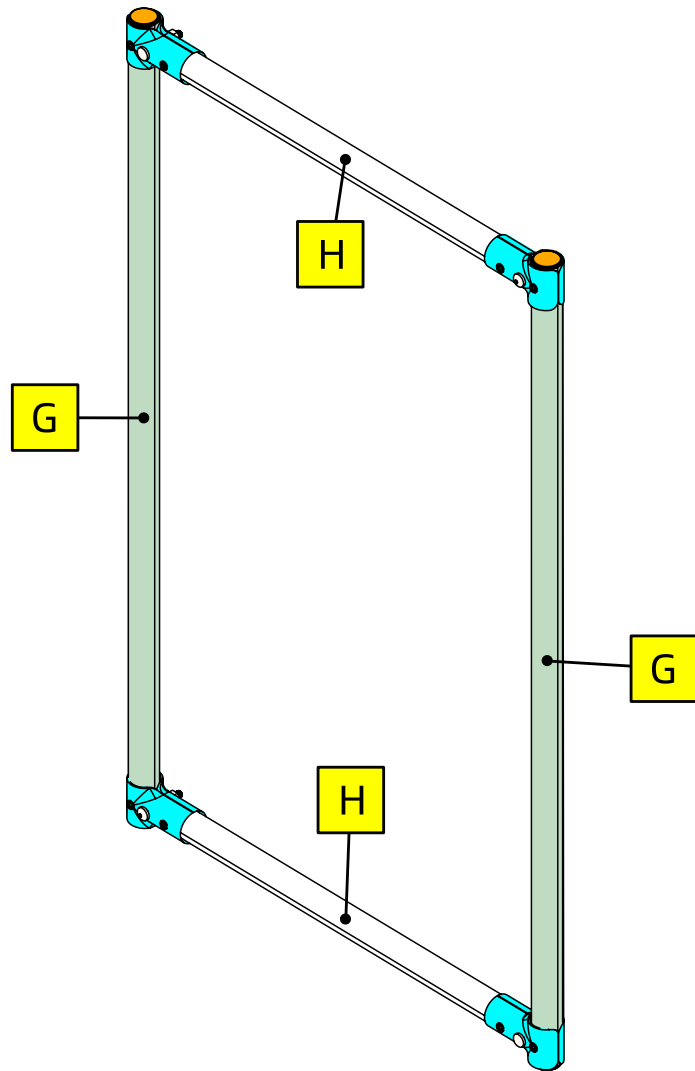

### Note

When attaching I to tube G, make sure the top edge of I is at the same level of the edge of G.



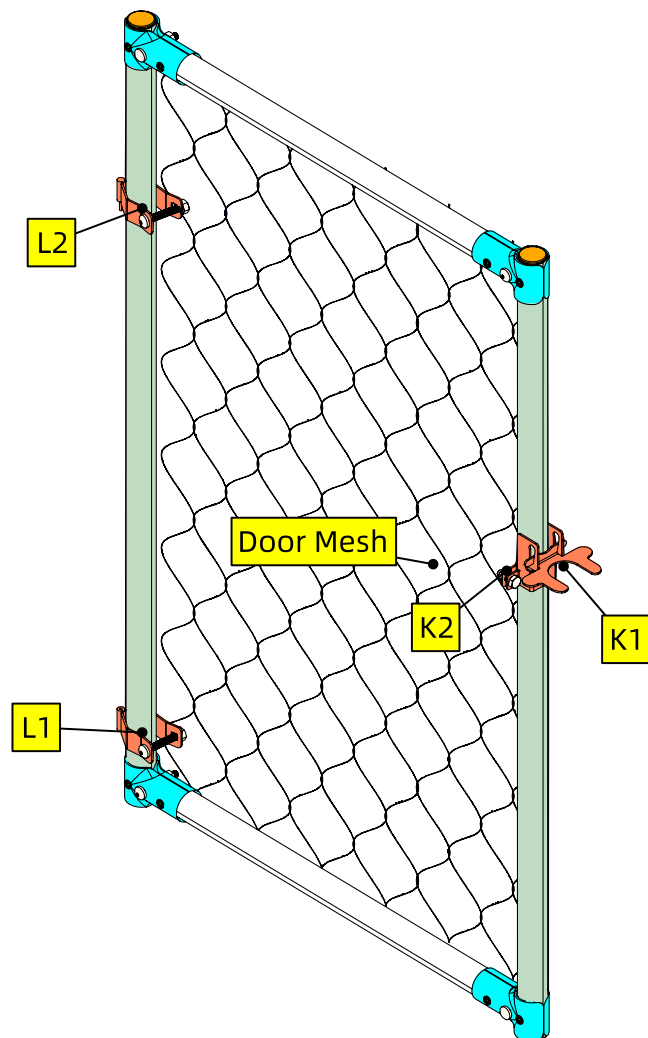

## Note

There are a bunch of steel spring wires, part N, in the package that can be used to fasten the door mesh to the four surrounding tubes. Zip ties, part No. P, can also be used in this step.

For L1 and L2, the location does not matter too much. Make sure that the shaft of L2 points downwards, and the hole of L1 is on top of L1. Tighten the nut of S2 to fasten L1 and L2 to the vertical tube.

S3 uses the same nut as S2.

| Part      | Qty |
|-----------|-----|
| L1        | 1   |
| L2        | 1   |
| S2        | 2   |
| K1        | 1   |
| K2        | 1   |
| S3        | 2   |
| N         |     |
| P         |     |
| Door Mesh | 1   |

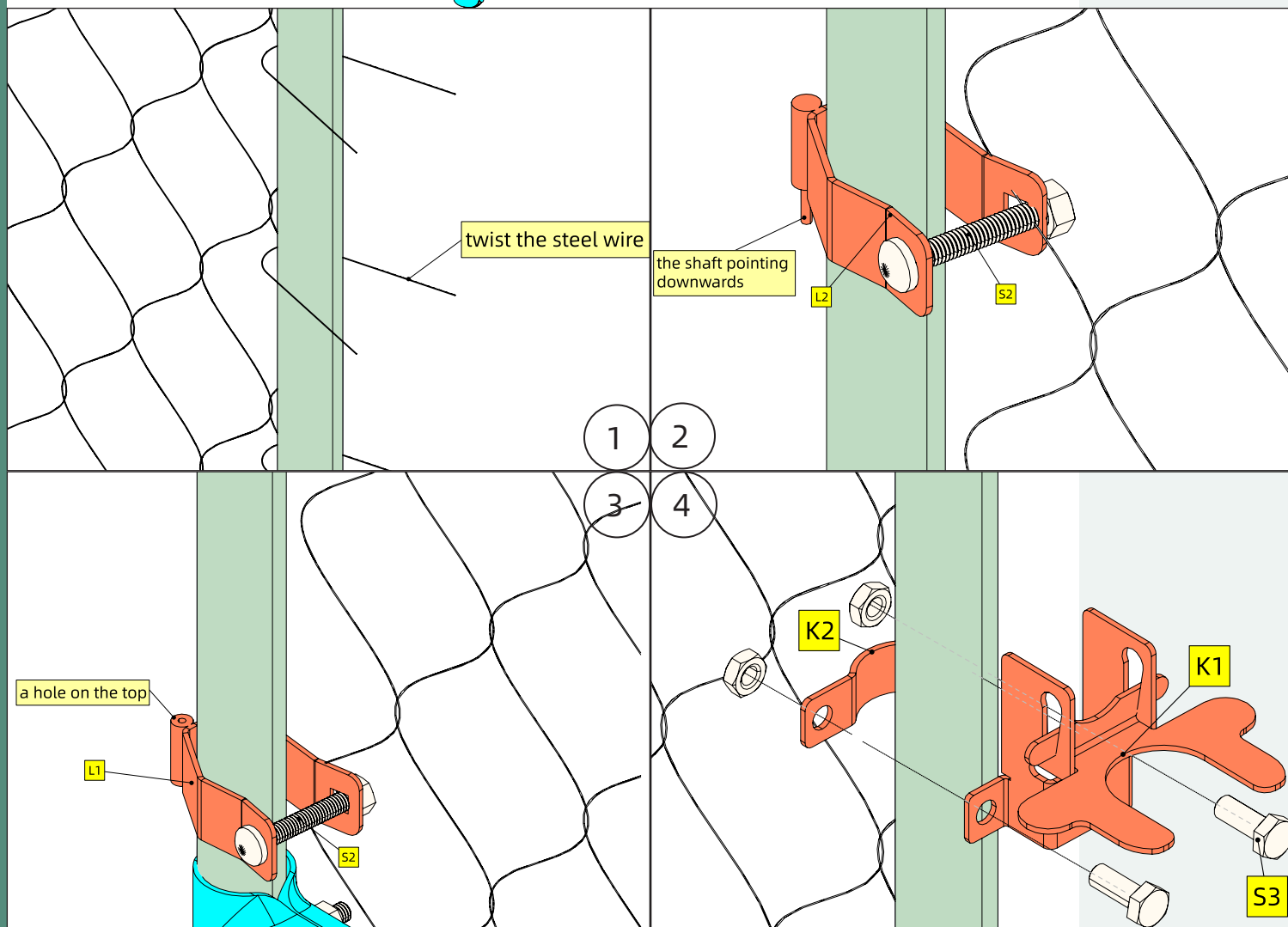

| Part      | Qty |
|-----------|-----|
| Wall Mesh | 1   |
| N         |     |
| P         |     |

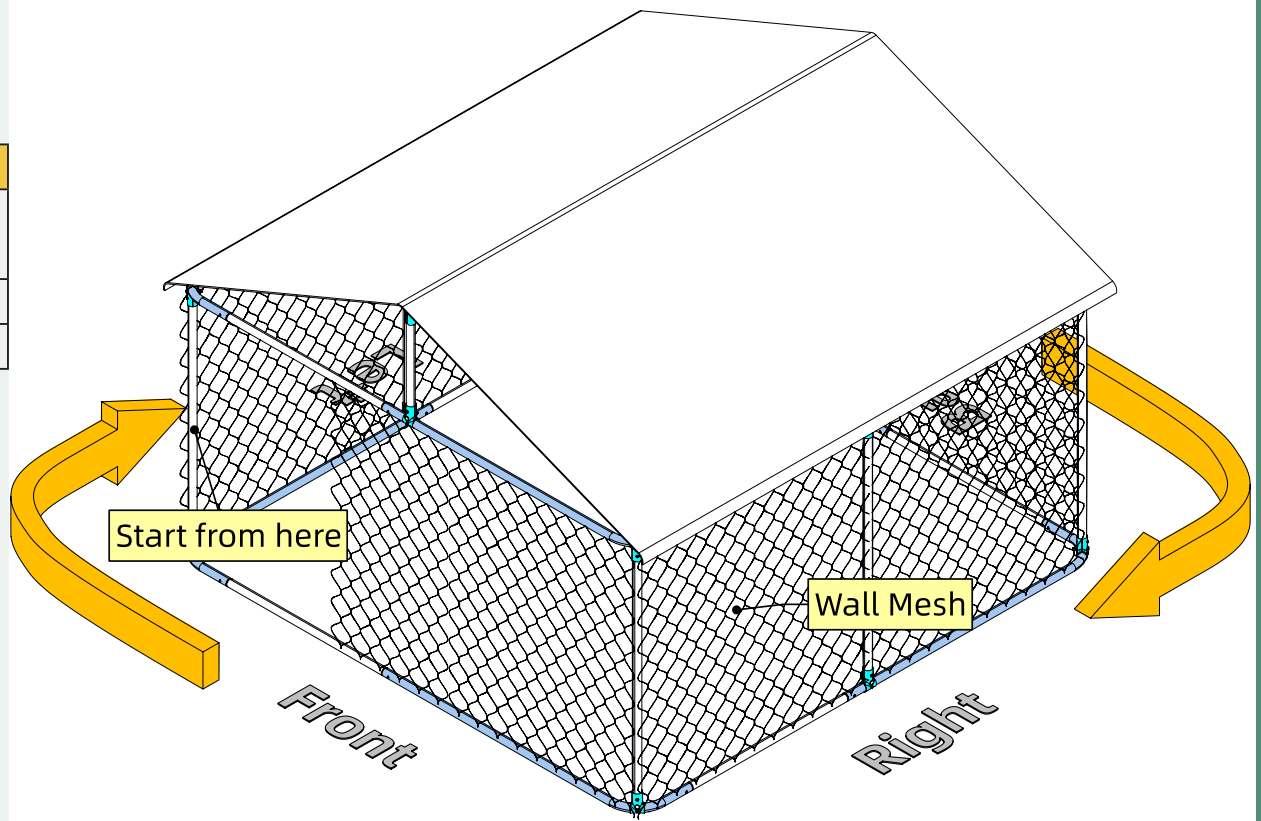

### Note

Start from the left tube at the front, and roll the wall mesh to the front.

Similar to the door mesh, use N and P to fasten the wall mesh to the tubes.

The arrow indicates the flow of the mesh.

You will have an open side at the front, which will be fixed later.

Do not pre-cut the mesh.

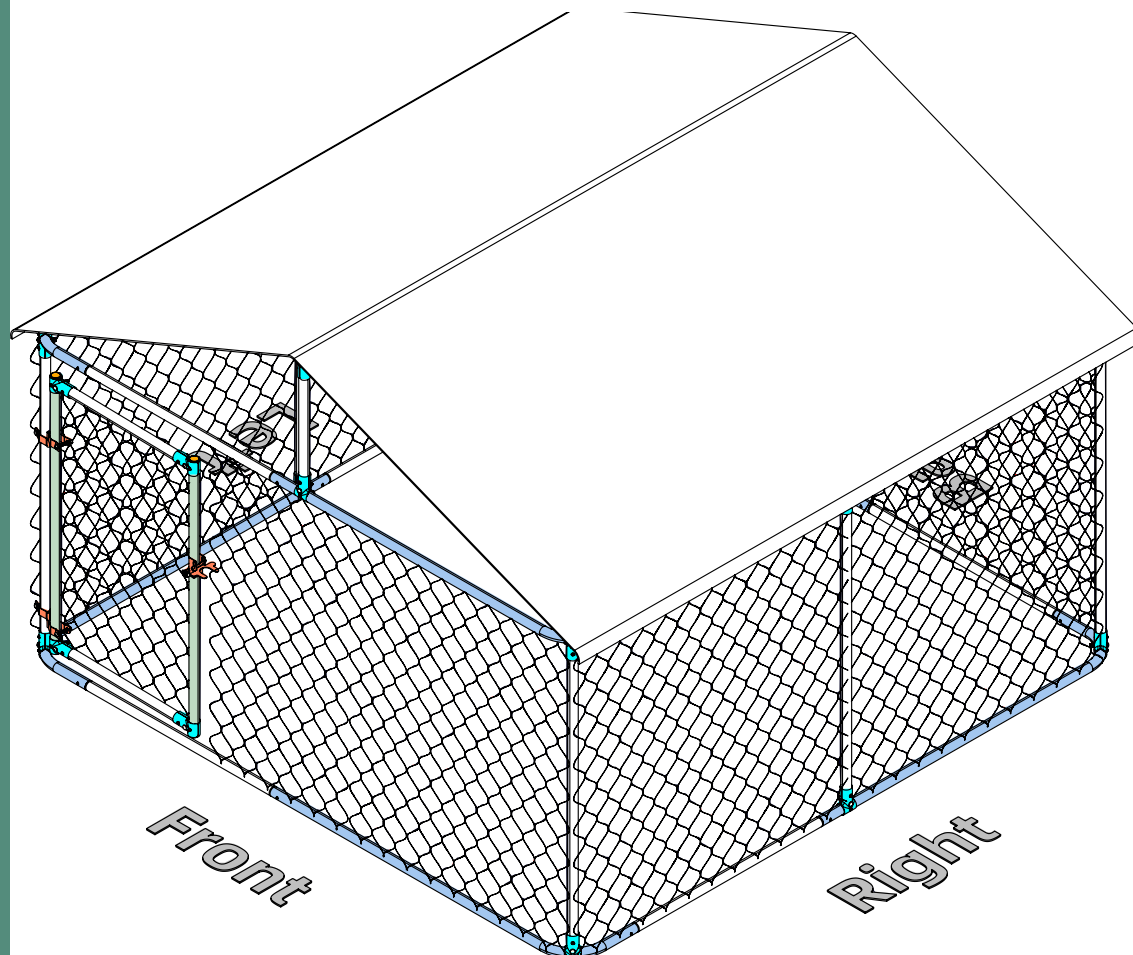

| Part | Qty |
|------|-----|
| L1   | 1   |
| L2   | 1   |
| S2   | 2   |

### Note

The location of L1 and L2 in this step is determined by the location of L1 and L2 in step 14. Tighten S2 to secure L1 and L2. Make sure you are positioning L1 and L2 correctly.

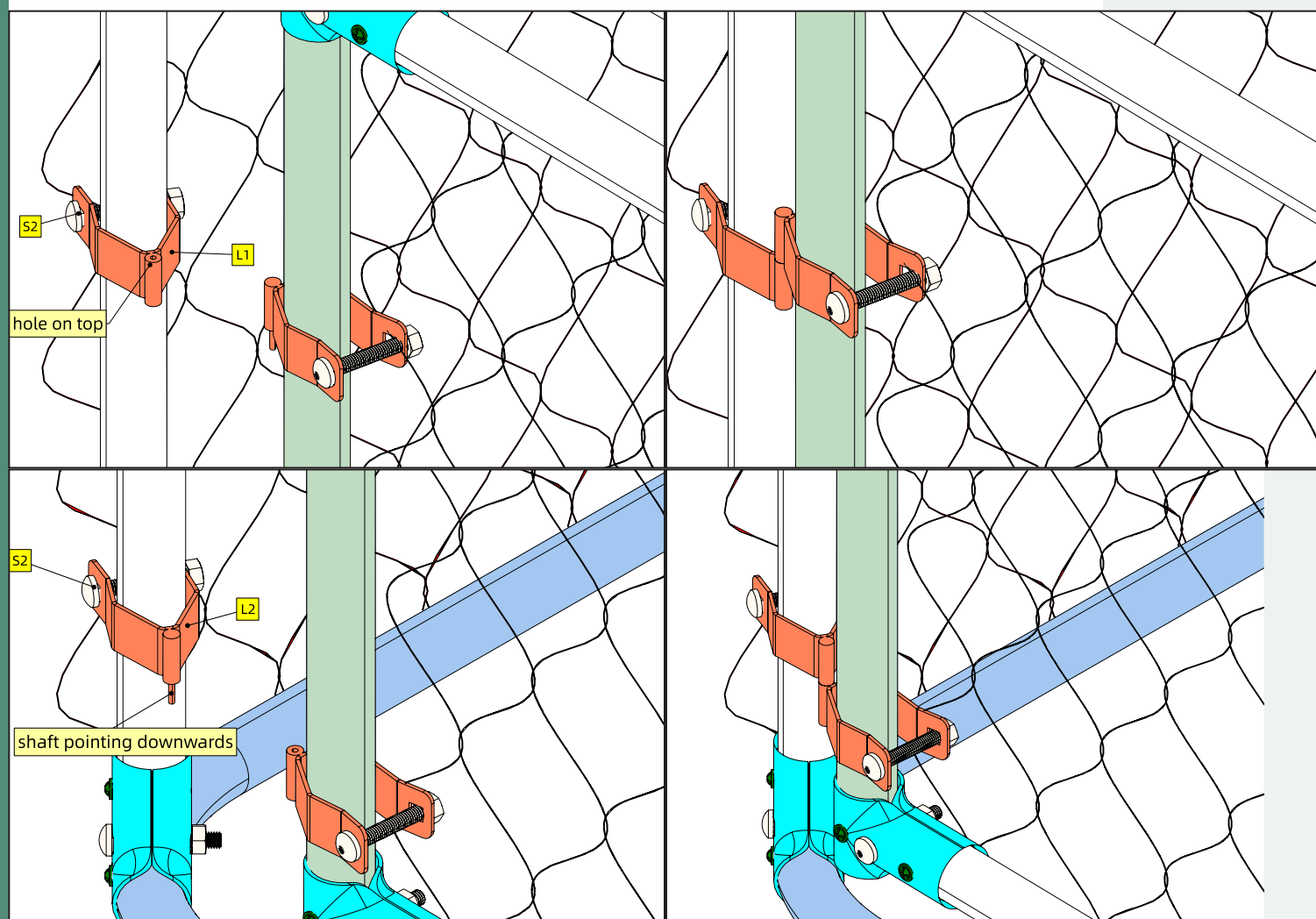

| Part | Qty |
|------|-----|
| C    | 1   |
| I    | 4   |
| S1   | 4   |
| S2   | 2   |
| N    |     |
| P    |     |

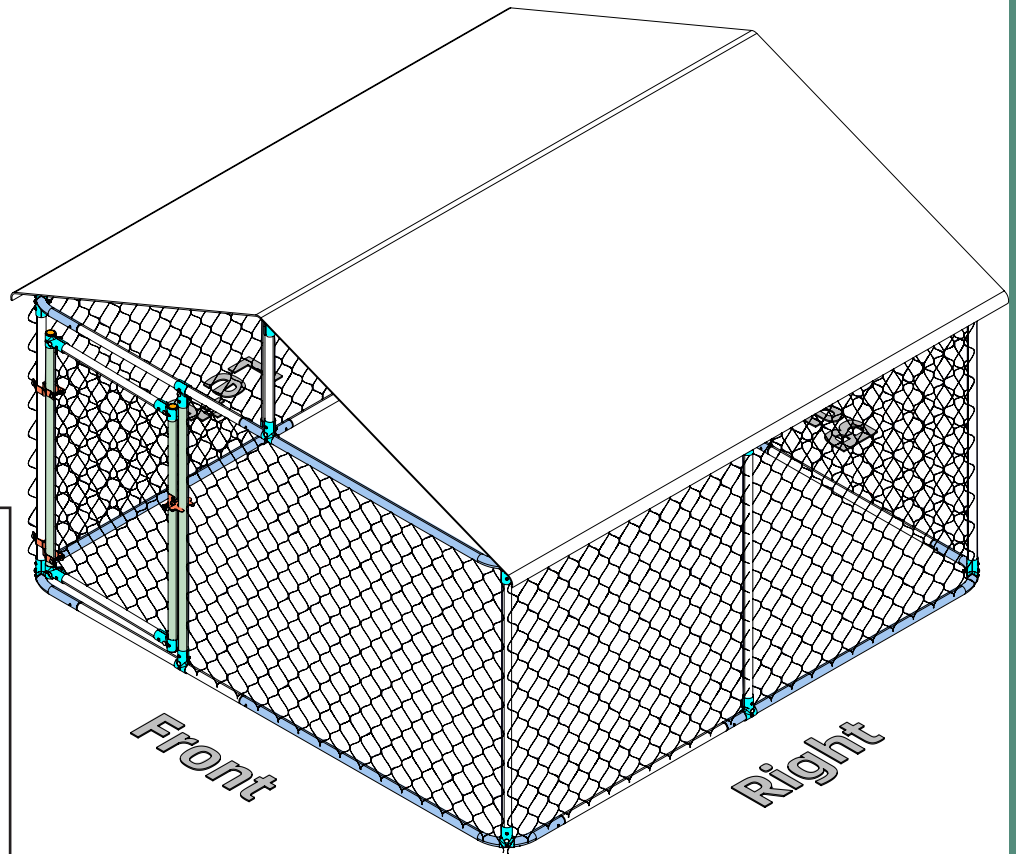

### Note

To find a good position for tube C, make sure it sits inside the gap of K1 and K1 can lift up easily. Then secure C to the rest of the frame using I and S1 S2. After C is secured, tie the rest of the wall mesh to C.

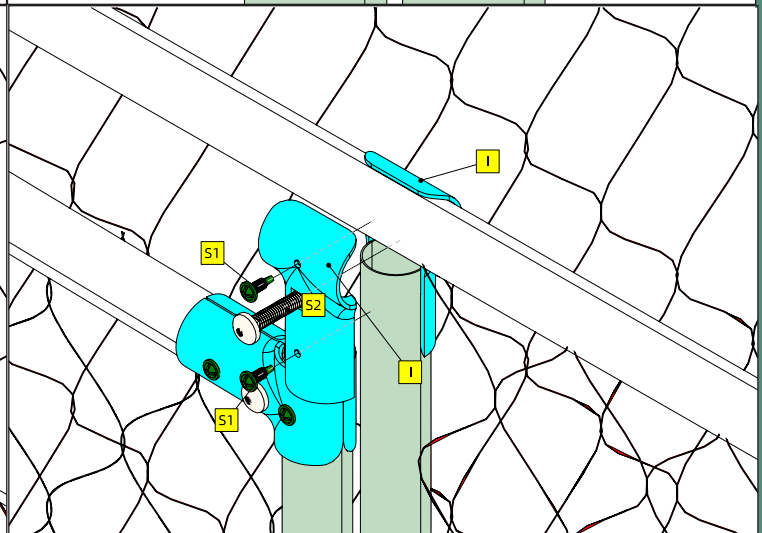
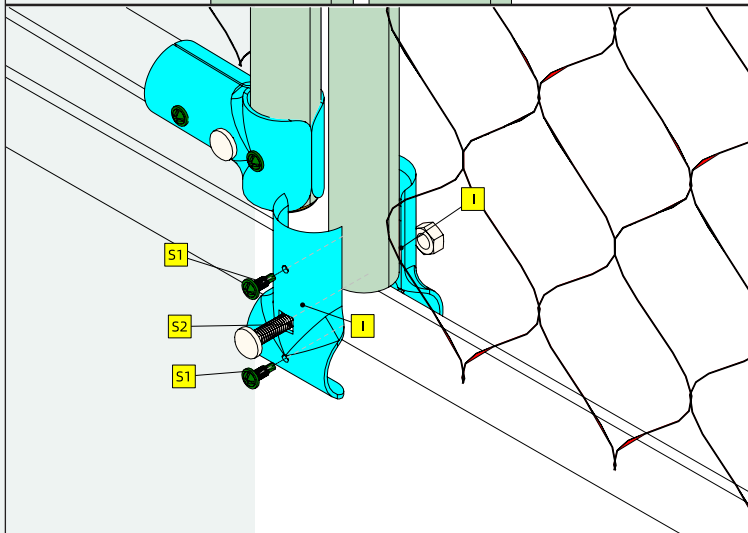
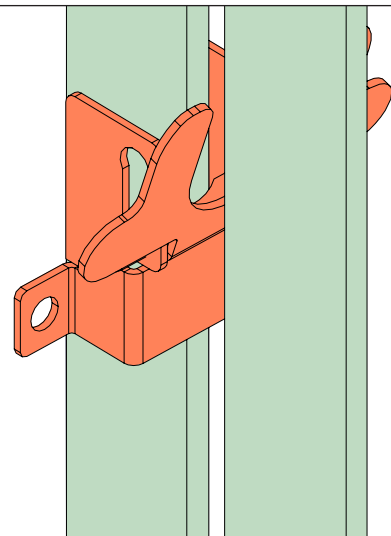
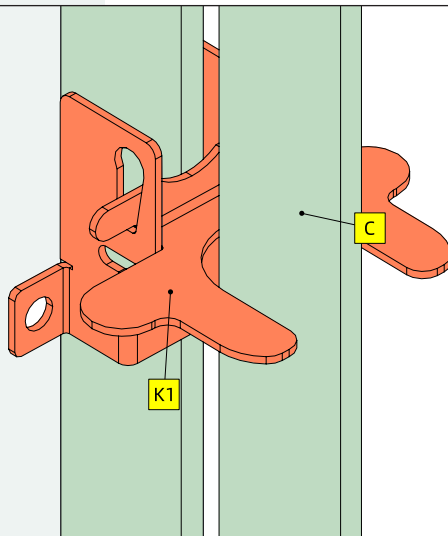

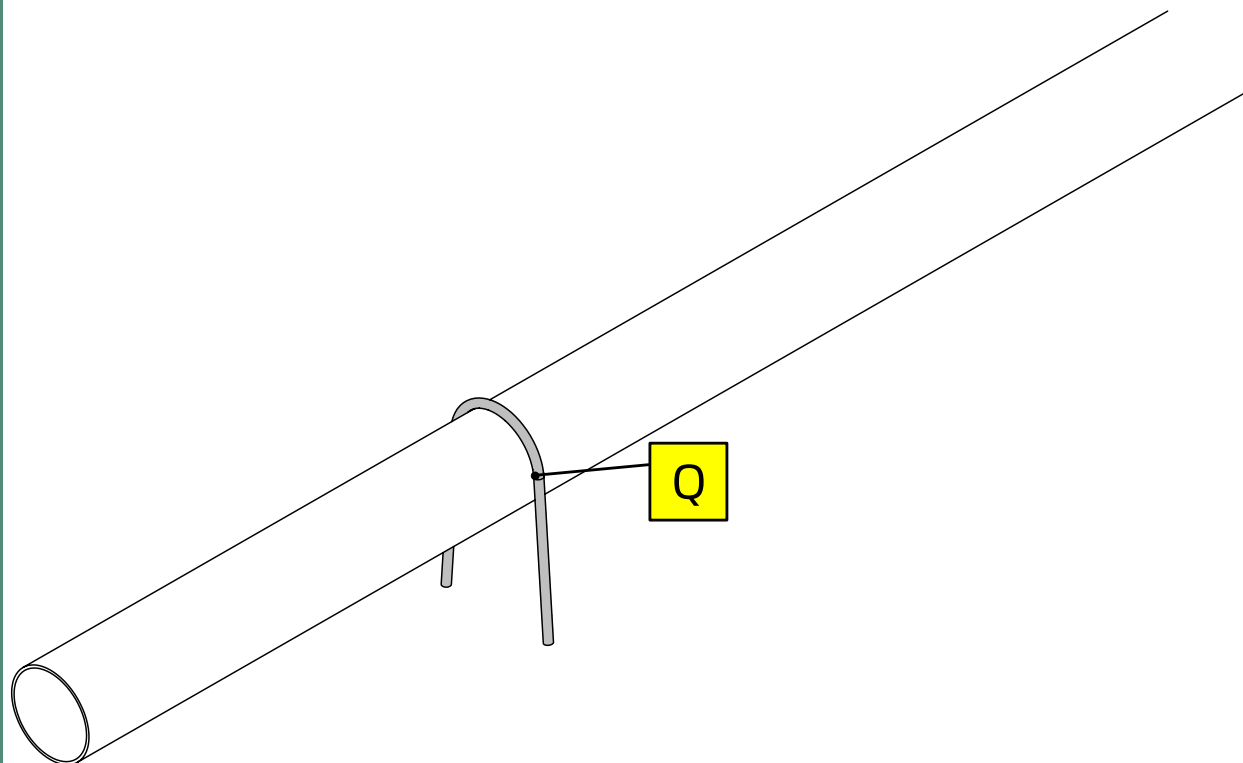

| Part | Qty |
|------|-----|
| Q    | 8   |
| S1   | 8   |

### Note

Use Q to secure the whole kennel frame into the ground. There are 8 anchor stakes, Part No. Q in the package. We suggest putting four in four corners and four at four sides.

Check the frames and see if there are screw holes on I left unused. If you follow the steps closely, there should be four on the pair of I at the back, and four on the roof part.

Congratulations, you have finished the assembling.