

# *ASSEMBLY INSTRUCTIONS*

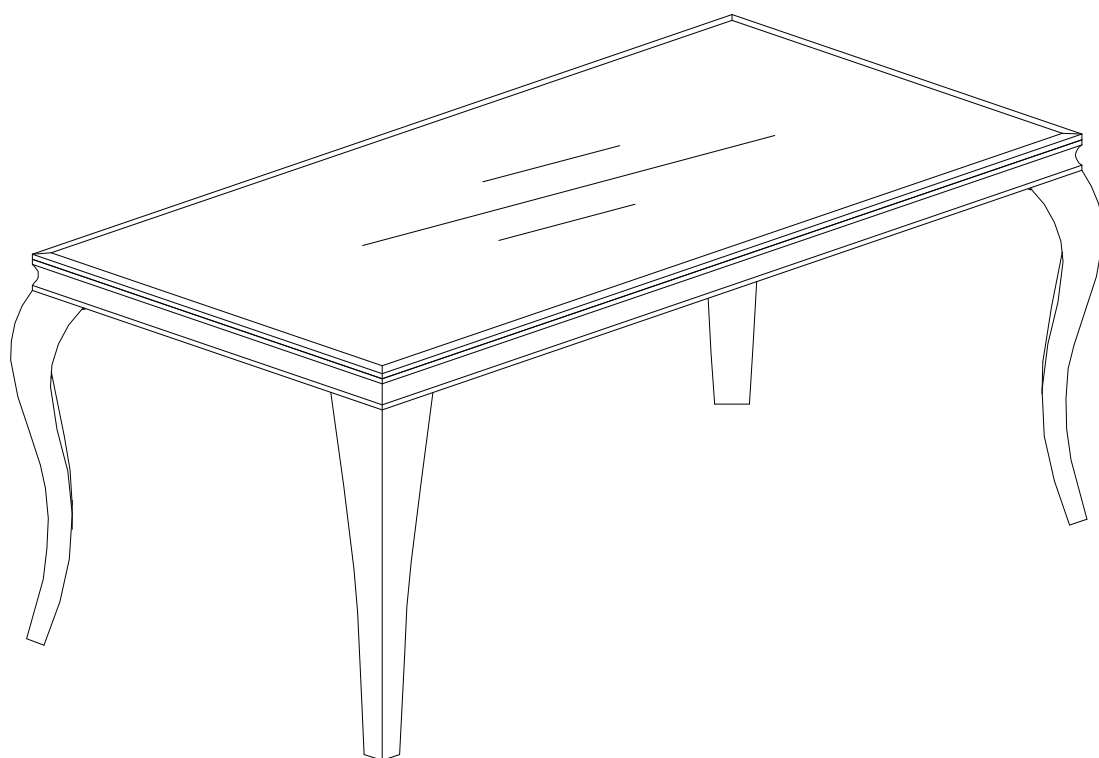

*Dining Table*

# ASSEMBLY INSTRUCTIONS

## ASSEMBLY TIPS:

- 1. Remove hardware from box and sort by size.
- 2. Please check to see that all hardware and parts are present prior to start of assembly.
- 3. Please follow attached instructions in the same sequence as numbered to assure fast & easy assembly.

**WARNING!**

- 1. Don't attempt to repair or modify parts that are broken or defective. Please contact the store immediately.
- 2. This product is for home use only and not intended for commercial establishments.

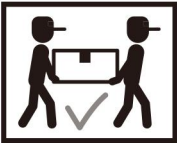

ASSEMBLY TIME

10 MINUTES

## PARTS IDENTIFICATION

### B1(BOX 1)

A GLASS

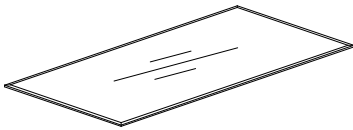

1PC

B TOP FRAME

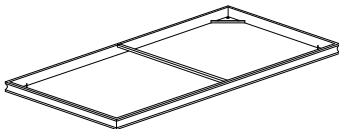

1PC

C LEG



4PCS

## Z HARDWARE IDENTIFICATION

### B3(BOX 3)-HARDWARE PACK IS LOCATED IN 105071(B3)

1 BOLTS M10\*12

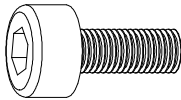

12PCS

2 FLAT WASHER Ø10\*20

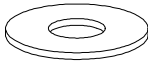

12PCS

3 ALLEN WRENCH 8MM

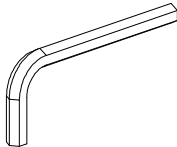

1PC

4 GLASS REST

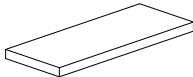

8PCS

ASSEMBLY INSTRUCTIONS

STEP1

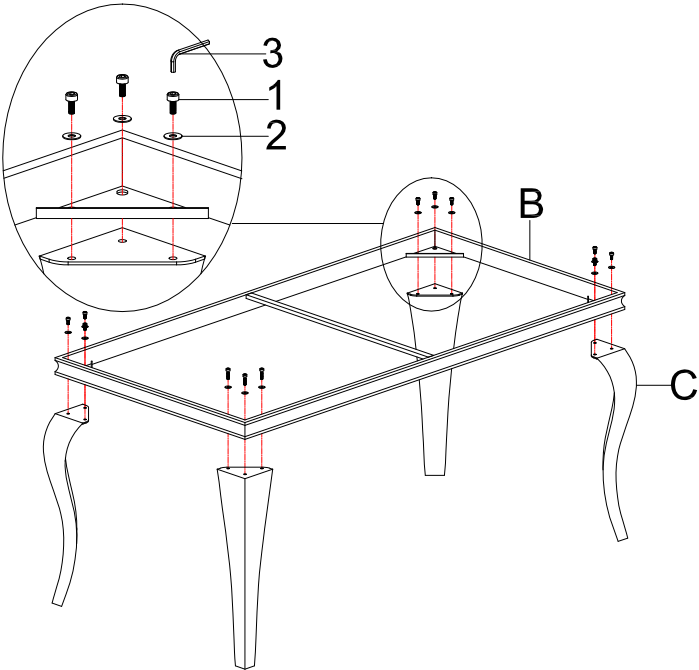

STEP2

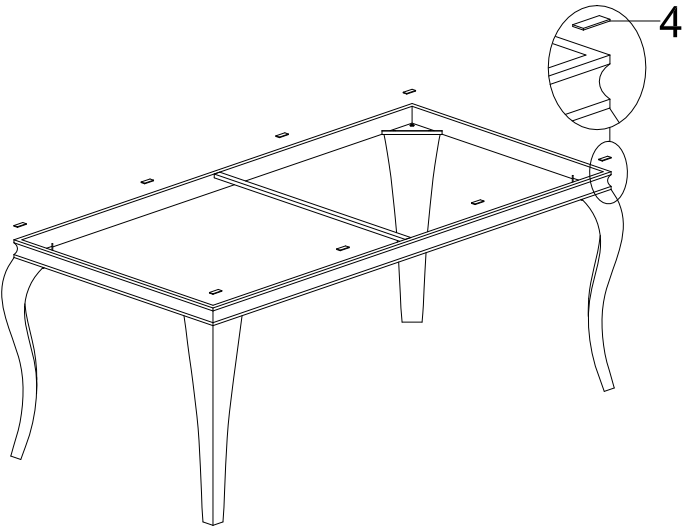

STEP3

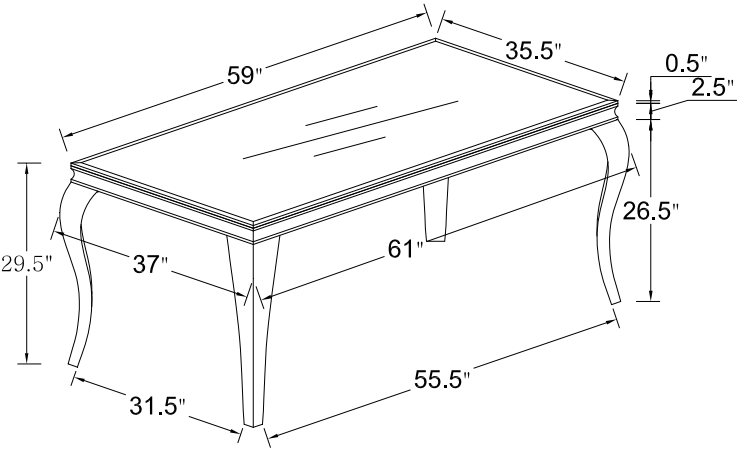
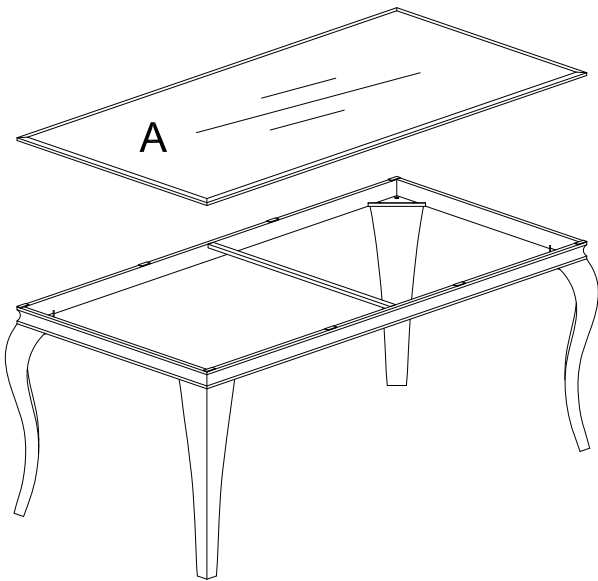

NOTE :DIMENSION TOLERANCE  $\pm 5\%$