

# BOOKCASE & STORAGE UNIT

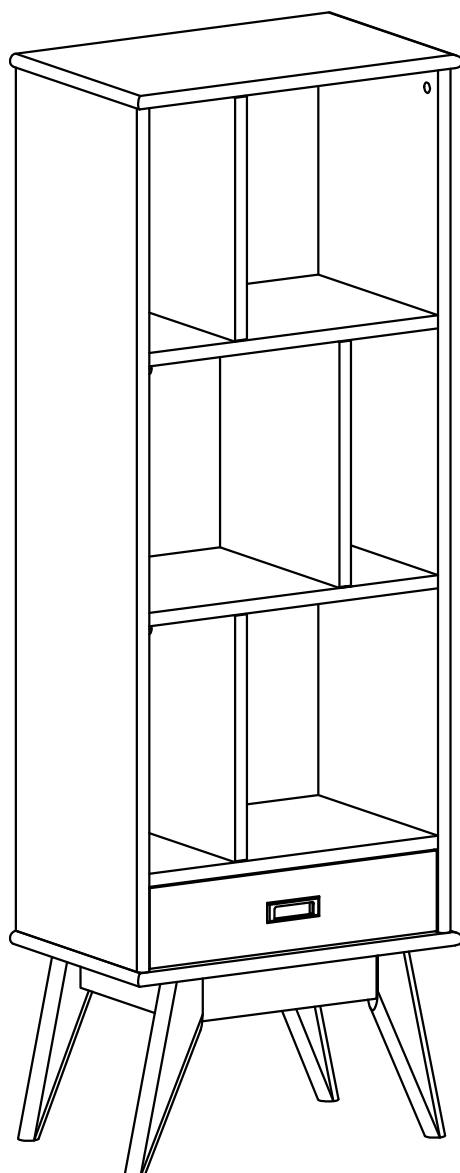



FOR REPLACEMENT PARTS OR HELP WITH  
ASSEMBLY PLEASE CONTACT US  
PLEASE ENSURE TO HAVE THE MODEL #  
FROM THE PACKAGING OR INSTRUCTION BOOKLET  
  
TO RETURN THE PRODUCT:  
PLEASE CONTACT THE RETAILER  
WHERE THE ITEM WAS PURCHASED FROM

**IMPORTANT :** Please read this manual carefully before beginning assembly of this product. Keep this manual for future reference.

## SAFETY INFORMATION

**CAUTION:** Injuries and damage can occur from furniture tip over if product is not properly anchored to the wall. Use the Furniture Anti-Tipping Restraint provided with the product. Consult our assembly instructions for help. If the Furniture Anti-Tipping Restraint kit is not in the box, please contact our customer service department in order to obtain another kit before using the furniture.

Identify all the parts and hardware. Do not discard of the packaging until you have checked that you have all of the parts and hardware required. Hardware package may have spare parts.

**WARNING:** This item contains small parts which can be swallowed by children and pets. Keep children and pets away during assembly. To avoid danger of suffocation, always keep plastic bags away from children and pets. We recommend that you assemble this unit on a carpeted floor to avoid scratches. If using power tools, set the tool to low torque to avoid damage.

**May require 2 people for ease of assembly.**

## CARE and MAINTENANCE

To clean, use a soft or slightly damp cloth, then wipe with a clean, dry cloth. Dust with soft dry cloth.

Do not use ammonia-based cleaning products, as they will damage the finish. Do not leave liquids or damp cloths on this furniture.

To avoid dulling of the finish, do not place furniture in direct sunlight.

Please inspect and tighten all screws or bolts on a regular basis to ensure proper performance and safety of your item.

## PRE-ASSEMBLY INFORMATION

### PART DESCRIPTION

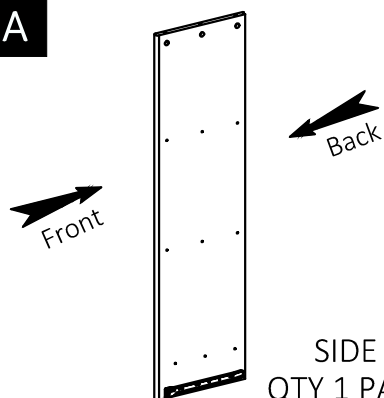
**A**

SIDE  
QTY 1 PAIR

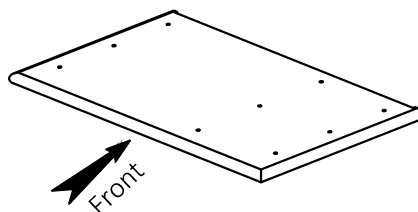
**B**

TOP  
QTY 1

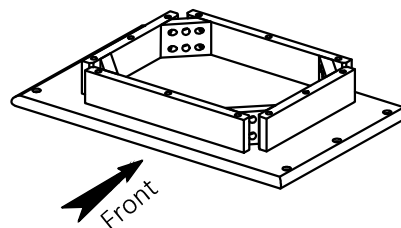
**C**

BOTTOM SHELF  
QTY 1

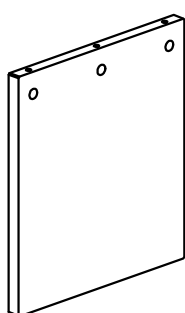
**D**

DIVIDER  
QTY 3

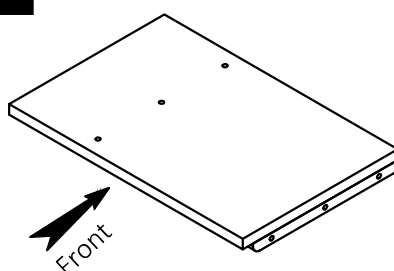
**E**

CABINET SHELF  
QTY 1

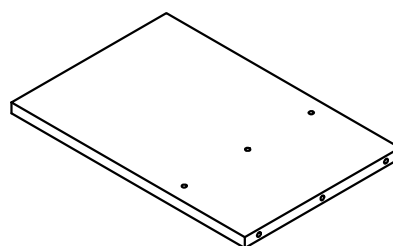
**F**

CABINET SHELF  
QTY 2

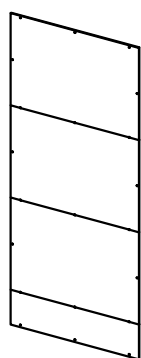
**G**

BACK PANEL  
QTY 1 SET

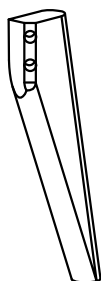
**H**

LEG  
QTY 2 PAIRS

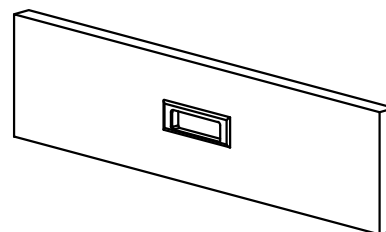
**I**

DRAWER FRONT  
QTY 1

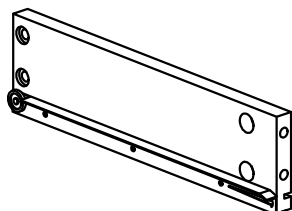
**J**

DRAWER SIDE  
QTY 1 PAIR

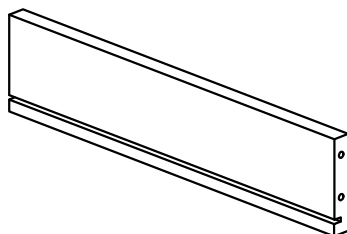
**K**

DRAWER BACK  
QTY 1

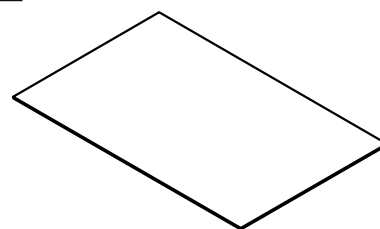
**L**

DRAWER BOTTOM  
QTY 1

**NEED HELP?** For help with assembly or if you are missing a part,  
Please call customer service

## PRE-ASSEMBLY INFORMATION

### HARDWARE DESCRIPTION

1

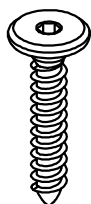

ALLEN KEY SCREW  
M6 X 30mm  
QTY 25

2

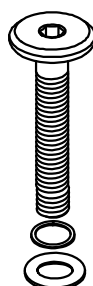

BOLTS AND WASHERS  
M8 x 60 mm  
QTY 8 SETS

3

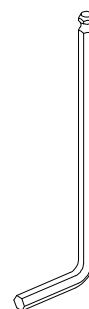

ALLEN KEY  
QTY 1

4



CAM LOCK PIN  
CAM LOCK  
QTY 31 SETS

5

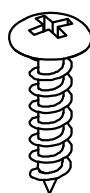

PHILLIPS SCREW  
ROUND HEAD  
M4 X 15mm  
QTY 21



6

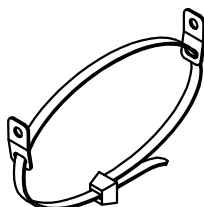

PLASTIC CAP  
QTY 15

7



- a.  M4 X 25mm - QTY 1
- b.  M4 X 15mm - QTY 1
- c.  M4 X 25mm - QTY 1

FURNITURE ANTI-TIPPING RESTRAINT  
QTY 1 SET

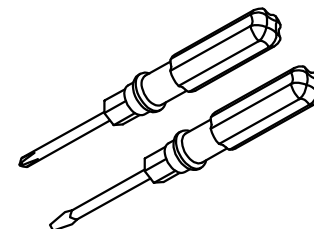

Required -  
Flathead screwdriver  
Phillips screwdriver  
**Not Included**

**NEED HELP?** For help with assembly or if you are missing a part,  
Please call customer service

## COMPONENTS-KEY DIAGRAM

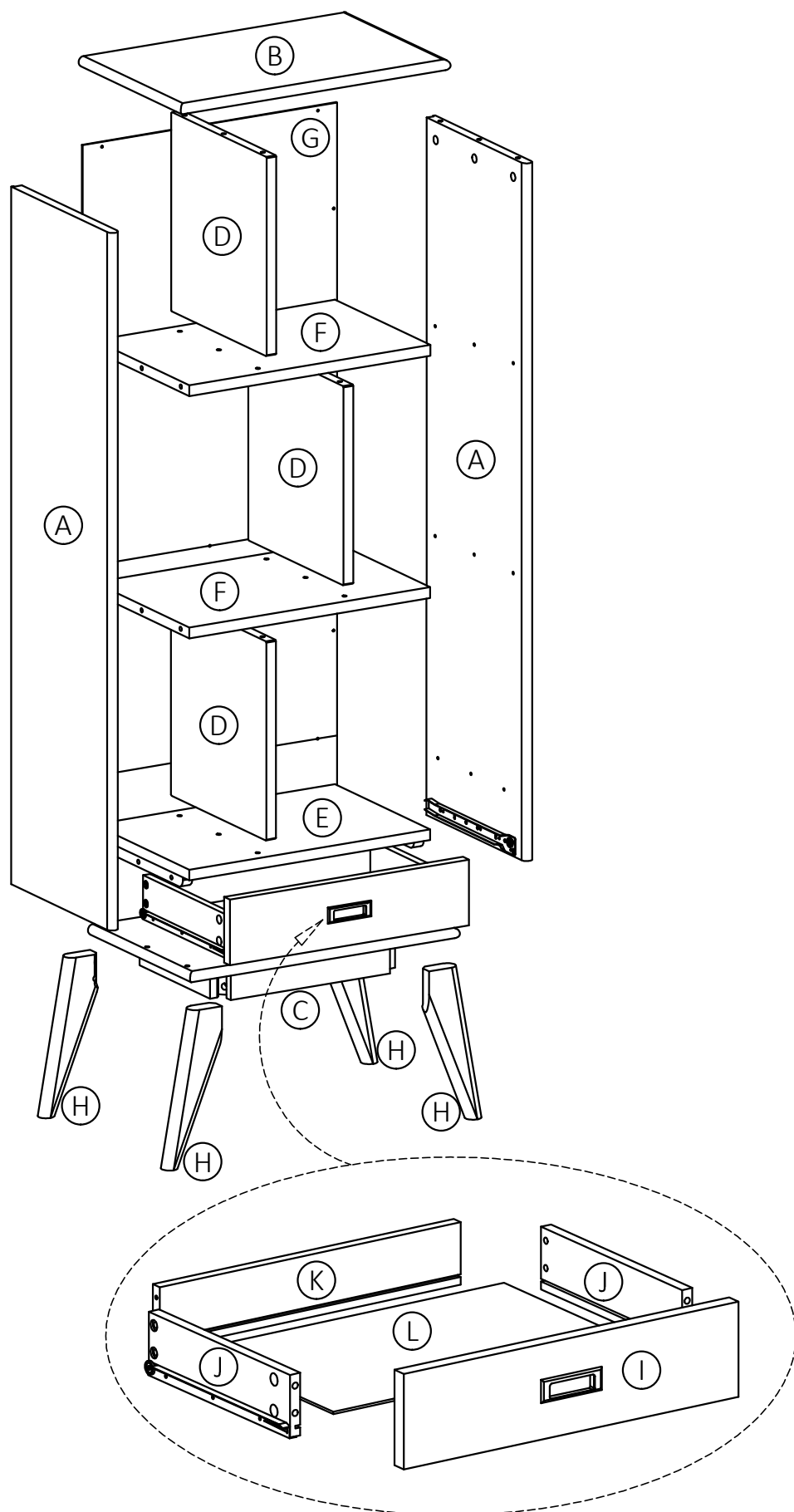

## ASSEMBLY

### STEP-1

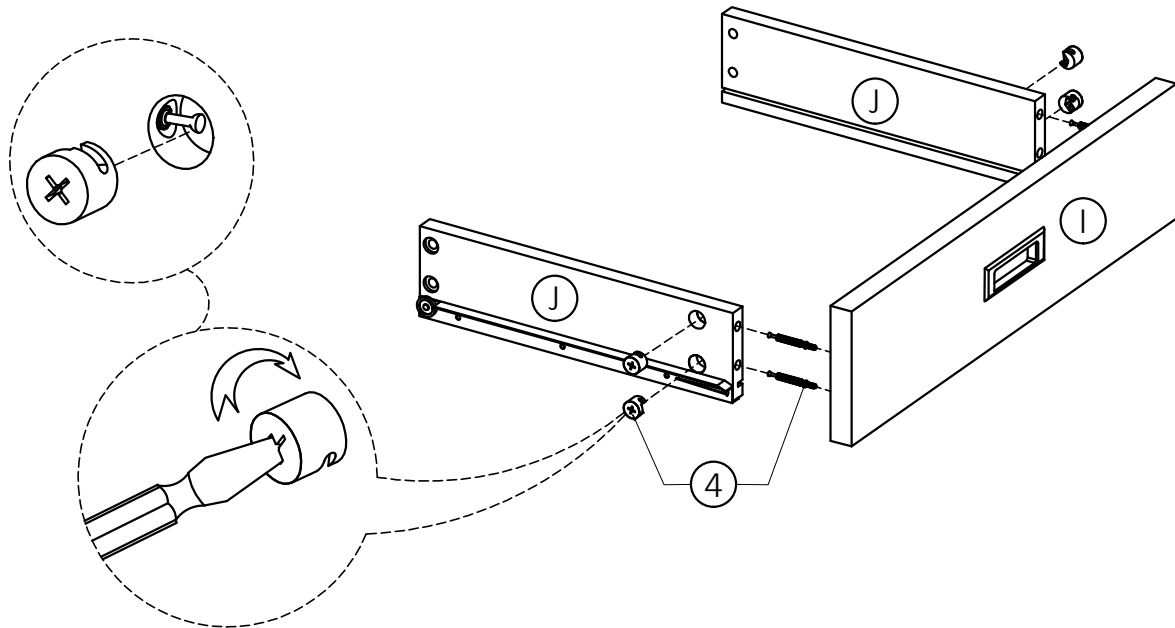

1. Attach four Cam Lock Pins (4) to back of Drawer Front (1).
2. Align Cam Lock Pins with pre-drilled holes and attach Drawer Sides (J).
3. Insert two Cam Locks (4) into pre-drilled holes on each Drawer Side (J).
4. Use flathead screwdriver to secure Cam Locks.

### STEP-2

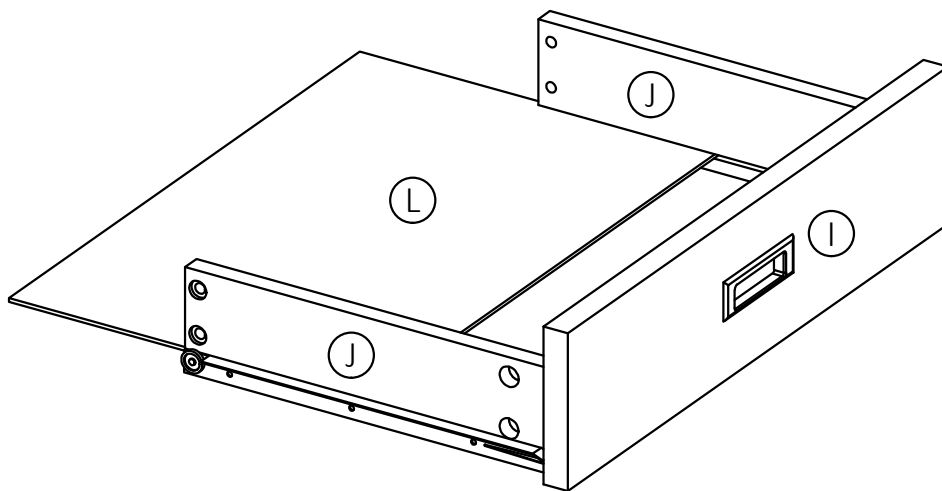

1. Slide Drawer Bottom (L) firmly into slots on Drawer Sides (J) and Drawer Front (1).

## ASSEMBLY

### STEP-3

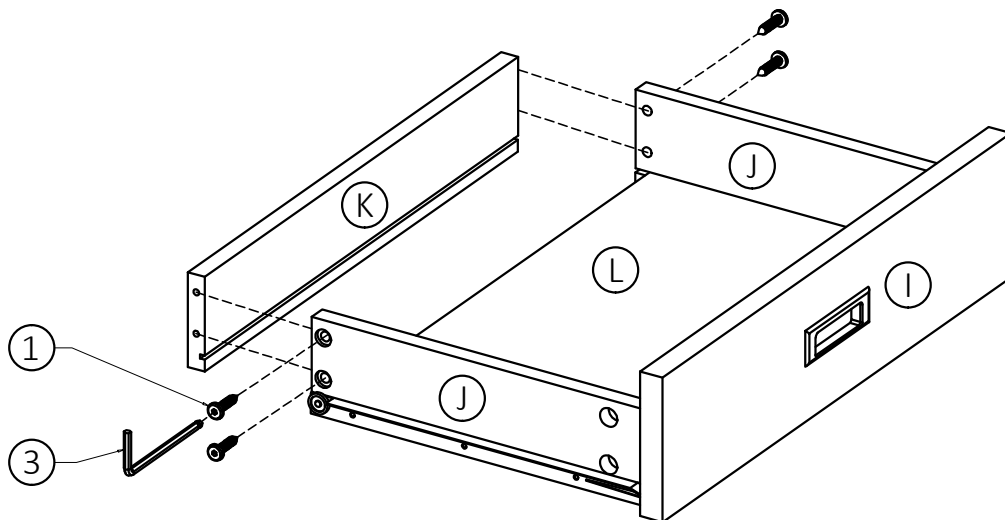

1. Align Drawer Back (K) with Drawer Bottom (L) and press firmly into slot.
2. Attach Drawer Back (K) using two Allen Key Screws (1) through pre-drilled holes on each Drawer Side (J).
3. Use Allen Key (3) to tighten Screws. Do not over-tighten.

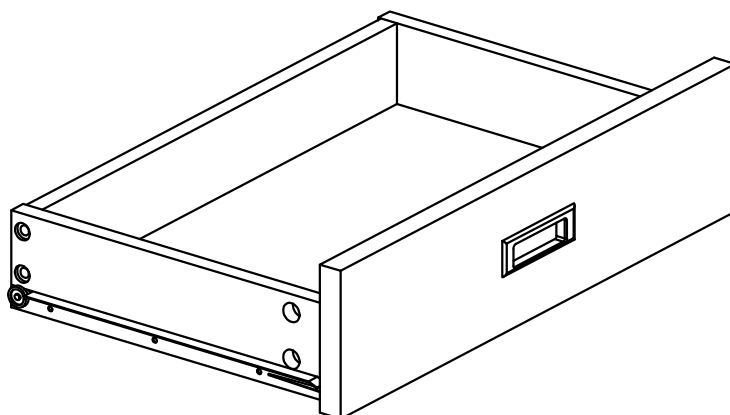

## ASSEMBLY

### STEP-4

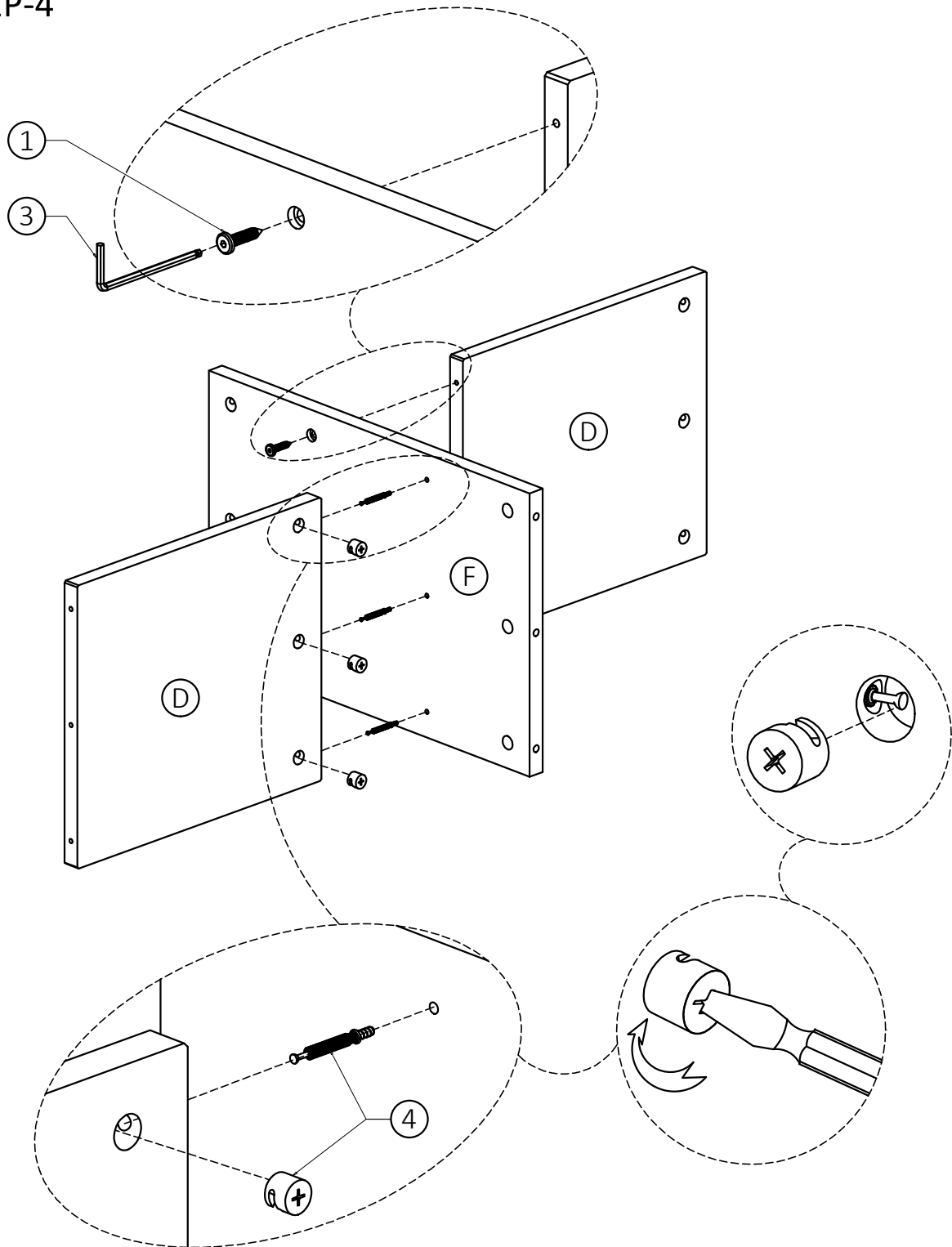

1. Attach Divider (D) to Cabinet Shelf (F) using three Allen Key Screws (1).
2. Use Allen Key (3) to tighten Screws. Do not over-tighten.
3. Attach three Cam Lock Pins (4) to underneath of Cabinet Shelf (F).
4. Align Cam Lock Pins with pre-drilled holes and attach Divider (D).
5. Insert three Cam Lock (4) into pre-drilled holes on Divider (D).
6. Use flathead screwdriver to secure Cam Locks.

## ASSEMBLY

### STEP-5

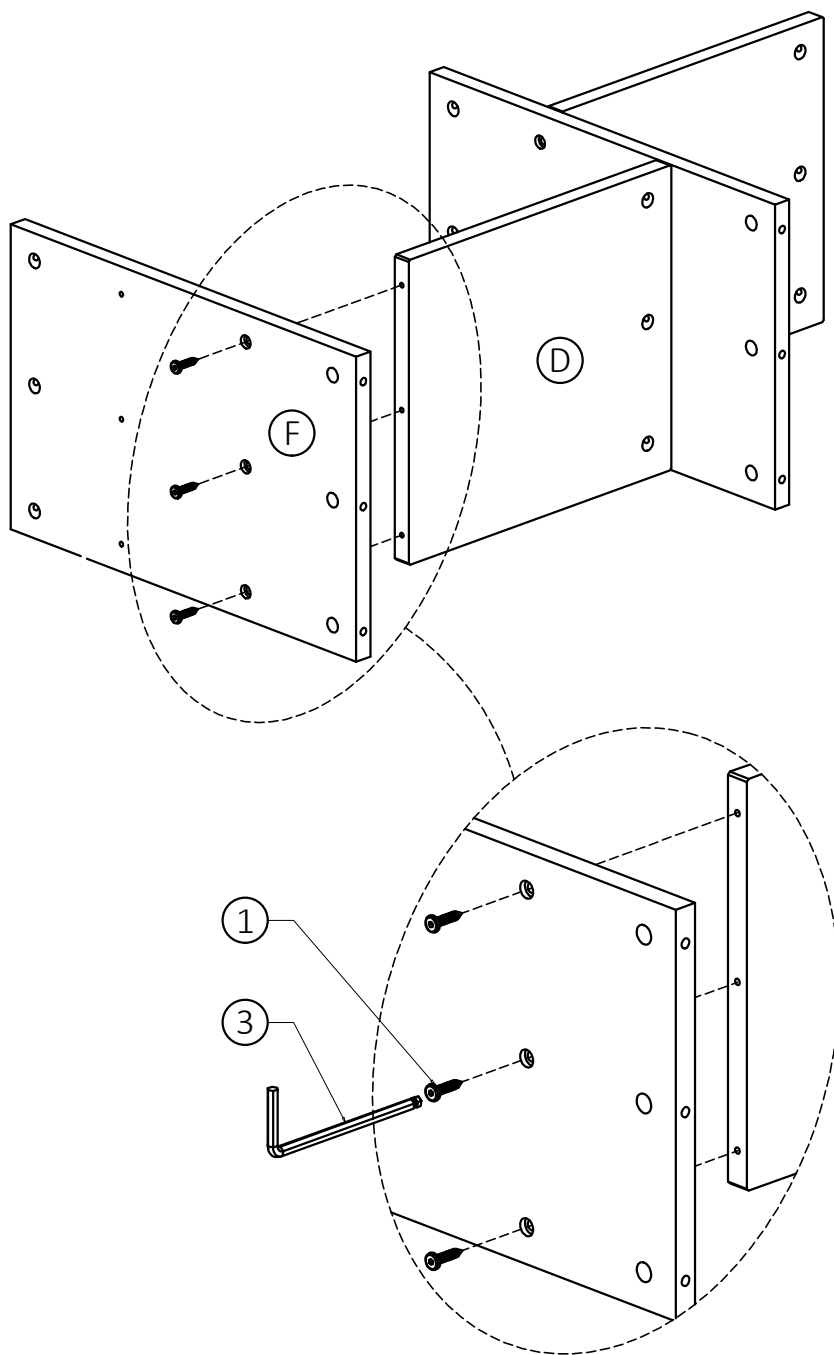

1. Attach Cabinet Shelf (F) to Divider (D) using three Allen Key Screws (1).
2. Use Allen Key (3) to tighten Screws. Do not over-tighten.

## ASSEMBLY

### STEP-6

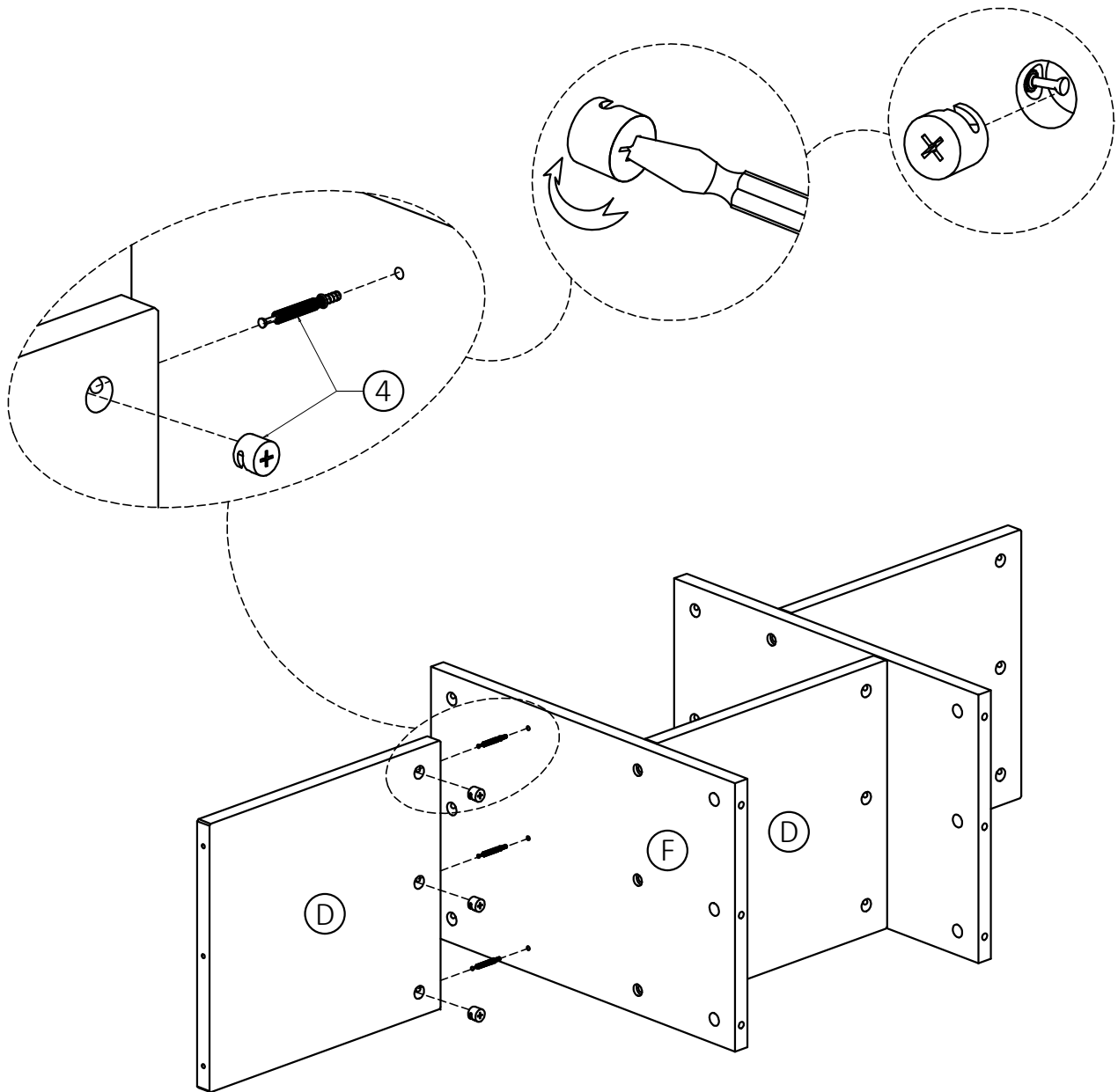

1. Attach three Cam Lock Pins (4) to underneath of Cabinet Shelf (F).
2. Align Cam Lock Pins with pre-drilled holes and attach Divider (D).
3. Insert three Cam Locks (4) into pre-drilled holes on Divider (D).
4. Use flathead screwdriver to secure Cam Locks.

## ASSEMBLY

### STEP-7

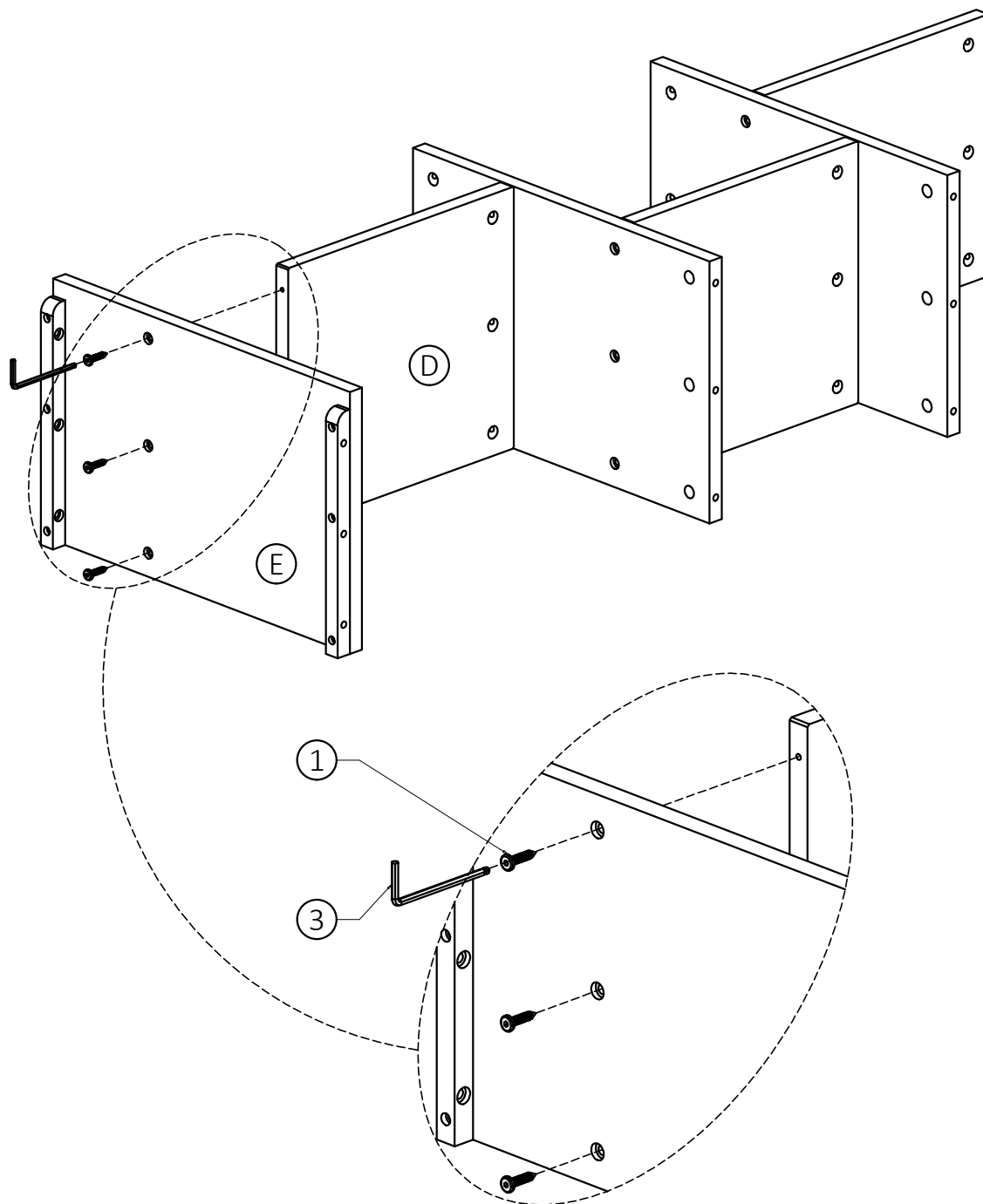

1. Attach Cabinet Shelf (E) to Divider (D) using three Allen Key Screws (1).
2. Use Allen Key (3) to tighten Screws. Do not over-tighten.

## ASSEMBLY

### STEP-8

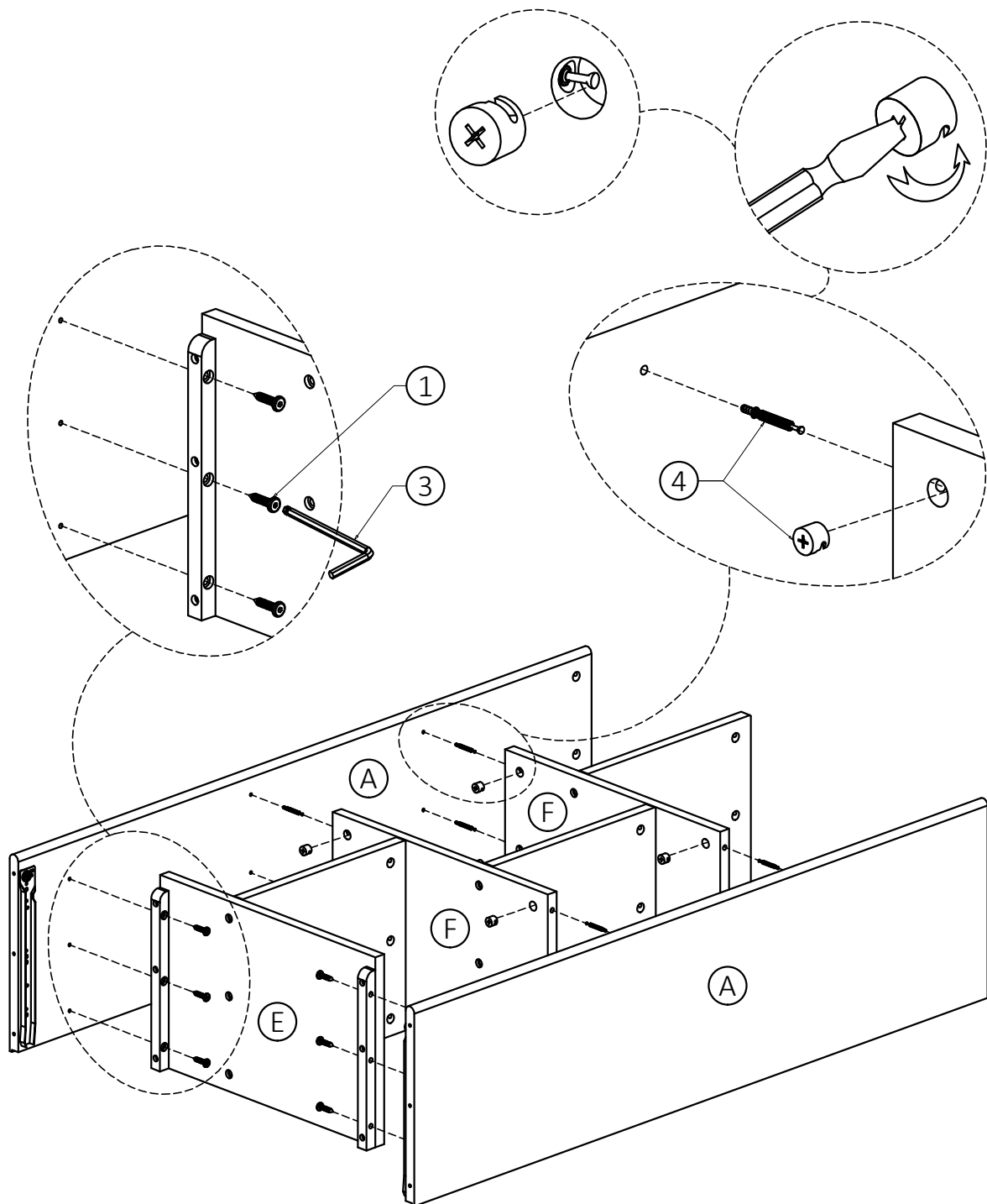

1. Attach twelve Cam Lock Pins (4) to inside of Sides (A) ( six Cam Lock Pins on each Side).
2. Align Cam Lock Pins with pre-drilled holes and attach Cabinet Shelf (F).
3. Insert six Cam Lock (4) into pre-drilled holes on each Cabinet Shelf (F).
4. Use flathead screwdriver to secure Cam Locks.
5. Attach Sides (A) to Cabinet Shelf (E) using six Allen Key Screws (1). (three Screws on each Side).
6. Use Allen Key (3) to tighten Screws. Do not over-tighten.

## ASSEMBLY

### STEP-9

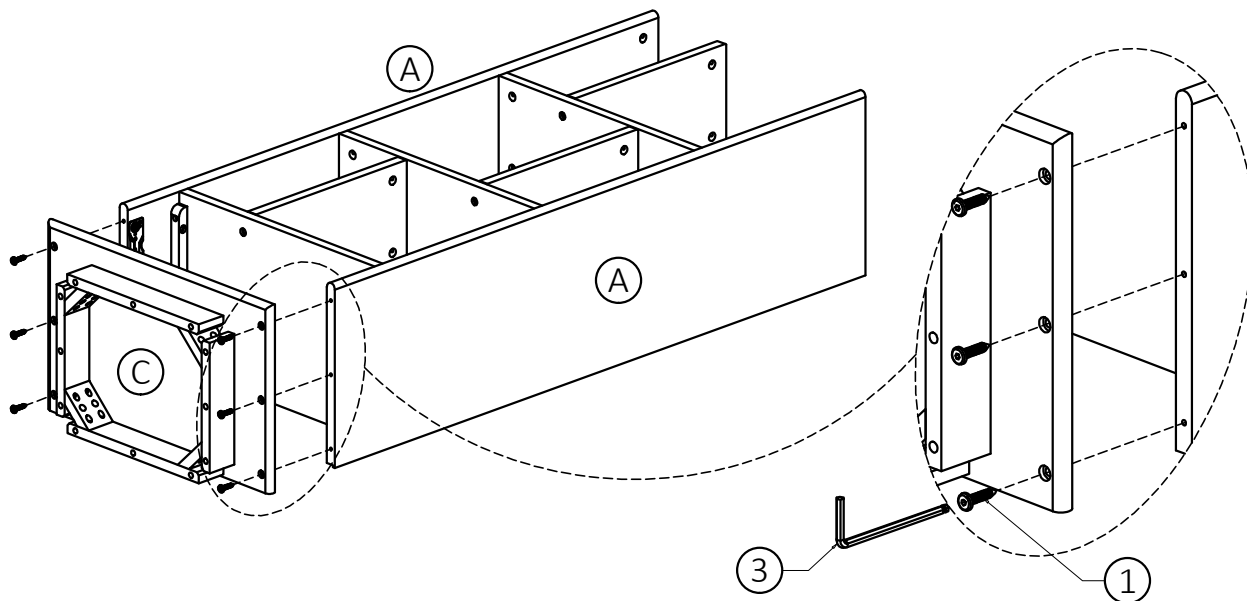

1. Attach Bottom Shelf (C) to Sides (A) using six Allen Key Screws (1) (three Screws on each Side) .
2. Use Allen Key (3) to tighten Screws. Do not over-tighten.

### STEP-10

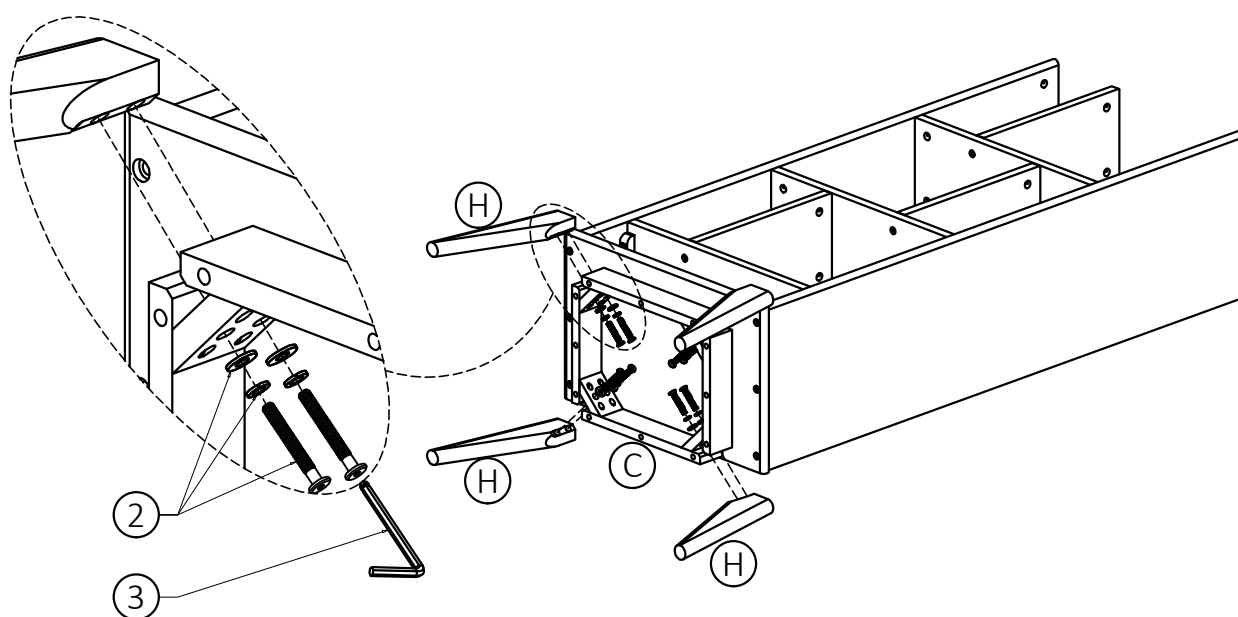

1. Attach Legs (H) to Bottom Shelf (C) using eight sets Bolts and Washers (2) (two sets on each Leg).
2. Use Allen Key (3) to tighten Bolts. Do not over-tighten.

## ASSEMBLY

### STEP-11

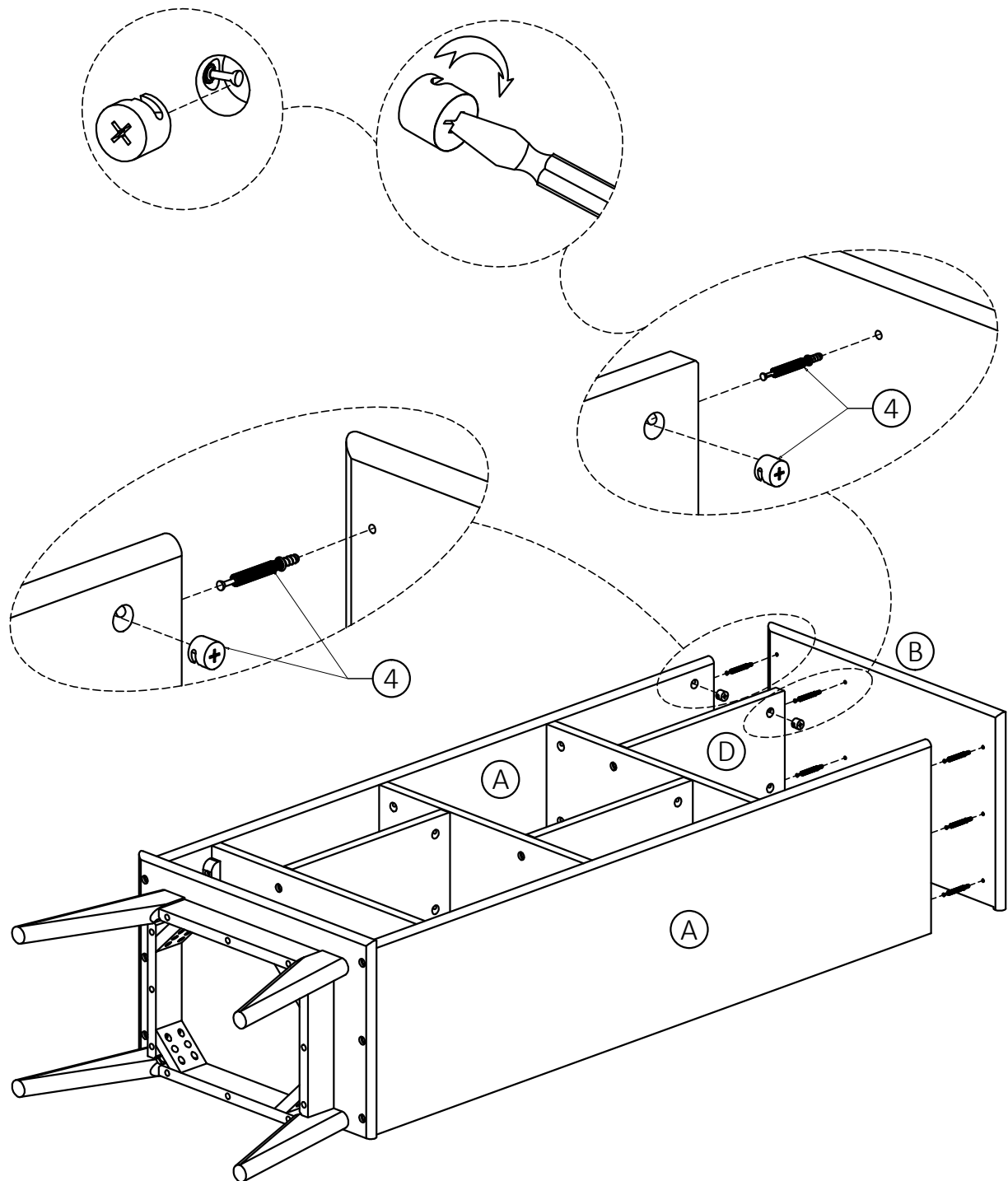

1. Attach nine Cam Lock Pins (4) to underneath of Top (B).
2. Align Cam Lock Pins with pre-drilled holes and attach Divider (D), Sides (A).
3. Insert three Cam Locks (4) into pre-drilled holes on Divider (D) and three Cam Locks (4) into pre-drilled holes on each Side (A).
4. Use flathead screwdriver to secure Cam Locks.

## ASSEMBLY

### STEP-12

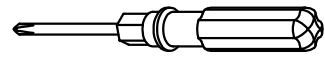
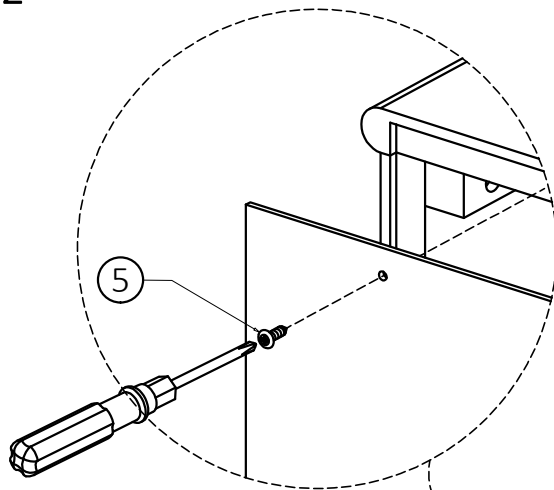

**NOTE:** The screwdriver is not included in the hardware pack.

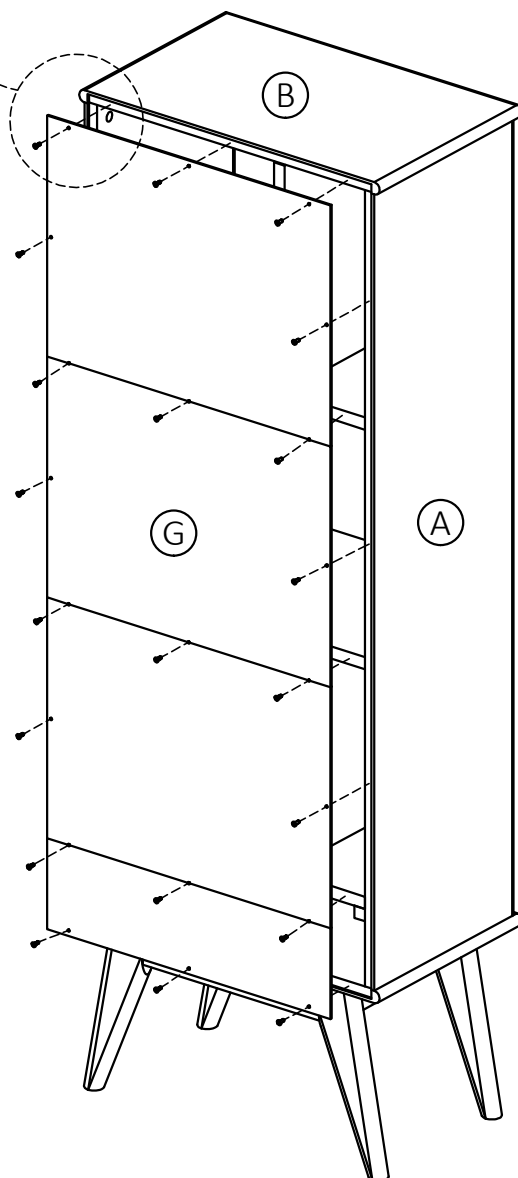

1. Attach Back Panel (G) to back frame of bookcase using twenty one Phillips Screws Round Head (5) into pre-drilled guide holes.
2. Use Phillips screwdriver to tighten screws. Do not over-tighten.

## ASSEMBLY

### STEP-13

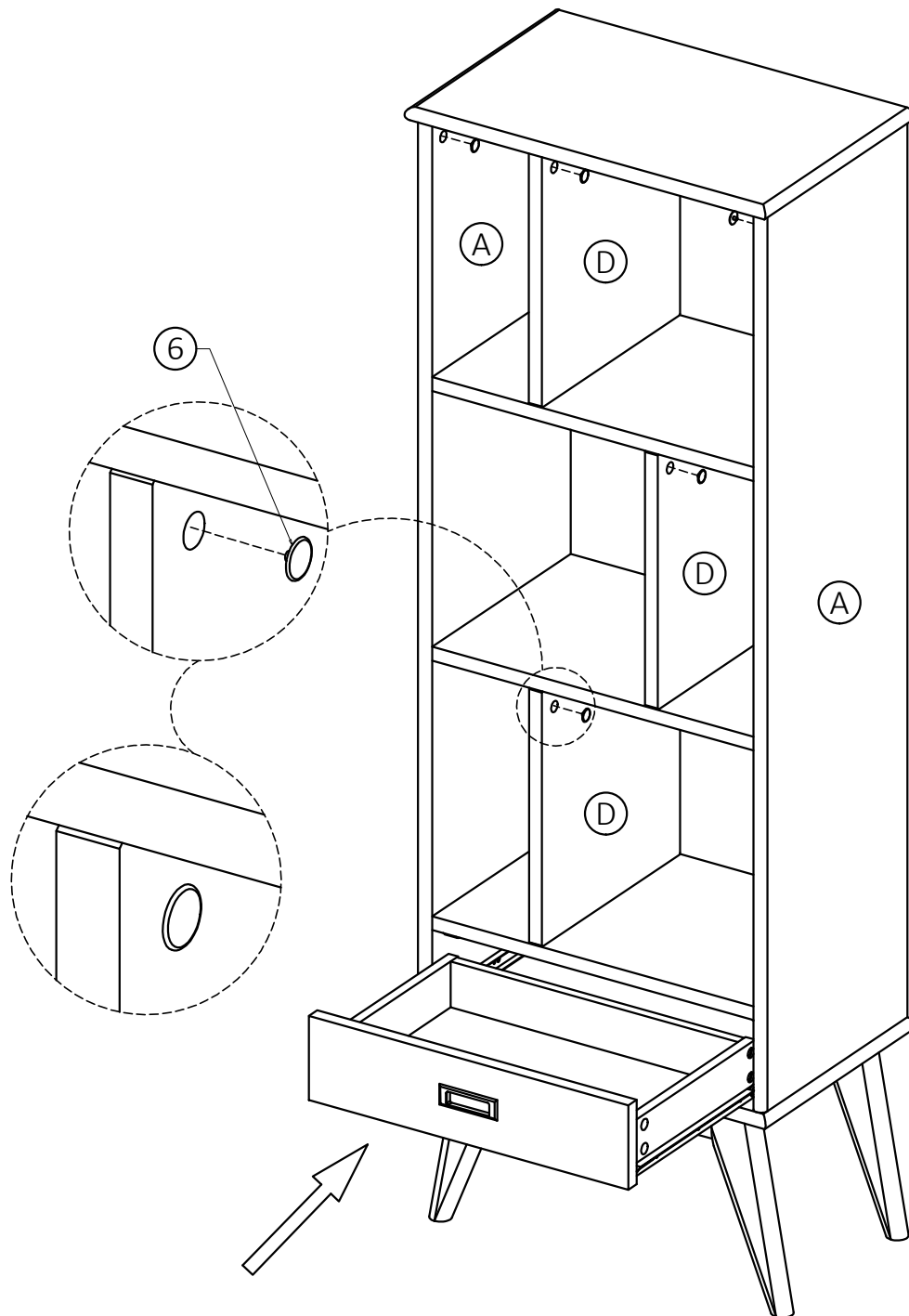

1. Insert assembly drawer into glides on assembly bookcase.
2. Insert fifteen Plastic Caps ⑥ into holes Cam Locks on Sides ① and Dividers ②.

## FURNITURE ANTI-TIPPING RESTRAINT ASSEMBLY

**NOTE:** Injuries and damage can occur from furniture tip-over. It is important to use the safety bracket included. If the tipping restraint kit is not in the box, please contact our customer service department in order to obtain another kit before using the furniture.

### STEP-14

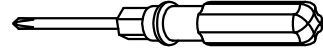

**NOTE:** The screwdriver is not included in the hardware pack.

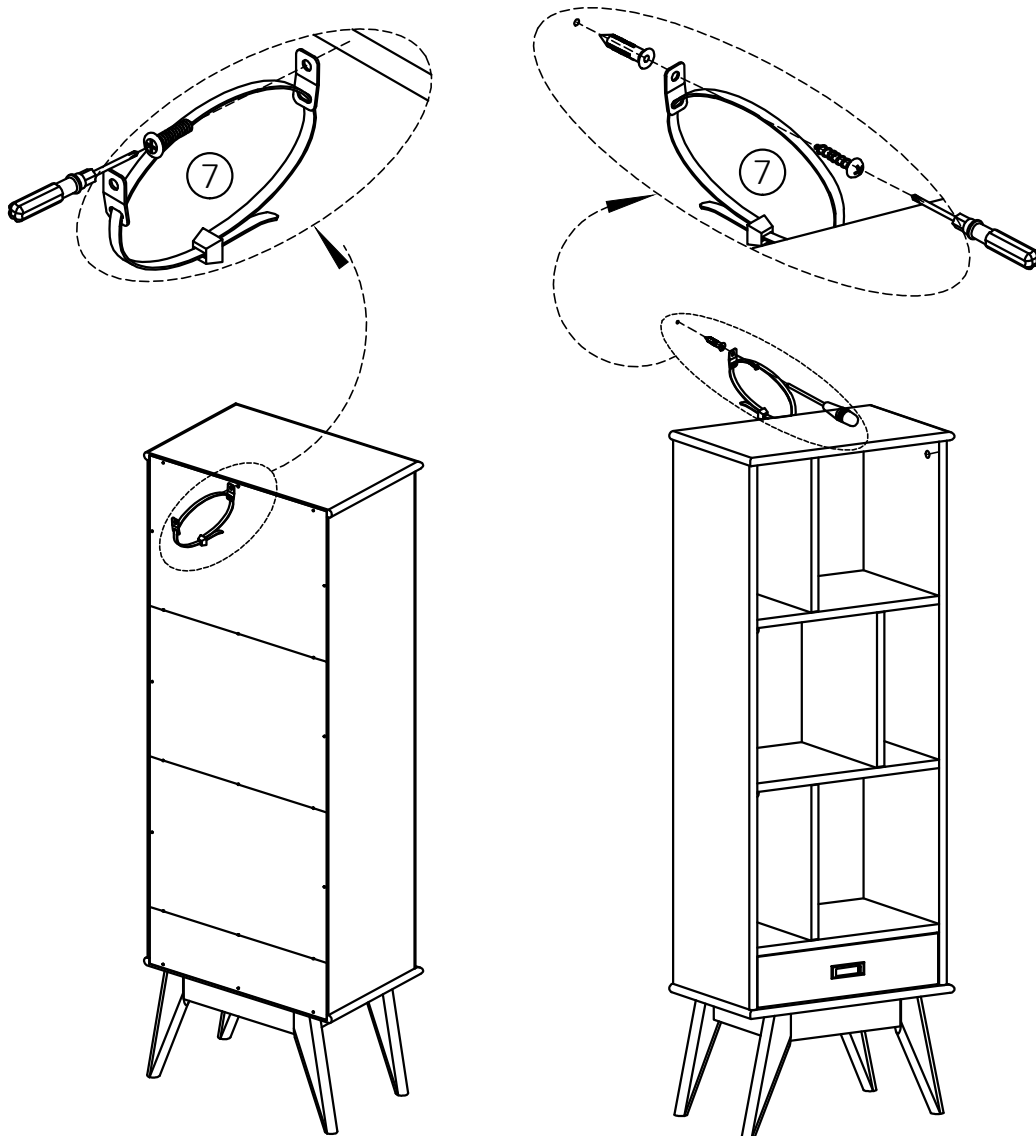

## FURNITURE ANTI-TIPPING RESTRAINT ASSEMBLY

### Furniture Anti-Tipping Restraint Instructions:

1. Attach one of the mounting brackets securely to the back edge of the furniture. Use the shorter screw.
  2. Determine where furniture is to be placed and mark location on the wall for mounting bracket screw hole approximately 2 inches below the bracket mounted to the furniture.
  3. Drill a 3/16 inch hole in the wall. Press the plastic anchor into the hole and gently tap until the flange on the anchor is against the wall surface.
  4. Position the bracket over the anchor and use the longer screw to securely attach the bracket to the wall.
  5. Place the furniture so the back edge is in line with the bracket on the wall.
  6. Lace an end of the nylon restraint down through each bracket. Bring both ends together and slide the beaded end of the strap through the keyhole shaped slot in the other end until snug. Pull down on the beaded end until it snap locks into the keyhole slot.
  7. To double lock, return the beaded end back through the keyhole as shown.
  8. Check to make sure the strap is securely laced and locked to the brackets.
- 
- **DO NOT** put a TV or other heavy objects on top of a Bookcase or any other furniture not intended for use with a TV
  - **DO NOT** place heavy objects in drawer
  - **DO NOT** let children climb or hang on drawer or shelves

## WARRANTY

Thank you for purchasing our product. These products have been made to demanding, high-quality standards and are guaranteed for domestic use against manufacturing faults for a period of 12 months from the date of purchase. This warranty does not affect your statutory rights.

We reserve the right to repair or replace the defective product, at its discretion.

This product is guaranteed for 12 months if used for normal purposes. Any warranty is invalid if the product has been overloaded or subject to neglect, improper use or an attempted repair by other than an authorized agent. Heavy-duty or daily professional/commercial usage are not guaranteed.

Due to continuous product improvement, we reserve the right to change the product specifications without prior notice.