

CARAVAN SET UP INSTRUCTIONS

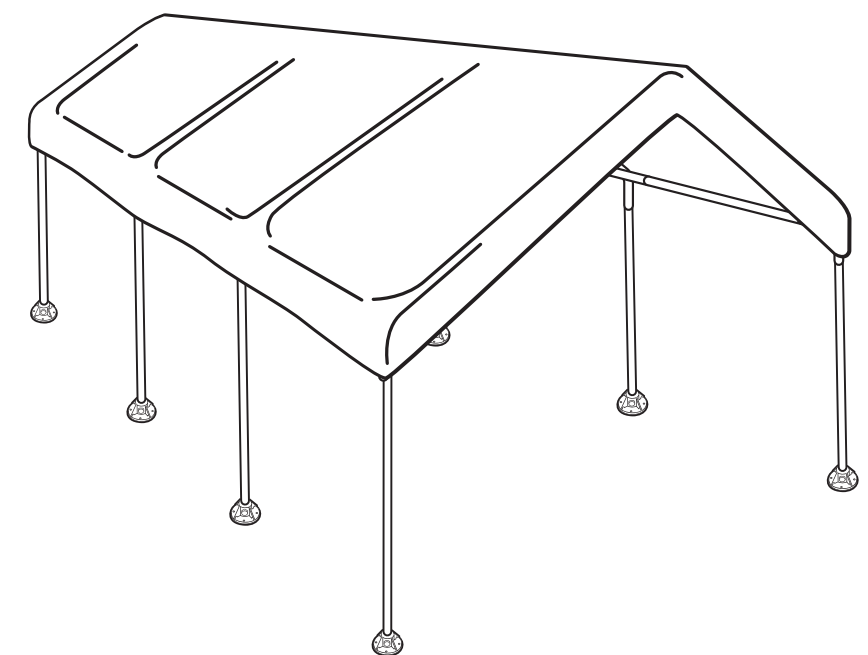
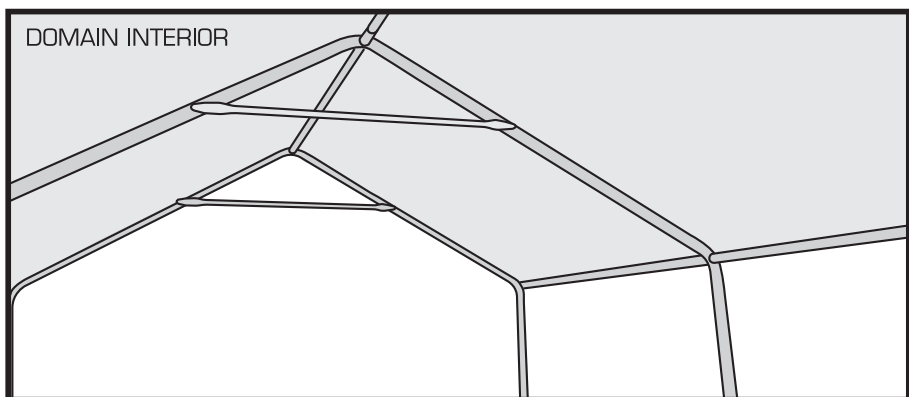
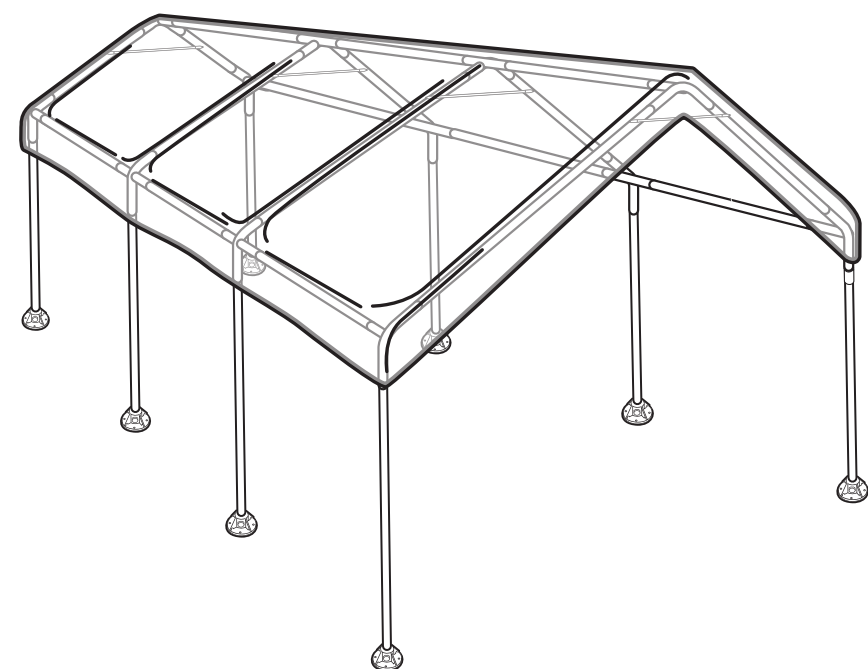

WARNING

Use caution during installation. The user assumes all risk of injury during setup and use. Please follow the following safety precautions to avoid injury.

1. Do not use the canopy as a permanent shelter. It is designed for temporary use only!
2. Never set-up or continue to use the product in rainy, windy or stormy conditions, especially lightning storms. Please remove your canopy top before a storm.
3. Keep your canopy off of steep slopes and inclines
4. Have at least two adults helping during installation. Read all instructions carefully and follow accordingly. Failure to do so may result to injury or damage to the canopy.
5. Always inspect the canopy and each part before use. Make sure that everything is tightly secured. Replace any worn, defective or missing parts.
6. After installation, the canopy should be anchored to prevent damage and possible injury. It is the user's responsibility to properly anchor the product.
7. Do not set-up or use the product in close proximity to fire or any heat source. Do not use a barbecue grill under the canopy.
8. Do not bleach canopy cover, dry clean, wash in the washing machine, or dry in the dryer. Use only mild soap and water. Hang to dry.

LIMITED WARRANTY

Caravan® Canopy Int'l warrants that each part of this product will be free from defects in material and workmanship for a 2 year limited period from date of purchase.

- This warranty is void:
- If product is used under other than normal use and maintenance conditions.
 - If the product is modified or altered.
 - If product is subject to abuse or neglect.
 - If product damage is accidental, deliberate, or caused by rain, wind, snow/ice, or other forces of nature.
 - If product use does not conform to product instructions.
 - If product is repaired by someone other than Caravan® Canopy Int'l or its authorized representative.

The sole obligation of Caravan® Canopy Int'l under this warranty or any other legal obligation, with respect to the product, is repair or replacement, by Caravan® Canopy Int'l or its authorized representative, of the missing or defective parts causing malfunction with new parts after review and examination by Caravan® Canopy Int'l.

Under no circumstances will the retail customer, user, authorized representative or other person be entitled to any direct, special, indirect, consequential or exemplary damages for breach of contract or otherwise. Under no circumstances will any person be entitled to a sum greater than purchase price of the malfunctioning part.

No Caravan® Canopy Int'l authorized representative or person other than an officer of Caravan® Canopy Int'l may extend or modify this warranty. There are no other warranties from either Caravan® Canopy Int'l or its representatives which extend the face of this warranty. All other warranties, expressed or implied, including the warranties of merchantability, fitness for a particular purpose and fitness for use are excluded.

Please contact Caravan® Canopy Int'l for specific shipping instructions before returning any part. All shipping costs must be prepaid. Caravan® Canopy Int'l will not be responsible for any products damaged in transit.

Copyright © 2014 Caravan® Global



10ft x 20ft
3.05m x 6.1m
8 LEG COMMERCIAL FRAME

INSTALLATION INSTRUCTIONS

Please read instructions COMPLETELY before assembly.



DO NOT RETURN PRODUCT TO THE STORE
Missing parts, replacement parts, or assembly help, please contact customer service:
714-367-3000 or 877-922-6679

WARNING!

Use Caution during installation. Safety goggles are recommended. Please read the instructions carefully before installation. This is only a TEMPORARY shelter and is not recommended for permanent use.

Keep all flame and heat sources away from this canopy top fabric.

Do not set-up or leave the canopy unattended in the following conditions: gusty wind, rain, hail, sleet, snow, drizzle, or any other harsh weather conditions. Doing so may cause damage to the entire canopy and will void the warranty. Please call Caravan® Canopy for any questions or inquiries.



Copyright © 2014 Caravan® Global
All Rights Reserved.
www.caravansports.com
STANDARD KIT SNG_YV VER01

INCLUDED PARTS

Guide	Description	Qty
A1	Mega Domain Leg	8
A2	Mega Domain Foot	8
B	Mega Domain Cross Brace Pole	8
C	Mega Domain Peak Brace Pole	9
D	Mega Domain 3-Way Corner Bracket	6
E	Mega Domain 4-Way Corner Bracket	6
F	Mega Domain Elastic Ball Strap	44
G	Mega Domain Foot Stabilizer	8
H	Mega Domain Canopy Top	1
I	Snow Load Bars	4
J	Expansion Bolt	8
K	Snow Load Nut & Bolt	8

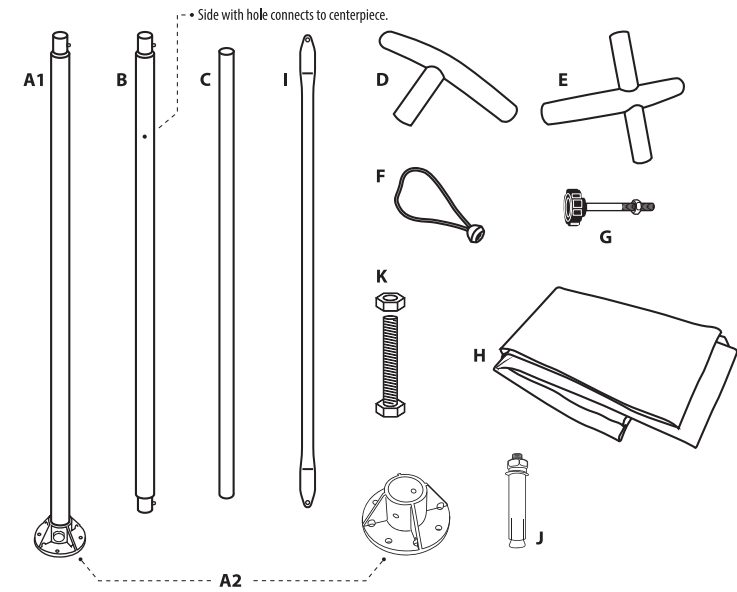

STEP 1 LAY OUT ALL PARTS BASED ON DIAGRAM BELOW

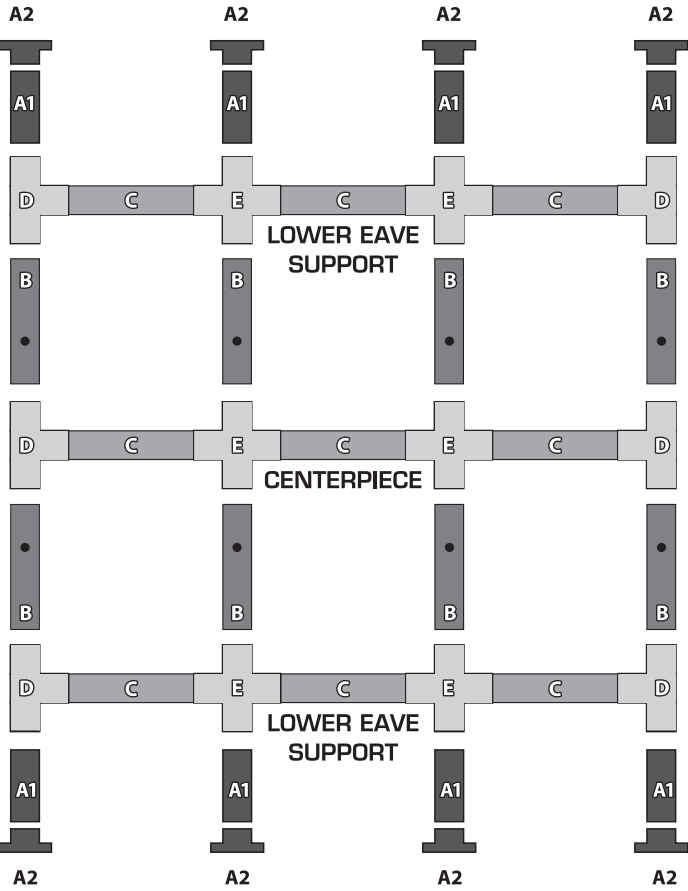

STEP 2 COMBINE THE CENTERPIECE

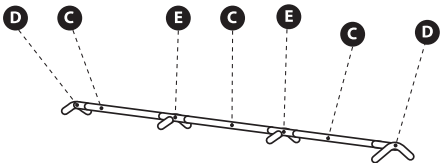

STEP 3 CONNECT B2 SIDES TO CENTERPIECE

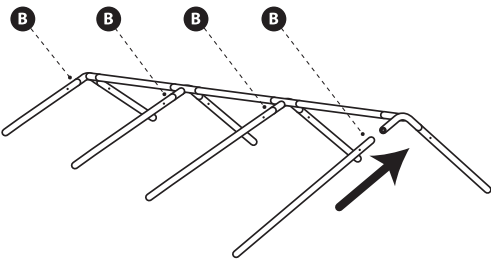

STEP 4 ASSEMBLE BOTH LOWER EAVE SUPPORTS

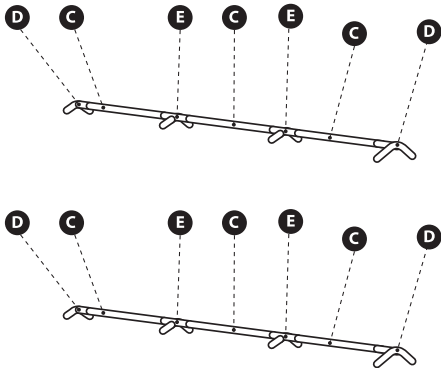

STEP 5 CONNECT B1 SIDES TO LOWER EAVE SUPPORTS

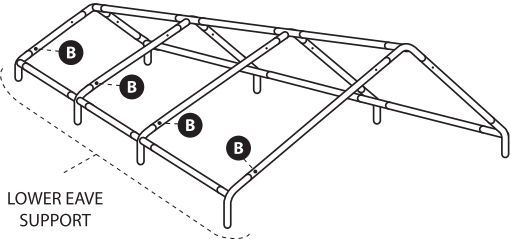

STEP 6 CONNECT SNOW LOAD BARS

Attach with snow load nut & bolt (K).

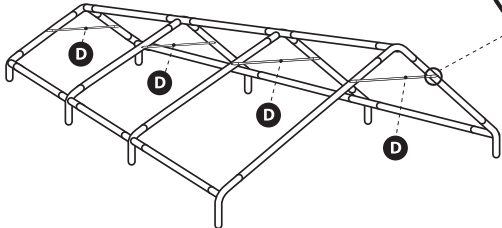

STEP 7 PLACE CANOPY TOP

Secure each corner with the elastic ball straps. Then secure all other grommet points with the remaining ball straps.

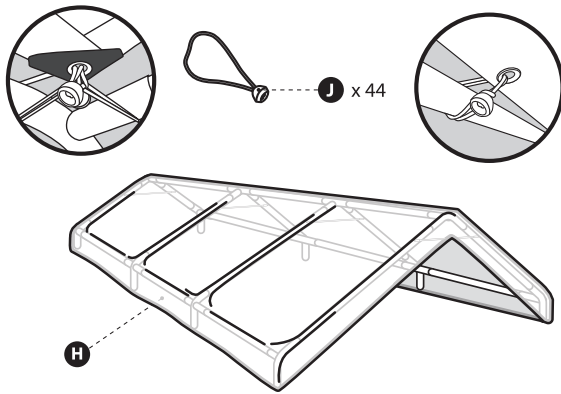

STEP 8 CONNECT LEGS & FEET

Secure canopy feet (A2) to canopy legs (A1) first. Then attach canopy legs. Start with one side first, then the other.

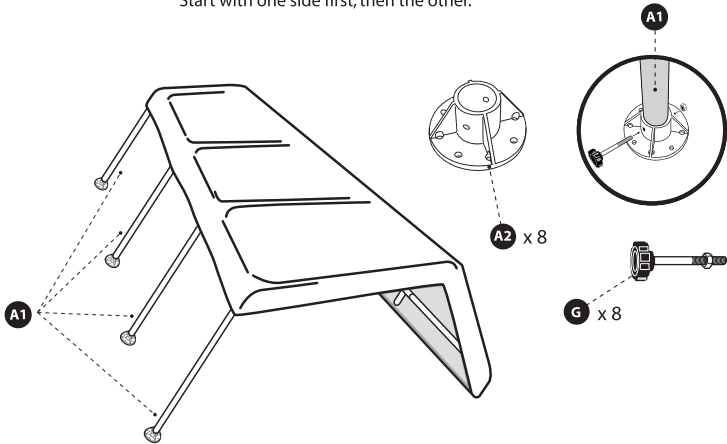

STEP 9 SECURE EXPANSION BOLTS TO CONCRETE

Drill hole in concrete to required depth.

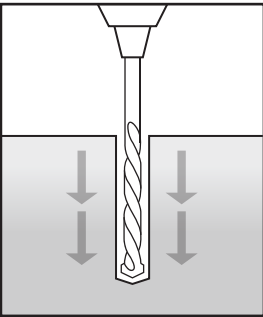

Remove all debris from hole.

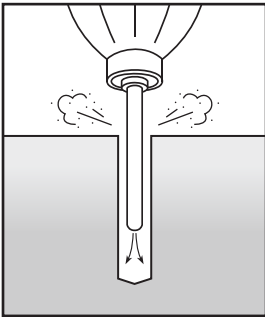

Insert expansion bolt through canopy foot into concrete.

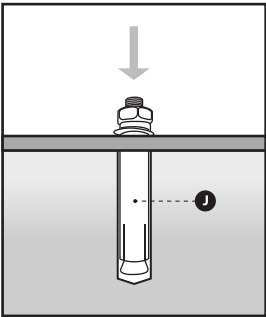

Fasten nut with socket wrench to fully secure expansion bolt to concrete.

