

Parts of a Drawer Slide:

Drawer Slide consists of 2 main parts:

E1 = Drawer Slide Rail/Track

E2 = Drawer Slide Runner

A Trigger Disconnect Lever is found on Drawer Slide Runner (E2)

Refer to Diagram below:

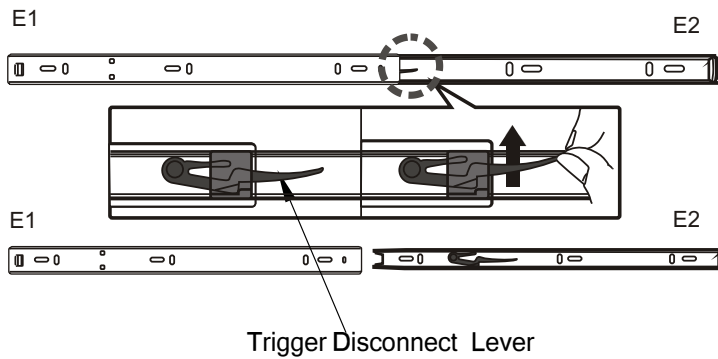

To install Drawer Slide, the Drawer Slide Runner (E2) needs to be detached or separated from the Drawer Slide Rail/Track (E1).

To detach or separate Drawer Slide Runner (E2) from Drawer Slide Rail/Track (E1), first slide out Drawer Slide Runner (E2) from Drawer Slide Rail/Track (E1) until the Trigger Disconnect Lever is visible on E2 as shown above. Next, depress the Trigger Disconnect Lever and at the same time slide out E2 from E1.