

STANDARD BED

Twin

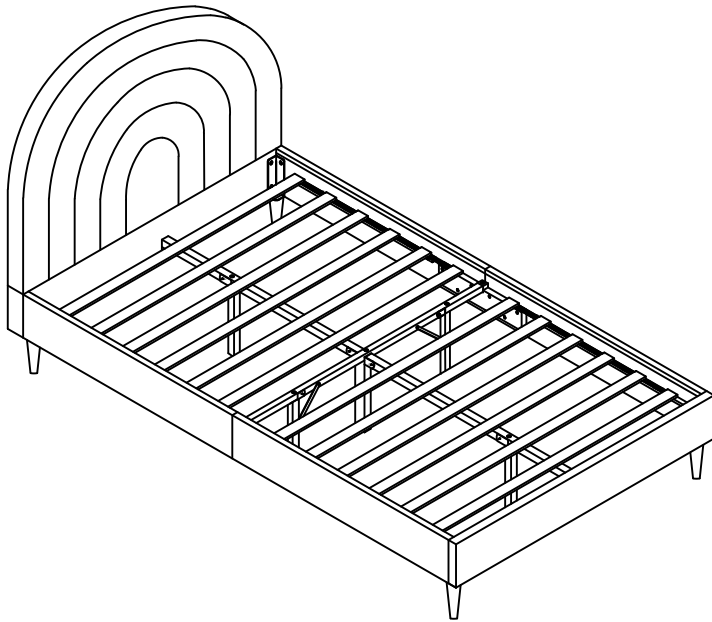

Please TEAR OFF this shrink film from side!
DO NOT USE CUTTER!

1. FOR THE PROTECTION OF YOUR FURNITURE, PLACE ALL PARTS ON A CLEAN AND SMOOTH SURFACE TO PREVENT ANY DAMAGE.
2. DO NOT USE POWER TOOLS TO ASSEMBLE THE BED.
3. PLEASE PERIODICALLY CHECK ALL FITTINGS AND RE-TIGHTEN AS NECESSARY.
4. DO NOT USE THE BED UNLESS ALL BOLTS AND SCREWS ARE FIRMLY SECURED.
5. NEED PARTS OR ASSISTANCE? EMAIL US AT kjbed@outlook.com
6. YOU CAN ASSEMBLE IT WITH OUR PACKAGING TOOLS OR WITH A.

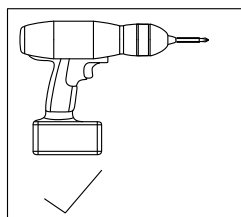

PART LIST

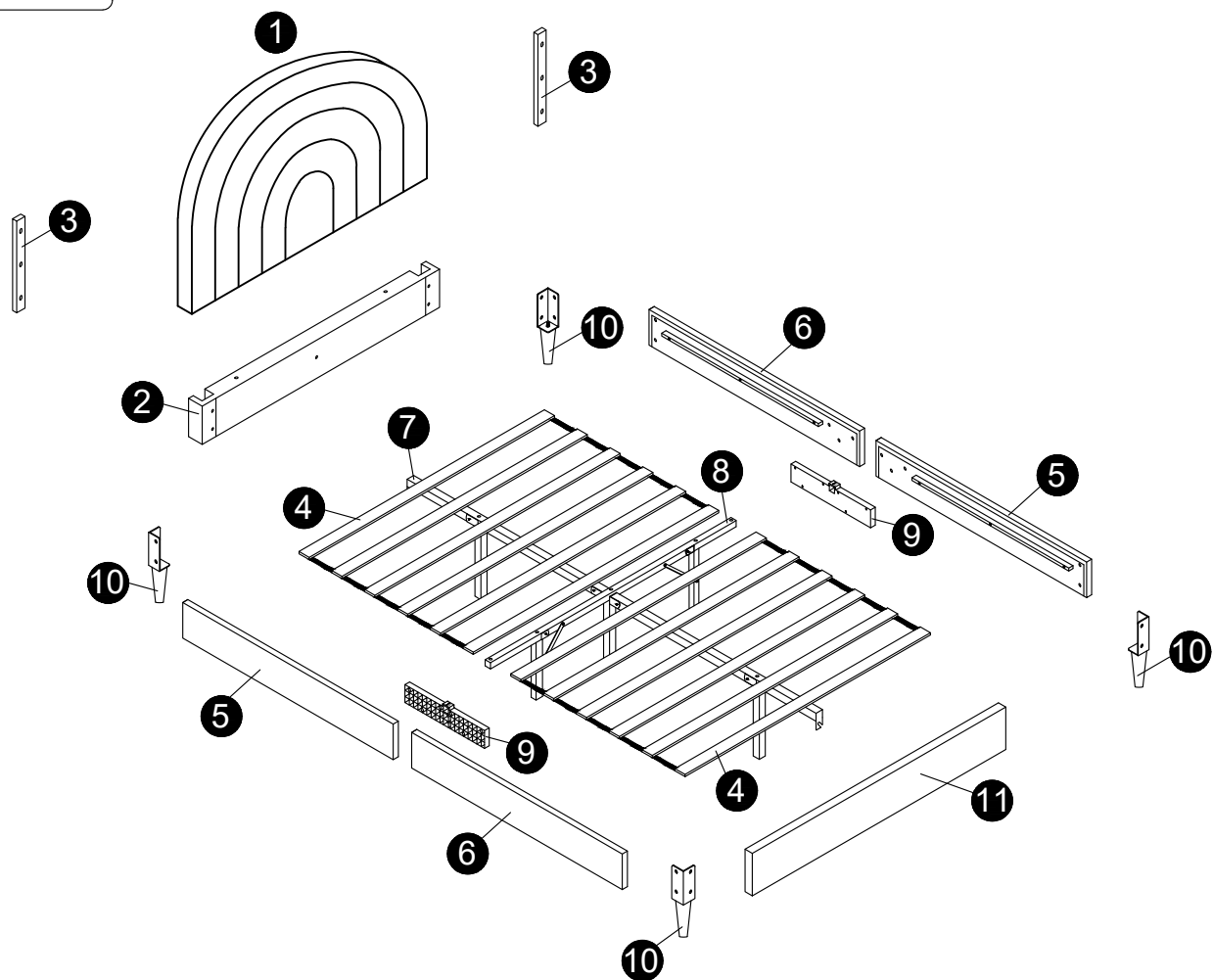

1 x 1pc

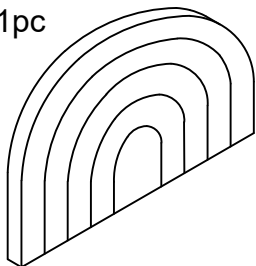

2 x 1pc

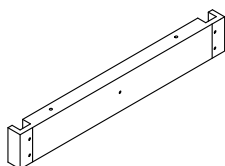

3 x 2pcs



4 x 2pcs

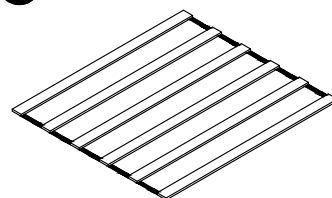

5 x 2pcs

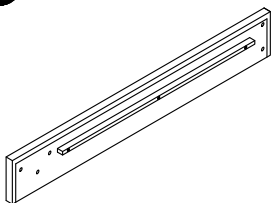

6 x 2pcs

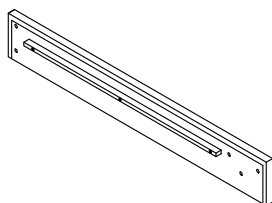

7 x 1pc

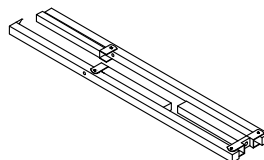

8 x 1pc

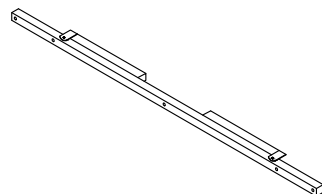

9 x 2pcs

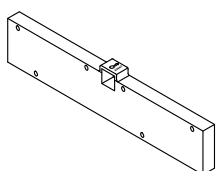

10 x 4pcs

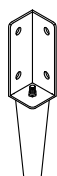

11 x 1pc

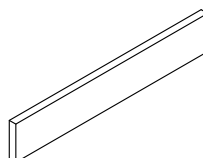

HARDWARE LIST



H1 M5 x 1pc



H2 M8x25mm x 18pcs



H3 M8x50mm x 4pcs



H4 M8x40mm x 22pcs



H5 M8 x 33pcs



H6 M8x17mm x 39pcs



H7 M8x22mm x 6pcs



H8 M8x60mm x 1pc

1

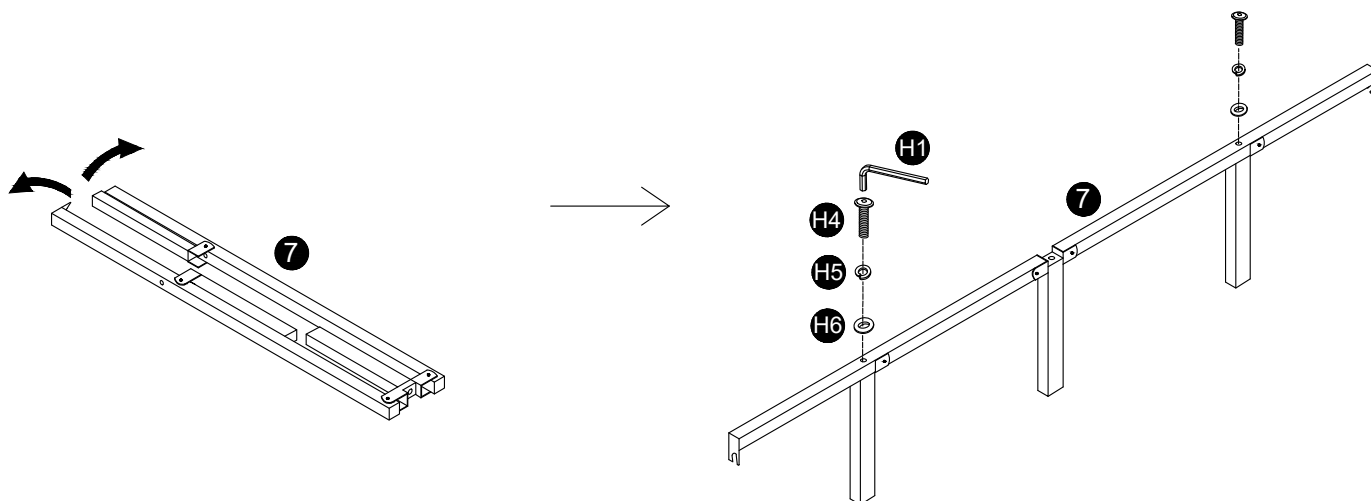

2

BEWARE OF CLAMP HAND

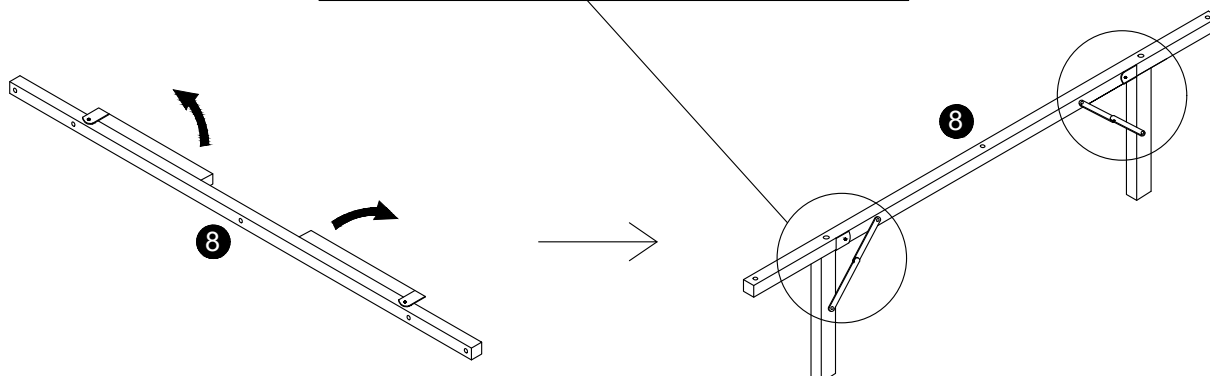
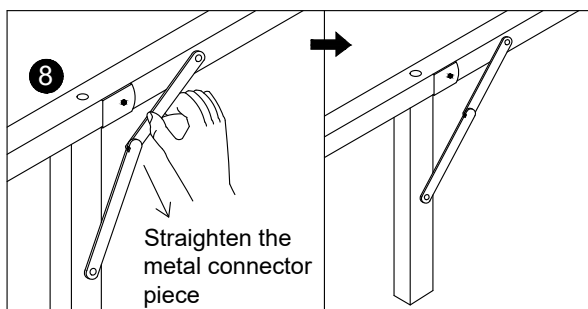

3

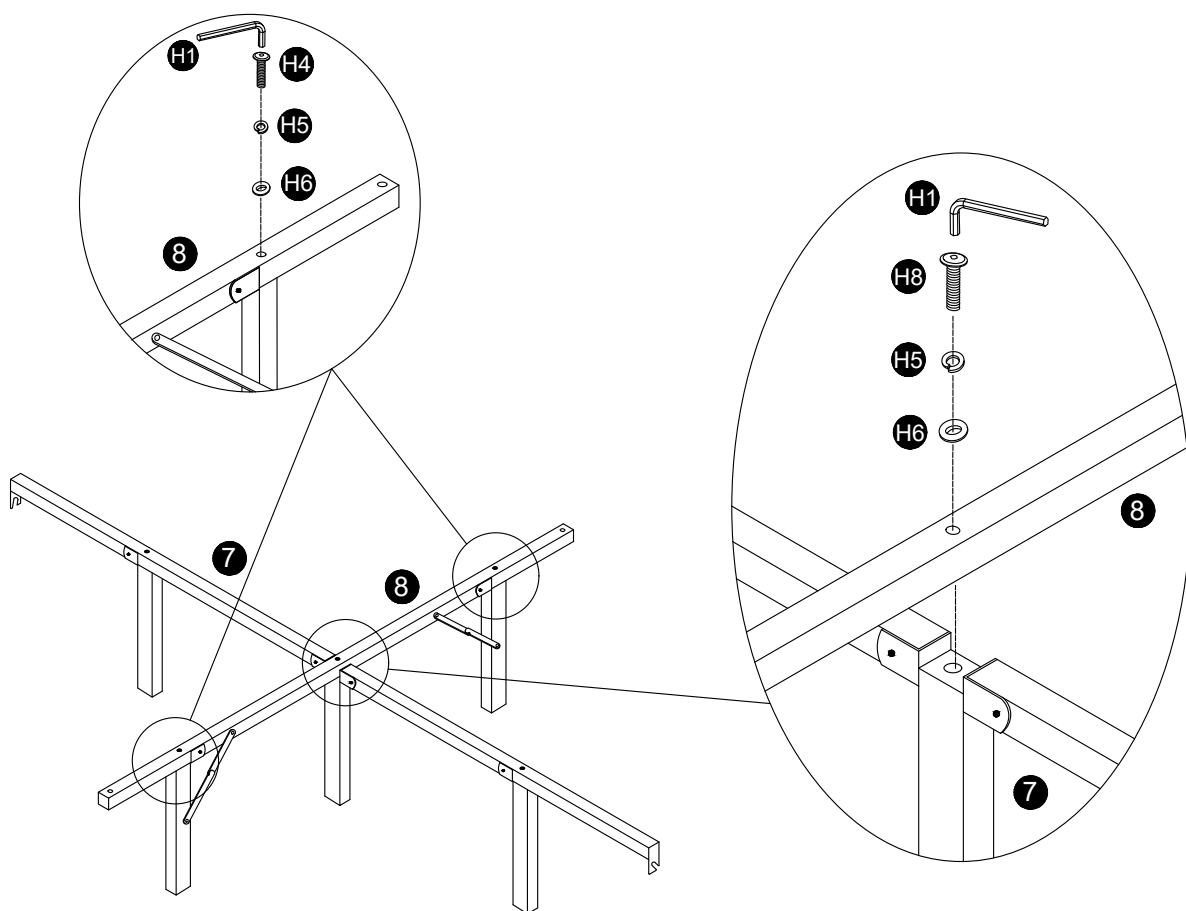

4

Important: part ⑨ , following the “INNER”

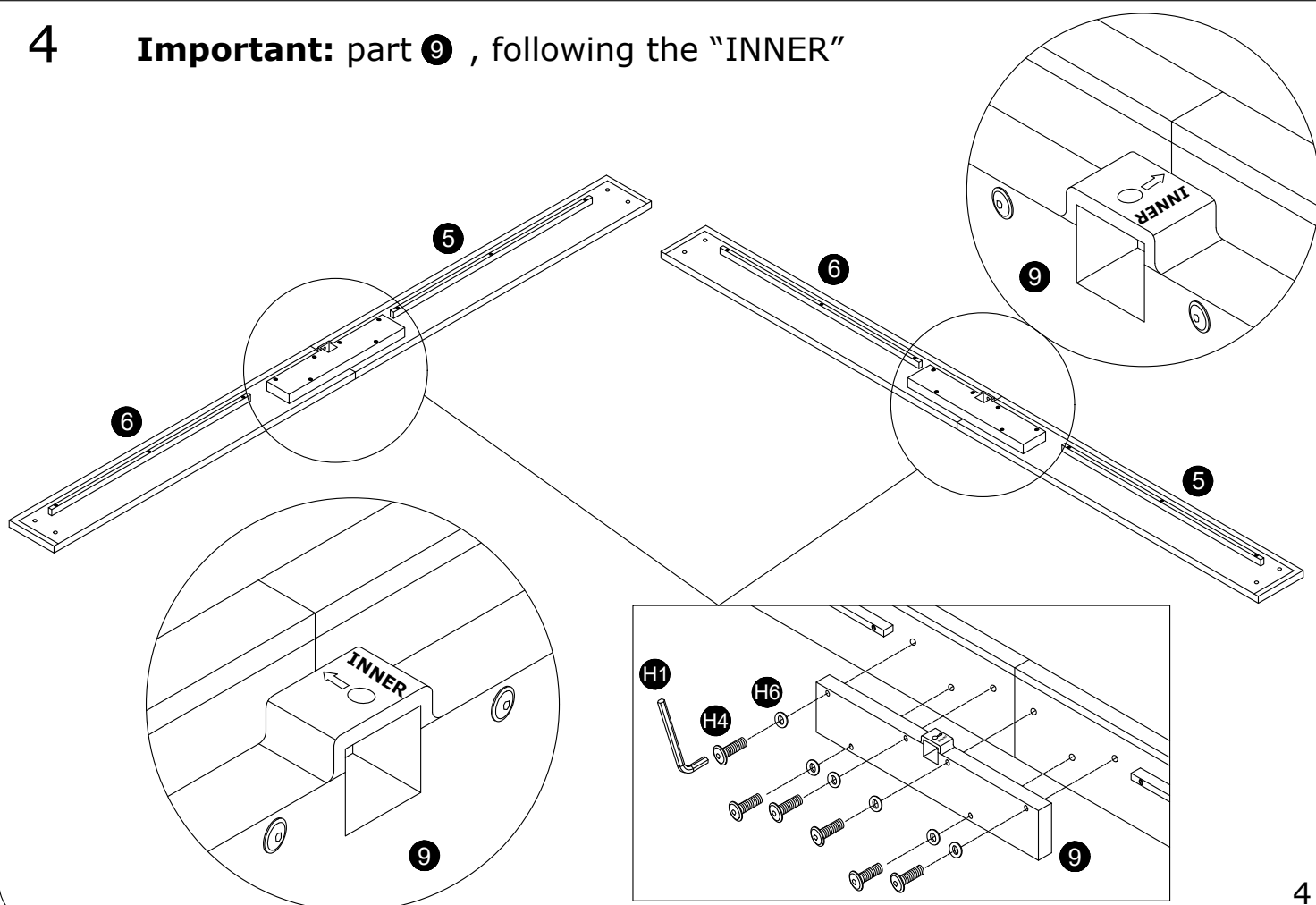

5 If can't assembly, checking STEP 4 if wrong

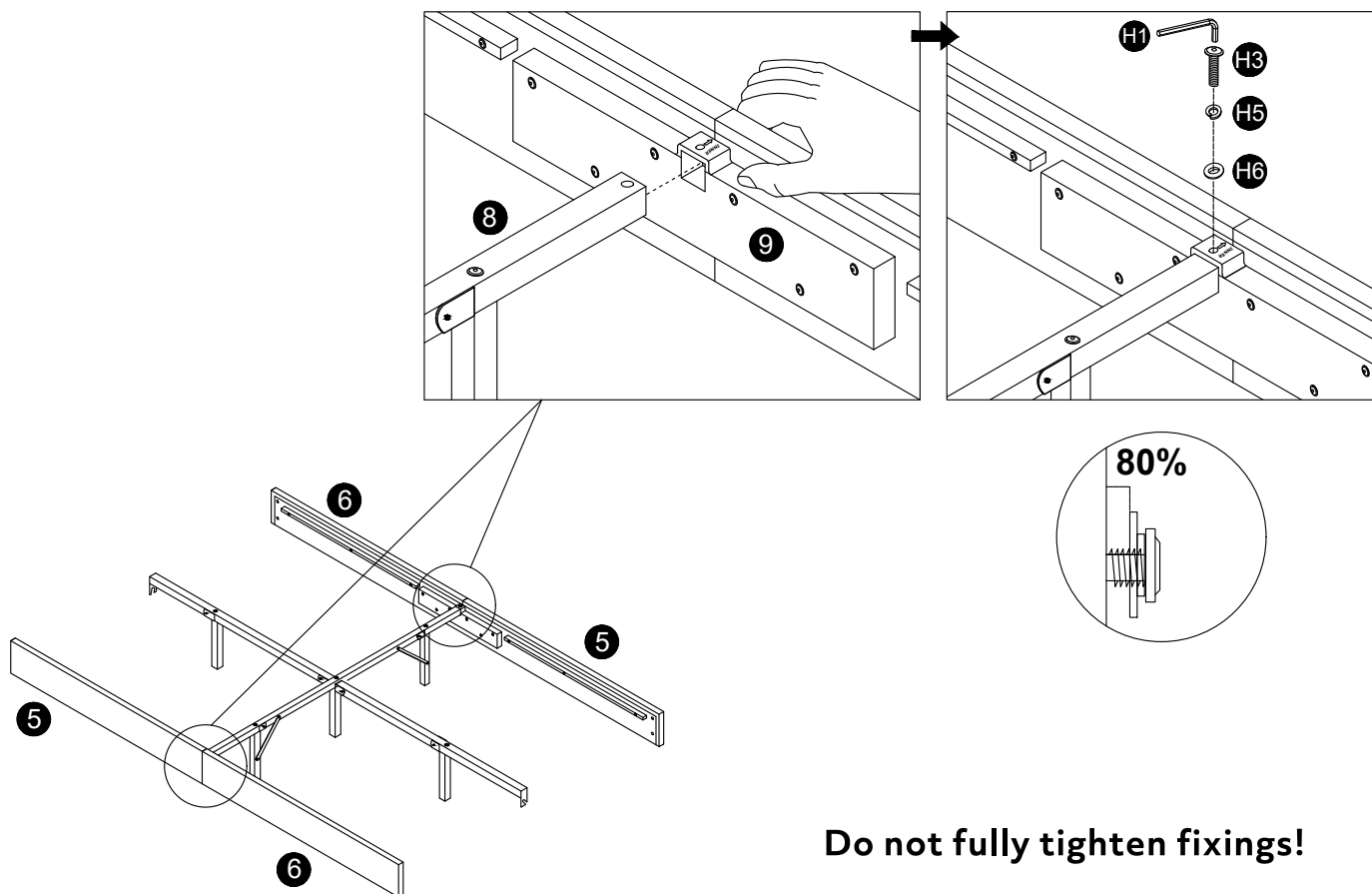

6

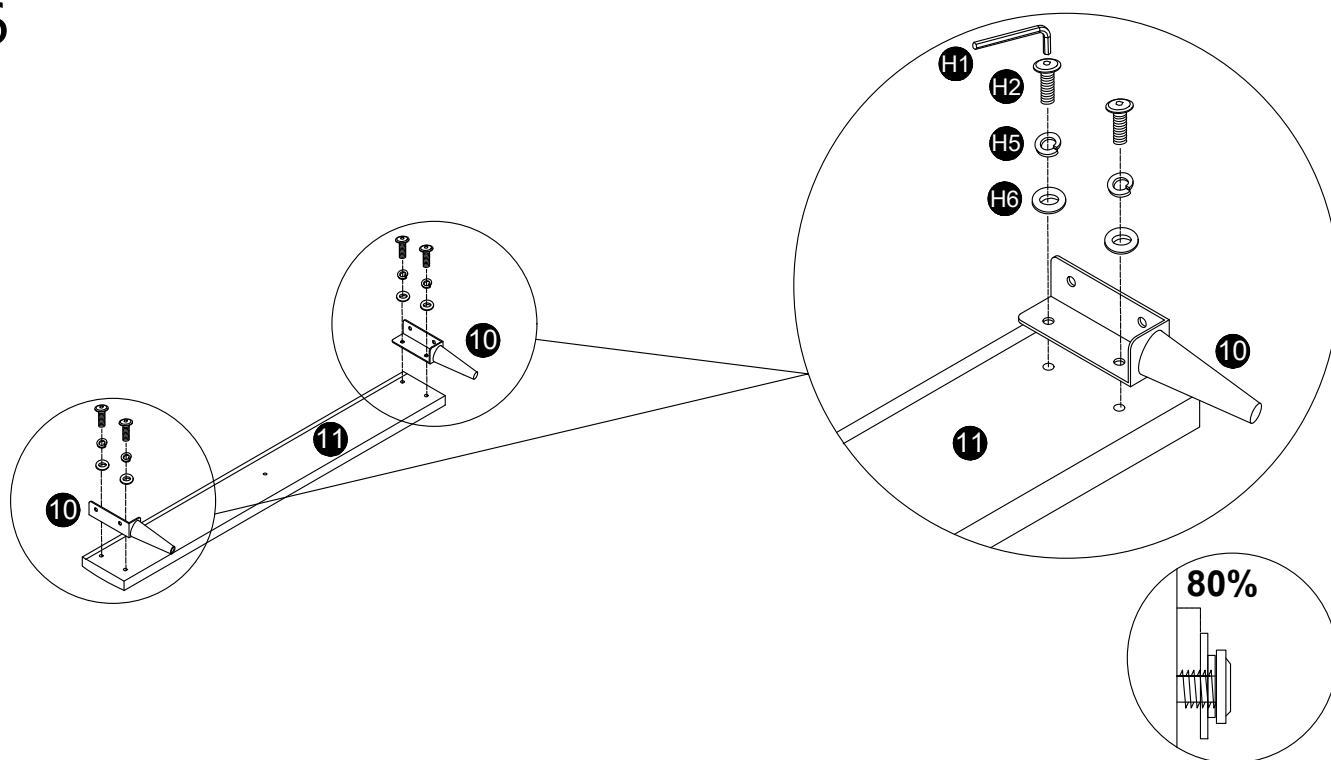

Do not fully tighten fixings!

7

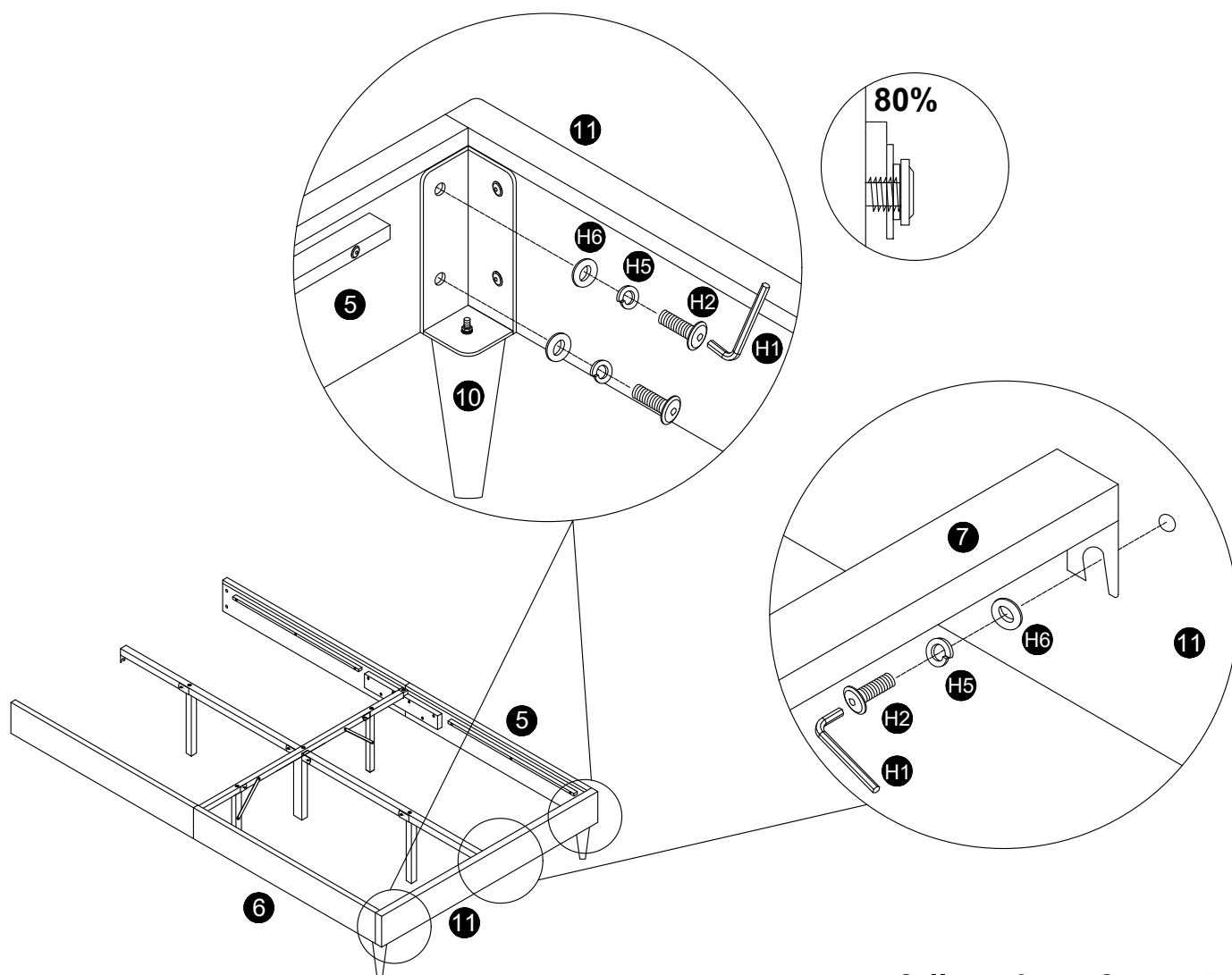

Do not fully tighten fixings!

8

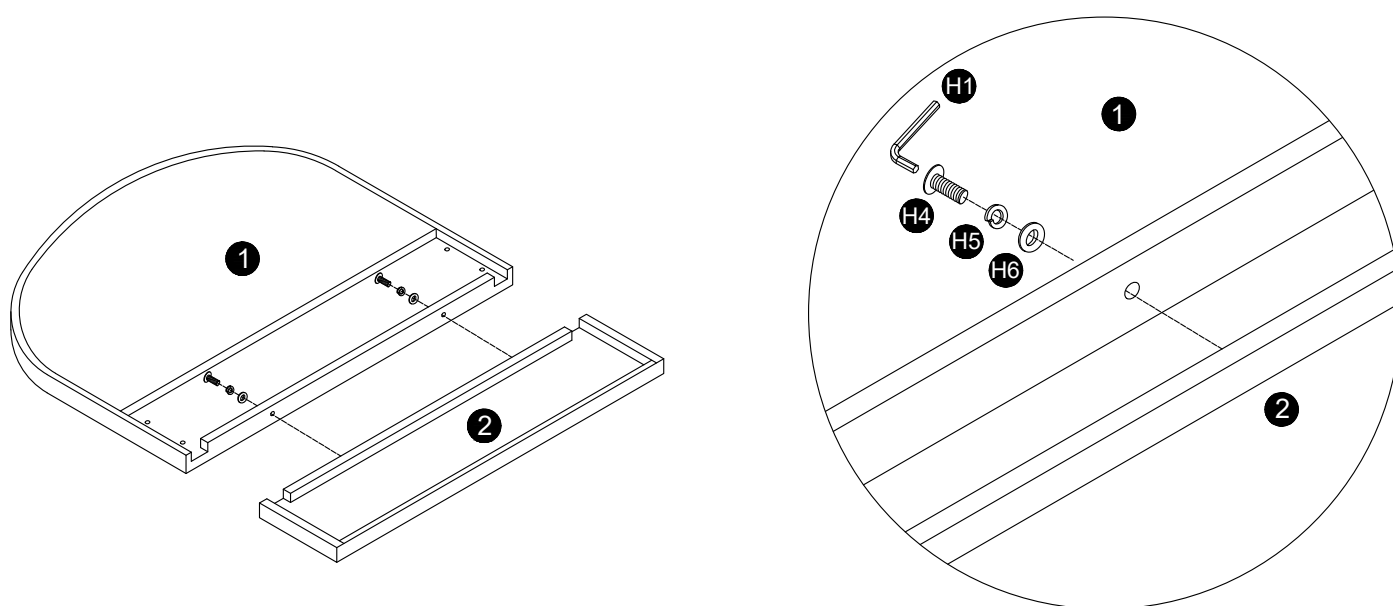

9

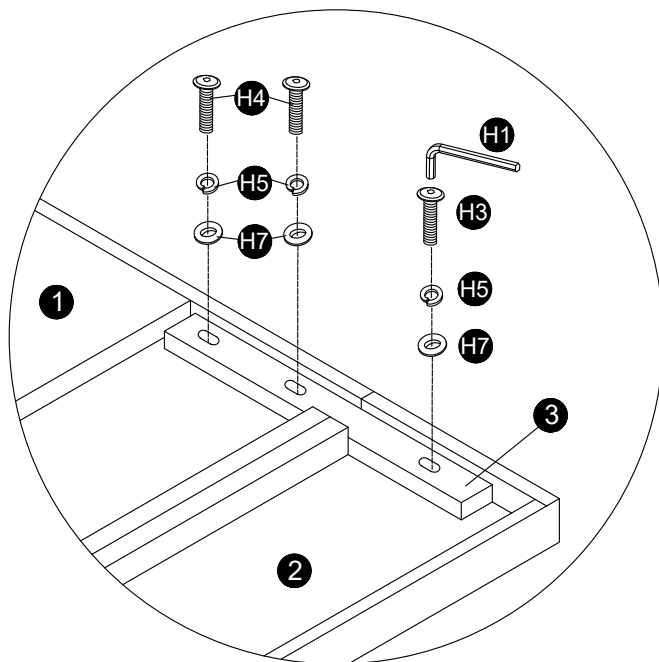
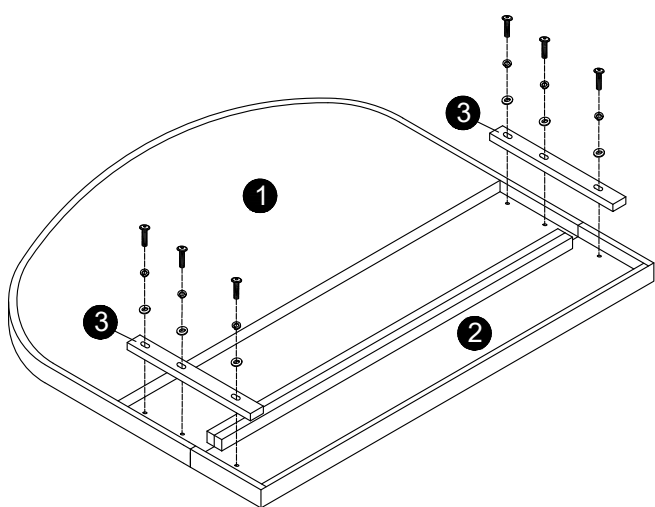

10

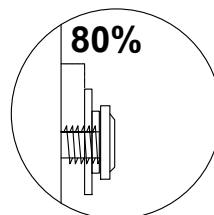
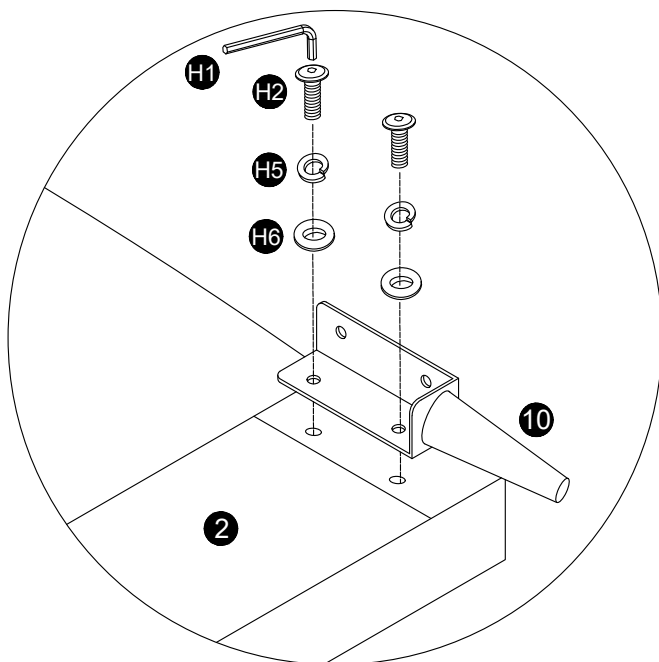
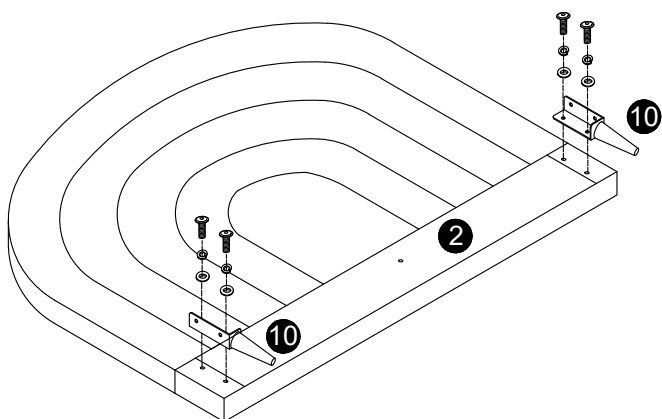

Do not fully tighten fixings!

11

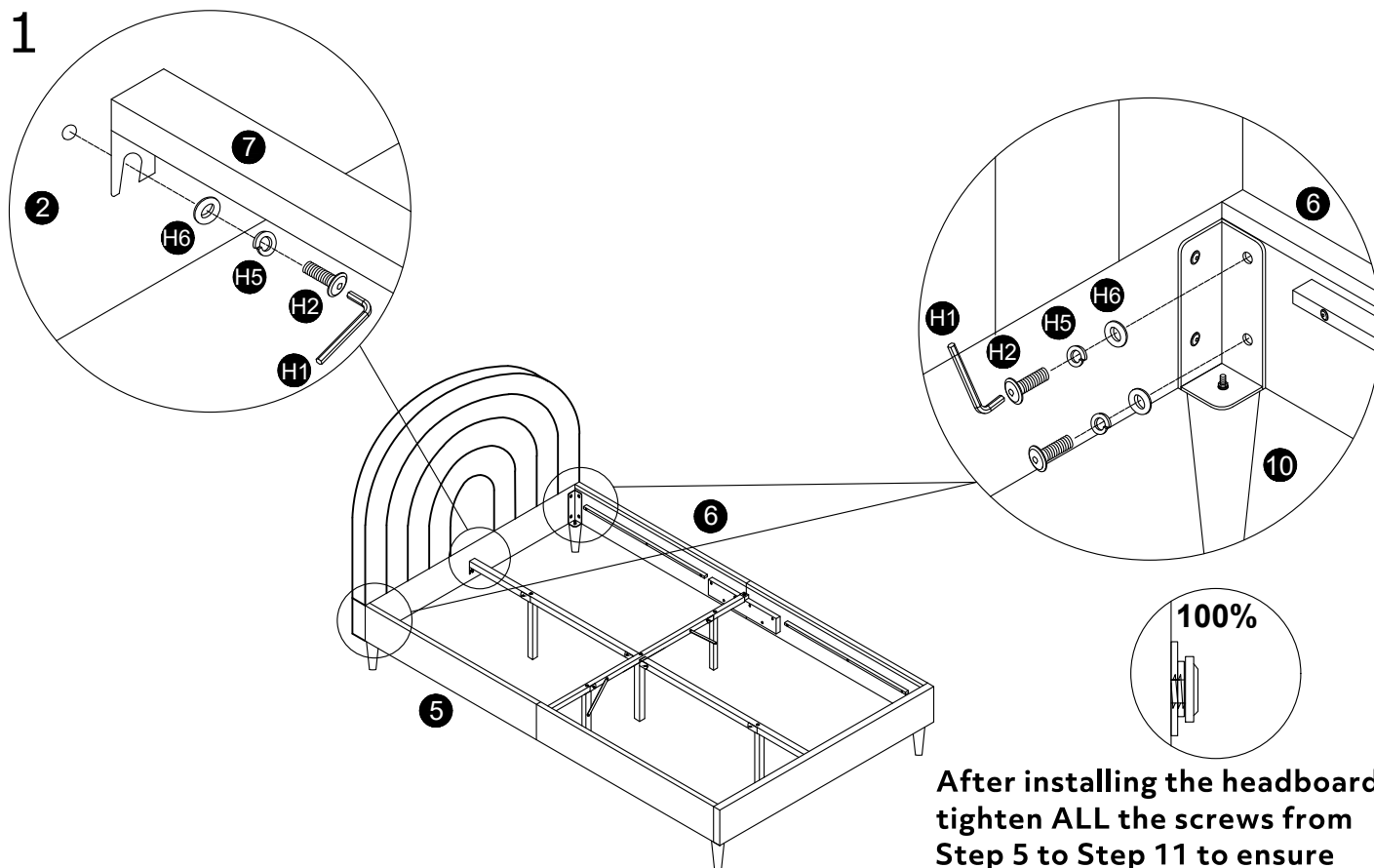

12

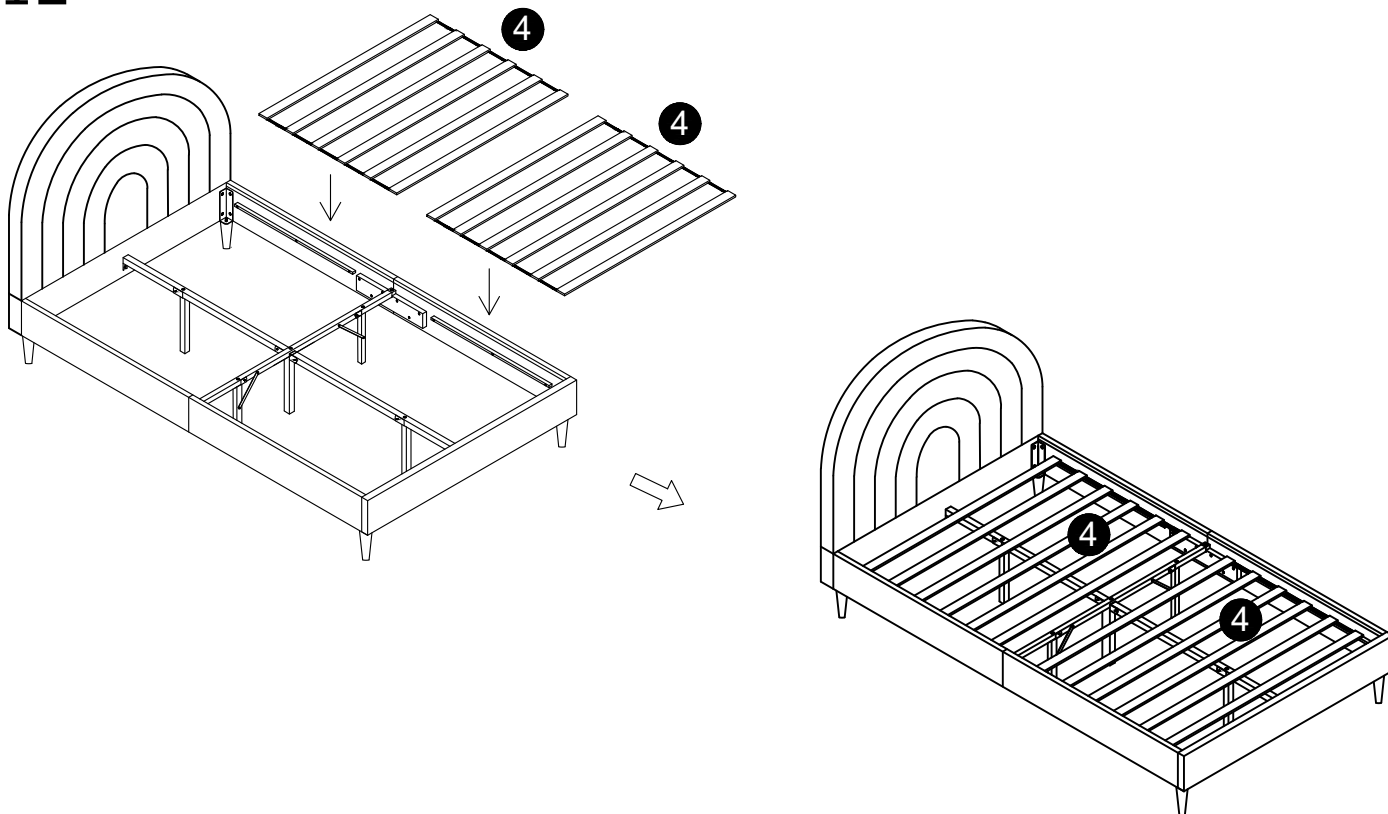

Job Complete !

In the interest of our environment please dispose of all packaging thoughtfully.