

ASSEMBLY INSTRUCTIONS

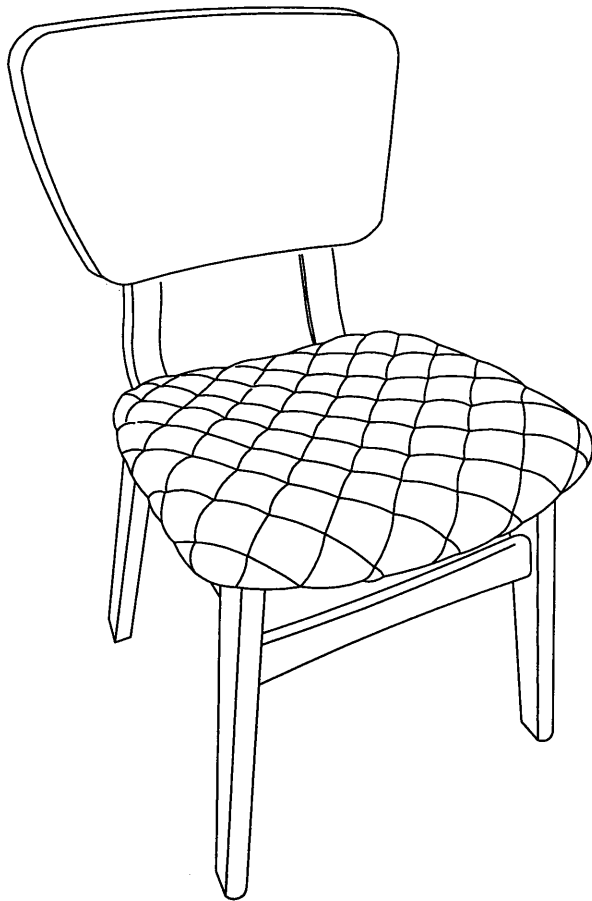

TOOLS REQUIRED



Allen Wrench

(Included)



Phillips
Screwdriver

(Not Included)



Rubber
Mallet

(Not Included)

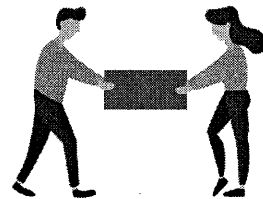

2 - People
Recommended

ASSEMBLY RATING



EASY —————> DIFFICULT

The Assembly Rating is a 5-point system showing the level of effort needed to assemble a specific product.

Thank you for your purchase!

We hope you enjoy this new addition to your home for many years to come.

Our commitment to providing quality products does not simply end when you purchase our product. We fully stand behind our products from start to finish.



CHECK BEFORE STARTING

Are you missing anything?

Double-check all parts, hardware and accessories listed on Page 6 are accounted for.

Check out our Quick Tips!

We recommend reviewing the pre-assembly handouts. Even experts need a refresher now and then!

Should we send any replacements?

Are there any irregularities or flaws in the parts? We can send replacements!

Prep Time!

Please review the assembly instructions and all diagrams prior to assembling. Arrange parts as recommended on Page 7 and group identical hardware together to make assembling easier.

PRE ASSEMBLY INTRODUCTION

We understand building ready-to-assemble furniture can be a challenging experience for some. To help avoid confusion, we have provided some helpful tips that may speed up the process.

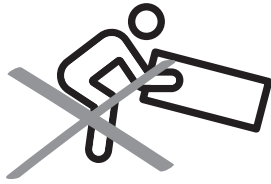

Teamwork

ALWAYS have at least two people to help with transporting and assembling the product to avoid potential injury and/or damage.

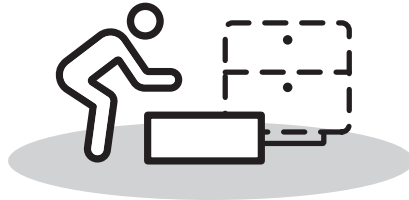
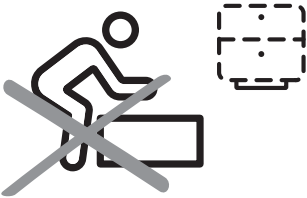

Suitable Location

Assembling near the area of the intended location is highly recommended.



Sufficient Space

Make sure you have enough space to move around during the assembly.

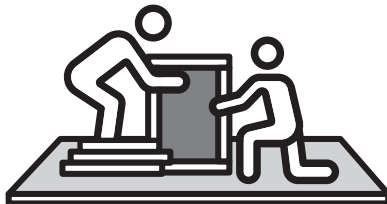

Avoid Scratches

Use cardboard, blankets or a carpeted area while assembling furniture to prevent scratches.

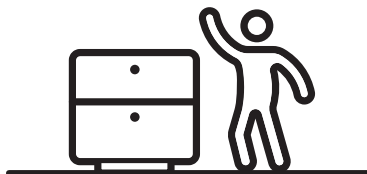
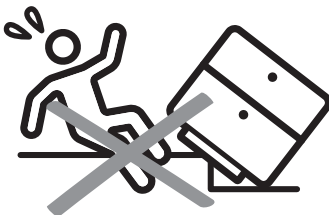

Flat Surface

Make sure the furniture rests on a flat and level surface with each leg evenly touching the floor.

ASSEMBLY AND CARE ADVICE



FAILURE TO FOLLOW THE GUIDELINES BELOW MAY RESULT IN INJURY AND/OR PROPERTY DAMAGE.



Position each part correctly and insert screws or bolts into their respective holes.

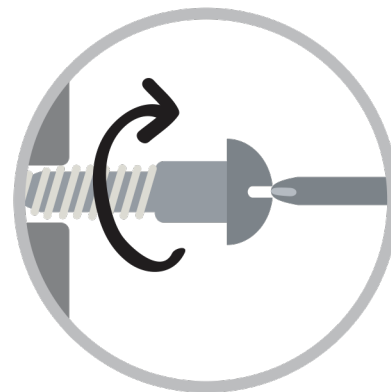

Turn clockwise to tighten and only tighten when step is completed or when instructed to do so.



Use the appropriate hand tools or power tools for assembly. Select steps, such as tightening screws and/or bolts, may require hand tools to avoid causing damage during assembly.



Save the instructions and store any supplied tools for later maintenance.

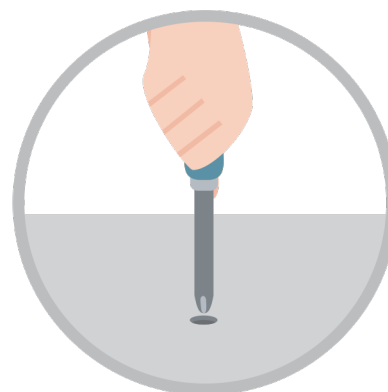

After two weeks, check and tighten any loose hardware and repeat again every six months thereafter.

IT IS THE USER'S RESPONSIBILITY TO MAINTAIN THE FURNITURE. THE HARDWARE MAY LOOSEN OVER TIME AND MAY CAUSE THE FURNITURE TO BE WOBBLY AND UNABLE TO SUPPORT ITS INTENDED WEIGHT CAPACITY. THIS MAY LEAD TO COLLAPSE AND MAY CAUSE SERIOUS INJURY.

SIDE CHAIR

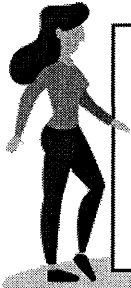

- Please keep instructions for future reference.
- Check the quantity and irregularity of parts and hardware before you start.

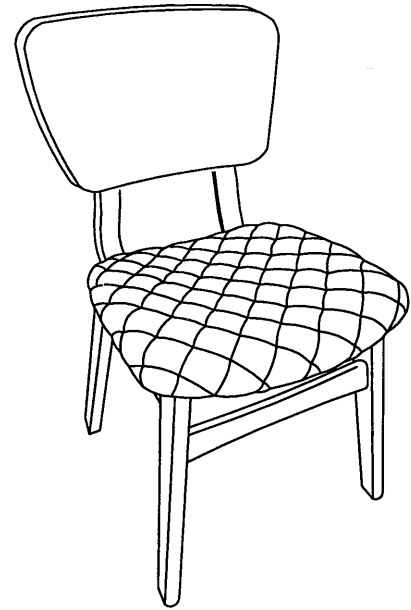

PARTS

#1 1pc



Back Rest

#2 1pc

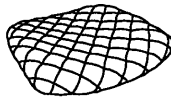

Seater

#3 2pcs



Rail Support

#4 1pc

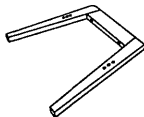

Left Leg

#5 1pc

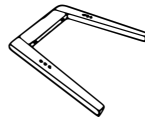

Right Leg

#6 2pcs



Back Support

HARDWARE

#A 4pcs

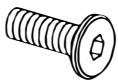

Bolt M6 x 25mm

#B 4pcs

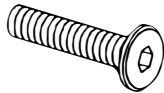

Bolt M6 x 50mm

#C 4pcs



Lock Washer M6

#D 4pcs



Nylon Washer M6

#E 4pcs

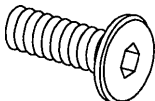

Bolt M8 x 35mm

#F 4pcs



Lock Washer M8

#G 4pcs



Flat Washer M8

#H 10pcs

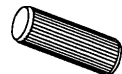

PVC Dowel M8 x 30mm

#I 4pcs

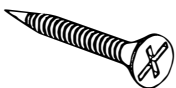

Screw M4 x 38mm

#J 4pcs



Wood Button

#K 1pc

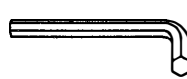

Allen Wrench M4

#L 1pc

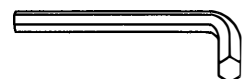

Allen Wrench M5

ASSEMBLY INSTRUCTIONS

1

- Part #3 x2pcs
- Part #4 x1pc
- Part #5 x1pc
- Hardware #H x10pcs

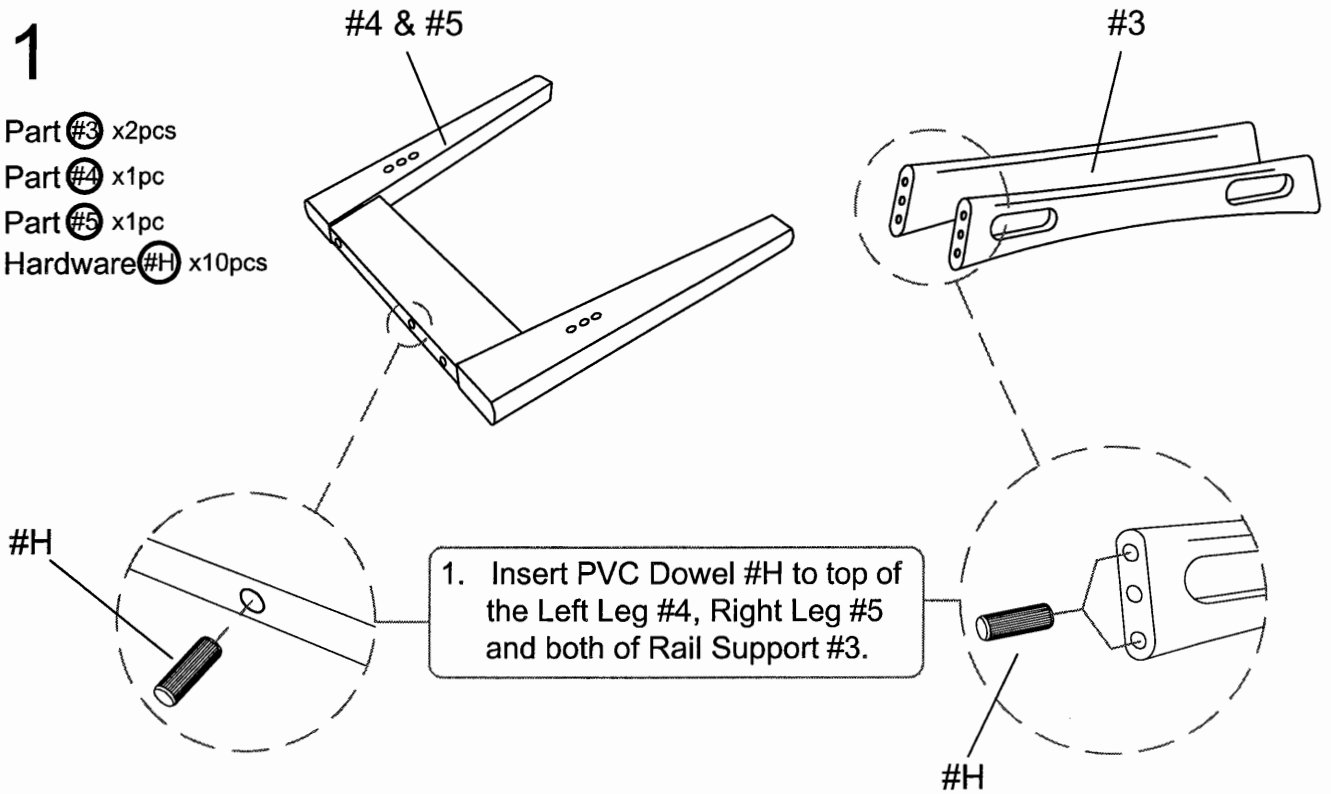

2

- Part #3 x2pcs
- Part #4 x1pc
- Part #5 x1pc
- Hardware #B x4pcs
- Hardware #D x4pcs

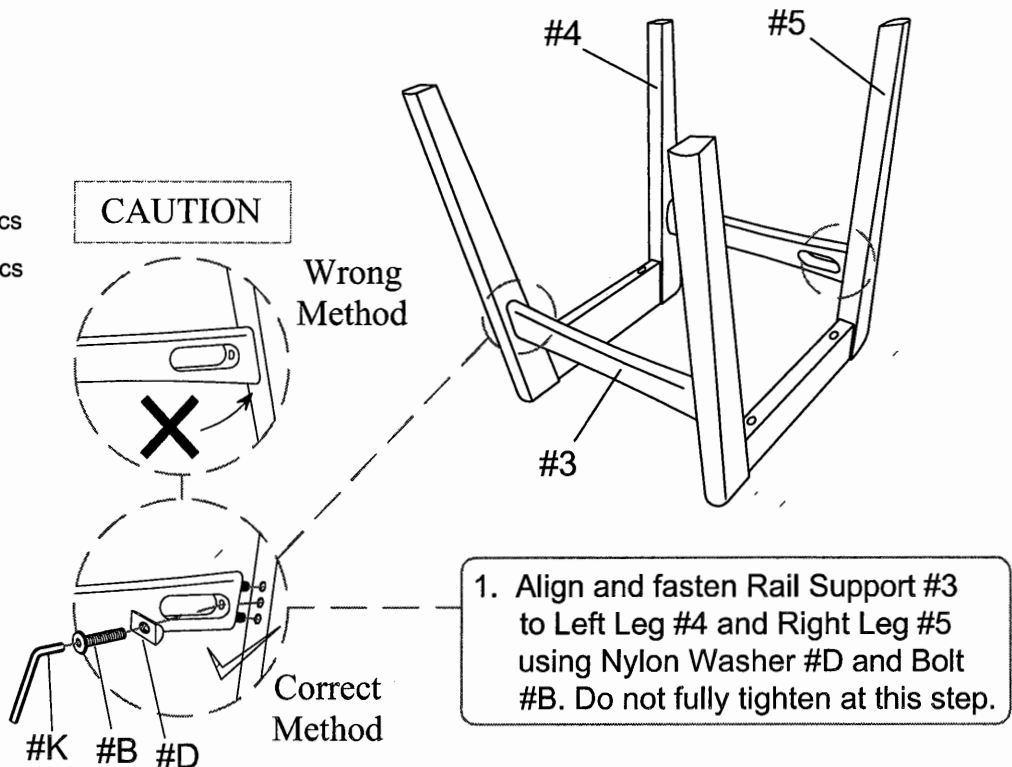

ASSEMBLY INSTRUCTIONS

3

Part #2 x1pc
Hardware #I x4pcs

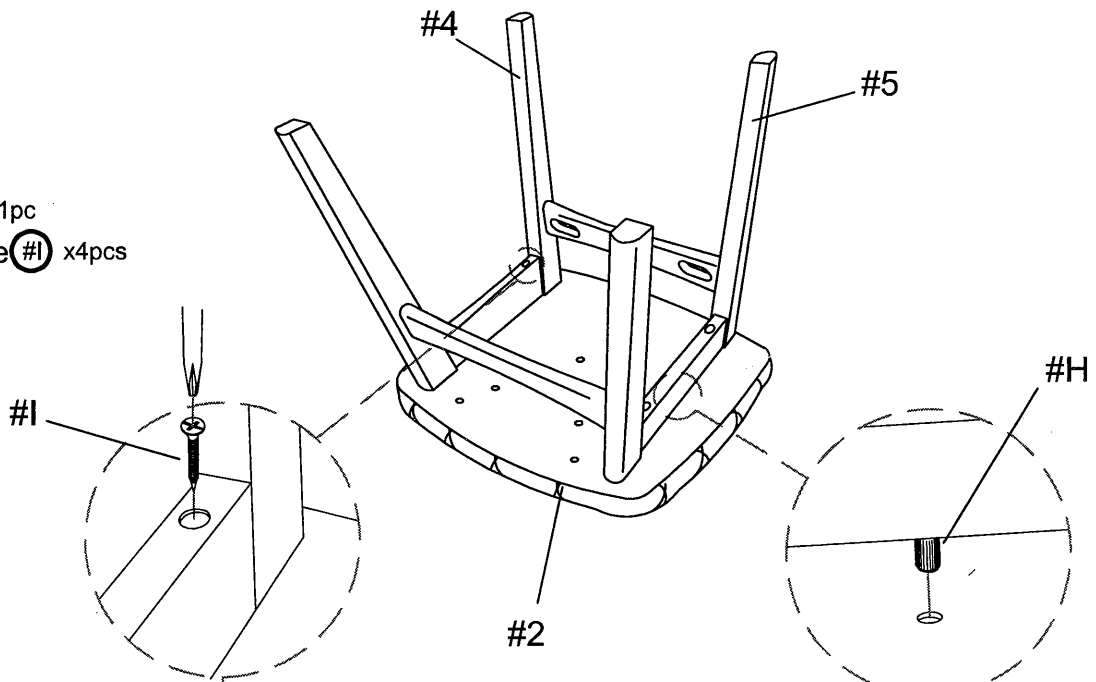

2. Align and fasten the Both Leg #4 & #5 to Seater #2 by using the CSK Screw #I and fully tighten with screwdriver (NOT INCLUDED).

1. Align and insert PVC Dowel #H to bottom of Seater #2.

4

Part #6 x2pcs
Hardware #E x4pcs
Hardware #F x4pcs
Hardware #G x4pcs

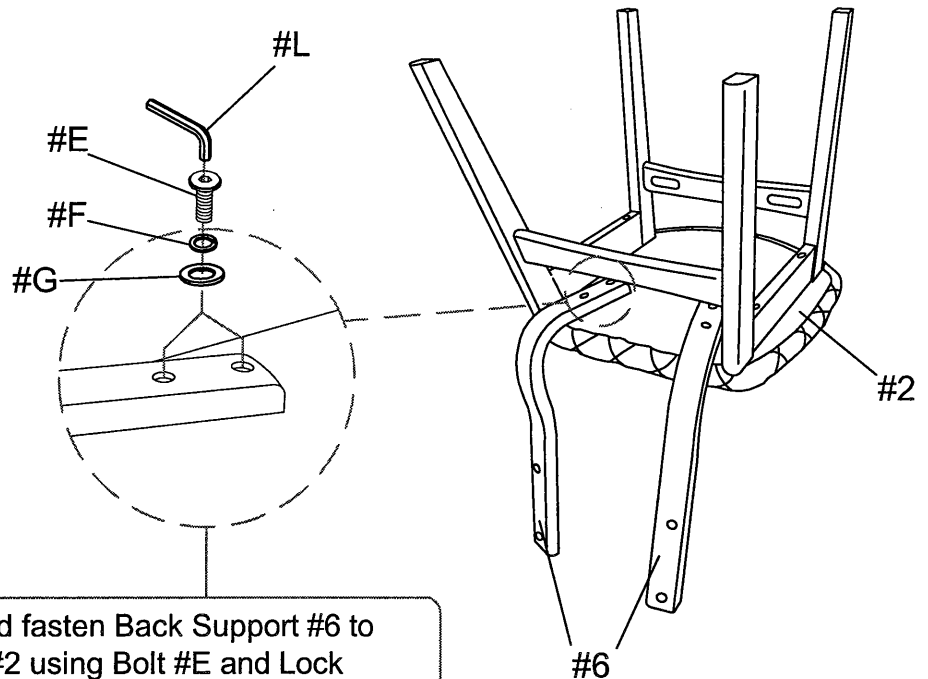

1. Align and fasten Back Support #6 to Seater #2 using Bolt #E and Lock Washer #F and Flat Washer #G and do not fully tighten with Allen Wrench #L.

ASSEMBLY INSTRUCTIONS

5

- Part #1 x1pc
- Hardware #A x4pcs
- Hardware #C x4pcs
- Hardware #J x4pcs

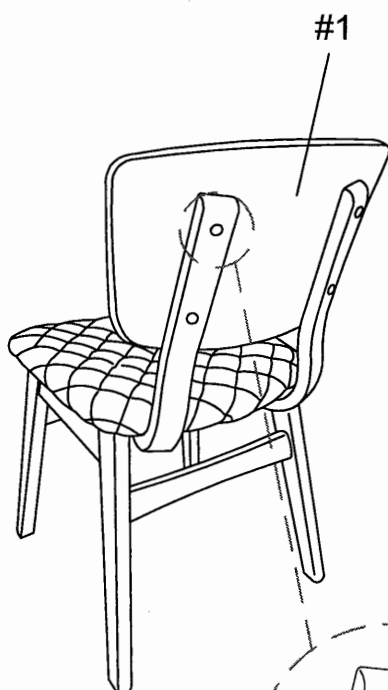

1. Align and fasten Back Rest #1 to Back Support #6 using Bolt #A and Lock Washer #C and fully tighten with Allen Wrench #K. Insert Wood Button #J to cover the open hole of the Back Support #6 and light tap with rubber mallet (NOT INCLUDED). **Fully tighten all the bolt.**

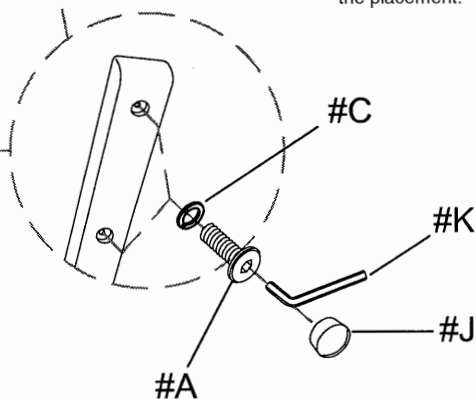

ASSEMBLY COMPLETED



Please ensure the furniture rests on an even and flat surface. If the product wobbles or feels loose, double-check all bolts and/or screws are properly tightened and secured.



Keep this handy!

Please retain this instruction manual and any order-related information for future reference.



Lift, don't drag!

To avoid damage to product please always LIFT the product when transporting or adjusting the placement.