

Safety precautions:

1. Turn off electrical power before starting installation of light fixture.
2. This product must be installed in accordance with the applicable installation code by a person familiar with the construction and operation of the product and the hazards involved.
3. Caution risk of fire . Consult a qualified electrician to ensure correct branch circuit conductor.
4. For Exetemal use only, recommend applying waterproof silicone to seal around trim and ceiling.

FLUSH MOUNT

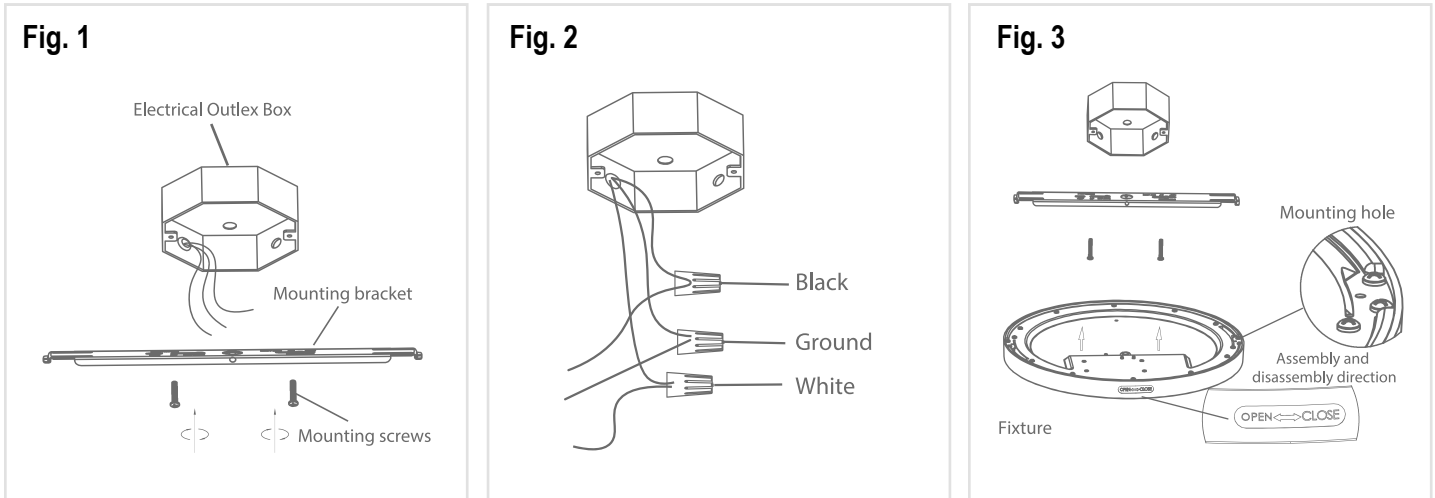

Installation Steps:

1. Prior to installation, install mounting bracket into the electrical outlet box with mounting screws. (Fig. 1) Drive screws completely to the end of the junction box.
2. Connect supply wires to wires on fixture with wire nuts or push wires into Quick Connector. (Fig. 2) Connect white to white, black to black, and copper wire to copper wire as grounding connection.
3. (Fig. 3) Attach the fixture to the mounting bracket; Screw the fixture to the mounting bracket in the direction of assembly and disassembly shown on the fixture