

EXTENDABLE 48" ROUND DINING TABLE ASSEMBLY INSTRUCTIONS

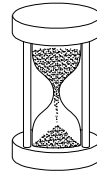

15 MIN

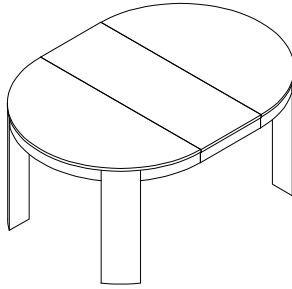
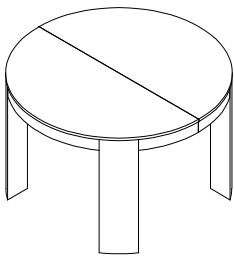
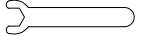
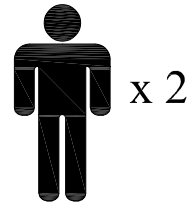

TOOLS REQUIRED
(Wrench provided)

PART LIST

| No. | Description | Sketch | Quantity |
|-----|----------------|--------|----------|
| 1 | TOP | | 1pc |
| 2 | LEGS | | 4pcs |
| 3 | EXTENSION LEAF | | 1pc |

HARDWARE LIST

| No. | Description | Sketch | Size | Quantity |
|-----|---------------|--------|---------------|----------|
| A | Bolt | | M8 x 50mm | 16pcs |
| B | Spring Washer | | M8 x 2 x 13mm | 16pcs |
| C | Flat Washer | | M8 x 2 x 19mm | 16pcs |
| D | Wrench | | 13 x 85 mm | 1pc |

STEP 1

Center legs at the corner and align with pre-drilled holes. Secure and tighten screws to attach the leg

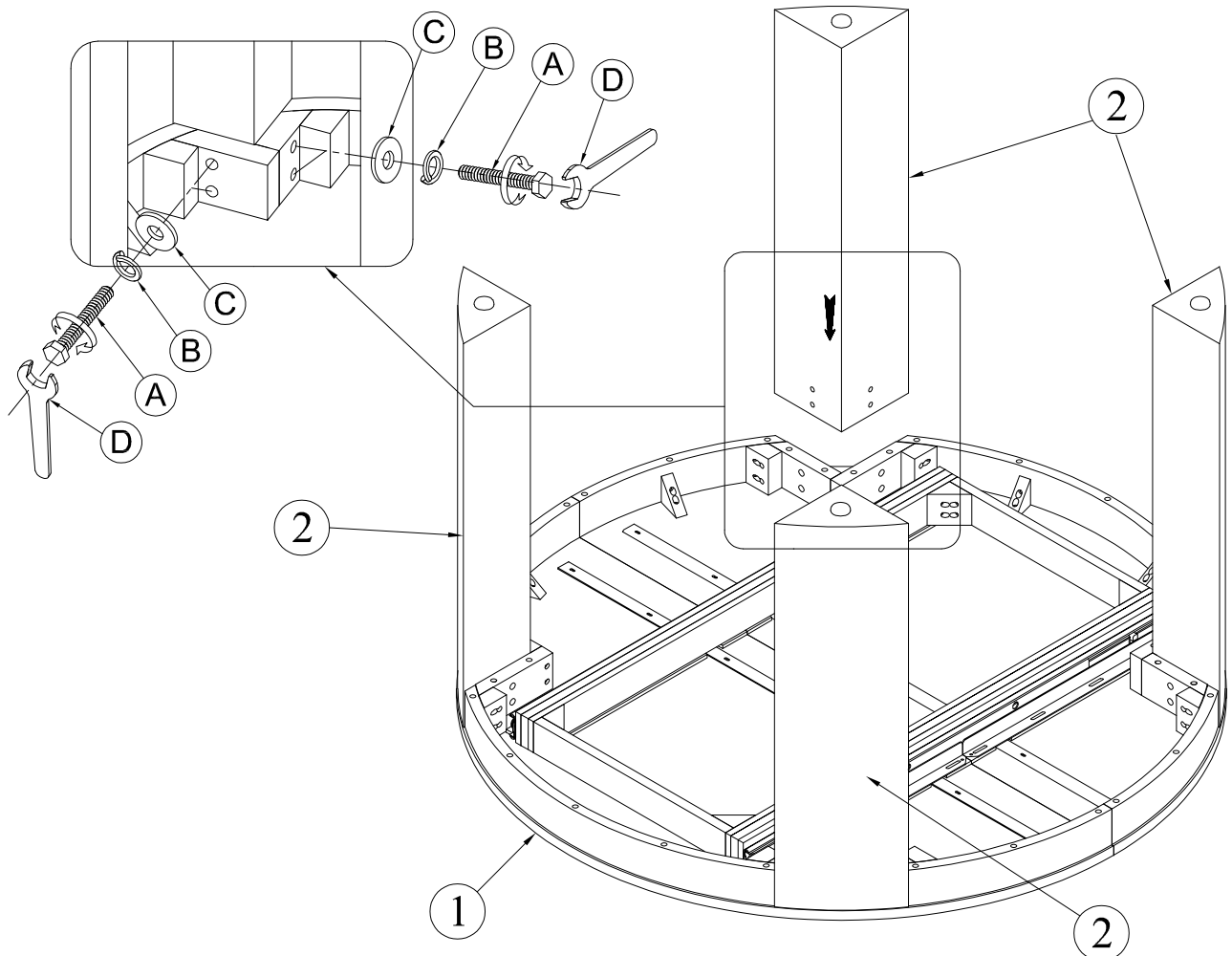

EXTENDABLE 48" ROUND DINING TABLE ASSEMBLY INSTRUCTIONS

STEP 2

Repeat this step in all 4 corners to install the legs

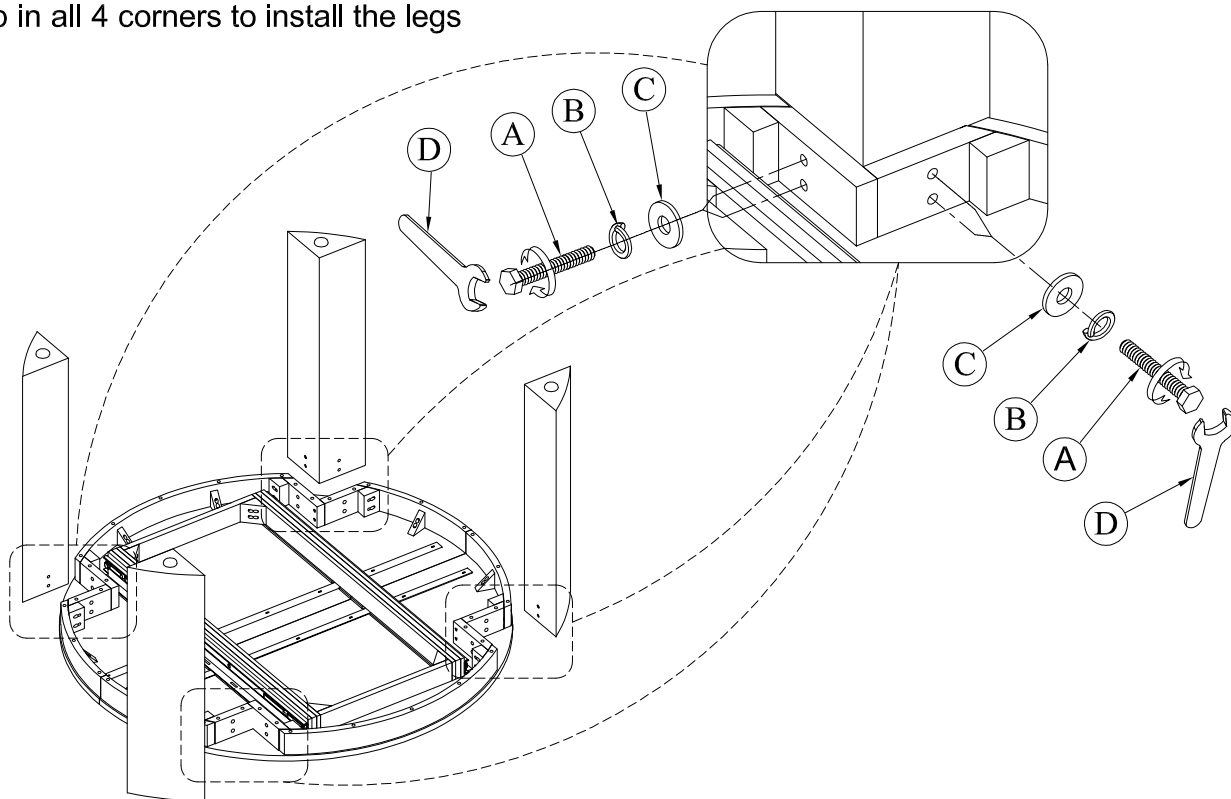

STEP 3

Carefully reposition the table upright and move
TABLE LOCKS to open position (see image).

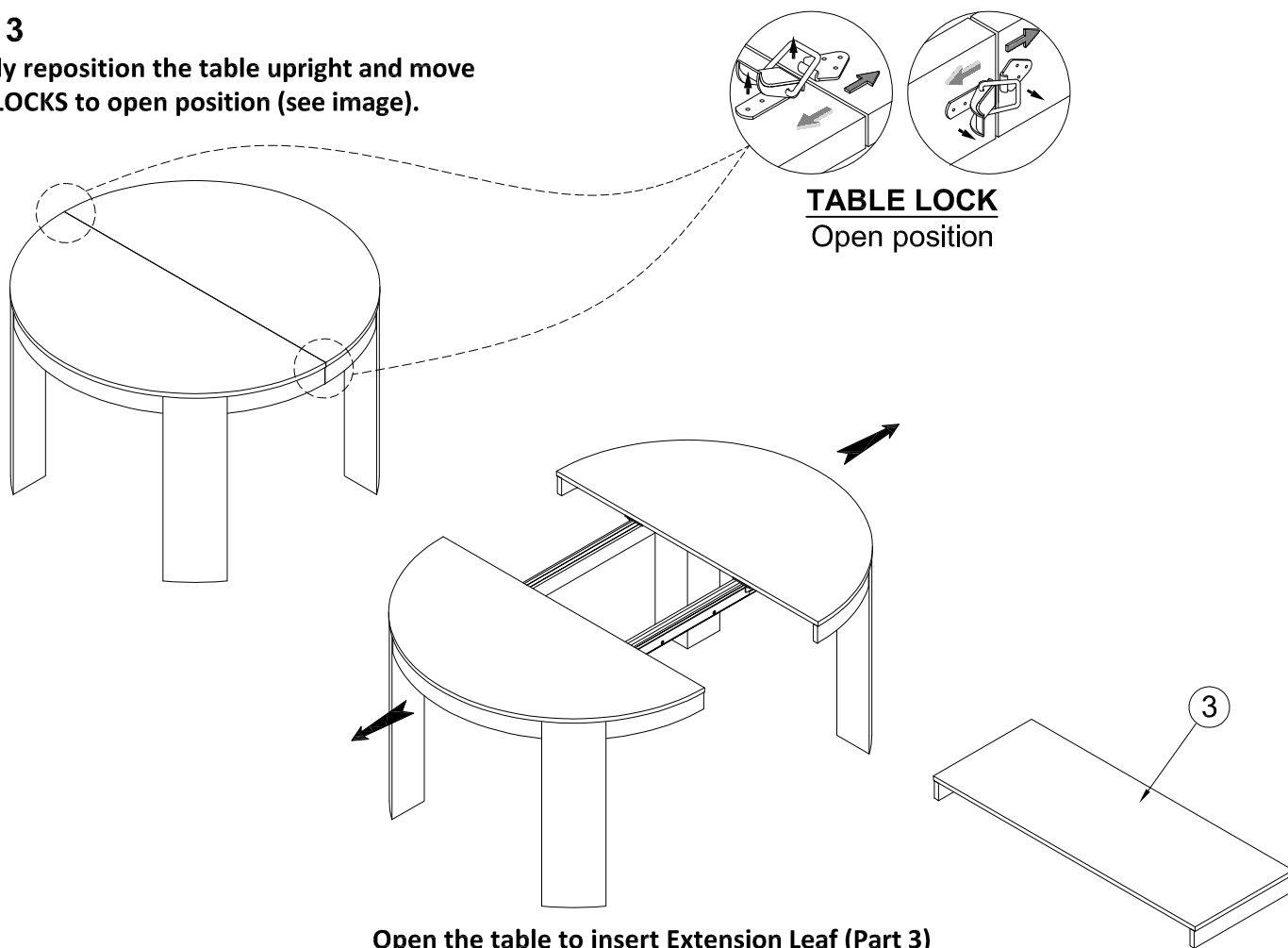

Open the table to insert Extension Leaf (Part 3)

EXTENDABLE 48" ROUND DINING TABLE ASSEMBLY INSTRUCTIONS

STEP 4

Reposition the Extension Leaf at the center of the table and align with the rest of the table. Move both parts of the table (left and right) close to the Extension Leaf and ensure there are no gaps.

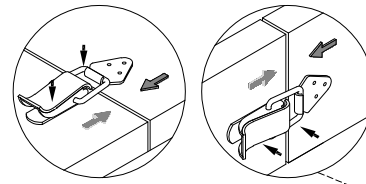
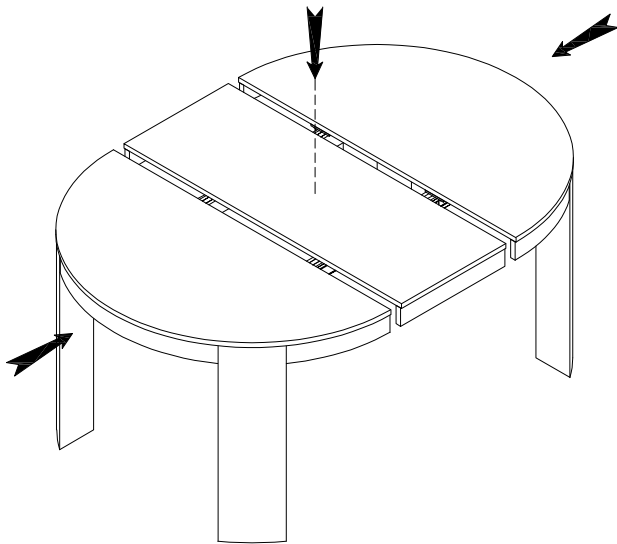
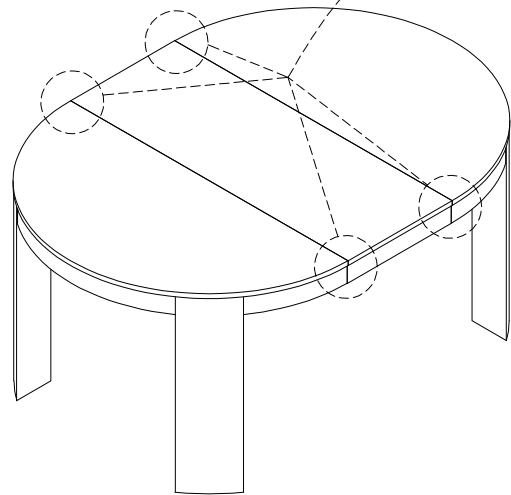
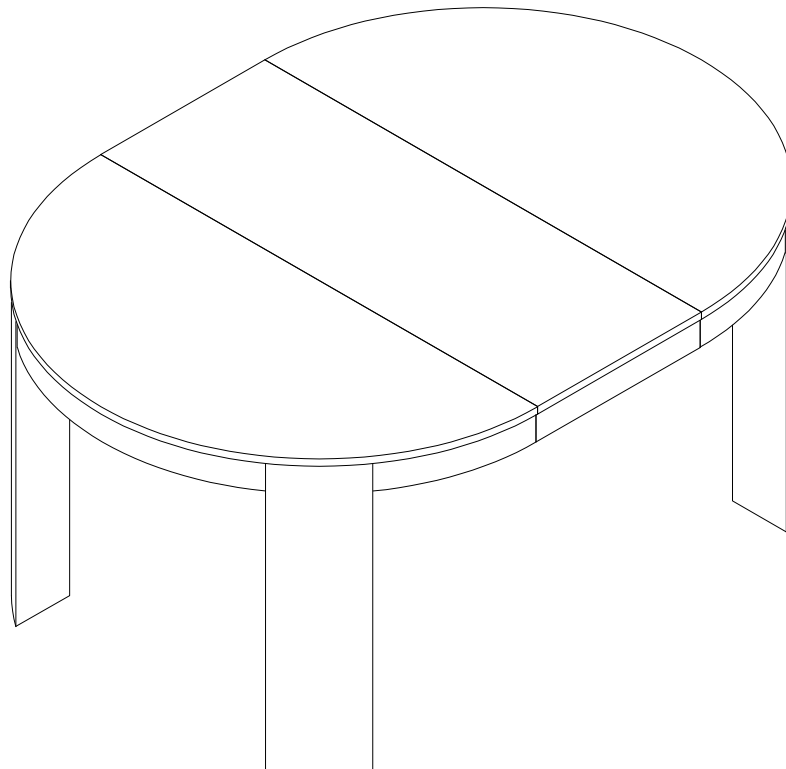

TABLE LOCK
Closed position



Move TABLE LOCKS to the Closed Position (see image), to secure all parts of the table top.

ASSEMBLY COMPLETE



**CAUTION ! : REQUIRES TWO ADULTS TO FLIP AND TURN
TABLE UPRIGHT AFTER ASSEMBLY IS FINISHED.**