

Genuine Hardwood Wall Planks Installation Instructions

READ THESE INSTRUCTIONS THOROUGHLY BEFORE BEGINNING INSTALLATION.

Required tools and materials: J-roller (see Step 10), 4' level, TSP (trisodium phosphate for cleaning sub wall see Step 1), Pencil, Saw (Miter Saw, Jigsaw, Hand Saw with Miter Box, or Utility Knife), Hammer & Finish Nails



Inspect planks thoroughly prior to installation. If boards are not acceptable, do not install. In order to insure proper adhesion and to avoid future movement such as gapping between boards and cracking on the face of the planks, permanent HVAC must be on and maintained between 60° - 75° F with a relative humidity in the home between 30-55% for a minimum of 14 days prior to installation as well as during and after installation. To accommodate for any changes in humidity, allow 1/4" expansion space for every 10' of wall on all sides.

The planks can be installed on any structurally sound, clean, dry, and flat surface. DO NOT install as flooring. Cement block, plaster and gypsum surfaces should have a minimum of one coat of primer sealer prior to installation. It is not recommended to install planks in high moisture areas such as bathrooms and steam rooms.



1. Clean the wall surface. Turn off power to installation area while working around wall outlets and light switches. Remove electrical cover plates, protruding nails and loose paint. Sponge wash with TSP (trisodium phosphate), available in hardware stores or home centers, to remove residues of greasy grime, mildew, chalked paint or anything that might affect the bond of the Vacubond™ adhesive. If wall has a heavy drywall texture, it will need to be block sanded and primed so the Vacubond™ adhesive can achieve a firm bond. Wallplanks can be installed over well bonded smooth wallpaper. Textured wallpaper should be removed and wall cleaned with TSP prior to installing wallplanks.

2. Work from several open boxes and "dry lay" before permanently installing to create your desired look. This step is especially important for the options with multicolor boards in each carton.



3. For walls that have outside corners, a trim piece may need to be purchased separately to create a finished look. If trim pieces are needed on your project, measure 1 3/4" back from where you wish the wall to end and then draw a vertical plumb line using your level. This line will be your guide to where the planks need to be cut. The trim piece is made to overlay the edges of the plank and should be nailed to the wall using small finish nails after the entire wall is installed.

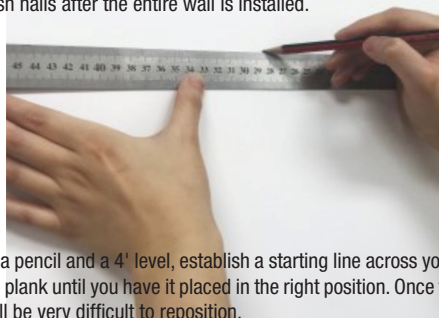

4. With the use of a pencil and a 4' level, establish a starting line across your wall at eye level. DO NOT adhere the plank until you have it placed in the right position. Once the material is adhered to the wall it will be very difficult to reposition.



TIP: To help ensure an absolute straight starter line with the first plank, we recommend you tap 1 1/2" finish nails halfway into the wall along the starting line at every 12". The protruding nails will help position the starter planks along the starting line before they are adhered to the wall. This procedure will not be possible when installing over a block wall. Use extra caution to ensure your first row is straight if you are not able to use nails as a guide.



5. Starting on the left side of the room, using the starting line (and nails) as a guide, peel the paper off the Vacubond™ adhesive and position the starter row planks groove side up along your line. Press into place. If you placed positioning nails in the wall in Step 4, remove them now.

6. Now that your level starter row is in place, stagger the end joints as you work your way up and down the wall, so that your end joints do not match up from row to row. To accomplish this look and minimize your waste, use your cut off piece from one row to start the next row.

7. Mark locations of light switches, electrical outlets and air vents on the planks before removing the paper liner on the tape. Cut and trial fit before installing. These cuts can be made using a drill to create a starter hole if necessary and then cutting with a jig saw or scroll saw.



8. Planks can be cut to fit by using an electric miter saw, a hand saw and miter box or by using a square as a guide and scoring the top and bottom surface with a utility knife and snapping through the high density fiberboard core at the cut mark. If the planks are cut by hand, a sanding block will be needed to smooth the cut edges.

9. When installing your top and bottom rows, the planks can be ripped lengthwise by using a jigsaw or table saw.



10. **Important!** To help set the Vacubond™ adhesive after the installation is complete, the wall **must** be rolled using a J-roller to insure the bond. Not using a J-roller can lead to failed adhesion. If a trim piece is used to finish installation, it can be installed now. Refer to Step 3 for trim installation instructions.

11. For installation on ceilings, follow steps 1-10 and use 18 gauge finish nails every 16" on both sides of the plank to further secure the planks to the ceiling.

Wall Planks Care and Cleaning:

- Your wall planks are virtually maintenance free. Normal dusting with a clean, dry cloth should be the primary cleaning method. As needed you can damp wipe using water only. Never saturate your wood walls. Slightly damp (wring out) cloth only. Never use wax, detergents, polishes, abrasive cleansers or use oil-based products on your wall.

- Hanging pictures and other wall Décor: Wall planks are not load bearing. Wall Décor like mirrors, pictures, and shelves can be mounted by drilling through the Wallplanks™, provided the underlying wall provides sufficient support (i.e. wall studs). Use proper hardware to install any wall decor.