

■ After-Sale Support

Dear Customer,

Thank you so much for purchasing our product. We sincerely appreciate your choice to incorporate our product into your living space.

Our goal is to build a mutually beneficial relationships with customers and we aim to be a reliable and recommendable brand.

We sincerely hope this product meets your expectations and that you would consider us again for your future needs.

When you receive the package, please kindly double check your package and accessories to be sure that you have all the necessary parts.

Should you have any questions, please contact us through the original purchase platform.

We will reply to each message within 24 hours and spare no efforts to help you as always.

Thank you once again for choosing us. Here's to creating wonderful memories and comfortable spaces together!

Kindest Regards,
Customer Care Team

CLOTHES RACK

ASSEMBLY INSTRUCTIONS

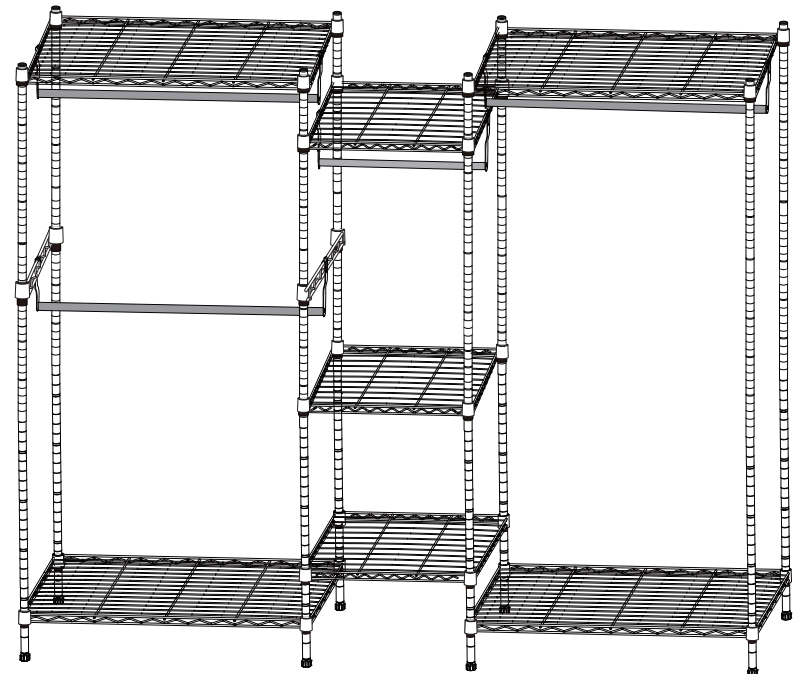

Please check all parts and accessories according to the parts list before assembling, make sure all contents are sufficient and in good condition.

If there is any parts missing or defective, please contact us immediately with purchase platform message to get replacement parts.

Please Kindly Notice That:

1.Part L are used as groups (2 pcs in a group). Multiple clearance existing between 2 plastics clips when they have been attached to the poles are not indicative of any quality issue but rather a structural design based physical law of thermal expansion and contraction, which is intended to make the metal steel rack firmly fastened to the poles.

2.When assembling, please pay attention to avoid finger being pinched.

3.During installation, you can adjust the height of each shelf.

PARTS:

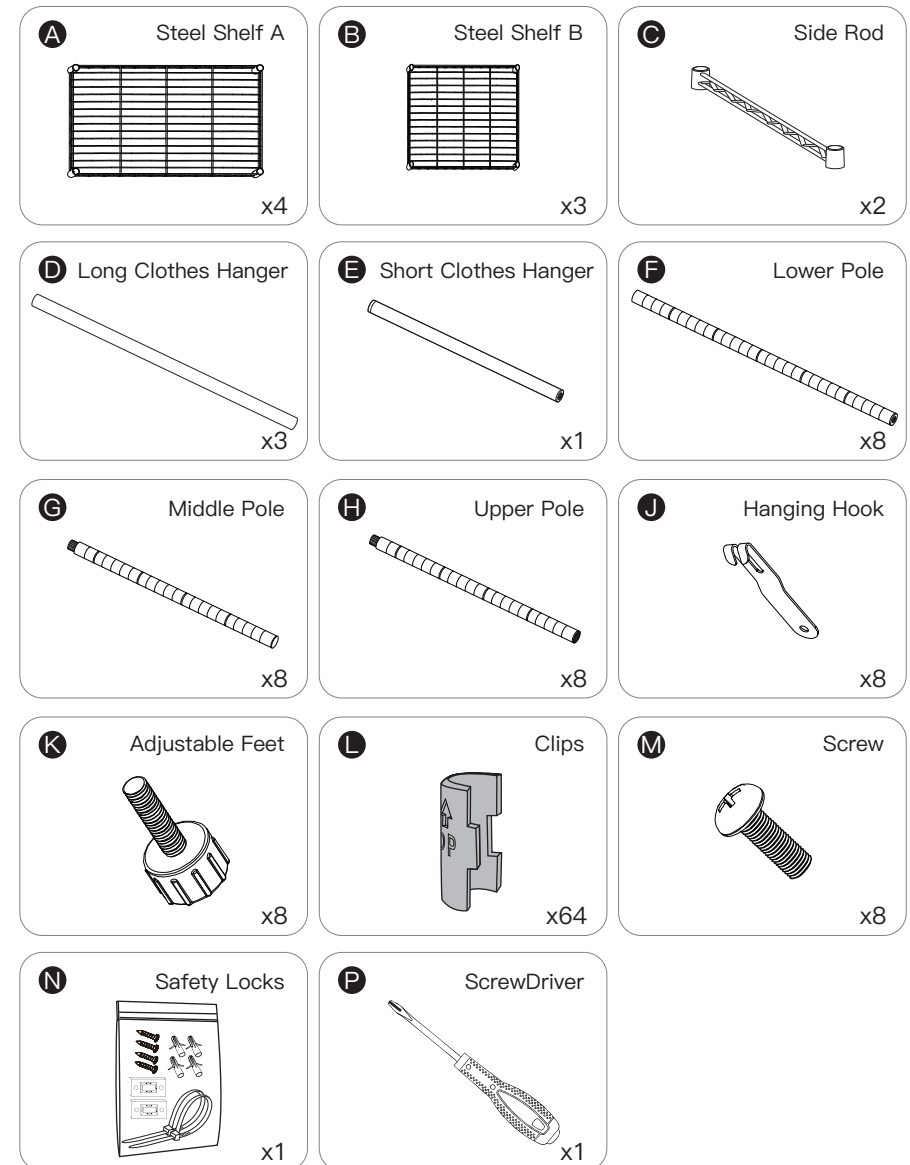

2 OPTIONAL LAYOUT AVAILABLE

TYPE-H
PAGE 4-17

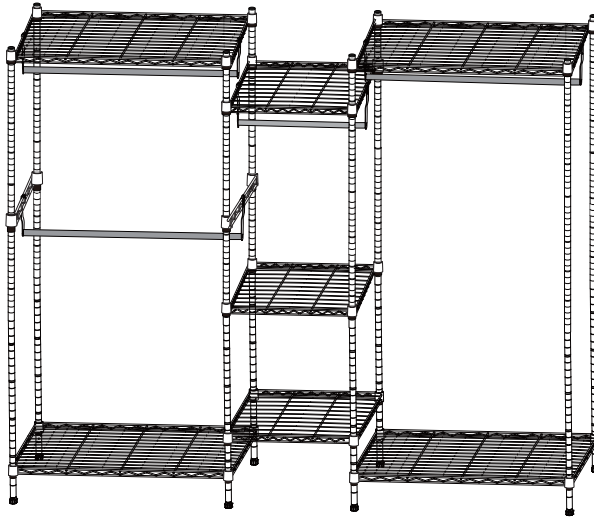

TYPE-L
PAGE 18-31

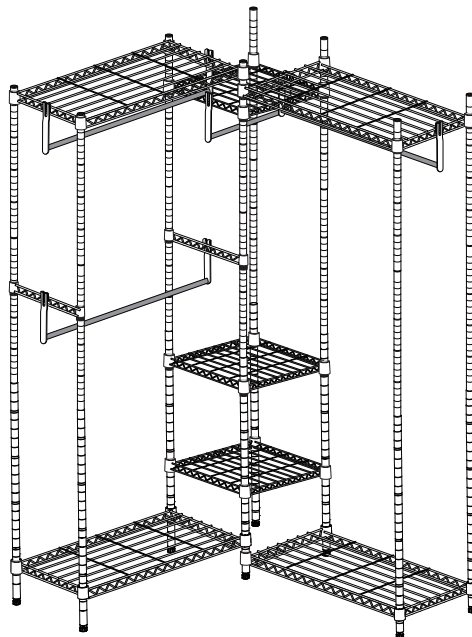

TYPE-H INSTALLATION

Layout the accessories and check its quantity and condition according to the part list, if any part missing or defective, please feel free to email us to get replacements.

Step 1 Install Adjustable Feet (part **K**) into Lower Pole (part **F**).

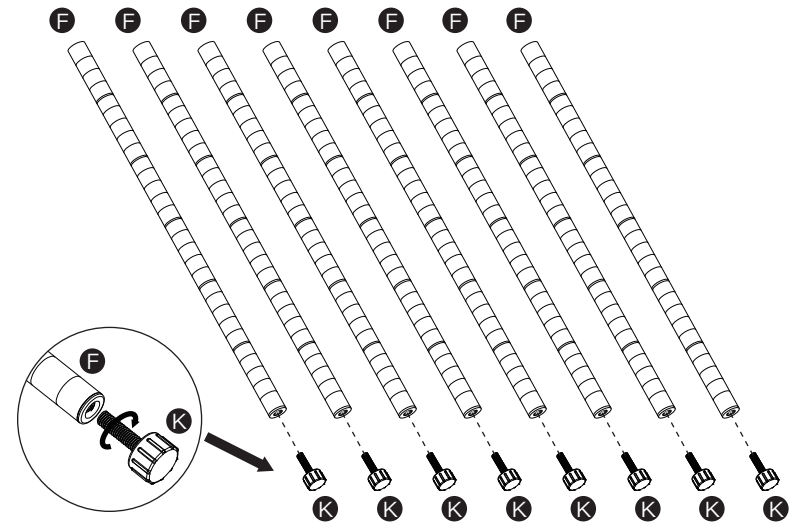

Step 2

Learn to install clips on poles.

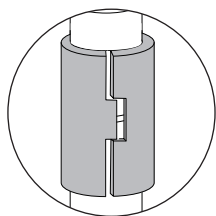
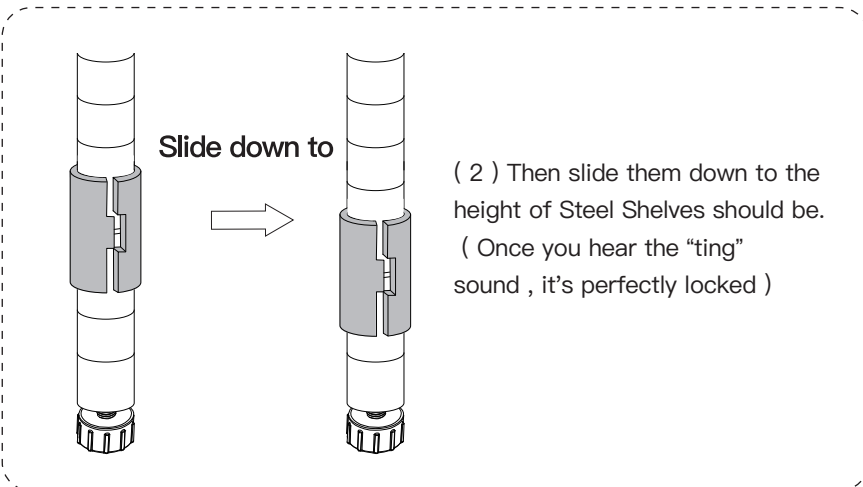
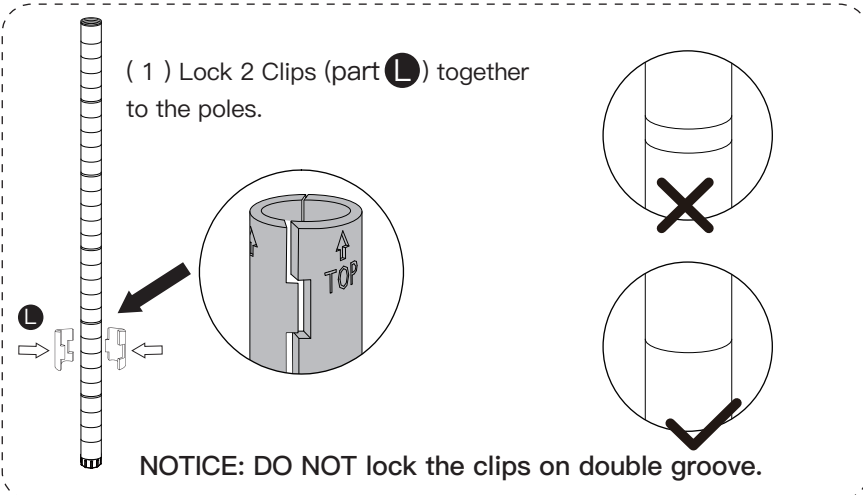

Note:

There is a gap between 2PCS plastic clips when assembled onto the poles as shown in the picture, this is a structural design rather than a quality issue, which aims to bind the shelves firmly onto the pole.

Step 3

Lock clips as below, and install Steel Shelf **A** (part **A**) on Lower Poles (part **F**).

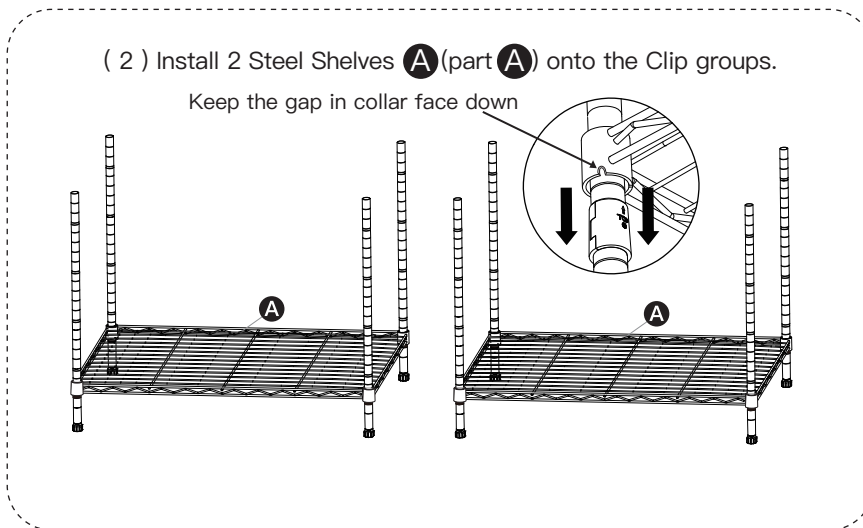
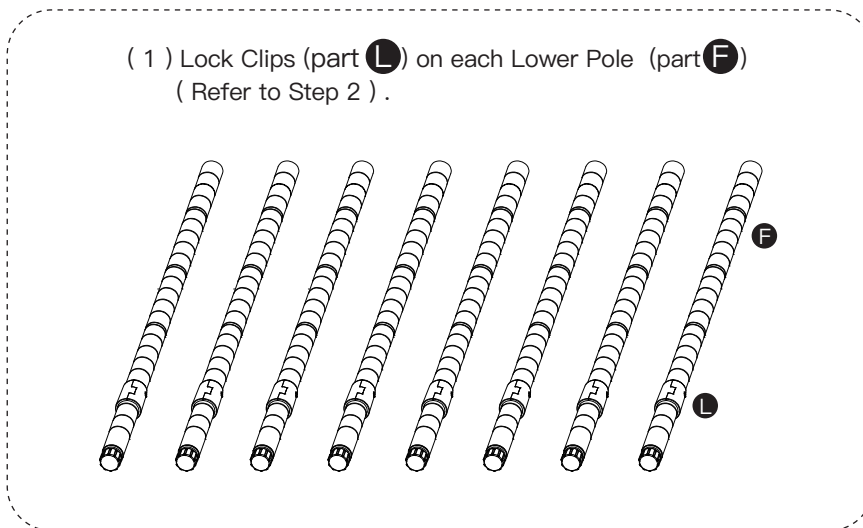

Step 4

Install Steel Shelf **(B)** (part **(B)**) on the clothes rack.

(1) Lock Clips (part **(L)**) as below.

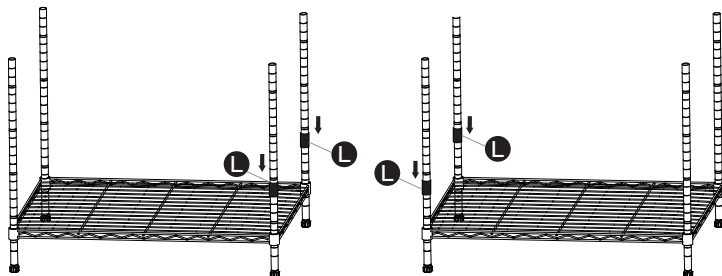

(2) Install the Steel Shelf **(B)** (part **(B)**) onto the Clip groups.

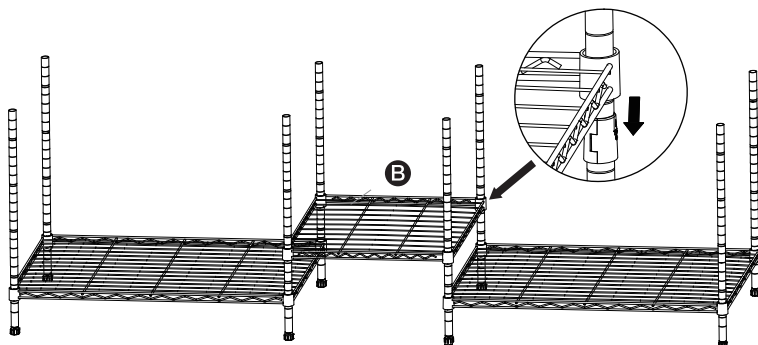

Step 5

Connect Middle Poles (part **(G)**) to Lower Poles (part **(F)**).

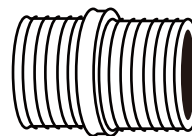

Note:

8 Detachable connectors are pre-assemble on lower side of Middle Poles and Upper Poles for your time-saving. It's normal if they get loose or connected with another pole when poles disassembled. You can re-screw in it to the poles.

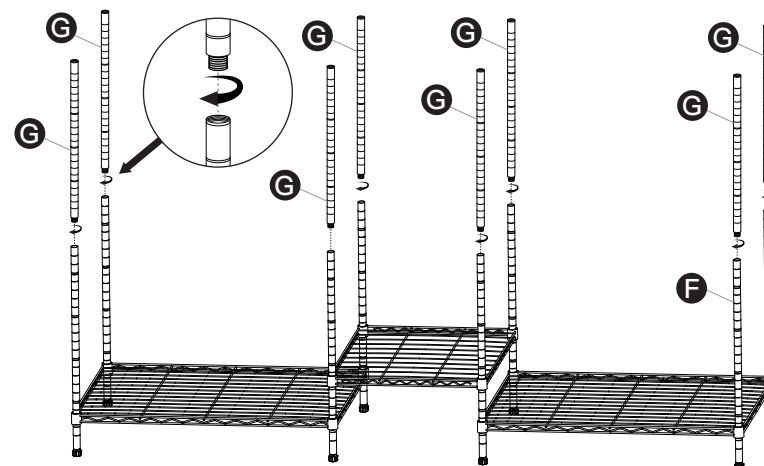

Step 6

Install Steel Shelf **B** (part **B**) on Middle Poles.

(1) Lock Clips (part **L**) as below.

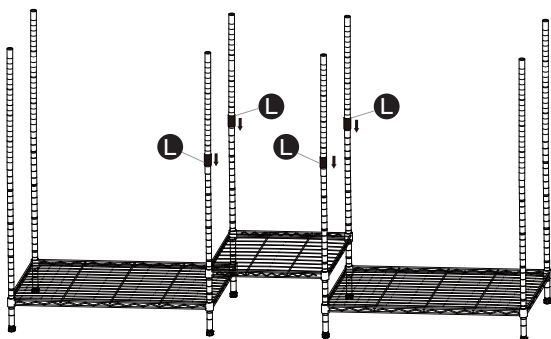

(2) Install Steel Shelf **B** (part **B**) onto the Clip groups.

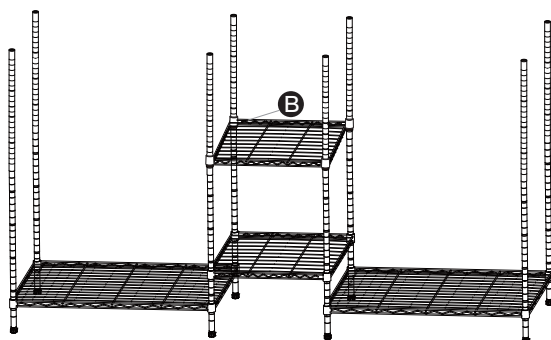

Step 7

Install Side Rods (part **C**) on Middle Poles.

(1) Lock Clips (part **L**) as picture below.

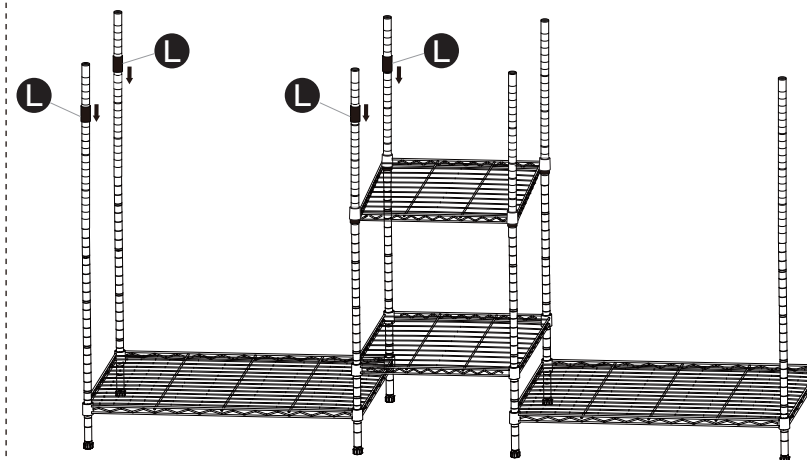

(2) Install part **C** onto the Clip groups.

Notice:

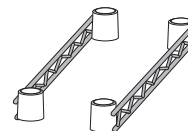

The side rod (part **C**) must be installed as showed above.

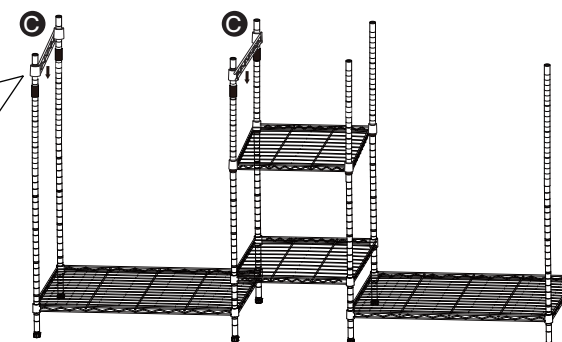

Step 8 Connect Upper Poles (part **H**) on Middle Poles (part **G**).

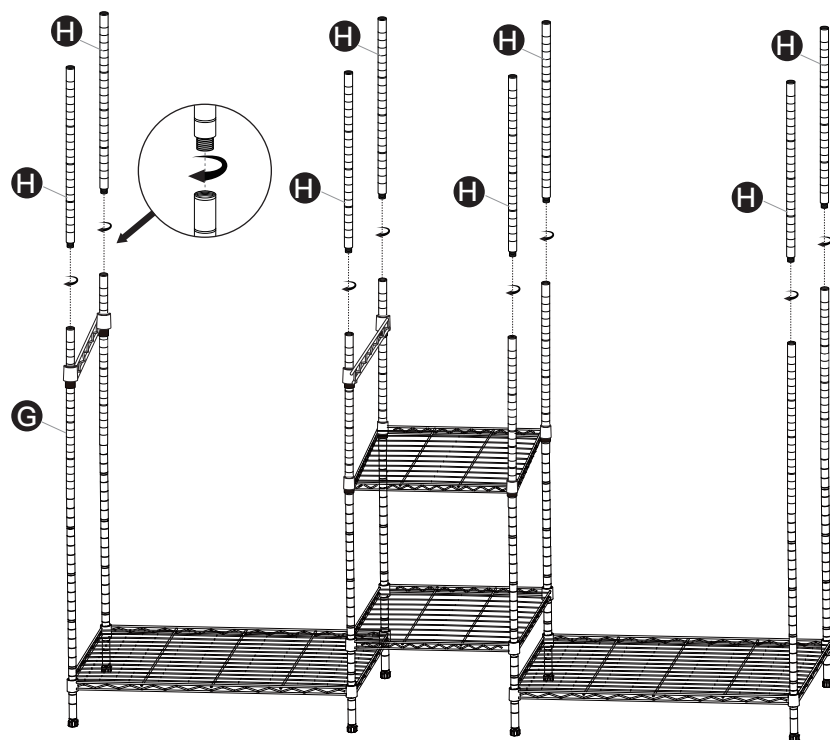

Step 9 Install Steel Shelf **B** (part **B**) on the clothes rack.

(1) Lock Clips (part **L**) as below.

Note:
To avoid hooks scratching shelves, make sure at least 8" distance among 3 top shelves.

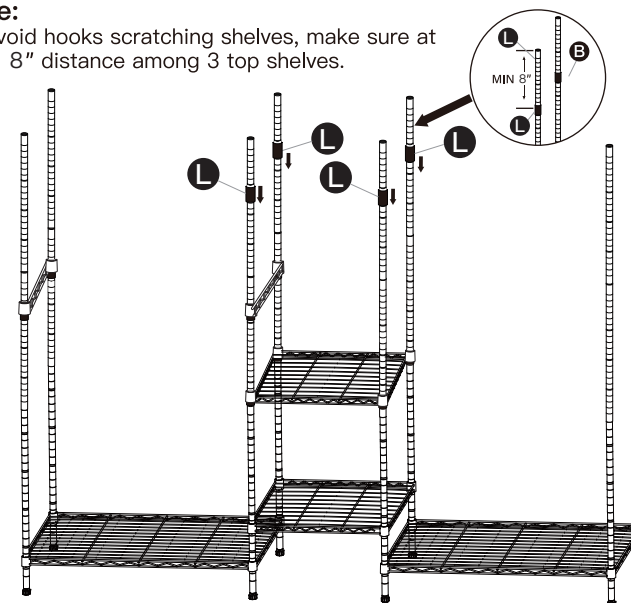

(2) Install the Steel Shelf **B** (part **B**) onto the Clip groups.

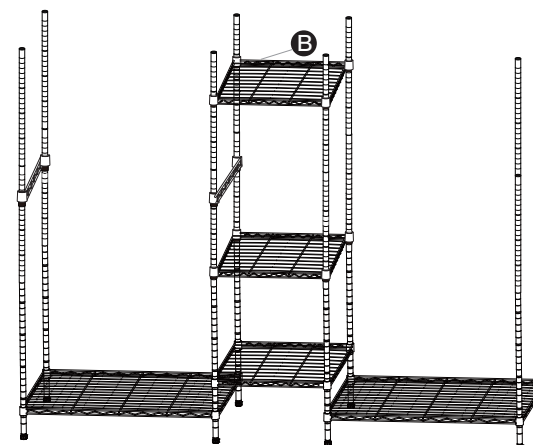

Step 10

Install Steel Shelves **A** (part **A**) on the clothes rack.

(1) Lock Clips (part **L**) as below.

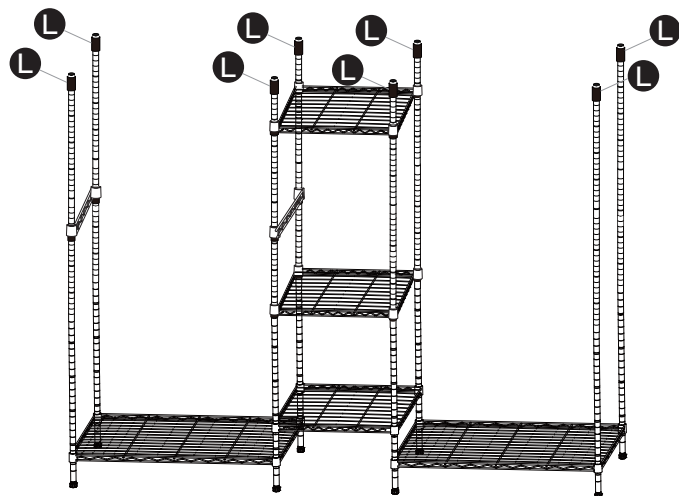

(2) Install 2 Steel Shelves **A** (part **A**) onto the Clip groups.

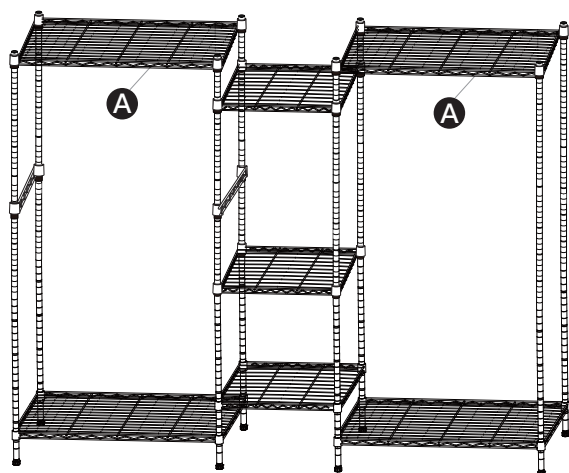

Step 11

Install part **J** on one side of part **D** and part **E**, and tighten them with part **M**.

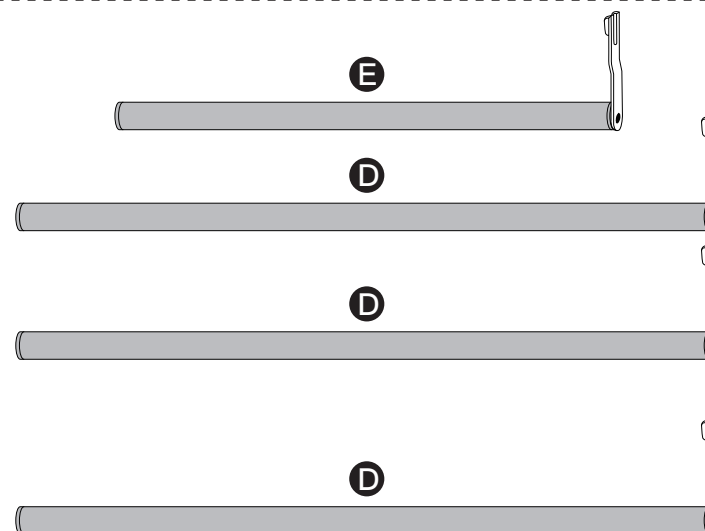
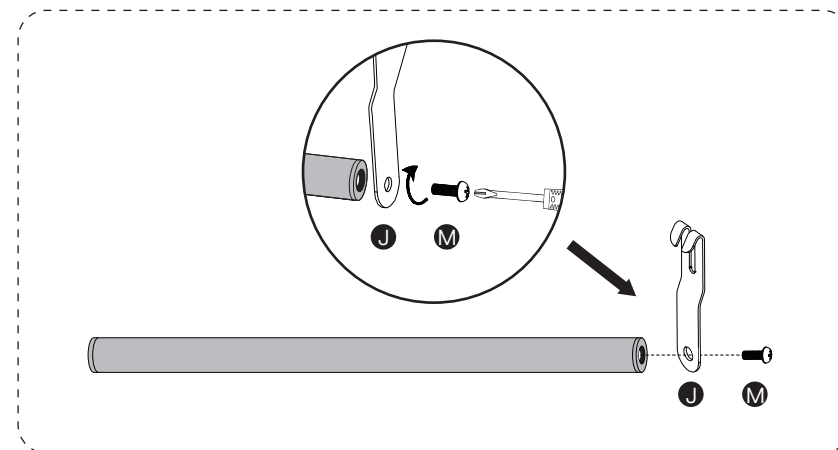

NOTICE:

Do Not tighten part **M** until next step.

Step 12 Install Hangers on the Rack.

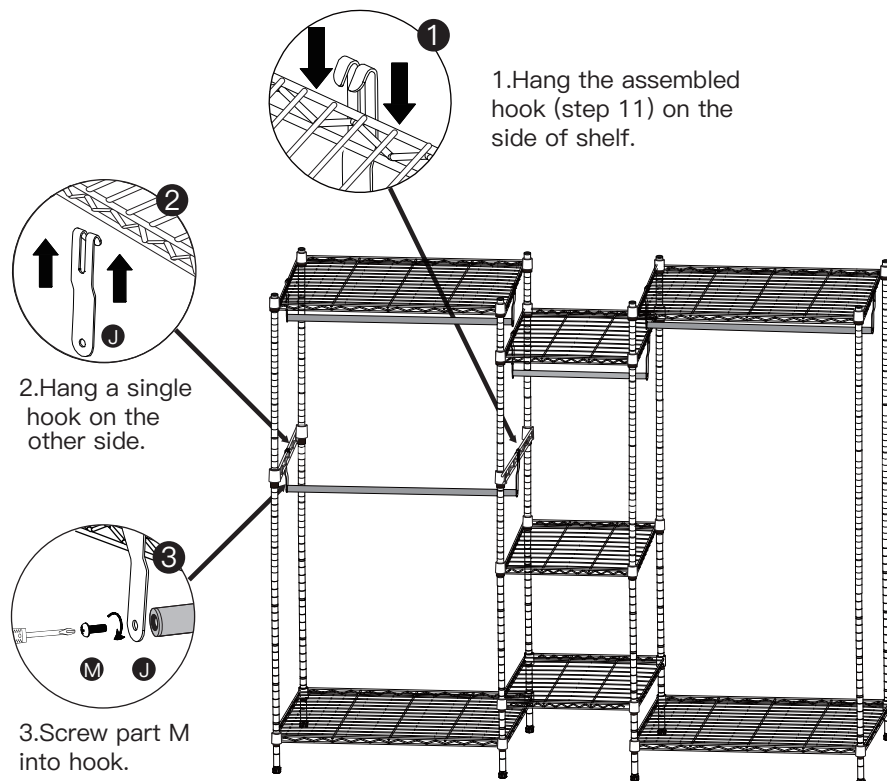

REMARK:

After each shelf is assembled, please put a piece of cloth on shelf and hit it several times with a tool (eg. A rubber mallet) to ensure more stability.

Note:

The rubble mallet is not included on the package.

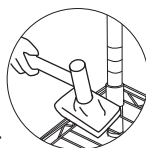

Step 13 Install part N to keep clothes rack more stable.

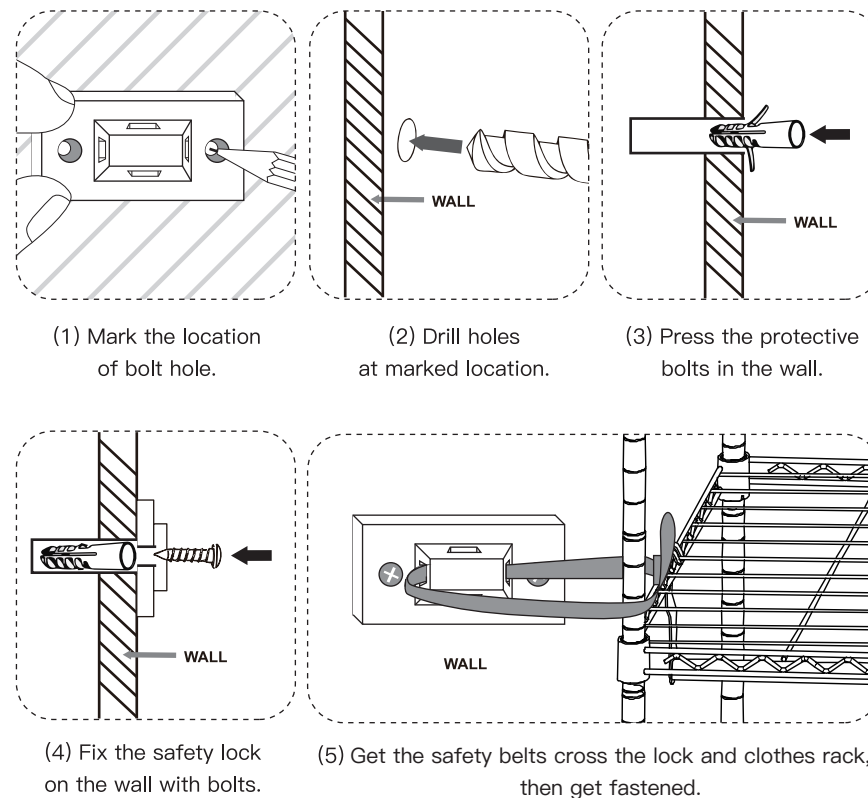

After-Sale Support

Dear Customer,

Thank you so much for purchasing our product. We sincerely appreciate your choice to incorporate our product into your living space.

Our goal is to build a mutually beneficial relationships with customers and we aim to be a reliable and recommendable brand.

We sincerely hope this product meets your expectations and that you would consider us again for your future needs.

When you receive the package, please kindly double check your package and accessories to be sure that you have all the necessary parts.

Should you have any questions, please contact us through the original purchase platform.

We will reply to each message within 24 hours and spare no efforts to help you as always.

Thank you once again for choosing us. Here's to creating wonderful memories and comfortable spaces together!

Kindest Regards,
Customer Care Team

TYPE-L INSTALLATION

Layout the accessories and check its quantity and condition according to the part list, if any part missing or defective, please feel free to email us to get replacements.

Step 1 Install Adjustable Feet (part **K**) into Lower Pole (part **F**).

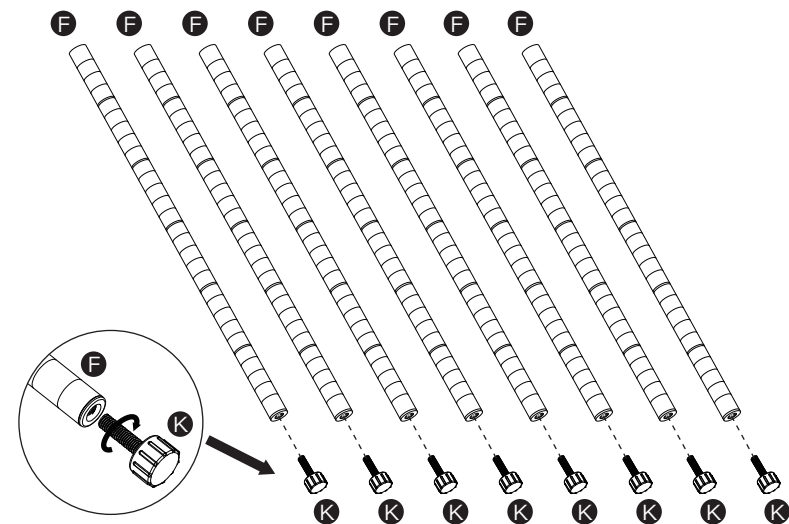

Step 2

Learn to install clips on poles.

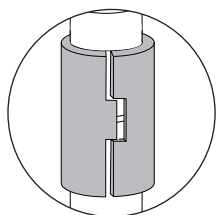
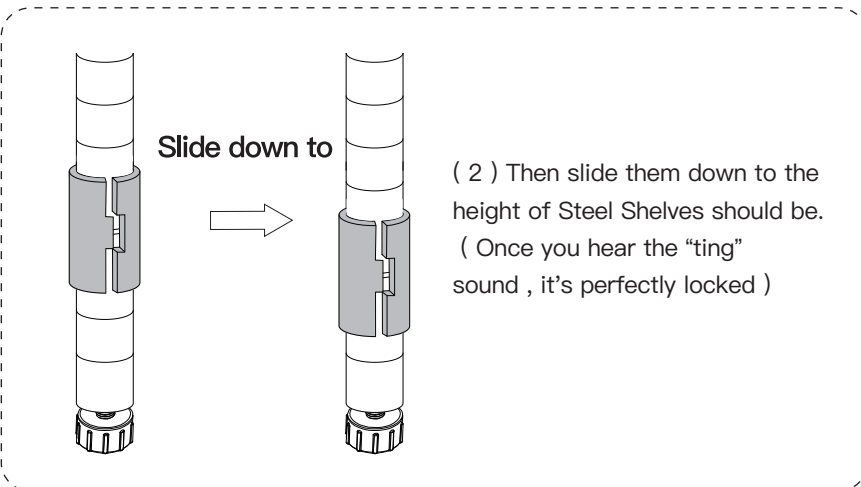
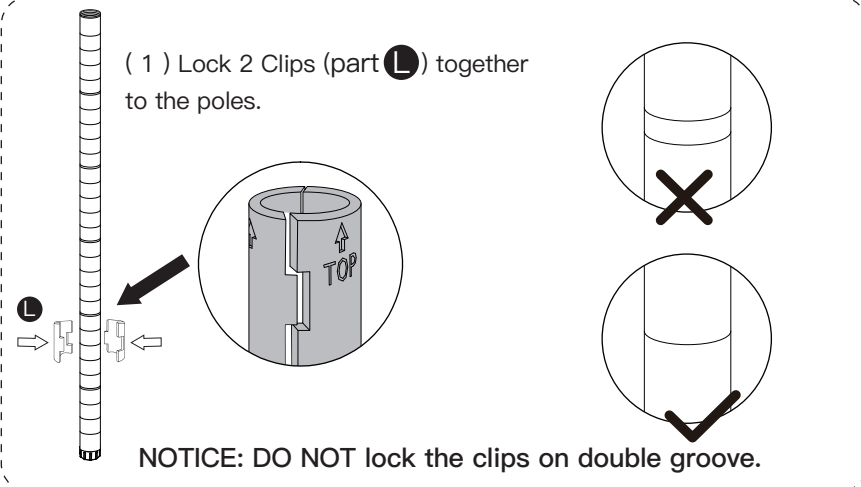

Note:

There is a gap between 2PCS plastic clips when assembled onto the poles as shown in the picture, this is a structural design rather than a quality issue, which aims to bind the shelves firmly onto the pole.

Step 3

Lock clips as below, and install Steel Shelf **A** (part **A**) on Lower Poles (part **F**).

(1) Lock Clips (part **L**) on each Lower Pole (part **F**)
(Refer to Step 2).

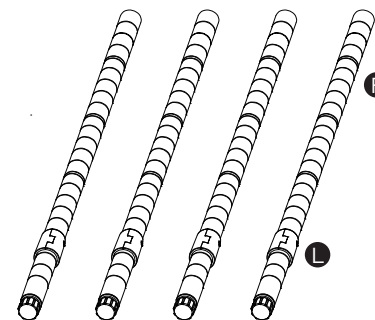

(2) Install steel shelf (Part **A**) onto the 4 lower pole (Part **F**).

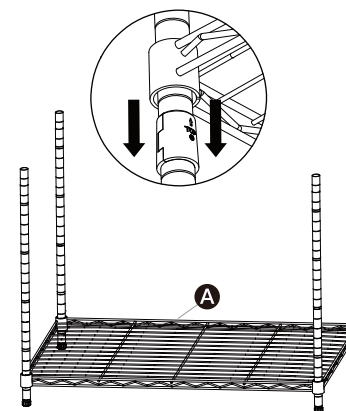

(3) Install clips (Part L) on 4 lower poles (Part F).

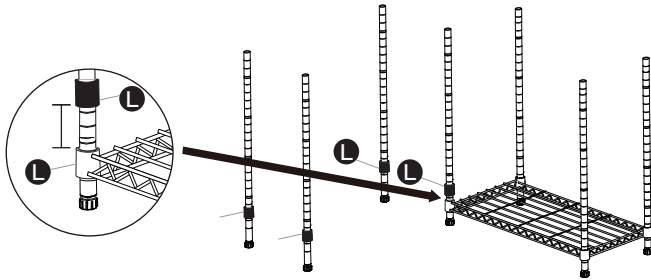

(4) Install steel shelf A (Part A) onto the 4 lower poles (Part F).

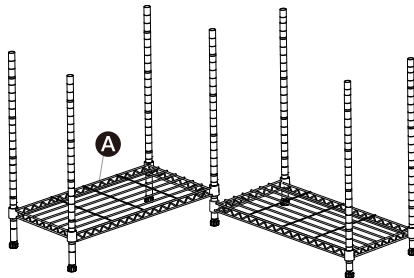

(2) Install the Steel Shelf B (part B) onto the Clip groups.

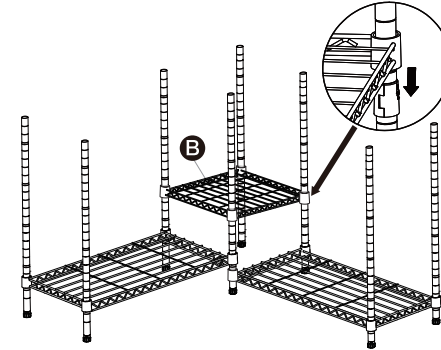

Step 5 Connect 8 Middle Poles (Part G) to 8 Lower Poles (part F).

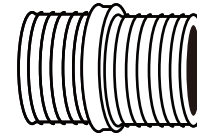

Note:

8 Detachable connectors are pre-assembled on lower side of Middle Poles and Upper Poles for your time-saving. It's normal if they get loose or connected with another pole when poles disassembled. You can re-screw in it to the poles.

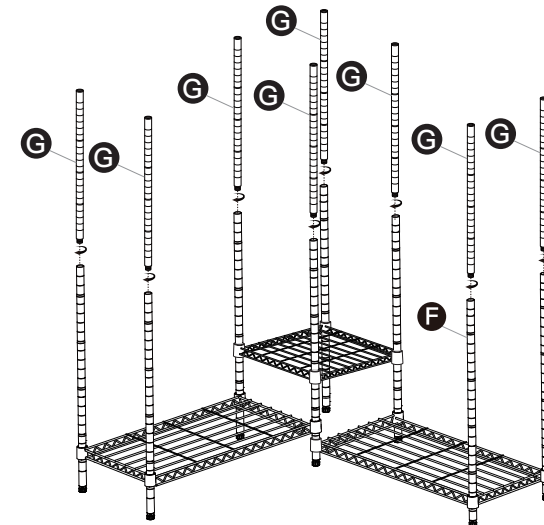

Step 4 Install Steel Shelf B (part B) on the clothes rack.

(1) Lock Clips (part L) as below.

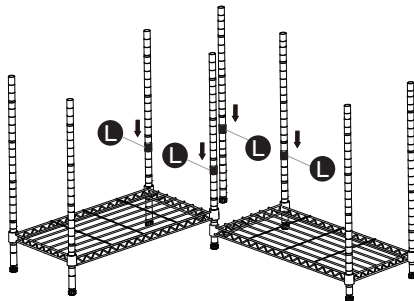

Step 6 Install Steel Shelf **(B)** (part **(B)**) on Middle Poles.

(1) Lock Clips (part **(L)**) as below.

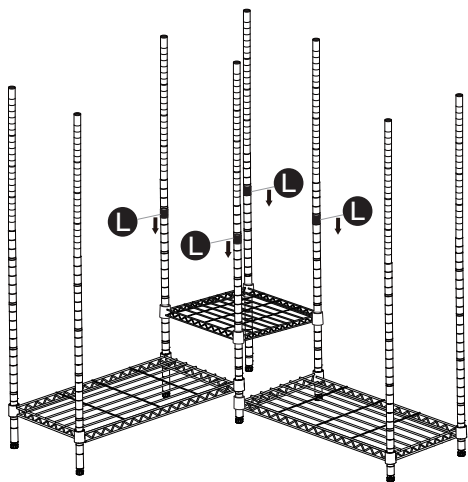

(2) Install Steel Shelf **(B)** (part **(B)**) onto the Clip groups.

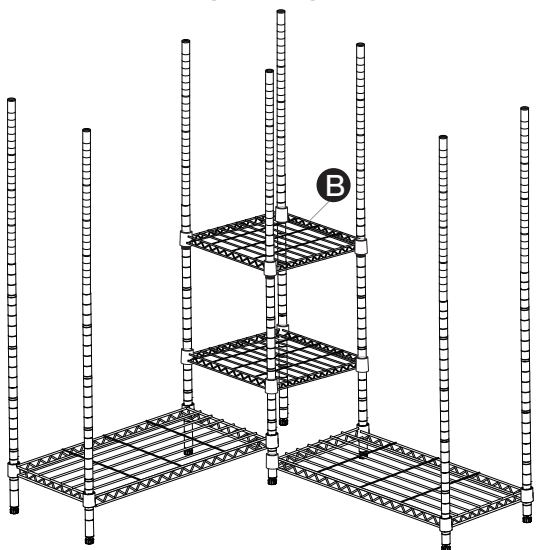

Step 7 Install Side Rods (part **(C)**) on Middle Poles.

(1) Lock Clips (part **(L)**) as below.

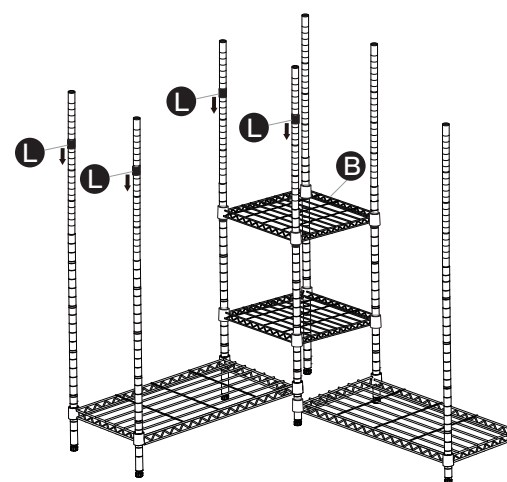

(2) Install part **(C)** onto the Clip groups.

Notice:

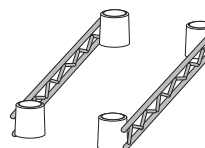

The side rod (part **(C)**) must be installed as showed above.

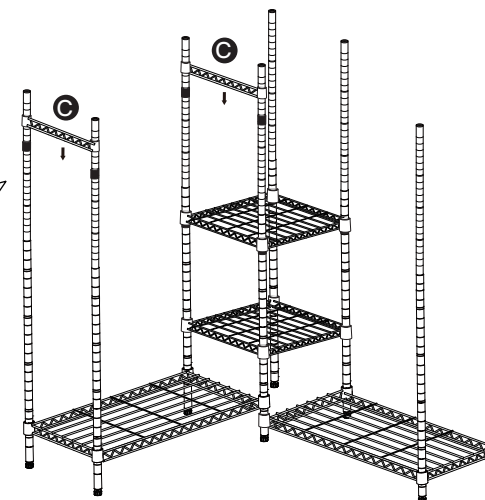

Step 8 Connect Upper Poles (part **H**) on Middle Poles (part **G**).

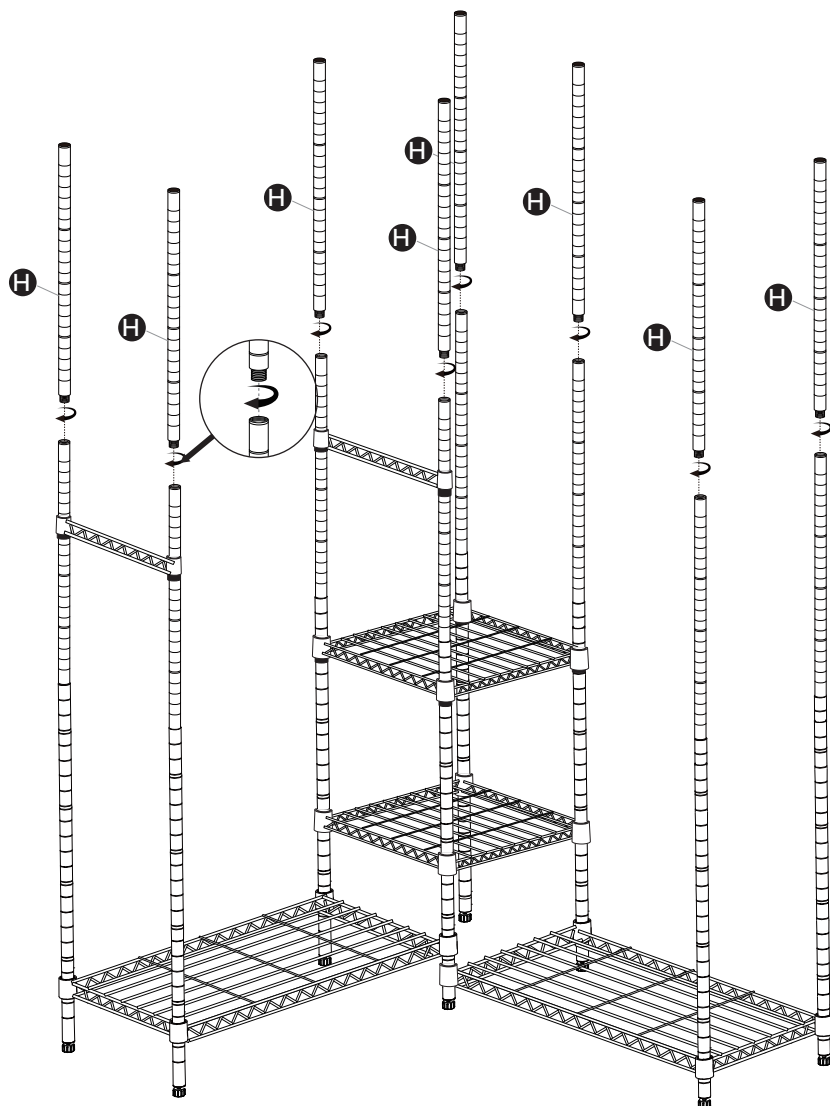

Step 9 Install Steel Shelf **B** (part **B**) on the clothes rack.

(1) Lock Clips (part **L**) as below.

Note:

To avoid hooks scratching shelves, make sure at least 8" distance among 3 top shelves.

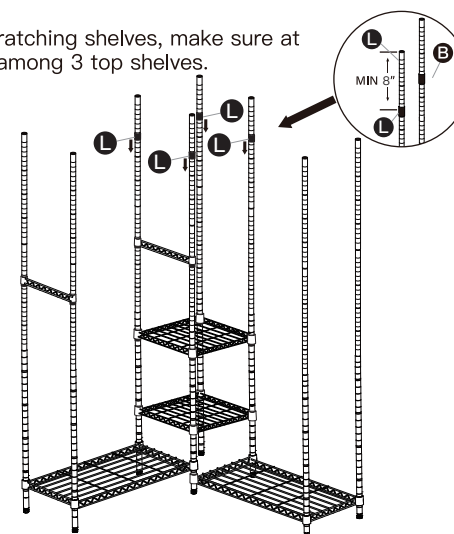

(2) Install Steel Shelf **B** (part **B**) onto the Clip groups.

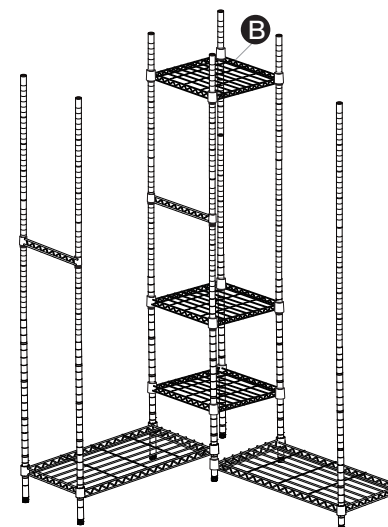

Step 10

Install Steel Shelves **A** (part **A**) on the clothes rack.

(1) Lock Clips (part **L**) as below.

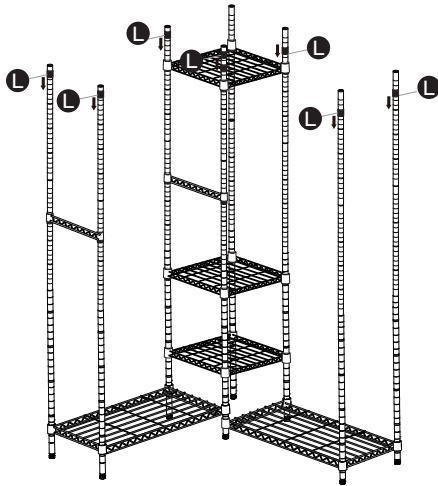

(2) Install Steel Shelf **A** (part **A**) onto the Clip groups.

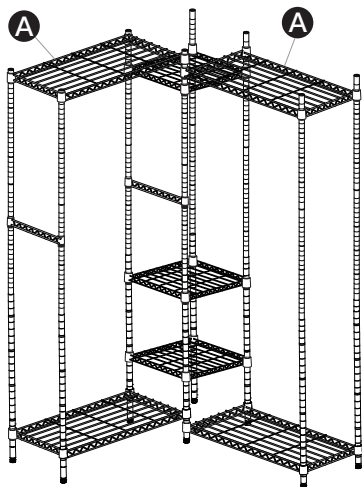

Step 11

Install part **J** on one side of part **D** and part **E**, and tighten them with part **M**.

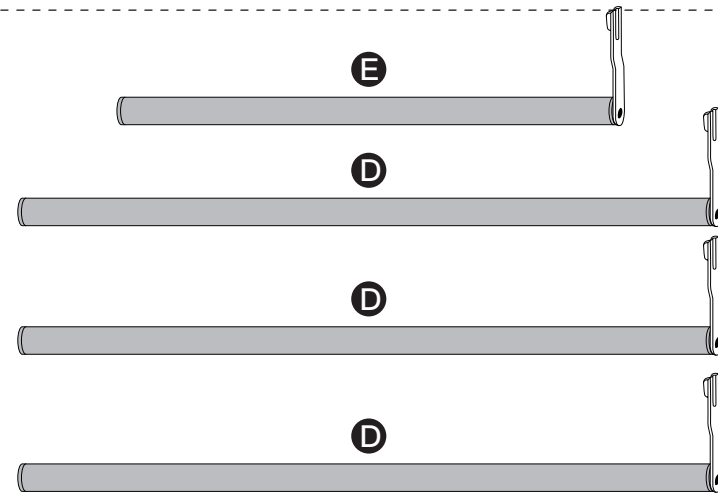
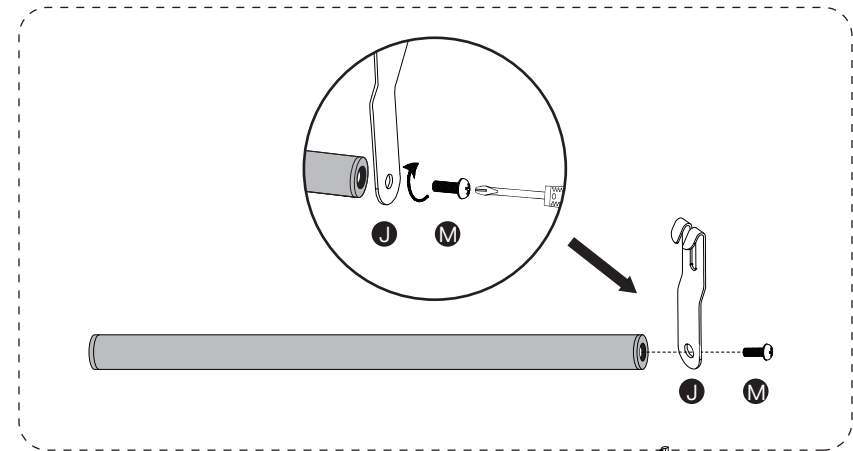

NOTICE:

Do Not tighten part **M** until next step.

Step 12

Install Hangers on the Rack.

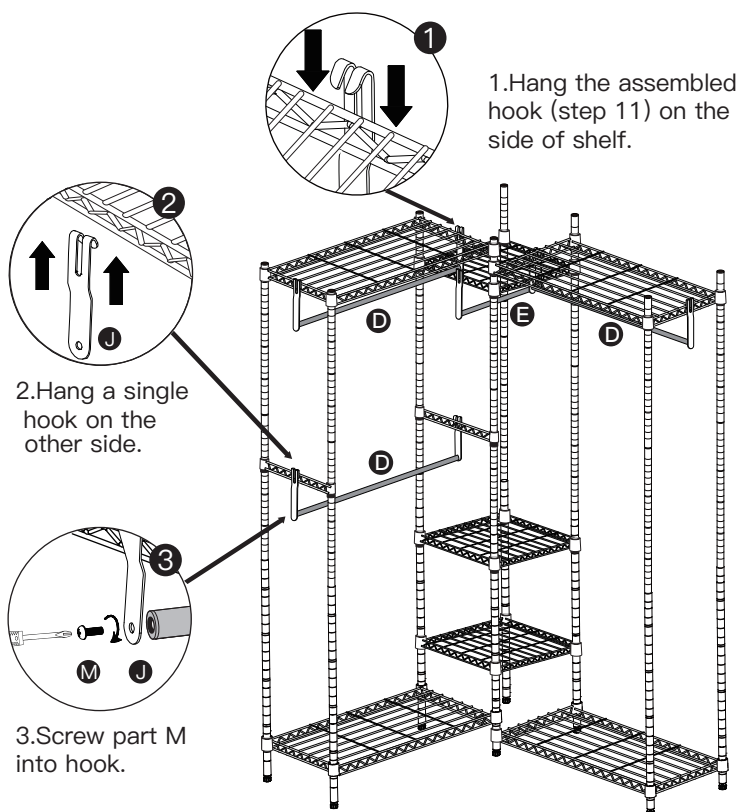

REMARK:

After each shelf is assembled, please put a piece of cloth on shelf and hit it several times with a tool (eg. A rubber mallet) to ensure more stability.

Note:

The rubble mallet is not included on the package.

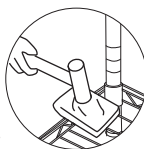

Step 13

Install part **N** to keep clothes rack more stable.

