

ASSEMBLY INSTRUCTIONS

TOOLS REQUIRED:

Allen Wrench (Provided, Part B)

BEFORE YOU START:

1. Check the parts against the parts list to make sure all items are present.
2. Assemble your furniture on a soft, flat surface to avoid scratching the finish.
3. **CAUTION:** Do not over tighten screws, nuts or bolts during assembly.
4. Your furniture may require occasional tightening.

INSTRUCTIONS:

1. Turn the table upside down on a clean soft surface.
2. Attach two metal legs to the top using Countersink Bolt (A) and the Allen Wrench (B).As Shown in Figure 1(Do not over tighten bolts during assembly)
3. Attach shelf panel to the metal legs using Countersink Bolt (A), and the Allen Wrench (B).As Shown in Figure 2. (Do not over tighten bolts during assembly)
4. Tighten all bolts before setting table back upright.

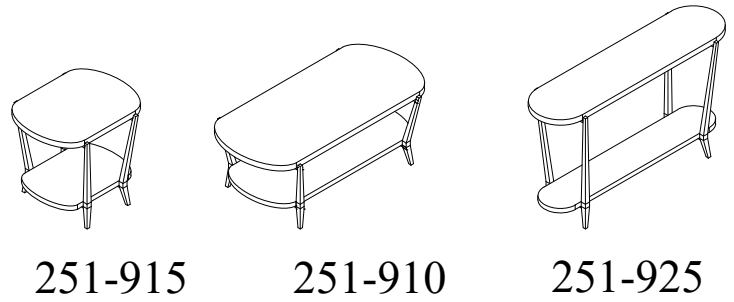

Figure 1

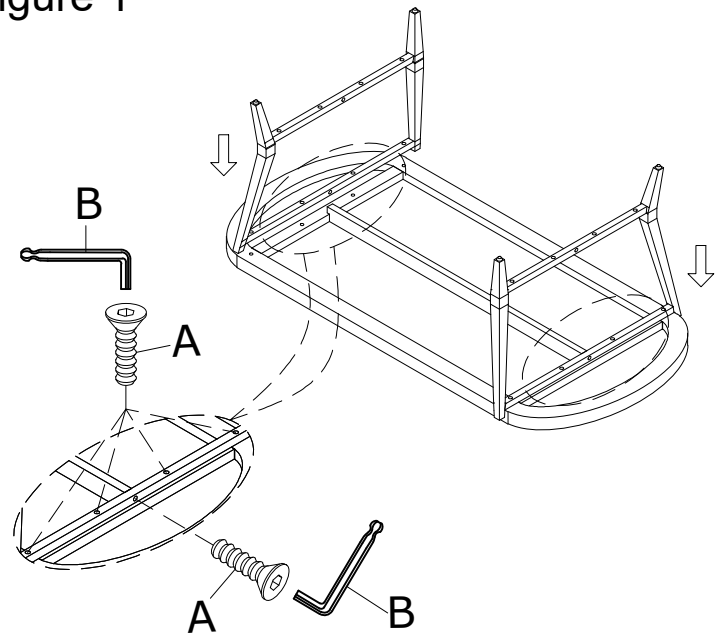

Figure 2

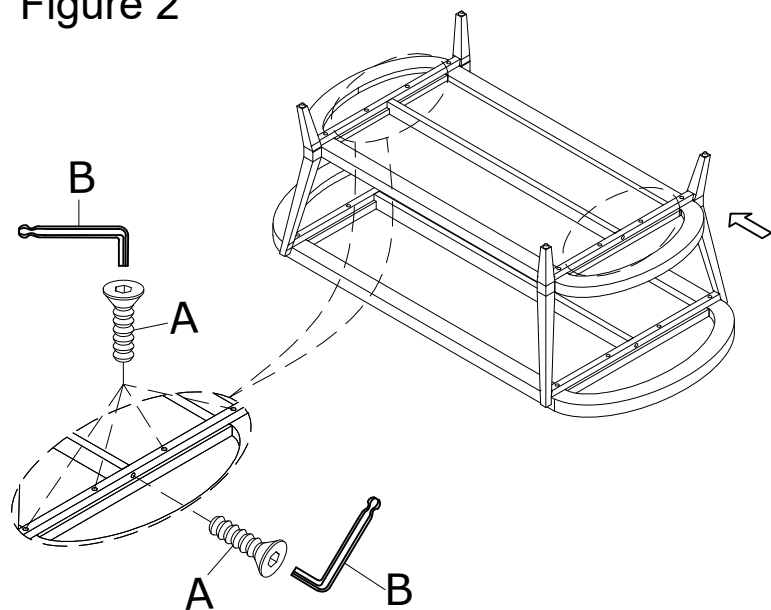
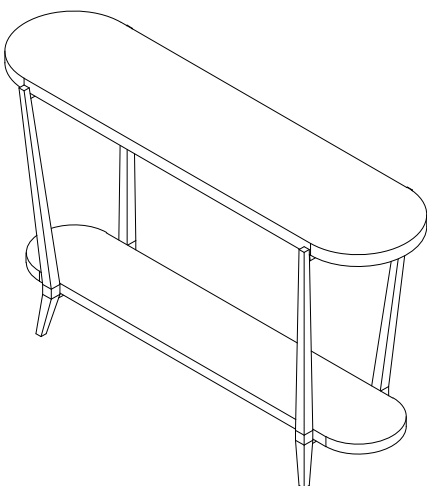
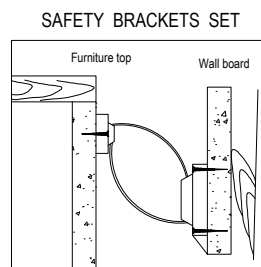

Figure 3

For the 251-925



HARDWARE LIST

NO.	Drawing	Description	Q'TY
A		Countersink Bolt ($\phi 5/16 \times 1-3/8$ ")	20 pcs
B		Allen Wrench	1 pc