

## USE AND MAINTENANCE

Use on level surfaces only

Because this product needs assembly, it is prone to working itself loose from time to time depending on the use. Please take the time to check that all connections are still tight and working properly  
Only clean using a damp cloth and mild detergent, do not use bleach or abrasive cleaners.

# Adjustable Drafting Stool

## PART LIST



1 - Caster x 5



2 - Star Chair Base x 1

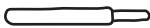

3 - Gas Lift x 1



4 - Chair tray x 1



5 - Chair Seat x 1



6 - Chair Back Bar x1



7 - Chair Back x1

## Hardware



A - Screw x 4



B - Screw x 2



C - Hand Wheel x 1



D - Back Support x 1



E - Allen Wrench x 1

## Assembly Instructions

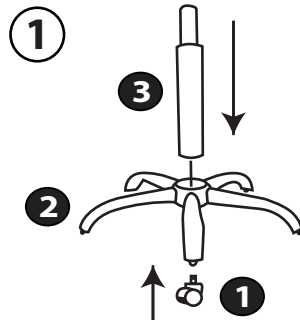

1. Select 3 Gas Lift x1, 2 Star Chair Base x1 and 1 Caster x5. Insert 3 into 2 and hand tighten. Insert 1 x 5 into the 2 and make sure the Casters slide smoothly.

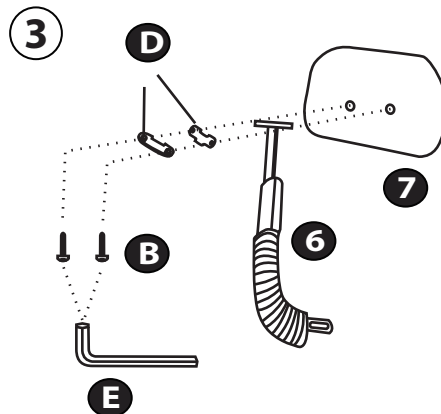

3. Insert B Screw x 2 into the D into the 6 into the 7 and hand tighten.

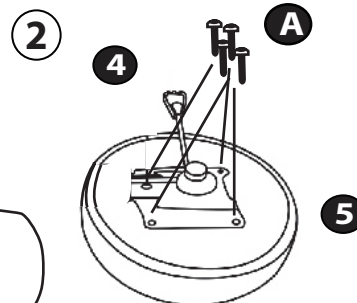

2. Insert A Screw x 4 into the 4 into the 5

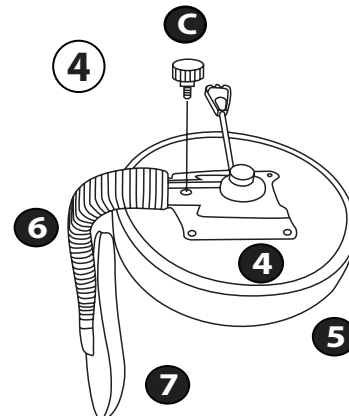

4. Insert C Hand Wheel x 1 into the hole of the 4 into the 5. Insert 7 into the 6.

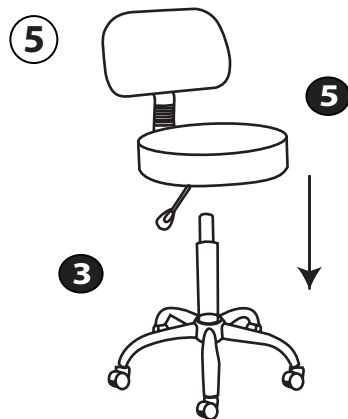

5. Insert 5 into 3.

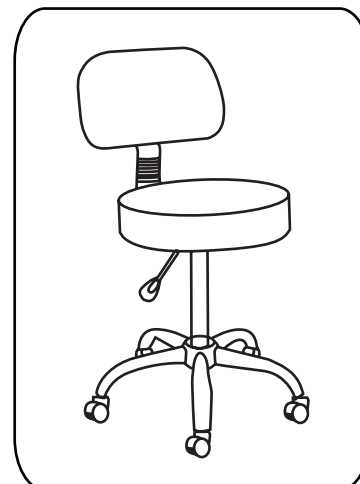

Congratulations! Setup of your new Mara Adjustable Drafting Stool is Completed !