

Warranty

We offer a one-year warranty for the light fixtures

Our warranty ensures that any issues related to the performance or functionality of the light fixtures will be addressed and resolved promptly.

Our dedicated customer service team is available 24 hours a day to assist you. If you have any questions or concerns, we guarantee a response within 24 hours. During the warranty period, if you encounter any problems or need assistance, please don't hesitate to reach out to us via email. To ensure a swift and accurate resolution, kindly provide your order ID and detailed information regarding the issue.

Important Note: Please use this light fixture only for its intended purpose and avoid retrofitting or remodeling it. The warranty does not cover failures caused by third-party products or natural disasters.

INSTALLATION INSTRUCTION

DSMZ11028/8

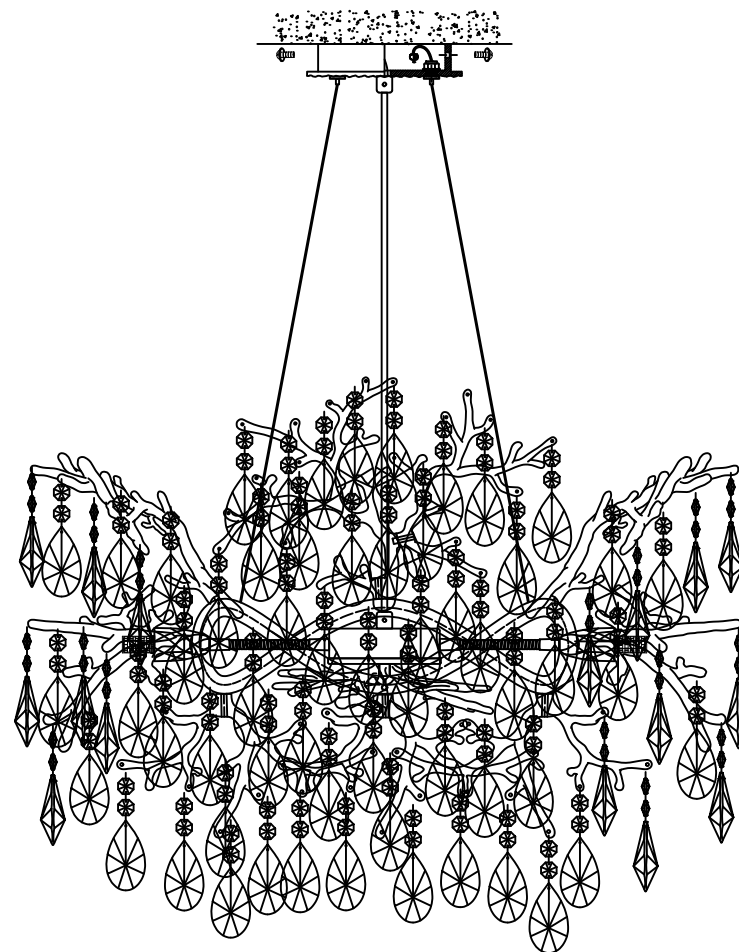

PACKAGE CONTENTS

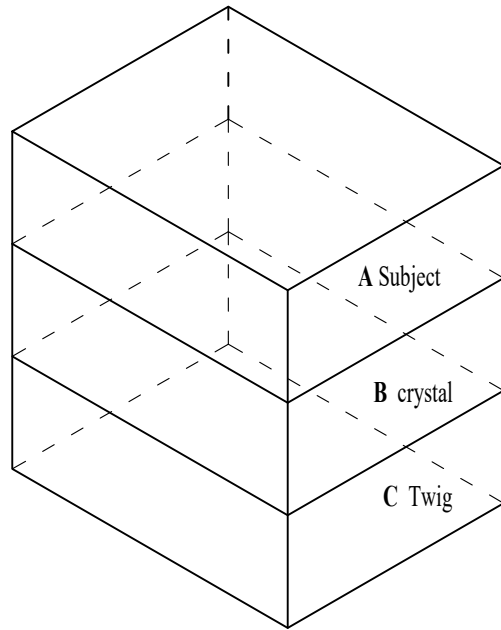

SAFETY INFORMATION

It is important to thoroughly read and understand the entire manual, before assembling, operating, or installing the product,

WARNING

- TURN OFF ELECTRICITY before installation, changing bulbs, or cleaning the light fixture.
- This fixture requires 8 pieces G9 bulbs(not included in the product), the maximum wattage for each bulb is 40W, please do not exceed the recommended wattage.
- A QUALIFIED ELECTRICIAN IS RECOMMENDED FOR INSTALLATION.
- Do not use corrosive substances such as gasoline or alcohol disinfectants to wipe the lamps, otherwise it will damage the lamps.

PREPARATION

- Before installation, please make sure all the accessories are included (refer to the package content), if there is any part missing, please contact us at the order page, we will arrange the replacement in a timely manner
- 8 pieces of G9 bulbs(Max. 40W) are required(not included in the product)
- For any questions or inquires, please feel free to contact us at the order page, our customer service team will reply ASAP.



X2

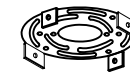

X1



X3

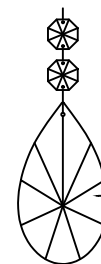
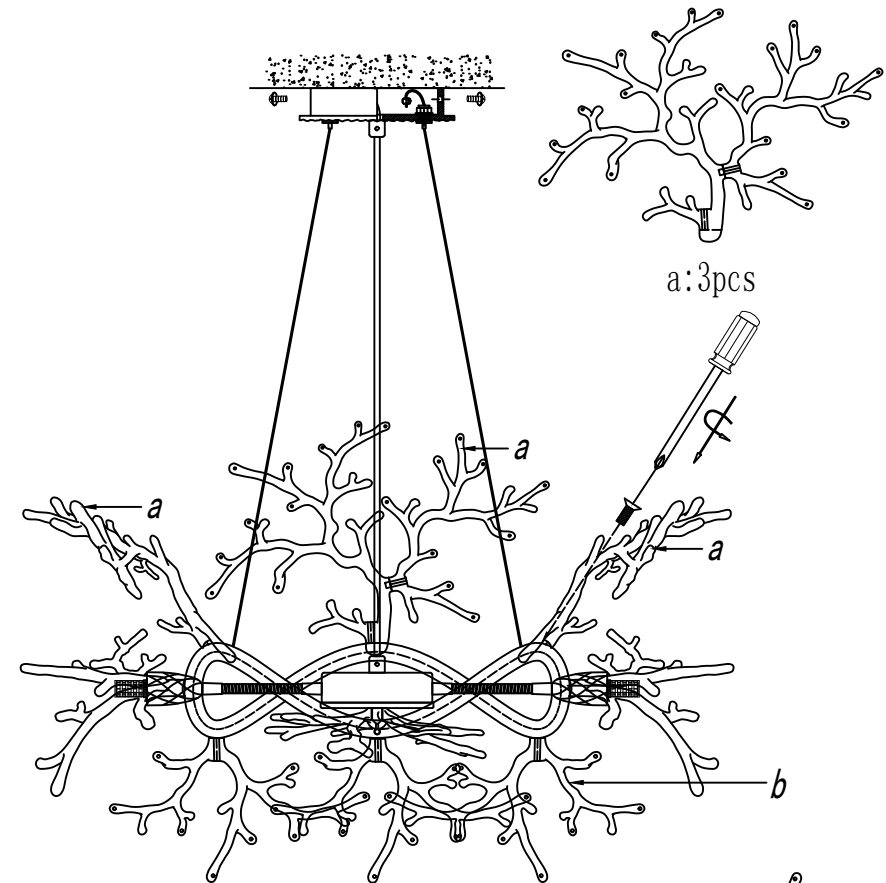

F Crystal String-164



G9 Bulbs-8
(not included)



b: 12pcs

Installation instruction

1

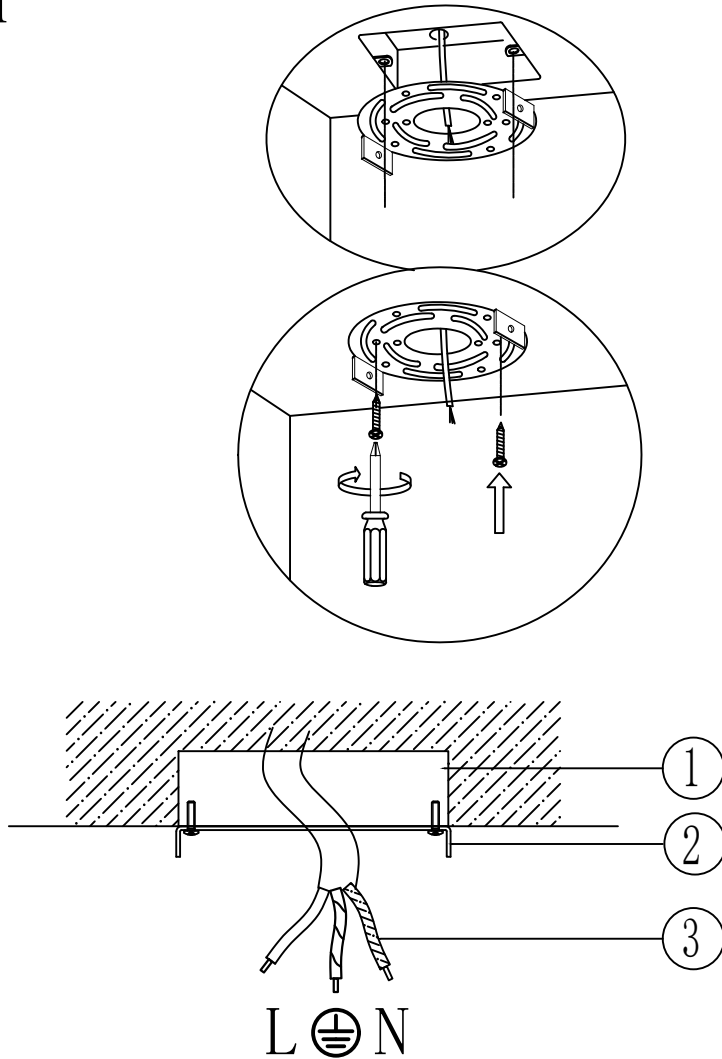

2

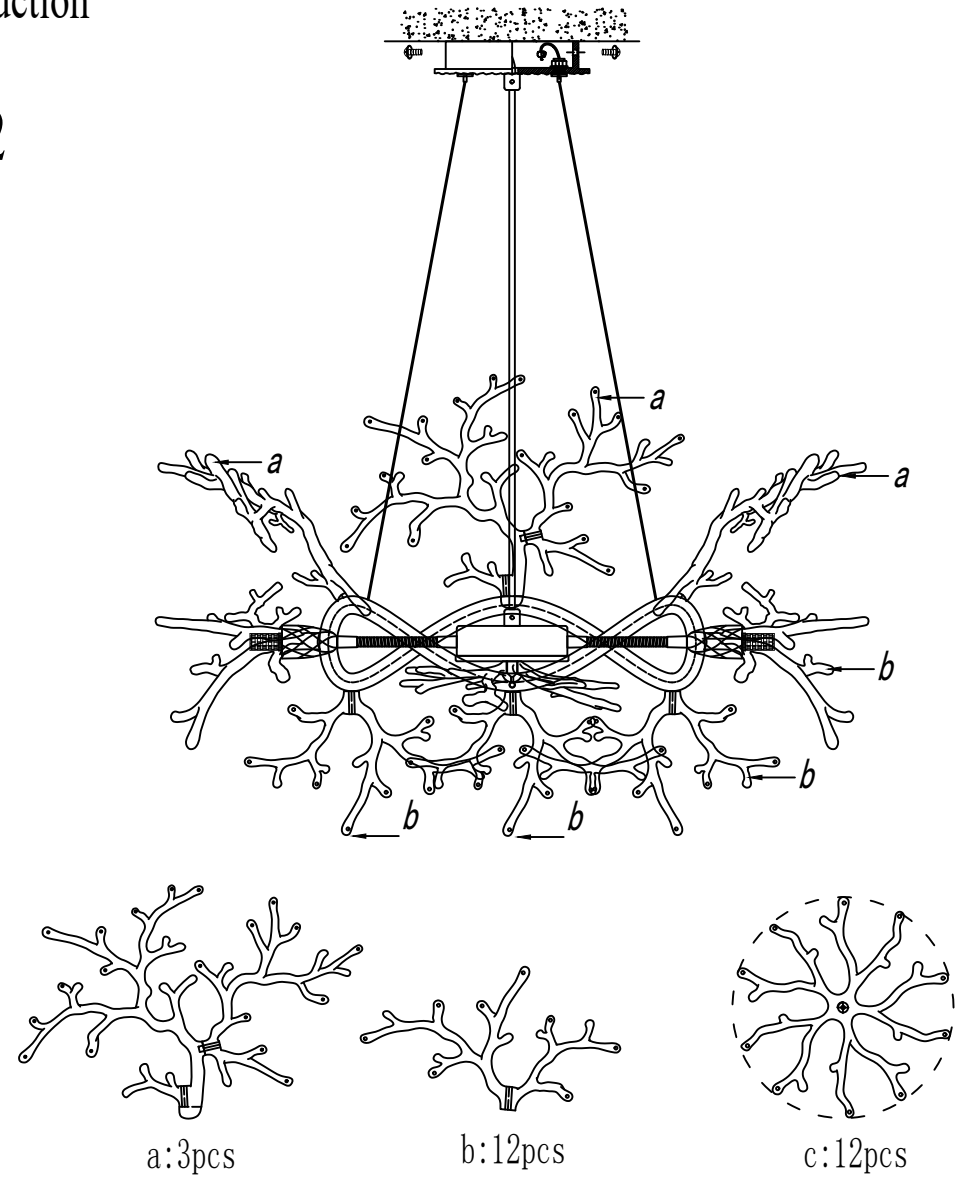

Steps:

1. Take out the lamp body and check the firmness of the lamp body;
2. Take out the decorative branches
3. Use a cross screwdriver to remove the M4*30mm screws on the lamp body in order, and install a set of decorative branches one by one, to avoid losing screws;
4. Install the branches with steel wire as the diagram, and thread the steel wire rope into the specified hole;

Installation instruction

3

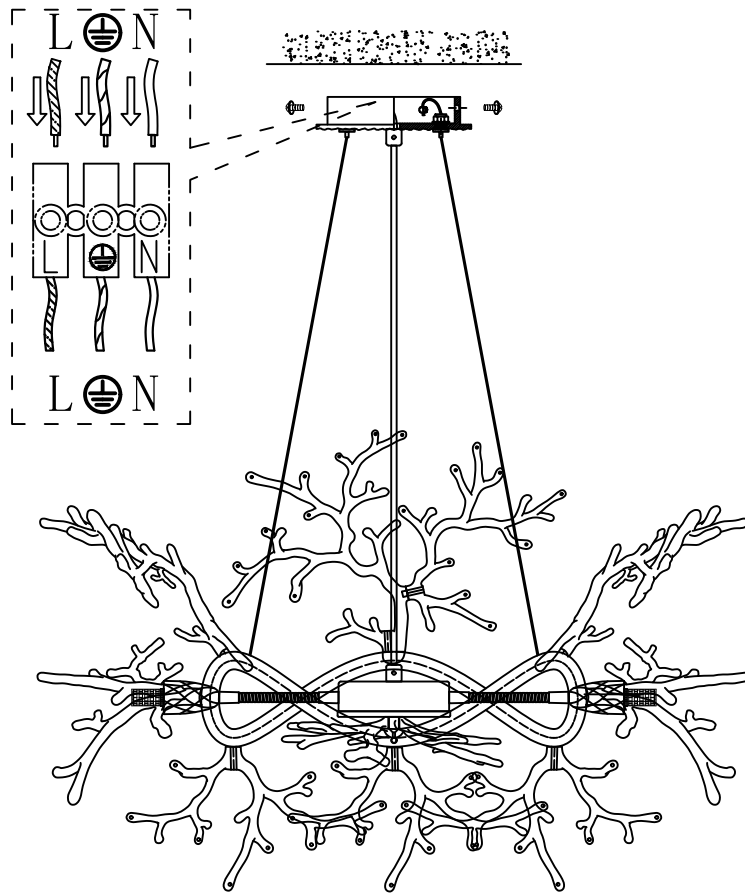

- ① ② Install the lamp body on the crossbar with the matching screws.
- ③ Install the bulbs and test them.

4

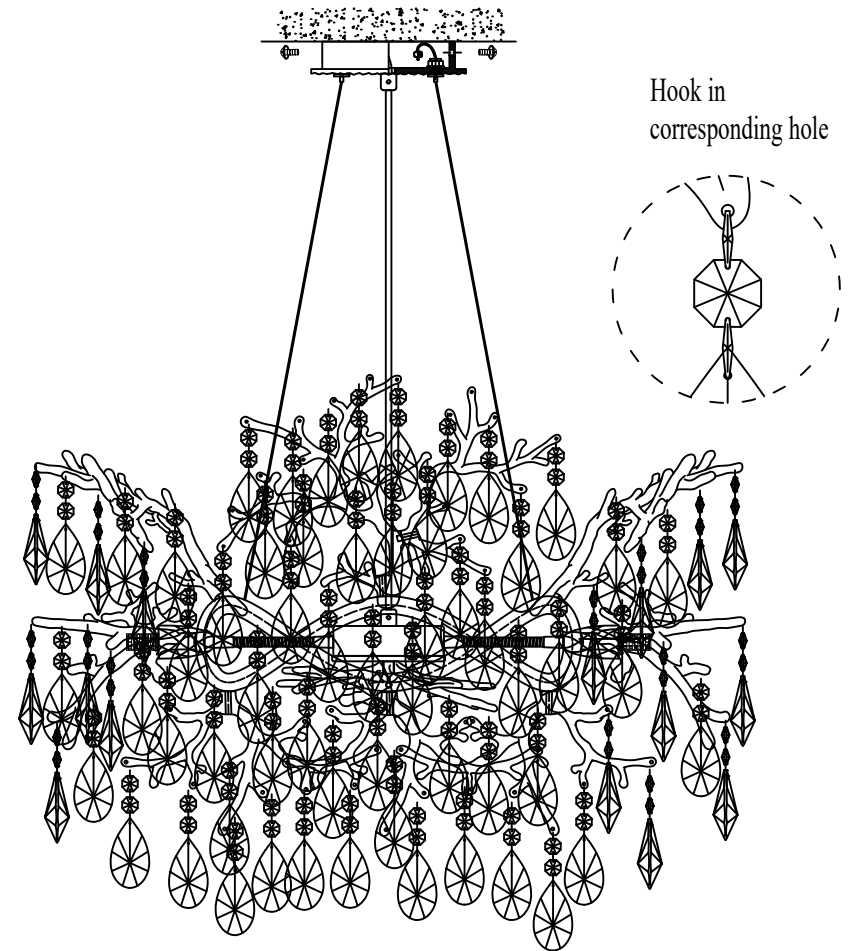

Fix the crystal string to the branch as shown.

1. Branch 1 should have 19 crystal strings, a total of 3, branch 2 should have 8 crystal strings, a total of 12, branch 3 should have 11 crystal strings, a total of 1, and the whole lamp should have 164 crystal strings.
2. When hanging crystals, try to keep them symmetrical to keep the light fixtures balanced.
3. The decorative support is die-casting, and the load-bearing capacity is limited. The suspension accessories shall not be replaced without authorization, and no one shall bear the weight during installation, so as not to cause unnecessary safety accidents.

FINISHED PRODUCTS

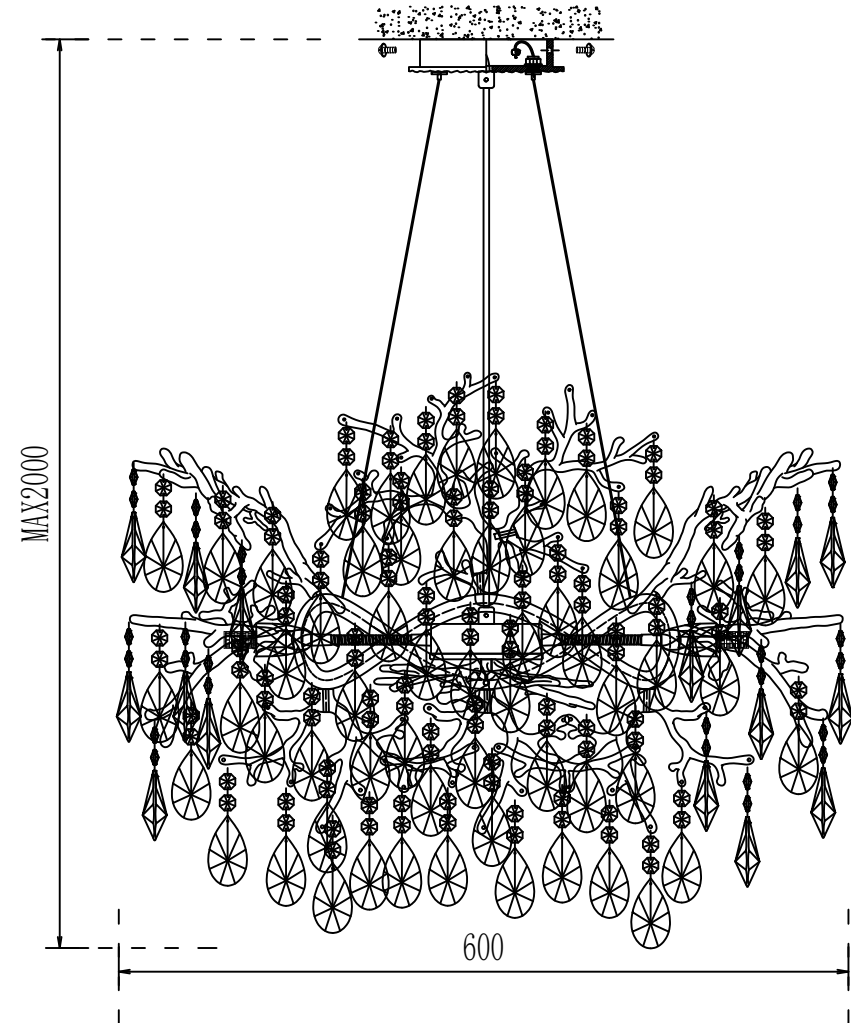

NOTES: Due to the handmade nature of the product, slight variations in dimensions may occur.

Cautions.

- 1.This lamp can only be used indoors;
- 2.TURN OFF THE POWER BEFORE THE INSTALLATION IS FINISHED.

Maintenance:

To ensure safe and efficient use of this product, please clean the lamp regularly (once a month). Before cleaning, turn off the power and wait for the lamp to cool to room temperature. Then use a soft cloth dipped in water and wrung dry to wipe it clean.