

## Installation Instruction

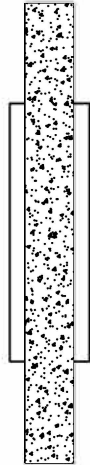

## Packaging Diagram

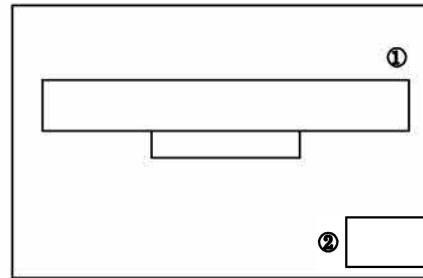
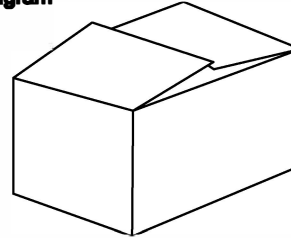

### Internal Packing List

1. Marble lamp body
2. Light source and accessories package

## Before Installation:

- ★ Please carefully read all steps.
- ★ Keep this manual for future reference.
- ★ Separate and list all parts and hardware.



Email:  
Lighting@xzt-service.com

★★★★★

5-star Rating

Thank you



- ★ Read each step carefully and follow the correct installation procedures.

- ★ To avoid losing any components during assembly, we recommend not moving the fixture until assembly is complete.

- ★ Keep all small parts and packaging materials of this product away from infants and children as they may cause serious injury.

### ★spec sheet:

Light Source: LED Light Strip    Watt: 3W(per)    Color Temperature: 3000K

## Packing List:

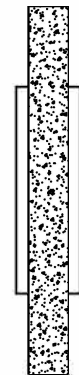

Lamp Body 1pcs

**Installation of Hanging Board:** Take out the hanging board and fix it on the wall where it needs to be installed with screws.

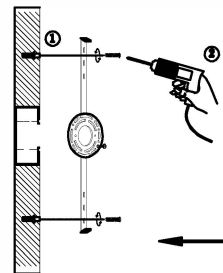

**Installation of Ceiling Lamp Body:** Take out the lamp body, connect the main line of the lamp body and the power line, align the holes of the ceiling plate with the holes of the hanging plate screws, and tighten the screws.

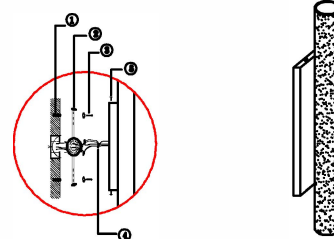

Turn on the light and test it.  
The installation is complete.

