

Brand Concept

Funsite, a top manufacturer and good designer, has decades of experience in manufacturing patio products. Each piece is sleekly designed, rigorously tested for durability, and assembly instructions have been standardized for simplicity from start to finish.

Funsite always looks forward to creating a freedom lifestyle for more people, and more opportunities to explore the unknown and explore the value of life!

Funsite hopes your leisure time delightful and comfortable by providing more patio products with reliable craftsmanship and durable material and 24 Hours service.

Our Service

30-day money back guarantee.

90-day warranty for quality-related issue with free replacement.

24 Hours Online Customer Service FOR YOU!

Reminder: Be sure to use your product as directed.

WhatsApp: 0086-13905747420

EMAIL: servicefunsite@gmail.com



Order Status



Installation Help



Gift Cards



New Product Discount

Part & Accessories

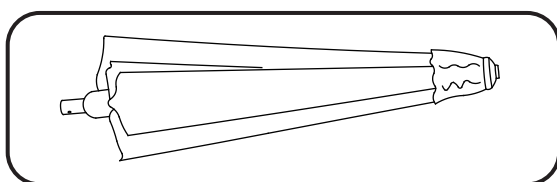

1 × Canopy Pole

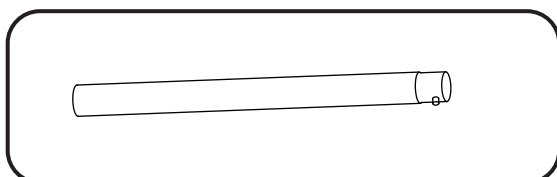

1 × Bottom Pole

People Required: 1



Tools Required: None

Estimated Time: 5 minutes

Maintenance

1. This patio umbrella is used as a sunlight canopy, it is not rain/water proved.
2. This patio umbrella is designed to be used with a base(not included.) If you use it free standing, you will need a base of minimum 30.86 lbs weight. If you use it through the center of a table, you will need a base of minimum 22 lbs weight. Heavier weight of the base, more wind resistant ability of this umbrella.
3. Keep the umbrella away from fire; do not use it during extreme cold and heat, and severe weather like rainy, windy, snowy days, and hailstorms,etc.
4. Fabric might be color faded by a period of use, especially under strong sunlight.
5. It is recommended to replace a new umbrella canopy every year.
6. Check every 6 months that all assembly fastenings are properly tightened and retighten when necessary.

SET UP

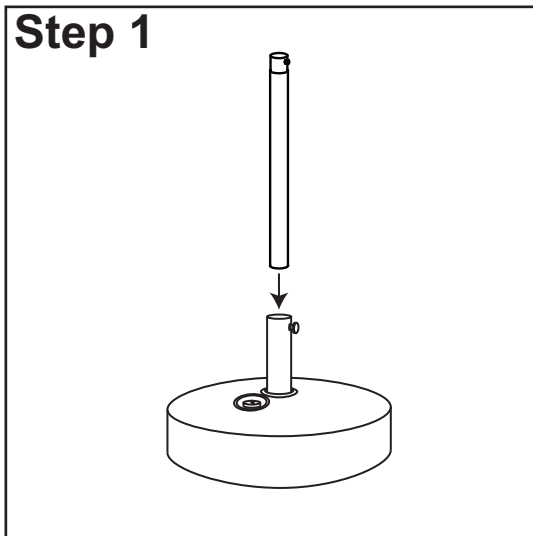

Step 1
Put the Bottom Pole in the matched Umbrella Base.
BASE IS NOT INCLUDED.

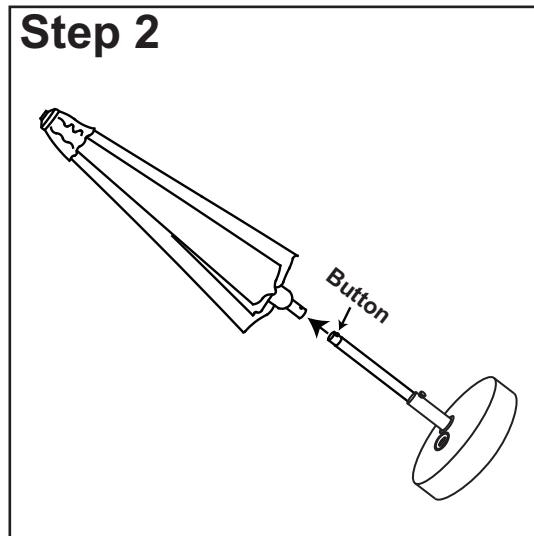

Step 2
Press the button inside the tube and insert it into the Canopy Pole.
When the button pop out through the hole, assembly is completed.

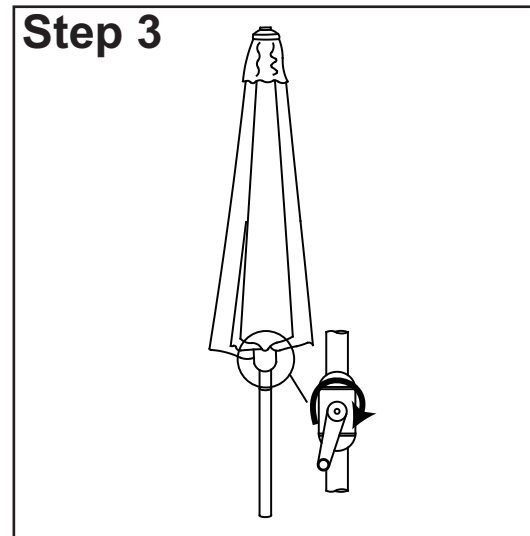

Step 3
Spin the crank clockwise slowly to open the umbrella.
To avoid breakdown, don't overspin the crank.

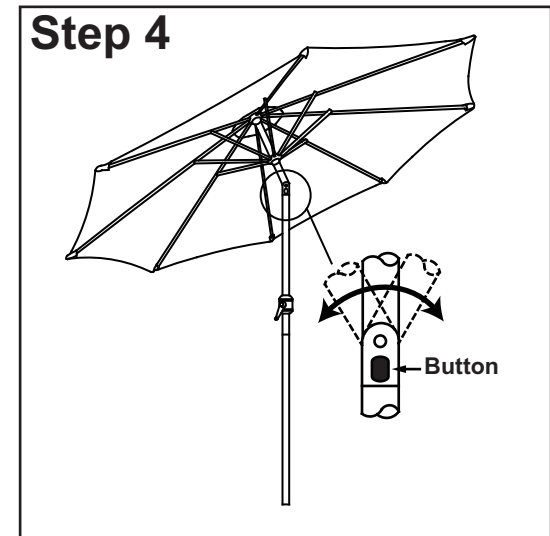

Step 4
Locate the button on the tilt, press it hard and hold it to adjust the tilt in different angle.
Release the button to lock the tilt in favorite angle.
To prevent unnecessary damage. Please fully press the push-button and do not forcibly adjust it by hand.

3

TAKE DOWN

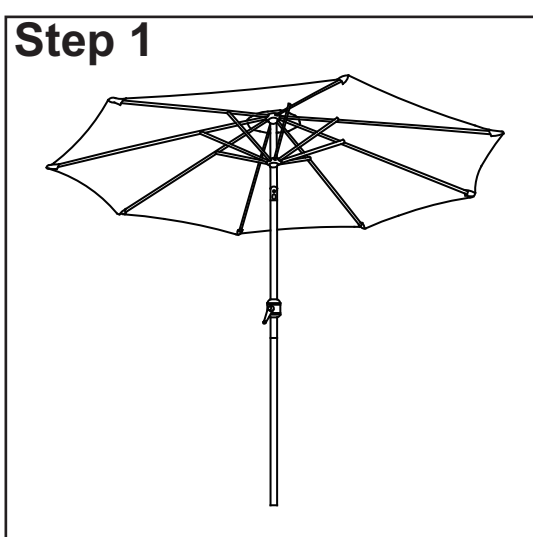

Step 1
Press the button hard and hold it to straighten the angle.

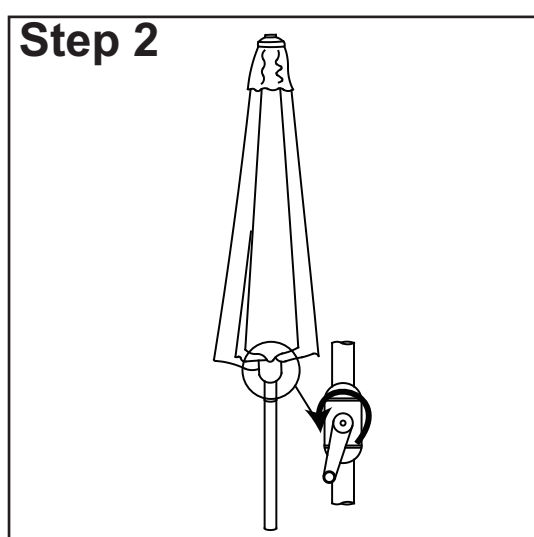

Step 2
Spin the crank counterclockwise slowly until it is fully closed.

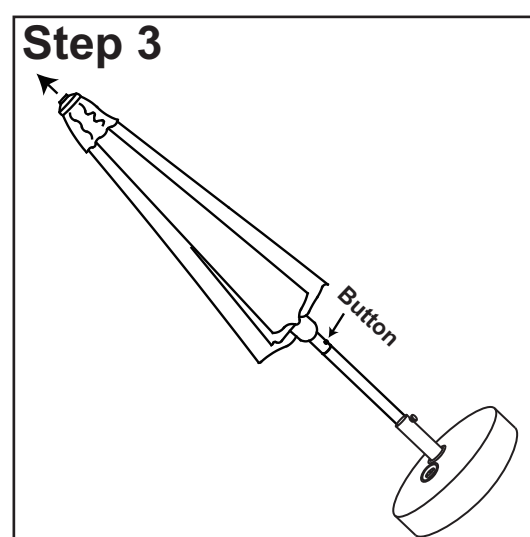

Step 3
Press the spring button and pull the Canopy Pole out.

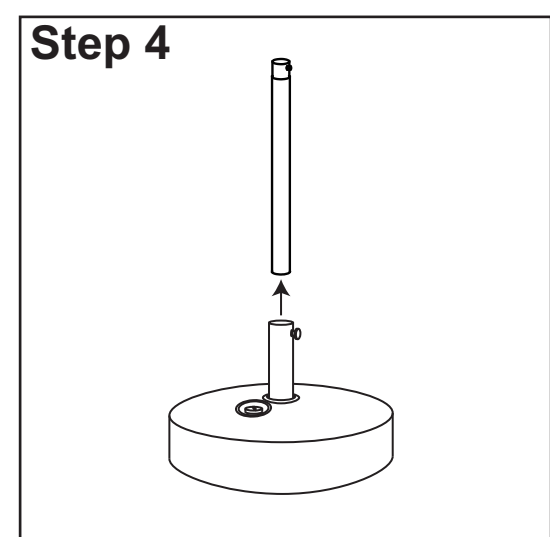

Step 4
Take the Bottom Pole out the Umbrella Base.

4