

# ASSEMBLY INSTRUCTION

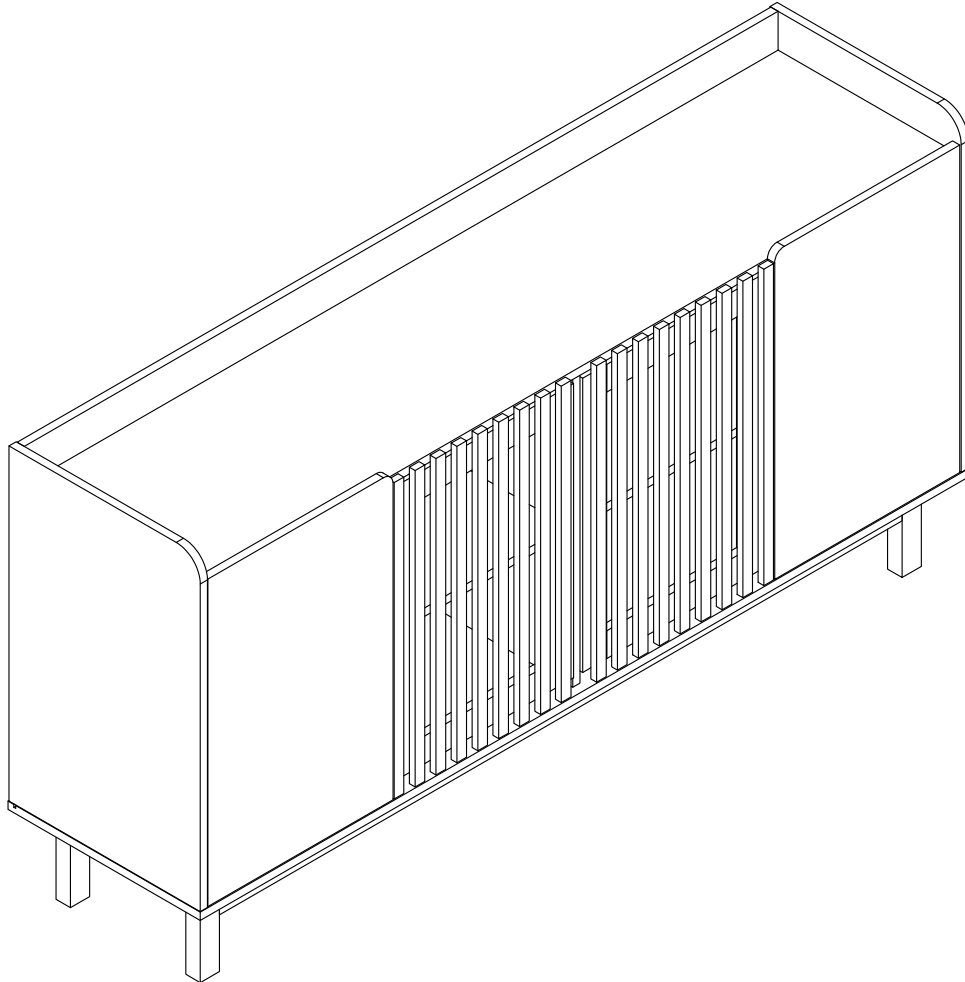

Please don't tighten the screws completely and go back later for a final tightening of all the screws after pieces are aligned with each other.



**MADE IN CHINA**

# ASSEMBLY INSTRUCTION

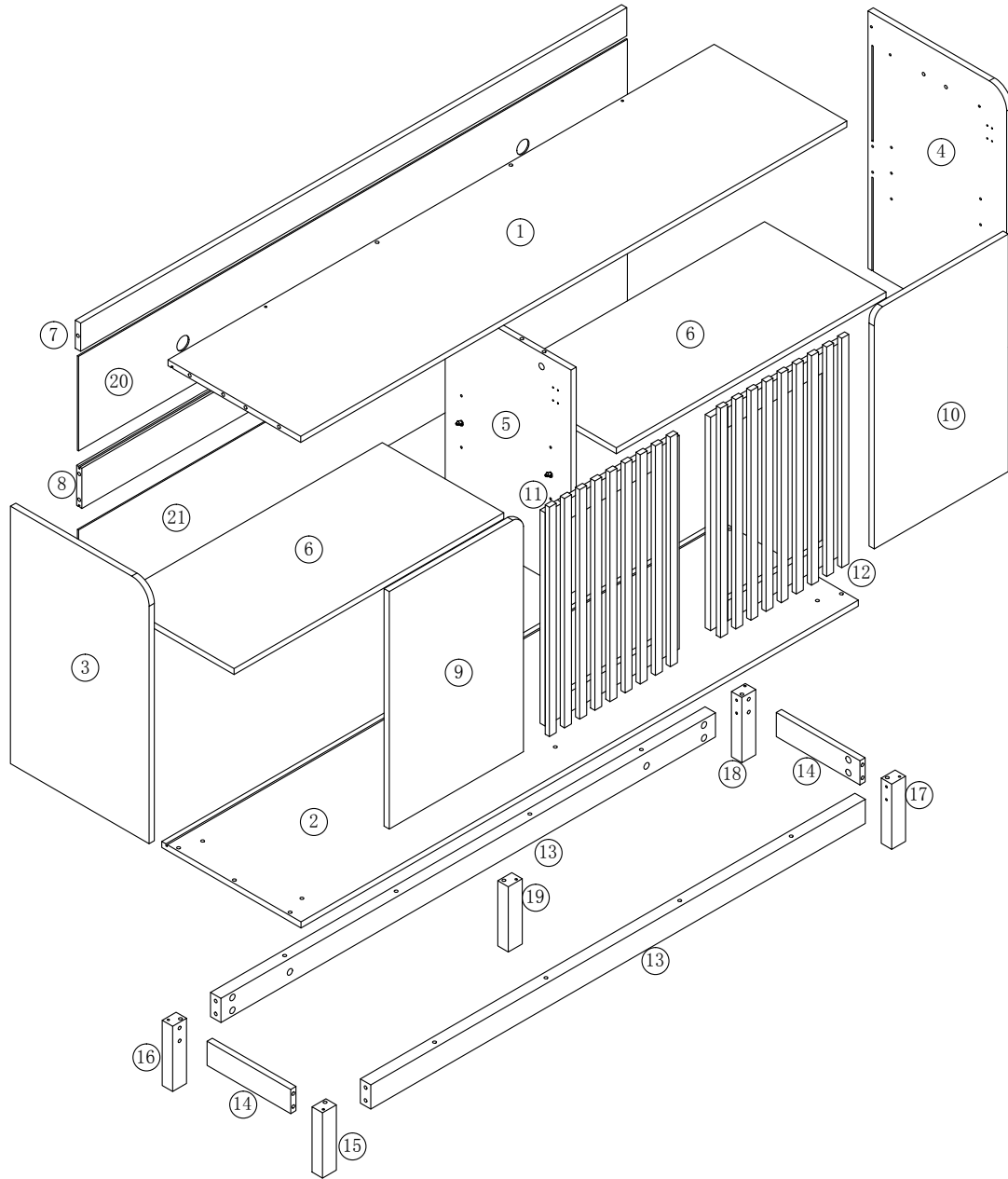

| No. | PICTURE     | SIZE     | QTY  | No. | PICTURE        | SIZE     | QTY  |
|-----|-------------|----------|------|-----|----------------|----------|------|
| A   | $\nabla 11$ | ST6*40   | 30+2 | F   | X2 X2 X2 X2 X1 |          | 2    |
| B   |             | 8*35     | 17+2 | G   |                | ST3.5*14 | 48+2 |
| C   |             | ST7*40   | 15   | H   |                | ST7*60   | 4    |
| D   | X1          | ST3.5*14 | 8    |     | →              | 30+2     | 1    |
| E   |             |          | 8    |     |                | M4       | 1    |

# ASSEMBLY INSTRUCTION

1

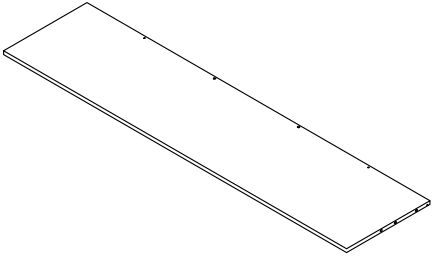

X1

2

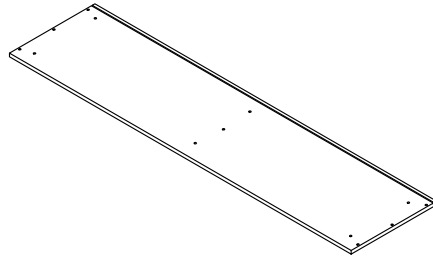

X1

3

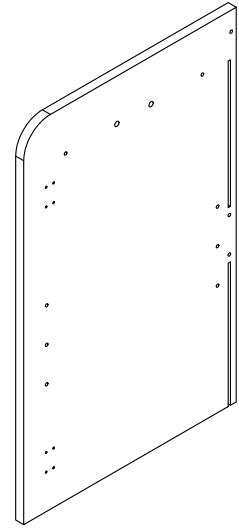

X1

4

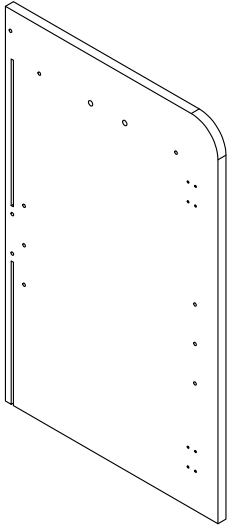

X1

5



X1

6

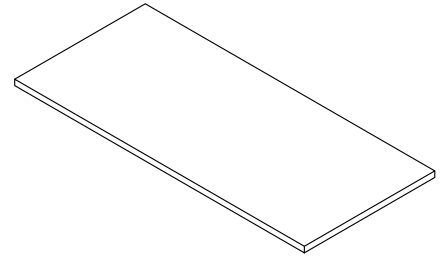

X2

7

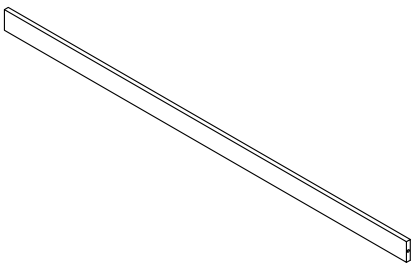

X1

8

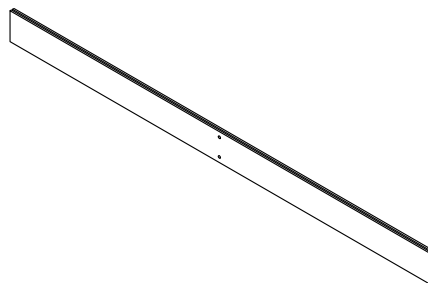

X1

9

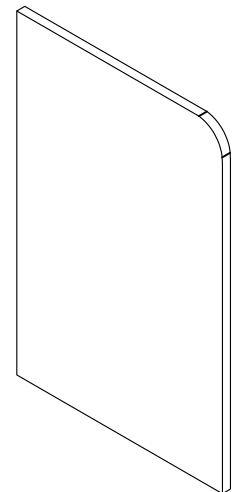

X1

# ASSEMBLY INSTRUCTION

10

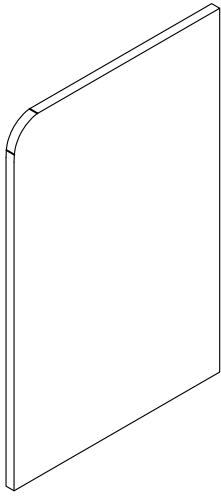

X1

11

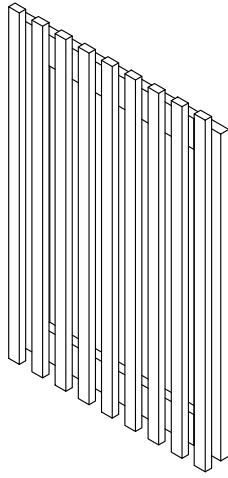

X1

12

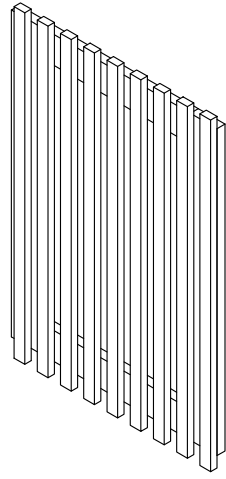

X1

13

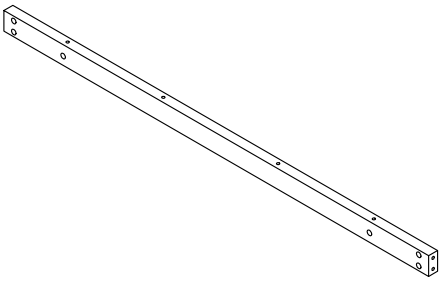

X2

14

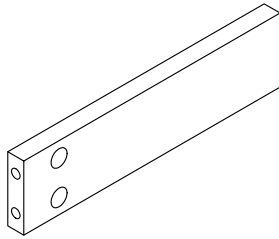

X2

17

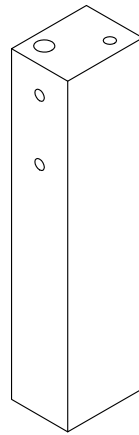

X1

18

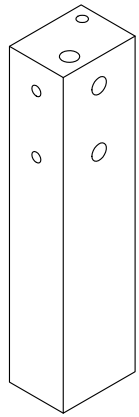

X1

15

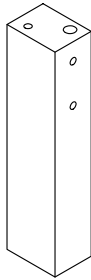

X1

16

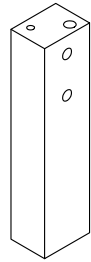

X1

19

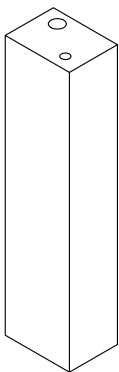

X1

20

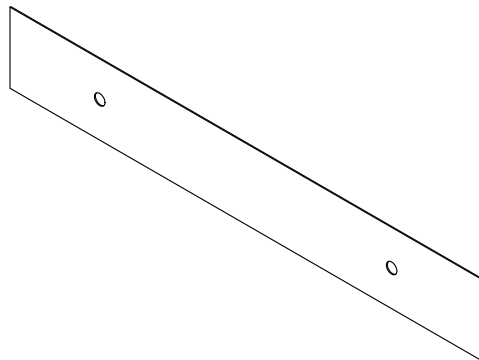

X1

21

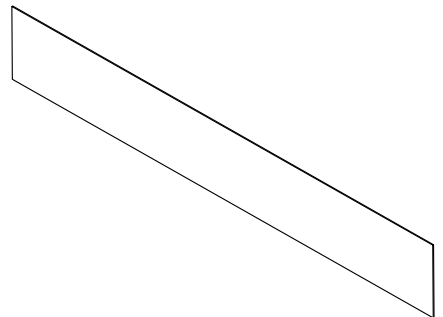

X1

# ASSEMBLY INSTRUCTION

## STEP 1

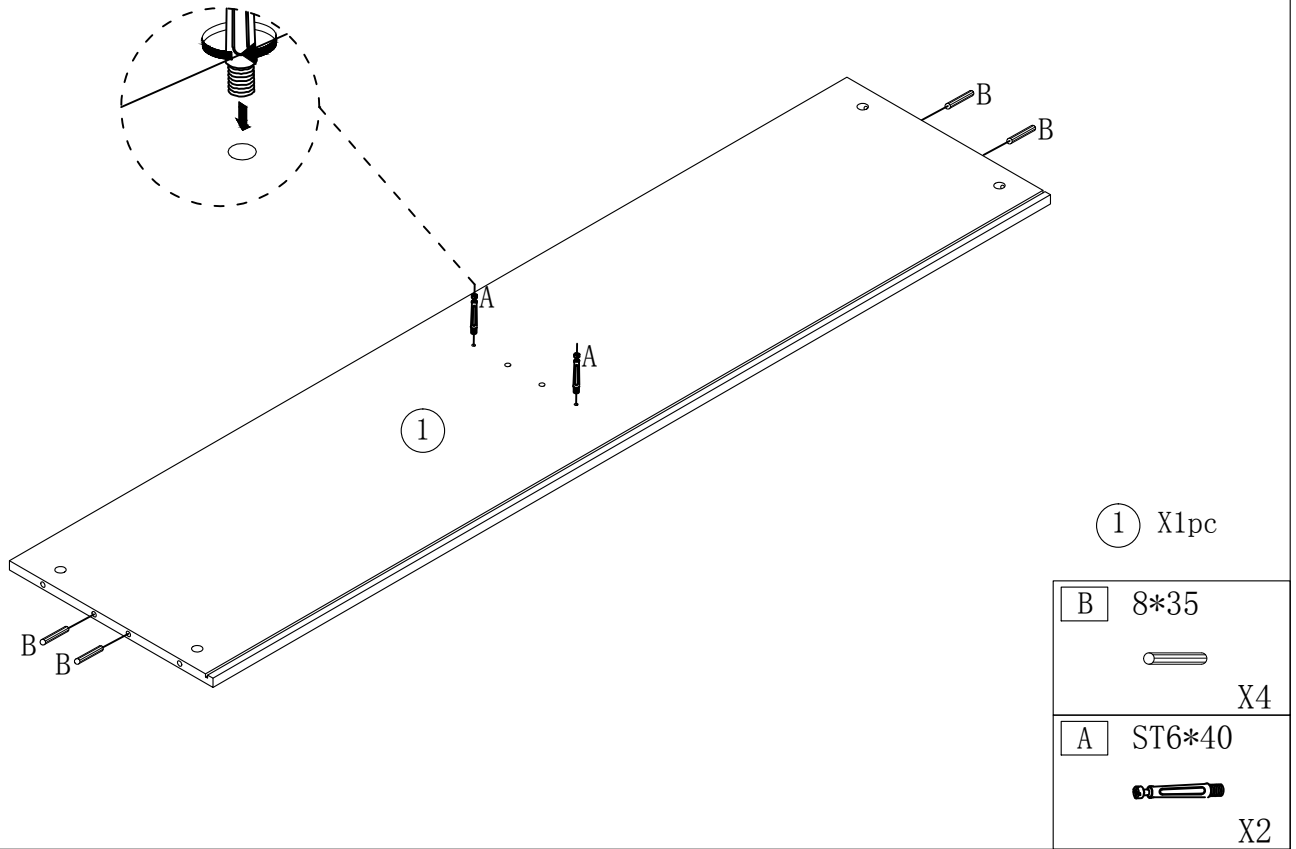

## STEP 2

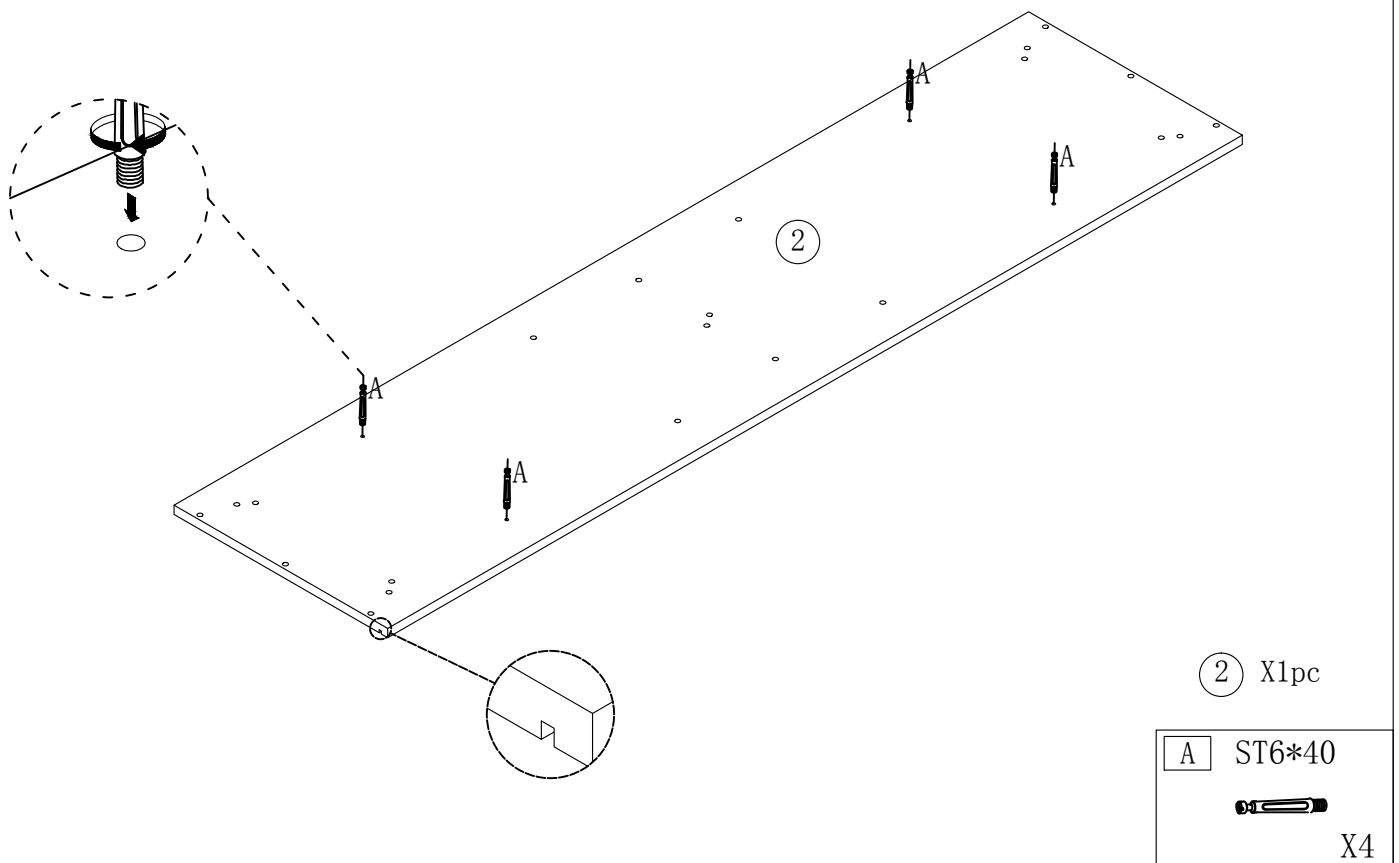

# ASSEMBLY INSTRUCTION

## STEP 3

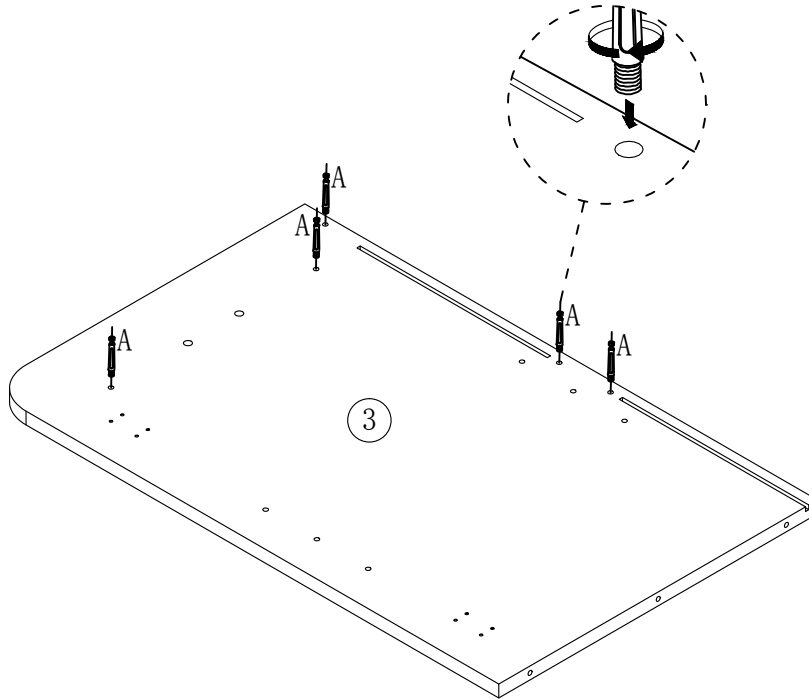

③ X1pc

A ST6\*40



X5

## STEP 4

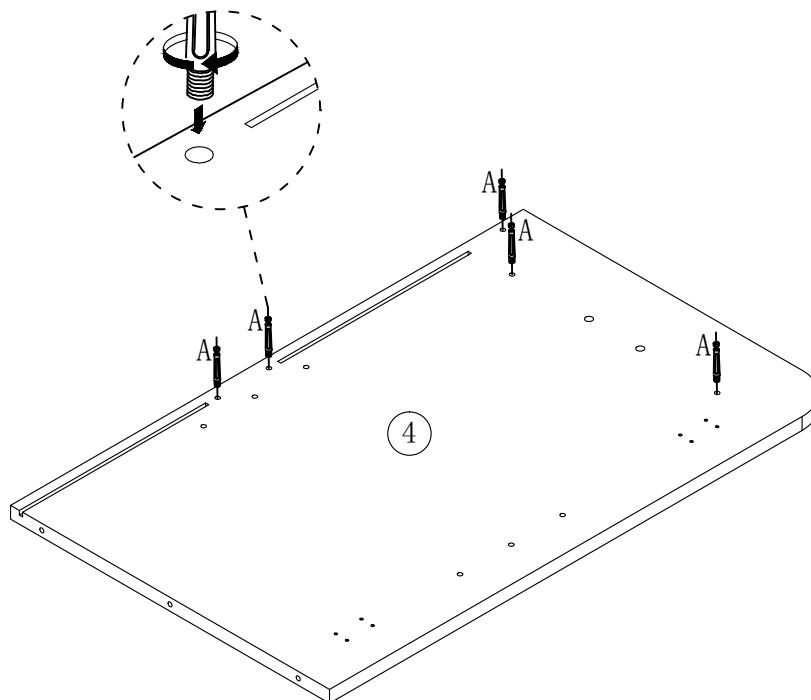

④ X1pc

A ST6\*40



X5

# ASSEMBLY INSTRUCTION

## STEP 5

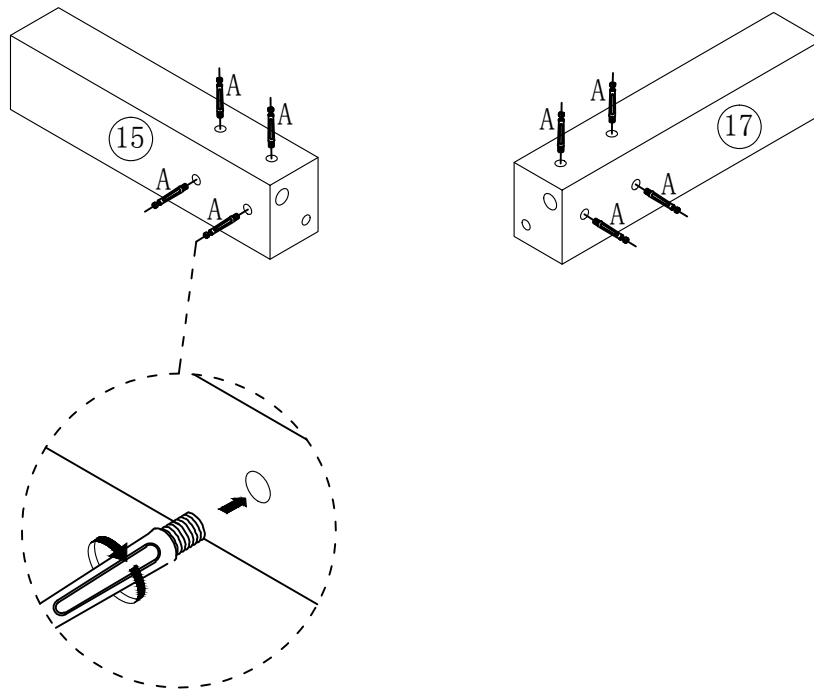

- ⑮ X1pc
- ⑰ X1pc

A ST6\*40



X8

## STEP 6

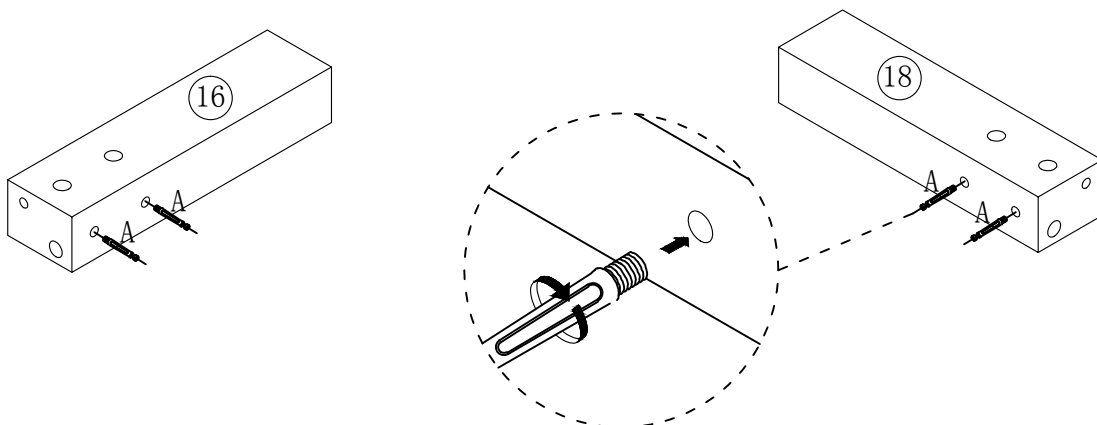

- ⑯ X1pc
- ⑱ X1pc

A ST6\*40





X4

# ASSEMBLY INSTRUCTION

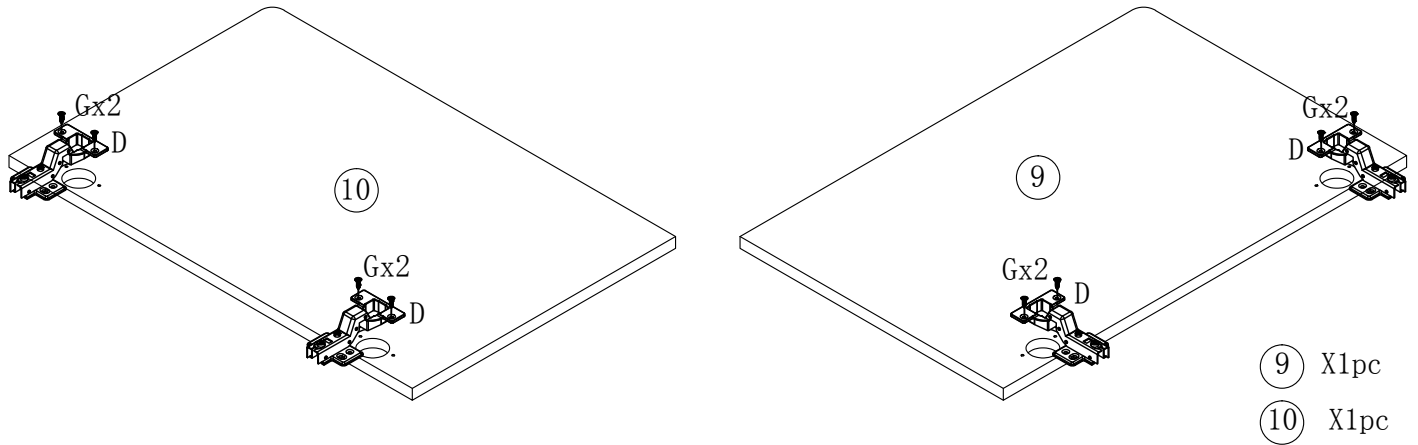
## STEP 7





- ⑨ X1pc
- ⑩ X1pc

|   |   |    |
|---|---|----|
| G | ST3.5*14  |    |
|   |    | X8 |
| D |  | X4 |

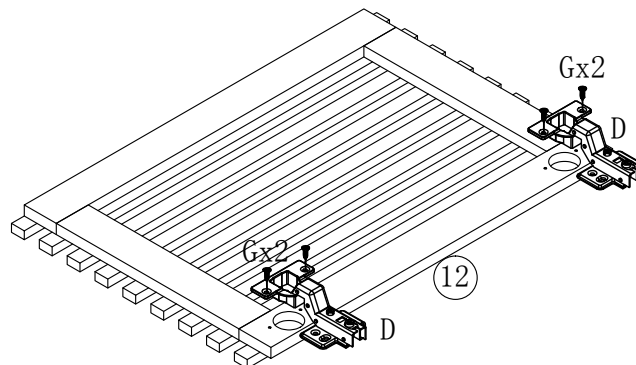
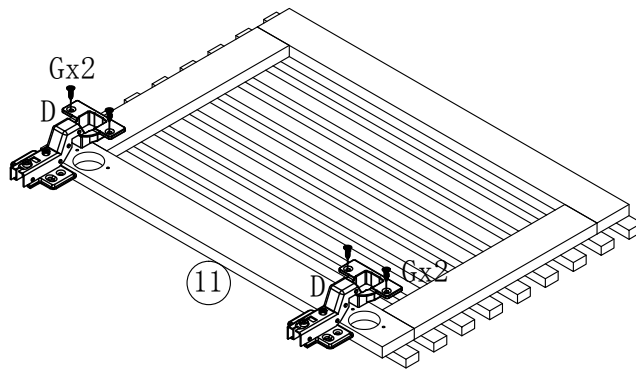
## STEP 8



- ⑪ X1pc
- ⑫ X1pc

|   |   |    |
|---|---|----|
| G | ST3.5*14  |    |
|   |  | X8 |
| D |  | X4 |

# ASSEMBLY INSTRUCTION

## STEP 9

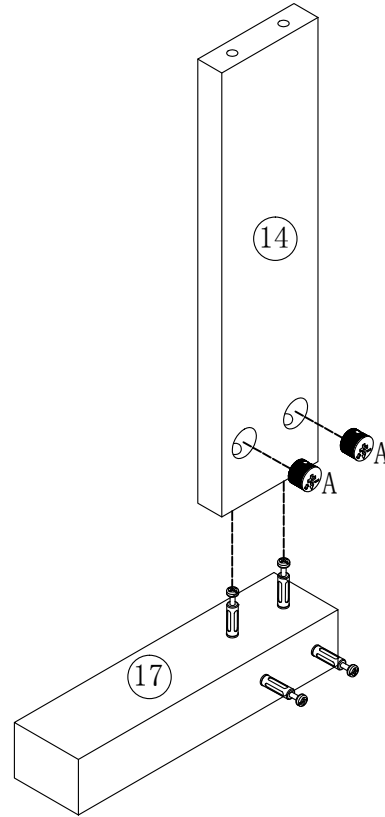
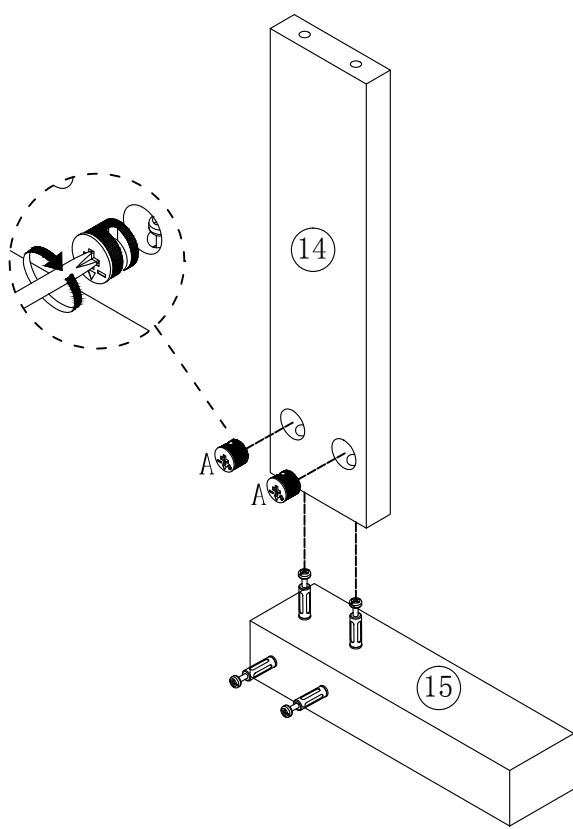

- ⑭ X2pcs
- ⑮ X1pc
- ⑰ X1pc

|   |  |
|---|--|
| A | ▽11  |
|   |  X4 |

## STEP 10

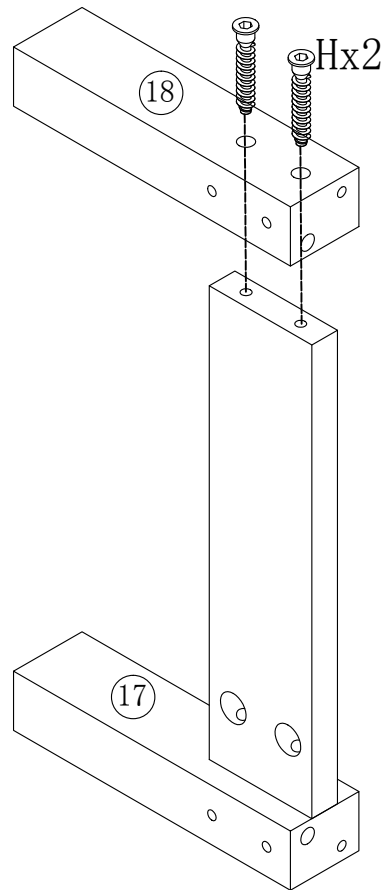
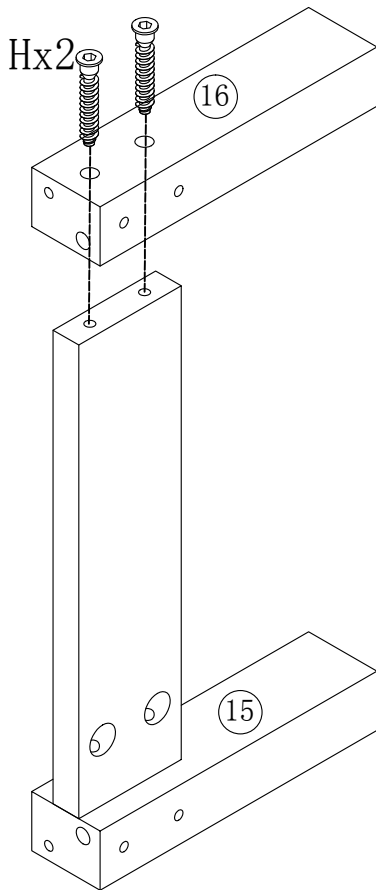

- ⑯ X1pc
- ⑰ X1pc

|   |  |
|---|--|
| H | ST7*60   |
|   |  X4 |

# ASSEMBLY INSTRUCTION

STEP 11

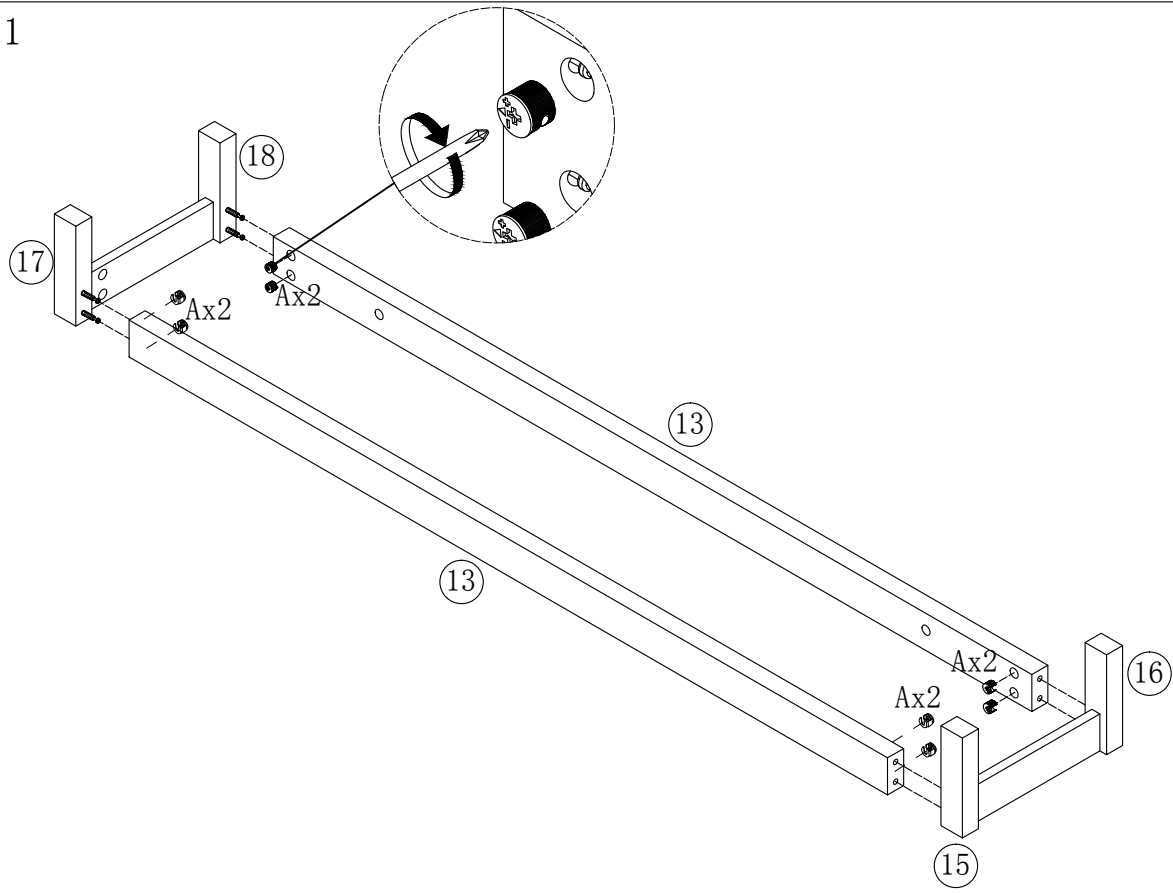

⑬ X2pcs

|   |  |
|---|--|
| A | ▽11  |
|   |  X8 |

STEP 12

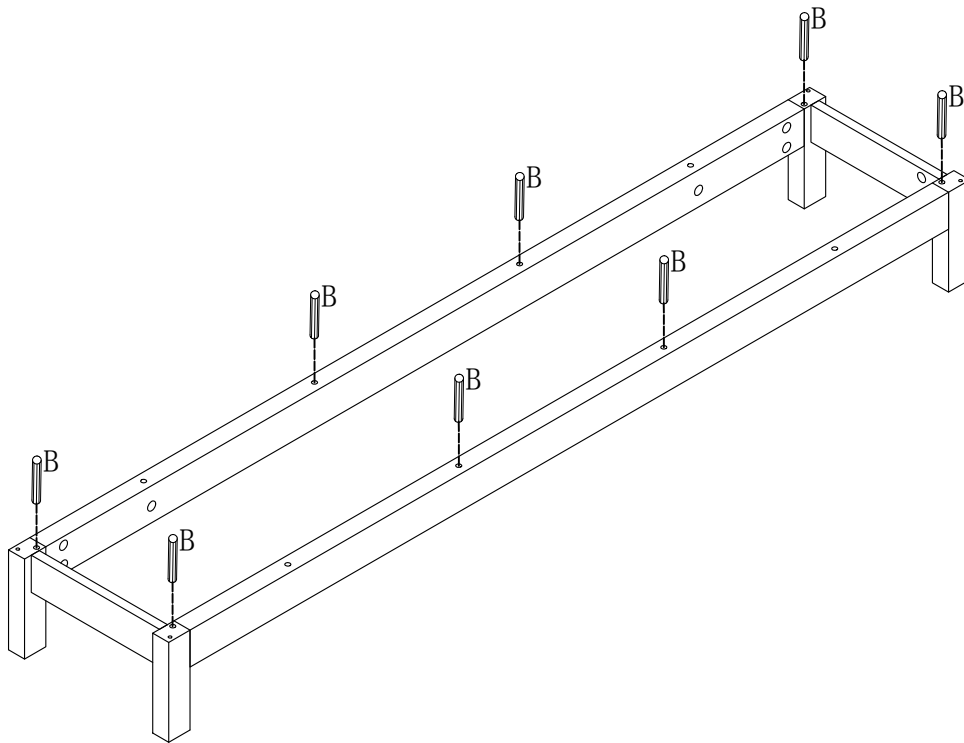

|   |  |
|---|--|
| B | 8*35   |
|   |  X8 |

# ASSEMBLY INSTRUCTION

## STEP 13

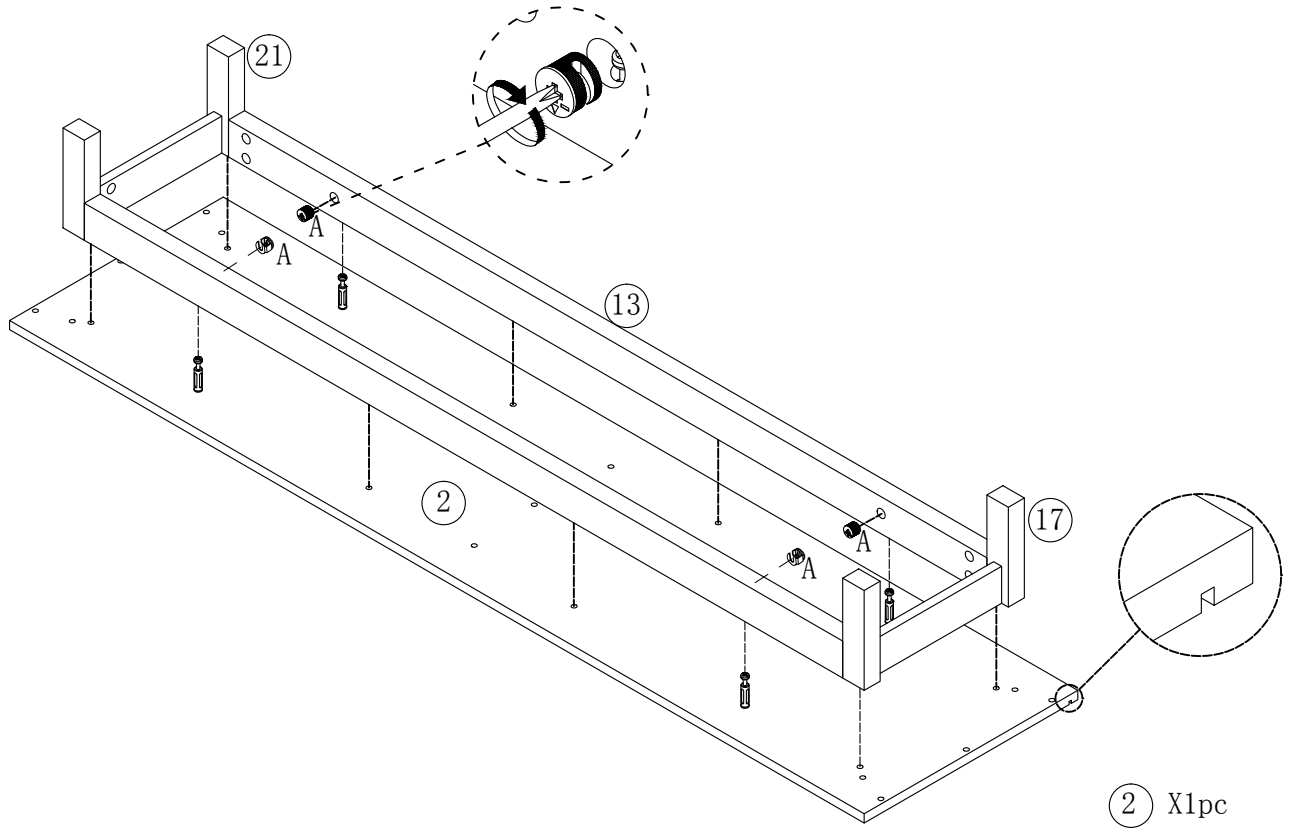

(2) X1pc

|   |  |
|---|--|
| A | ▽11  |
|   |  X4 |

## STEP 14

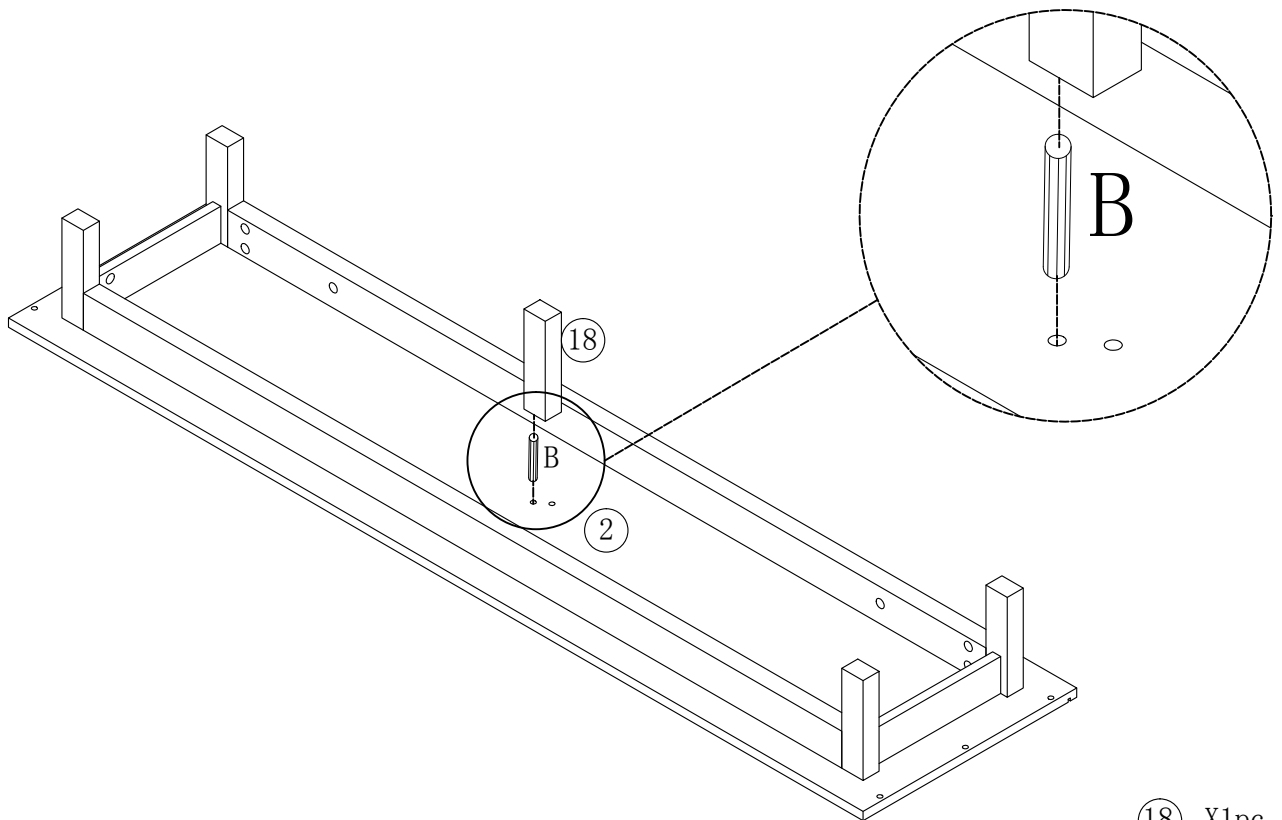

(18) X1pc

|   |  |
|---|--|
| B | 8*35   |
|   |  X1 |

# ASSEMBLY INSTRUCTION

STEP 15

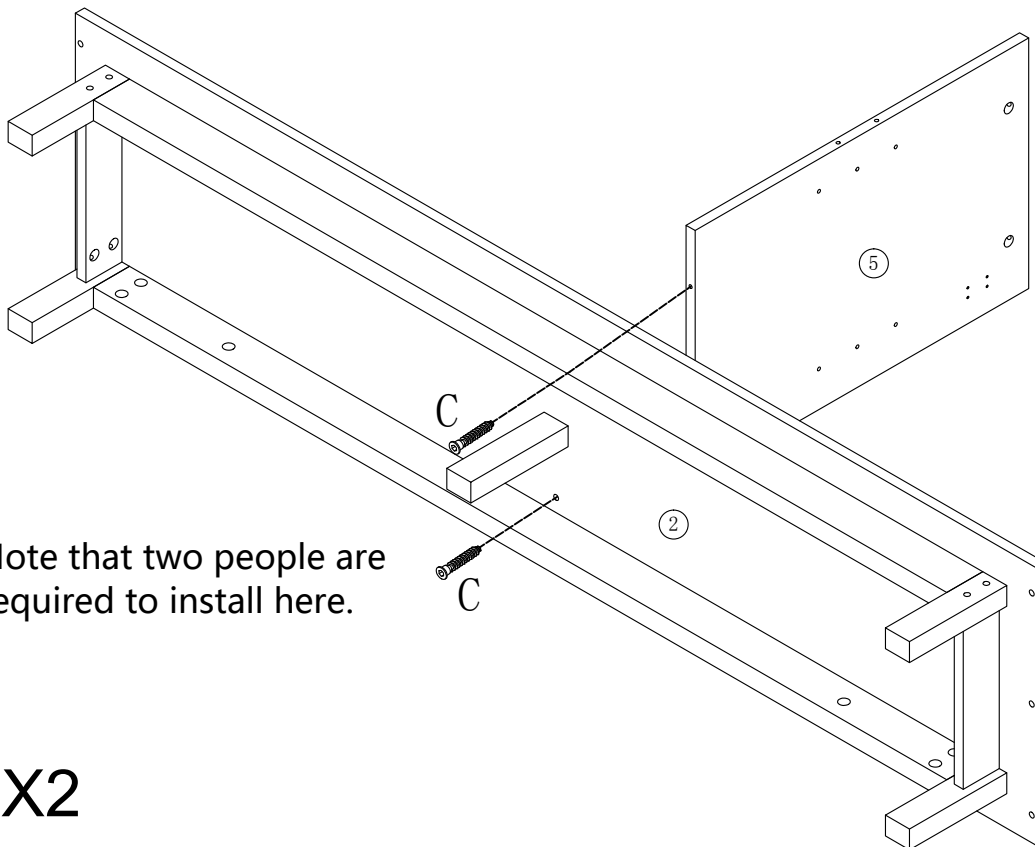
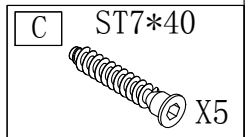
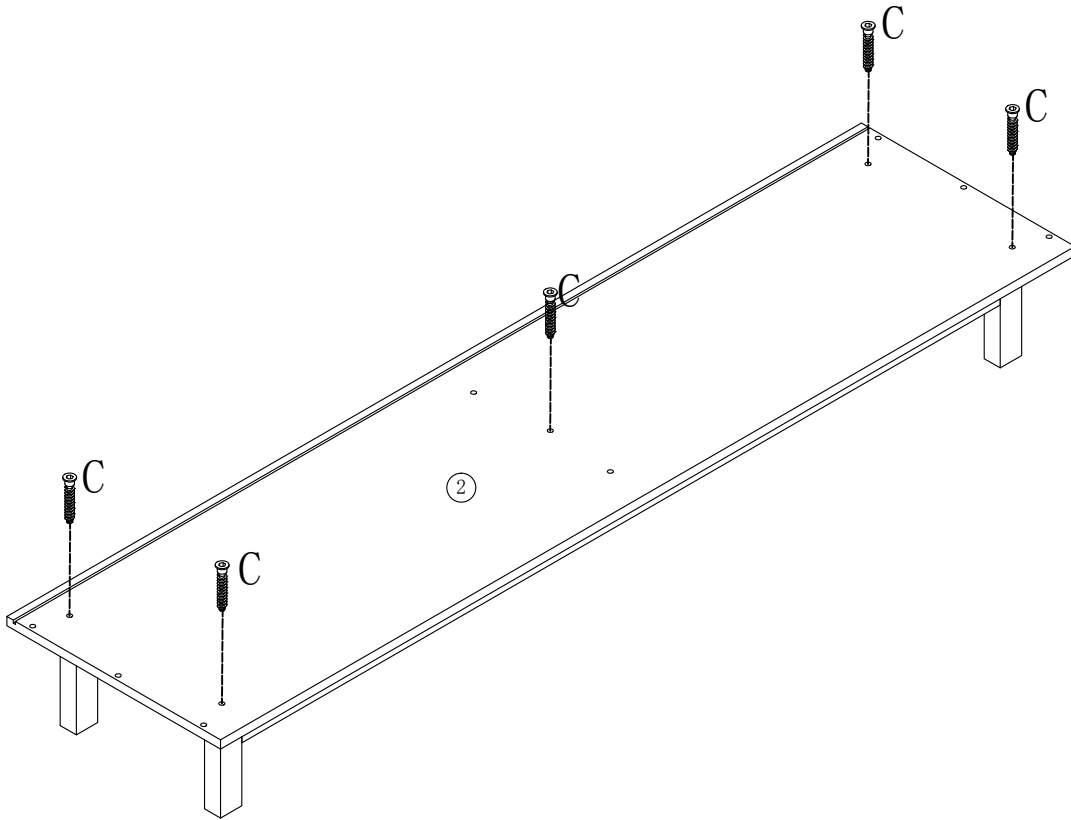

Note that two people are required to install here.

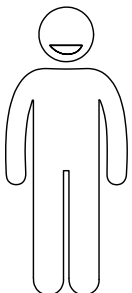

X2

5 X1pc

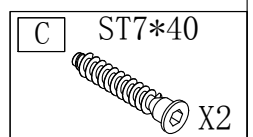

# ASSEMBLY INSTRUCTION

STEP 17

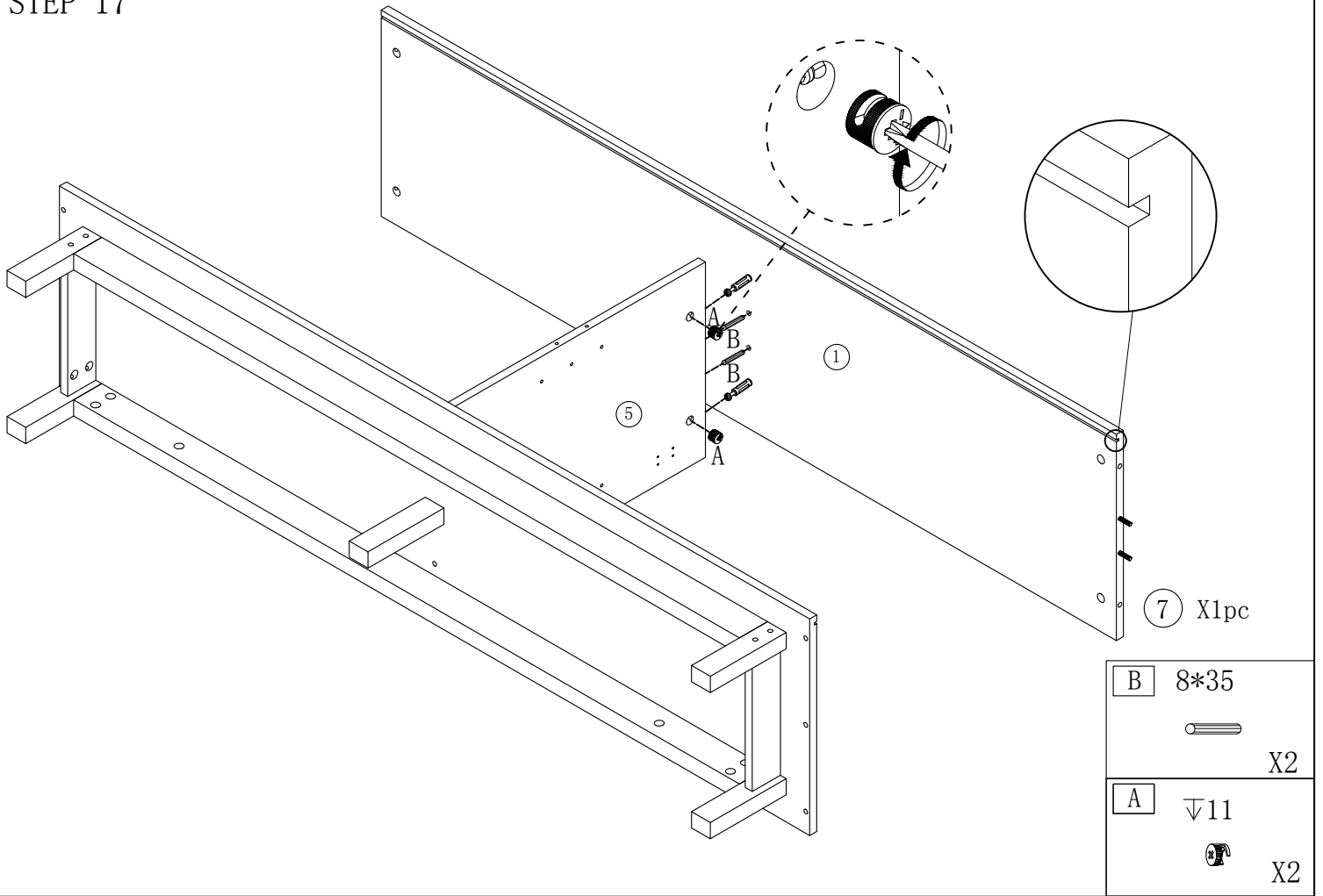

STEP 18

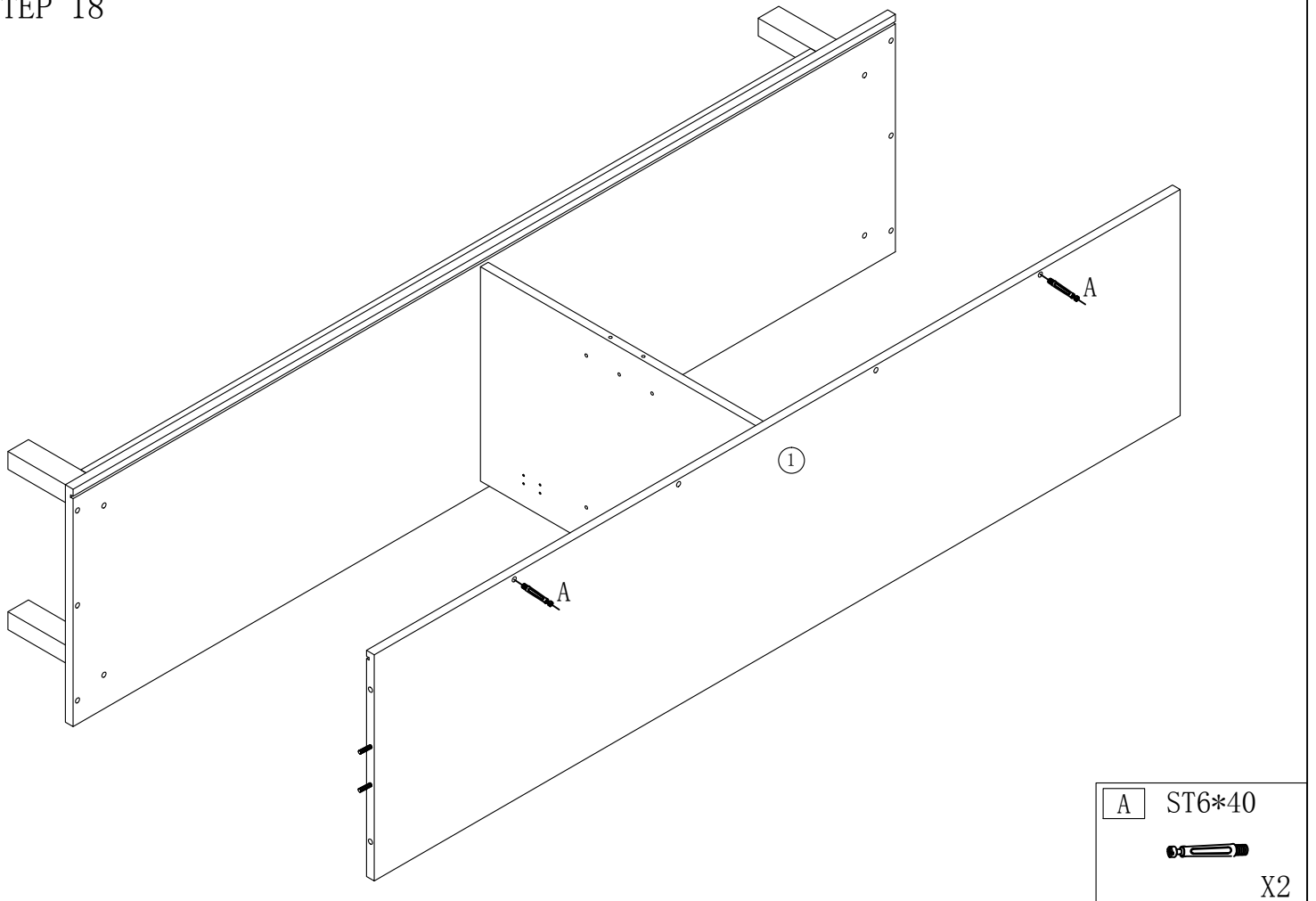

# ASSEMBLY INSTRUCTION

STEP 19

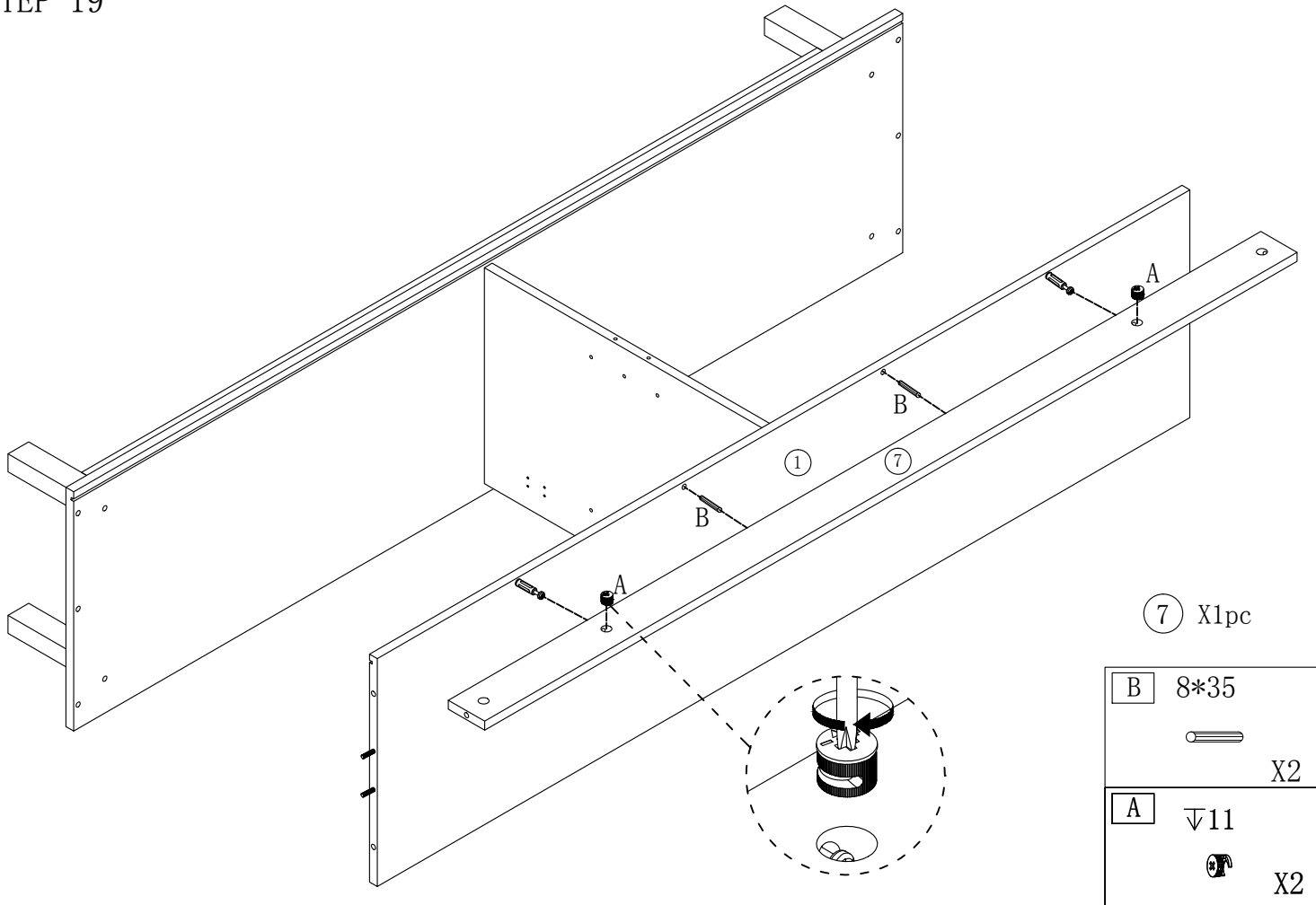

STEP 20

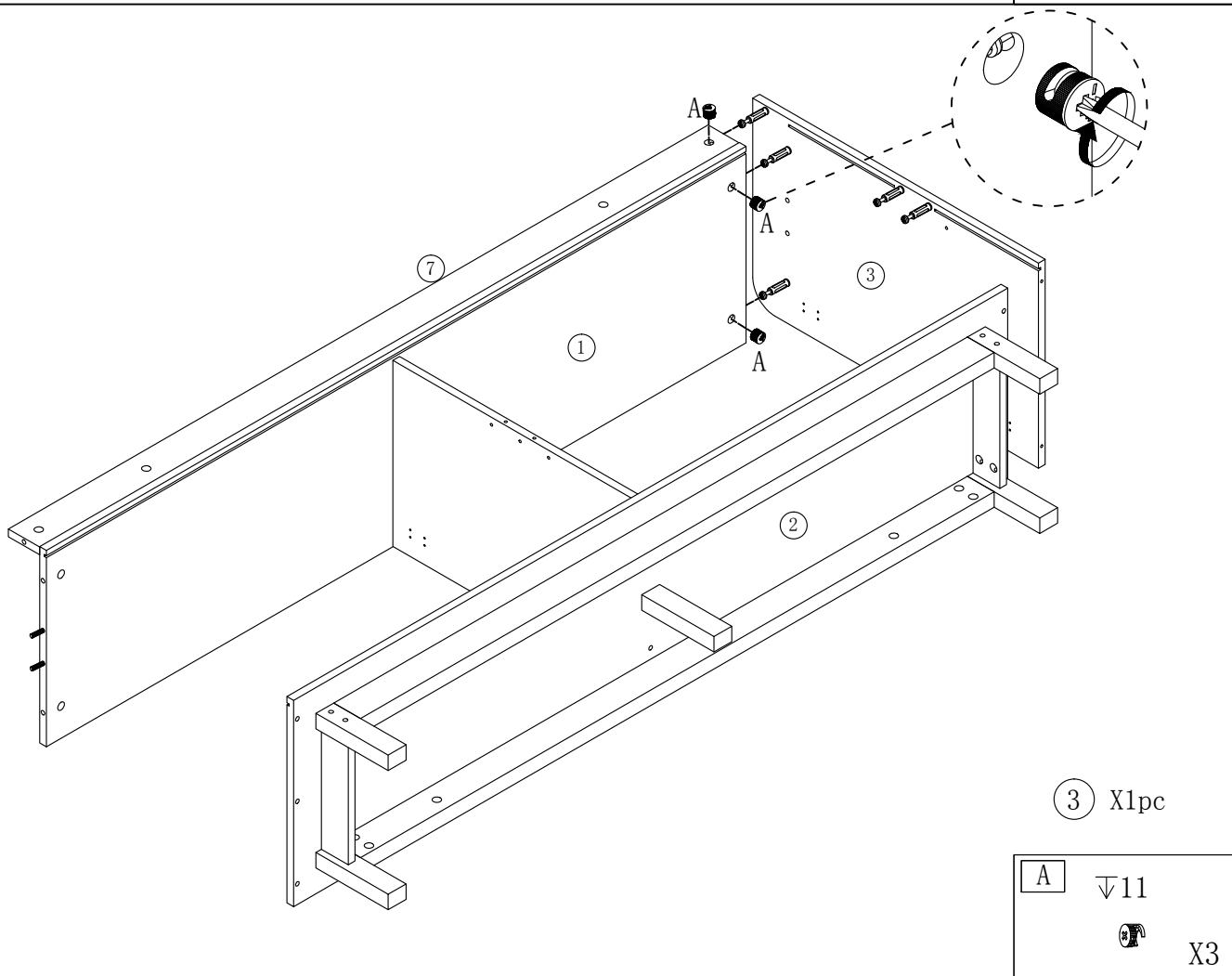

# ASSEMBLY INSTRUCTION

STEP 21

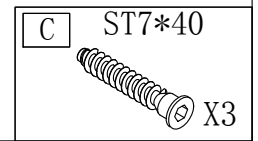
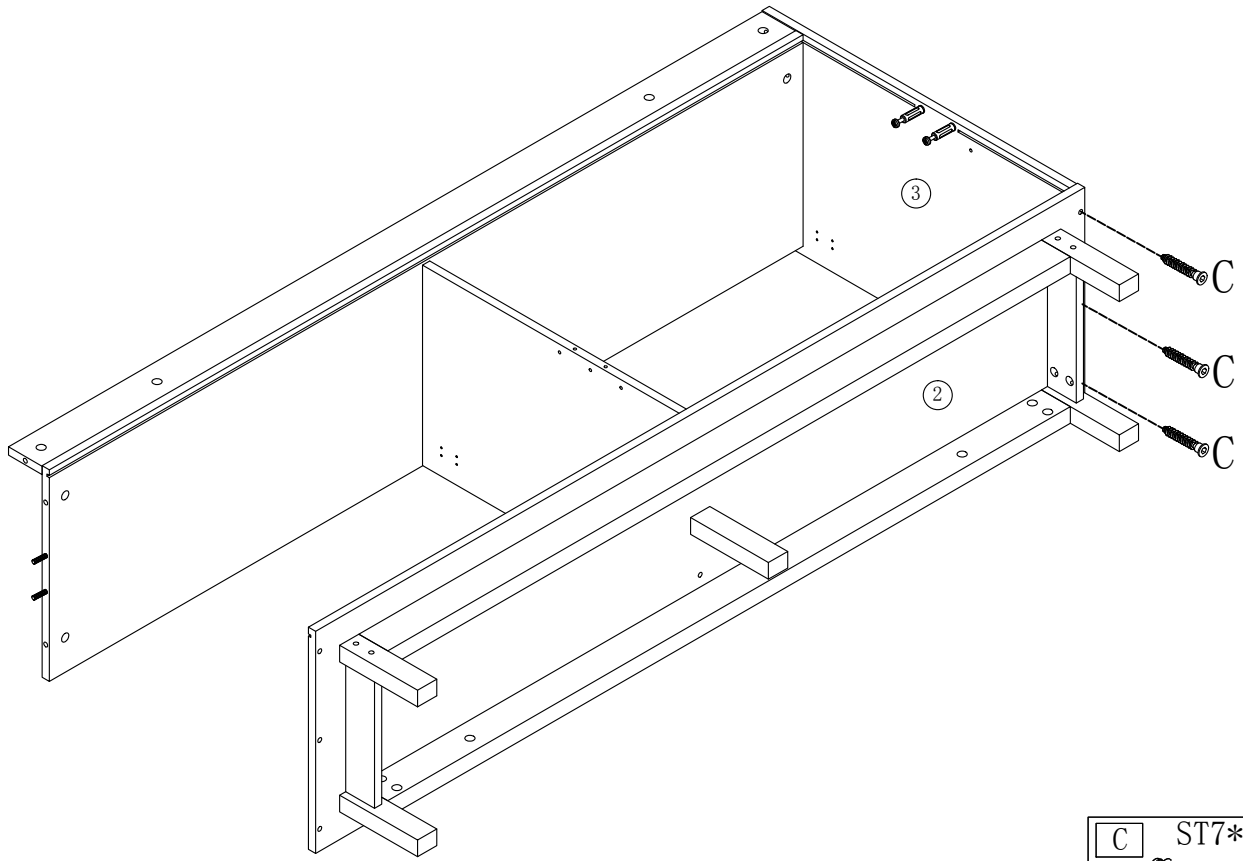

STEP 22

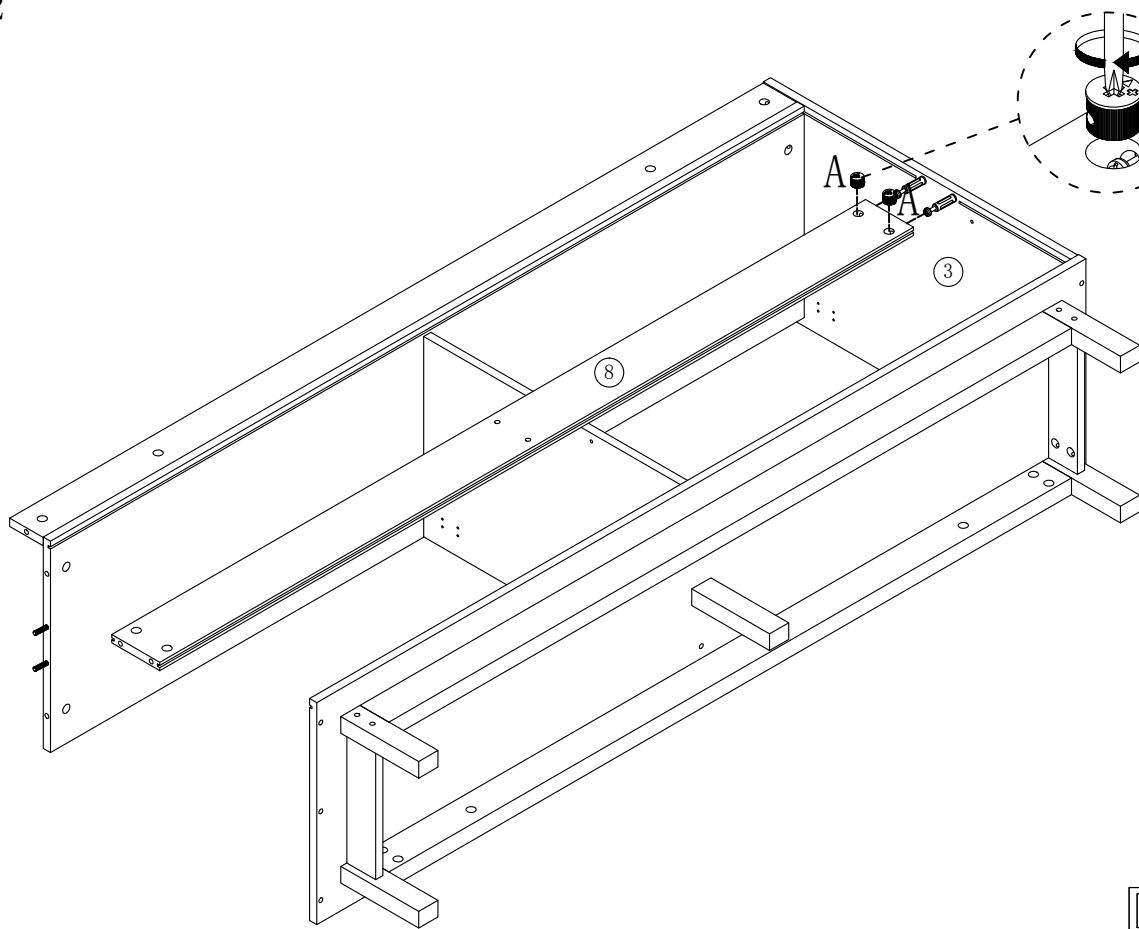

⑧ X1pc

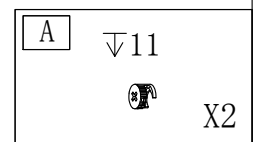

# ASSEMBLY INSTRUCTION

STEP 23

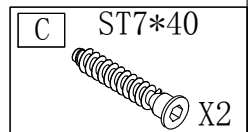
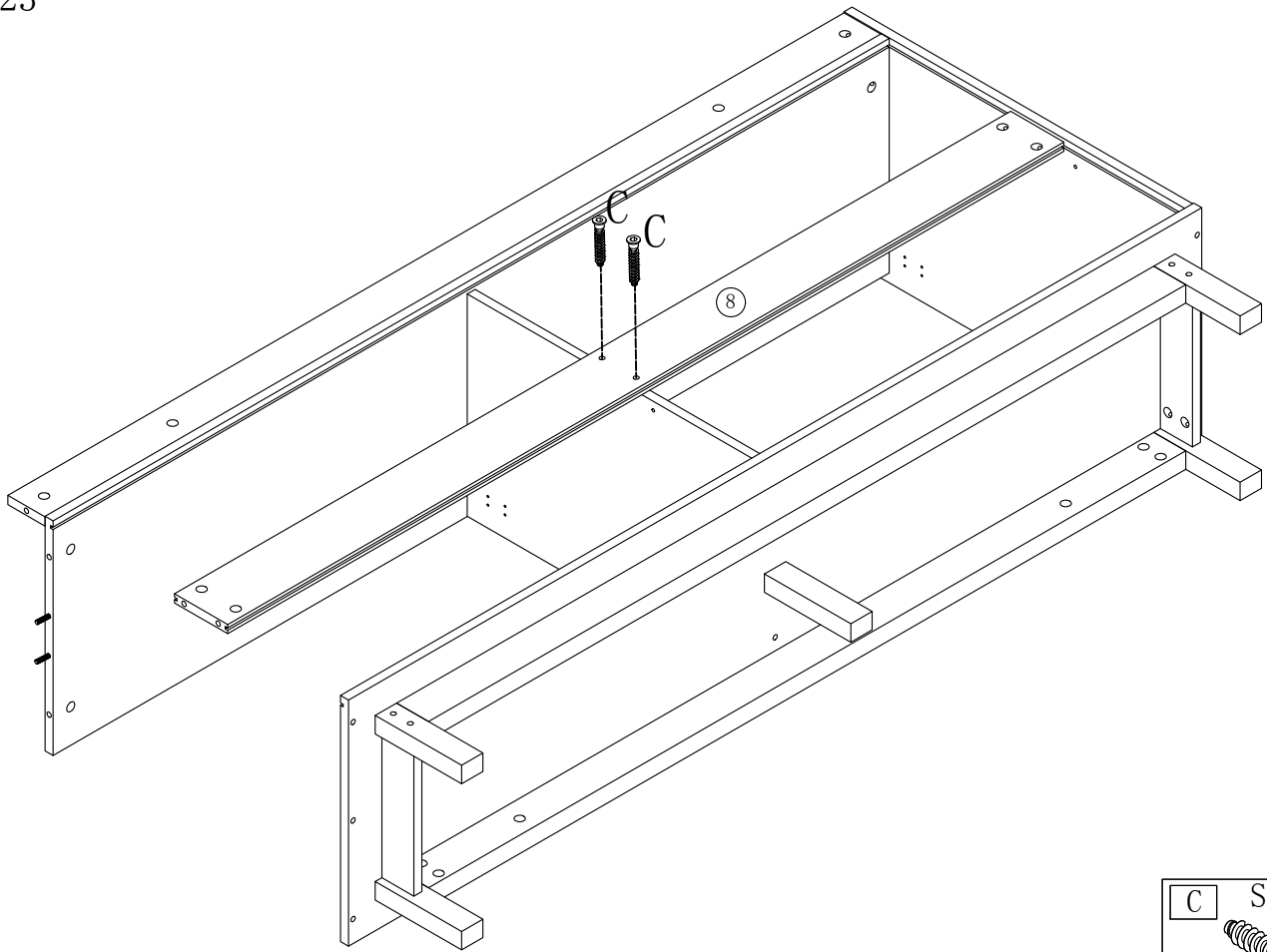

STEP 24

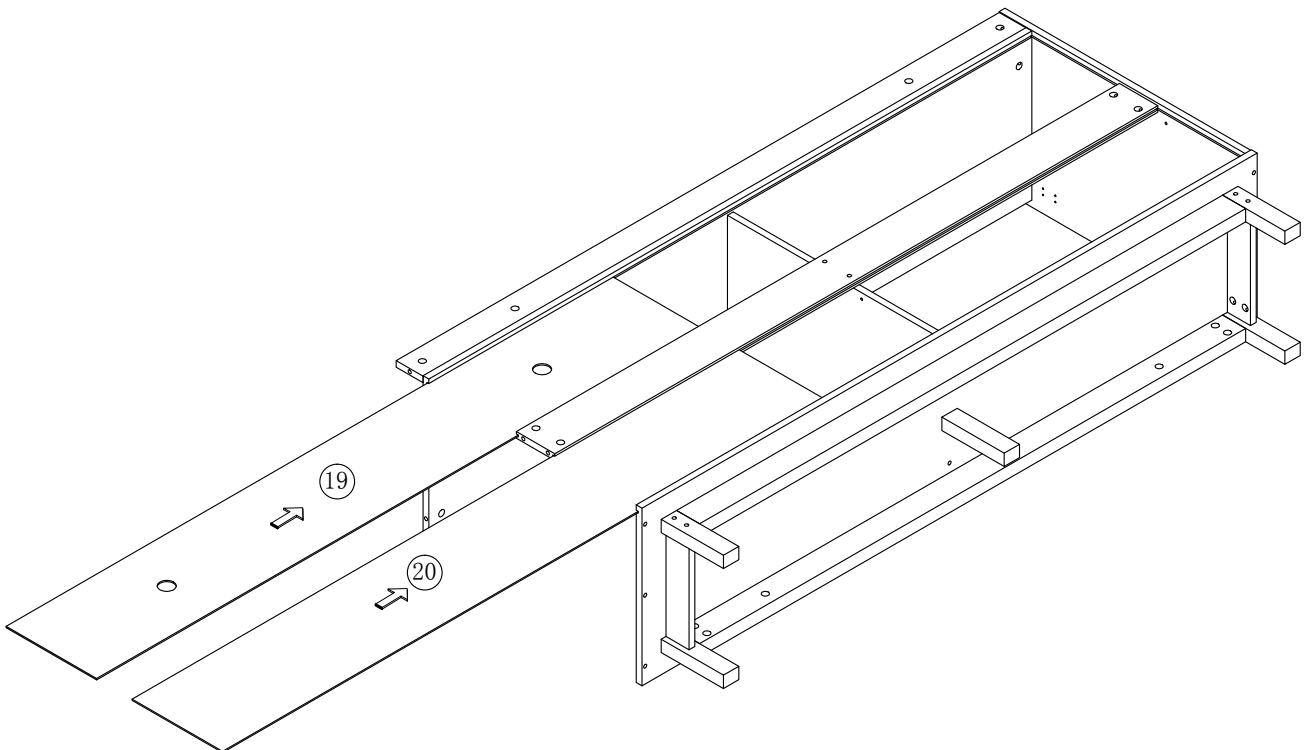

- ①9 X1pc
- ①0 X1pc

# ASSEMBLY INSTRUCTION

STEP 25

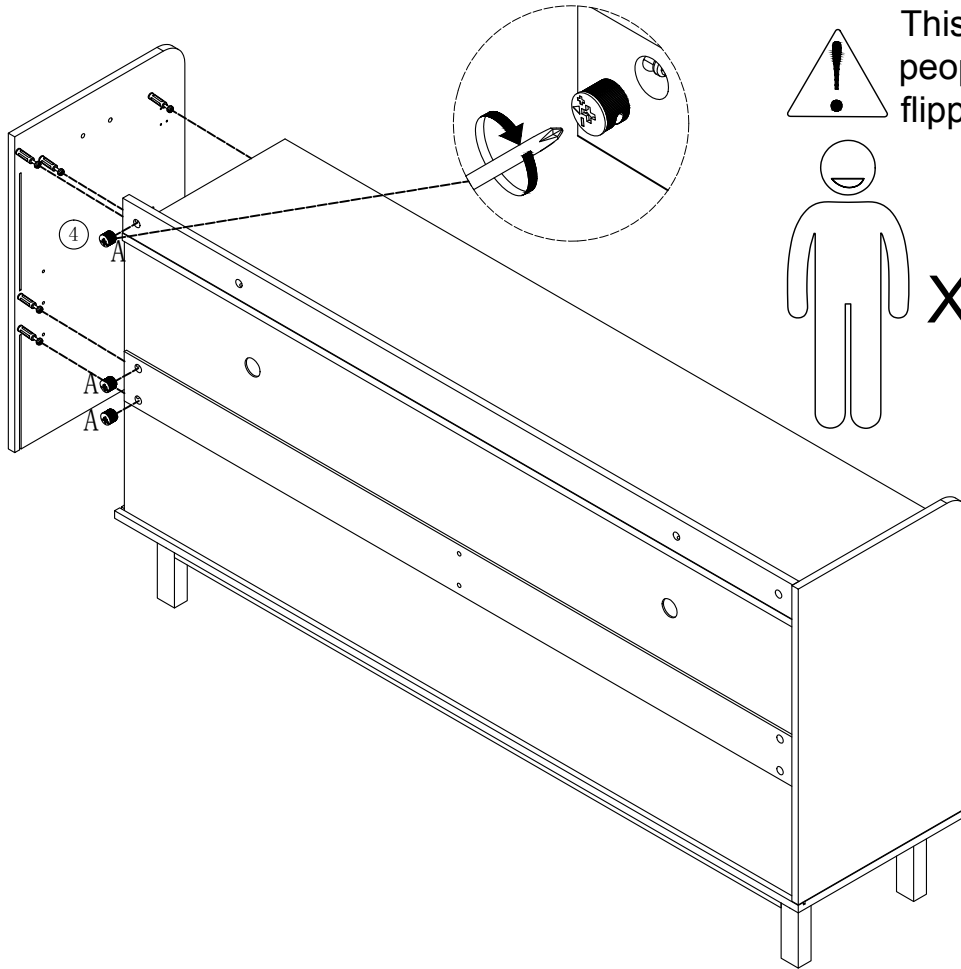

This step requires two people to operate when flipping.

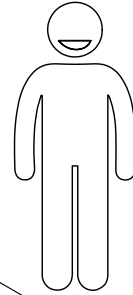

X2

④ X1pc

|   |     |    |
|---|-----|----|
| A | ▽11 |    |
|   |     | X3 |

STEP 26

This step requires two people to operate when flipping.

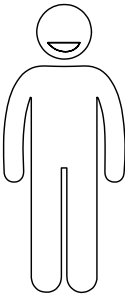

X2

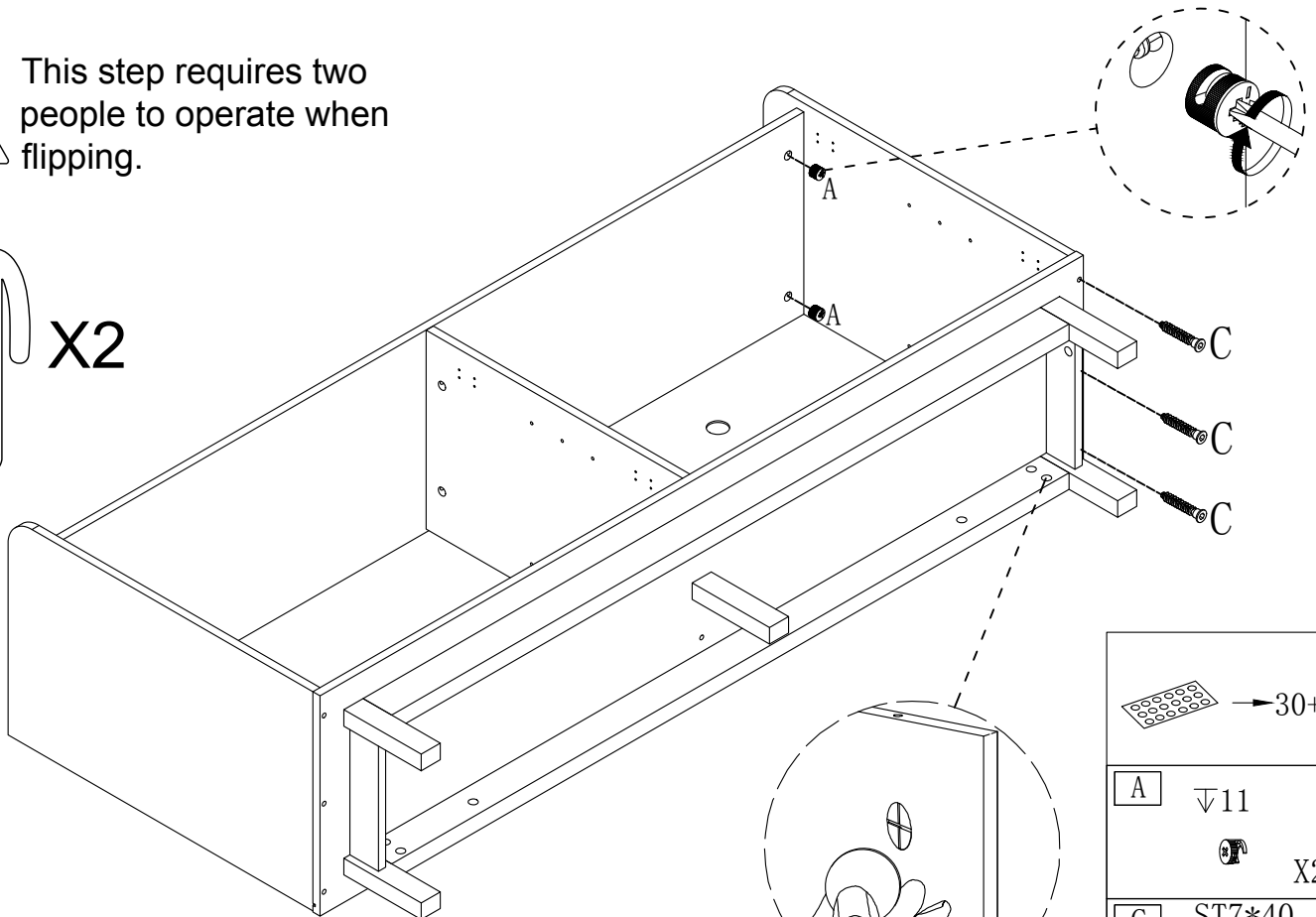

|   |        |       |
|---|--------|-------|
|   |        | →30+2 |
| A | ▽11    |       |
|   |        | X2    |
| C | ST7*40 |       |
|   |        | X3    |

# ASSEMBLY INSTRUCTION

## STEP 27



This step requires two people to operate when flipping.

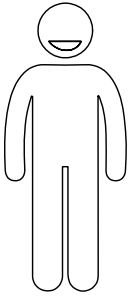

X2

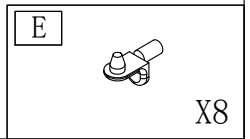
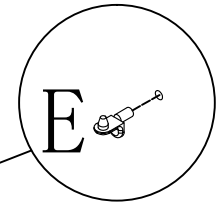
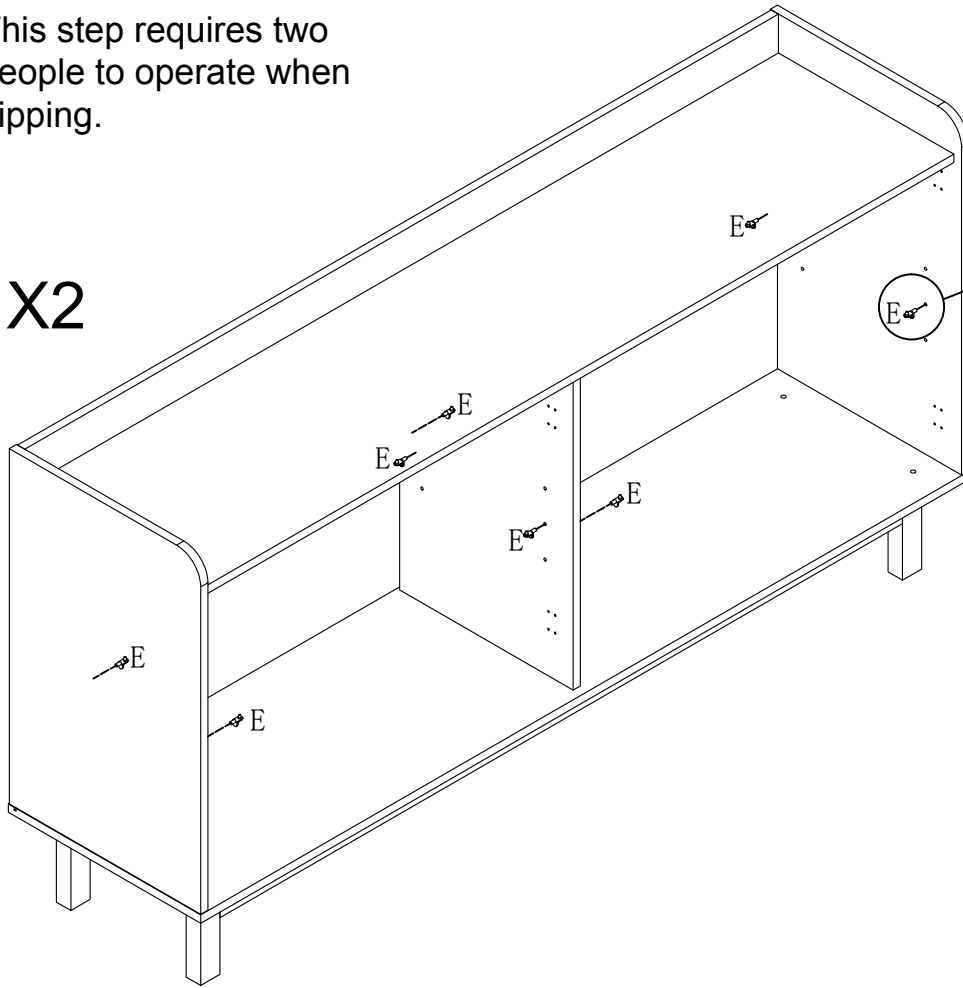

## STEP 28

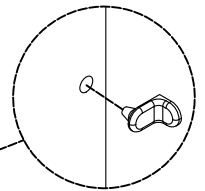
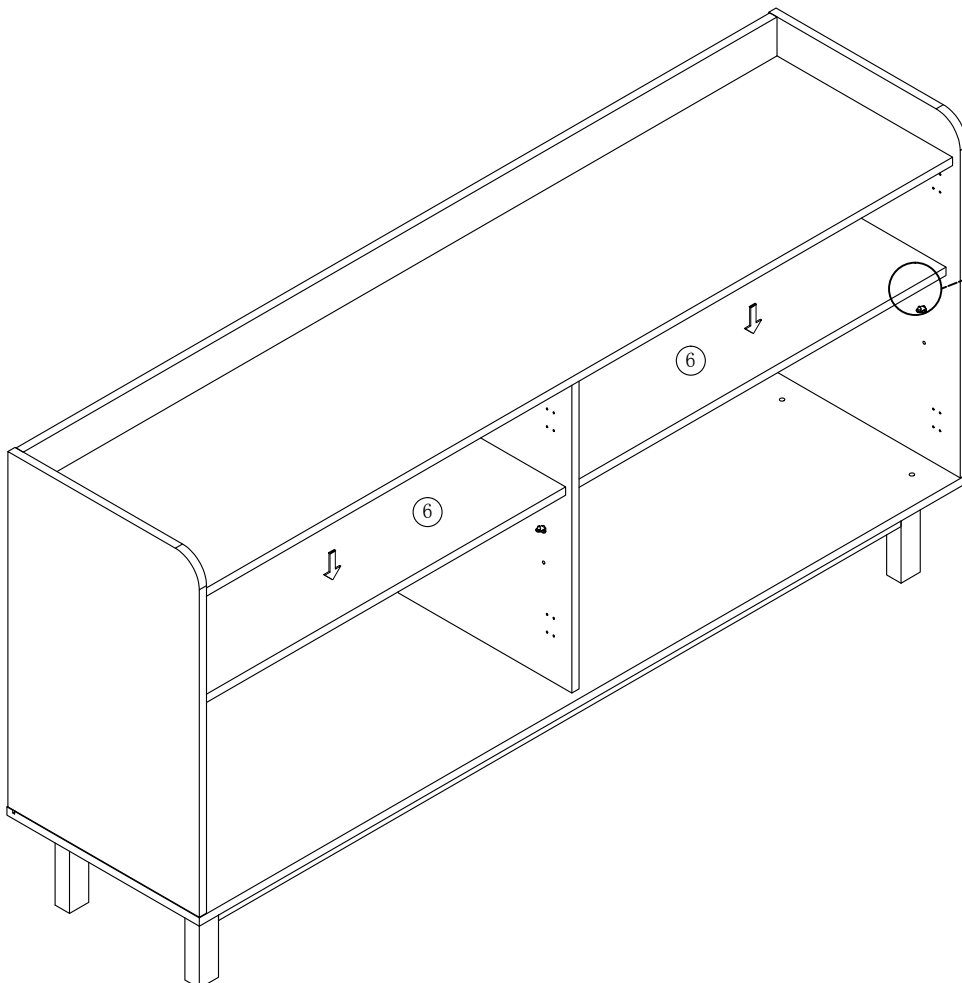

⑥ X2pcs

# ASSEMBLY INSTRUCTION

STEP 29

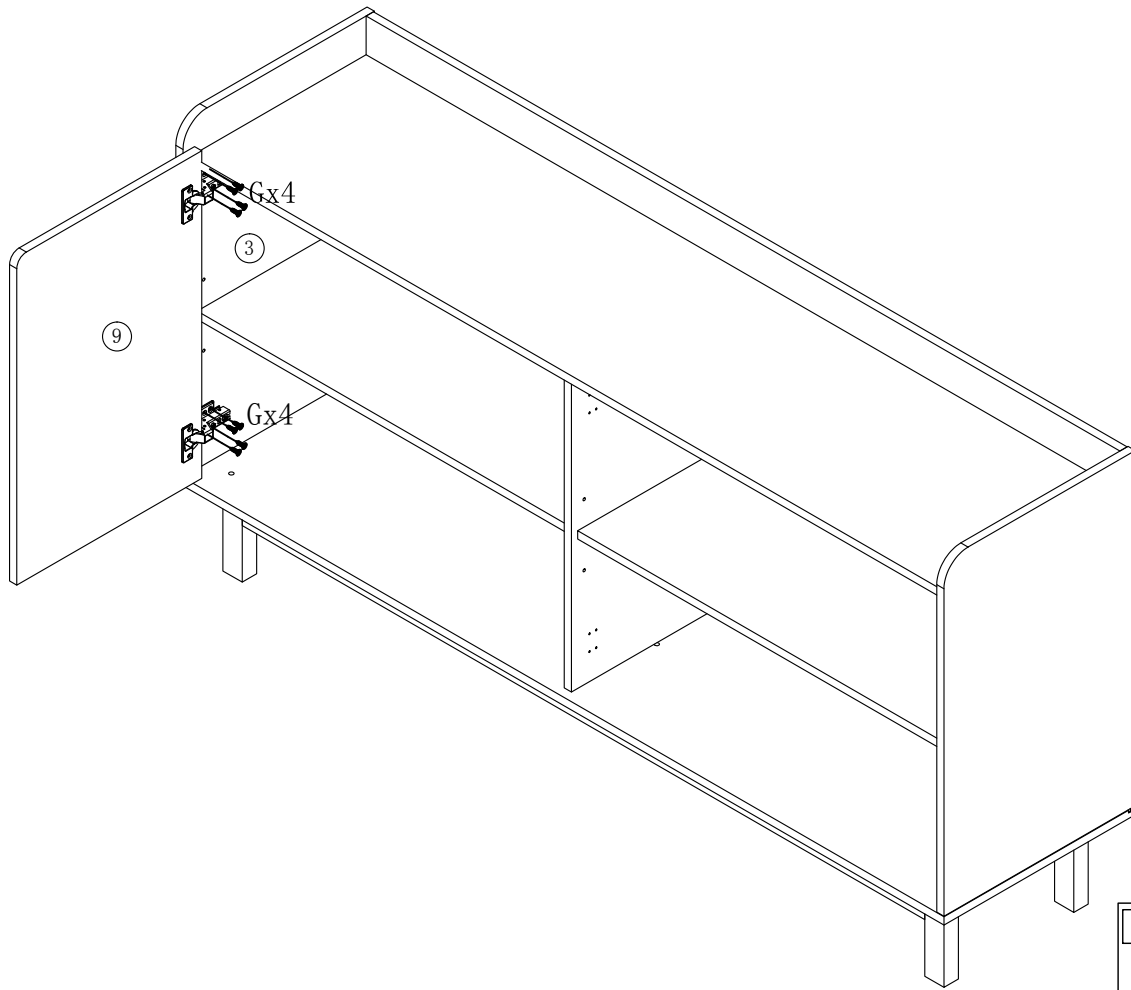

9 X1pc

G ST3.5\*14



X8

STEP 30

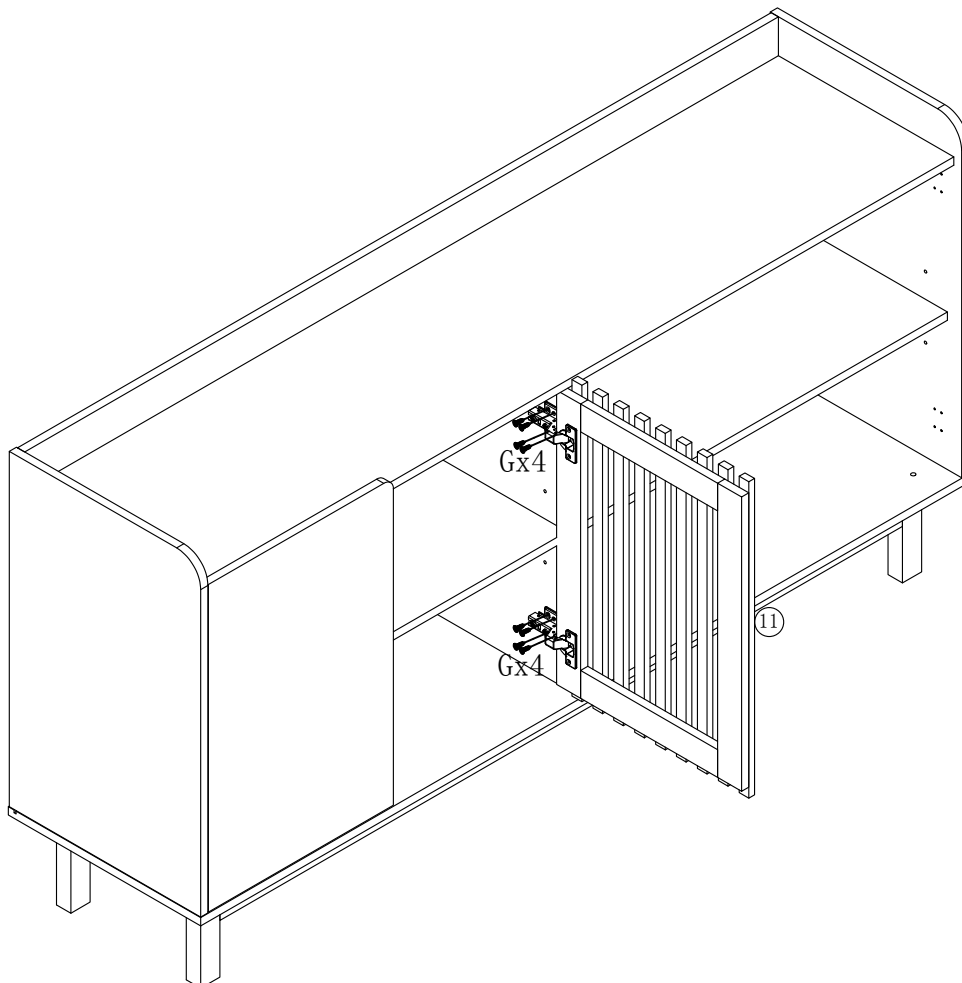

11 X1pc

G ST3.5\*14



X8

# ASSEMBLY INSTRUCTION

STEP 31

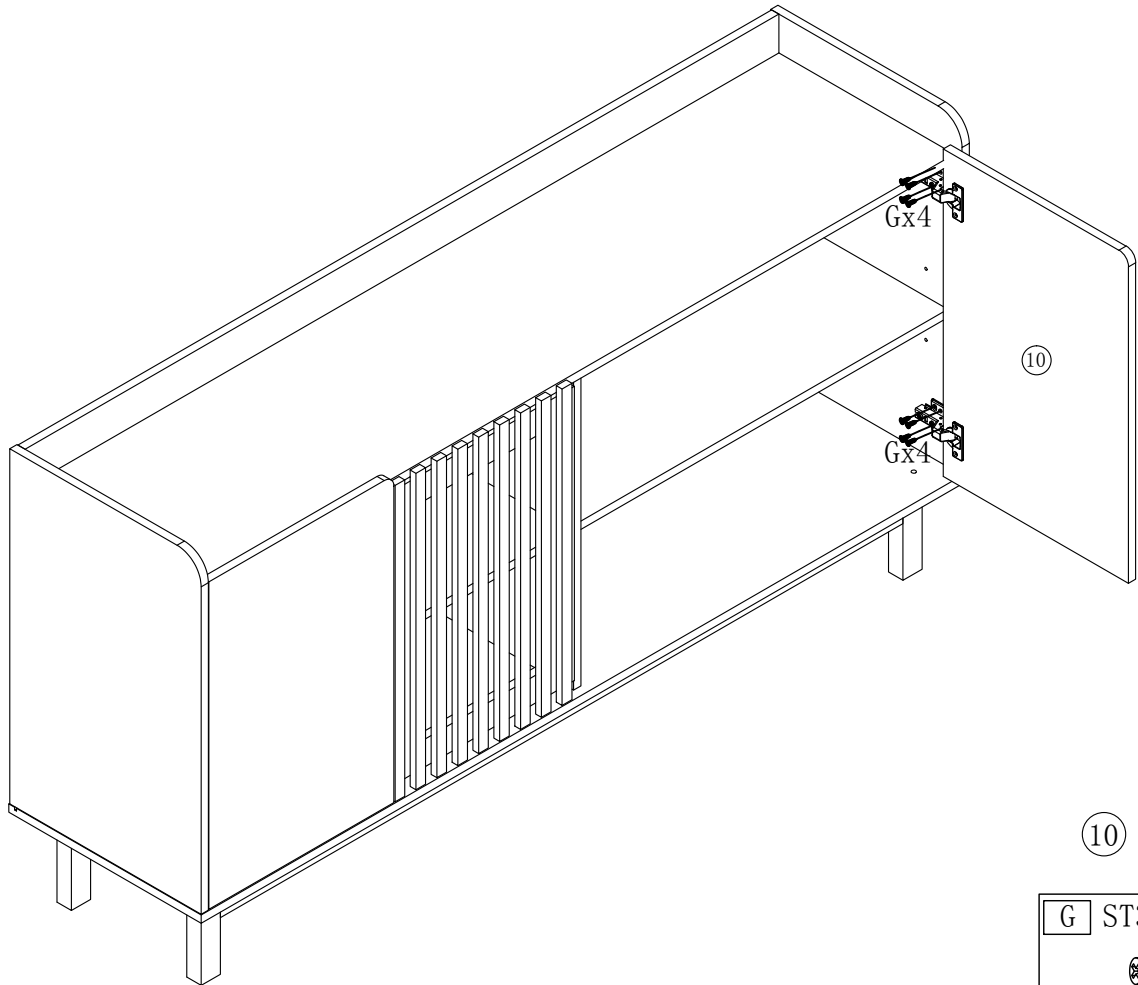

⑩ X1pc

G ST3.5\*14



X8

STEP 32

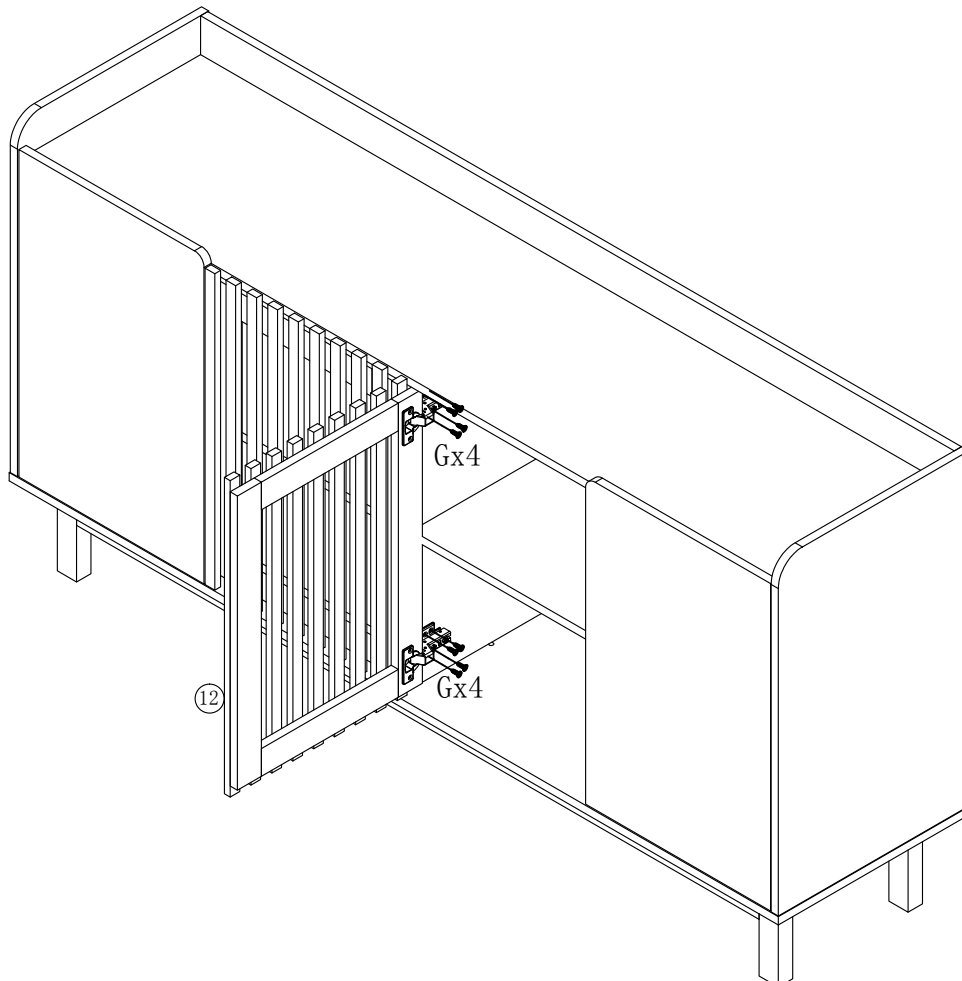

⑫ X1pc

G ST3.5\*14



X8

# ASSEMBLY INSTRUCTION

STEP 33

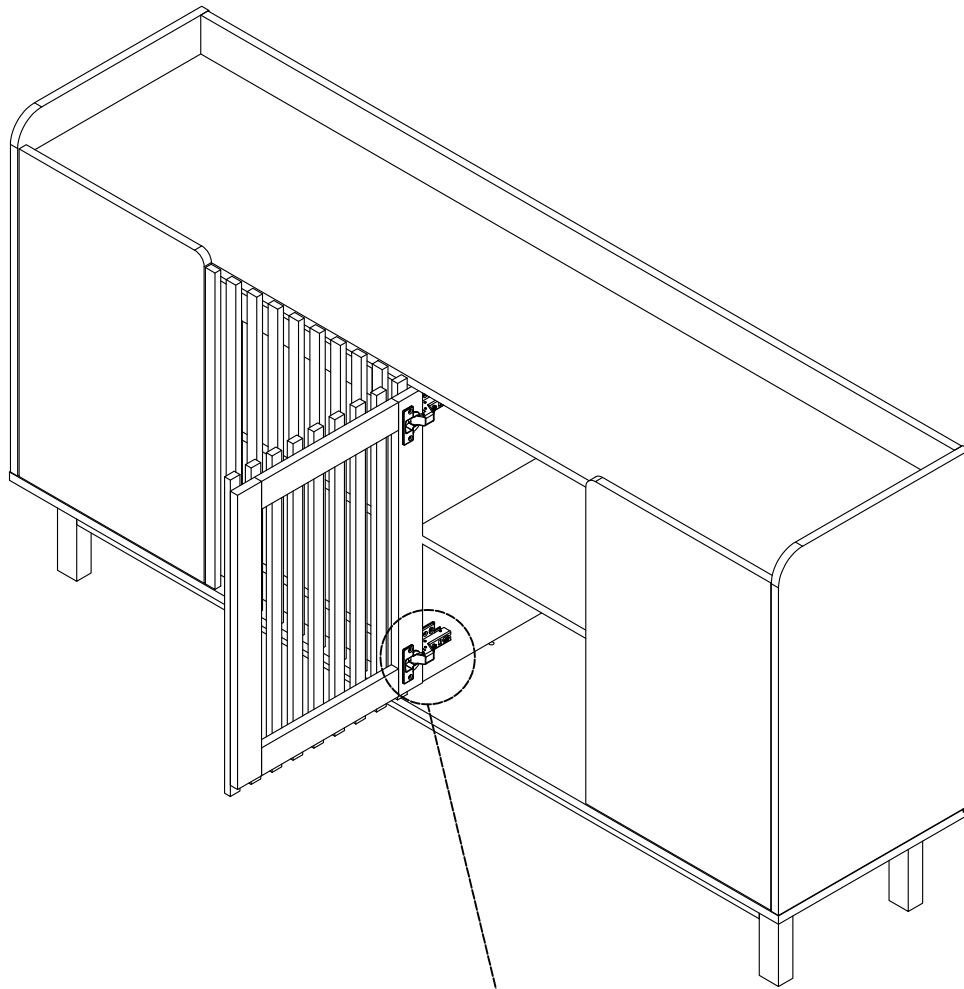

2. Adjust this screw to make the door forward or backward

3. Adjust this screw to make the door go up or down

Note: After the door pane is installed, if the gap of the door is too large or too small, you can adjust this screw to adjust the gap of the door.

1. Adjust this screw to make the door turn left or right

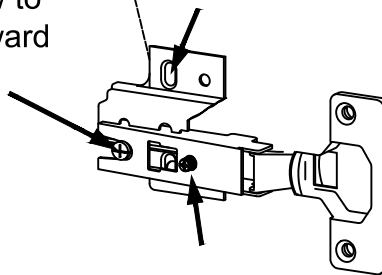

# ASSEMBLY INSTRUCTION

STEP 34

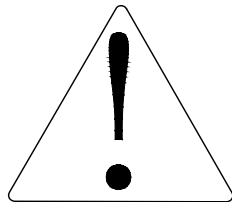
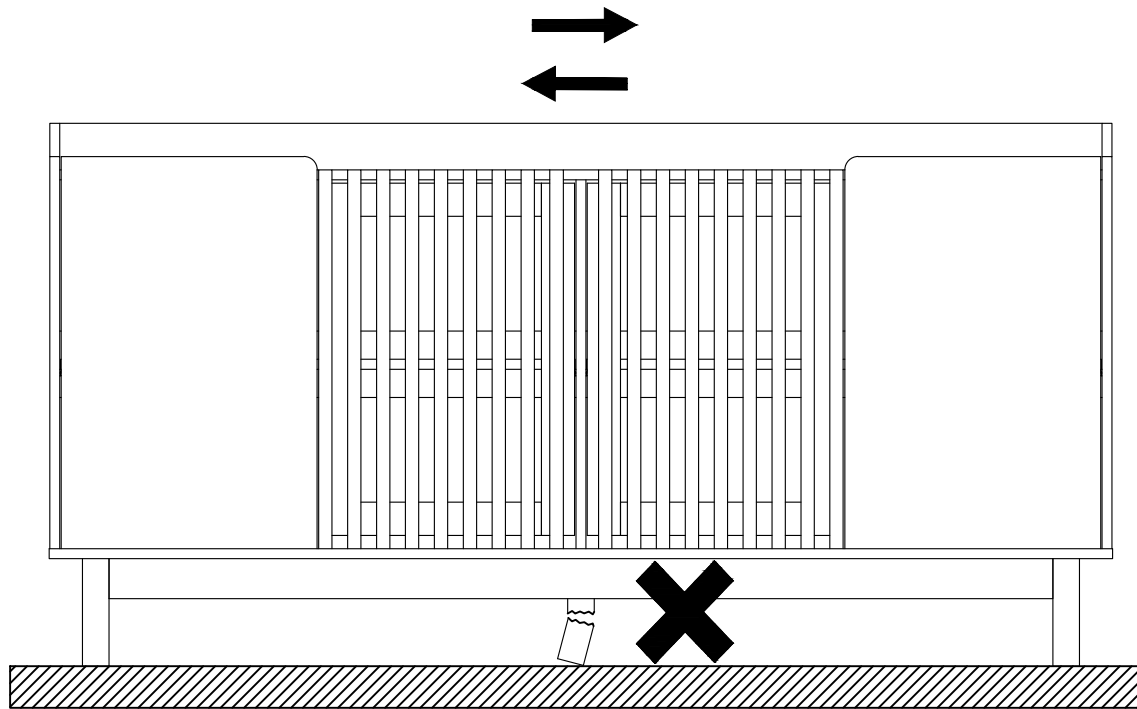

Attention: After installation, if you want to move the product, two people need to lift the entire product. Do not drag the product on the ground, as the middle table leg under the product may break easily.

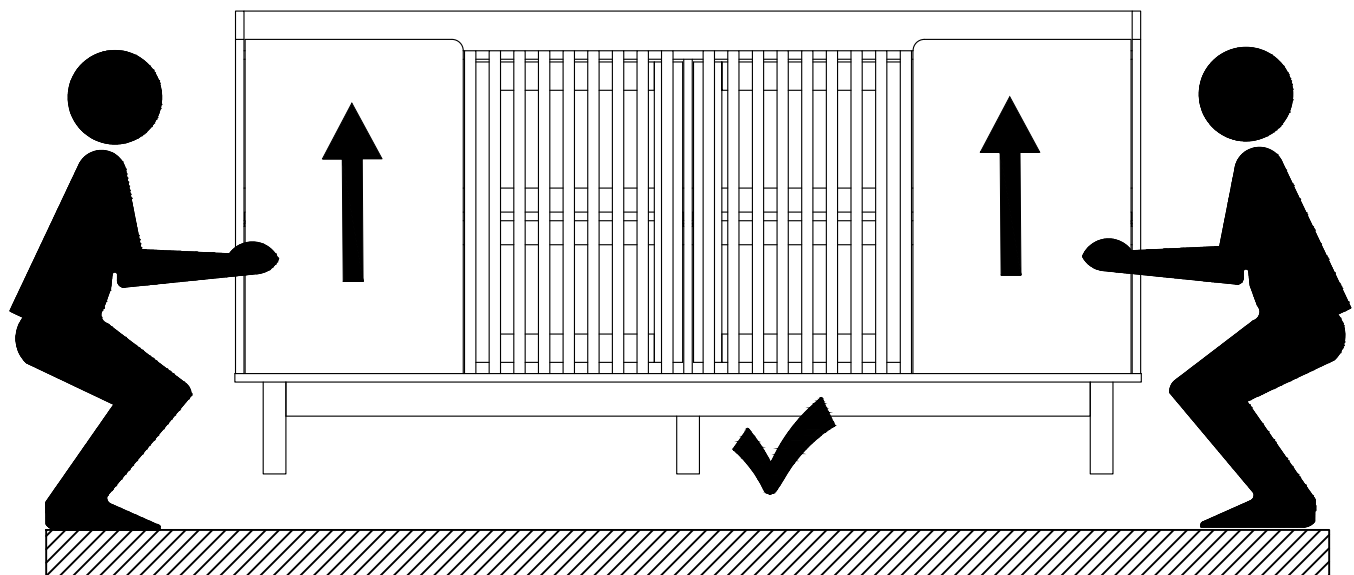

# ASSEMBLY INSTRUCTION

STEP 35

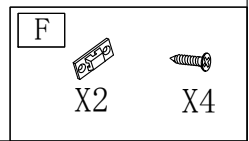
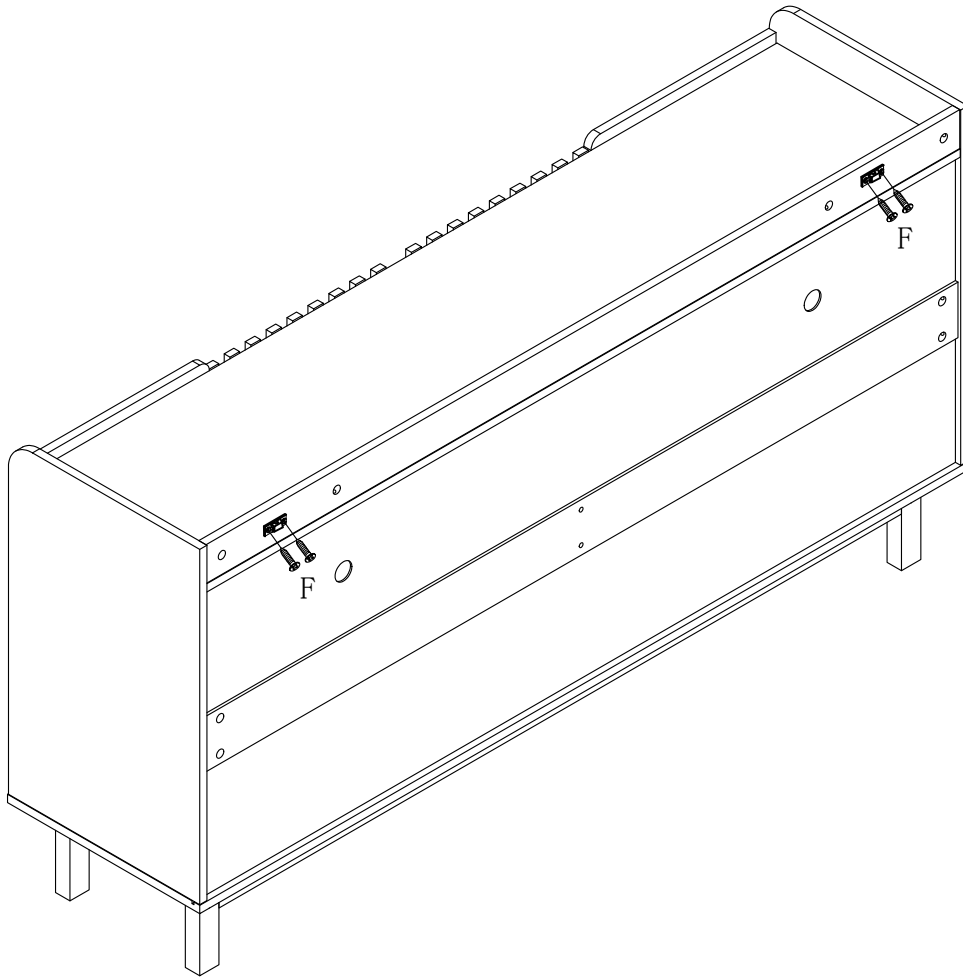

STEP 36

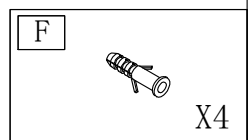
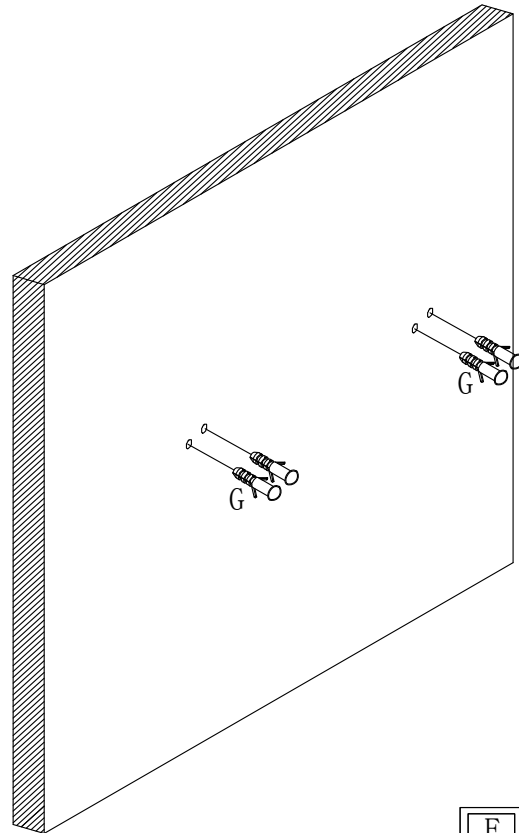
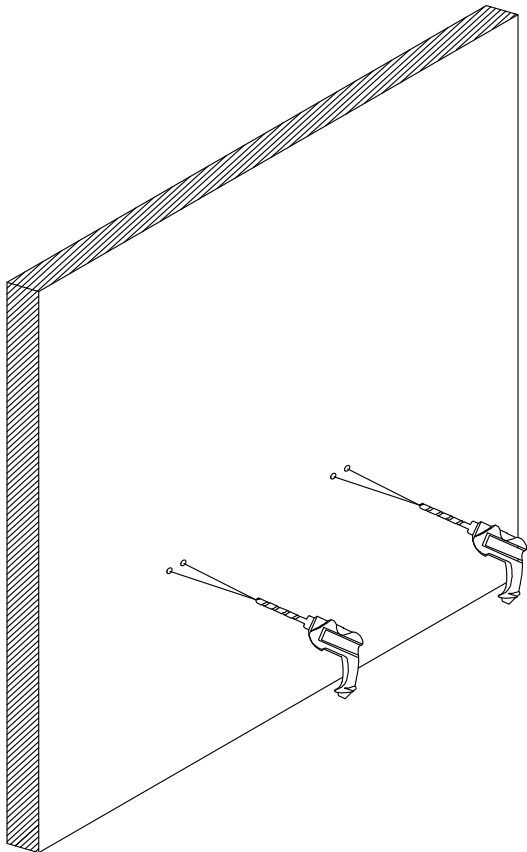

# ASSEMBLY INSTRUCTION

STEP 37

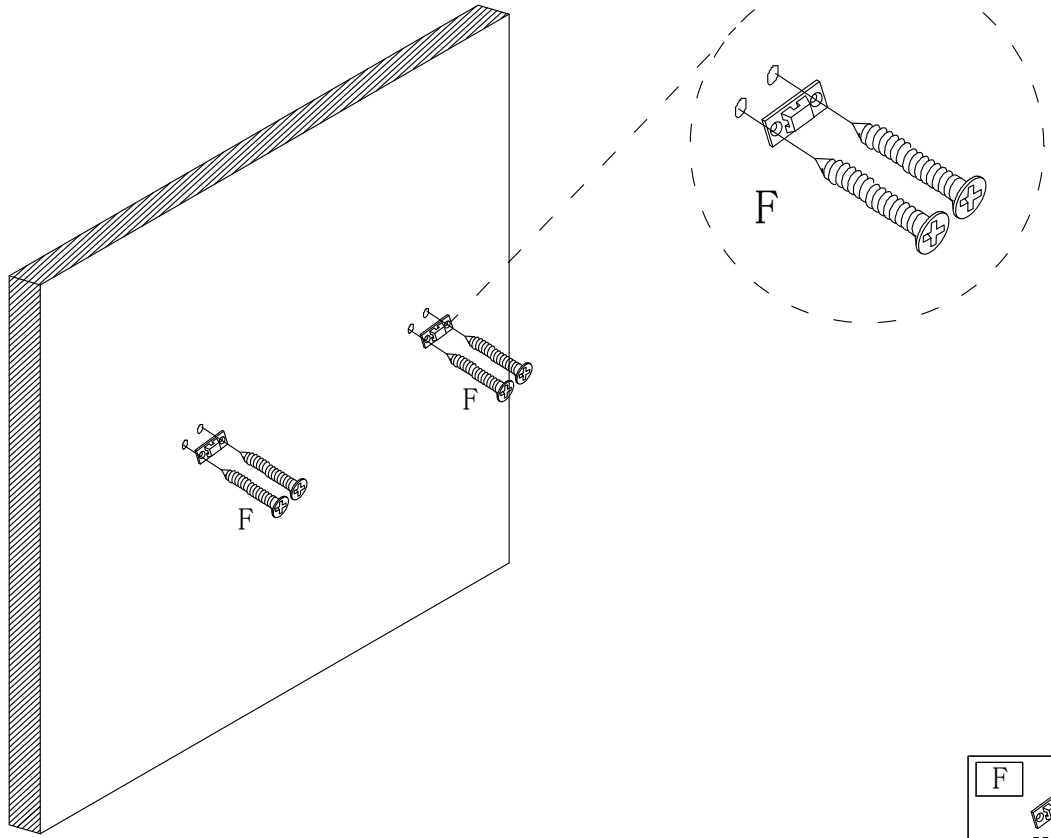

STEP 38

