

Read this instruction carefully. See hardware and furniture part list for guidance. Be sure all parts are complete, before you assemble. Place all wooden furniture parts on a clean and flat soft surface to prevent from being scratched. Follow the figure to start assembling.

- CAUTIONS :**
1. Do not FULLY - TIGHTEN the nut or nut bolt until all nut or bolt is ready assembled.
 2. Do not OVER - TIGHTEN the nut or bolt to avoid causing damages to the thread.
 3. Keep all hardware parts out of reach of children.

NOTE : THE LIST AND QUANTITY SHOWN ARE FOR 1 UNIT ASSEMBLY.

Tool needed : Screwdriver (not provided).

PART LIST		
ITEM	DESCRIPTION	QTY
A	HEADBOARD	1 PC
B	FOOTBOARD	1 PC
C	BED LEG	4 PCS
D	SIDE RAIL	2 PCS
E	CENTER RAIL	1 PC
F	CENTER SUPPORT LEG	3 PCS
G	BED SLAT	13 PCS

HARDWARE LIST		
ITEM	DESCRIPTION	QTY
1	JCBC BOLT M6 x 30mm	8 PCS
2	M6 SPRING WASHER	8 PCS
3	M6 FLAT WASHER	8 PCS
4	WOOD SCREW M4 x20mm	2 PCS
5	WOOD SCREW M4 x38mm	9 PCS
6	M4 ALLEN KEY (BALL SHAPE)	1 PC
7	M5 ALLEN KEY (BALL SHAPE)	1 PC

STEP 1

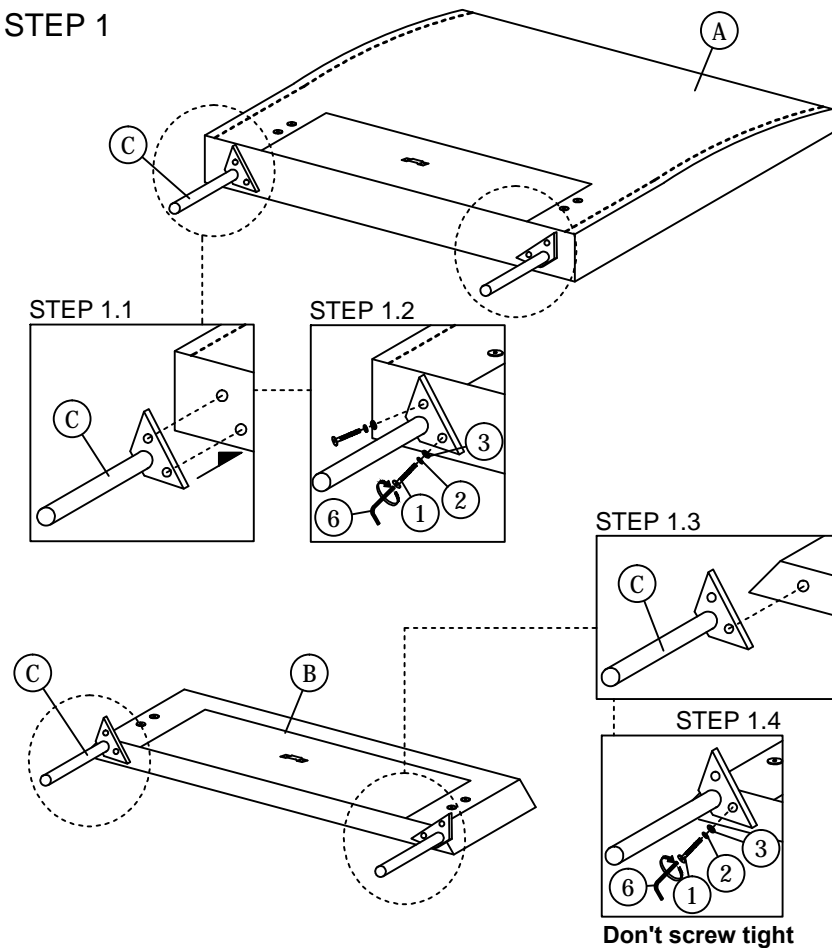

STEP 2

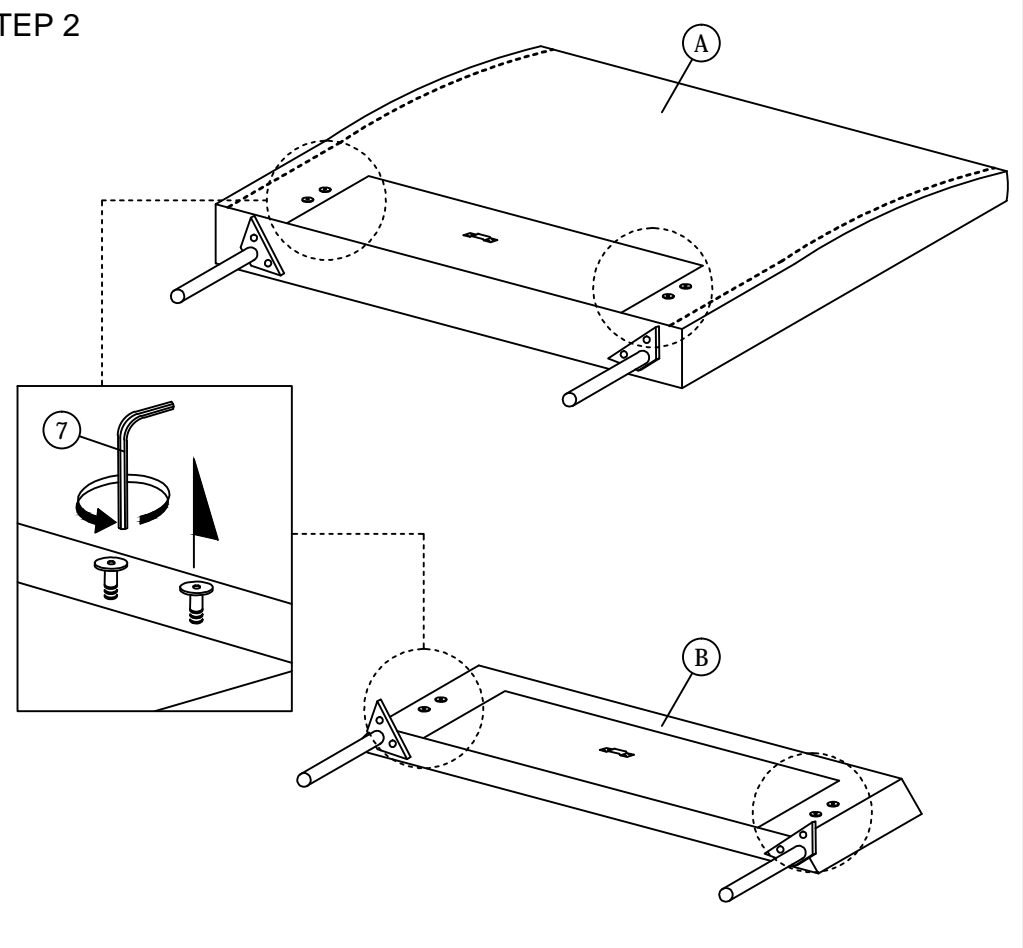

ASSEMBLY INSTRUCTIONS

STEP 3 Note: Finish Step 3.1 & Step 3.2, you need to lift the footboard and then tight the screws follow the picture Step 3.3.

STEP 3.2

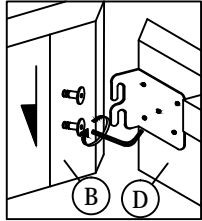

STEP 3.1

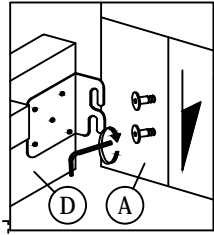

STEP 3.3

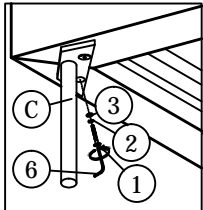

**** Finish step 3.3.
Please screw tight
the step 1.4 bolt.**

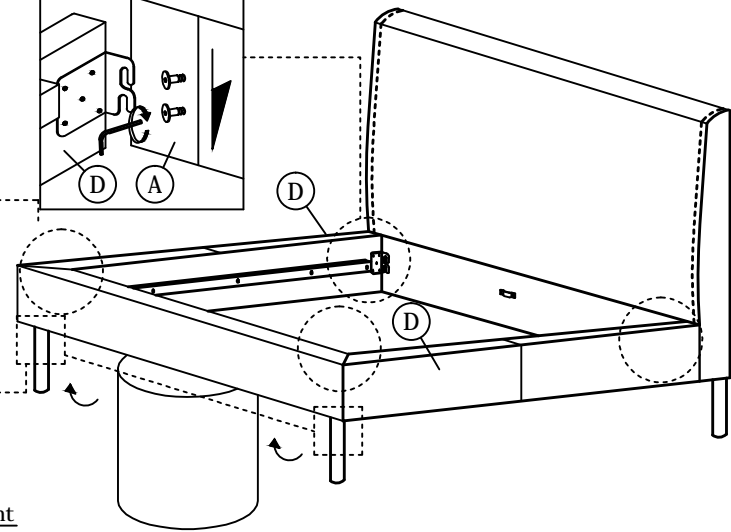

STEP 4

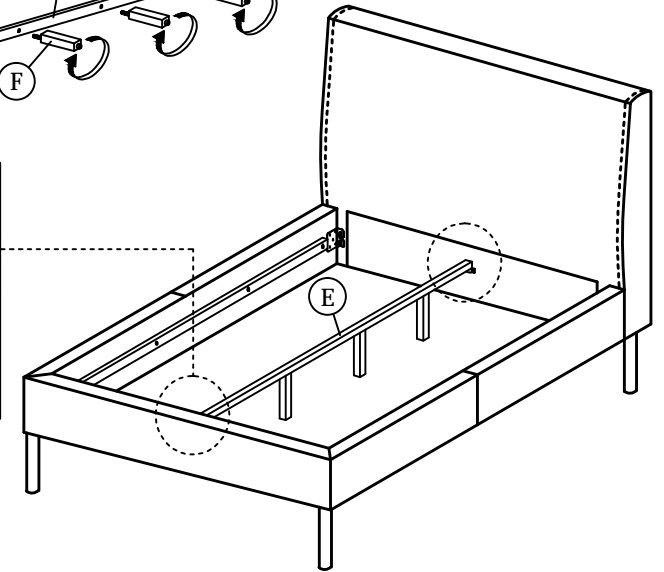
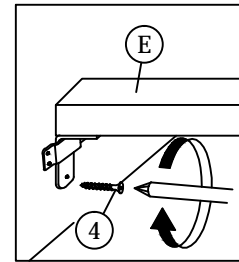
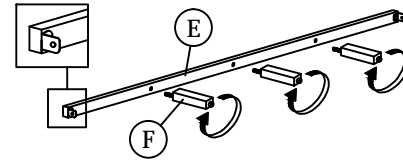

STEP 5

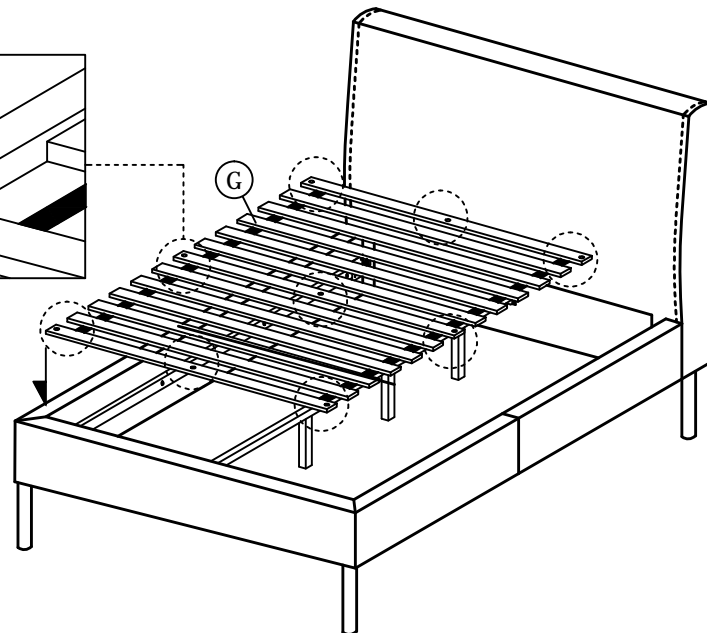
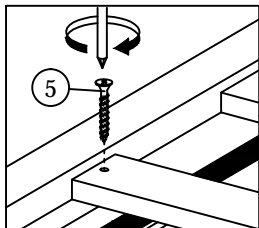

STEP 6

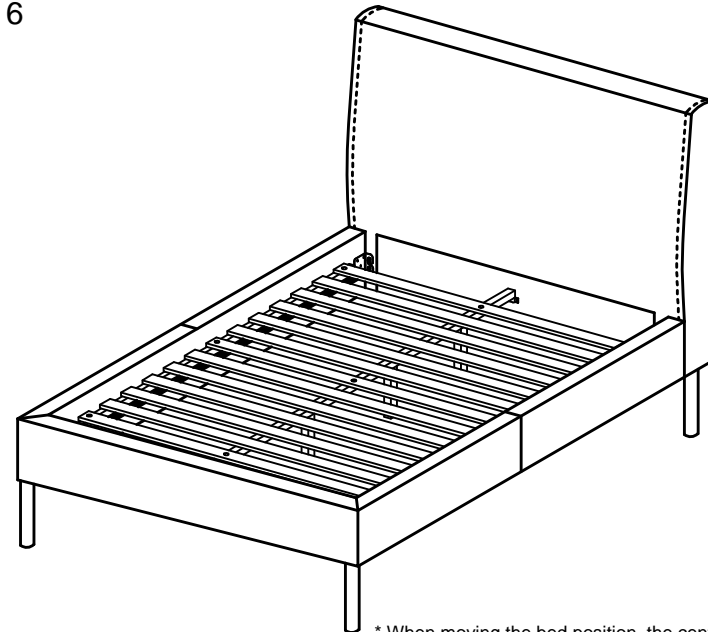

*** When moving the bed position, the center support legs
must be adjust to be straight to avoid any broken problem.**