

Assembly Instructions

Instructions de montage

6 Drawer Dresser

Commode à six tiroirs



CONTACT US FIRST

- If you have received a damaged or defective part
- If you are missing hardware or parts
- For help with assembly



Replacement parts will leave our facility within two business days via UPS ground or mail. Please note: shipping times will vary depending on location.

Before you call please:

- 1) Record the following information from the shipping label on the outside of the box. You will need it for warranty purposes:
 - Ship To Name
 - Sales Order Number
- 2) Note the product model number.
- 3) Review the contents of your shipment to determine what you are missing.

Option de service en ligne

Complétez le formulaire *Commande de Pièces de Rechange* disponible dans la section *Soutien à la clientèle* de notre site web.

- Si vous avez reçu une pièce endommagée ou défectueuse
- Si vous manquez la quincaillerie ou les pièces

Les pièces de rechange quitteront notre installation dans deux jours ouvrables via UPS par terre ou le courrier. Notez s'il vous plaît que les temps d'expédition varieront selon l'emplacement.

Pour parler avec quelqu'un en français, s'il vous plaît contacter votre détaillant.

Required Tools / Outils requis



Optional Tools:
Using a power screwdriver will speed up assembly.

Outils facultatifs
Utilisant la puissance un tournevis accélérera l'assemblée.

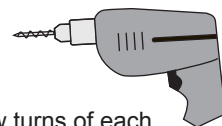

Caution

Do not over tighten any screw. The last few turns of each screw should be done very slowly or by hand.

Attention

Évitez de trop serrer les vis. Ralentissez la vitesse de la foreuse pour les derniers deux tours de vis ou vissez-les lentement à la main.

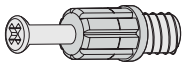

24mm Green
Twister Dowel (18)
Goujon de torsion vert
RM-0501

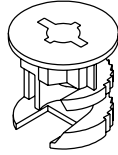

15mm Zinc Cam
(large) (18)
Ferrure en zinc grand
RM-0103

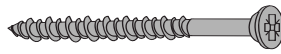

#8 - 1½" Screws (24)
Vis no.8 - 1½ po.
RM-0504



Euro Screw (96)
Vis "Euro"
RM-0074

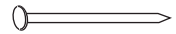

¾" Nail (28)
Clou ¾"
RM-0022

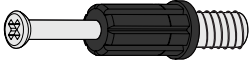

34mm Black
Twister Dowel (24)
Goujon de torsion noir
RM-0500

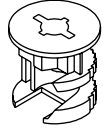

12mm Zinc Cam
(small) (30)
*Ferrure en zinc
12mm (petit)*
RM-0502



Double Ended
Connecting Rod (3)
Vis d'assemblage double
RM-0567

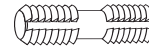

Plastic Dowel (6)
Goujon en plastique
RM-0072



Wood Dowel (6)
Goujons de bois
RM-0069

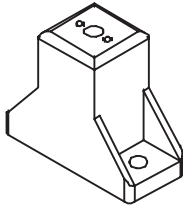

1" Gray Spacers (12)
Entretoise gris 1 po.
RM-0828-G

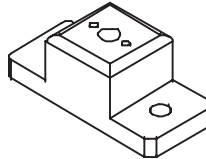

½" Gray Spacers (12)
Entretoise gris ½ po.
RM-0829-G

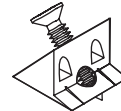

Drawer Bottom Stabilizer (12)
Stabilisateur inférieur de tiroir
RM-0839

You will have a different style of knob or handle depending on the product finish
Vous aurez un style différent du bouton ou de la poignée en fonction de la finition de produit

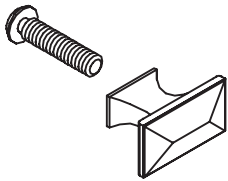

Chrome Square Knob & screws (12)
poignée de chrome carée avec les vis
For White finish
Pour fini blanc
RM-0843

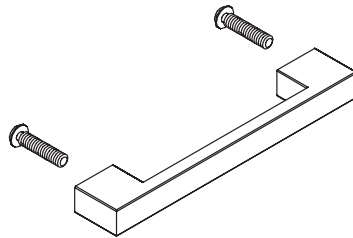

Brushed Nickel Handle & screws (6)
poignée en nickel satiné avec les vis
For Washed Ebony finish
Pour fini ébène délavé
RM-0844

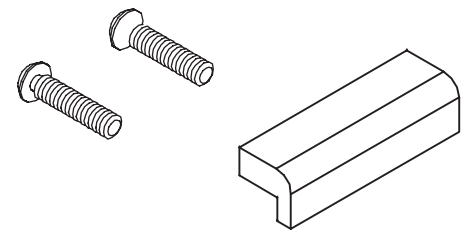

Chrome Handle & screws (6)
poignée de chrome avec les vis
For Black, Espresso, Cherry finish
Pour fini noir, espresso, cerisier
RM-0824

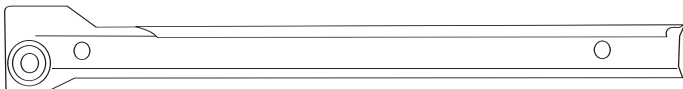

1 LEFT Gray Cabinet Slide per Drawer (Total = 6)
1 Glissière gris GAUCHE De Cabinet (total = 6)
RM-0469-G

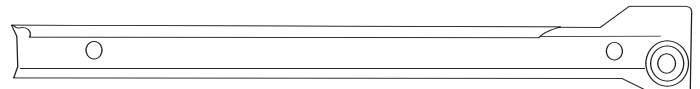

1 RIGHT Gray Cabinet Slide per Drawer (Total = 6)
1 Glissière gris DROITE De Cabinet (total = 6)
RM-0469-G

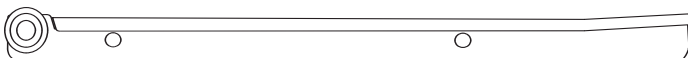

1 LEFT Gray Drawer Slide per Drawer (Total = 6)
1 Glissière gris GAUCHE de tiroir (total = 6)
RM-0469-G

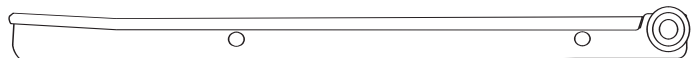

1 RIGHT Gray Drawer Slide per Drawer (Total = 6)
1 Glissière gris DROITE de tiroir (total = 6)
RM-0469-G

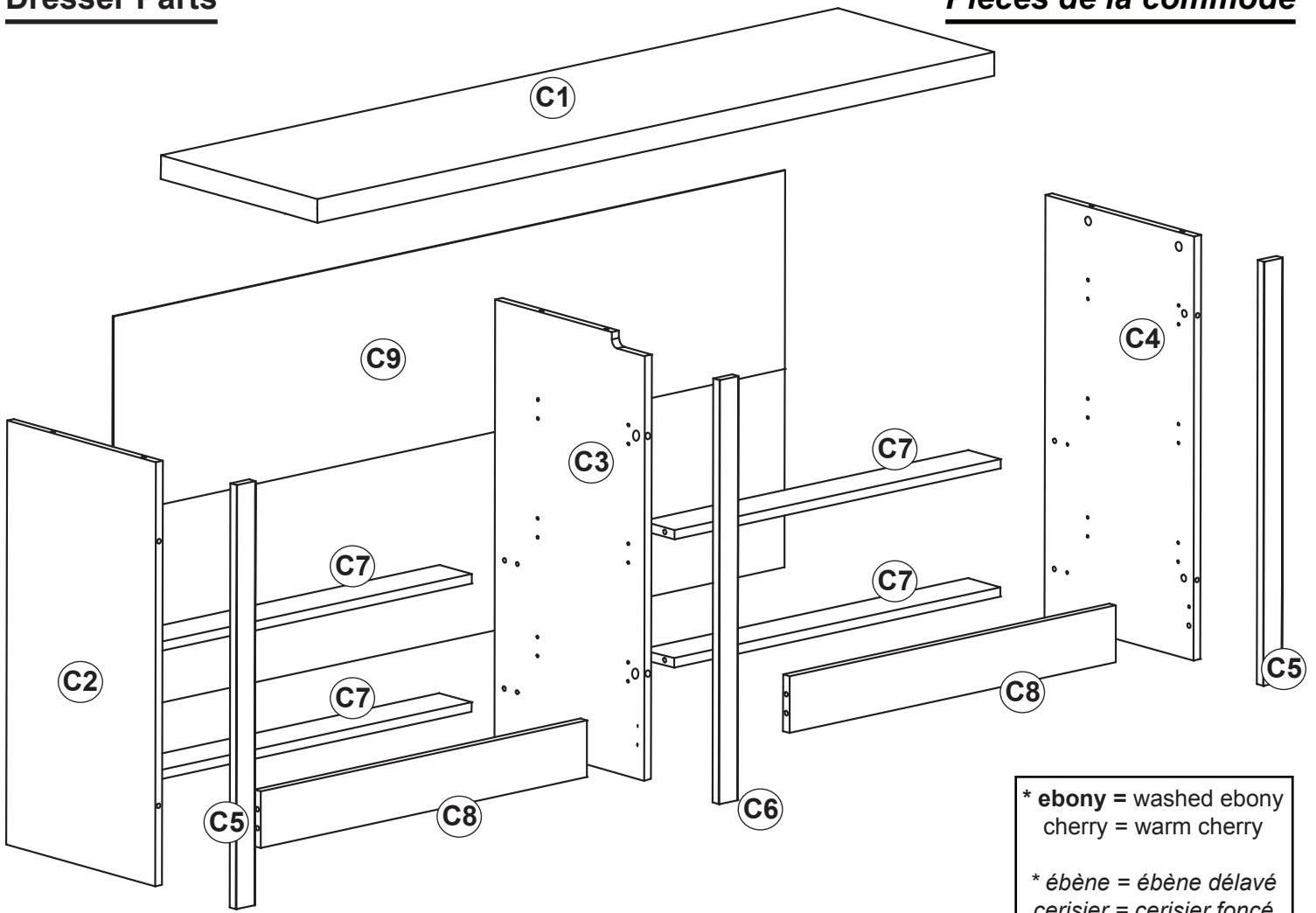

C1

Top (1)
Dessus
black / noir
espresso
cherry / *cerisier*
ebony / *ébène**
white / blanc

C2

Left Side (1)
Côté gauche
black / noir
espresso
cherry / *cerisier*
ebony / *ébène**
white / blanc

C3

Center
Gable (1)
Pignon central

C4

Right Side (1)
Côté droit
black / noir
espresso
cherry / *cerisier*
ebony / *ébène**
white / blanc

C5

Side Moulding (2)
Moulure latérale
black / noir
espresso
cherry / *cerisier*
ebony / *ébène**
white / blanc

C6

Center Moulding (1)
Moulure centrale
black / noir
espresso
cherry / *cerisier*
ebony / *ébène**
white / blanc

C7

Rear
Stabilizer (4)
Renforcement arriere

C8

Front Stabilizer (2)
Renforcement avant
black / noir
espresso
cherry / *cerisier*
ebony / *ébène**
white / blanc

C9

Backer (1)
Dos

* **ebony** = washed ebony
cherry = warm cherry

* **ébène** = *ébène délavé*
cerisier = *cerisier foncé*

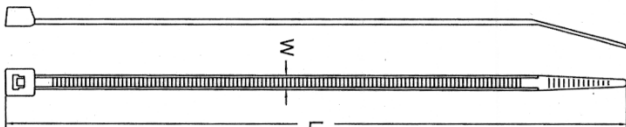

Cable Tie / *Attache pour cable* (1)
RM-0459



Mounting Base / *Base de support* (2)
RM-0458



#6 - 3/4 Pan Head Screw / *Vis #6-3/4 po.* (1)
RM-0460

Step 1 Estimated Time: 10 Minutes

1a Screw green twister dowels into the side (C5) and center (C6) moldings where shown

Vissez les goujons de torison vert aux moulures latéral (C5) et central (C6) comme montre

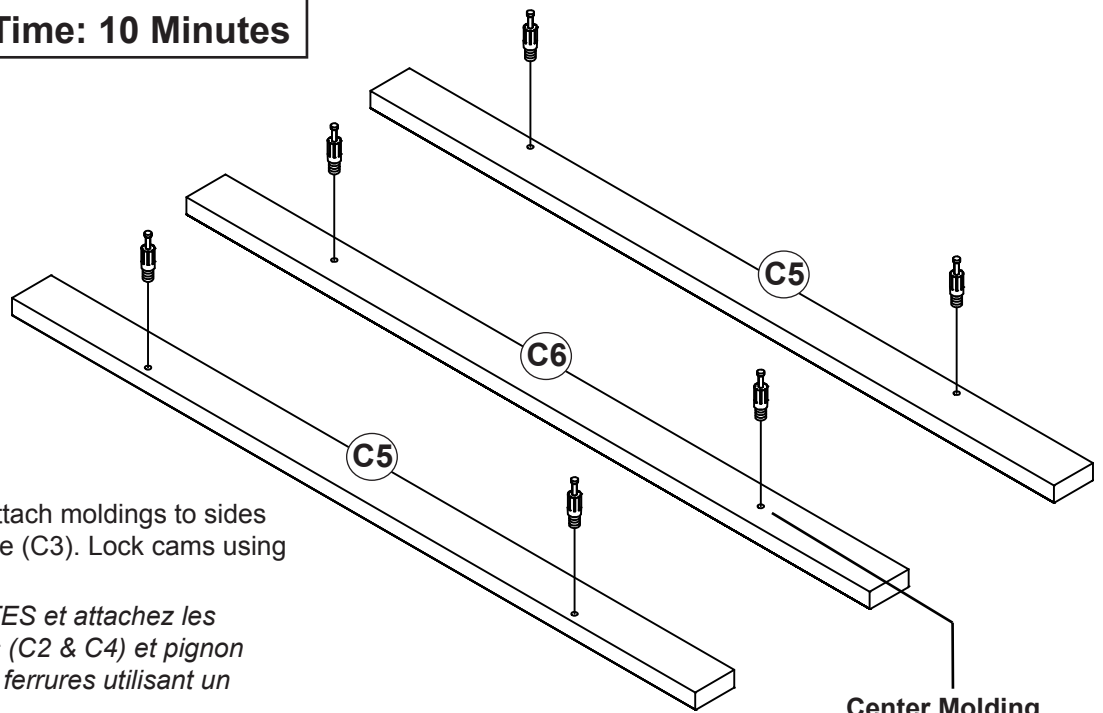

1b Insert SMALL cams and attach moldings to sides (C2 & C4) and center gable (C3). Lock cams using a flat head screwdriver.

Insérez les ferrures PETITES et attachez les moulures latéral aux côtés (C2 & C4) et pignon centrale (C3) et serrez les ferrures utilisant un tournevis principal plat

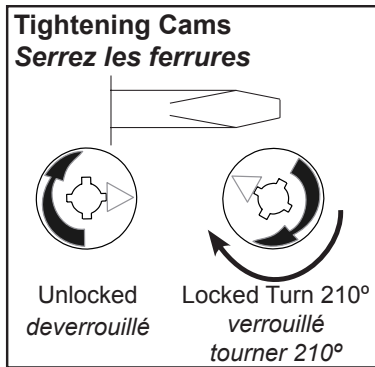

Center Molding
dowel is in center
Moulure centrale
le doigt est au centre

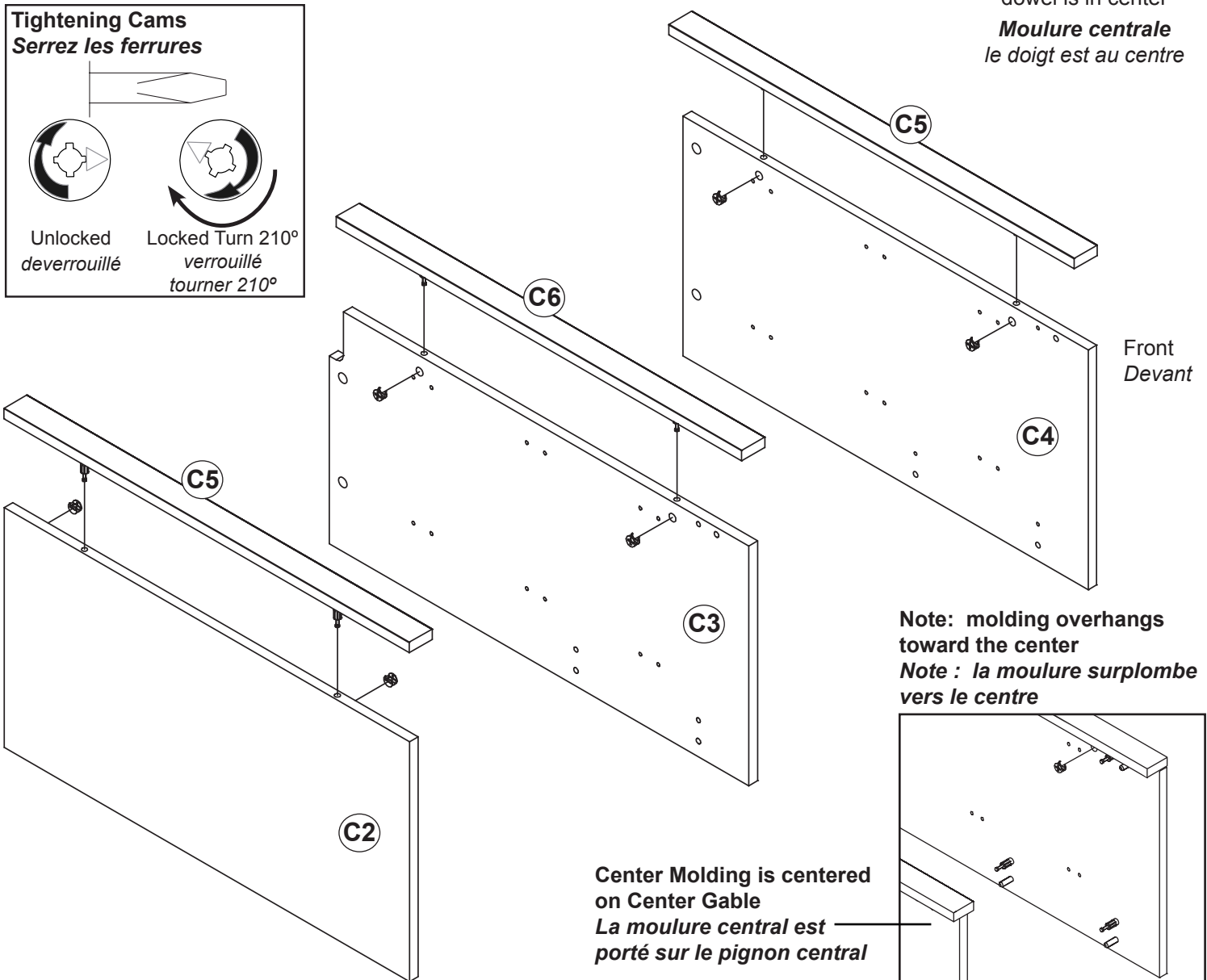

Note: molding overhangs toward the center
Note : la moulure surplombe vers le centre

Center Molding is centered on Center Gable
La moulure centrale est portée sur le pignon central

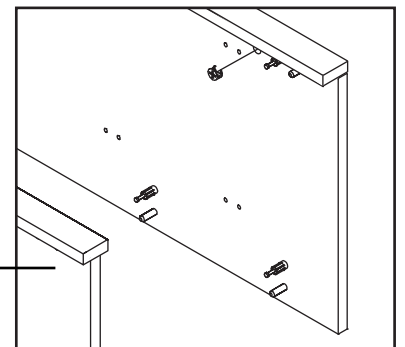

Step 2 Estimated Time: 20 Minutes

2a For the Left (C2) and Right (C4) Sides Pour les côtés gauche (C2) et droit (C4)

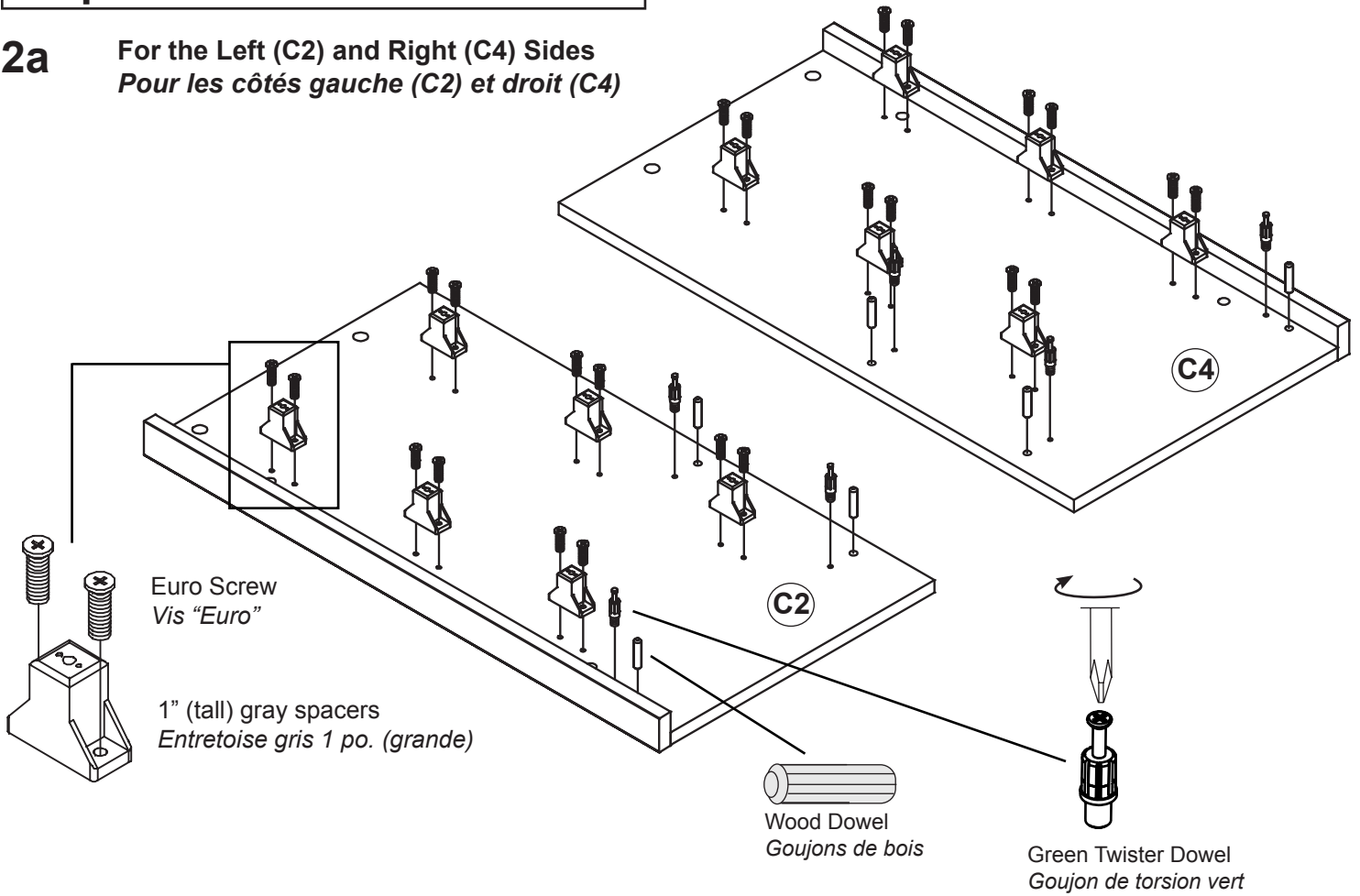

2b For the Center Gable (C3) Pour le pignon central (C3)

Attach 1/2" (short) gray spacers to BOTH sides of the unfinished center gable (C3) with Euro Screws
Attachez les entretoises gris 1/2 po. (petite) AUX DEUX côtés du pignon de centre non-fini (C3) avec des vis "Euro"

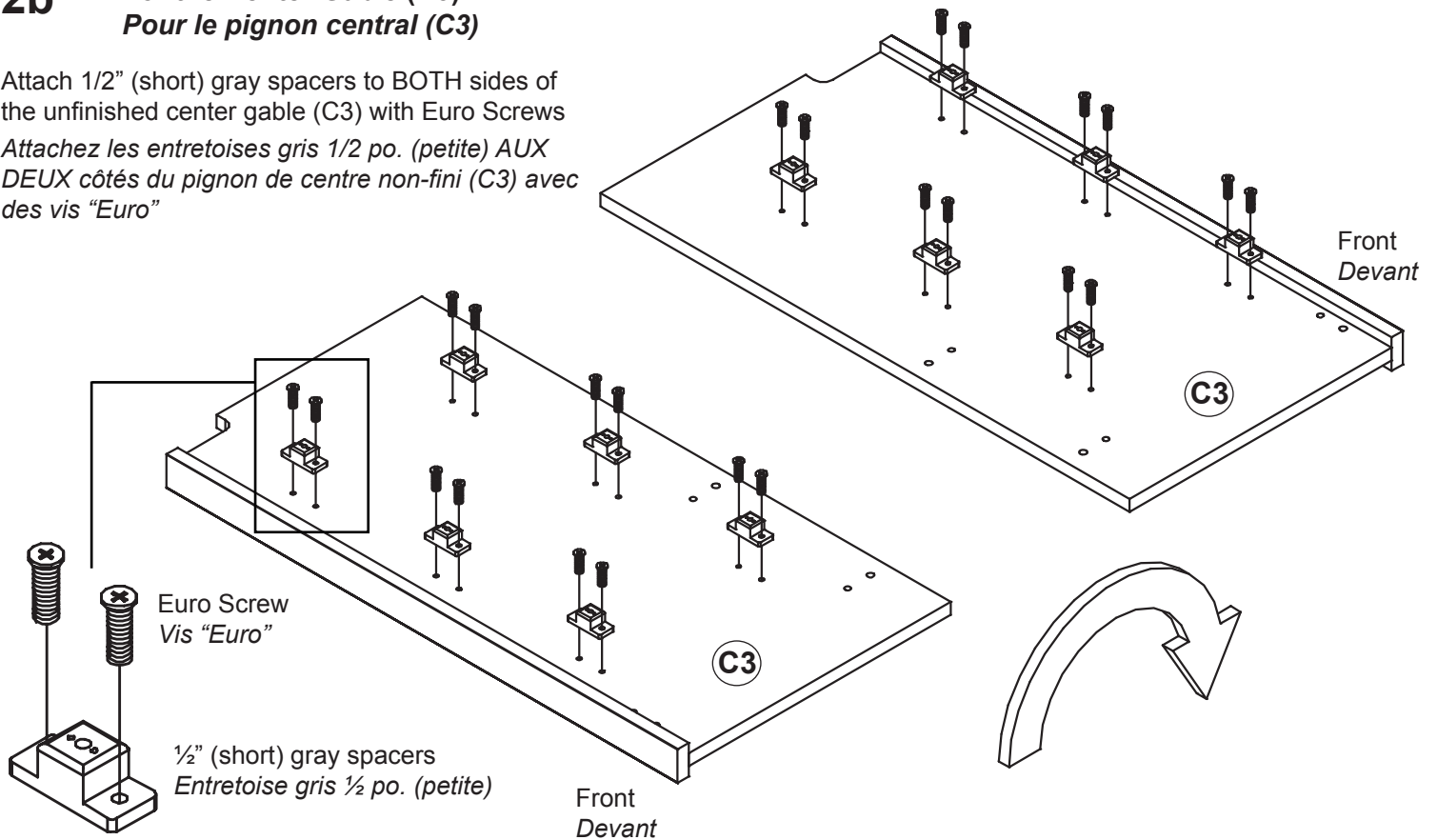

Step 3 Estimated Time: 10 Minutes

Attach metal cabinet slides to all spacers with Euro screws

Attachez les glissières de coffret en métal aux toutes les entretoises en utilisant les vis "Euro"

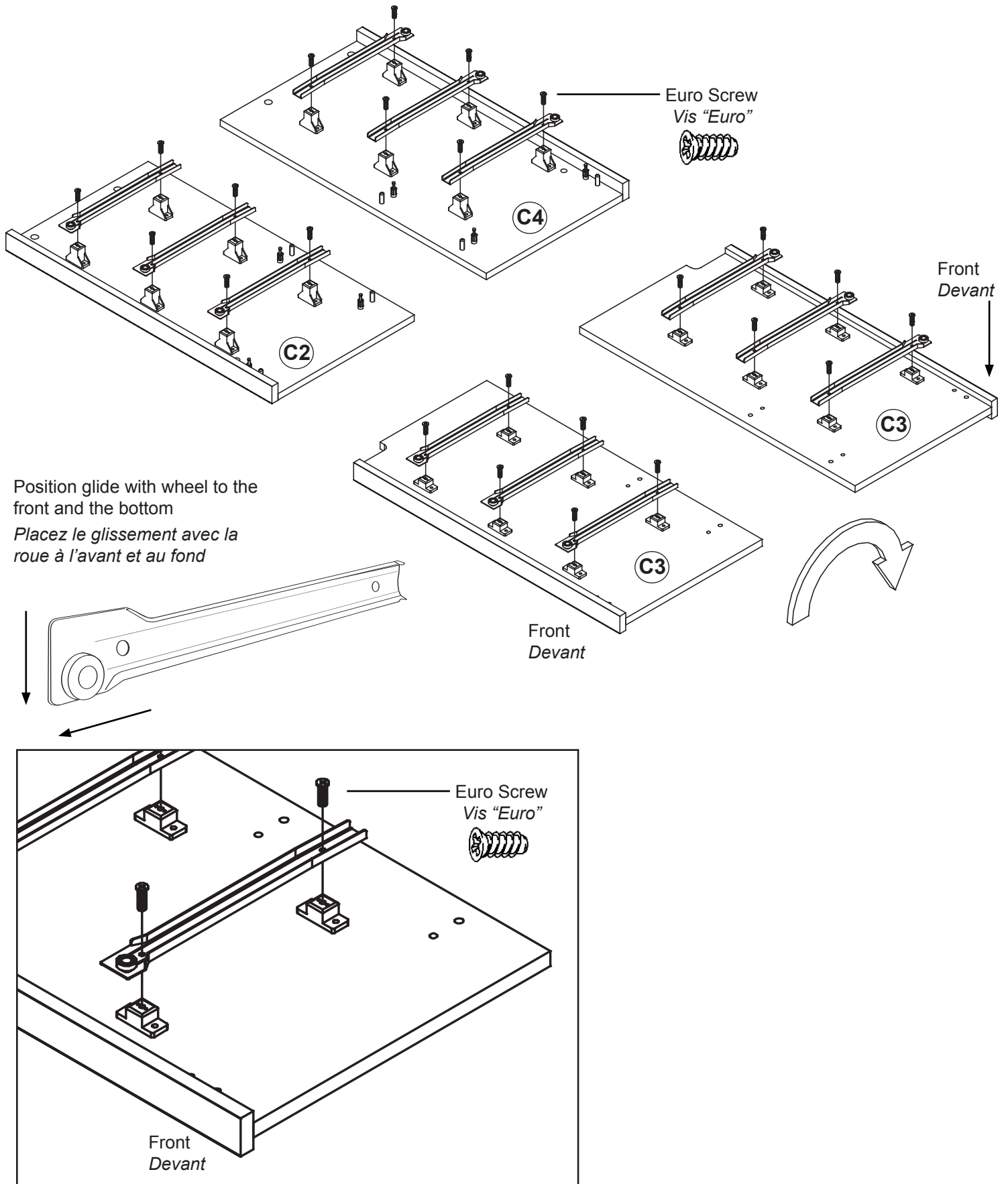

Step 4 Estimated Time: 20 Minutes

4a Insert LARGE cams into 1 front stabilizer (C8), and 2 rear stabilizers (C7), then attach to the left side (C2) and lock cams using a flat head screwdriver

Insérez les ferrures GRANDES dans 1 renforcement avant (C8) et 2 renforcements arrière (C7) puis, attachez aux côtés gauche (C2) et serrez les ferrures utilisant un tournevis principal plat

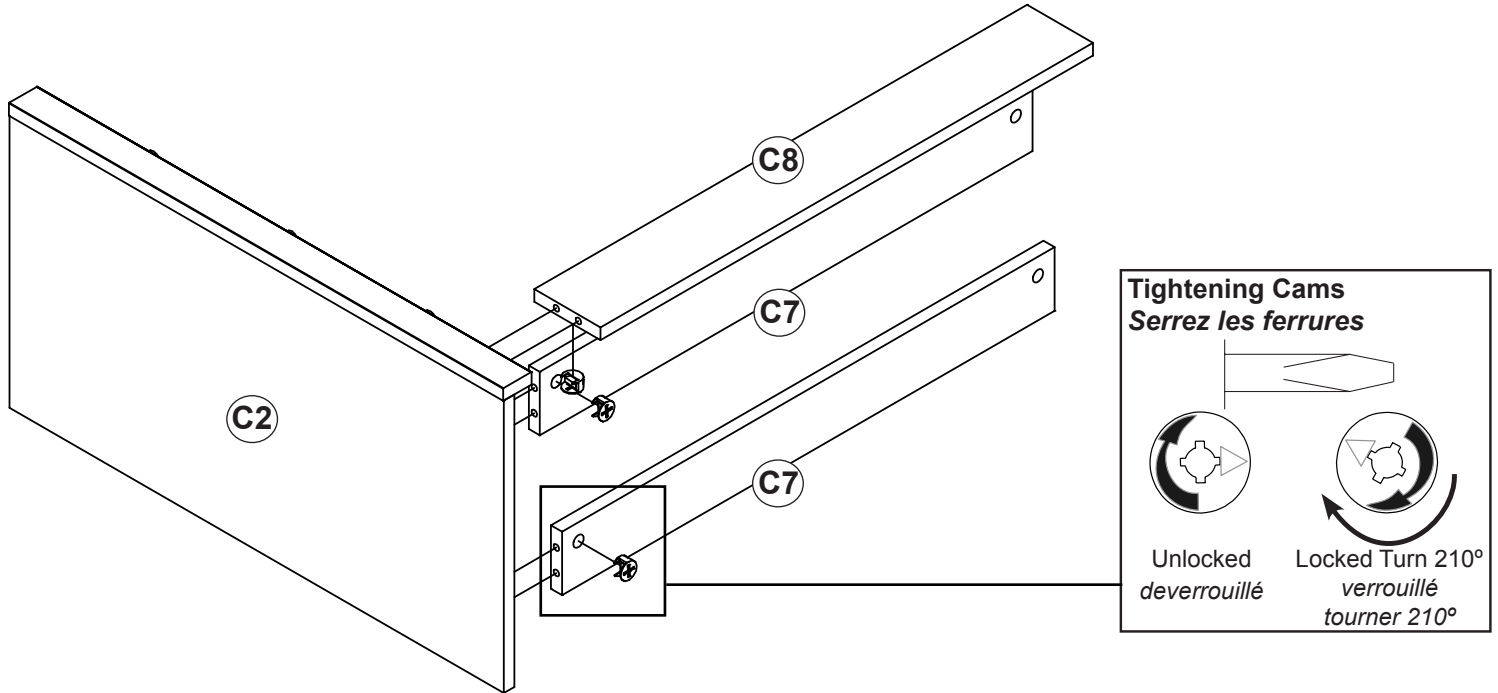

4b

Insert double ended connecting rod and black plastic dowel into the other end of the rear (C7) and front (C8) stabilizers. Then, attach to the center gable (C3).

Insérez le vis d'assemblage double et le goujon en plastique noir dans l'autre extrémité des stabilisateurs arrière (C7) et avant (C8). Puis, les attachez au pignon central (C3).

The rod will protrude through the center gable
La goujon dépassera par le pignon central

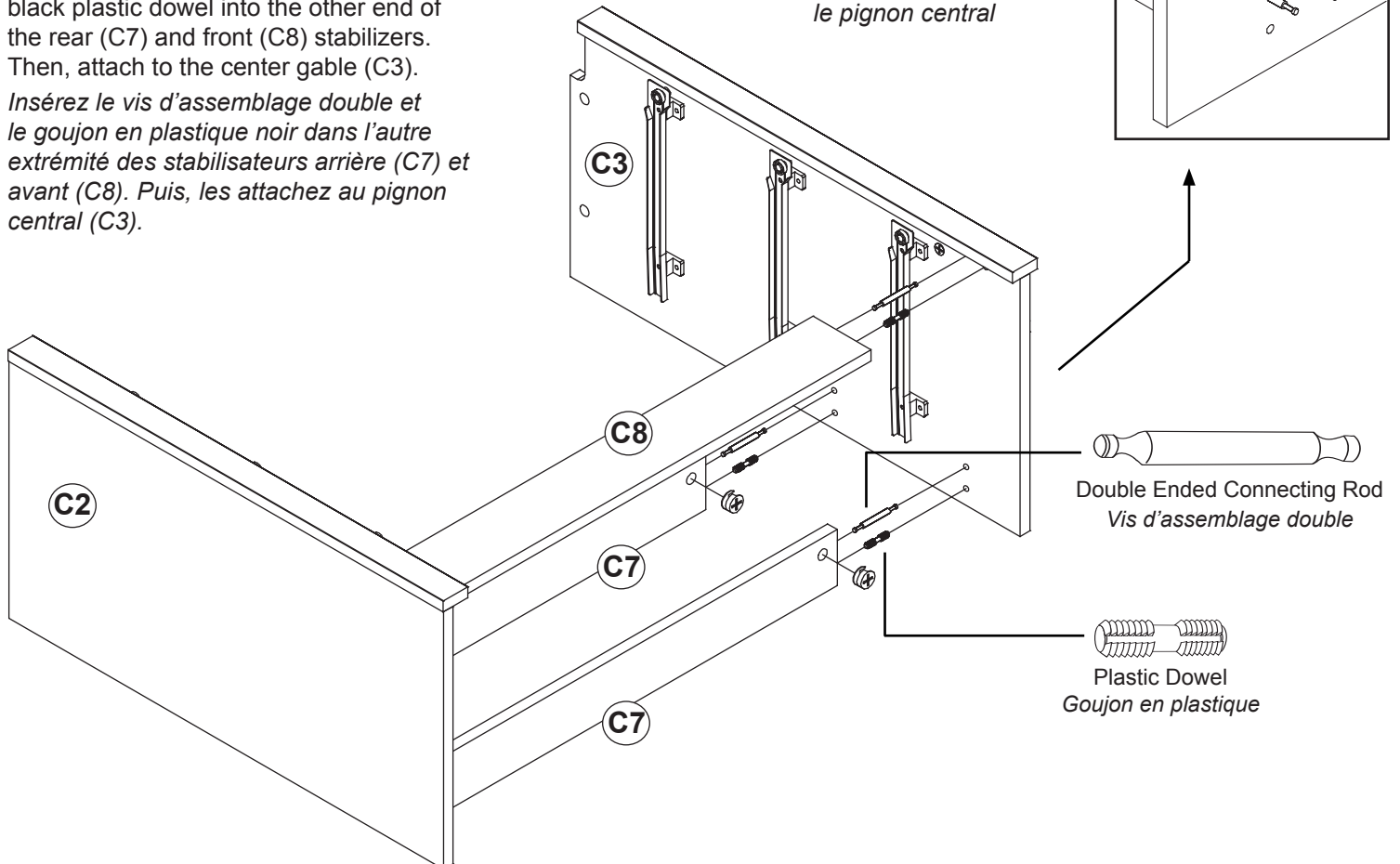

4c

Attach remaining front stabilizer (C8), and 2 rear stabilizers (C7) to the right (C4) side and lock cams using a flat head screwdriver

Attachez le renforcement avant (C8) et 2 renforcement arrière (C7) qui reste aux côtés droite (C4) et serrez les ferrures utilisant un tournevis principal plat

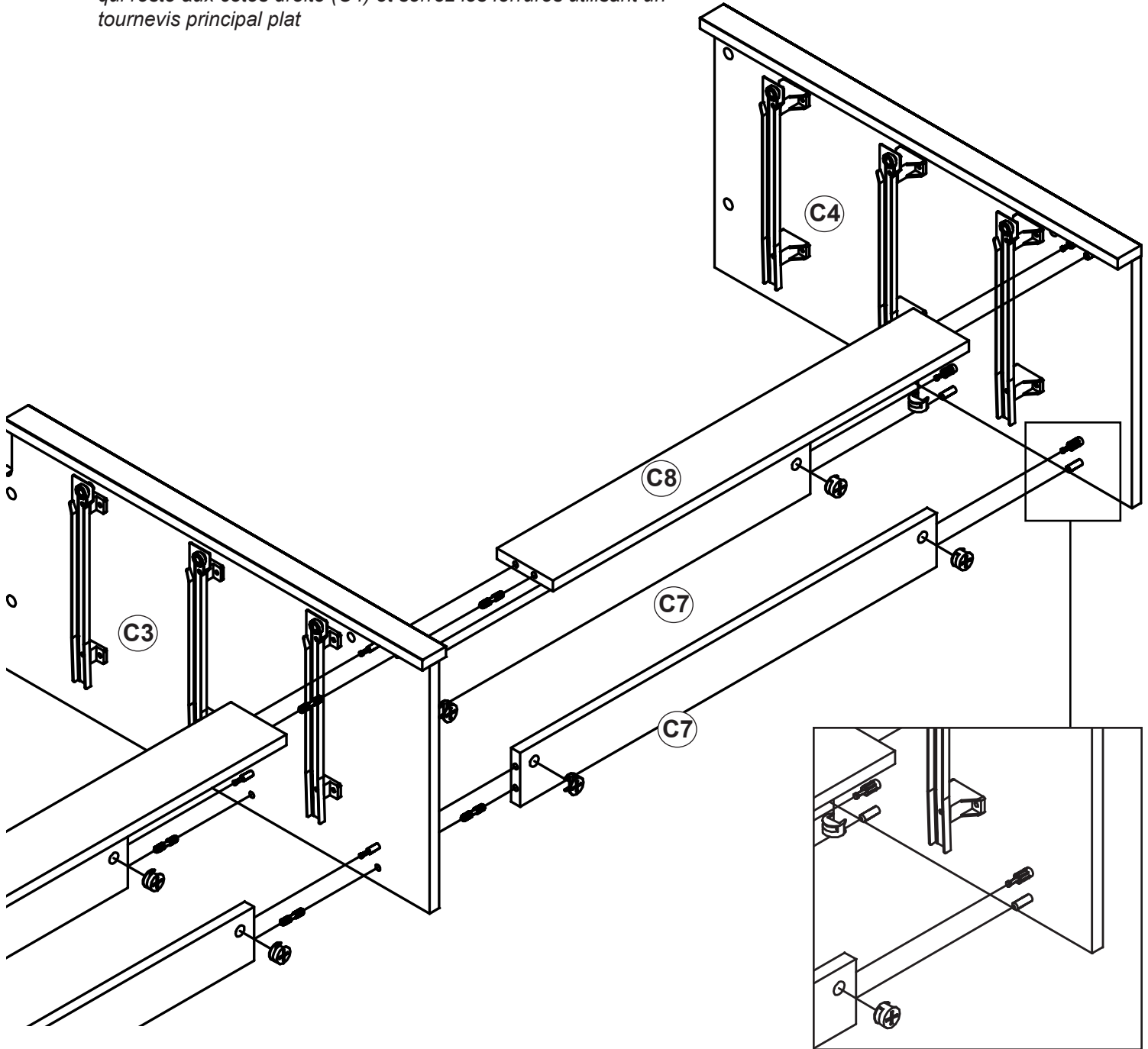

Tightening Cams
Serrez les ferrures

Unlocked
deverrouillé

Locked Turn 210°
verrouillé
tourner 210°

Step 5 Estimated Time: 10 Minutes

- 5a** Screw green twister dowels into the top (C1)
Vissez les goujons de torison vert au dessus (C1)

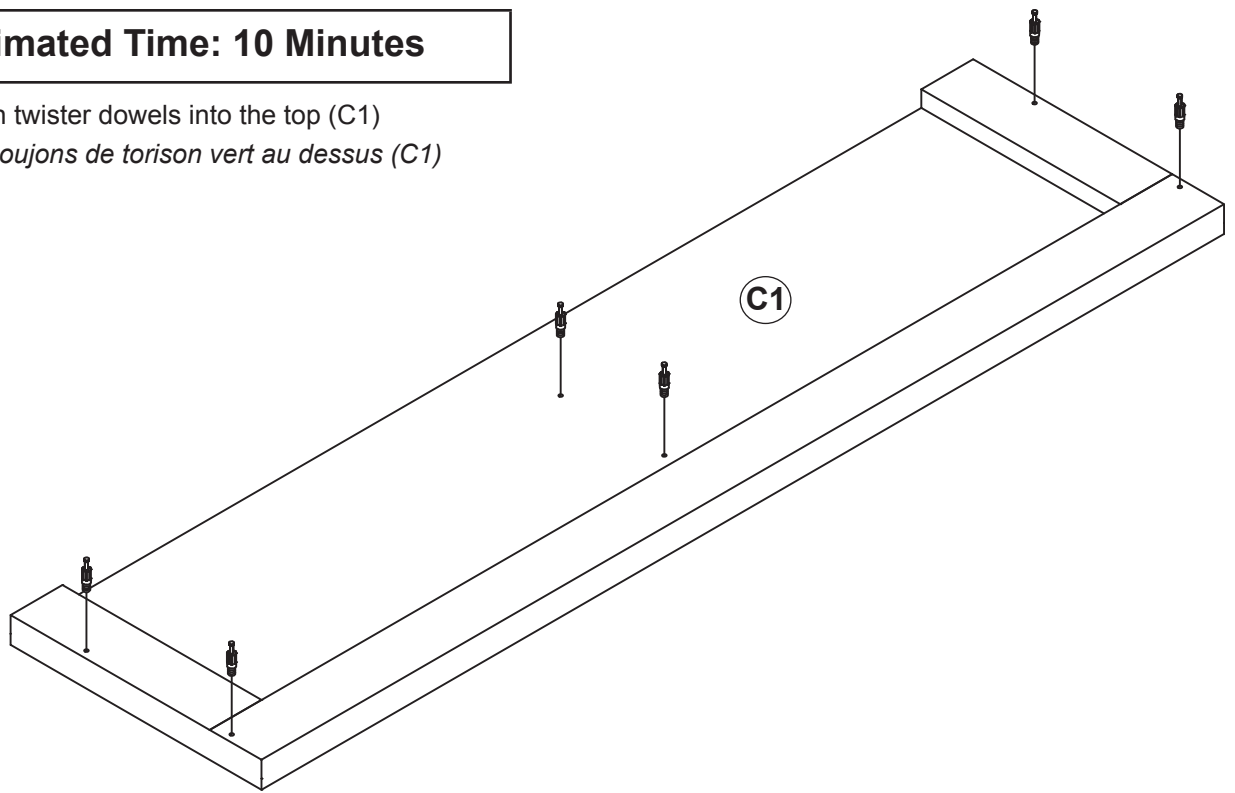

- 5b** Insert cams into sides, attach the top (C1) then, tighten cams.
Insérez les ferrures aux côtés, attachez le dessus (C1) puis, serrez les ferrures

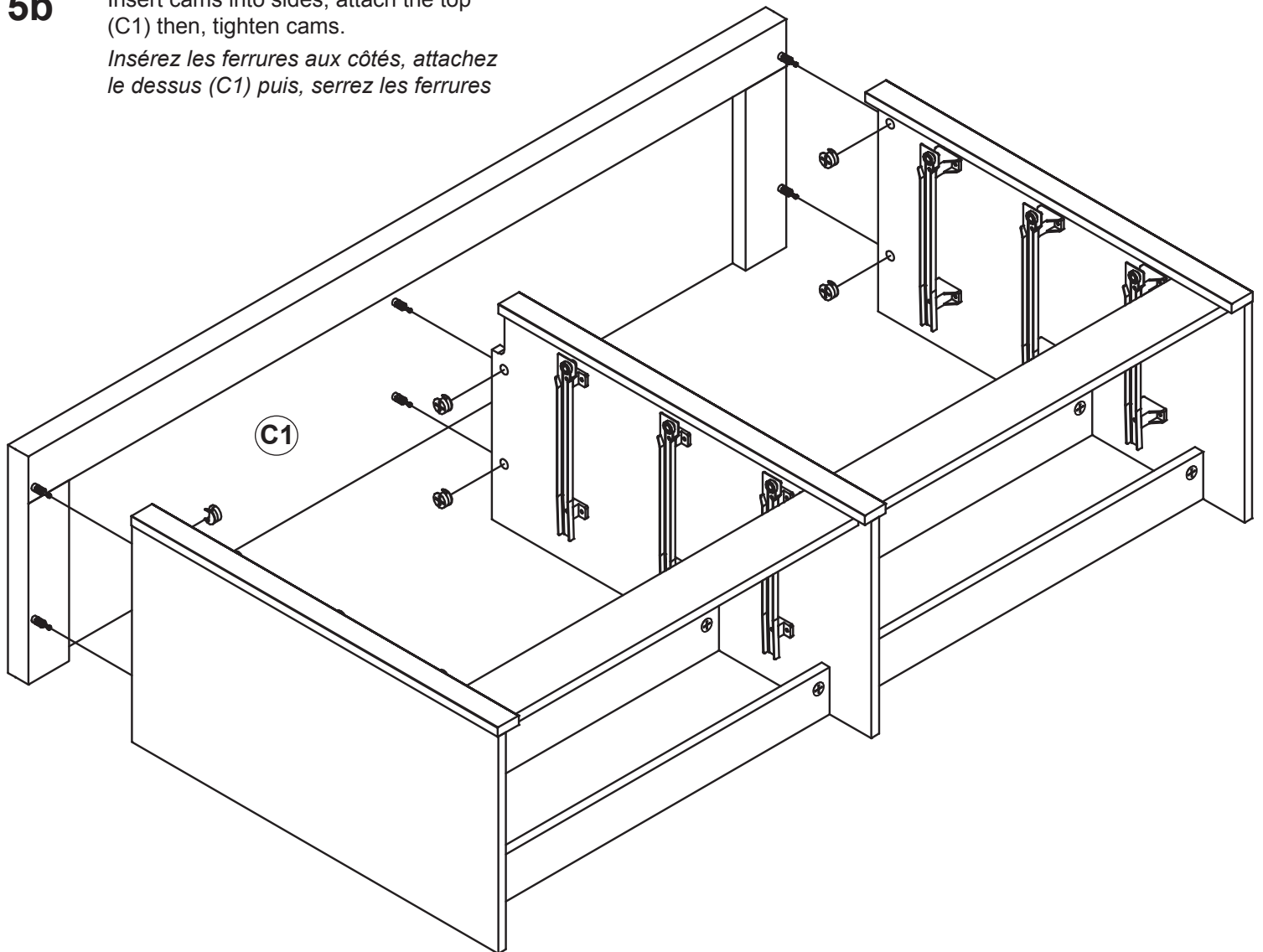

Step 6 Estimated Time: 5 Minutes

Attach backer with nails (C8)

Attachez le dos avec les clous (C8)



$\frac{3}{4}$ " Nail
Clou $\frac{3}{4}$ "

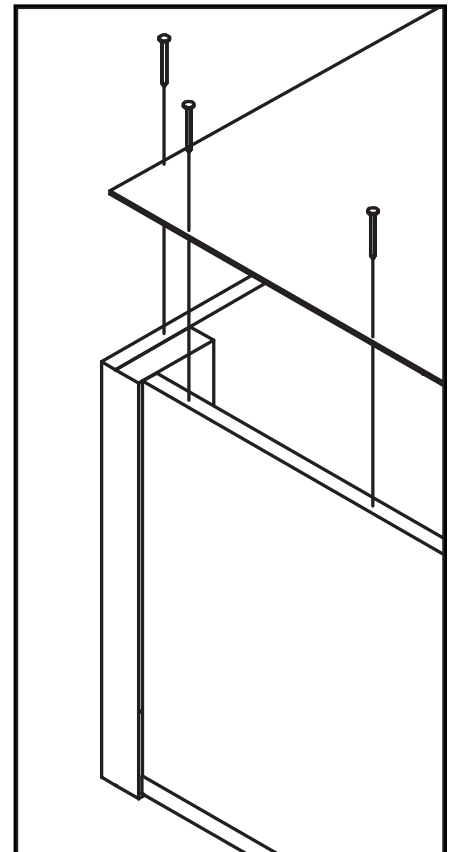
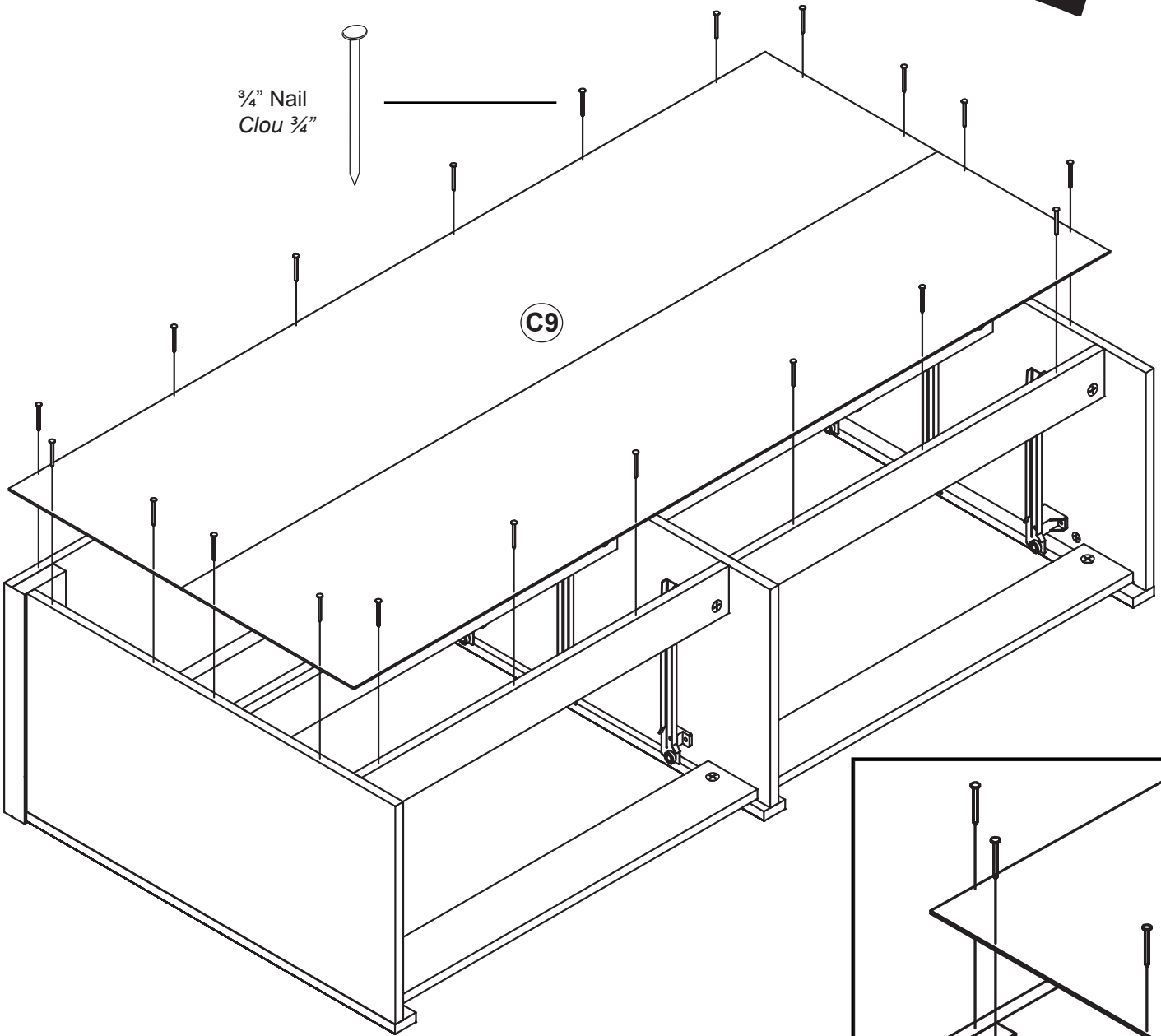

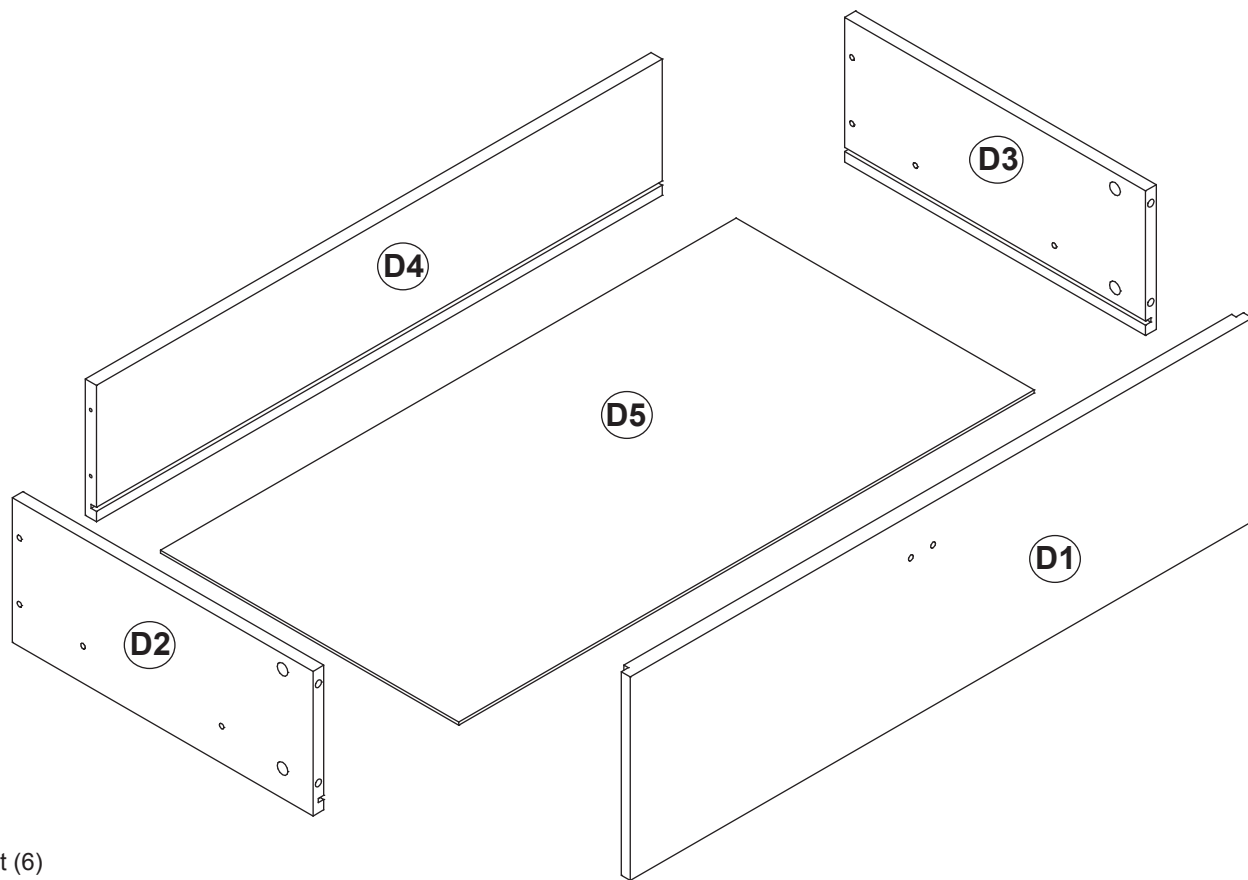

Drawer Parts
Pièces de tiroir

D1 Drawer Front (6)
Devant du tiroir
black / noir
espresso / *expresso*
washed black / *noir vieilli*
warm cherry / *cerisier foncé*
white / blanc

D2 Left Drawer Side (6)
Côté gauche du tiroir
Unfinished
non-fini

D3 Right Drawer Side (6)
Côté droit du tiroir
Unfinished
non-fini

D4 Drawer Back (6)
Arrière du tiroir
Unfinished
non-fini

D5 Drawer Bottom (6)
Fond du tiroir
Unfinished
non-fini

a

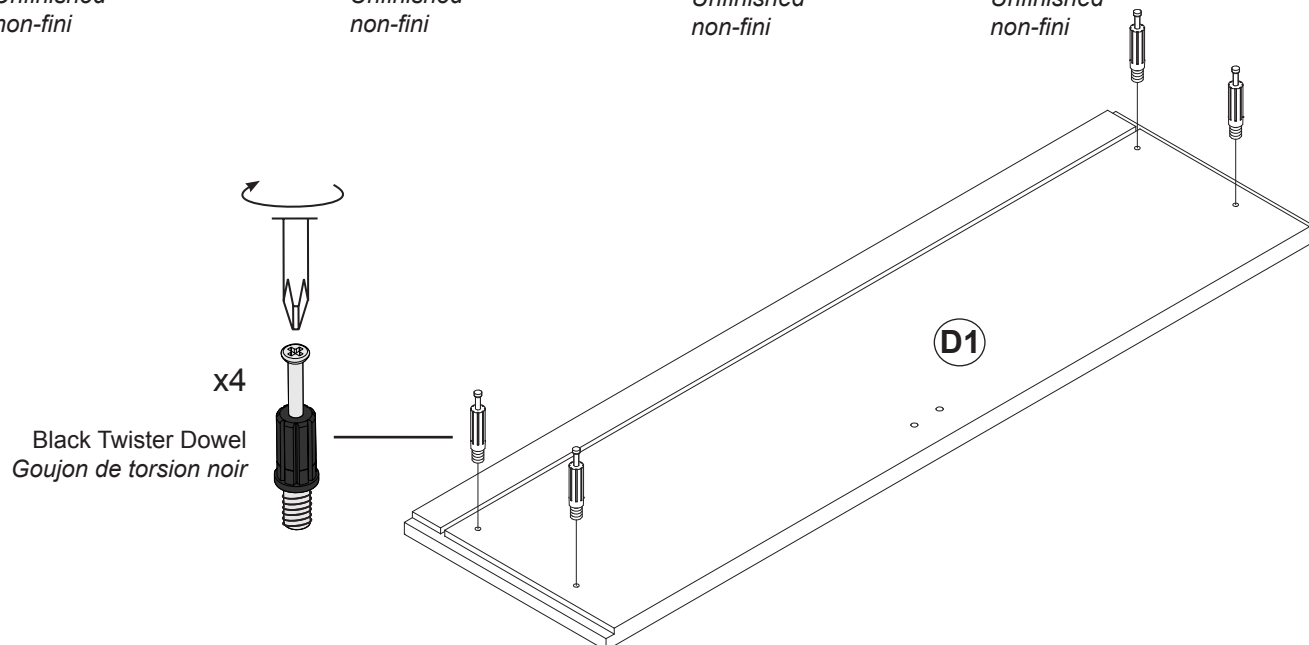

b

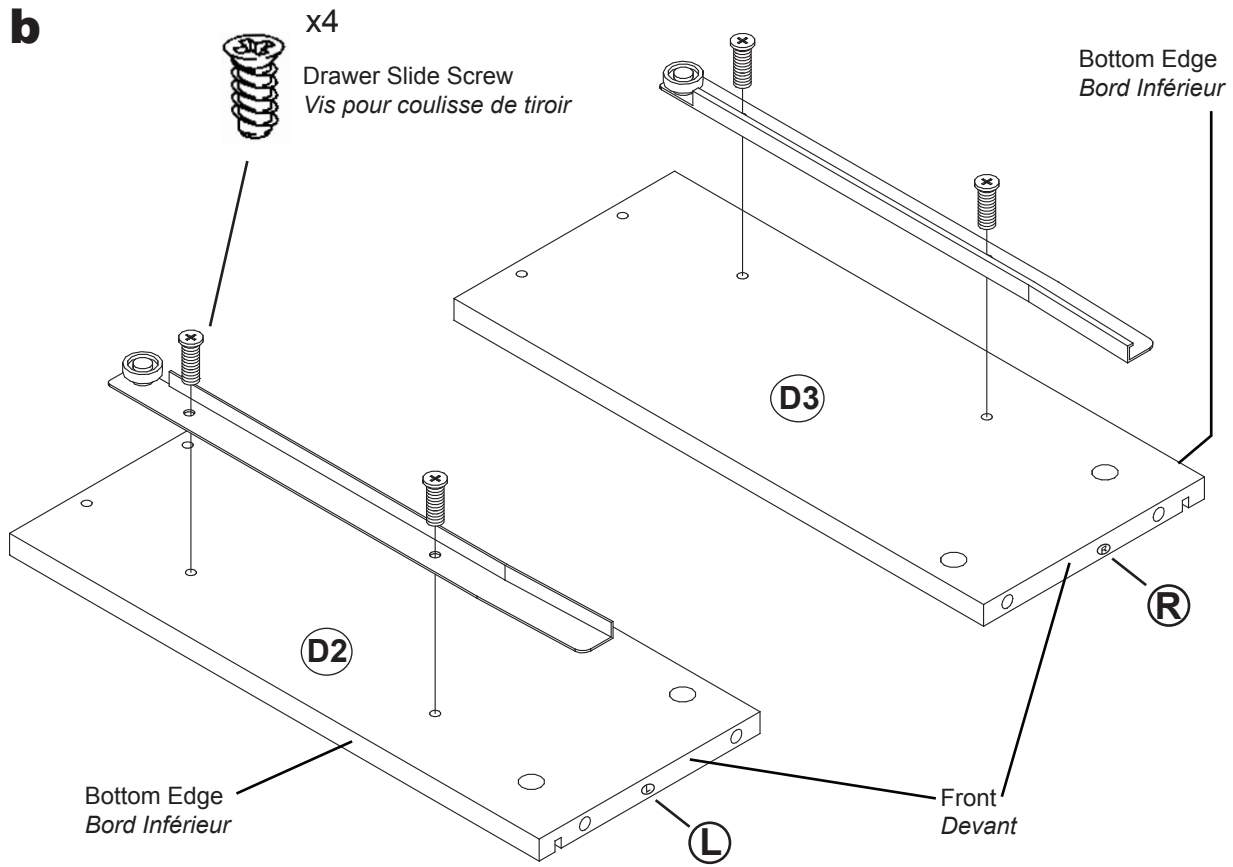

c

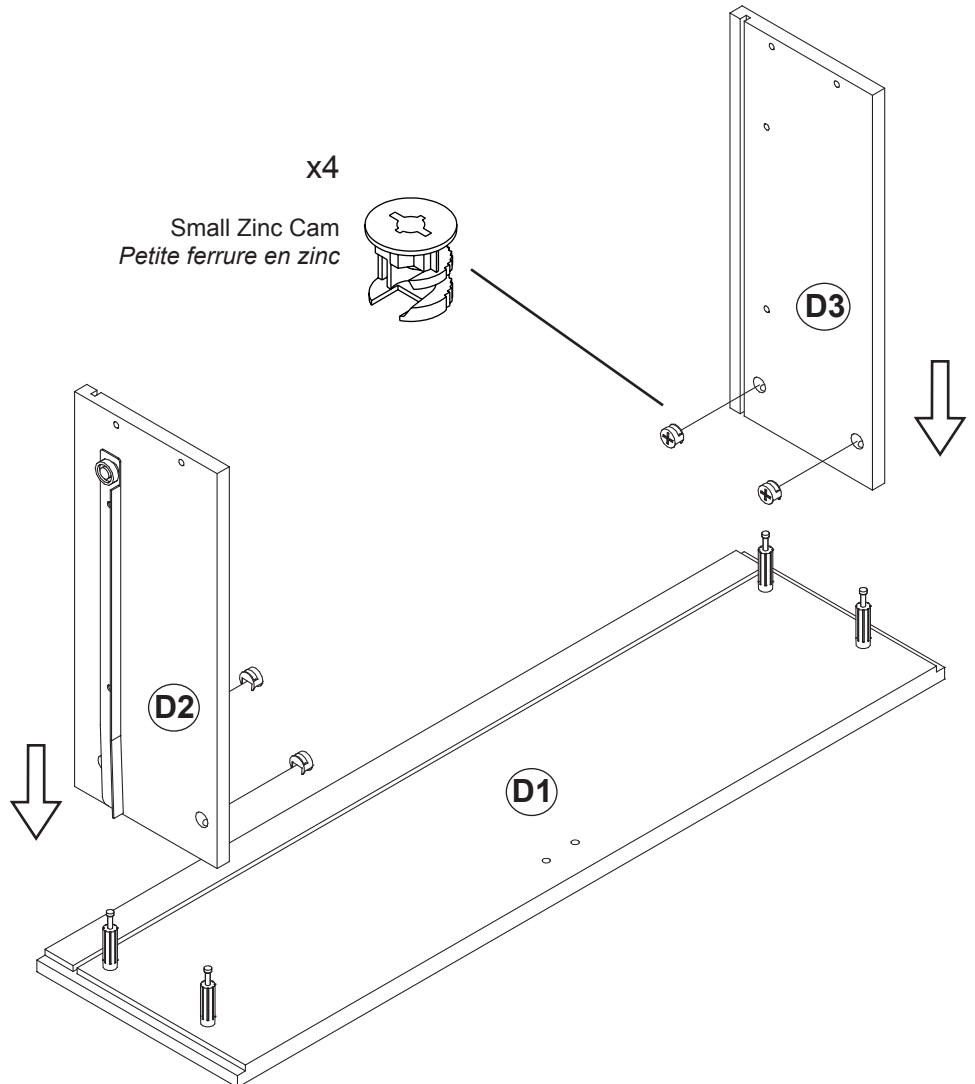

d

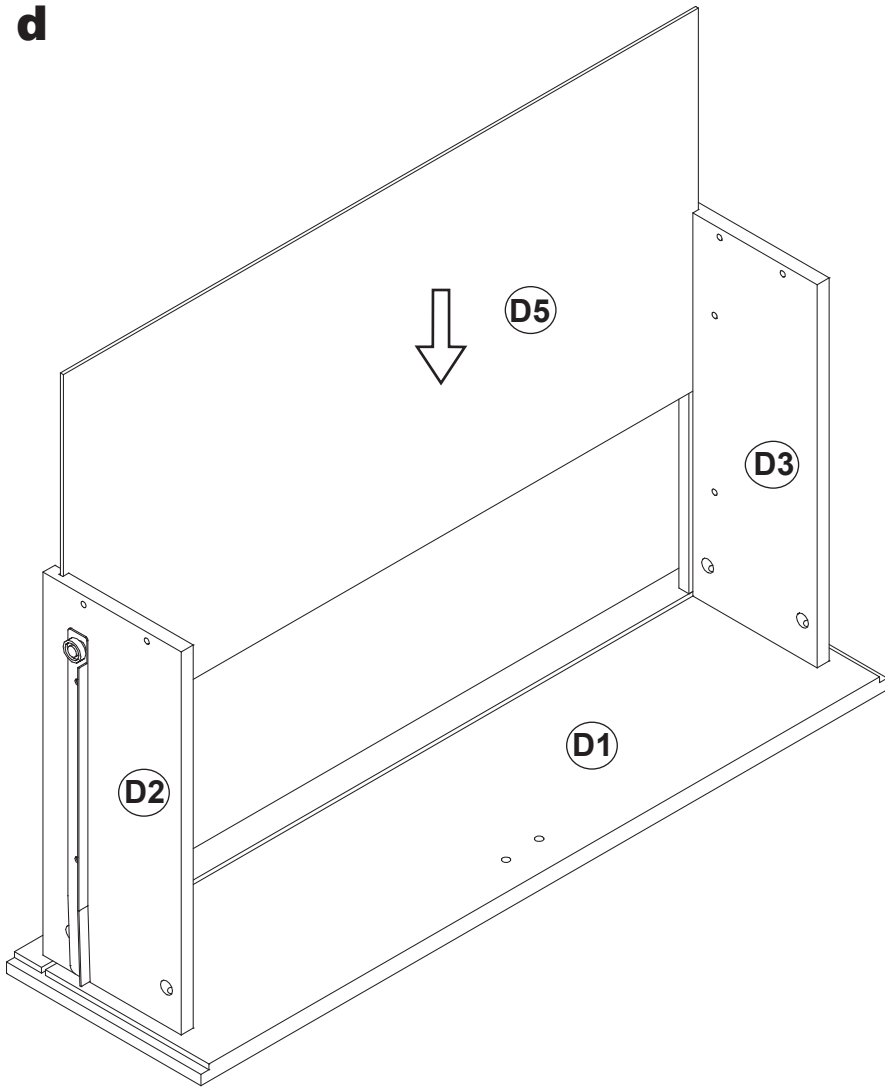

e

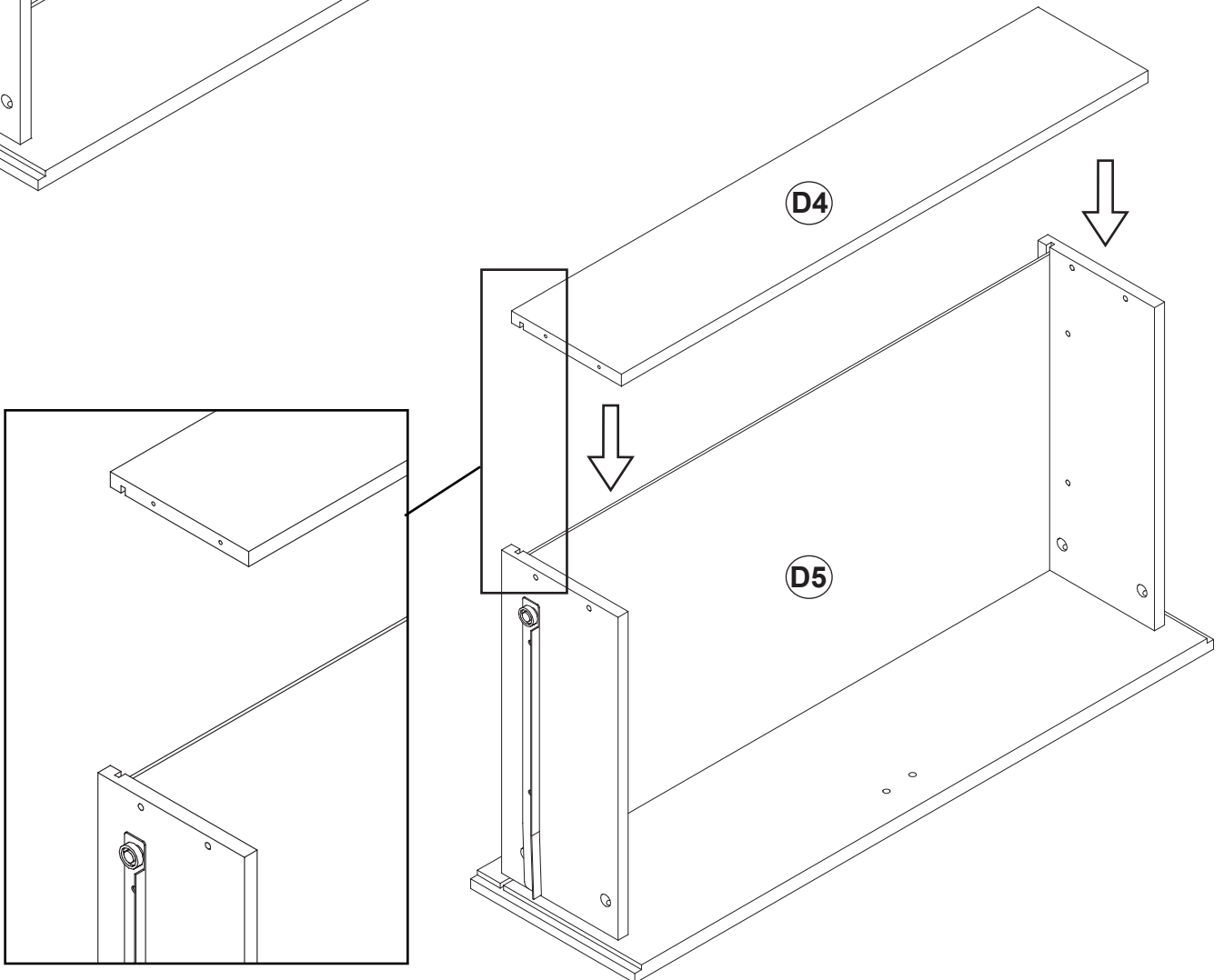

f

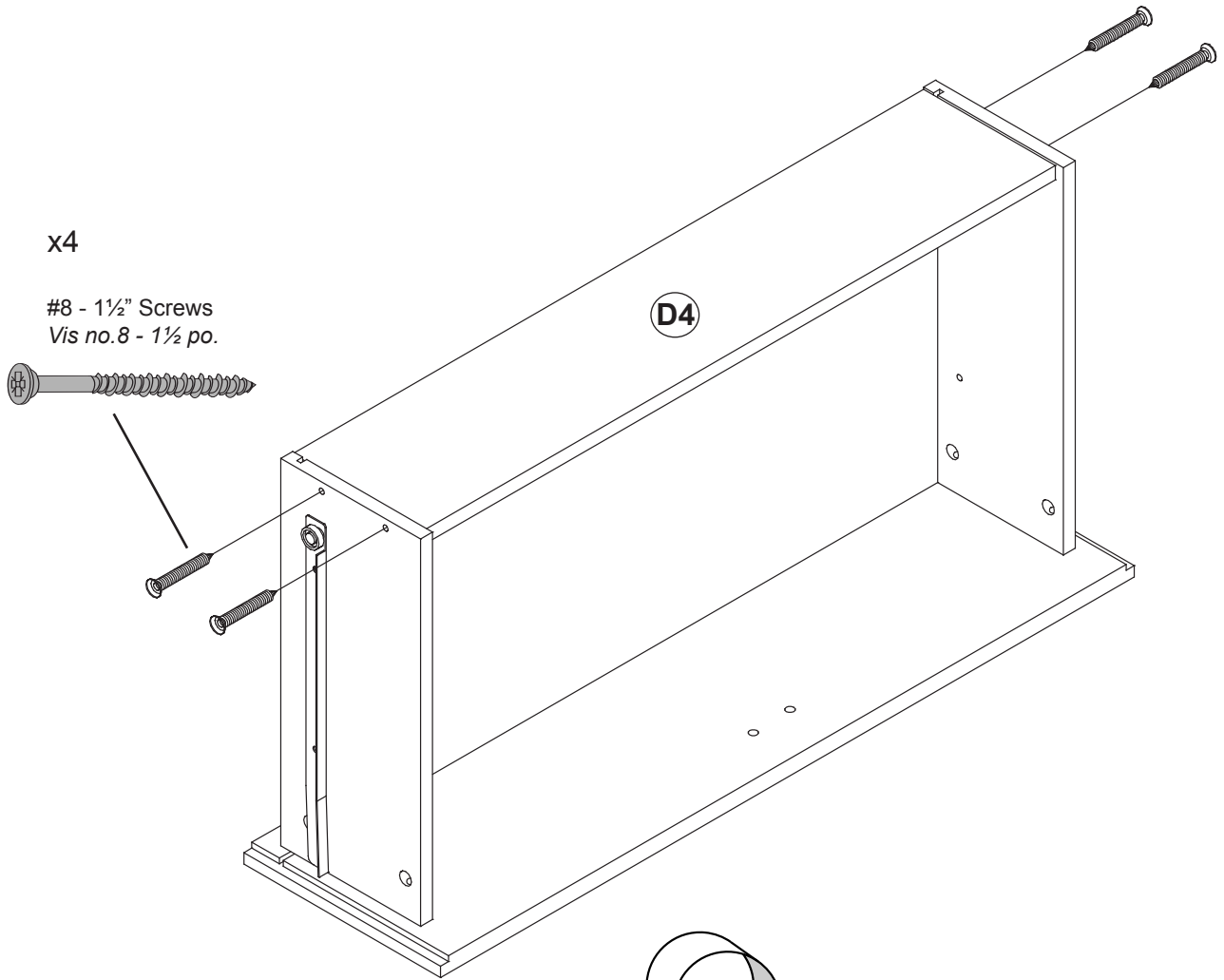

g

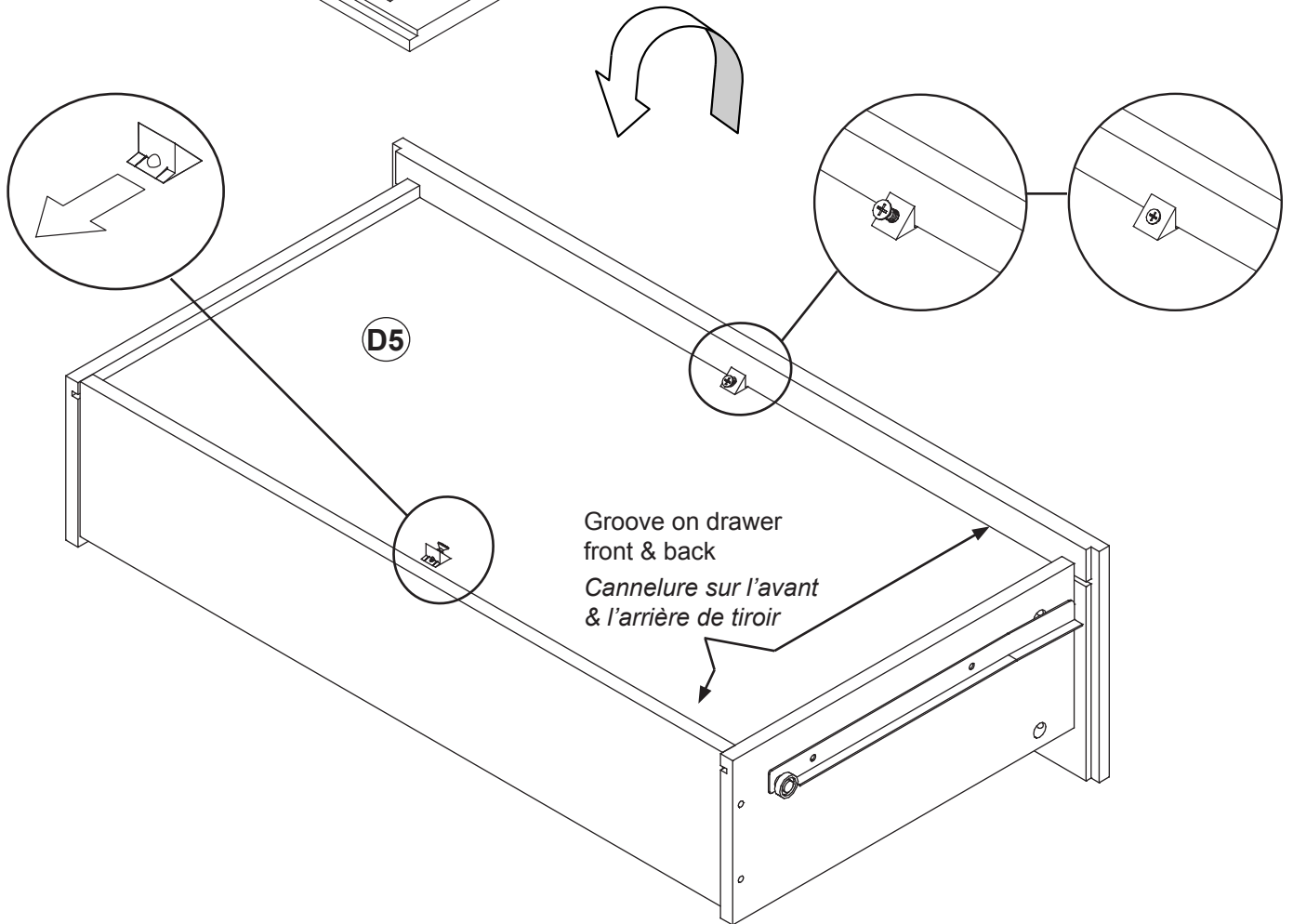

7h

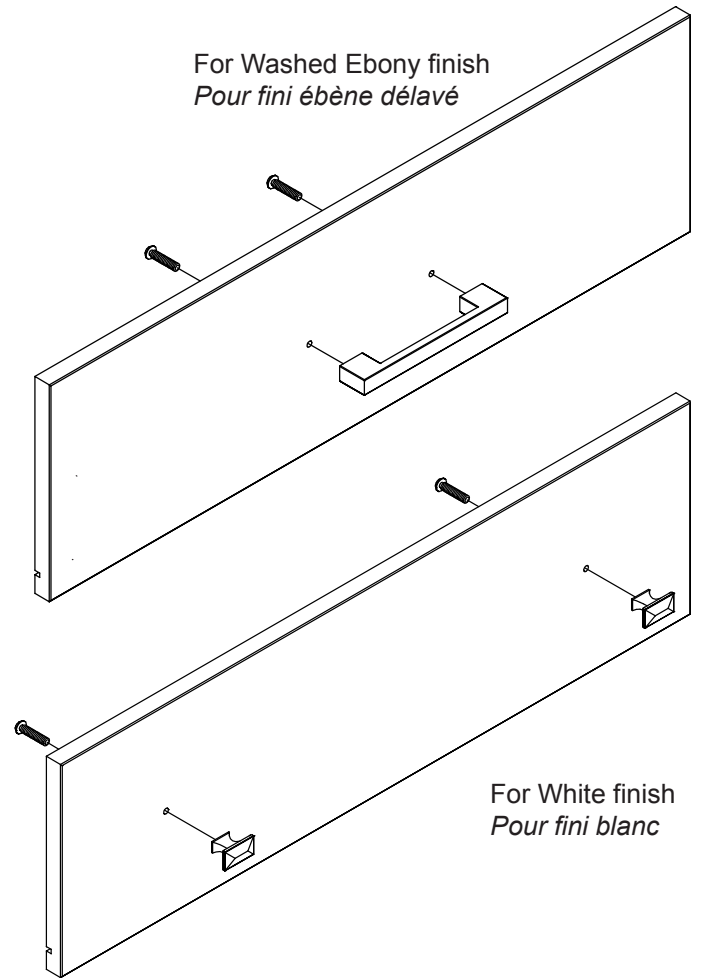
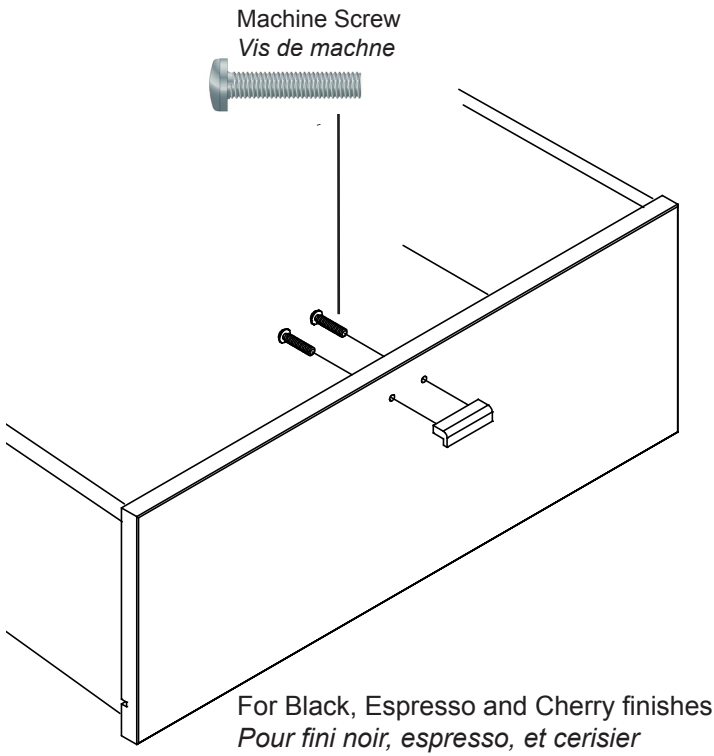

Step 8 Estimated Time: 1 Minute

Insert drawers
Insérez les tiroirs

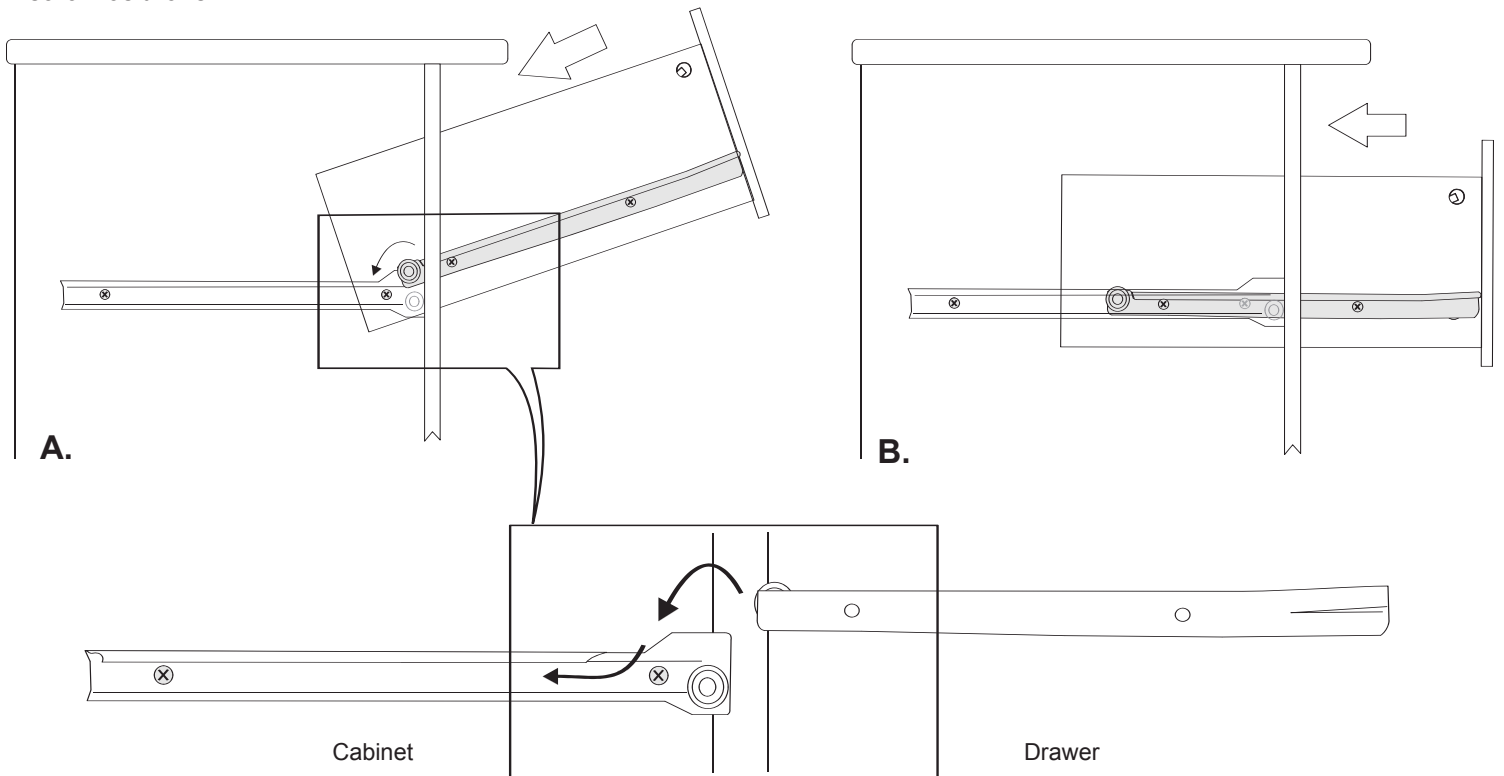

Note: When drawers are installed correctly, you will not be able to remove them without first lifting up the drawer front.

NOTE: Quand des tiroirs sont installés correctement, vous ne pourrez pas les enlever sans se soulever d'abord vers le haut de l'avant de tiroir.

STEP 9 Attaching and Using the Cable Tie

Attacher et Utilisation de l'Attache de Câble

We strongly recommend using a cable tie on all furniture, especially if small children have access

Nous recommandons utilisant fortement une attache de câble sur tous les meubles, surtout si les petits enfants ont accès

- 9a** With the #6-3/4" screw, attach one of the mounting bases to one of the sides 1 inch from the top.
Avec le #6-3/4" vis, attacher une des bases montant à un des côtés 1 pouce du sommet.

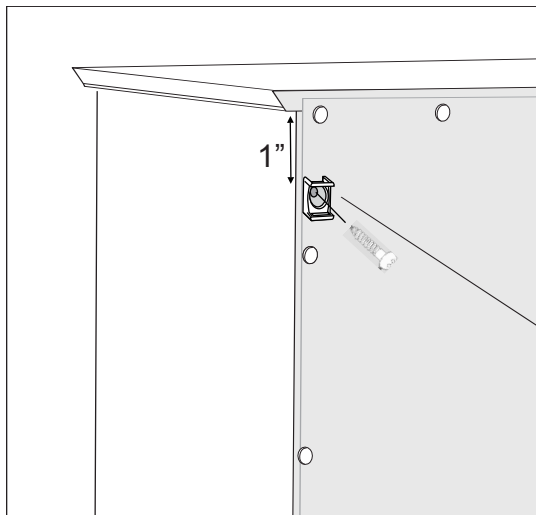

- 9b** Attach the 2nd mounting base to the wall 2" lower than the one on the cabinet

Important: Find a wall stud and attach the mounting base with a 1½" screw (not included). If you cannot locate a stud, use an approved wall mounting system

Attacher la deuxième base montant au mur 2" plus bas que le l'un sur le cabinet.

Important : Trouver un clou de mur et attacher la base montant avec un 1½ » la vis (n'a pas inclus). Si vous ne pouvez pas localiser un clou, utilisez un système fixé au mur approuvé

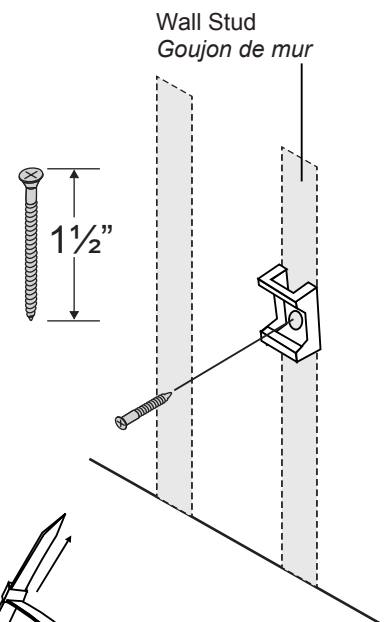
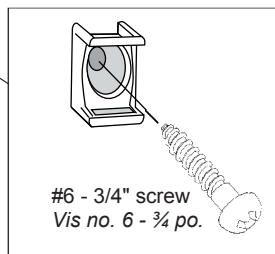

- 9c** Feed the cable tie through each mounting base and then through the locking mechanism to tighten.

Nourrir l'attache de câble par chacun montant la base et alors par le mécanisme de verrouillage pour resserrer.

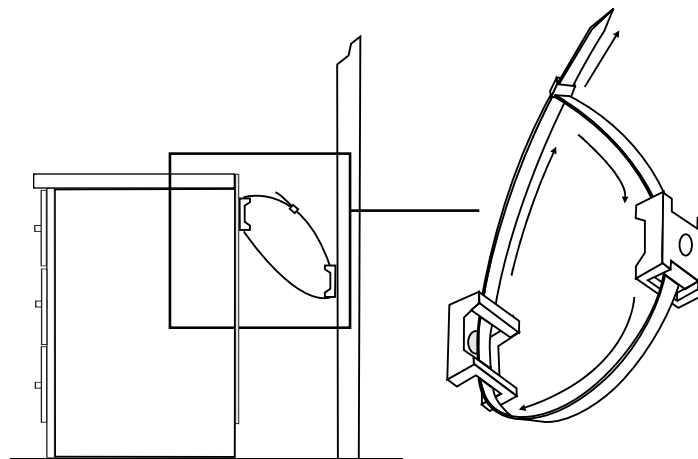

Give Us Your Feedback



Thanks!