

# Assembly Instruction

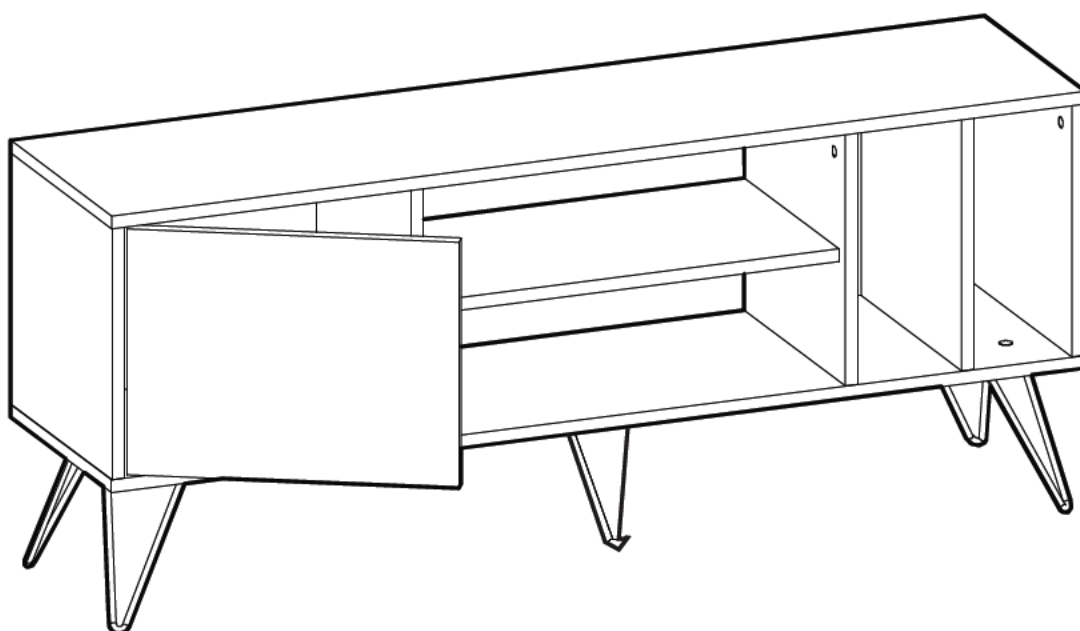

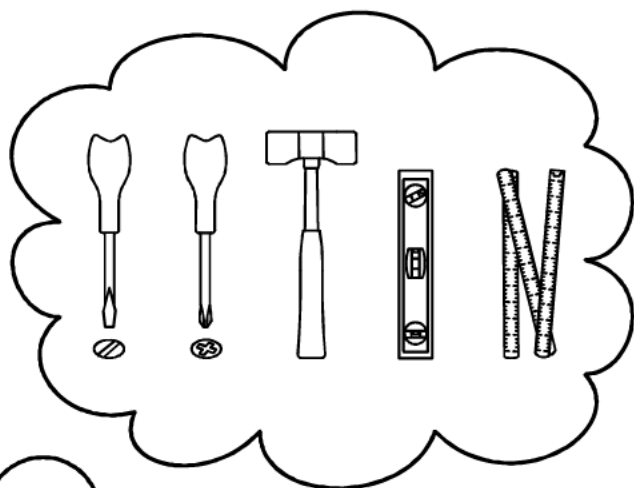
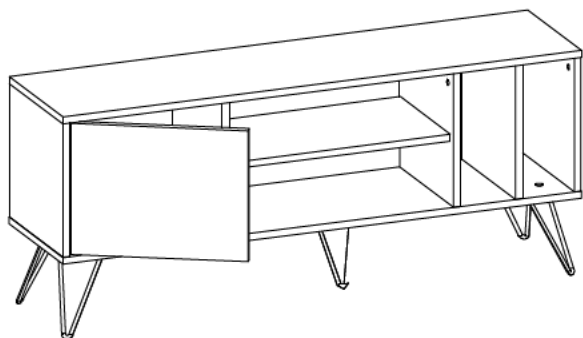

## Disassembled Parts

Part#1	1x
Part#2	1x
Part#3	1x
Part#4	1x
Part#5	1x
Part#6	1x
Part#7	1x
Part#8	1x
Part#9	1x
Part#10	1x

---

**Total 10x**

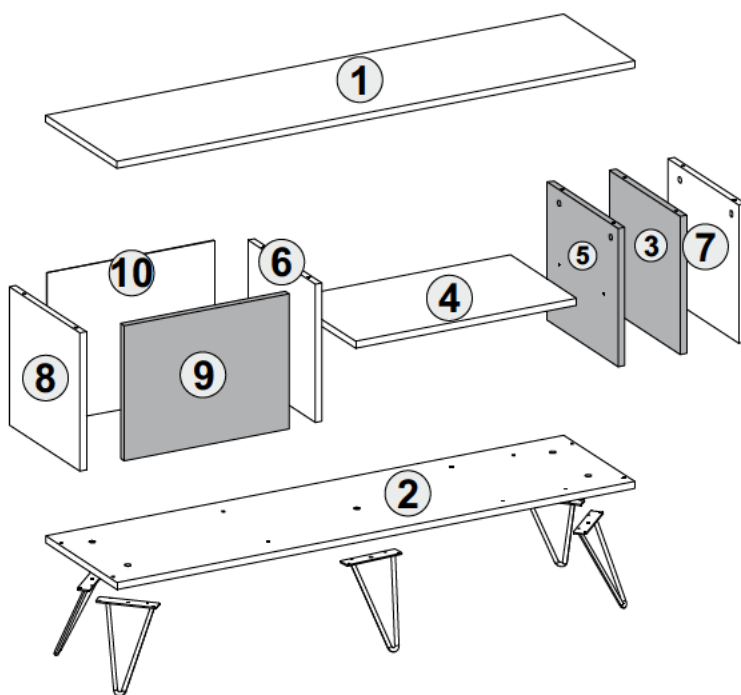

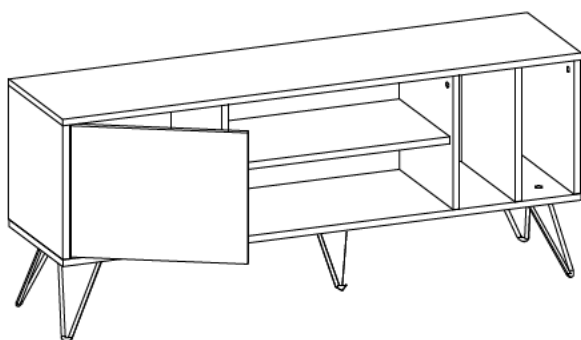

## Tools & Installation Components



A23 Q10 minifix screw

10x



A02 15x14 minifix head

10x

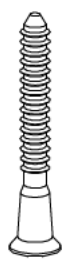

A17 6x50 screw

10x



A19 3,5x18 screw

28x



A21 Q15 sticker

13x



A21 Q15 sticker

5x

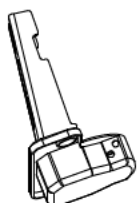

C01 concealed hinge base

2x

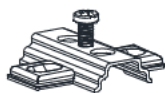

C04 aks37 hinge mounting plate

2x



A28 nail

8x

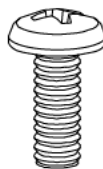

A19 m6x20 bolt

5x



A20 m6 nut

5x



P20 pin connector

4x



metal leg

5x



Please be aware that C01(bracket) and C04(pivot) parts may come as attached together.

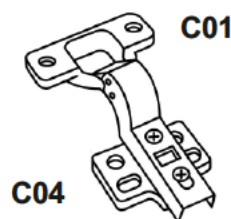

**Step 1** - Attach 5 metal legs to the wood part 2 using A19 screws as shown below.

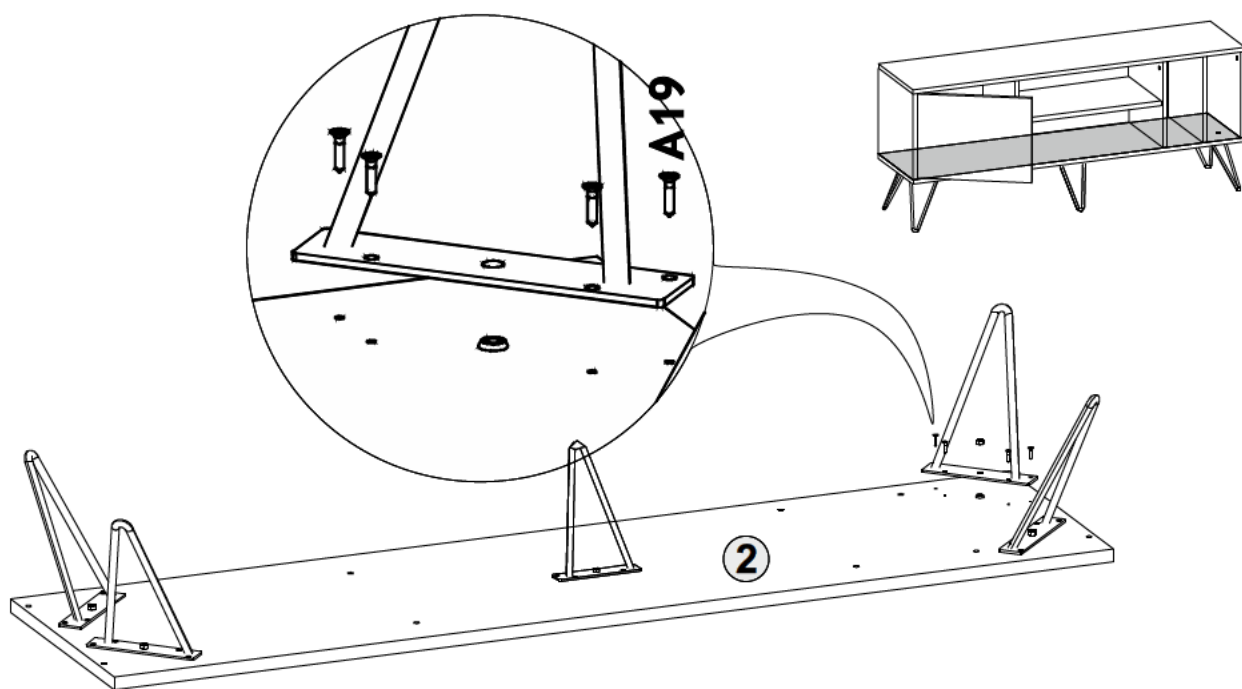

**Step 2** Fasten 5 metal legs to the wood part 2 using A19 bolts and A20 nuts as shown below.  
- Cover the A19 bolts' head with A21 stickers for the better look of your TV stand as shown below.

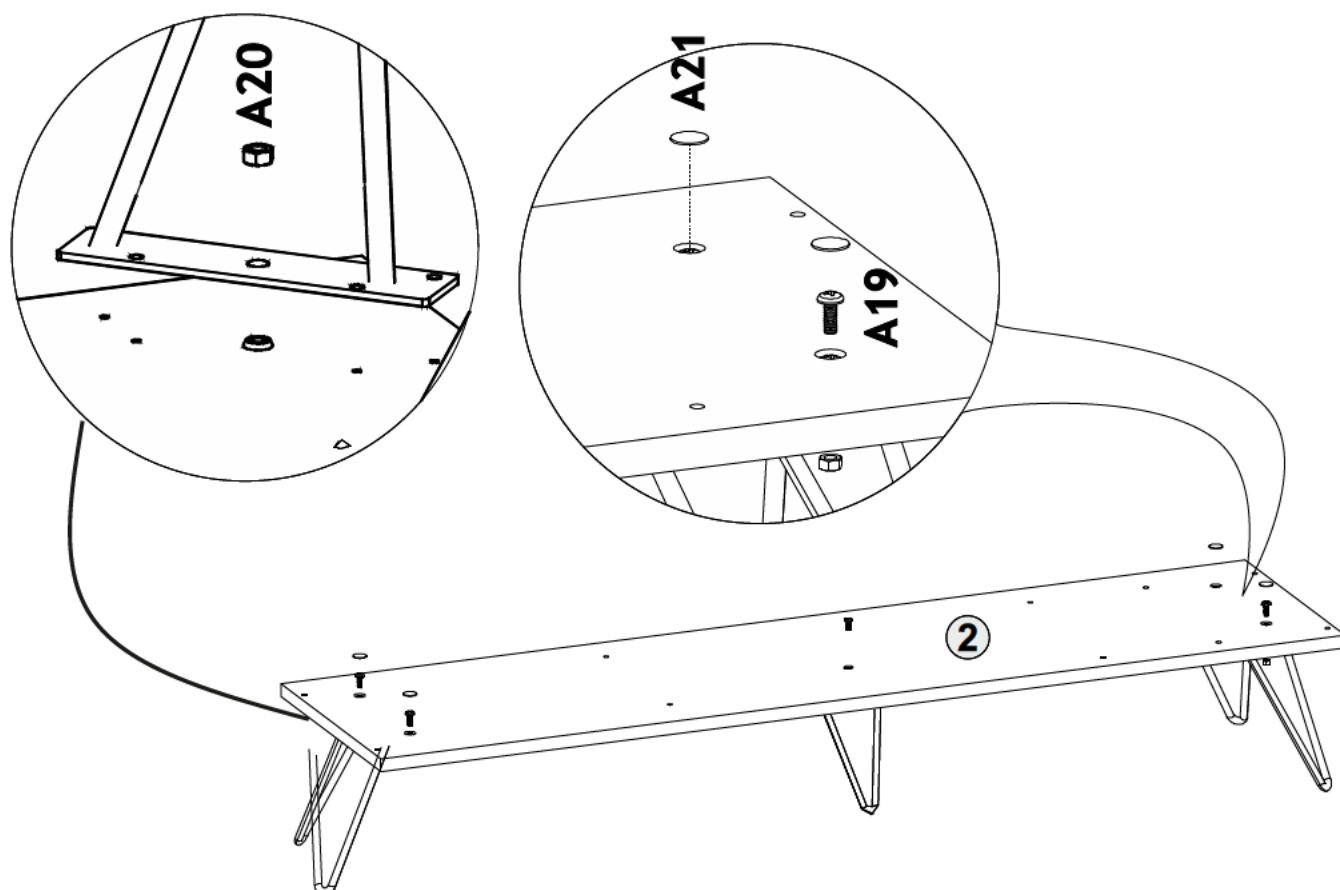

# Step 3

- Attach A24 hinge mounting plate to the pre-drilled trace holes of the part 8 using A19 screws.
- Attach A21 concealed hinge base to the pre-drilled hole of the part 9 using A19 screws.

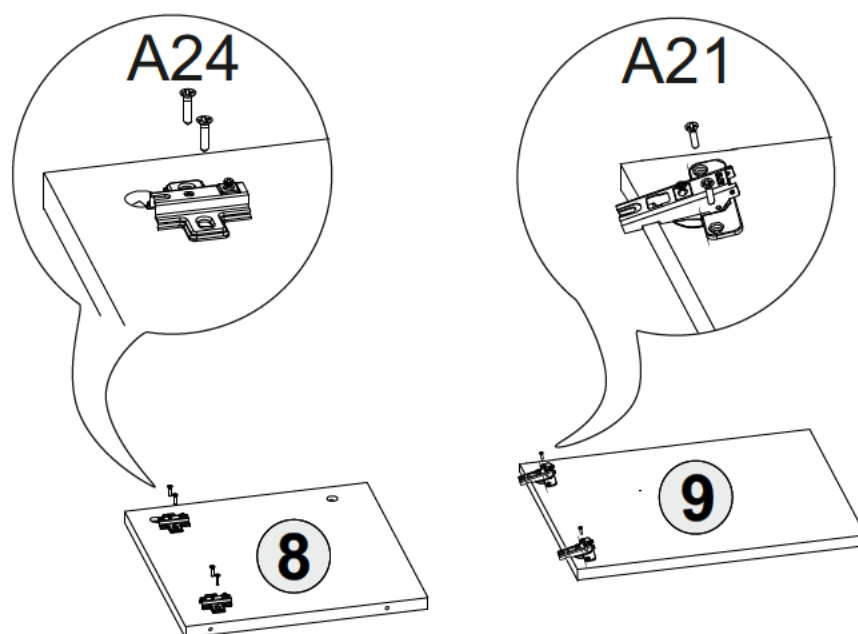

# Step 4



- Put the parts 8, 6, 5, 3, 7 and part 2 together using A17 screws as shown below.
- NOTE that the holes of part 8, 6, 5, 3 and 7 are not in the same distance. Part 8, 5, 3 and 7 holes are located 1.5 inches from the front and 2.3 inches from the back side of the piece. Part 6 holes are located 1.9 inches from the front and 2.3 inches from the back side of the piece.

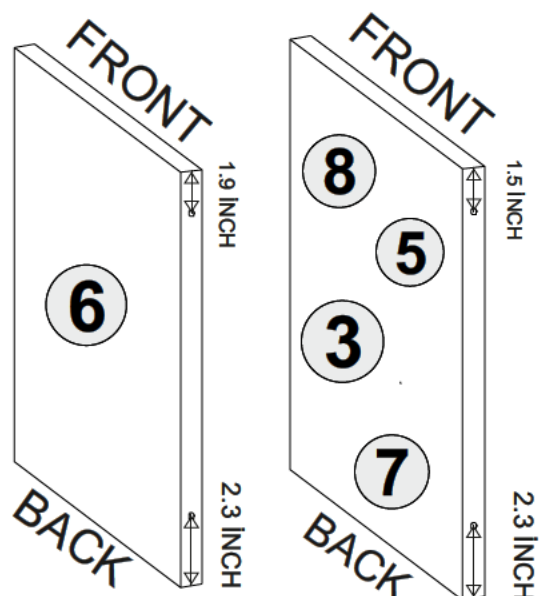
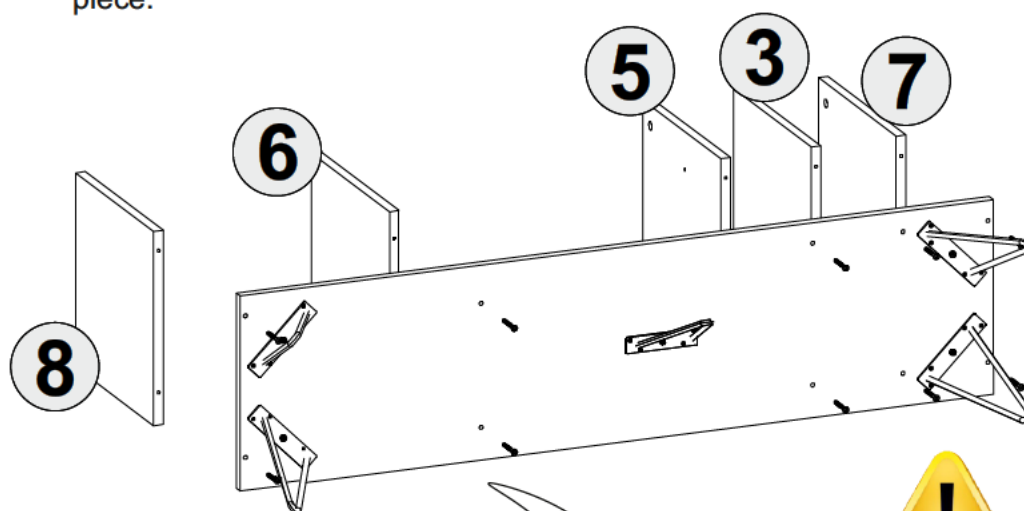

The holes are not countersunk. Push the screw A17 through the hole until its head sits flush with the wood surface. The screw head should not protrude above the surface

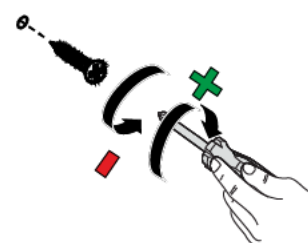
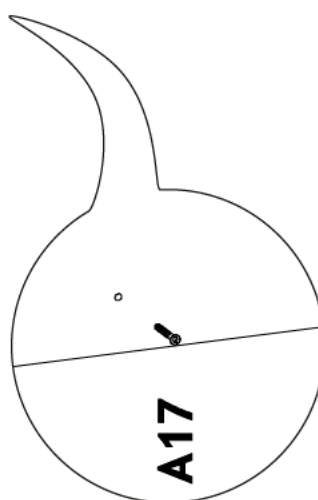

## Step 5

- Place the A23 minifix screw into the pre-drilled holes of the part 1.
- Place the A02 minifix head into the assembled part 8, 6, 5, 3 and 7. NOTE that the minifix head arrow should be placed in the direction of upper wood hole.
- Attach the part 1 to the body we assembled in the previous steps and screw the A02 minifix heads to + or clockwise direction until its locked. Do not go any further.

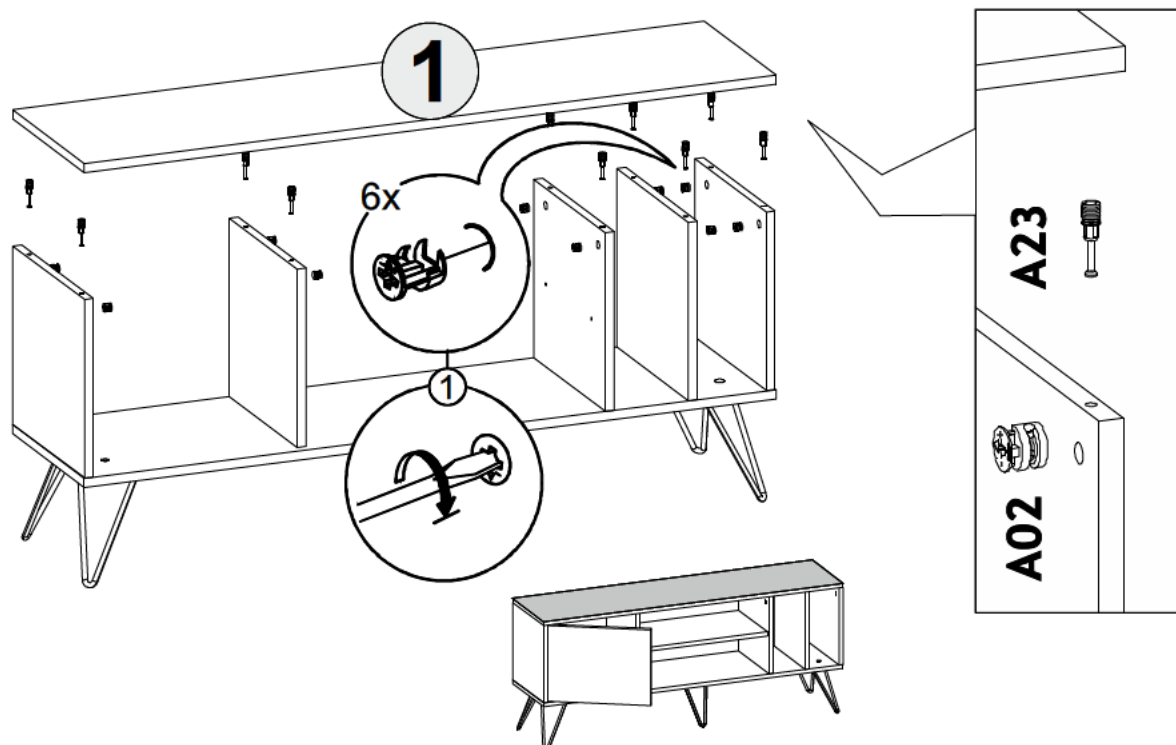

## Step 6

Place the back panel (part 10) as shown below and tap the nail (A28) with a hammer to drive it into the wood. Keep driving the nail until its head is either flush with or below the surface of the wood. Use all the nails given in the hardware pack for best result.

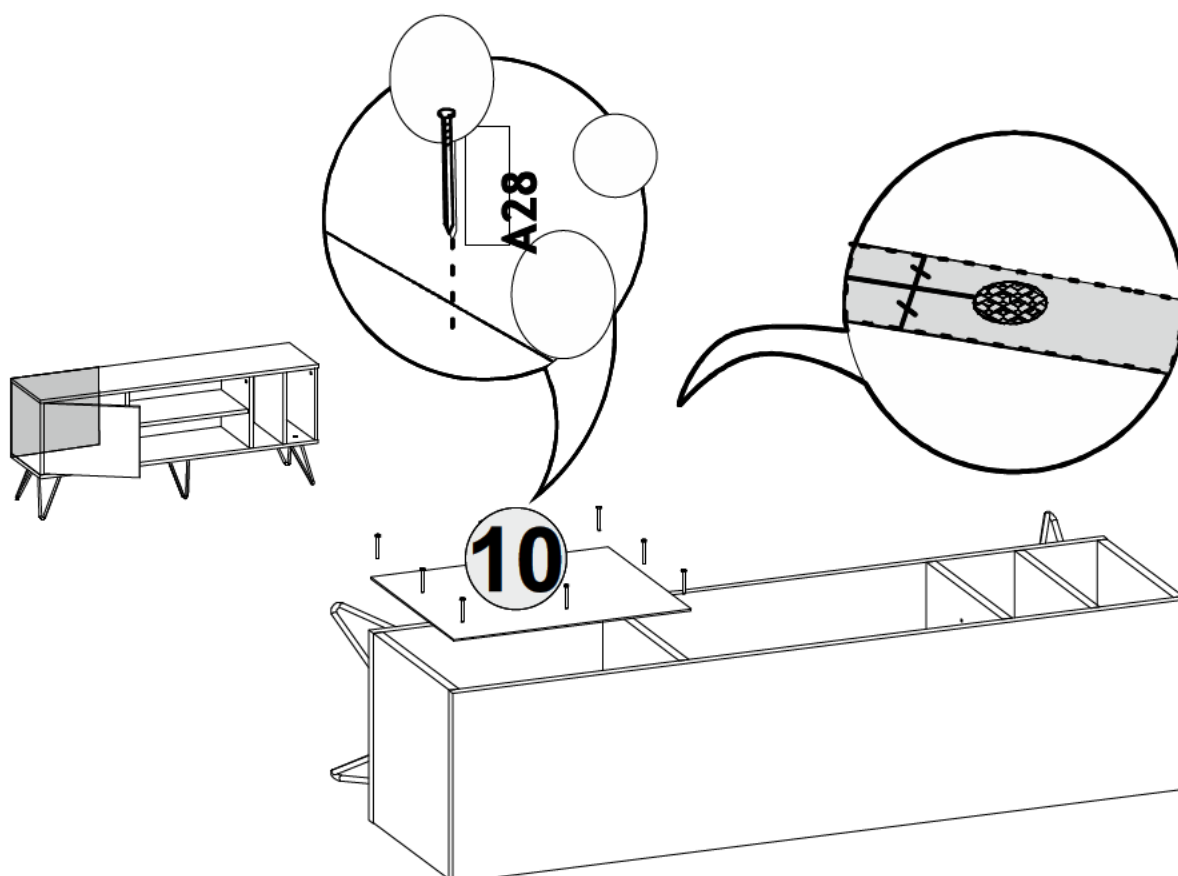



# Step 7

- Insert the P20 pins into the predrilled holes of the middle shelf as shown below.
- Place the part 4 on the pins that you have installed.
- Cover visible minifix heads with A21 sticker for a better look of your TV stand

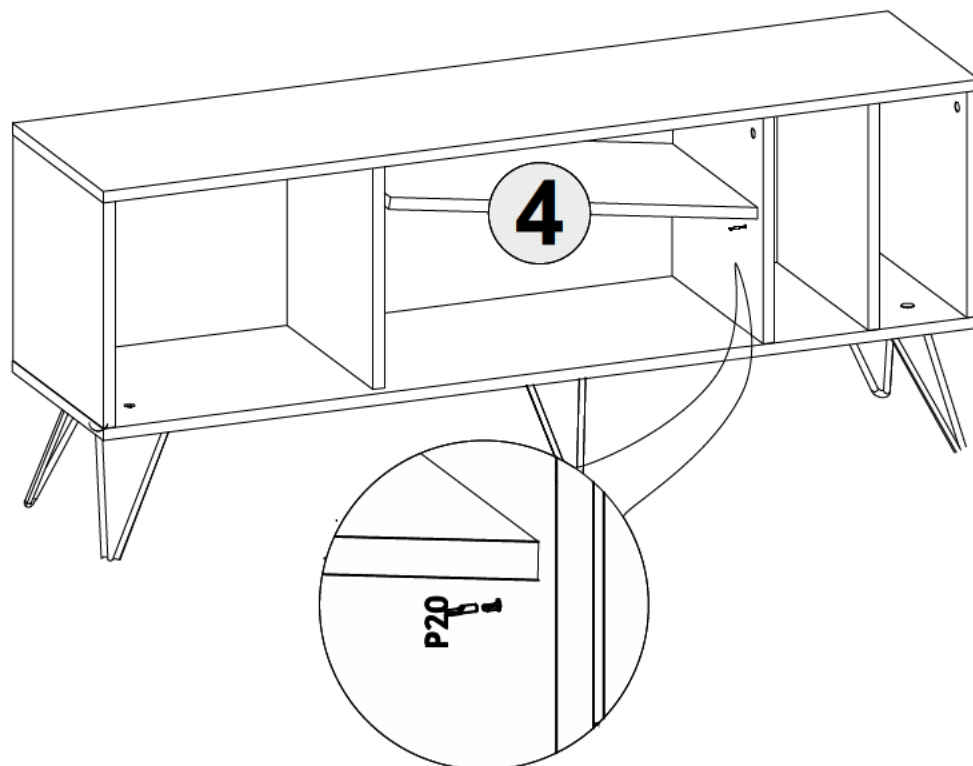

# Step 8



Attach the door (part 9) to the TV stand as shown below. Turn a special screw on the hinge mounting plate (A24) to fasten the concealed hinge base (A21) to the hinge mounting plate that you installed in step 3. NOTE that the same special screw on the hinge mounting plate (A24) aligns the door depth in the forward and backward direction. The second special screw on the concealed hinge base (A21) aligns the door height in the upward and downward direction.

