

INSTRUCTION

DIRECTION FOR INSTALLATION

1. Carefully remove product from package;

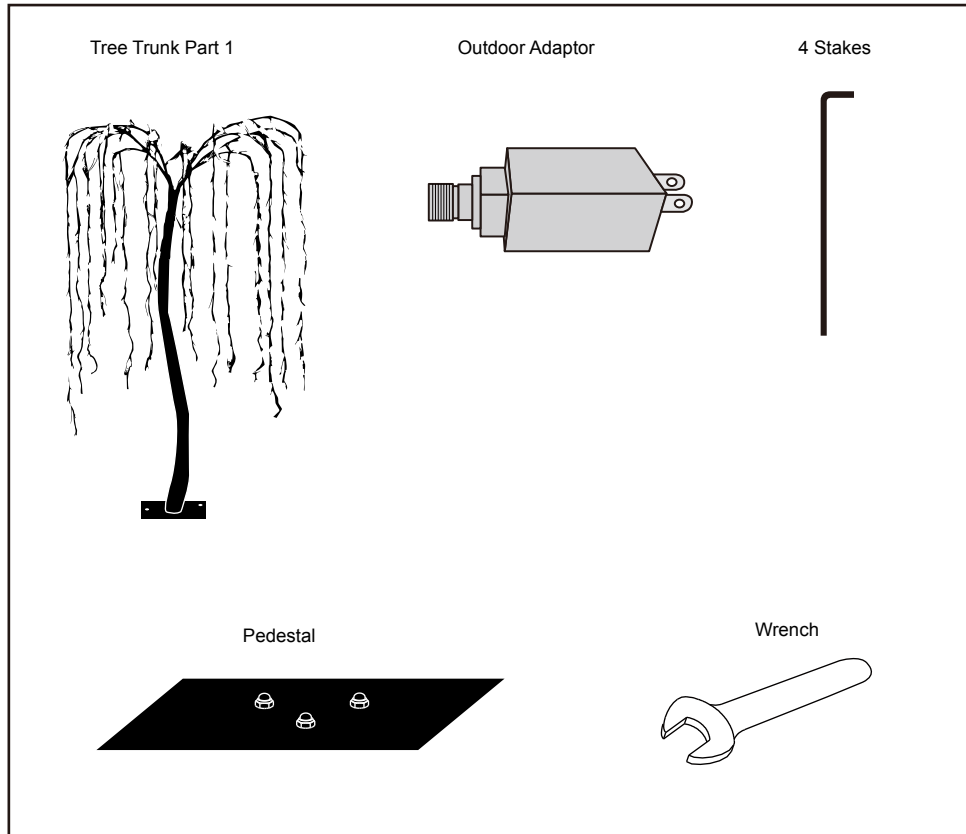

2. Adjust the trunk to fit the nuts on the base and fix it with screws by wrench included.

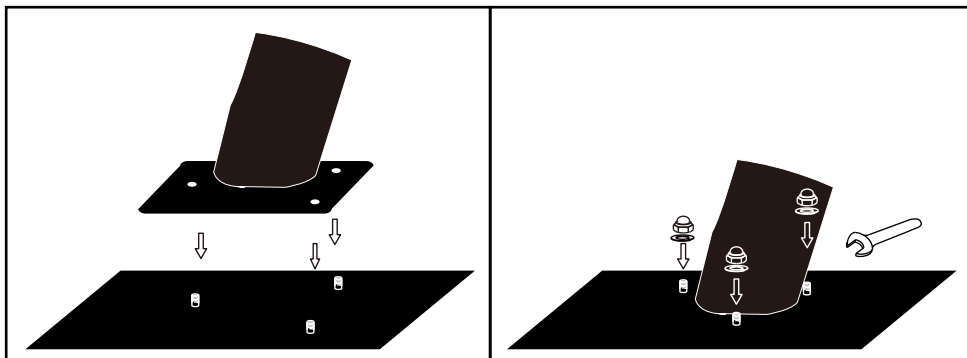

3. Connect the power adapter and then plug in the outlet. Fix the base by ground stakes.

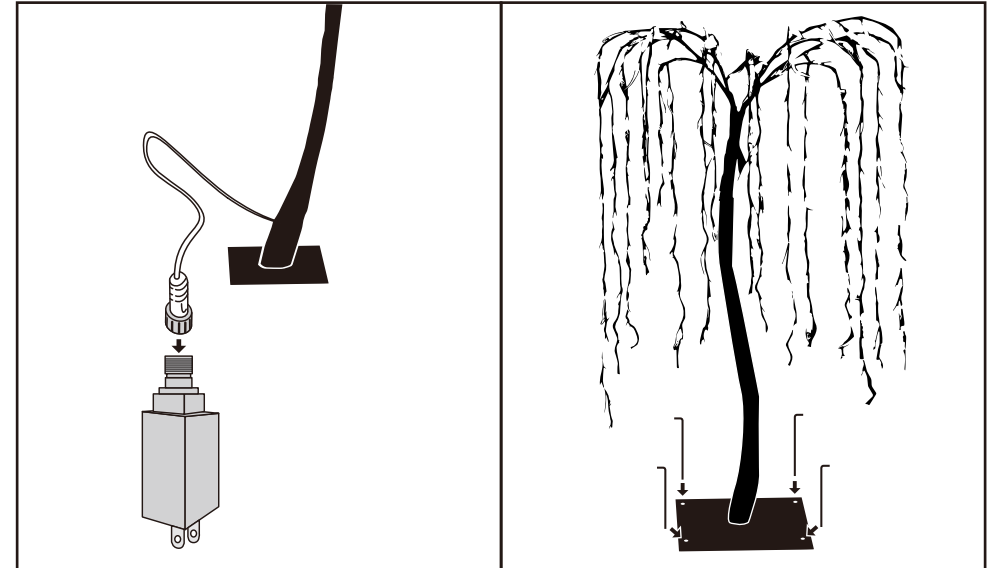

The tree can be shaped by bending and arranging the branches into desired position to give it a natural appearance!

IMPORTANT SAFETY INSTRUCTIONS

When in use outdoors, install only to a covered GFCI electrical outlet that is weather proof. Make sure the outdoor adaptor and cord are assembled correctly and secured tightly to prevent water from entering the device

1. Please read and follow all instructions and warnings both on the instructions and on the product carefully before use.
2. Retain these instructions for future reference.
3. This product is to be used only as intended its use.
4. For indoor/ outdoor use.
5. If used outdoors, connect the product to a Ground Fault Circuit Interrupting (GFCI) recep tacle.
6. Do not mount or place near gas or electric beaters, fireplaces, candles or other similar sources of heat
7. Do not secure the wiring of this product with staples or nails, or place on sharp hooks, nails or in a manner that can cut or damage the wire or insulation.
8. This is an electric product and not a toy! To avoid risk of fire, burns, personal injury and electric shock it should not be played with or placed where small children can reach it.
9. Do not close doors or windows on the product or extension cords as this may damage the wire and insulation.

WARNING!

- This product contains small parts that may cause suffocation if swallowed by children.
- Supervise children when using the lights, The product is not a toy
- Plastic bags can be dangerous. To avoid danger of suffocation, keep this bag away from babies and children.