

WC-04S

Wine Refrigerator

User Manual

SKU: FWC006-24BL-USZX

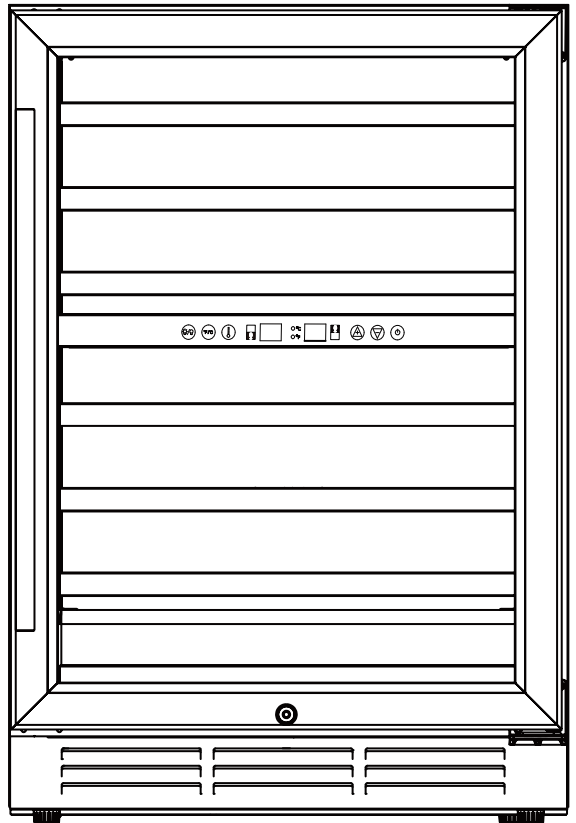

For Customer Service Support
Call: 1-833-632-0897
Email: support@homyd.com

THANK YOU FOR CHOOSING US

Thank You for Choosing Our Product

Thank you for choosing our product.

We sincerely appreciate your trust and support. Your satisfaction is our top priority, and we are committed to delivering high-quality products and attentive service.

If you have any questions or suggestions during use, please **DO NOT** hesitate to contact us. We are always here to assist you.

Contact Information

Email: support@homyd.com (Replies within 24 hours on business days)

Toll-Free: 1-833-632-0897 (Monday to Friday, 9:00 AM – 6:00 PM ET)

We hope this product brings ease and enjoyment to your daily life.

Warranty Statement

This product is covered by a limited warranty that protects against defects in materials and workmanship under normal household use.

If your product develops a fault after the return period of your purchase platform has ended, please contact us directly. We will do our best to assist you based on the warranty terms.

For warranty-related inquiries, please reach out using the contact details listed above.

Contents

Important Safety Instructions	02
Key Components and Structure	05
Control Panel And Display Ocerview	06
Installation	07
Cleaning and Maintenance	11
FAQs	13
Troubleshooting	14
Specs	17
Warranty Policy	18
Return Policy	19

IMPORTANT SAFETY INSTRUCTIONS

 To reduce the risk of fire, electrical shock, or injury when using your appliance, follow these essential safety precautions:

General Precautions

1. Read all instructions before using the appliance.
2. This appliance can be used by persons with reduced physical, sensory, or mental capabilities or a lack of experience and knowledge, **only** if they have been given supervision or instruction concerning the use of the appliance in a safe way and understand the hazards involved.

Child Safety

3. An empty wine refrigerator can be hazardous to children. If disposing of the appliance, remove doors and seals to prevent entrapment.
4. Never allow children to play with, operate, or crawl inside the appliance.
5. This appliance and its packaging are not toys and should be kept away from children.
6. Children must be supervised when using the appliance.

Installation & Placement

7. The appliance is designed for free-standing installation.
8. The appliance is designed for free-standing installation.
9. Please keep the unit in the upright position. **DO NOT** tip the unit.
10. Place your appliance on a hard, level floor that is strong enough to support it when fully loaded.
11. To level your appliance, adjust the leveling legs at the bottom of the appliance, if necessary.
12. Install the appliance in a well-ventilated area where the ambient temperature is between **50°F and 90°F (10°C - 32°C)**.
13. **DO NOT** install the appliance in direct sunlight or near any heat source.

Electrical Safety

14. This appliance must be properly grounded and connected to a suitable power outlet (**115 volts, 60Hz 15 amps**).
15. This unit must be positioned so that the plug is accessible. **DO NOT** run cord over carpeting or other heat insulators. **DO NOT** cover the cord. Keep the cord away from traffic areas, and **DO NOT** submerge it in water.
16. Never unplug the appliance by pulling the power cord. Always grip the plug firmly and pull straight out from the receptacle.
17. **DO NOT** plug or unplug power plugs with wet hands.
18. Use receptacles that cannot be turned off by a switch or pull chain.
19. **DO NOT** under any circumstances cut or remove the third ground prong from the power cord supplied.
20. **DO NOT** twist or pinch the power cord of the appliance.
21. **DO NOT** damage the power cord under any circumstances.
22. **DO NOT** operate this machine or any other appliance with a damaged power cord. If the power cord is damaged, it must be replaced by the manufacturer, its service agent or similarly qualified personnel to prevent a hazard.
23. Because of potential safety hazards, it is strongly recommended that you do not use an extension cord with this appliance. However, if you must use an extension cord, it is absolutely necessary that it be a UL-listed, 3-wire grounding type appliance extension cord having a grounding type plug and outlet and that the electrical rating of the cord be **115 volts** and at least **10 amperes**.

Usage Guidelines

24. **DO NOT** store or use gasoline or any other flammable vapors and liquids in the vicinity of this or any other appliance. The fumes can create a fire or explosion.
25. **DO NOT** store explosive substances in this appliance, such as aerosol cans with a flammable propellant.
26. **DO NOT** store perishable food, medicine, or other medical products.
27. **DO NOT** use electrical appliances inside the drink storage compartments of the appliance unless they are of the type recommended by the manufacturer.

28. **DO NOT** touch the cooled surfaces while the appliance is operating, especially with wet hands.

Maintenance and Cleaning

29. Before cleaning or performing maintenance, ensure the appliance is unplugged to prevent electric shock or death.
30. If the appliance will remain unused for an extended time, switch it off, defrost, clean, dry thoroughly, and leave the door open to prevent mold growth.
31. **DO NOT** attempt to repair or replace any parts of the appliance unless explicitly instructed in this user manual. All other servicing must be carried out by qualified service personnel.



Risk of Fire or Explosion-Flammable Refrigerant Used

Dispose of the appliance following federal or local regulations. Follow all handling instructions to ensure safe disposal.

DO NOT use mechanical devices to defrost the appliance.

DO NOT puncture refrigerant tubing.

Servicing must be performed by trained personnel only.

Clean and maintain the appliance regularly according to this manual's Cleaning & Maintenance section.

KEY COMPONENTS AND STRUCTURE

- 1.Top Hinge
- 2.Control Panel
- 3.Glass Door with Handle
- 4.Shelves
- 5.Lock
- 6.Leveling Legs
- 7.Air Outlet

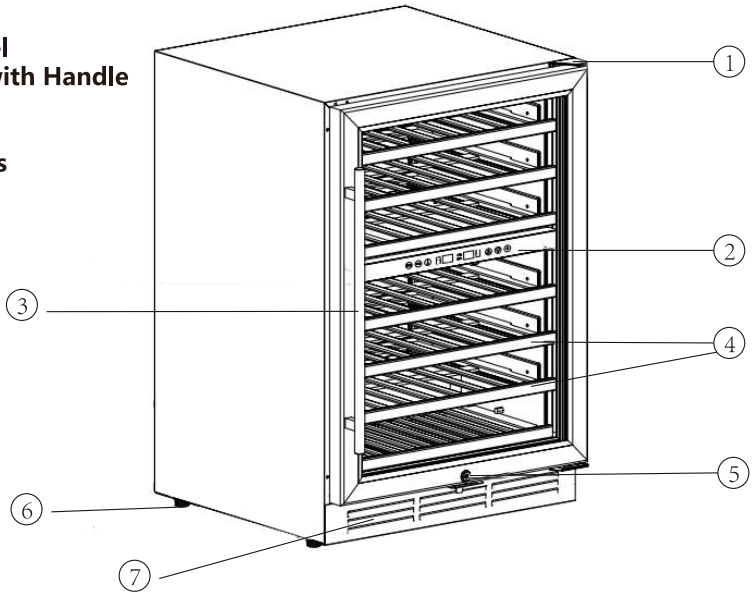

Accessories

2 x Keys

1 x Top Hinge

4 x Adjustable Leveling Feet (Extra)

6 x Plugs (for the Top and Bottom Screw Holes)

1 x Bottom Hinge

6 x Screws

Door Lock

This refrigerator is equipped with a lock and key system.

The keys are included in the plastic bag with the Instruction Manual.

To **lock** the door: Insert the key into the lock and turn it **clockwise** until the metal pin is fully engaged.

To **unlock** the door: Turn the key counterclockwise and open the door.

After use, **remove the key and store it in a safe place.**

CONTROL PANEL AND DISPLAY OVERVIEW



Button

Press the button once to turn the machine **ON**.

Press and Hold (3+ Seconds): Turn the machine **OFF**.



and



Button

Adjust Temperature: Press to increase or decrease by 1 degree per press.



Button

Press to begin adjusting the temperature for the upper or lower zone.

**The temperature can be adjusted between 5-13 °C (40-55 °F) for the upper zone and 13-18 °C (55-65 °F) for the lower zone.*



Button

Switch Temperature Units: Press button to toggle between Fahrenheit (°F) and Celsius (°C).



Button

Press once to switch the light **ON** or **OFF**.

If the lights are off, they will automatically switch on when you open the door and switch off when you close it.

** Please pre-cool the machine before first use.*

Recommended Storage Temperature

Wine Varietal	Fahrenheit/°F	Celsius/°C
Rose and Sparkling Wines	41-46	5-8
Dry/White Wines	48-53	9-12
Red Wines	59-65	14-18

INSTALLATION

If you plan on reversing the door hinges, **DO NOT plug the wine refrigerator into the power outlet.*

1. Setup the Wine Refrigerator

A. Unpack and Inspect

Remove all exterior and interior packaging. Confirm all accessories are included: Instruction Manual, Keys, Top Hinge, Bottom Hinge, Adjustable Leveling Feet, Screws, and Plugs. If anything is missing, contact our customer service. (email support@homyd.com or call us at +1-833-632-0897).

B. Prepare the Wine Refrigerator

Remove any tape securing the door and the inner cabinet. Clean the inner cabinet with a damp cloth.

C. Position the Wine Refrigerator

Place the unit on a level, flat surface, away from direct sunlight and heat sources (e.g., stove, furnace, radiator). **DO NOT** install the appliance where the temperature will go below **10°C (50°F)** or above **32°C (90°F)**.

Ensure a clearance of **5 cm (2 inches)** between the left/right sides and the wall. The front of the machine must be completely unobstructed.

D. Allow Refrigerant to Settle

If the unit was tipped during shipping or transport, let it sit upright for **24 hours** to allow the refrigerant to settle before plugging it in.

E. Plug Accessibility

Position the appliance so that the plug is easily accessible.

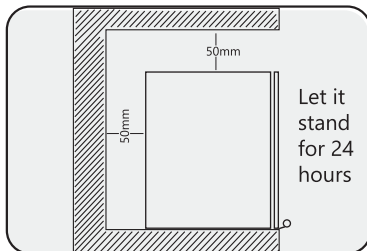

2. Install the Handle

- A. As illustrated in Figure 4.2.1, extract the gasket from the area where the handle is installed. The gasket can be easily removed manually without the need for tools.
- B. Align the handle with the pre-installed screws on the door frame. Tighten the screws with a screwdriver until the handle is securely fastened to the door frame, as depicted in Figure 4.2.2. (Avoid over-tightening to prevent damage to the handle assembly.)
- C. If changing the door opening direction, remove the plug from the right side and insert it into the hole on the left side.
- D. Reinstall the gasket to its original position.

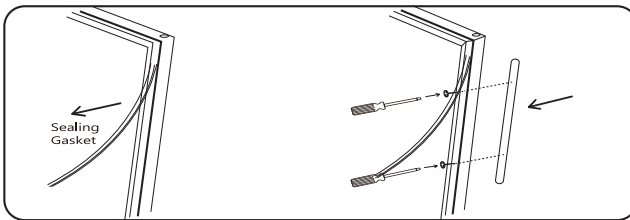

Fig 4.3.1

3. Reverse the Door Wing

The refrigerator is shipped with the door hinge brackets attached to the right side.

The door may be reversed to allow opening from the right side.

A. Prepare the Tools

Phillips screwdriver #2 and hex wrench.

B. Prepare the Wine Refrigerator

Remove the metal shelves before reversing the door. Use a sharp implement to lever out the plugs (there are three on the door frame, both at the top and bottom, and another one on the door). If the plastic plugs are broken, discard them. The holes to move the hinges are already pre-drilled.

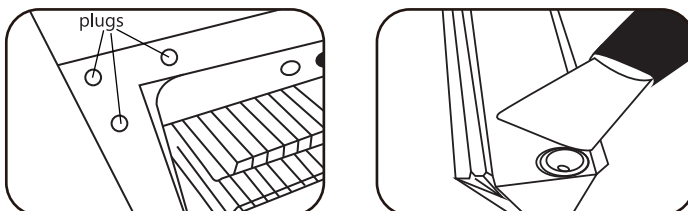

Fig 4.3.2

C. Take Off the Door

Please commence disassembly solely from the bottom of the door, following the steps below:

- 1) Lay the wine cabinet flat or tilted with the door facing upward to change its opening direction.
- 2) Use a hexagonal screwdriver to remove the two screws connecting the door, as shown in the Figure 4.2.3. Be cautious not to lose the metal anti-slip washers in between.

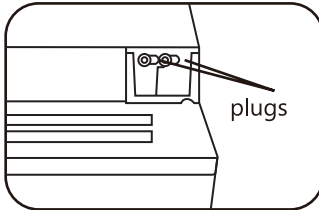

Fig 4.3.3

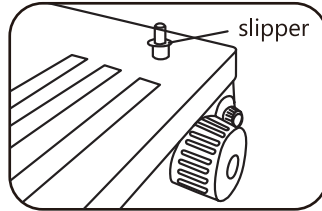

Fig 4.3.4

- 3) Lift slightly as depicted in the illustration to extract the connecting piece between the door and the hinges (i.e., lift from the hinge pin).

Note: Ensure the preservation of the connecting piece under the door and hinges, for they will be required for subsequent steps.

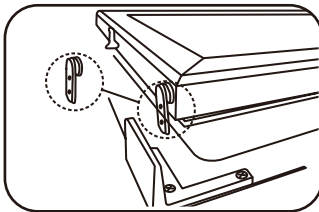

Fig 4.3.5

- 4) Tilt the door (as shown in the Figure 4.2.6) slightly to detach it.

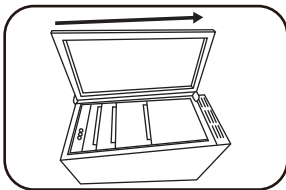

Fig 4.3.6

D. Install the Door on the Opposite Side:

a. Use a Phillips screwdriver to disassemble the hinge brackets from the machine (save the removed screws for the next step).

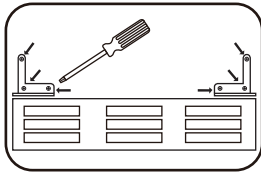

Fig 4.3.7

b. Use the screws removed earlier to affix the left hinge brackets, found in the accessories, to the door frame on the opposite side of the machine.

c. Transfer the saved connecting piece (shown in Fig. 4 .3.8) to the underside of the door on the opposite side.

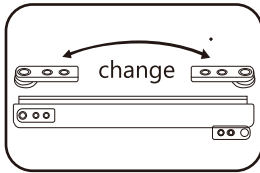

Fig 4.3.8

d. Incline the door and insert it onto the hinge bracket above the machine.

e. Proceed to move the lower part of the door into the hinge bracket pin.

f. Secure the two hex screws for the lower hinge bracket, ensuring that you do not lose the intermediary metal anti-slip washers.

g. Insert the plugs removed in the second step into the holes on the side from which the door was removed.

E. Settle Down the Refrigerant

Wait at least **24 hours** before plugging in the refrigerator to allow the refrigerant to settle down. Then plug in the unit.

CLEAN AND MAINTENANCE

1. Clean the Wine Refrigerator Before First Use

1. If using the refrigerator for the first time, it is best to clean the inside before stocking it with drinks. Proceed to Step 3.
2. Unplug the wine refrigerator and empty the contents of the machine.
3. Create a cleansing mixture by dissolving 3-4 tablespoons of baking soda in warm water.
4. Moisten a sponge or a gentle cloth with the solution and use it to clean the wine refrigerator.
5. Rinse with fresh, warm water, then gently pat dry with a soft cloth.
6. It is imperative to maintain the cleanliness and suppleness of the gaskets to guarantee an effective seal. Adhere to the general guidelines to cleanse the door gaskets every three months. A light application of petroleum jelly on the hinge side of the gaskets will preserve their suppleness and ensure a secure seal.
7. Reconnect the wine refrigerator once the unit is clean and dry.

CAUTION:

1. It is recommended to clean the wine refrigerator at least once a quarter to maintain good performance and hygiene.
2. **DO NOT** use harsh chemicals, abrasives, ammonia, chlorine bleach, concentrated detergents, solvents, or metal scouring pads; some of these substances may erode, damage, and/or discolor your wine refrigerator.
3. **DO NOT** use hard brushes, wire brushes, abrasives, organic solvents, boiling water, acid, or alkaline items, as this may damage the surface and interior of the wine refrigerator.

2. Defrost the machine

1. Empty the machine. Unplug the unit to allow the frost to melt. (**DO NOT** use mechanical devices or non-manufacturer-recommended methods to speed up defrosting.)
2. Allow the frost to melt naturally. Ensure the internal drain is not blocked.
3. During defrosting, the melted frost will flow through the internal drain tube into the drip tray located above the compressor. The heat from the compressor will help evaporate the water. (If the drip tray becomes too full, it must be emptied manually.)

4. Clean the interior using warm water and a soft cloth. Dry thoroughly, reset the temperature, and allow the unit to cool for **2 hours**.
5. Reload wines and adjust to your desired temperature.

3. Storage For Holidays and Relocation

1. For extended holidays or when the wine refrigerator is empty, unplug the power cord and clean both the interior and the door seal.
2. Keep the door open to ensure proper air circulation.
3. Place the appliance in the coolest area of the room, away from heat sources and direct sunlight.
4. When moving the wine refrigerator, always keep it upright and avoid laying it flat.

CORRECT DISPOSAL OF THIS PRODUCT



When the unit is taken out of service, its disposal and the handling of its materials must comply with national regulations.

FAQs

1. What are the warranty specifications?

We provide a 12-month warranty and lifetime technical support for this item. If you would like to learn more, please contact our customer service team.

2. Can the shelves inside the Wine Refrigerator be moved?

The shelves inside the Wine Refrigerator are adjustable and can be moved.



3. Does it keep food securely cold?

This Wine Refrigerator is primarily designed for storing drinks, especially for chilling wine, beer, and other beverages. It features different temperature settings to keep drinks at their ideal temperatures.

For food items that need to be frozen, we recommend the safest practice is to use a freezer that is specifically designed for food storage.

TROUBLESHOOTING

Problem	Possible Cause(s)	Solution
The appliance does not run.	The appliance may not be plugged in, or the plug may be loose.	Ensure the appliance has been plugged in properly.
	The appliance is turned off.	Press  to turn on the appliance.
	The house fuse has blown, or the circuit breaker has tripped	Check/replace fuse.Reset circuit breaker.
The appliance does not operate.The appliance is not cold enough.	The external environment may require a higher setting.	Set a colder setting. Allow several hours for the temperature to stabilize.
	The appliance has recently been disconnected for a period of time.	It takes 3-4 hours for the appliance to cool down completely.
	Prolonged or frequent door openings.	Open the door less often.
	The door is not closed completely.	Close the door properly.
	The door gasket does not seal properly.	Check the door gasket. Clean or change the gasket if necessary.
The compressor turns on and off frequently.	The room temperature is hotter than normal.	It's normal for the appliance to work harder under these conditions.
	A large amount of content has been added to the appliance.	A large amount of content causes the appliance to run longer until the desired temperature is reached.
	Prolonged or frequent door openings.	Open the door less often.

Problem	Possible Cause(s)	Solution
	The temperature has not been set correctly.	Press either  or  to check the set temperature, and set the temperature properly.
	The door is not closed completely.	Close the door properly.
	The door gasket does not seal properly.	Check the door gasket. Clean or change the gasket if necessary.
The light does not work.	Not plugged in.	Plug the appliance in.
	The circuit breaker tripped, or a fuse blew.	Check the breaker and/or fuses.
	The light button is "OFF".	Press  to turn the light ON.
Appliance vibrates.	The appliance is not level.	Check that the appliance is level.
	The bottles are vibrating.	Make sure the bottles don't touch each other.
	There is an object under the appliance.	Remove the object under the appliance.
The appliance seems to make too much noise.	The appliance is not level.	Level the cooler.
	Normal noise from the flow of the refrigerant.	The rattling noise may be caused by the flow of refrigerant, which is a normal occurrence. As each cycle ends, you may hear gurgling sounds caused by the flow of refrigerant in your appliance. Contraction and expansion of the inside walls may cause popping and cackling noises.

Problem	Possible Cause(s)	Solution
The door will not close properly.	The appliance is not level.	Level the appliance.
	The door was reversed and not properly installed.	Reinstall the door properly.
	The gasket is dirty.	Clean the door gasket.
	The shelves are out of position.	Place the shelves properly.
Moisture buildup on the interior or exterior of the appliance.	This is normal during high-humidity periods.	Lower the room humidity.
	This is normal in high-temperature environments.	Move the appliance to a cooler location, and avoid exposure to heat and sunlight.
	Prolonged or frequent door openings.	Open the door less often.
	The door does not seal completely.	Check door gaskets for proper seal.
Error Code: E1-E2-E3-E4-E7-E8	A sensor has failed.	Contact customer service.
Received the product damaged or with missing accessories.	Possible damage caused during shipping.	In this situation, contact our customer service team. They will be more than happy to assist you in resolving the issue.
The item was received with the outer box placed upside down.	The item was received with the outer box placed upside down. It may have been caused by the staff responsible for delivering the package accidentally.	Please don't worry! Just be careful when opening the outer box to check for any damage. Once you have the refrigerator out, please let it sit for 24 hours before plugging it in. If you have any issues, feel free to reach out to our customer service team at any time. We're here to help!

SPECS

FWC006-24 Wine Refrigerator	
SKU	FWC006-24BL-USZX
MODEL	WC-04S
Voltage/Frequency	115V~60HZ
Refrigerant	R600a, 1.06 Oz/30g
Rated Current	1.4 A
Product Dimensions	23.4*22.4*34.3 inches
Net / Gross WEIGHT	94.8/115.74 lbs

WARRANTY POLICY

1-Year Limited Warranty

Toll-Free Call: 1-833-632-0897 Mon to Fri, 9AM - 6PM (ET)

Email: support@homyd.com

Thank you for choosing our products. We provide a 1-Year Limited Warranty for items purchased through our official channels. Please kindly note that this warranty is for the original purchaser and is non-transferable. If you purchase from an unauthorized seller, please get in touch with them directly.

We are committed to ensuring that our products are free from defects in materials and workmanship for one year from the date of purchase, as long as they are used under normal household conditions and maintained according to the User Manual. **Please note that certain conditions and exclusions apply:**

Should you find any defects in the original product or its non-wearable parts, we will be happy to repair or replace the item within one year of purchase. If a replacement is necessary, the warranty period will continue from the original purchase date. Please be aware that normal wear and tear, or damage due to mishandling, accidents, or failure to follow instructions, are not covered. However, replacement parts are available for purchase. Feel free to contact us for more information.

Please also note that this warranty does not cover damage caused by exposure to liquids or foreign materials, unauthorized repairs or modifications, or use in commercial or non-household environments (unless specified for commercial use).

If you encounter any issues with your product, we are here to help. You can reach us by phone at **1-833-632-0897** or email us at **support@homyd.com**. For certain product categories, we also offer the option to upgrade your warranty to our VIP service.

Our friendly phone support team is available from **Monday to Friday, 9 AM - 6 PM (ET)**.- To assist you more efficiently, please have your product with you when you call. Besides, we aim to respond to emails within 24 business hours. If you don't receive a reply within this timeframe after sending us an email, kindly check your spam folder to ensure you don't miss our response.

In addition to the one-year warranty, we also offer lifetime technical support. After the warranty period, service is still available at an additional cost. Please don't hesitate to contact us with any questions or concerns.

RETURN POLICY

We offer a 30-day return policy for purchases made directly through our company. This policy is separate from and does not override the return policies of third-party platforms.

Return Eligibility

Items must be returned within 30 days of purchase.

Products should be in new or like-new condition, with original packaging and all accessories (manuals, handles, keys, etc.).

Returns not related to quality issues will require the buyer to cover return shipping costs, which will be deducted from the final refund.

How to Initiate a Return

Contact our customer service team for return authorization.

Provide the following information:

Proof of purchase (e.g., screenshot with platform name, order number, date, item, and amount)

After approval, we will send a return shipping label. Attach it to the product box and return via the designated carrier.

Once we receive and inspect your return, we will process your refund within **2–3 business days** (excluding original processing or handling fees).

***Note:**

- Returned products that are damaged or missing parts may not qualify for a refund.
- This return policy does not affect your warranty rights.
- For details, please refer to the “Return Policy” section of this manual or the return policy on your purchase platform.

SKU: FWC006-24BL-USZX

