

Assembly Instructions

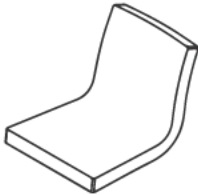

A (1 pc)



B (1 pc)



C (1 pc)



D (1 pc)



E (2 pcs)
1x25mm



F (2 pcs)
1x16mm
07.06.18 dd



G (4 pcs)



H (3 pcs)
1.25x35mm

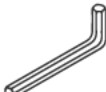

I (1 pc)
4mm



J (1 pc)
5mm

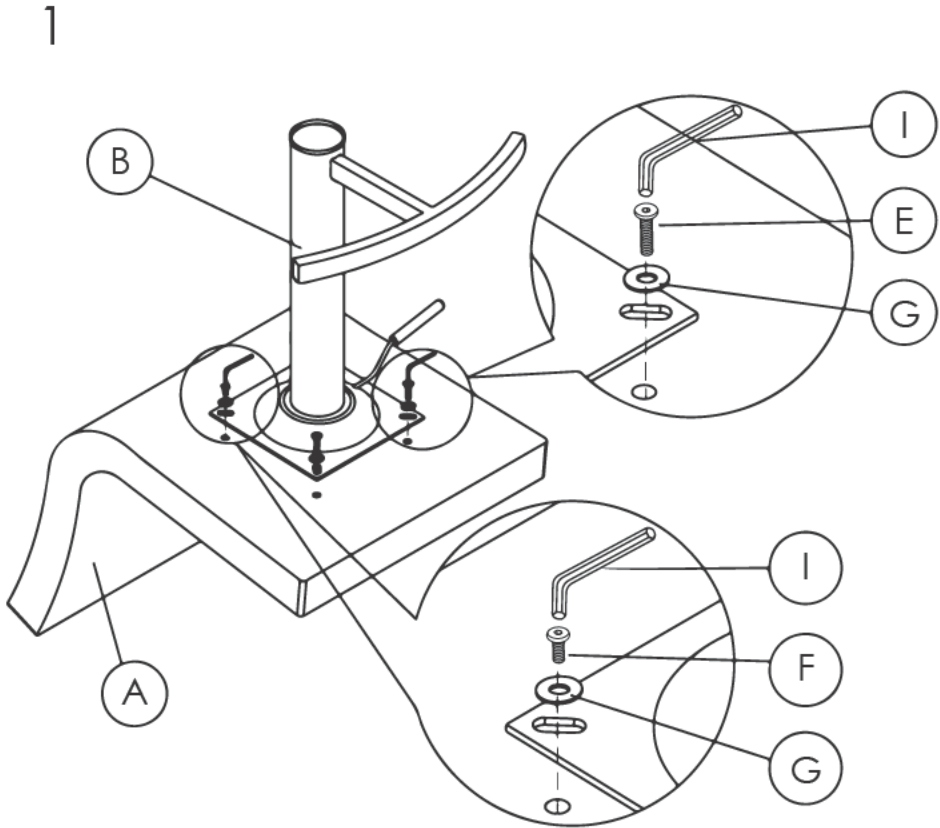

During assembly, hand tighten screws only. When the screws are in place, tighten completely.

Assembly Instructions

2

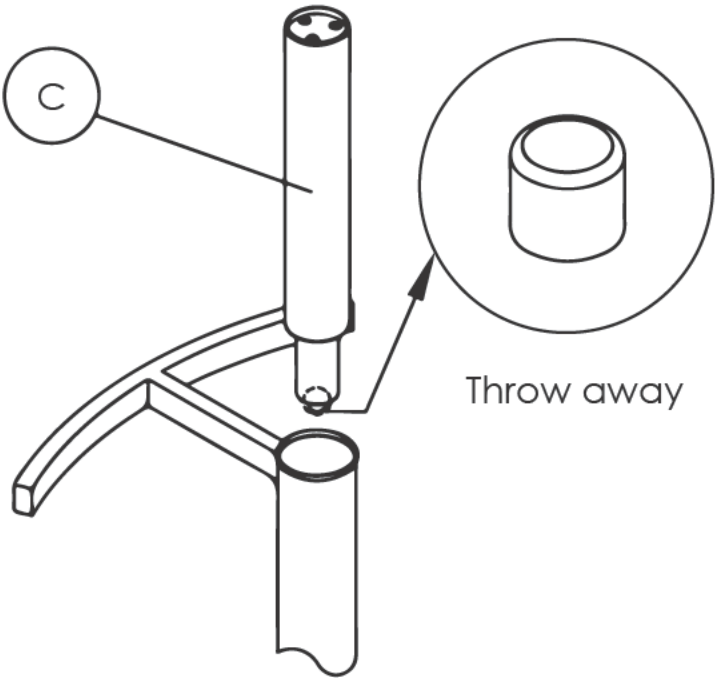

3

