

Cautions

- Before use, check that your mains power supply corresponds to the voltage shown in this manual (also shown on the rating plate of the appliance, located under the base).
- Always keep the appliance out of the reach of children.
- The appliance is not intended for use by persons (including children) with reduced physical, sensory or mental capabilities or lack of experience or knowledge, unless they have been given supervision or instruction concerning use of the appliance by a person responsible for their safety.
- This appliance is not intended to be operated by means of an external timer or a separate remote-control system.
- Do not let the Power Cable ❷ hang over the edge of the counter or work-top, or let it touch hot surfaces.
- Do not put the appliance into a heated oven.
- Do not place the Inner Pot ❸ directly over any other heat source for cooking.
- Do not move the appliance,when operating.
- Surfaces of the appliance, especially the Cooker Lid ❷ will become hot in use.
- The Inner Pot ❸ will be HOT when removed after cooking. Always wear oven gloves or use an oven cloth when moving hot cookware.
- Do not use the Mini Rice Cooker for any other purpose other than the one for which it is intended.
- Damage will occur if the unit is used to cook without water. Do not overfill.
- Before each use, check that the Steam Vent ❹ is not obstructed.
- Do not approach the Steam Vent ❹ during cooking - there could be a scalding hazard.
- Never use the unit for shallow or deep frying of food.
- Before use, ensure that the heating plate and the bottom of the Inner Pot are clean and dry. The outside of the Inner Pot ❸ should also be clean and dry.
- The cooker must be placed on a flat and stable surface.
- Do not drop the cooker.
- Handle the Inner Pot with care to avoid knocks which could dent or distort it. If the pot has become dented or distorted do not use it; contact Judge at the address given beneath the warranty statement.
- Do not place the Mini Rice Cooker near any other heat source as this could lead to distortion.
- This appliance must be plugged into an earthed socket rated at over 10A.
- Do not share a socket with other appliances, as it may overheat and cause a fire.
- Do not immerse the plug or cooker in water or other liquids.
- Unplug the cooker when not in use.
- Allow the cooker to cool before attaching or detaching any parts.
- Do not use accessories from any other manufacturer’s appliance.
- Do not use outdoors.
- If the mains supply cable becomes damaged, contact Judge at the address given beneath the warranty statement.
- Do not tamper with any of the safety systems beyond the maintenance instructions specified.
- Do not attempt to repair the unit. In case of breakdown return it to Judge at the address given beneath the warranty statement.

Specification

Name	Model No.	Cooking Capacity	Rated Wattage	Rated Frequency	Rated Power
Mini Rice Cooker	JEA63	0.3L	200-238W	50/60Hz	220-240V



Judge 2 Year Domestic Electrical Guarantee

- The Judge 2 Year Domestic Electrical Guarantee covers the product to be free of defects in materials and workmanship for a period of TWO YEARS from the date of original retail purchase.
- During this period, JUDGE will, at their option, repair or replace defective parts of the product, or replace the product, providing the Use Care and Safety Advice have been followed.
- The Guarantee does not cover damage, defect or failure caused by or resulting from accidents, external damage, alteration, modification, abuse, misuse or misapplication.
- The Guarantee does not cover any damage caused by taking the appliance apart yourself, or attempting to repair the appliance yourself.
- **THE PRODUCT IS INTENDED FOR DOMESTIC USE ONLY.**
- Please keep your Purchase Receipt and contact us directly if you encounter any problems with your product.

HORWOOD SHALL NOT BE LIABLE FOR INCIDENTAL OR CONSEQUENTIAL DAMAGES RESULTING FROM THE USE OF THIS PRODUCT (INCLUDING COLOUR FADING, SCRATCHES OR ACCUMULATED DIRT) WITHOUT FOLLOWING THE USE, CARE & SAFETY INSTRUCTIONS.

Note: Due to the introduction of improvements from time to time, the right is reserved to supply products which differ slightly from those illustrated and described in this publication.

Errors and Omissions Excepted.

 **JUDGE**
CUSTOMER SERVICES
Horwood, Avonmouth Way,
Bristol, BS11 9HX, Great Britain

www.judgcookware.co.uk

customerservice@horwood.co.uk

Tel: 0117 940 0000



FOR DOMESTIC USE ONLY

CORRECT DISPOSAL OF THIS PRODUCT



This marking indicates that this product should not be disposed with other household wastes throughout the EU. To prevent possible harm to the environment or human health from uncontrolled waste disposal, recycle it responsibly to promote the sustainable reuse of material resources. To return your used device, please use the return and collection systems or contact the retailer where the product was purchased. They can take this product for environmental safe recycling.



Mini Rice Cooker

Model No: JEA63



Please read this instruction manual carefully before use and save for later reference.

V002

UNPACK YOUR MINI RICE COOKER CAREFULLY AND REMOVE PACKING PIECES, LABELS AND STICKERS BEFORE USE.

Features

Your Judge Mini Rice Cooker will prepare rice in such a way that the rice is excellent to eat, while retaining the highest possible nutritional value. Slight pressure cooking, combined with a high cooking temperature, ensures that the best flavour is extracted from the rice. The cooker is very energy efficient. As soon as the the rice is cooked, the unit will stop cooking and switch to Keep Warm mode - the rice will keep warm for up to 6 hours.

Identifying the parts of your Judge Mini Rice Cooker

- ① Cooker Body

② Cooker Lid

③ Inner Pot

④ Inner Pot Lid (JEA63IP)

⑤ Lid Catches

⑥ Cook Button
- ⑦ “Cook” Light

⑧ “Warm” Light

⑨ Steam Vent
- ⑩ Ladle (JEA63L)

⑪ Measuring Cup (JEA63MC)

⑫ Power Cable (JEA63PC)

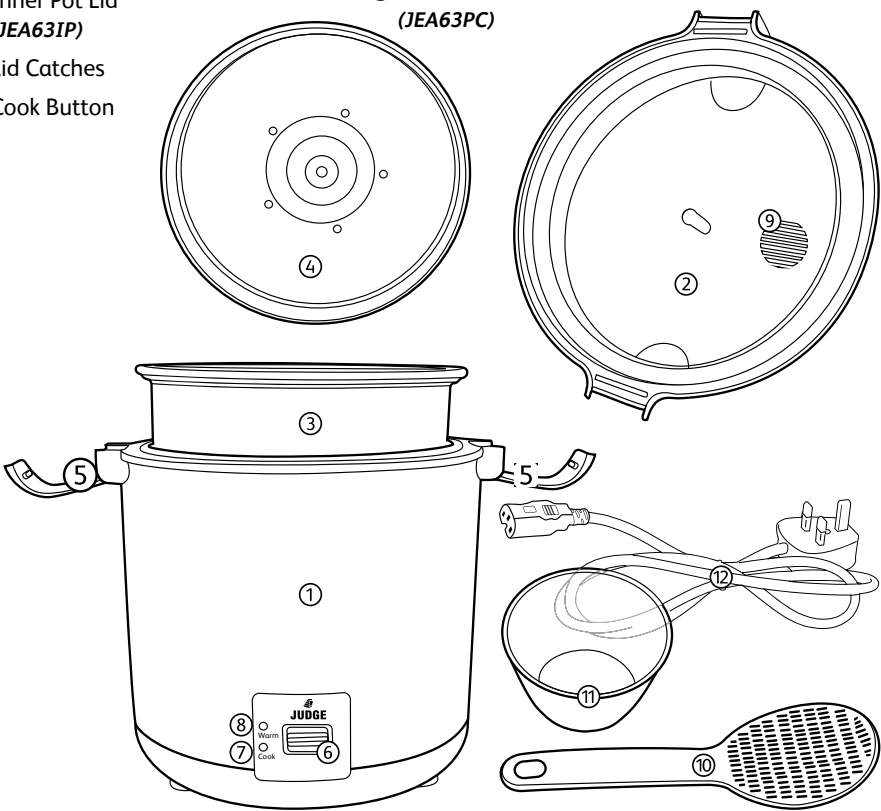

Before First Use

Take out the Inner Pot ③ and Inner Pot Lid ④, wash in warm soapy water, rinse and wipe dry with a cloth. Replace.

- Note that the Inner Pot Lid ④ should be attached to the underside of the Cooker Lid ②.

Preparation Before Use

- Measure your rice using the Measuring Cup ⑪. Rinse the rice in cold water and place into the Inner Pot ③.
 - One Measuring Cup ⑪ of rice is approx. 150g - note this will vary according to the type of rice being used.
- Add water.
 - The inside of the Inner Pot ③ has a scale that is a guide as to the level of water to add for a particular amount of rice. If you have placed 1 Measuring Cup ⑪ of rice in the Inner Pot ③, add water to the rice until the water level, including the rice, is approximately at the “1 CUP” mark on the scale. Personal taste and the type of rice affect the amount of water required; the table below indicates how the amount can be varied from the CUP marks on the scale. There is also a scale in litres (0.1 to 0.3); remember, this is a guide to the water level for the amount of rice, not a measure of the volume of the Inner Pot ③.
 - Do not exceed the maximum water level mark (1.5 Cup / 0.3 litres) on the Inner Pot ③ scale. Too much water will cause the Mini Rice Cooker to overflow.

Rice in Inner Pot ③	Add water to level mark in Inner Pot ③
0.5 cup	0.5 - 1 CUP
1 cup	1 - 1.5 CUP (MAX)
1.5 cups	1.5 CUP (MAX)

- Wipe the outer surface of the Inner Pot ③ and place in the Cooker Body ①. The pot will be held away from the heating plate by a spring-loaded central plate until the Cooker Lid is closed.
- Ensure the Inner Pot Lid ④ is attached to the underside of the Cooker Lid ②.
- Attach the Cooker Lid ② placing it on top of the Cooker Body ① and securing with the Lid Catches ⑤ (you will hear a “Click” sound).

Using The Cooker

- Make sure the Cooker Lid ② is attached properly If the lid is not closed correctly, cooking will be affected.
- Plug in the Power Cable ⑫ and connect to the power socket. The “Warm” Light ⑧ will illuminate.
- Press the Cook Button ⑥ down. The “Cook” Light ⑦ will illuminate and the cooking process will start.
- When the rice is cooked, the Cook Button ⑥ will move back to the ready position automatically, making a “Click” sound and the the “Cook” Light ⑦ will switch off. The “Warm” Light ⑧ will illuminate, showing that the cooker is keeping the rice warm.
 - For best results, when cooking has finished, let the rice stand in the cooker in ‘Keep Warm’ mode for 15 minutes, then stir.
 - As a guide, 1 cup of white rice (approx. 150g) will take approximately 10-15 minutes to cook, and should be left to stand for at least 15 minutes. Cooking times will vary according to the type and quantity of rice/water used.
- If you do not need to keep the rice warm after cooking, unplug the unit and remove the Inner Pot ③. Do not pull the Power Cable ⑫.

Removing the lid and serving

- CAUTION: Always use a heat/steam resistant cloth or oven gloves to protect your hands when removing the Cooker Lid ②.
- After the appropriate standing time unclip both Lid Catches ⑤ .
 - Carefully lift away the Cooker Lid ②.
 - Use the Ladle ⑩ to seperate the rice grains
 - Serve using the supplied Ladle ⑩.

Cleaning

- Take out the Inner Pot ③ and wash in warm soapy water, rinse and wipe dry with a cloth. Replace.
- Rice may stick to the heating plate and Inner Pot Lid ④. You may use a damp nylon scourer to clean it. Wipe with a dry cloth.
- After each use it is advisable to remove the Inner Pot Lid ④ by gently pulling away from the Cooker Lid ② and rinse thoroughly.

Tips

- Brown rice or wild rice cooks perfectly, and the cooker self regulates the cooking time (for some larger grains of rice can take up to 1 hour).
- Experiment with different rice types, or mix coconut milk with the water for a delicious coconut rice.

Troubleshooting & Repair

Fault		Possible causes	Solutions
Indicator does not illuminate	Heating plate does not heat	1. Power is not connected	Check the switch, socket, fuse, Power Cable and circuit breaker at Consumer Unit
	Heating plate heats up	1. The indicator or associated circuit is faulty	Contact Judge Customer Services
Indicator illuminates	Heating plate does not heat	1. Heating circuit is faulty 2. Element is burnt-out	Contact Judge Customer Services
Rice is uncooked or taking too long to cook		1. The rice has not cooked for long enough 2. Heating plate is distorted 3. Foreign objects between Inner Pot and heating plate 4. Inner Pot is distorted	1. Ensure that the appropriate rice:water ratio is being used. Refer to the ‘Operating Instructions’ 2. Contact Judge Customer Services 3. Clean with a nylon scourer 4. Contact Judge Customer Services
Rice is burnt or will not keep warm automatically		1. Cook Button has broken 2. Temperature control circuit is faulty	Contact Judge Customer Services