

Assembly Instruction

Advice:

- 1.Power tools are suggested to be used during installation.
- 2.More than one person may be required to assemble this product.
- 3.The best advice is not tightening up any screws until the whole piece is assembled.If having difficulty aligning holes,loosen the screws already installed and readjust the armrest.
- 4.To avoid mess-up or mismatch,please use the hardware of each box to install the furniture in the same box.

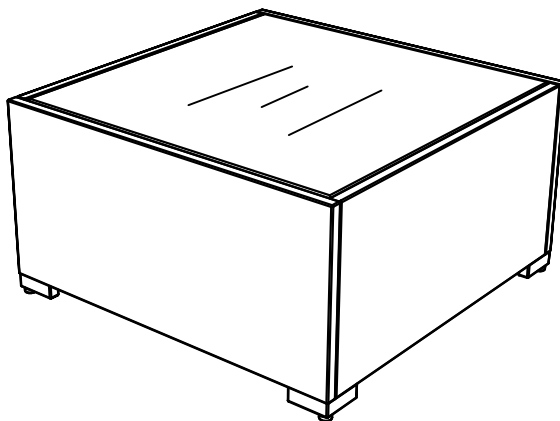

Table



Assembly Video

Parts List

Part Number	Picture	Description	QTY
T-A		Long Side Panel	2
T-B		Short Side Panel	2
T-C		Glass Top	1
N		Washer (M6)	8
V		Screw (M6*35)	8
X		Screw (M6*25)	8
L		Allen Key	1
E		L Shape Foot	4

STEP 1

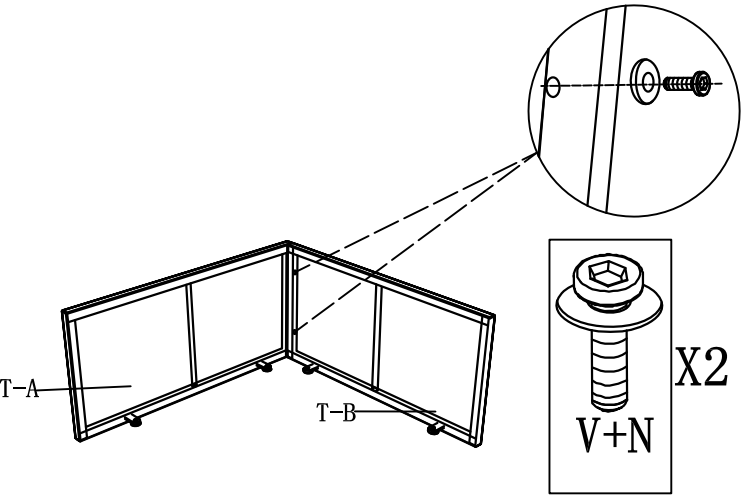

STEP 2

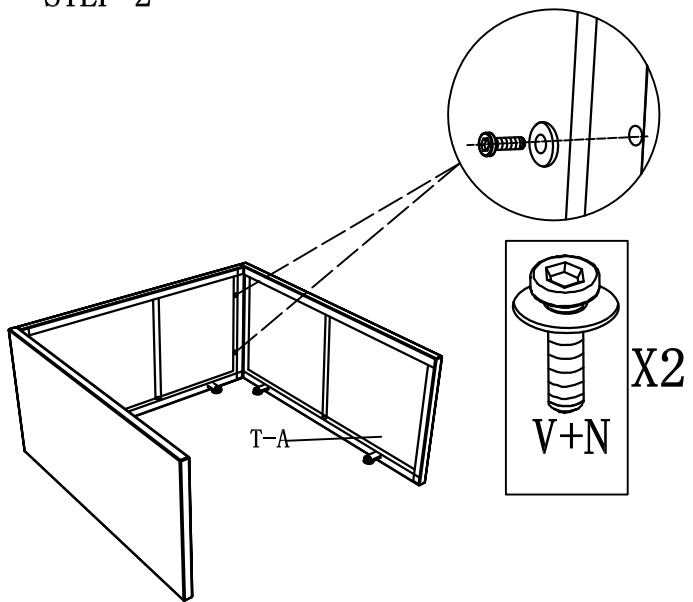

The best advice is not tightening up any screws until the whole piece is assembled.

STEP 3

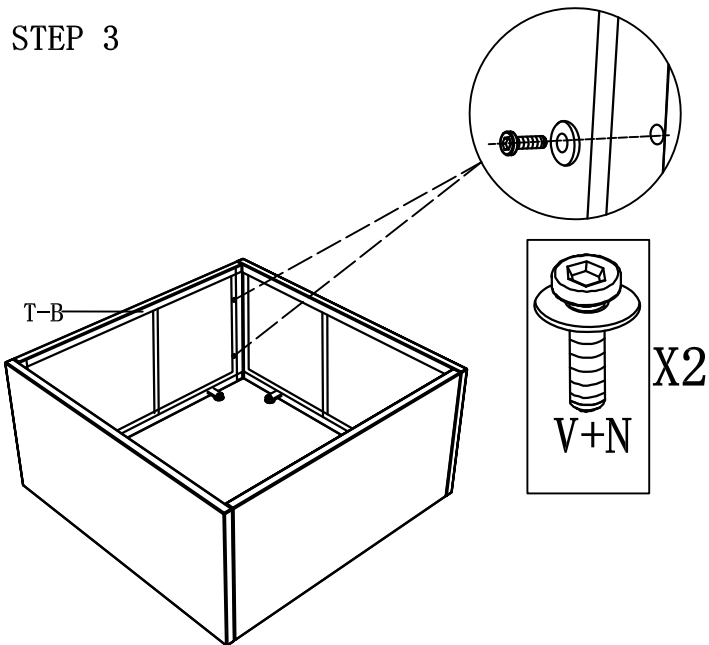

STEP 4

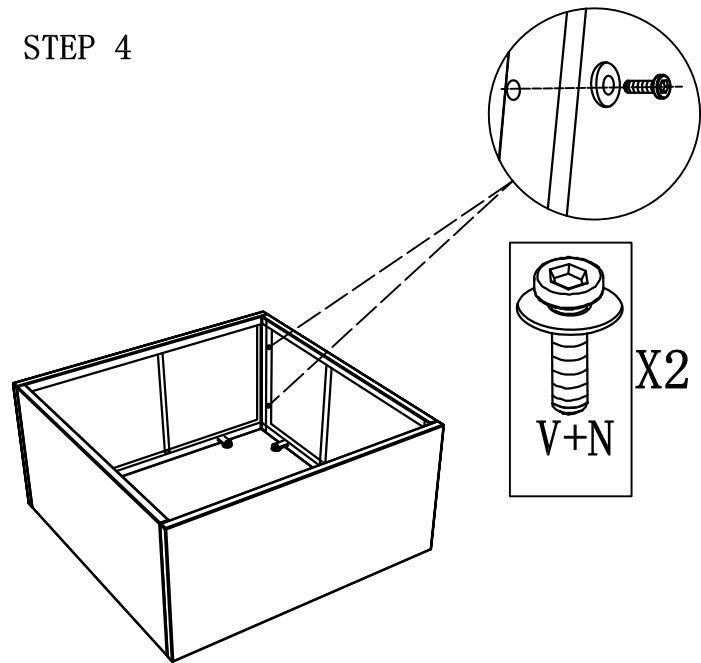

STEP 5

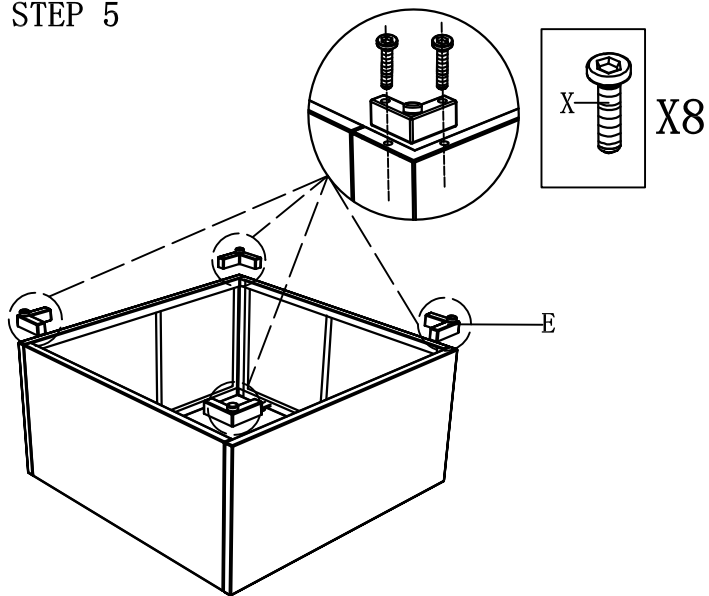

FINISH

