

## SLIDING DOORS TERRARIUMS INSTRUCTION MANUAL

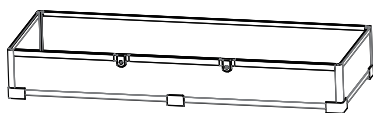

### PARTS LIST



Base

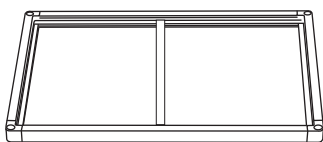

Top Frame

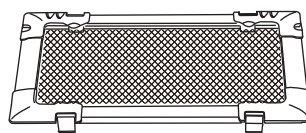

Top Cover (2)

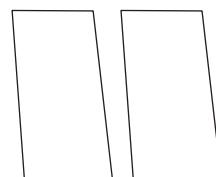

Side Glass (2)

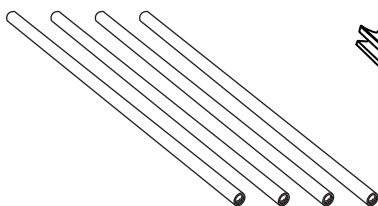

Tubes (4)

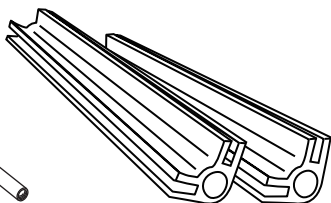

Back Supports (2)

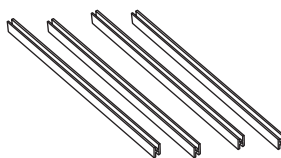

H-Slot (4)



Back Glass (3)



Glass Doors (3)



Screwdriver



Gloves



General Key(2)



Rubber Caps (4)



Screws (4)



Cable Hole Covers (12)

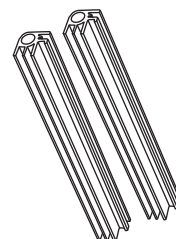

Front Supports (2)

# ASSEMBLY INSTRUCTIONS

**Note: 2 ADULTS ASSEMBLY REQUIRED - IN CASE THE BREAK OF GLASS.**

## 1. Install Tubes

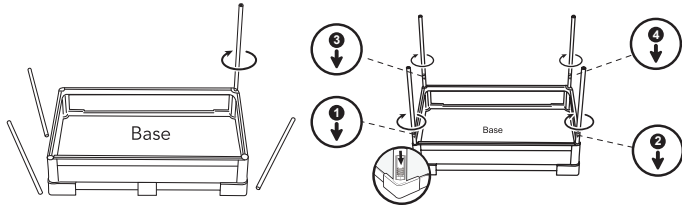

## 2. Install Back Supports and Front Supports

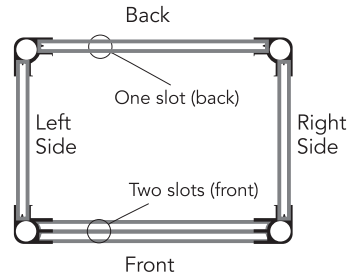
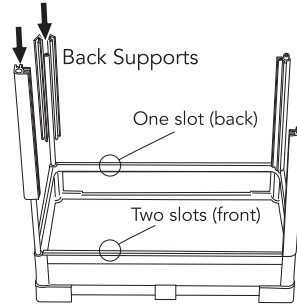

## 3. Install back glass and side glass

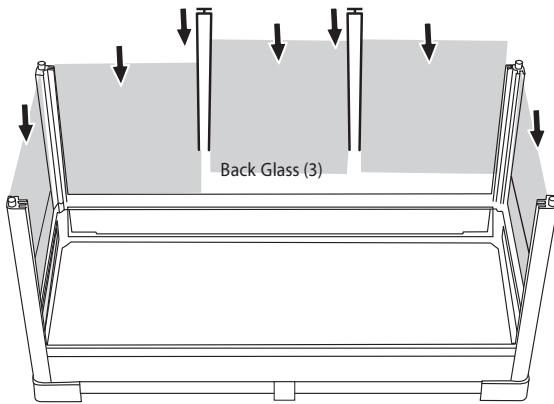

## 4. Install the front glass doors

★ In order to avoid any damages, you must install any of 2pcs glass doors into the inner and outer slot as FIG.A and FIG.B to the right side, then install the third glass door into the outer slot as FIG.C to the left side.

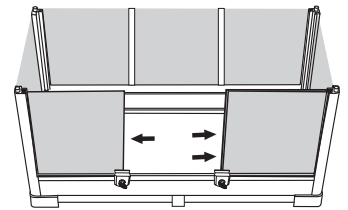
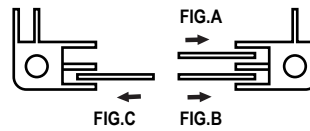

## 5. Install top frame and screws

Please use your screwdriver to tighten the screws first, then lock the key.

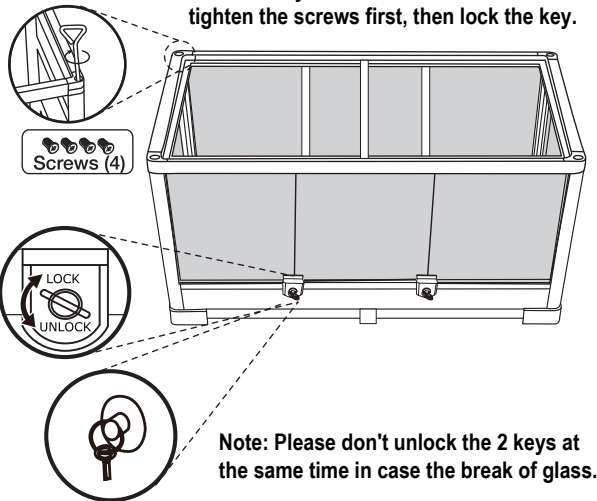

## 6. Install Top Cover and Rubber Caps

★ Do not open the doors together in case the break of glass.

