

# MANUAL TRASH COMPACTOR - MTC-30

APPROX WEIGHT: 157.80 lbs.  
DOES NOT INCLUDE WEIGHT OF POWER OR PACKAGING!!!

\*\*\* ANY ADDITIONS, DELETIONS, OR OMISSIONS MUST BE CORRECTED ON THIS DRAWING AS THIS DRAWING WILL BE CONSIDERED ALL INCLUSIVE \*\*\*

ALL GRAPHICS PROVIDED ARE FOR REFERENCE ONLY. IF CERTAIN DIMENSIONS ARE CRITICAL PLEASE VERIFY THOSE DIMENSIONS WITH YOUR SALESPERSON

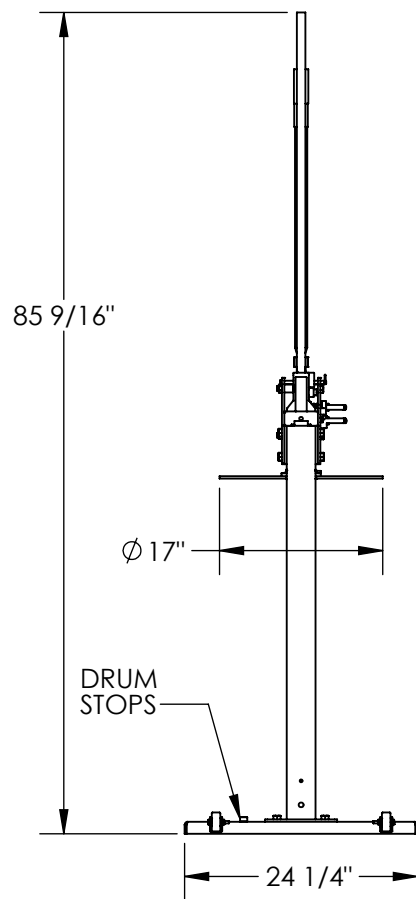

## STANDARD FEATURES

MODEL NUMBER: MTC-30  
OVERALL WIDTH: 32 1/16"  
USABLE WIDTH: 25 3/8"  
OVERALL LENGTH: 24 1/4"  
USABLE LENGTH: 24 1/4"  
OVERALL HEIGHT: 85 9/16"  
SERVICE RANGE: 1 1/4" TO 35 3/4"  
COMPACTOR HEAD: 17"  
7,000 LBS OF COMPACTING FORCE  
WHEELS: RUBBER - 2"  
TOUGH BAKED IN POWDER COATED BLUE FINISH  
DRUM USED: 30 GALLON

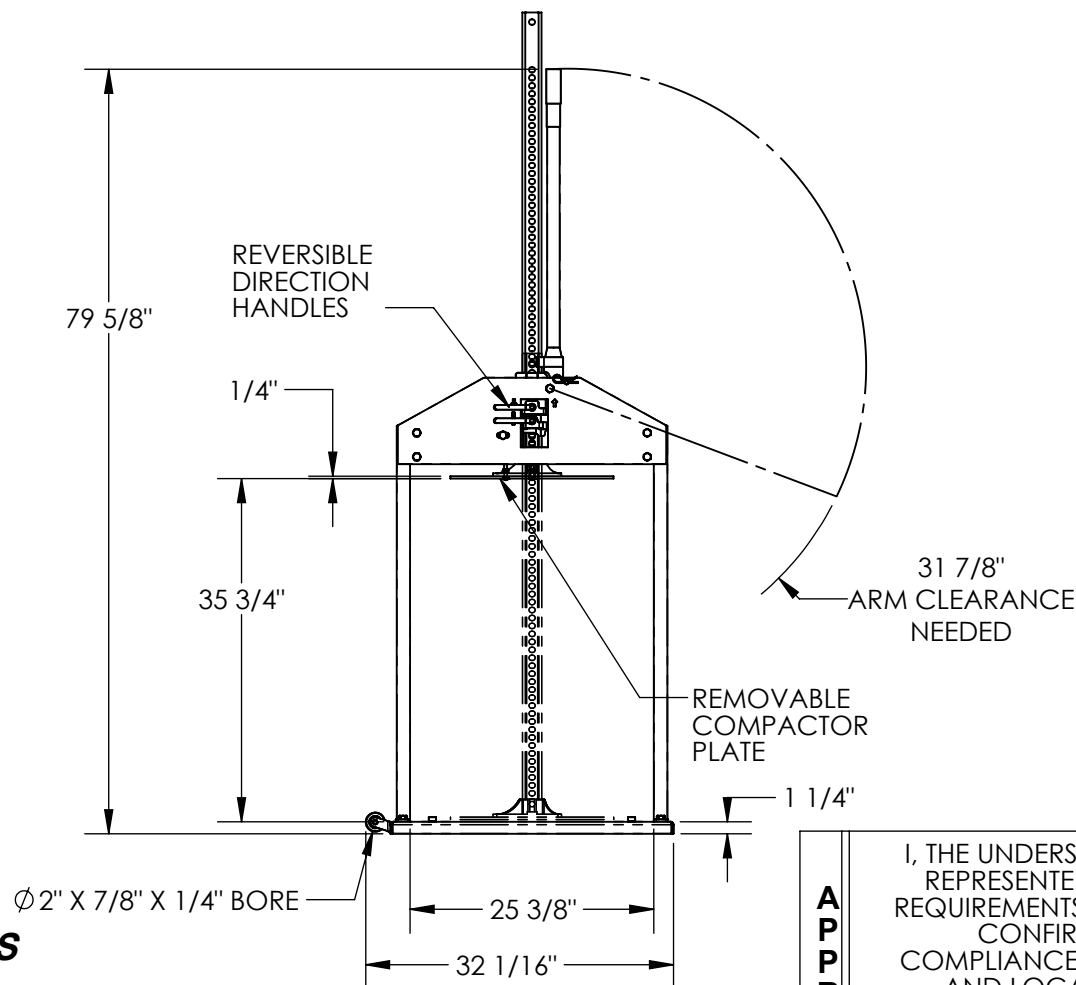

## SPECIAL FEATURES

NONE

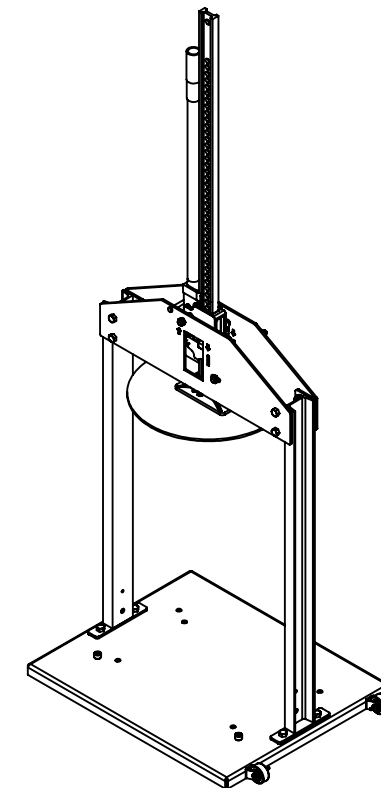

APPROVAL

I, THE UNDERSIGNED, AGREE THAT THE PRODUCT AS REPRESENTED SATISFIES DESIGN AND DIMENSION REQUIREMENTS. I ALSO ACKNOWLEDGE MY DUTY TO CONFIRM PRODUCT AND INSTALLATION COMPLIANCE WITH ALL APPLICABLE FEDERAL, STATE AND LOCAL REGULATIONS AND STANDARDS.  
**UNITS REQUIRING APPROVAL DRAWINGS OR MODIFIED ARE NON-RETURNABLE**  
[ ] As drawn [ ] As marked

Signed: \_\_\_\_\_ Date: \_\_\_\_\_

Printed Name: \_\_\_\_\_

LEAD TIME WILL START UPON RECEIPT OF SIGNED APPROVAL DRAWING

FOR INTERNAL USE ONLY  
PROJECT SIGN OFF

SALES	
ENG.	
FAB.	
POWER	

DISTRIBUTOR'S NAME:

VESTIL MANUFACTURING

DRAWN BY: WS

DATE: 02/03/2009

REFERENCE: X

SCALE: 1:20

QUOTED LEAD TIME: X

QUOTE # X

P.O.# X

W.O.# X

SALES: X

FILE NAME:

22-007-008