

INSTRUCTIONS PERTAINING TO A RISK OF FIRE, OR INJURY TO PERSONS IMPORTANT SAFETY INSTRUCTIONS

Lighted lamp is HOT!

WARNING — To reduce the risk of FIRE OR INJURY TO PERSONS.

- 1) Turn off / unplug and allow to cool before replacing lamp.
- 2) Lamp gets HOT quickly!
- 3) Do not touch hot lens or cowl.
- 4) Do not touch lamp or fixture if warm.
- 5) Do not look directly at lamp when on.
- 6) Keep lamp away from combustible materials.
- 7) Use only with wattage and lamp marked on fixture.
- 8) Do not touch the inner glass envelope of the lamp at any time. Use a soft cloth. Oil from skin may damage lamp.
- 9) Do not operate the fixture with a damaged or missing lens.

SAFETY INSTRUCTIONS READ THIS FIRST KEEP THESE INSTRUCTIONS

- 1) **WARNING:** This fixture is not to be installed within 10 feet (3M) of a pool, spa or fountain.
- 2) This fixture is to be used only with a power unit (transformer) rated a maximum of 300 W (25 AMPS) 15 volts per circuit.
- 3) The #18 ga. fixture wire is not intended for direct burial or connection to transformer.
- 4) Direct burial rated wire is to be buried a minimum of 6" (152mm) beneath the surface of the ground.
 - 8 GA wire can be purchased in length of 250' (76 M),
 - 10 GA wire can be purchased in length of 250' (76 M)
 - 12 GA wire can be purchased in lengths of 100' (30 M); 250' (76 M); 500' (152M); and 1000' (304 M)
- 5) Fixture shall not use a tungsten halogen lamp unless the fixture is marked for use with such lamps.
- 6) Wiring connections must be made with approved/listed wire connection device(s) suitable for the application. Do not exceed manufacturers' wiring combination specifications for size and quantity of conductors.

CAUTION

WHEN INSTALLING KICHLER LANDSCAPE LIGHTING (LINE VOLTAGE OR LOW VOLTAGE), CARE SHOULD BE TAKEN TO KEEP CLEAR OF POTENTIALLY COMBUSTIBLE MATERIALS.

WHEN MAINTAINING THE FIXTURES, BE SURE TO REMOVE LEAVES, PINE NEEDLES, GRASS CLIPPINGS, MULCH, OR ANY DEBRIS THAT HAS ACCUMULATED ON THE LIGHT BULB, LENS, OR BODY OF THE FIXTURE.

ASSEMBLY AND INSTALLATION

1. TURN OFF POWER

2. Open the quick link to connect the mounting bracket and remaining parts
3. Install the mounting bracket to your desired ceiling / tree surfaces.
4. Adjust the fixture chain to your desired length by removing links, as needed.
5. Unscrew the shade to expose the socket. Install the MR16 lamp in socket. Reinstall the shade once lamp has been installed.
6. Connect the mounting bracket with the rest of the fixture by quick link.
7. Make wire connections using approved wire nuts (not supplied).

FIXTURE DETAILS:

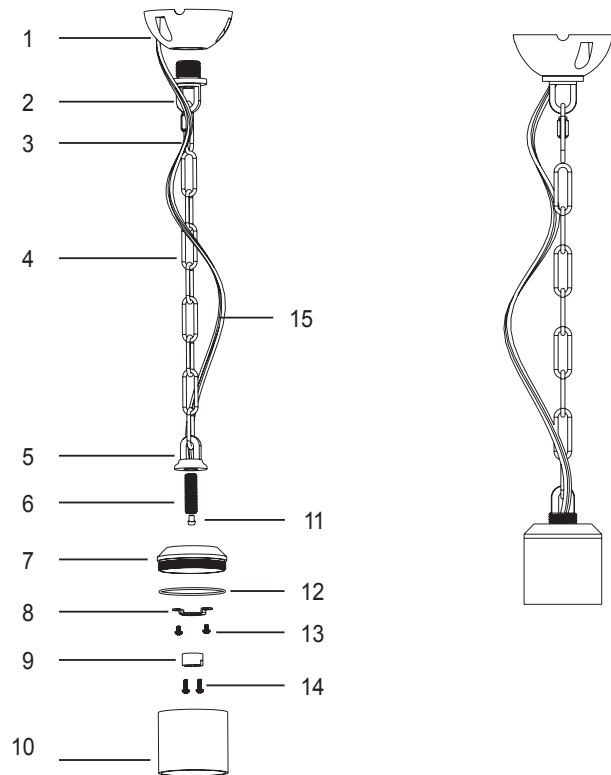

1. Mounting bracket
2. Connector
3. Quick link
4. Chain
5. Coupling
6. Bushing
7. Shade holder
8. Socket bracket
9. Socket
10. Shade
11. Plug
12. O-Ring
13. Screw
14. Screw
15. Cable