

Assembly Instructions

Metal Swivel Chair

- ⚠ Before you throw the carton, please ensure that you have all the parts needed for the assembly.
- ⚠ **Hardware Note:**
 - 1. For each step please don't fully tighten all the screws at first, when they all align to the holes you can fully tighten them.
 - 2. All the bolts should be assembled **vertically** to the holes.
- ⚠ **Spare parts** can be found in the hardware box if you do not have enough bolts for assembly.

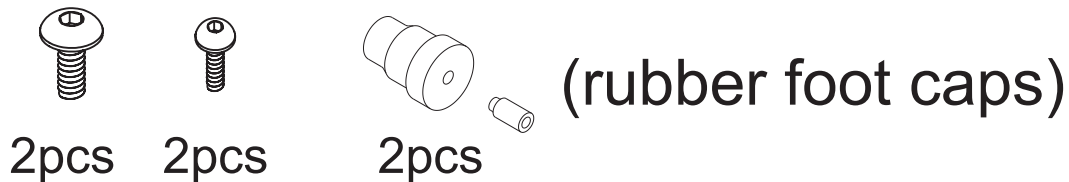
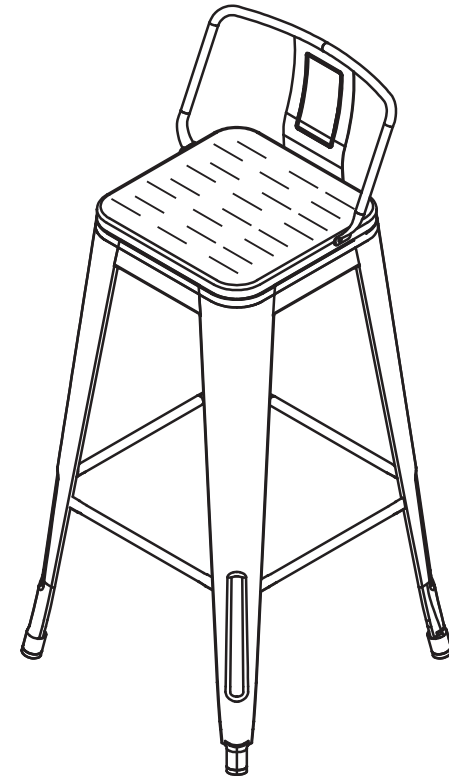

⚠ THIS INSTRUCTION BOOKLET CONTAINS IMPORTANT SAFETY INFORMATION. PLEASE READ AND KEEP FOR FUTURE REFERENCE.

Assembly Instructions

Parts & Hardware

A

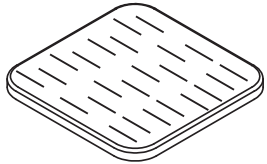

Wooden top
1pc * 4

B

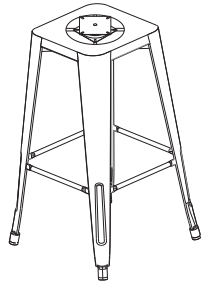

Metal Base
1pc * 4

C

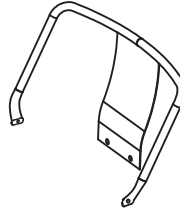

Back
1pc * 4

1

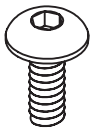

Large Bolts
4pcs * 4

2

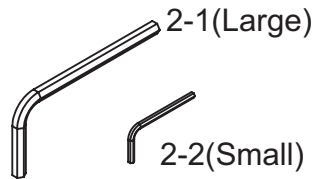

Wrench
2pcs

3



Small Bolts
4pcs * 4

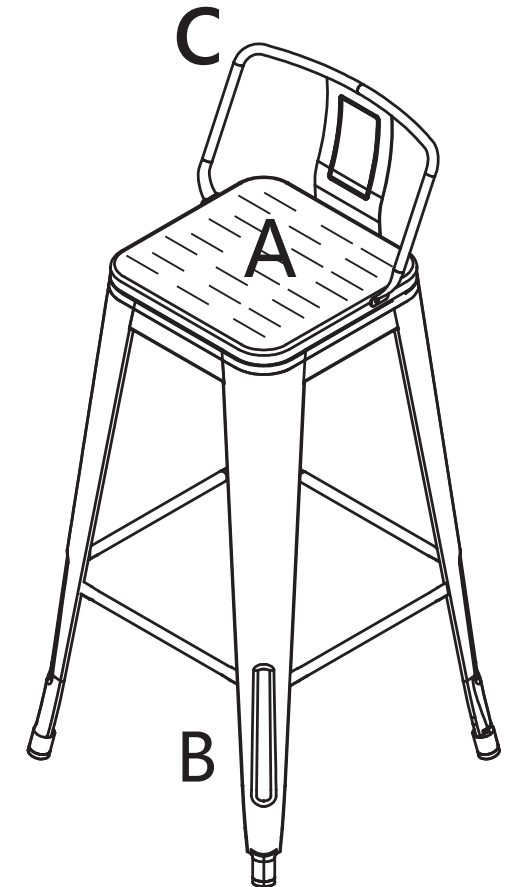

Assembly Instructions

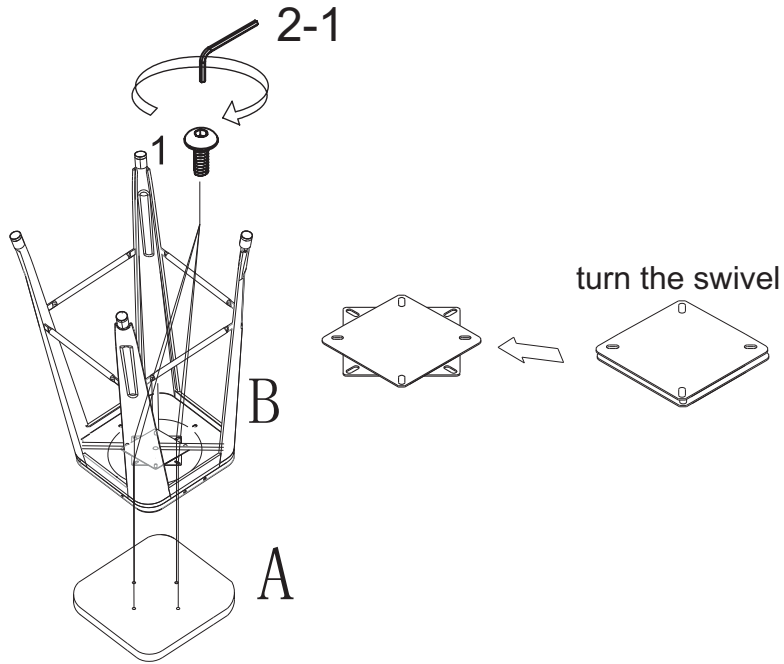

Step 1:

Attach (B) to (A) using (1) and with (2-1) to tighten.

! Hardware Note:
Please do not completely tighten all the hardware, until the entire assembly is complete.

Step 2:

Attach (C) to (B) using (1) and with (2-2) to tighten.

! Hardware Note:
Please do not completely tighten all the hardware, until the entire assembly is complete.

! Press the two side of the back inside when you find the bolts are not long enough to tighten. (see below diagram)

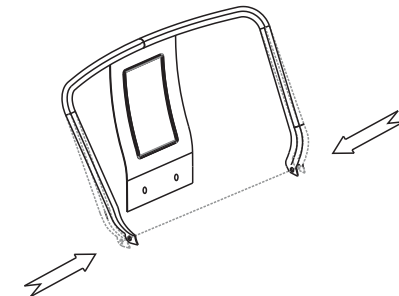
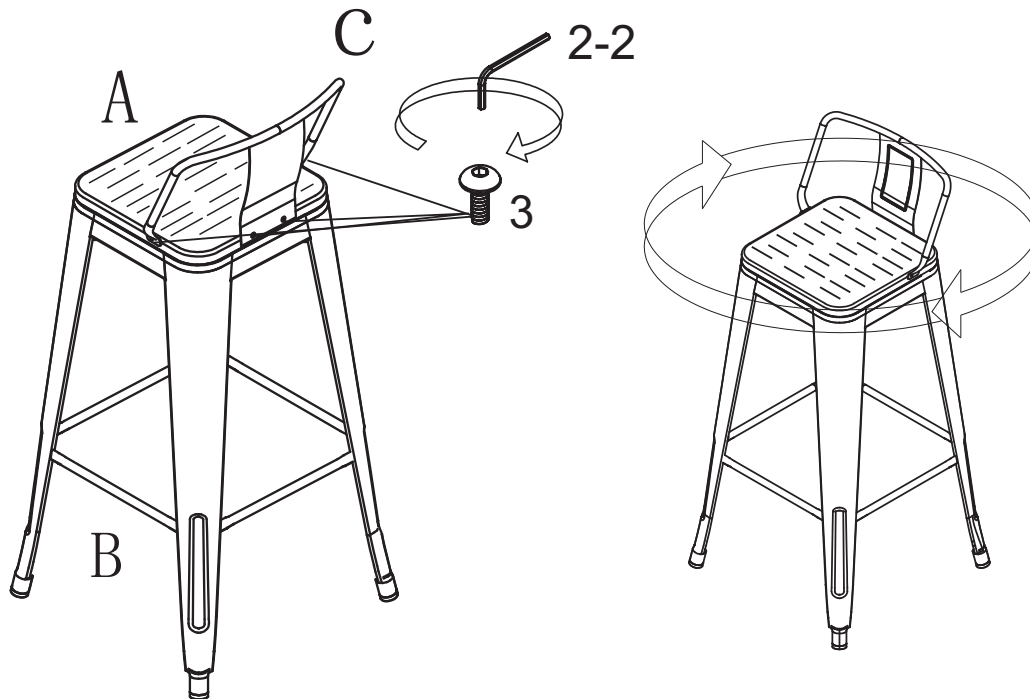

FAQ:

1. I don't have enough bolts to assemble the stool?

We have 4 spare bolts in hardware box.

2. One of the leg don't have rubber foot caps?

We have 2 spare caps in hardware box .

3. One legs is not at the same level with the other three legs?

Firstly, please check if four legs all have rubber foot caps. If no the caps can be found in the hardware box.(Spare parts)

Secondly, if four legs all have rubber foot caps. Please push the leg that doesn;t at the same level inside slightly until four legs at the same level.(see below diagram)

