

# Drawer Storage Cabinet

Instruction Manual

# Cómoda de cajones

Manual de instrucciones

# Armoire de rangement à tiroirs

Manuel d'Instruction

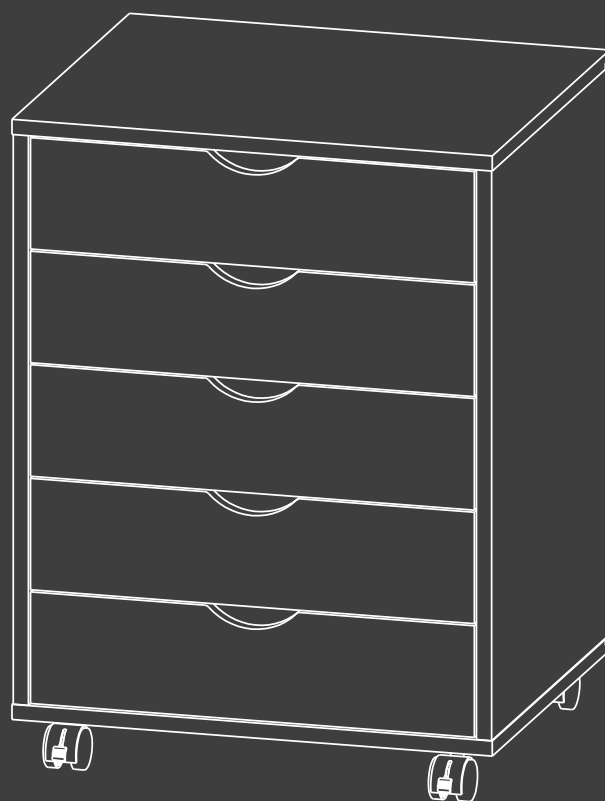

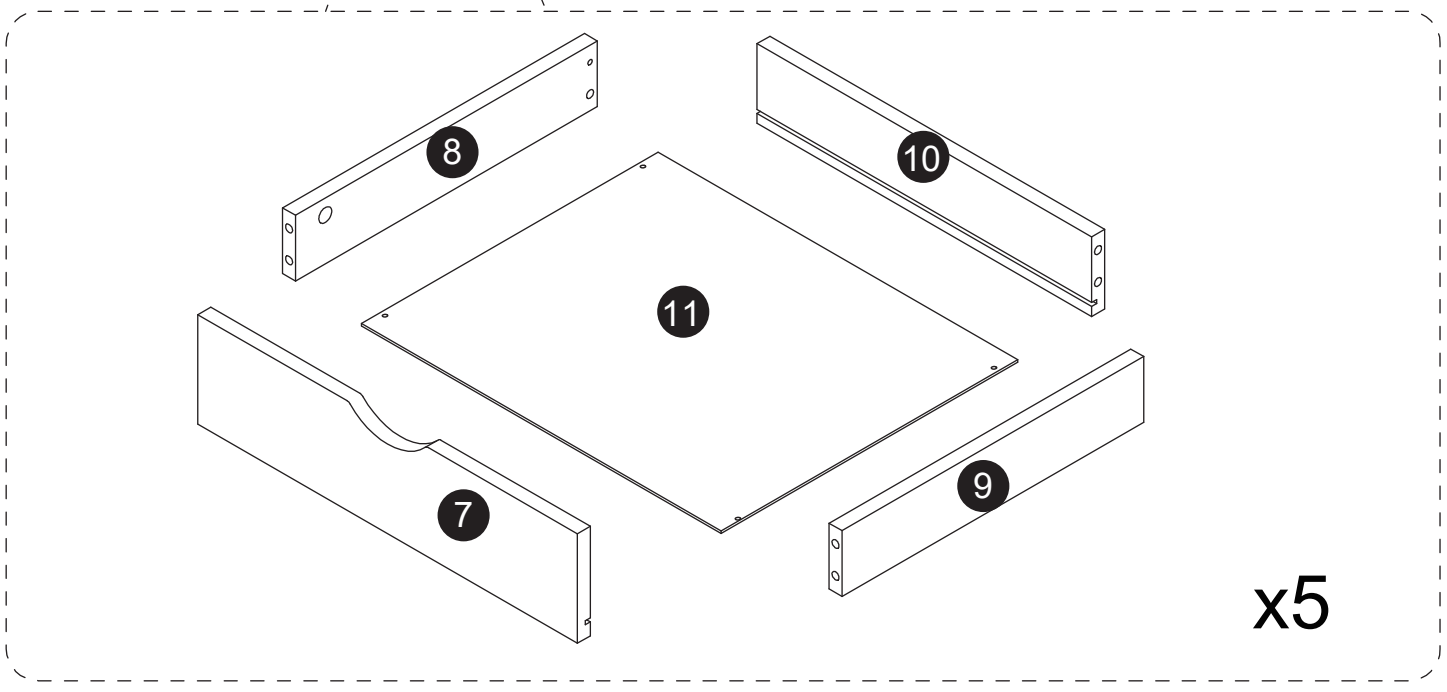
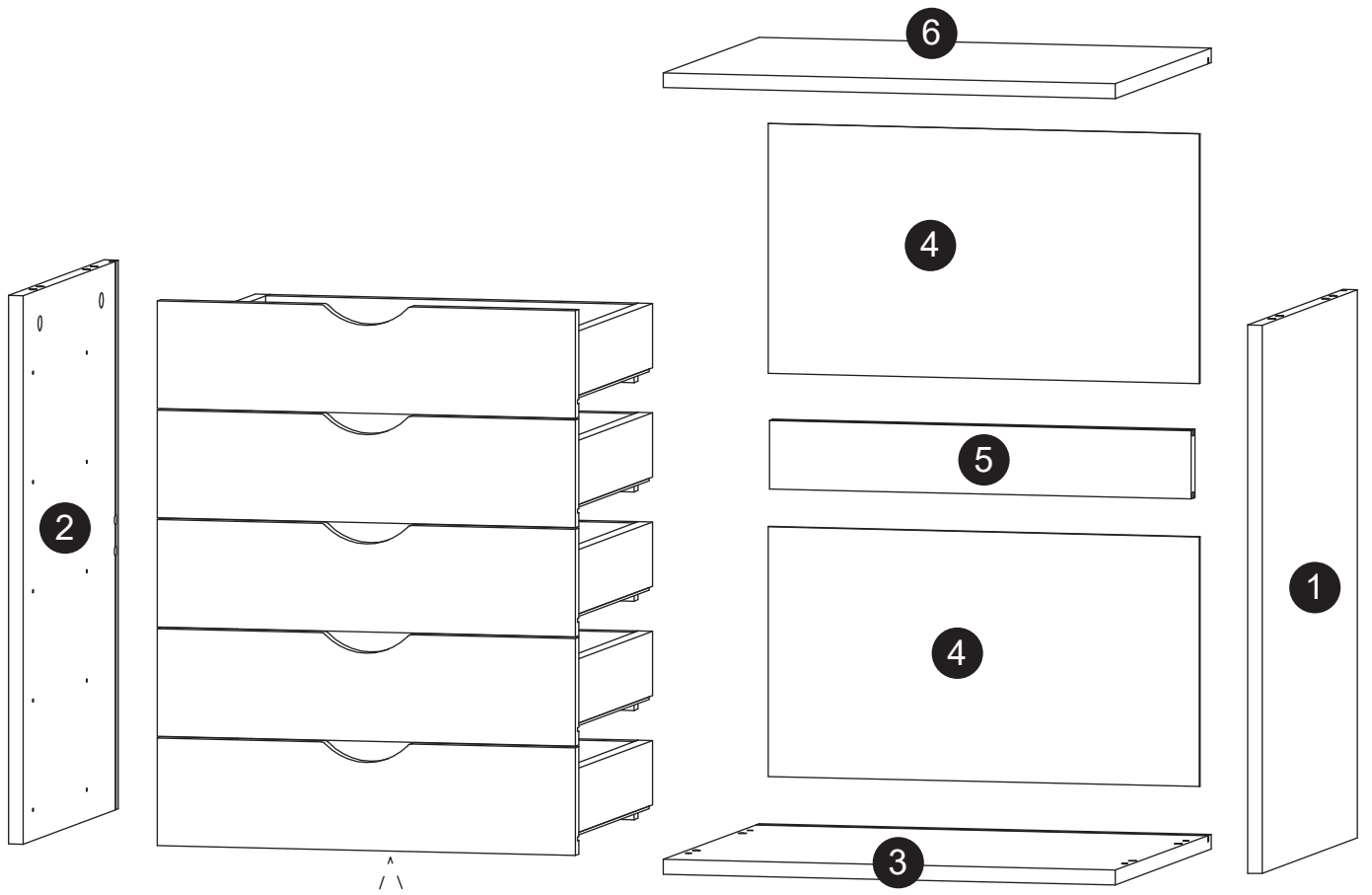

1 X1

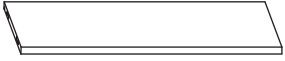

2 X1

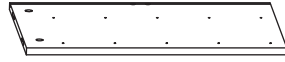

3 X1



4 X2

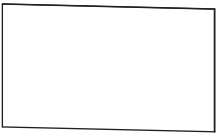

5 X1



6 X1

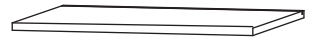

7 X5



8 X5



9 X5

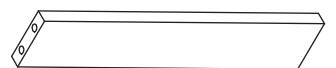

10 X5



11 X5

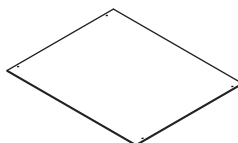

**A** X28



**B** X28



**CL** X5

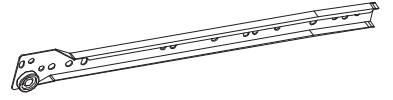

**CR** X5

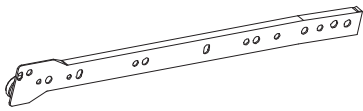

**DL** X5

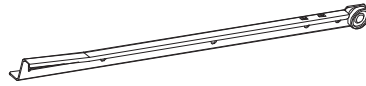

**DR** X5

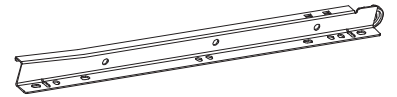

**E** X64

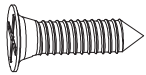

M4\*14mm

**F** X10



**G** X8

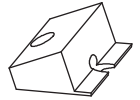

**H** X2

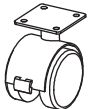

**I** X2



**J** X4



**K** X1



**L** X28



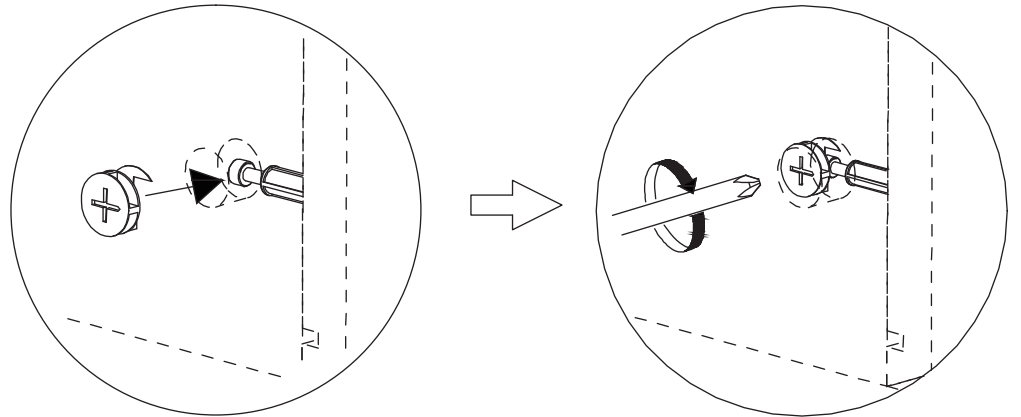
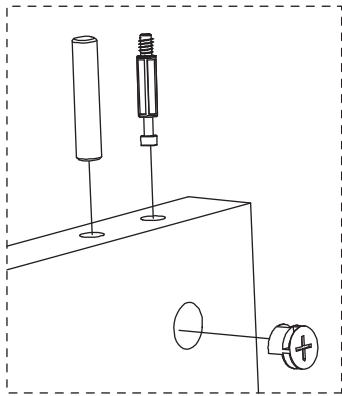
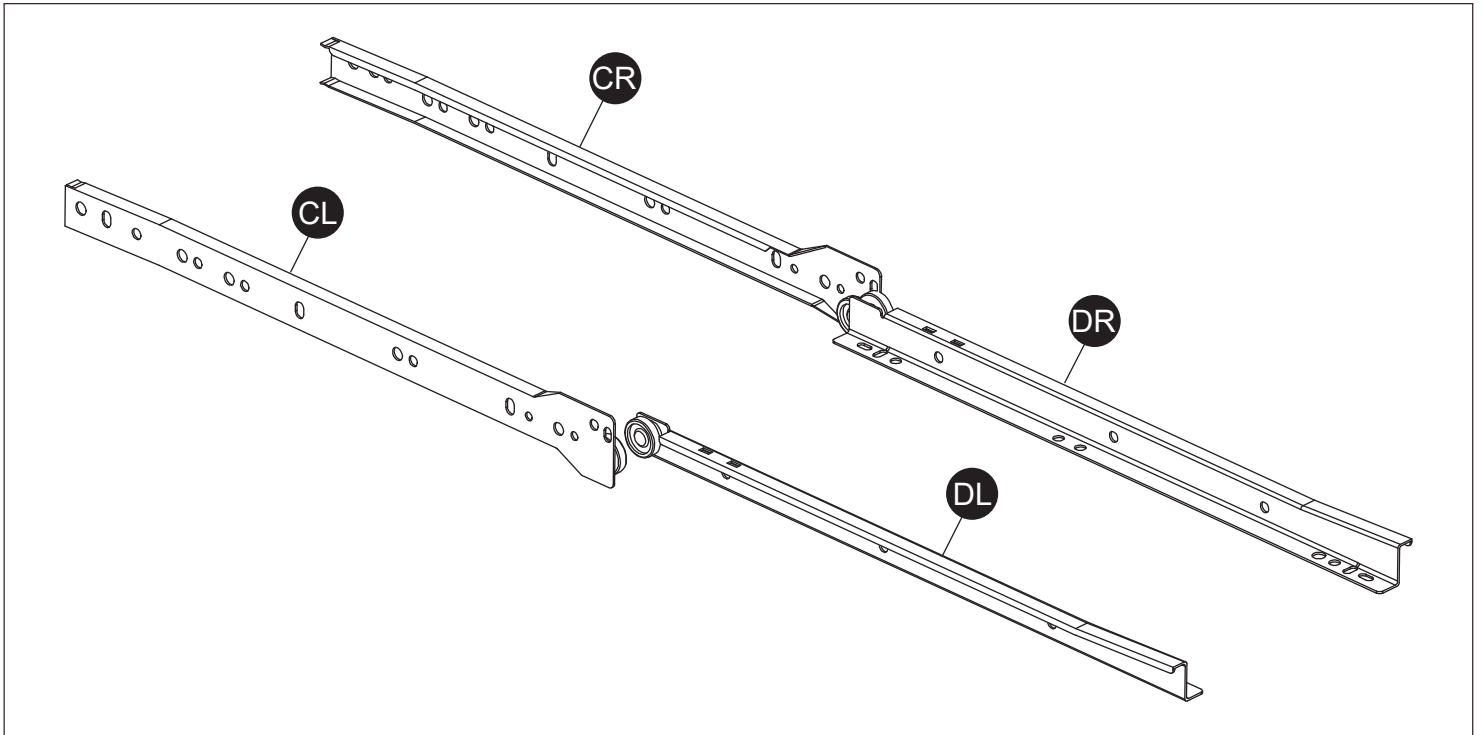

EN:

## Note:

1. As shown, make sure each part is in the correct position.
2. Align the slot of the cam lock with the cam bolt, then turn the cam lock clockwise to lock it.

ES:

## Nota:

1. Como se muestra, asegúrese de que cada pieza esté colocada en la posición correcta.
2. Alinee la ranura de la excéntrica con el perno de excéntrica y, a continuación, gírela en sentido horario para bloquearla.

FR:

## Remarque :

1. Comme illustré, assurez-vous que chaque pièce est à la bonne position.
2. Alignez la fente du verrou à came avec le boulon à came, puis tournez le verrou à came dans le sens des aiguilles d'une montre pour le verrouiller.

# Step 1

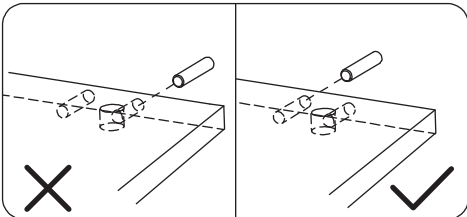
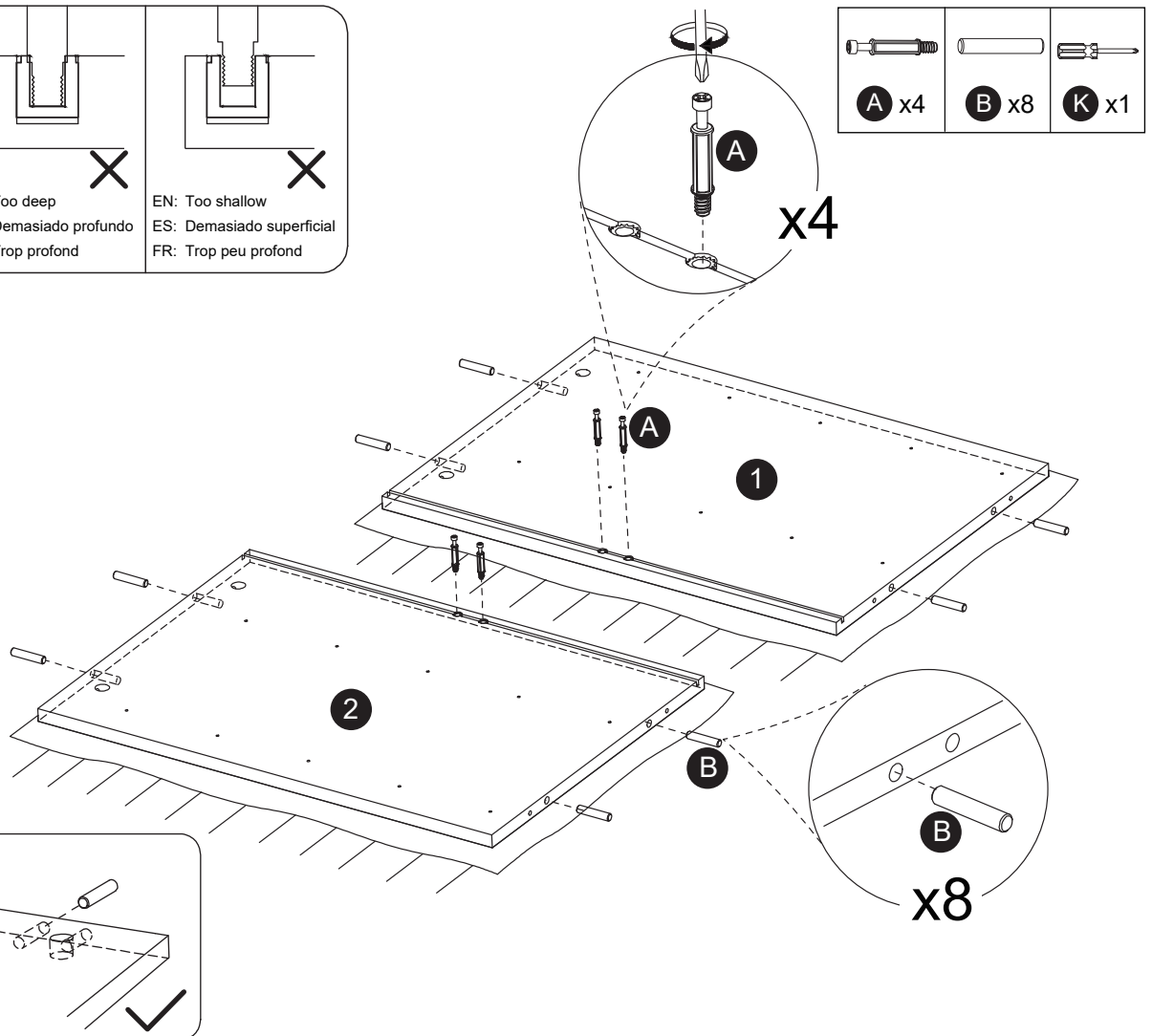
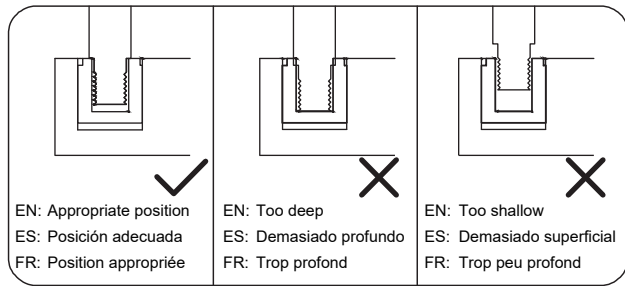

## EN: **Note:**

1. Place a blanket under the panels to prevent scratches or damage.
2. Insert Wooden Dowels **B** into the holes closer to the center of the panel, not the edge holes.
3. Do not insert wooden dowels too deep or too shallow.

## ES: **Nota:**

1. Coloque una manta debajo de los paneles para evitar arañazos o daños.
2. Inserte los tacos de madera **B** en los orificios más cercanos al centro del panel, y no en los orificios de los bordes.
3. No inserte los tacos de madera a demasiada ni a poca profundidad.

## FR: **Remarque :**

1. Placez une couverture sous les panneaux pour éviter les rayures ou les dommages.
2. Insérez les chevilles en bois **B** dans les trous les plus proches du centre du panneau, pas dans les trous de bord.
3. N'enfoncez pas les chevilles en bois ni trop profondément, ni trop peu profondément.

# Step 2

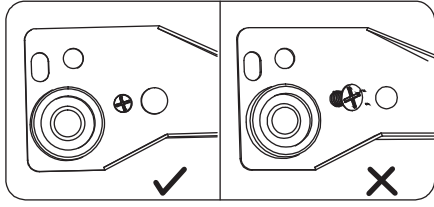

EN: FRONT  
ES: FRONT  
FR: AVANT

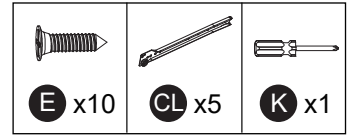
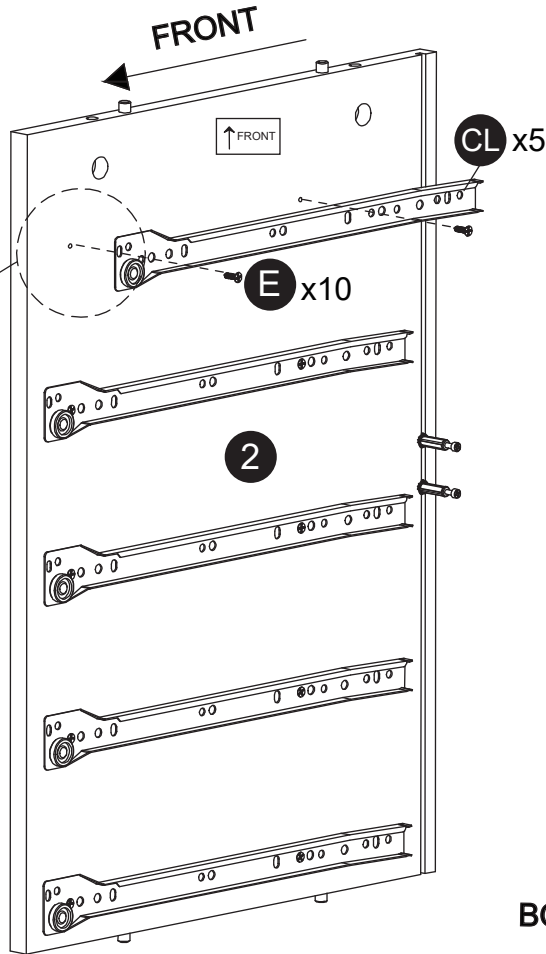

EN: TOP  
ES: ARRIBA  
FR: HAUT

EN: BOTTOM  
ES: ABAJO  
FR: FOND

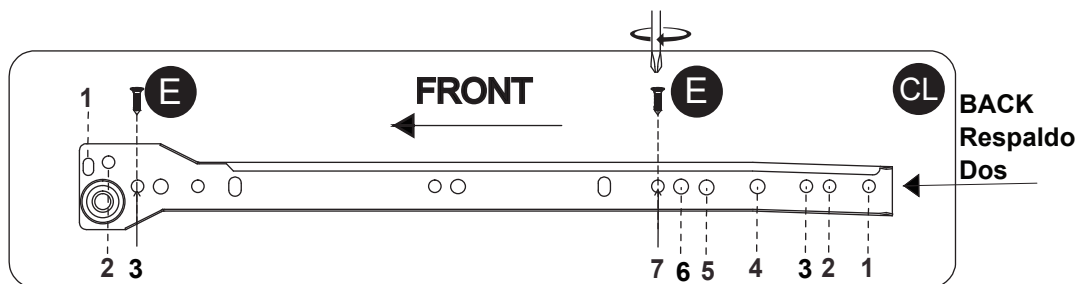
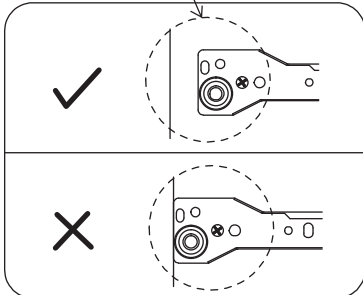

EN: **Note:**

1. As shown, make sure the panels and sliders are in the correct position.
2. Make sure the screws are properly seated and aligned for a smooth installation.

ES: **Nota:**

1. Como se muestra, asegúrese de que los paneles y las guías estén en la posición correcta.
2. Asegúrese de que los tornillos estén bien asentados y alineados para una instalación sin problemas.

FR: **Remarque :**

1. Comme illustré, assurez-vous que les panneaux et les glissières sont dans la bonne position.
2. Assurez-vous que les vis sont bien en place et alignées pour une installation fluide.

# Step 3

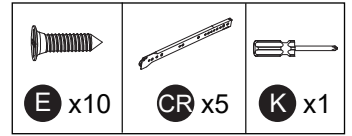
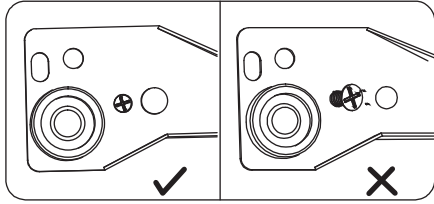

**TOP**  
 EN: TOP  
 ES: ARRIBA  
 FR: HAUT  
  
 EN: BOTTOM  
 ES: ABAJO  
 FR: FOND  
**BOTTOM**

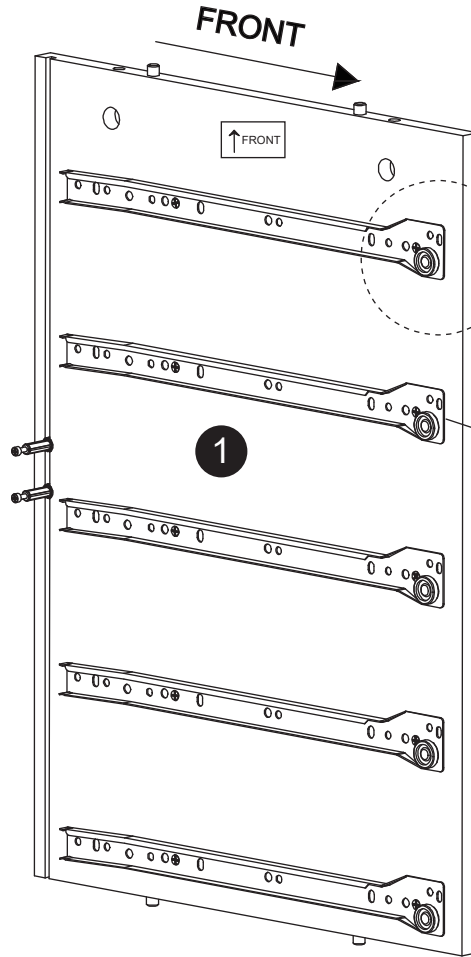

EN: FRONT  
 ES: FRONT  
 FR: AVANT

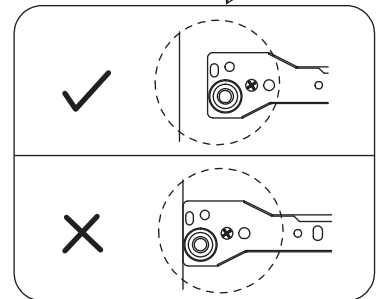
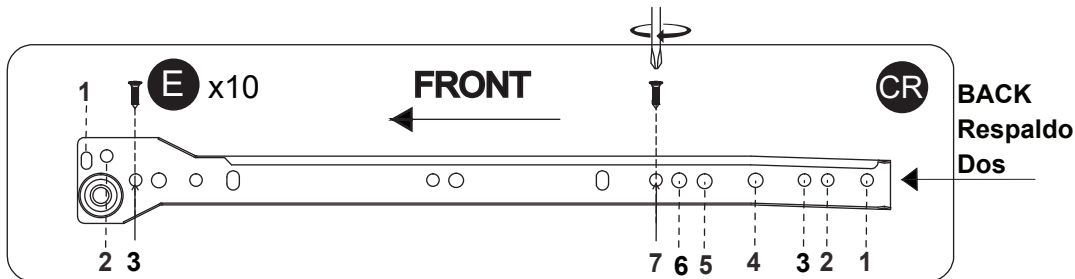

# Step 4

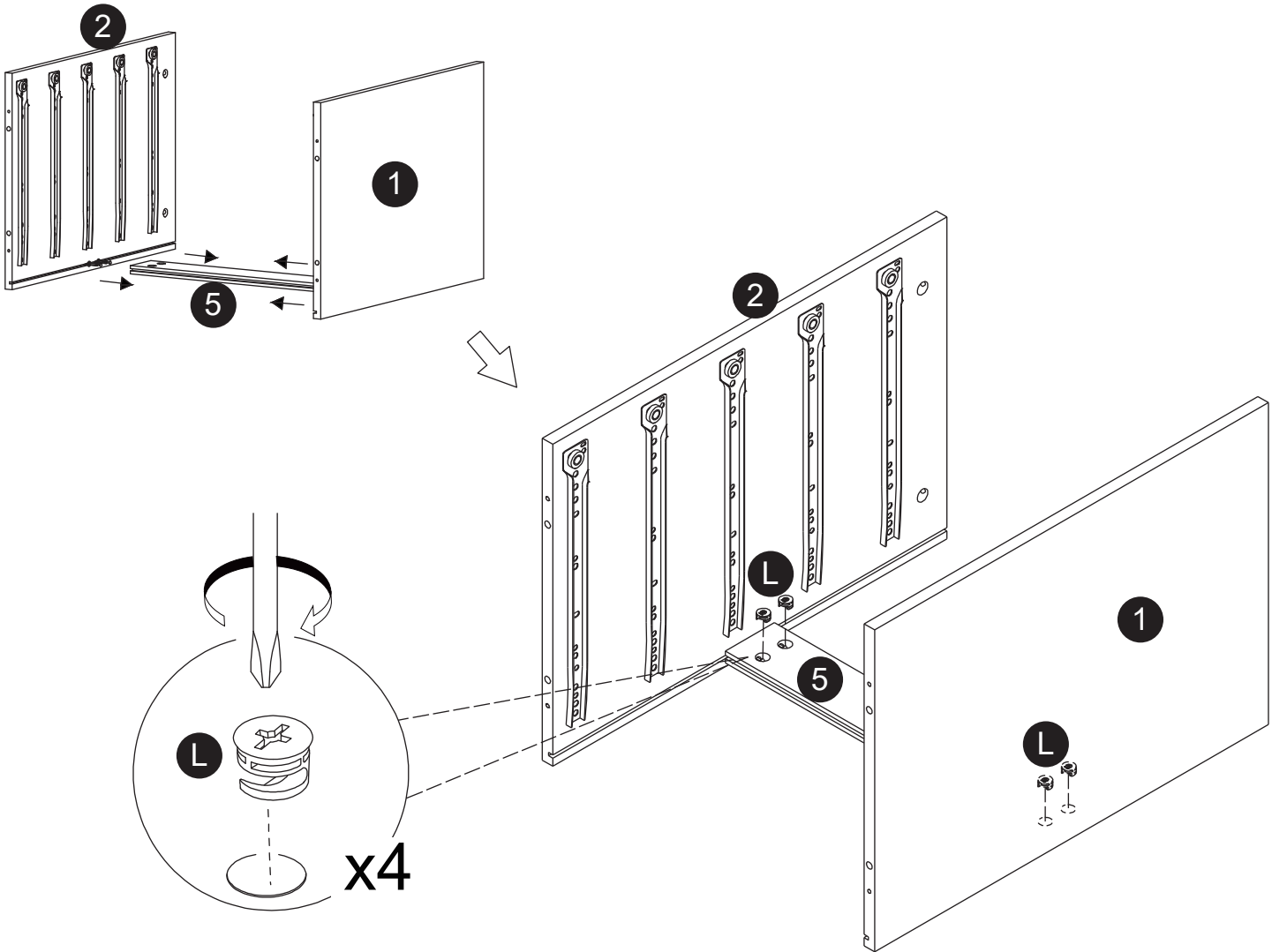
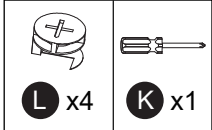

# Step 5

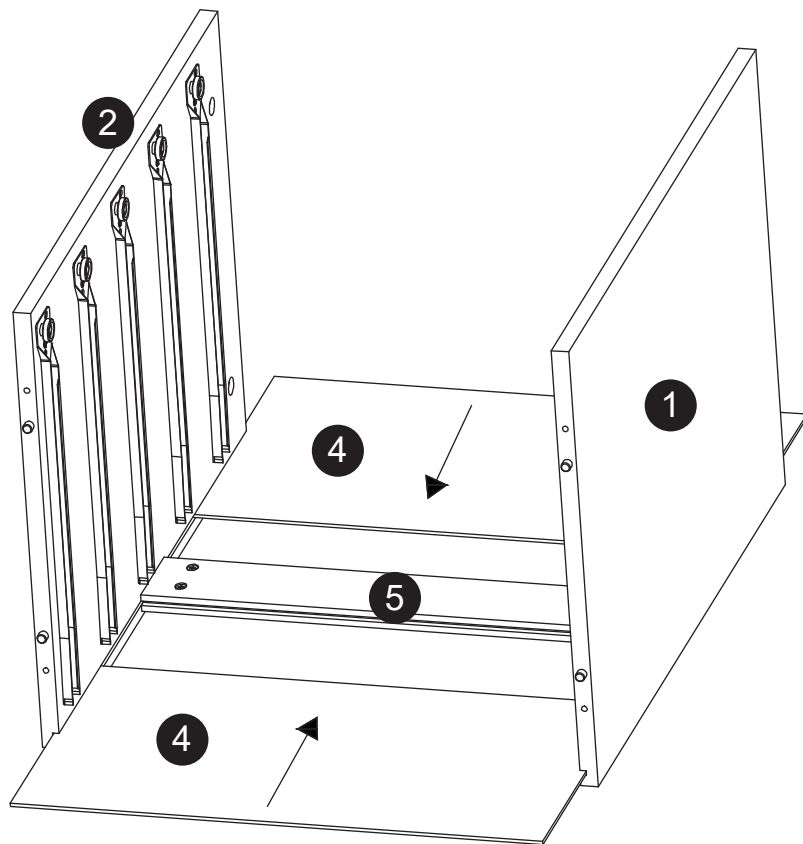

# Step 6

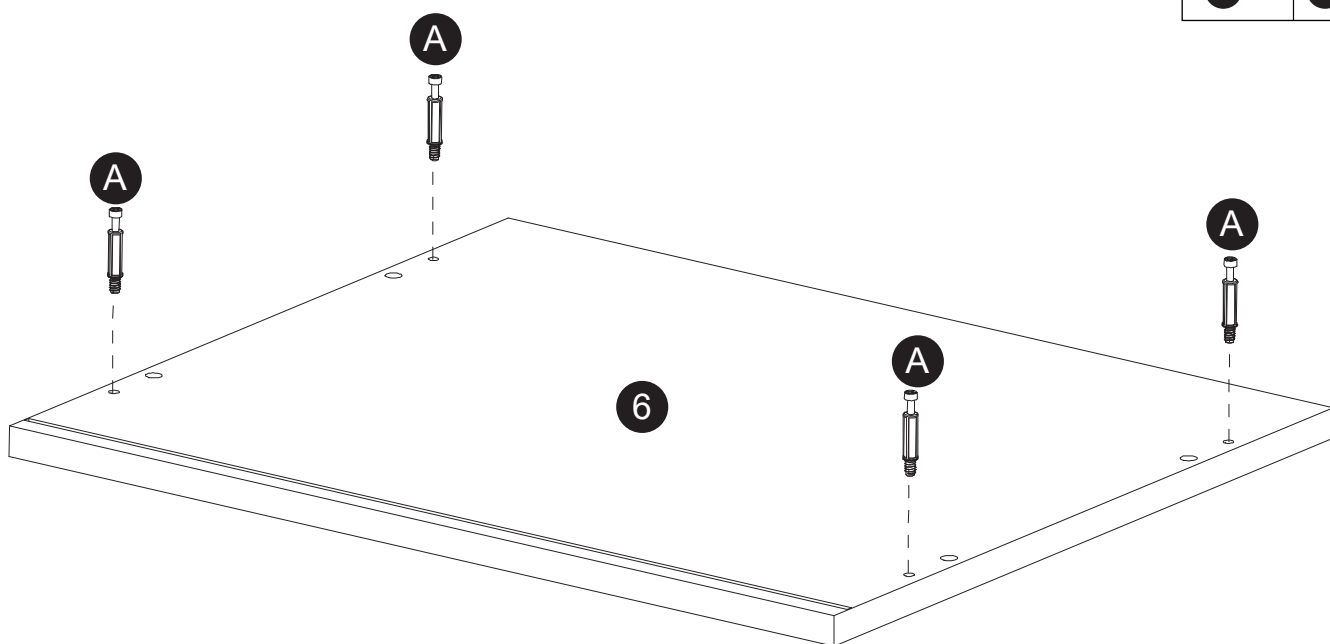
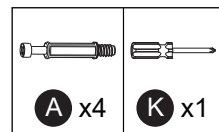



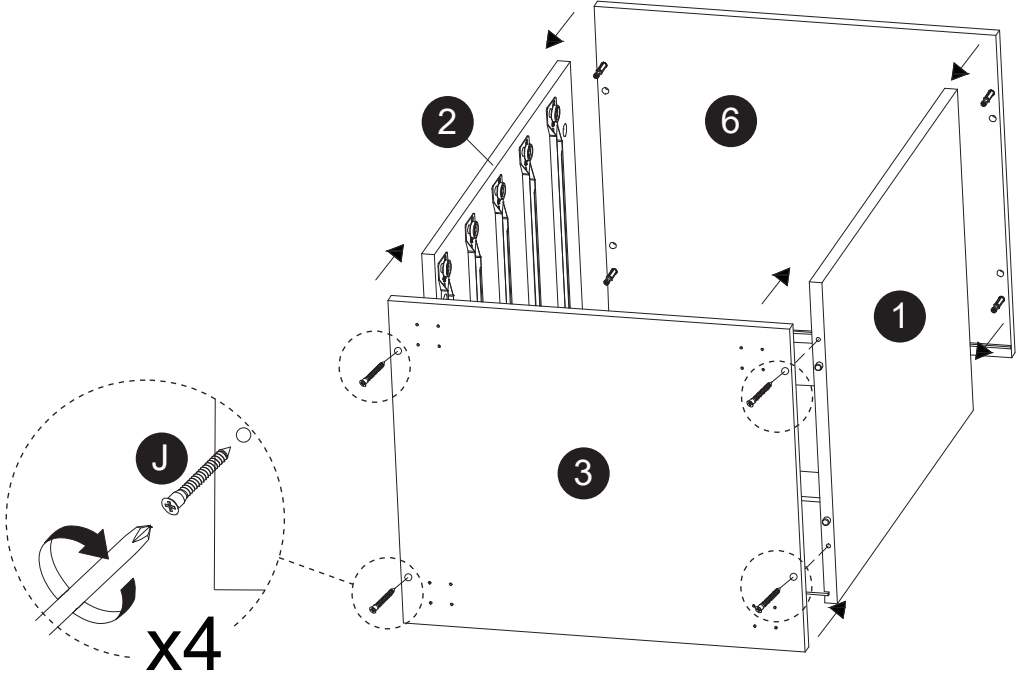
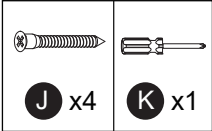

# Step 7

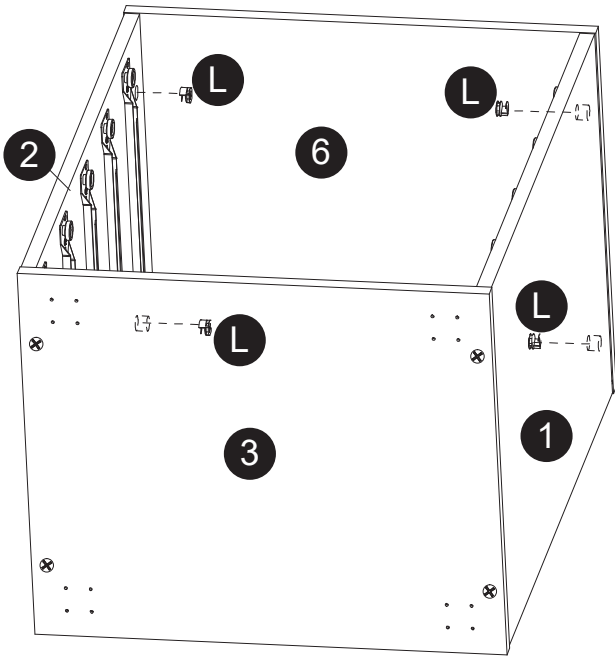
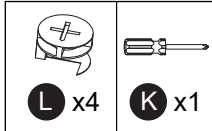

# Step 8



# Step 9

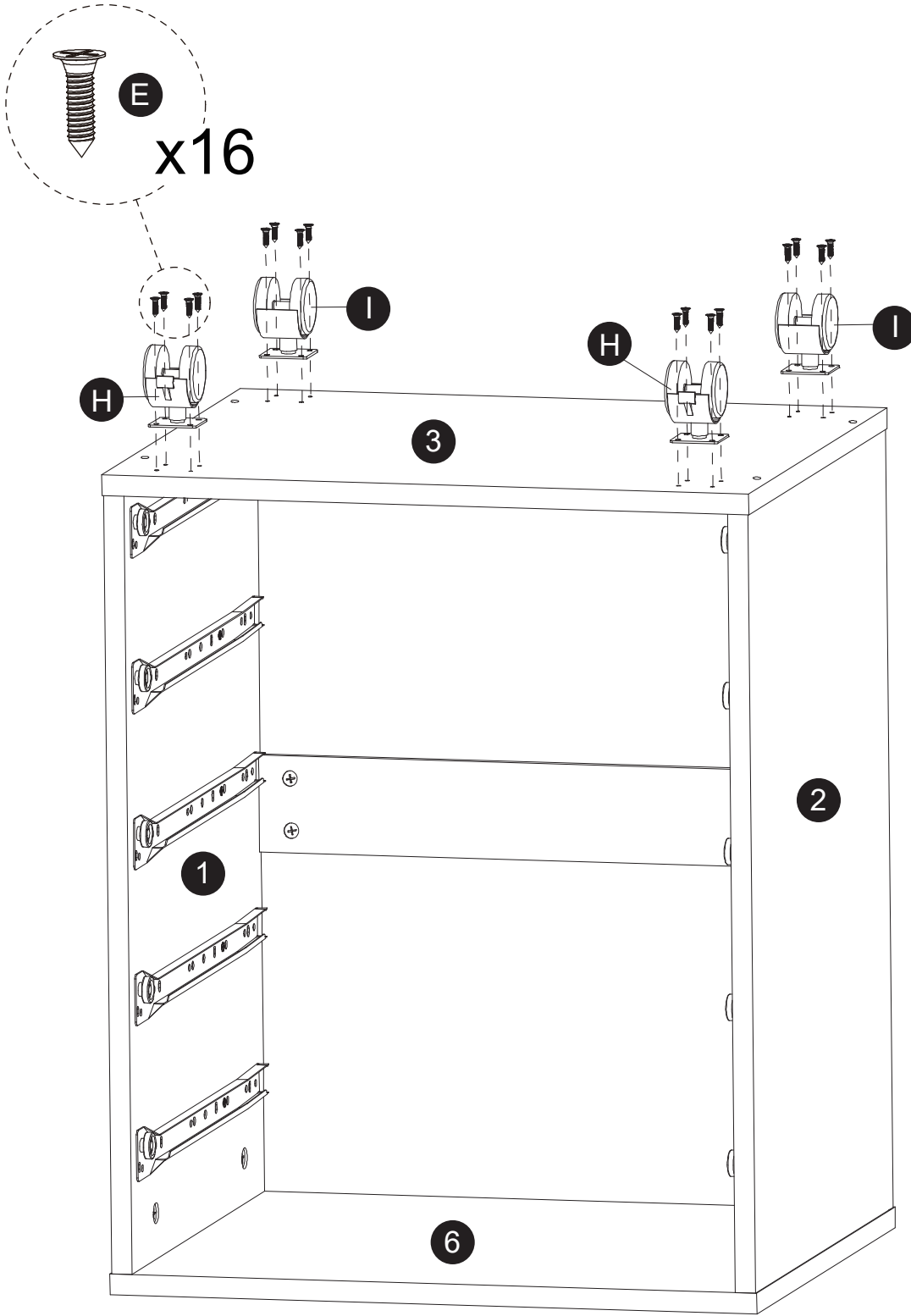

			
<b>E</b> x16	<b>H</b> x2	<b>I</b> x2	<b>K</b> x1

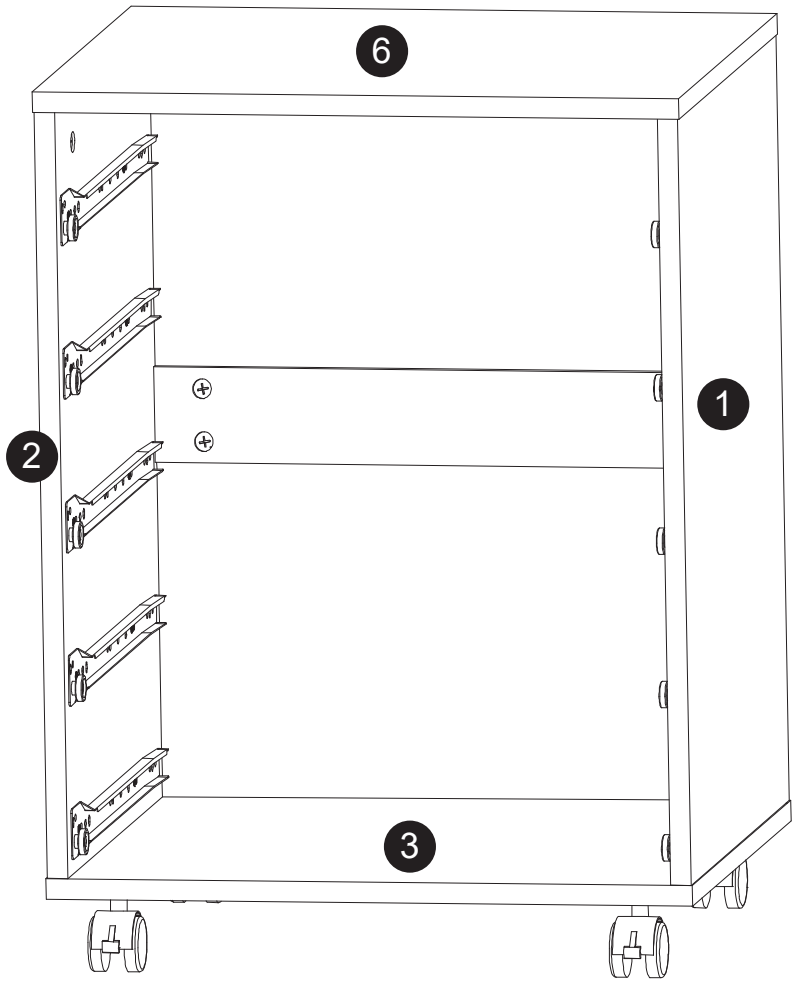
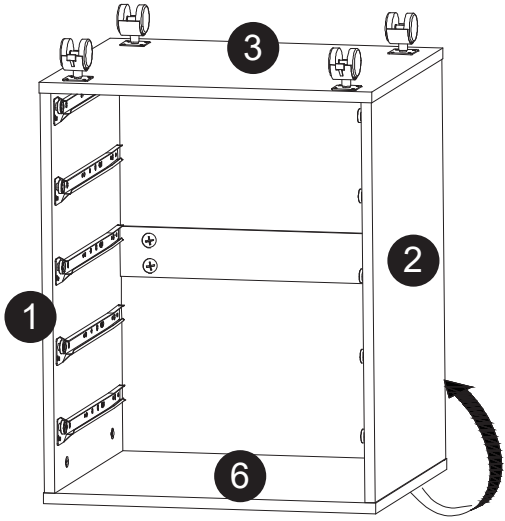

# Step 10



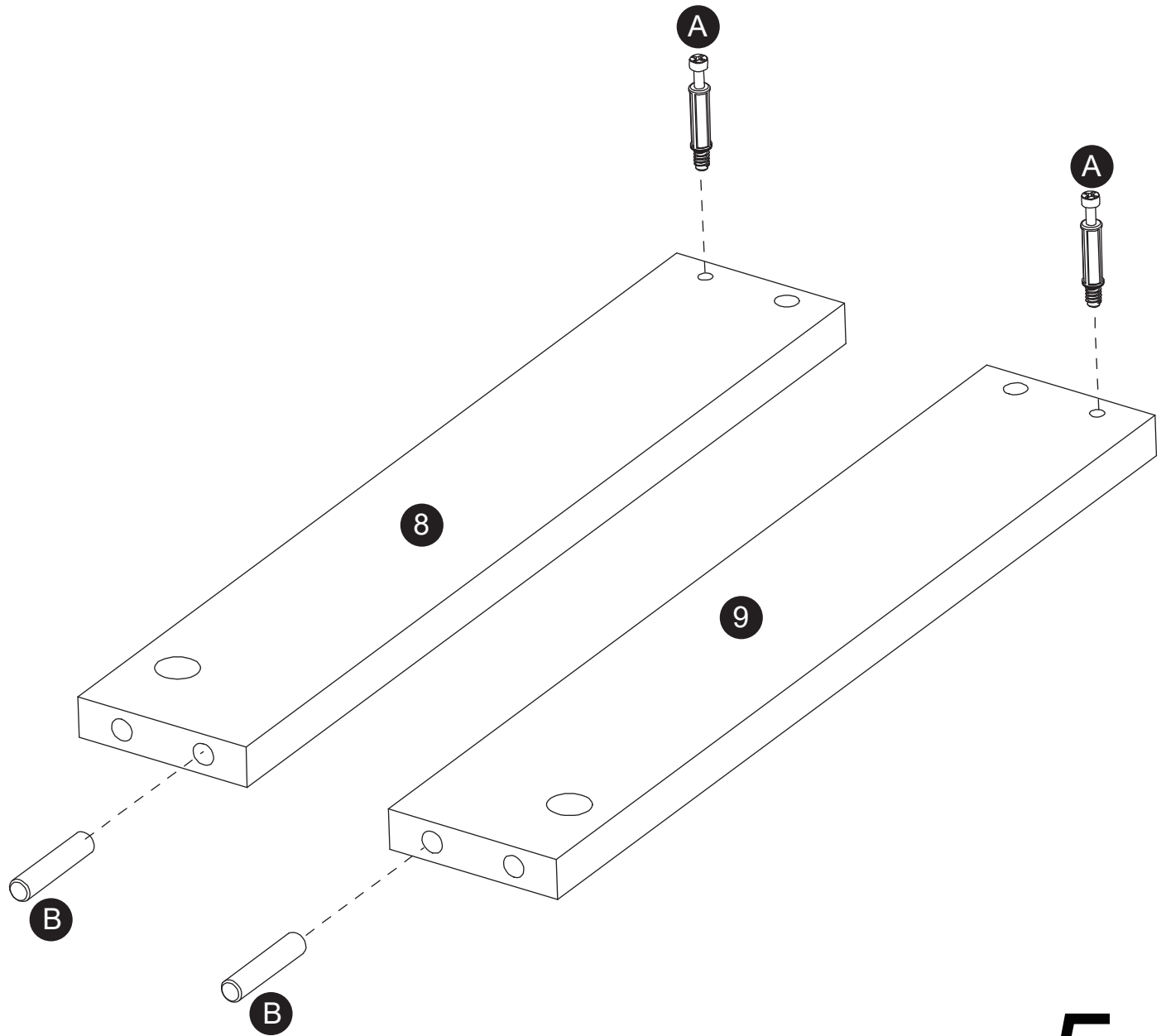

# Step 11

		
<b>A</b> x10	<b>B</b> x10	<b>K</b> x1



x5

# Step 12

		
<b>A</b> x10	<b>B</b> x10	<b>K</b> x1

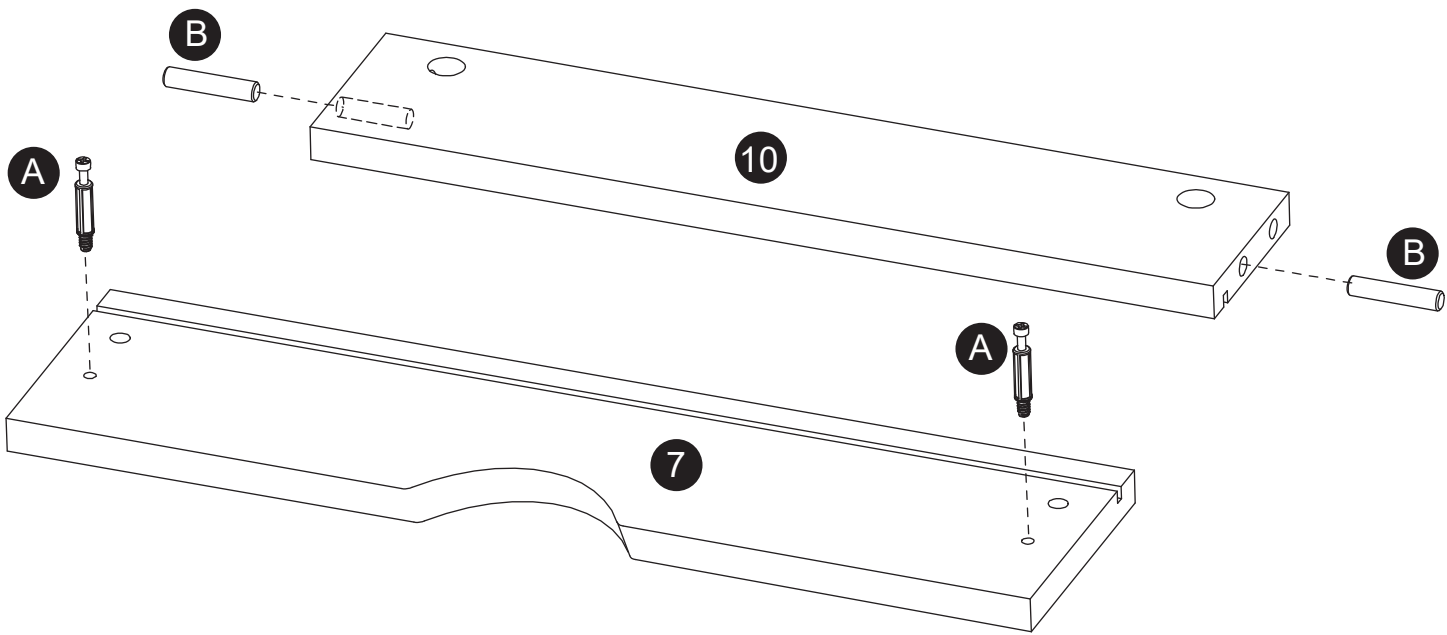

x5

# Step 13

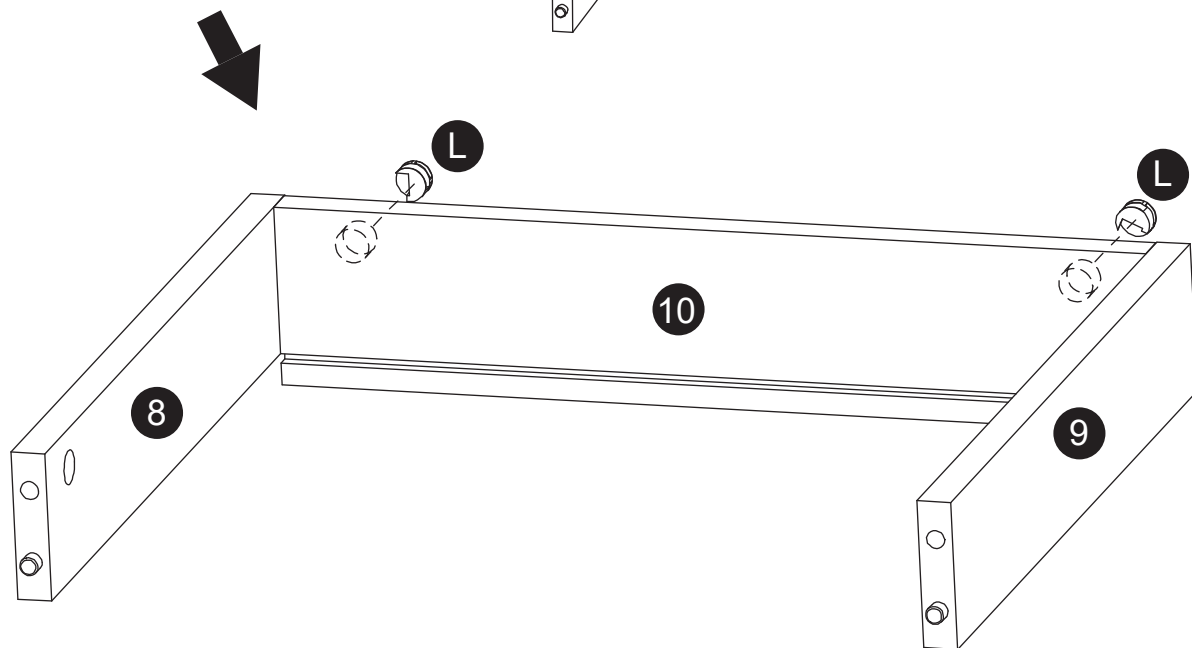
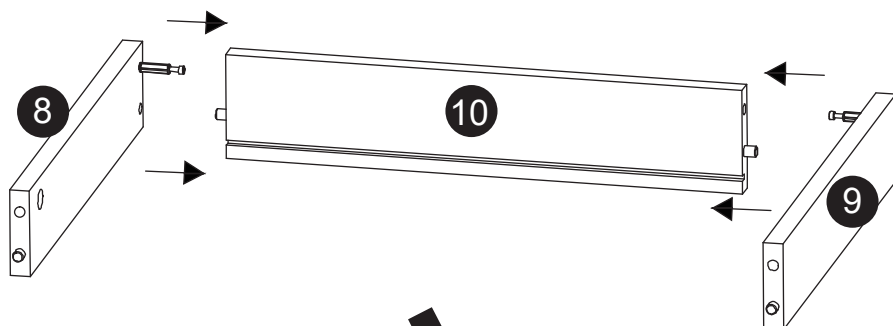
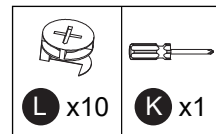

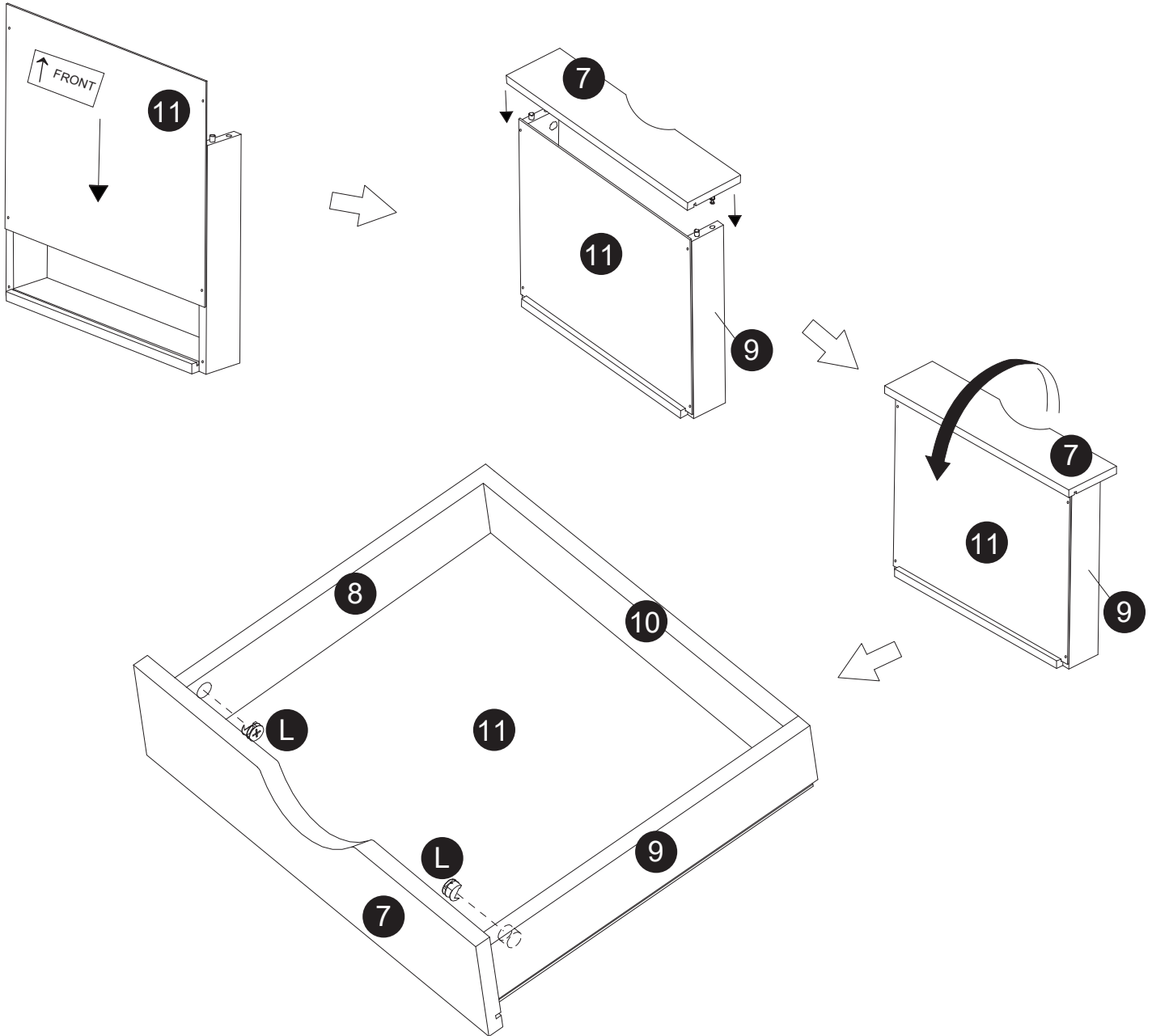
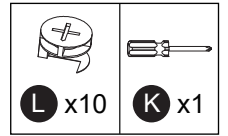

x5

# Step 14



x5

# Step 15

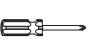
			
<b>E</b> x20	<b>DL</b> x5	<b>DR</b> x5	<b>K</b> x1

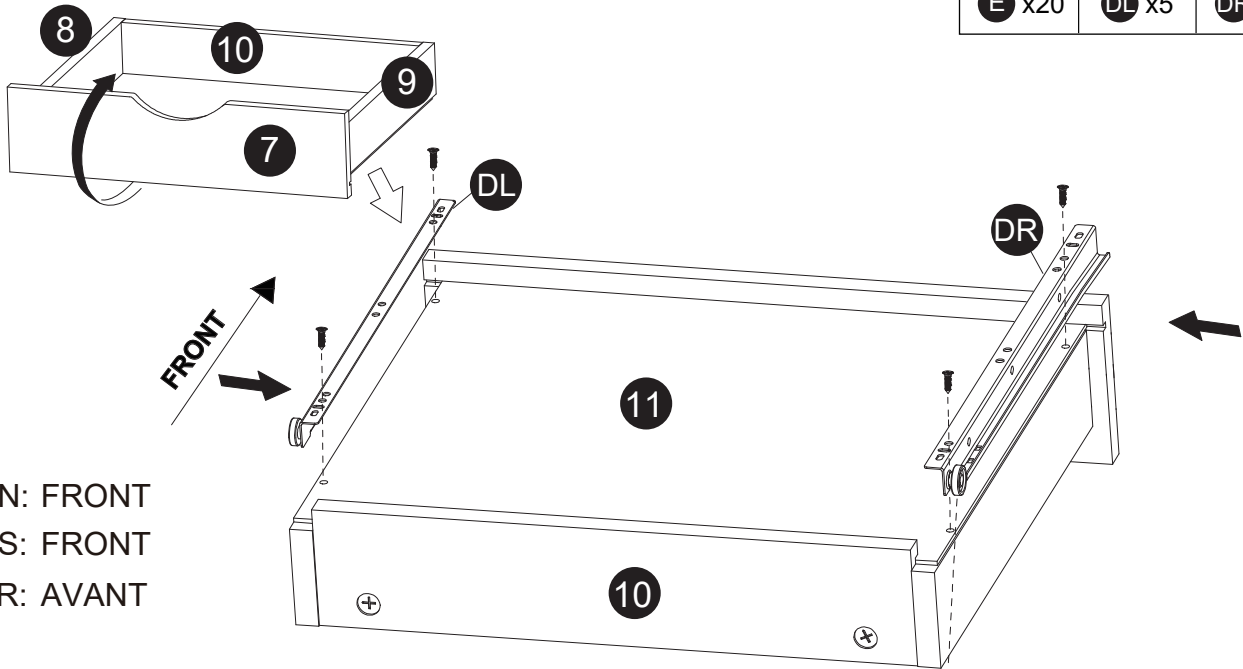

EN: FRONT  
 ES: FRONT  
 FR: AVANT

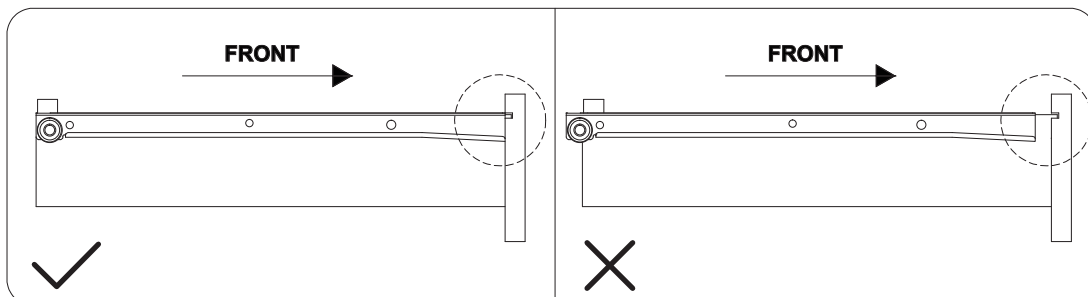
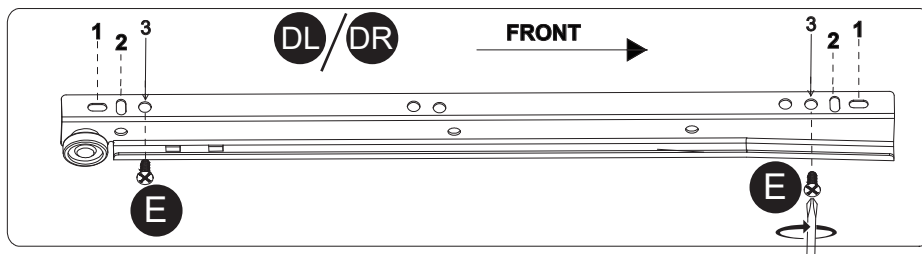
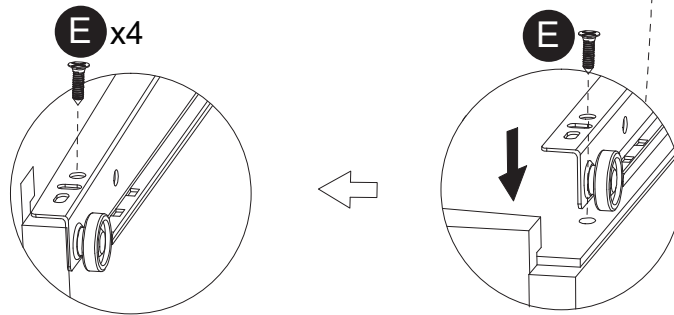

# Step 16

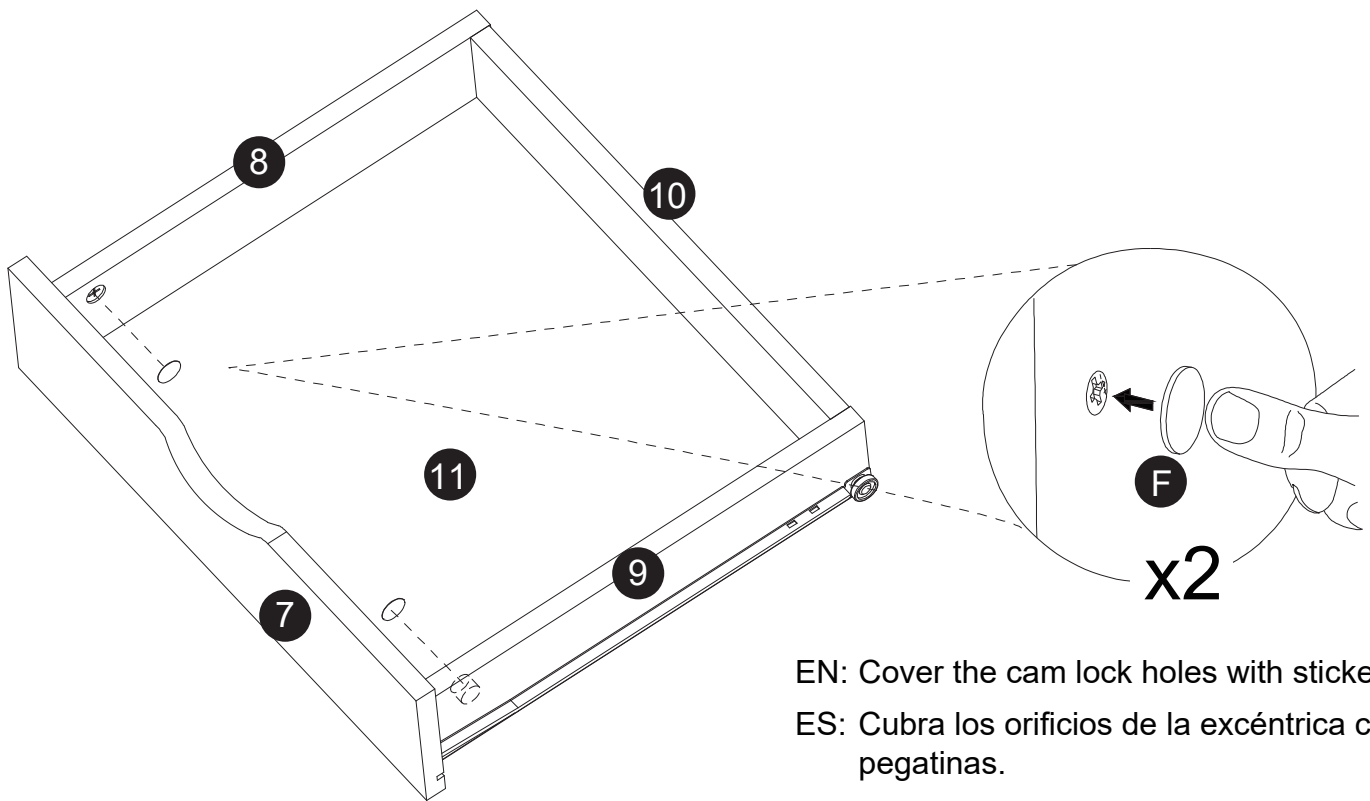
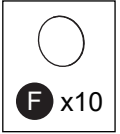

EN: Cover the cam lock holes with stickers.

ES: Cubra los orificios de la excéntrica con pegatinas.

FR: Couvrez les trous de la serrure à came avec des autocollants.

x5

## Step 17

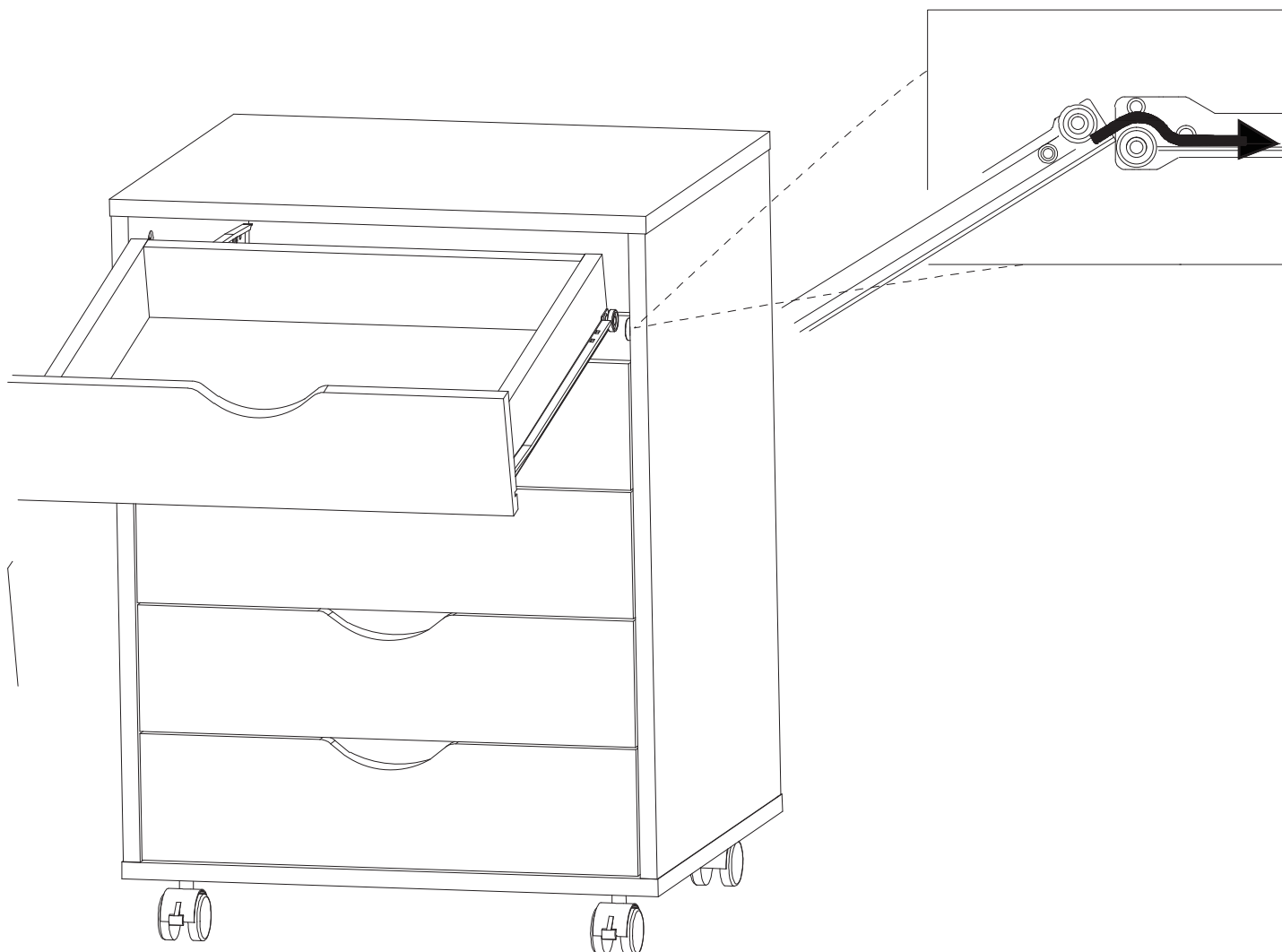

EN: **Note:**

1. Assemble the bottom drawer first to help prevent tipping.
2. If the drawer does not go in smoothly, take it out and repeat this step.



ES: **Nota:**

1. Monte primero el cajón inferior para ayudar a evitar vuelcos.
2. Si el cajón no entra con suavidad, sáquelo y repita este paso.

FR: **Remarque :**

1. Assemblez d'abord le tiroir du bas pour éviter qu'il ne bascule.
2. Si le tiroir ne s'insère pas correctement, veuillez le retirer et répéter cette étape.

# Step 18

		
<b>E</b> x8	<b>G</b> x8	<b>K</b> x1

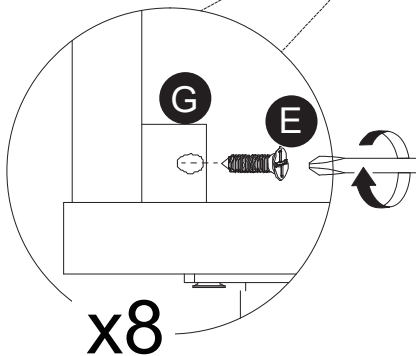
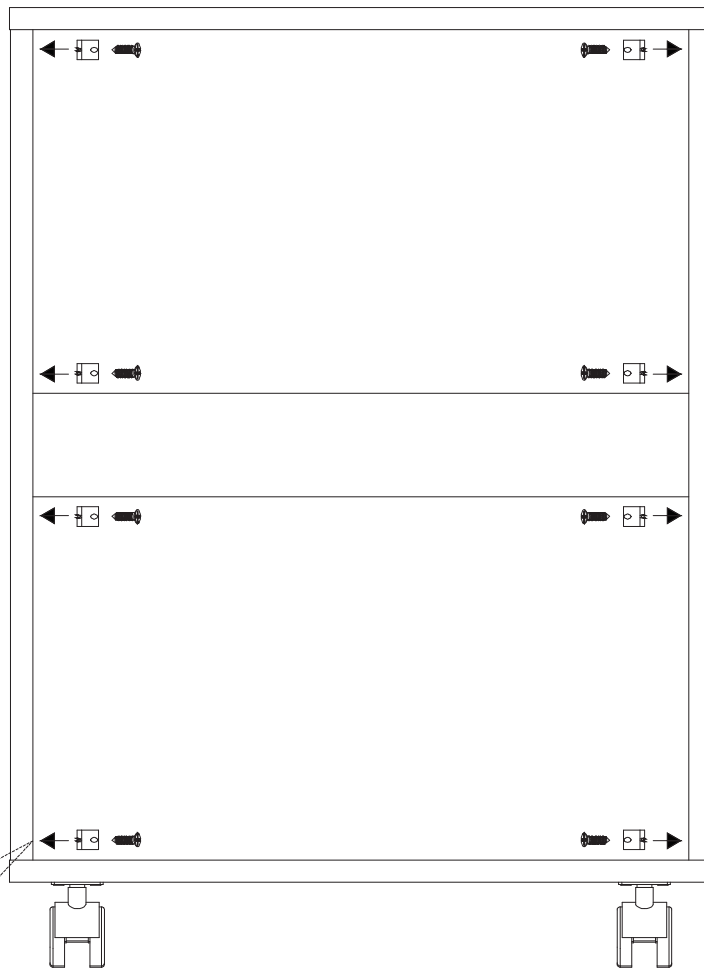
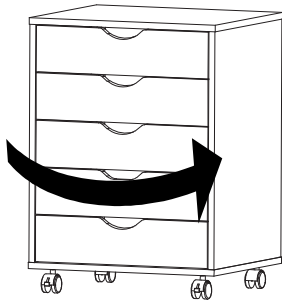

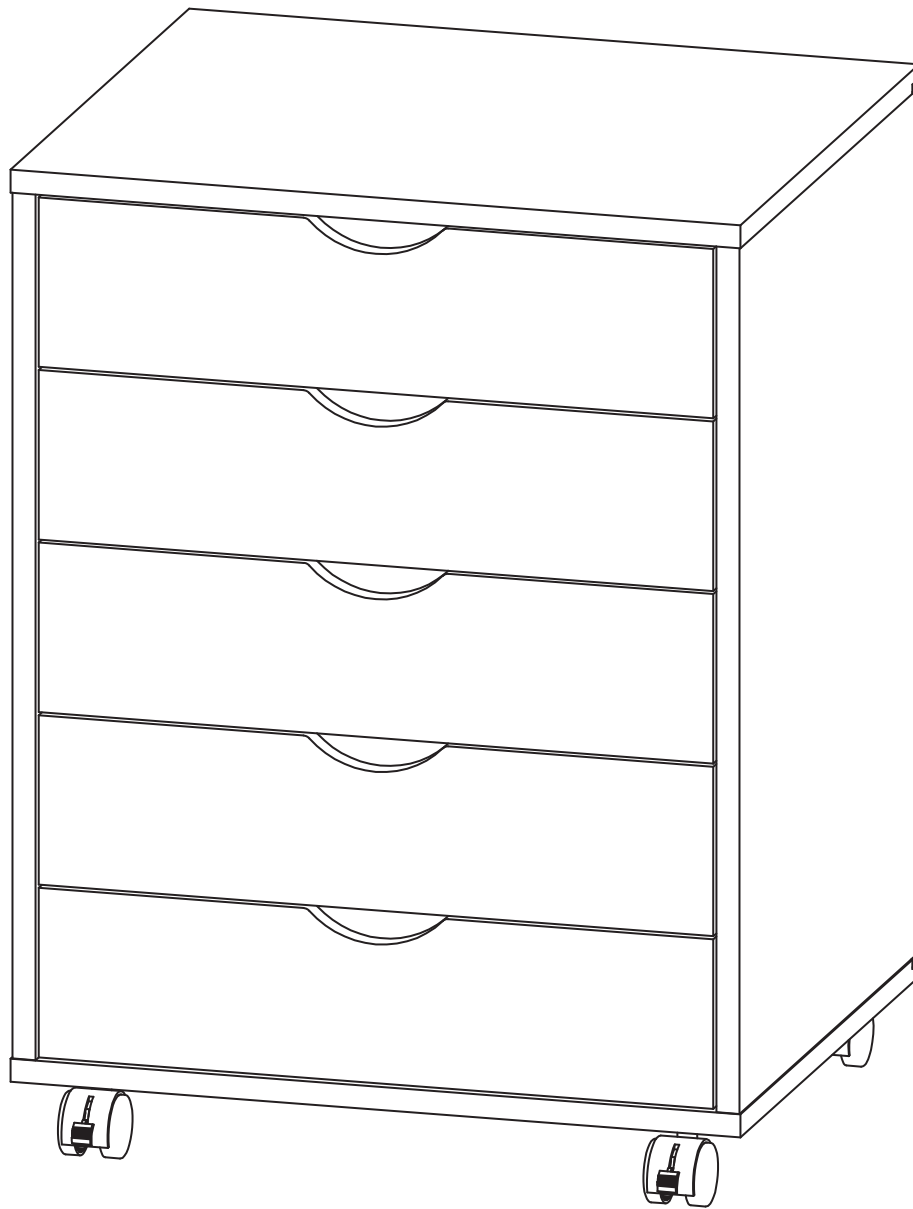

Thank you for choosing this product. We strive to provide you with the best quality products and service in the industry. Should you have any issues, please don't hesitate to contact us.