

INSTRUCTION MANUAL



Model No.: HL-6610

WARNING



Please read the instructions carefully and follow the assembly steps.

To ensure proper assembly, please follow all steps and use all parts provided. Not following this warning may result in serious injury to you or others.

To prevent misalignments, keep the screws loose and do not tighten them until they are all in their correct positions.

Avoid overtightening or forcing the screws, as this could cause them to break, strip, or damage the threads of the holes.

Using the wrong size of screws for a particular part could cause damage to the screw or the part.

Please lubricate all moving parts regularly and tighten all bolts and screws every 6 months, or as needed.

SAFETY INFORMATION

WEIGHT CAPACITY FOR SEATING: 265 LBS



Sit in the center of the chair with your back against the backrest



Do not sit at the front edge of the chair



Do not stand on the chair



Do not use the chair with more than one person



Do not push the chair around when a person is sitting in it



Do not push down on the backrest when a person is reclined



Do not place all your weight on the backrest only

ASSEMBLY PARTS AND TOOL

BEFORE YOU GET STARTED, A FEW POINTERS:



Having a friend to help makes assembly extra-easy



Please use the included wrench instead of an ELECTRIC HAND DRILL in case of damage to the product.

A

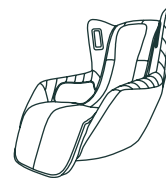

Main body *1

B

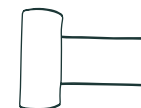

Head Cushion *1

C



Center connecting support *1

D

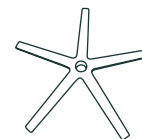

Five-foot support *1

E

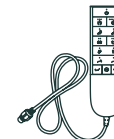

Remote Control *1

F



Power Cord *1

ASSEMBLY INSTRUCTIONS

Step 1

Put the chair upside down on the floor, insert Center Connecting Support C into the groove on the bottom of Main Body A, and connect Five-foot Support D.

Note: Fit the first side of Center connecting support C to the fixing device.

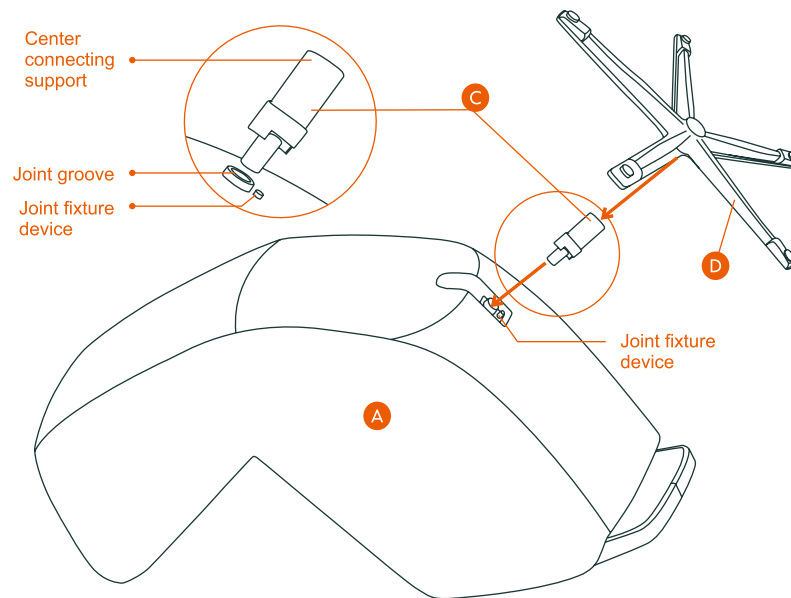

ASSEMBLY INSTRUCTIONS

Step 2

Thread Head Cushion B through the holding strap on backrest, and adjust it's position until it is secure.

Note: Flip head cushion over back of chair when using massage function.

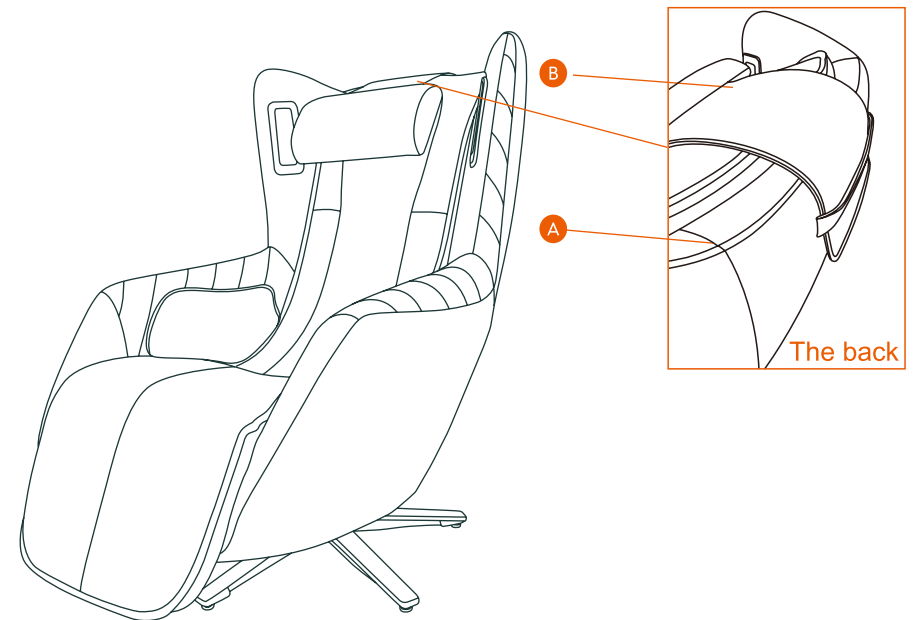

ASSEMBLY INSTRUCTIONS

Step 3

Insert Remote Control E into the remote control terminal on Main Body A and tighten the screw cap. Insert Power Cord F into the power port, and turn on the power.

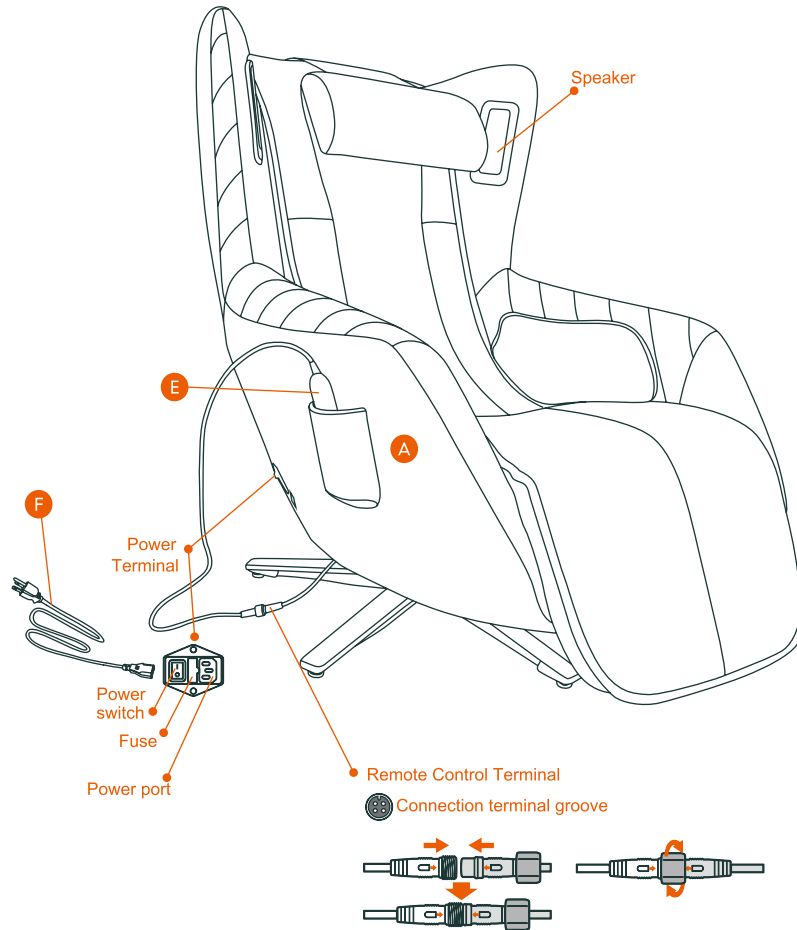

ASSEMBLY INSTRUCTIONS

Step 4

Using Remote Control E, test the massage function of the chair. Now your chair is successfully assembled.

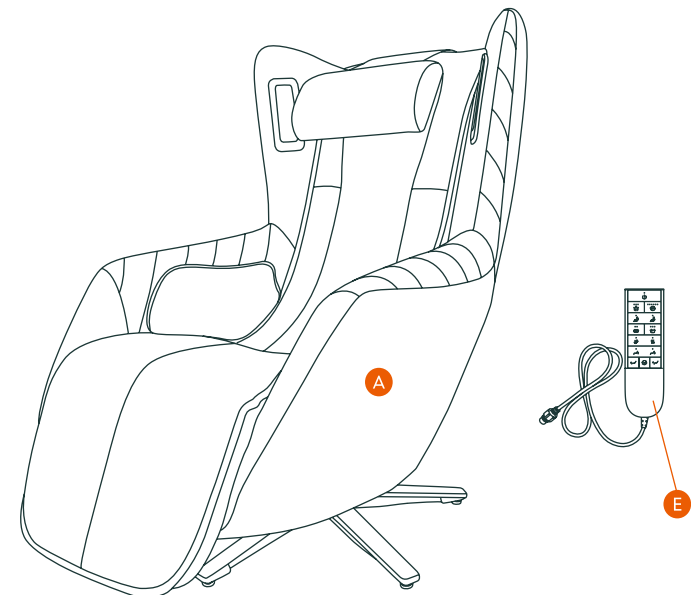

USAGE INSTRUCTION

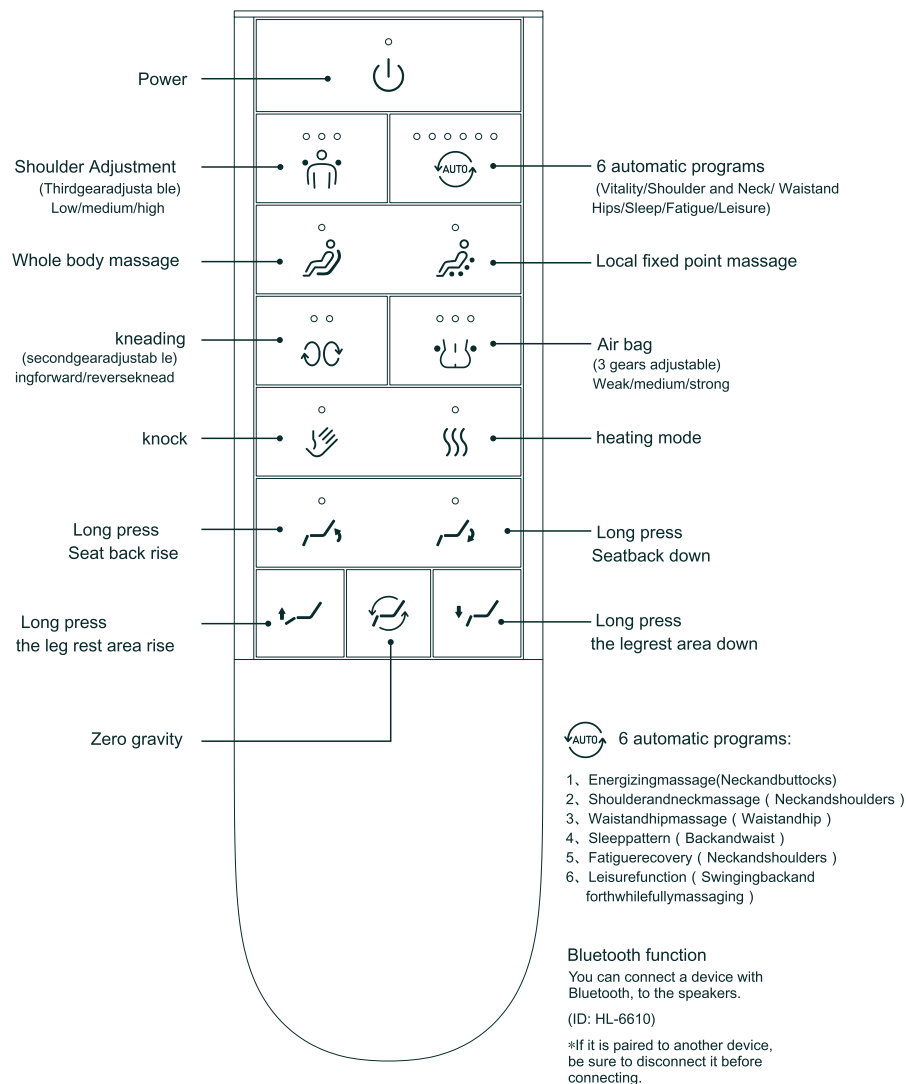

SAFETY PRECAUTIONS

Please adhere closely to the following safety precautions to ensure that your product is used properly and safely.

During installation

Do not modify, disassemble or repair other than service provider.

>It may cause fire/electric shock.

Use on a flat surface.

>It may cause failure or accident.

Power-related

If it does not turn on or cause an error, immediately unplug the power connected to the outlet and request for after-service care.

>It may cause an electric shock, short circuit, or fire.

Make sure the upholstery is not torn or stripped in appearance. The material may get caught in the massage mechanism which may result in a serious accident. If there is any damage, please contact the support center.

>It may cause electric shock or injury.

Do not allow children to touch the power plug.

>There is a risk of electric shock or injury.

Do not bend the power plug too hard or break it by pressing it against any heavy object.

> Risk of fire and electric shock.

Do not use multiple devices simultaneously when using a multi outlet adapter.

> Risk of fire due to overheating of the outlet.

When disconnecting the power plug, hold the plug and Do not pull from the wire.

> If the power cord becomes torn or damaged, there is a risk of fire and electric shock.

Remove any contaminant, moisture, etc from the pins of the power plug.

>It may cause electric shock / fire.

Do not touch the power plug with wet hands. Always disconnect the power plug when cleaning.

>There is a risk of electric shock.

This product is intended to be used exclusively with 120V.

> Risk of fire due to the high heating of the outlet.

Be sure to use a ground-type outlet when using the multi-tap.

> Use of non-grounded multi-tap-outlets can cause electric shock and injury.

In the event of power failure, immediately turn off the power switch and unplug the power from the outlet.

>It may cause accidents when the power is turned on again.

When in Usage

For safety reasons, persons with the following conditions or ailments should not use this product.

People with thrombosis, embolism, severe venous, acute venous, etc.

A person suspected of having whiplash.

A person with symptoms of a sudden contraction of a spasm or muscle.

A pregnant woman in the early stages of pregnancy or right after childbirth.

A person with an abnormality in the spine or misaligned to the left or right due to accidents or diseases.

People with acute appendicitis and severe heart failure.

People who are using human implanted electronic medical devices such as implanted heartbeats.

A person with seizures or a psychogenic disease.

A person who has lost a sense of temperature due to a high degree of peripheral circulation from diabetes, etc.

A person with an osteomyelitis.

A Person who is not free of expression and movement of their body.

Someone with spine symptoms or under spine treatment.

SAFETY PRECAUTIONS

A person who is being treated at a medical institution because of a special physical defect.
Persons with any of the following conditions should consult a physician before using this product.

People who are concerned about side effects from the use of this product such as pregnant women.

A person whose body temperature is higher than normal due to acute inflammation.

People with skin disease, malignant tumors, and other symptoms of skin disease.

Someone who needs stability because they are being treated by a doctor.

Other people who feel an abnormality in their bodies.

A person whose doctor forbade massage.

A person or a person with weak muscles due to older age

A person with back pain.

Do not use or store in humid areas such as bathrooms.

> It may cause electric shock, fire, failure, and mold.

Do not allow children to play or climb on the massage chair

> There is a risk of falling or injury.

Do not wear anything hard on your head, such as headgear.

> It may cause injury.

Use time is 30 minutes per day, 15 minutes per usage, and only 5 minutes for continuous use in the same area.

> Long-term use can strain muscles or nerves.

If you experience any of the following side effects while using the product, please stop using it :

Posture damage, bruises, stab wounds, cuts from the product.

Excessive usage of this product can cause damage to muscles and tendons, nerves, vertebrae, etc.

Skin disease, burns, etc.

Fractures, bone dislocation, abrasion, etc.

Respiratory system failure and suffocation, etc.

When massaging your hips and thighs, take out all objects out of your pants pocket.

> There may be an accident or injury.

During the massage operation, do not disconnect power from the outlet or turn the power switch on/off.

> It may cause an accident.

Do not use it near fireplaces, or while smoking. Also, do not use it with heating appliances such as an electric pad.

> It may cause a fire.

Do not use it after drinking alcohol.

> There may be an accident or injury.

Do not allow more than one person to get on the product or use it at the same time.

> Cause of falling or injury.

The maximum load of this product is 120kg.

> Do not use for anyone over 120kg as this may damage the product or cause injury.

Do not use on bare skin.

> When using the massage chair on bare skin, it can cause skin damage due to the heated seat and massage ball movements.

Be careful not to trip over the remote control cable.

> There is a risk of injury.

When cleaning the product, disconnect the power plug from the outlet

> Causes electric shock or injury.

FCC WARNING

Any Changes or modifications not expressly approved by the party responsible for compliance could void the user's authority to operate the equipment. This device complies with part 15 of the FCC Rules.

Operation is subject to the following two conditions:

1. This device may not cause harmful interference.
2. This device must accept any interference received, including interference that may cause undesired operation.

Note: This equipment has been tested and found to comply with the limits for a Class B digital device, pursuant to part 15 of the FCC Rules. These limits are designed to provide reasonable protection against harmful interference in a residential installation. This equipment generates uses and can radiate radio frequency energy and, if not installed and used in accordance with the instructions, may cause harmful interference to radio communications. However, there is no guarantee that interference will not occur in a particular installation. If this equipment does cause harmful interference to radio or television reception, which can be determined by turning the equipment off and on, the user is encouraged to try to correct the interference by one or more of the following measures:

- Reorient or relocate the receiving antenna.
- Increase the separation between the equipment and receiver.
- Connect the equipment into an outlet on a circuit different from that to which the receiver is connected.
- Consult the dealer or an experienced radio/TV technician for help.

FCC 20cm Statement

This equipment complies with FCC radiation exposure limits set forth for an uncontrolled environment. This equipment should be installed and operated with a minimum distance of 20cm between the radiator & your body. This transmitter must not be co-located or operating in conjunction with any other antenna or transmitter.

GROUNDING INSTRUCTION

This product must be grounded. If it should malfunction or breakdown, grounding provides a path of least resistance for electric current to reduce the risk of electric shock. This product is equipped with a cord having an equipment-grounding conductor and a grounding plug. The plug must be plugged into an appropriate outlet that is properly installed and grounded in accordance with all local codes and ordinances.

DANGER - Improper connection of the equipment-grounding conductor can result in a risk of electric shock. Check with a qualified electrician or serviceman if you are in doubt as to whether the product is properly grounded. Do not modify the plug provided with the product- if it will not fit the outlet, have a proper outlet installed by a qualified electrician.

This product is for use on a nominal 120-volt circuit, and has a grounding plug that looks like the plug illustrated in sketch A in following figure. A temporary adapter that looks like the adapter illustrated in sketch B and C may be used to connect this plug to a 2-pole receptacle as shown in sketch B if a properly grounded outlet is not available. The temporary adapter should be used only until a properly grounded outlet (sketch A) can be installed by a qualified electrician. The green colored rigid ear, lug, or the like extending from the adapter must be connected to a permanent ground such as a properly grounded outlet box cover. Whenever the adapter is used, it must be held in place by a metal screw.

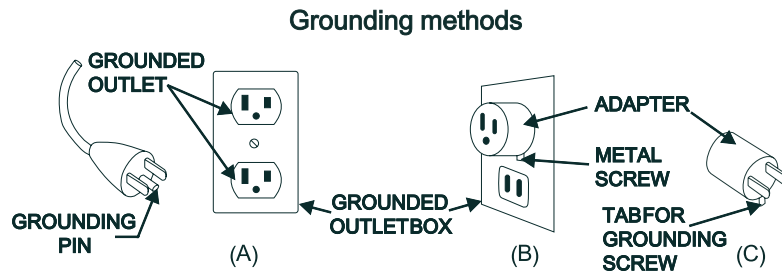

No adapters should be used with this product in Canada

LIMITED WARRANTY

be defective in material or workmanship within one year from the date of original purchase so long as you, the original purchaser, still owns it. This is your sole and exclusive remedy. This warranty is subject to the provisions below.

EXCLUSIONS

This warranty does not apply and no other warranty applies to:

- Normal wear and tear, which are to be expected over the course of ownership.
- Misuse, abuse, or excessive use of the product.
- Modifications or attachments to the product that are not approved by COLAMY.
- Products that were not installed, used, or maintained in accordance with product instructions and warnings.
- Products used for rental purposes or unauthorized retail activities.

Seating Usage: Normal use for seating is identified as the equivalent of a single shift, forty- (40) hour workweek. To the extent that a seating product is used in a manner exceeding this, the applicable warranty period will be reduced in a pro-rata manner.

RETURN POLICY

We adopt a 30-day return policy which means that all products purchased on this website may be returned to us within the timeframe. You need to contact us within 30 days after the product(s) came into your possession and the product(s) must be returned to us without any undue delays.

Returned products must be returned in the same condition as they were sent and they must be sent in their original packaging.

If the product is not faulty, (i.e. if you changed your mind or if you are unhappy with the product for some other reason), the cost of shipping will fall on you. And it is your responsibility that the package arrives safely to us so we recommend that you use a courier service where it is possible to track the shipment.

LIMITED WARRANTY

If the product is faulty when you receive it, please contact us and we will help you out.

We reserve the right to give a partial refund in cases when the product(s) is not in an unused condition, is damaged or has missing parts, not due to our error.

HOW RETURNS WORK

To request a return, please fill out the contact form on our website and attach a copy of your invoice as proof of purchase and the reason for your return in the message.

Then we will provide the return address for the product as soon as possible.

Once the returned product has been received by us and inspections have been completed, a specific disposition will be provided to you.

In addition, if the return is approved, the refund amount will be automatically credited to your original payment method.

SPECIFICATION

Product Name	Massage Chair
Product size	115.5×72.5×105.5 (cm)
package size	142×75×65 (cm)
Net weight	51 kg
Gross weight	64.6 kg
Pated voltage	110V~ 50-60Hz
Pated input current	1 A