



INSTRUCTION MANUAL

3-Piece Table and Chair Set

As shoppers, we're always trying to find the perfect balance between quality & value. At BCP, we believe we've achieved that. Our diverse catalog of everyday essentials is tailored especially to our customers & guaranteed to hit that sweet spot of high quality & low price.

— Always. —

! NOTICE

- Please do not exceed the weight limitations of this item.
- Do not stand on or use any part of this item as a step ladder.
- Firmly secure all bolts, screws and knobs before use.
- Reconfirm that all bolts, screws, and knobs are secure every 90 days.
- Fasten screws loosely during assembly. Do not firmly tighten screws until item is fully assembled.
- Do not use or store this item in the proximity of open flame or flammable/combustible chemicals.
- Be aware that some parts are heavy and have sharp edges.
- If any parts are missing, broken, damaged, or worn, stop using this product until repairs are made and/or factory replacement parts are installed.
- Do not use this item in a way inconsistent with the manufacturer's instructions as this could void the product warranty.

TOOLS REQUIRED



110 LBS
CAPACITY
TABLE



330 LBS
CAPACITY
CHAIR



1 PERSON
ASSEMBLY



APPROXIMATELY
30 MIN.
ASSEMBLY

HARDWARE

1

M6 X 35MM
SCREW



24 PCS

2

M6 X 12MM
SCREW



16 PCS

PARTS

A

SIDE FRAME



2 PCS

B

SUPPORT

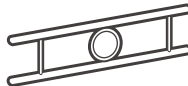

2 PCS

C

STORAGE
SHELF



1 PC

PARTS

D

TABLETOP



1 PC

E

CHAIR
SUPPORT



2 PCS

F

CHAIR
BACKREST

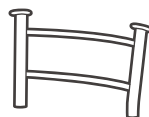

2 PCS

G

CHAIR LEG I



2 PCS

H

CHAIR LEG II



2 PCS

I

SEAT



2 PCS

PRODUCT ASSEMBLY

1

Attach two part B supports and part C storage shelf to two part A side frames with twelve part 1 screws.

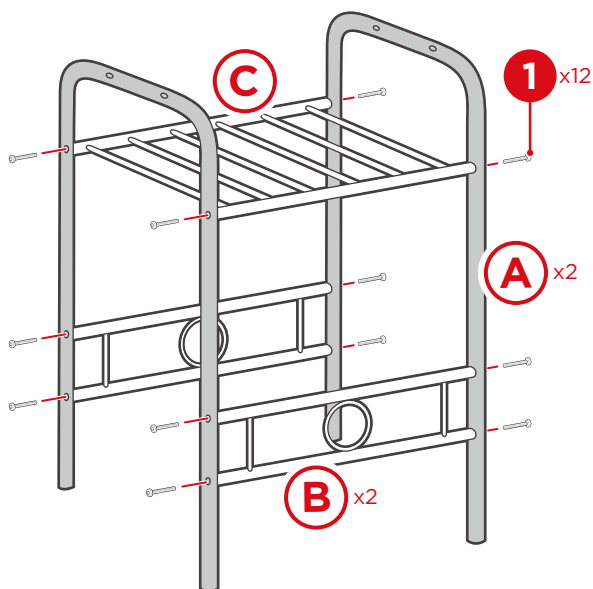

PRODUCT ASSEMBLY

2

Flip the table frame over. Attach part D tabletop with four part 1 screws.

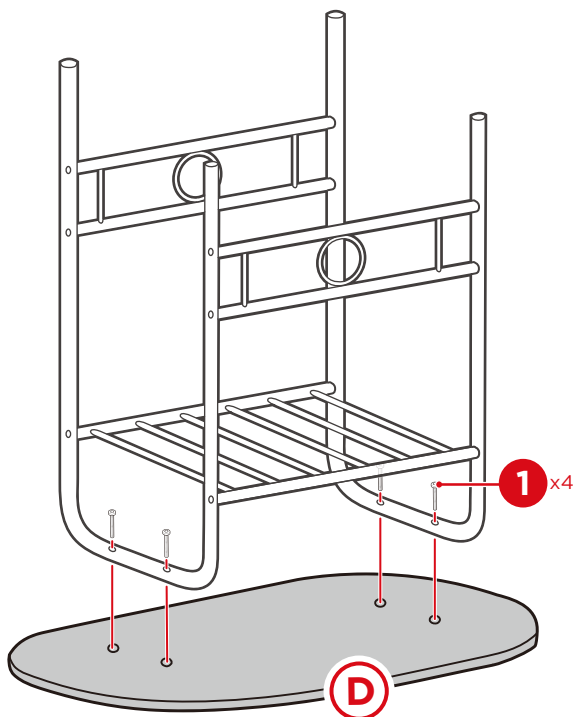

3

Attach a part E chair support to a part F chair backrest with four part 2 screws.

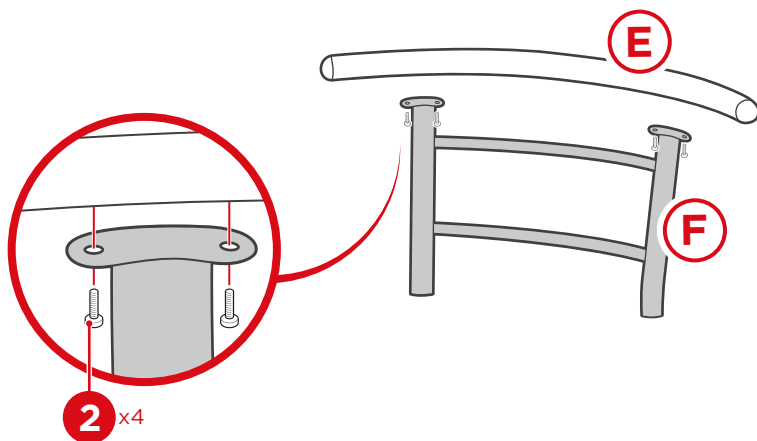

PRODUCT ASSEMBLY

4

Overlap the part G and H chair legs and attach them to the backrest with four part 2 screws.

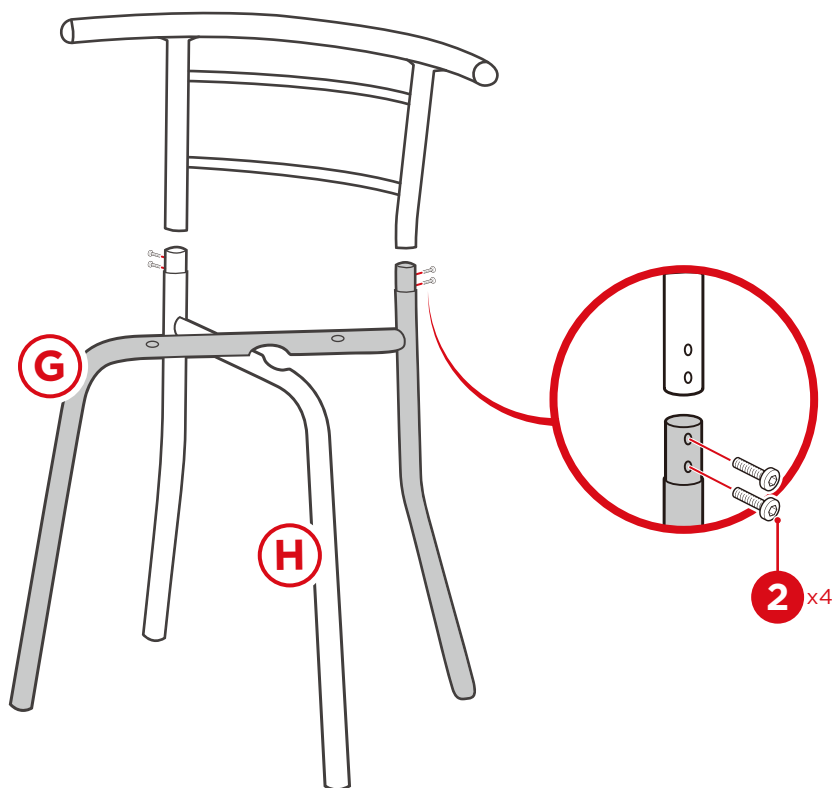

PRODUCT ASSEMBLY

5

Attach a part I seat with four part 1 screws.
Repeat steps 3 to 5 to build another chair.

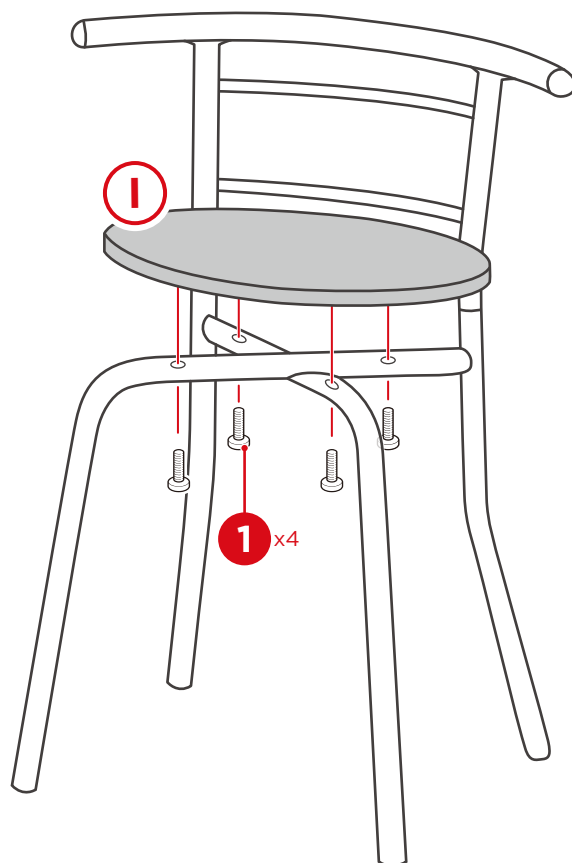



Product Assembly



Returns & Refunds

PRODUCT WARRANTY INFORMATION

All items can be returned for any reason within 60 days of the receipt and will receive a full refund as long as the item is returned in its original product packaging and all accessories from its original shipment are included. All returned items will receive a full refund back to the original payment method. All returned items will not be charged a re-stocking fee.

All returned items require an RA (Return Authorization) number, which can only be provided by a return request is submitted. Items received without an RA may not be accepted or may increase your return processing time. Once an item has been received refunds or replacements will be processed within 5 business days.

All returns must be shipped back to the Center at the customer's expense. If the reason for return is a result of an error by then we will provide a pre-paid shipping label via email. Boxes for return shipping will not be provided and is the customer's responsibility to either use the original shipping boxes or purchase new boxes.

Pictures may be required for some returns to ensure an item is not damaged prior to its return. Items returned are not considered undamaged until they are received and verified as such. All damages to items are the customer's responsibility until the item has been received by and acknowledge as undamaged.

WARNING

Manufacturer and seller expressly disclaim any and all liability for personal injury, property damage or loss, whether direct, indirect, or incidental, resulting from the incorrect attachment, improper use, inadequate maintenance, unapproved modification, or neglect of this product.