

①

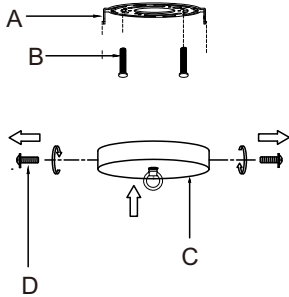

Step1.

- 1.Remove (A) from (C) by unscrewing (D).
- 2.Screw (A) to ceiling by (B).

②

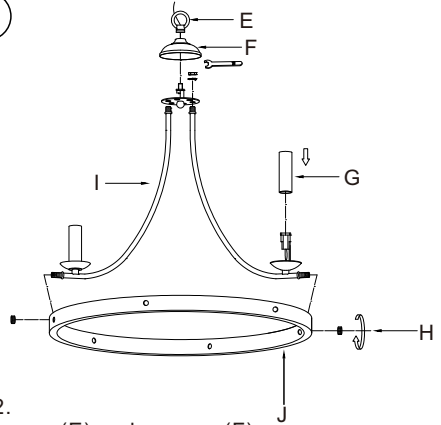

Step2.

1. Unscrew (E) and remove (F).
2. Use Screwdriver to tighten (I) and screw (H) to connect (J).
3. Place (G) cover holders.
4. Retighten (F) by (E) (reversal of step 2.1).

③

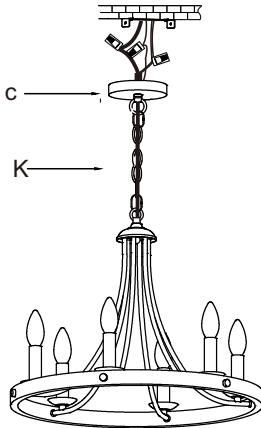

Step3.

1. Determine the desired length of the fixture and feed the wire through the (K) and (C).
2. Connect black fixture wire to black supply wire and white fixture wire to white supply wire using wire caps (provided).

④

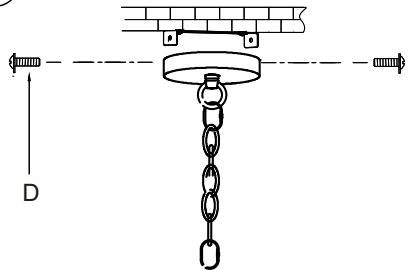

Step4.

1. Reinstall (D) (reversal of step 1.1).

GETTING STATED

1. Make sure all parts are included before discarding any packing materials.
2. Shut off main electrical supply at fuse box or circuit breaker. Simply turning the power off using the light switch is not sufficient to prevent electrical shock!
3. Insert the light source after finishing the light fixture.
4. Requires installation by a licensed Electrician.