

# Installation Instruction

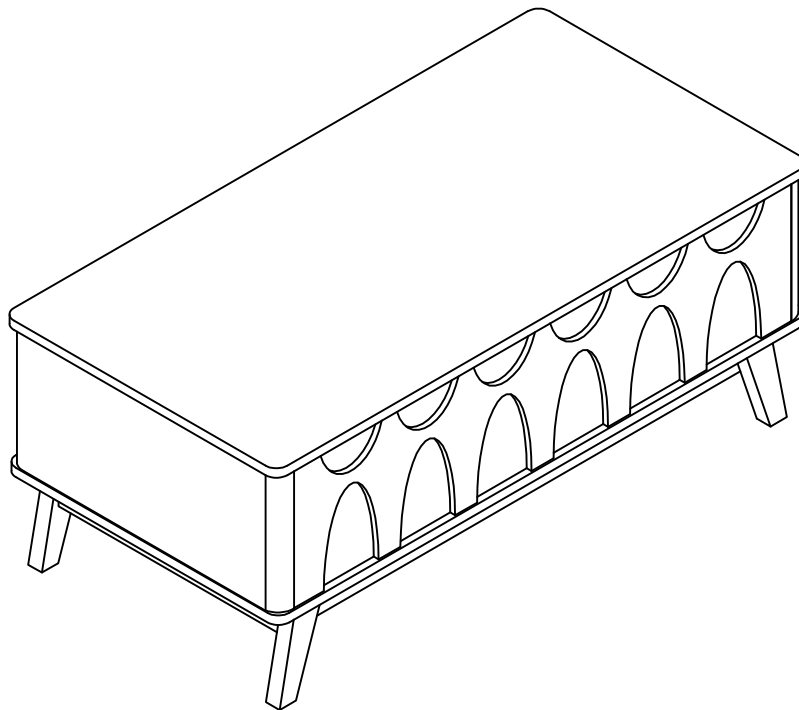

# Assembling

---

## What you need

- Use the packaging carton as a working surface to prevent product damage during assembly
- Phillips head screwdriver

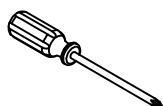

## Weight Limitation

**100** | **35**  
 lbs table top    lbs per

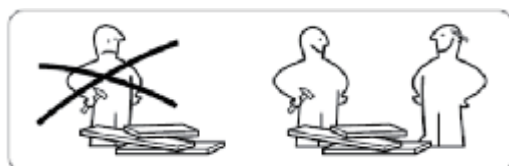

# What' included

---

Code	Description	Qty
A	Cam Bolt M6X35MM	26
B	Cam Lock 15X9MM	26
C	Wooden Dowel M8X30MM	12
D	Screw M4X50MM	10
E	Screw M3.5X14MM	20
F	Left regulator	1
G	Right regulator	1
H	Foot nail	4
I	Wrench M4X55MM	1
J	Screw M6X25MM	10
K	Phillips screwdriver	1
L	Hole position sticker	18
M	Hole position sticker	8

# The Hardwares

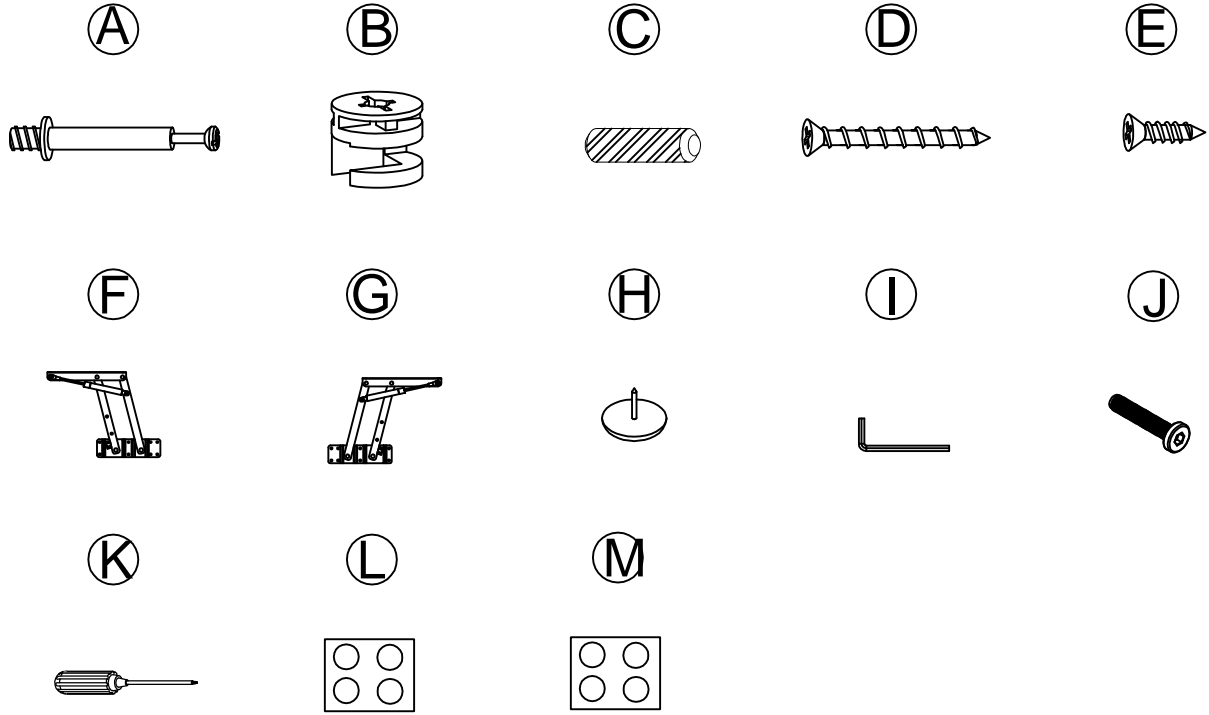

**IMPORTANT:**

- 1. Do not tighten bolts / screws completely until all bolts / screws are lined up and inserted into holes.
- 2. Do not over tighten screws and bolts to avoid stripping
- 3. Please use hand tools to assemble this product, you can also use power tools (please use power tools carefully)

# Included Accessories

Code	Description	Qty
1	Cabinet Top	1
2	Bottom Panel	1
3	Left Side Panel	1
4	Right Side Panel	1
5	Front apron	1
6	Backboard	1
7	Foot left and right connecting plate	2
8	Foot front and rear connecting plates	2
9	Connecting pipe	1
10	Solid wood foot	2
11	Solid wood foot	2

# The Accessoriess

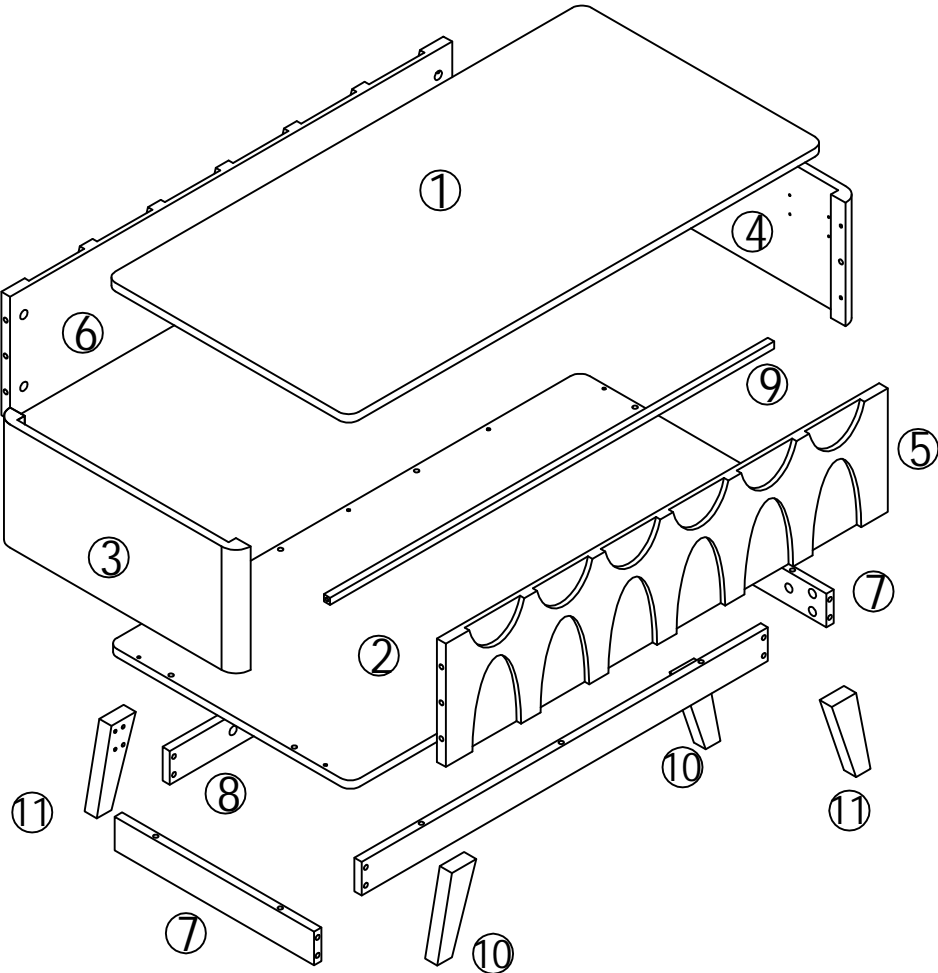

# Step 1

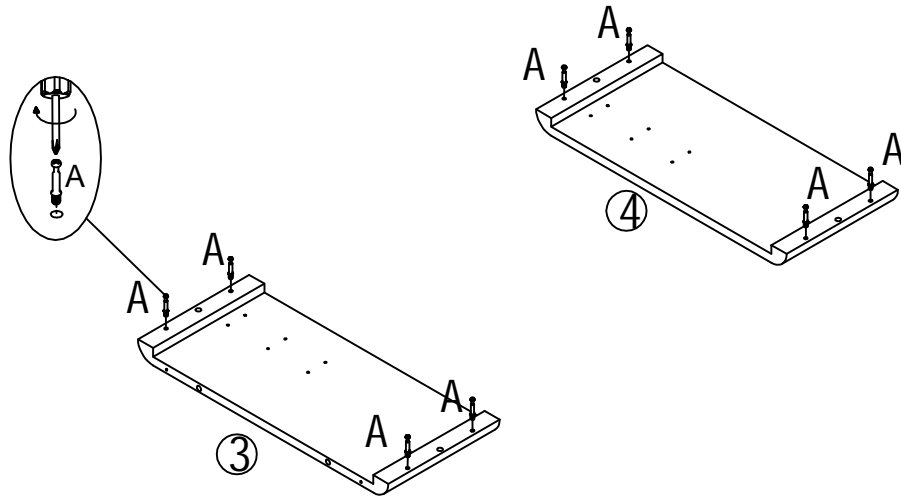
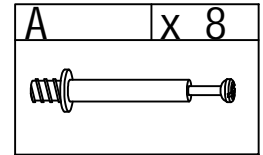

# Step 2

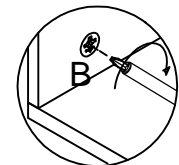
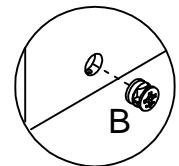
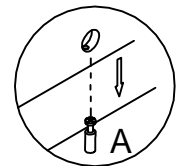
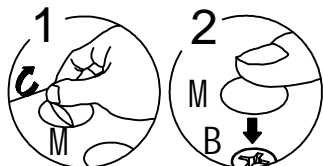
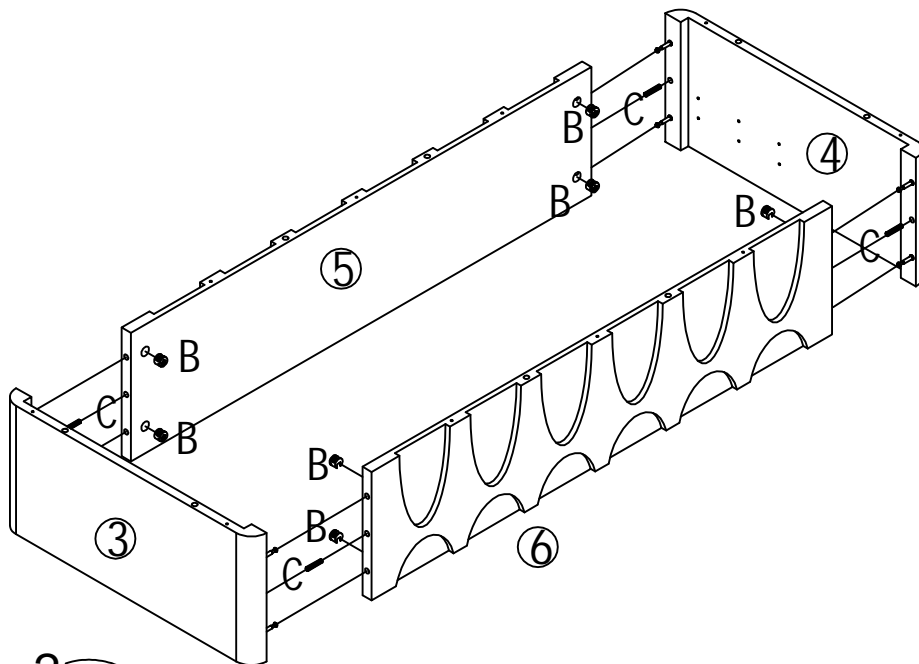
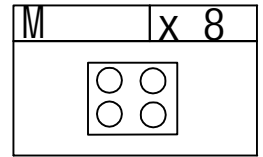
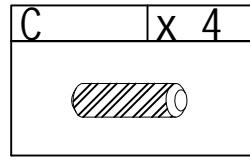
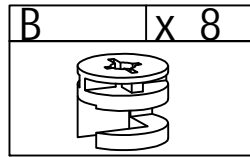

# Step 3

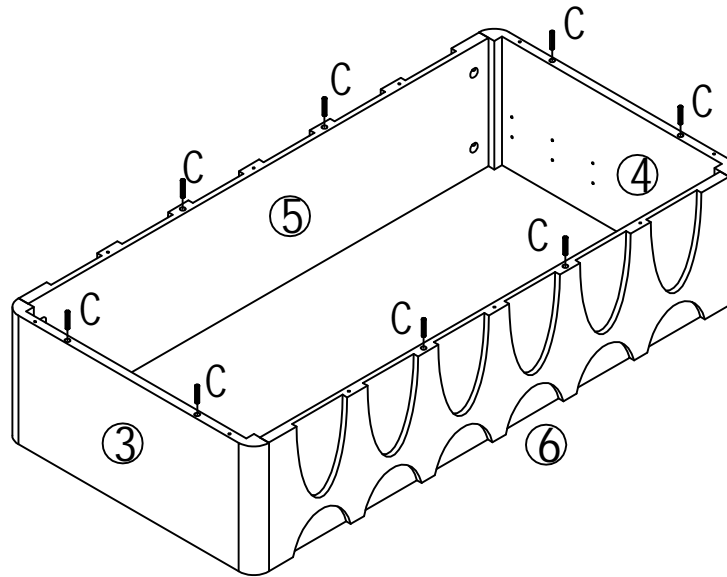
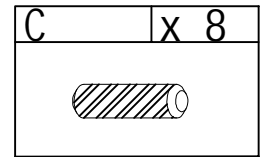

# Step 4

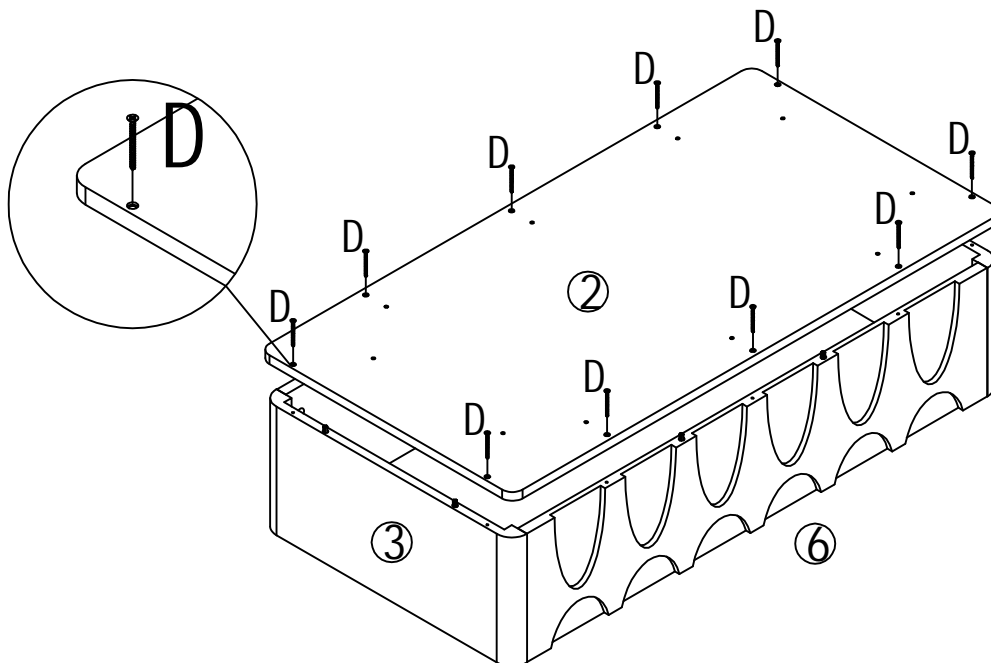
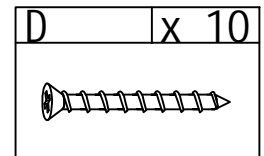

# Step 5

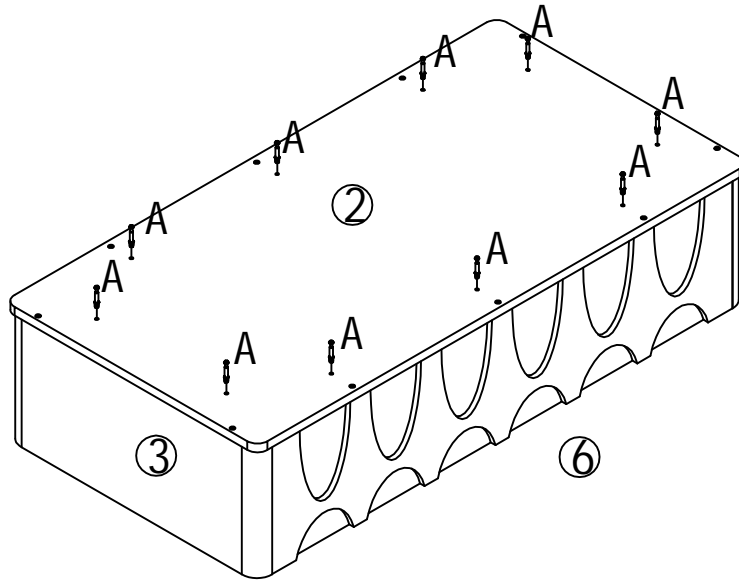
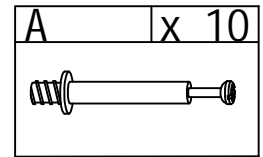

# Step 6

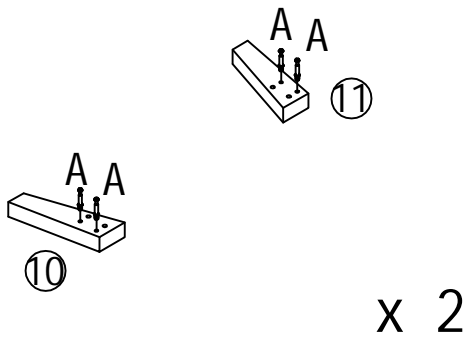
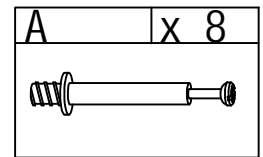

# Step 7

Pay attention to screw J do not lock lock to 90 percent.

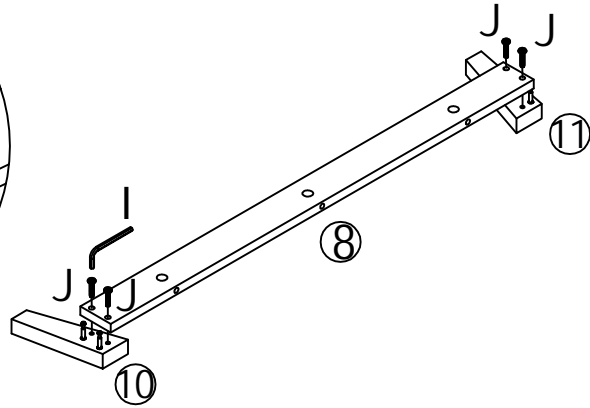
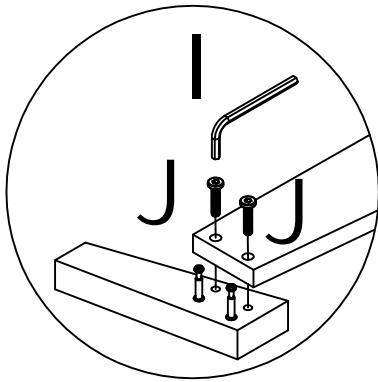
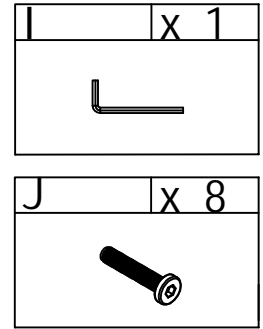

x 2

# Step 8

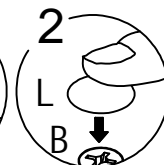
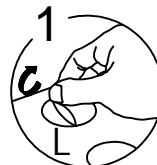
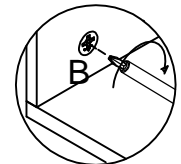
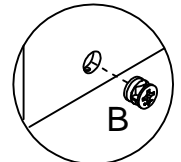
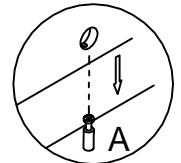
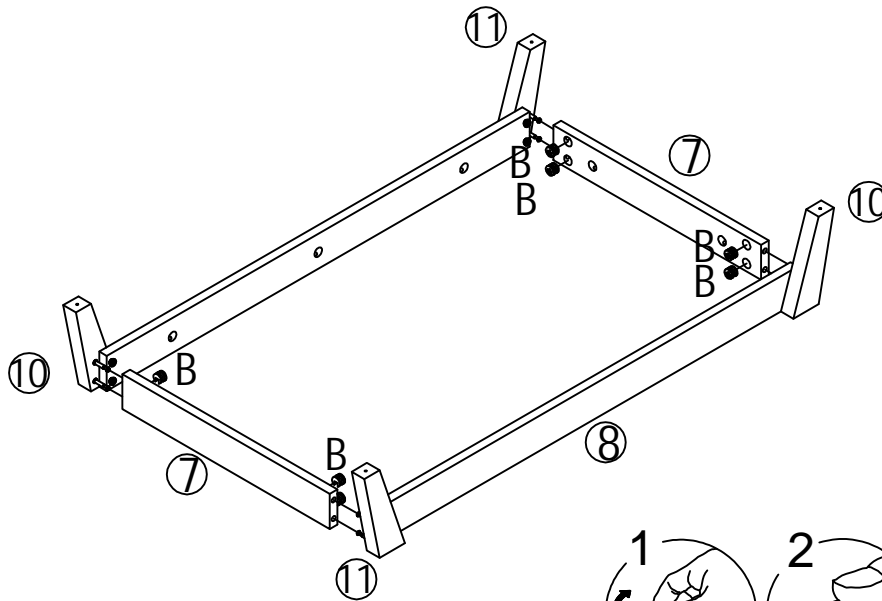
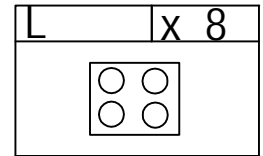
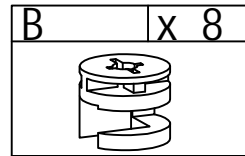

# Step 9

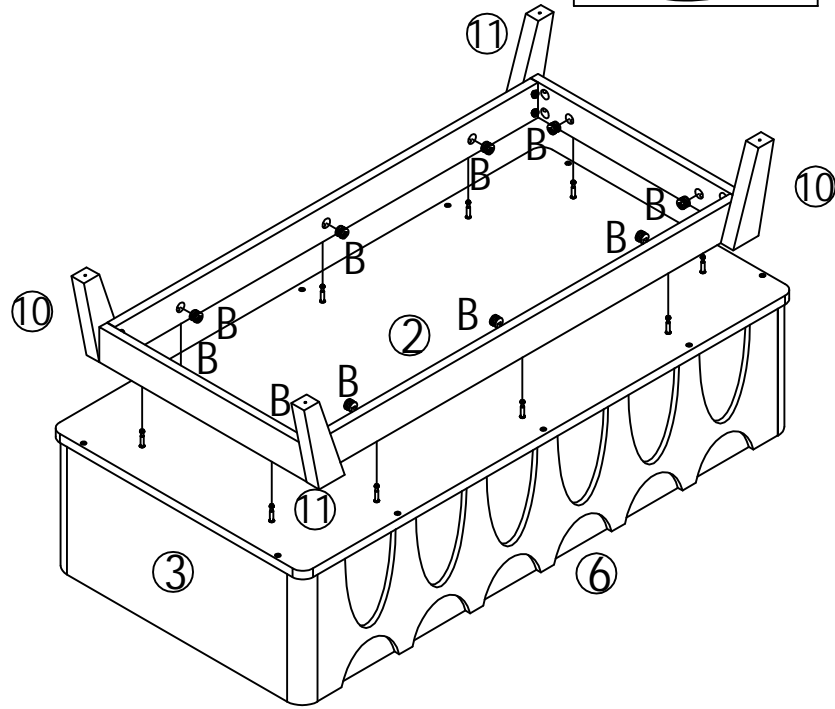
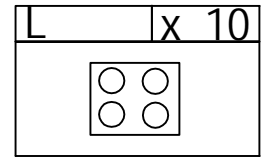
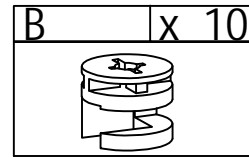

# Step 10



Lock the screw  
J 100%

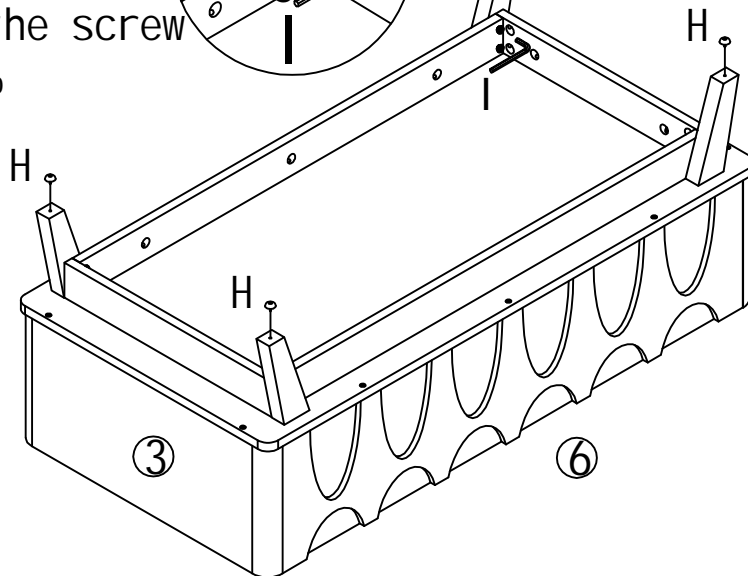
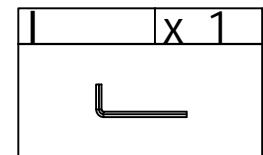
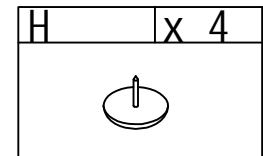
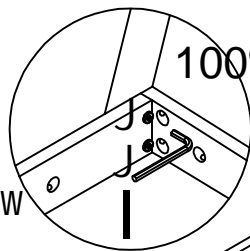

# Step 11

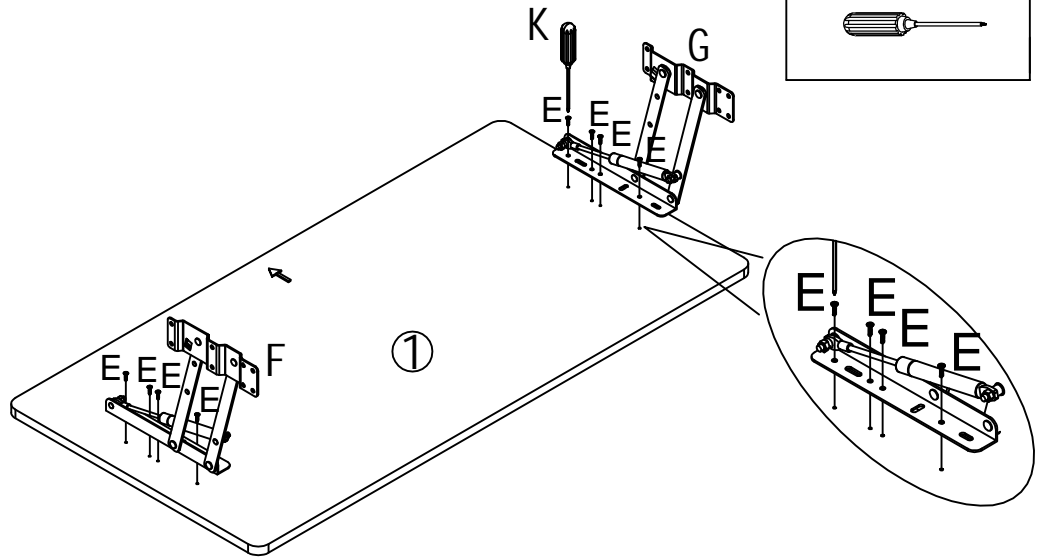
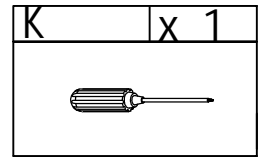
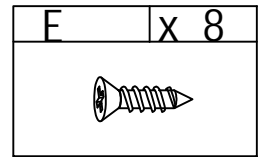
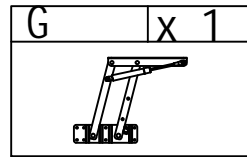
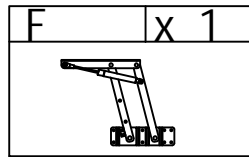

# Step 12

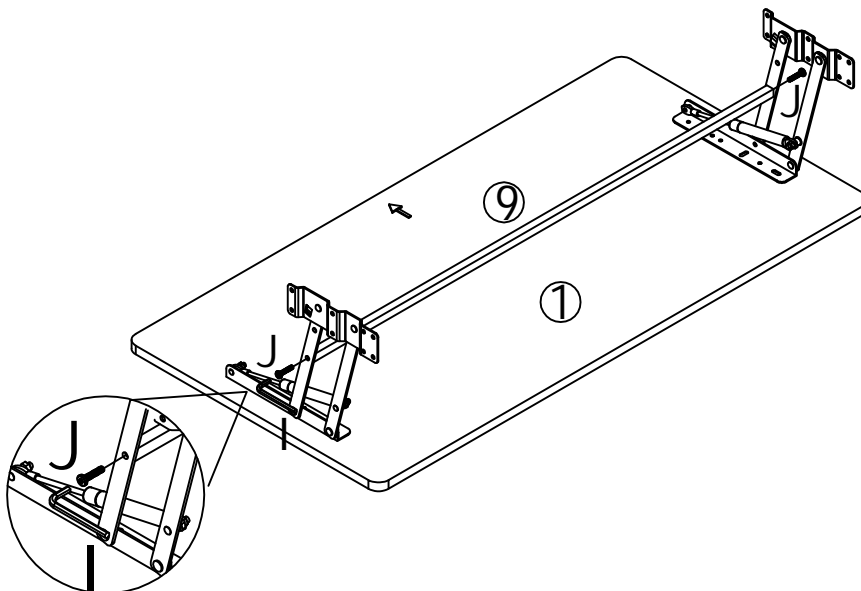
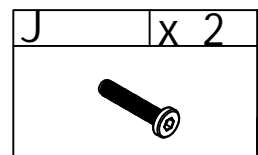
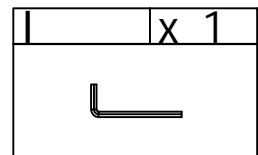

# Step 13

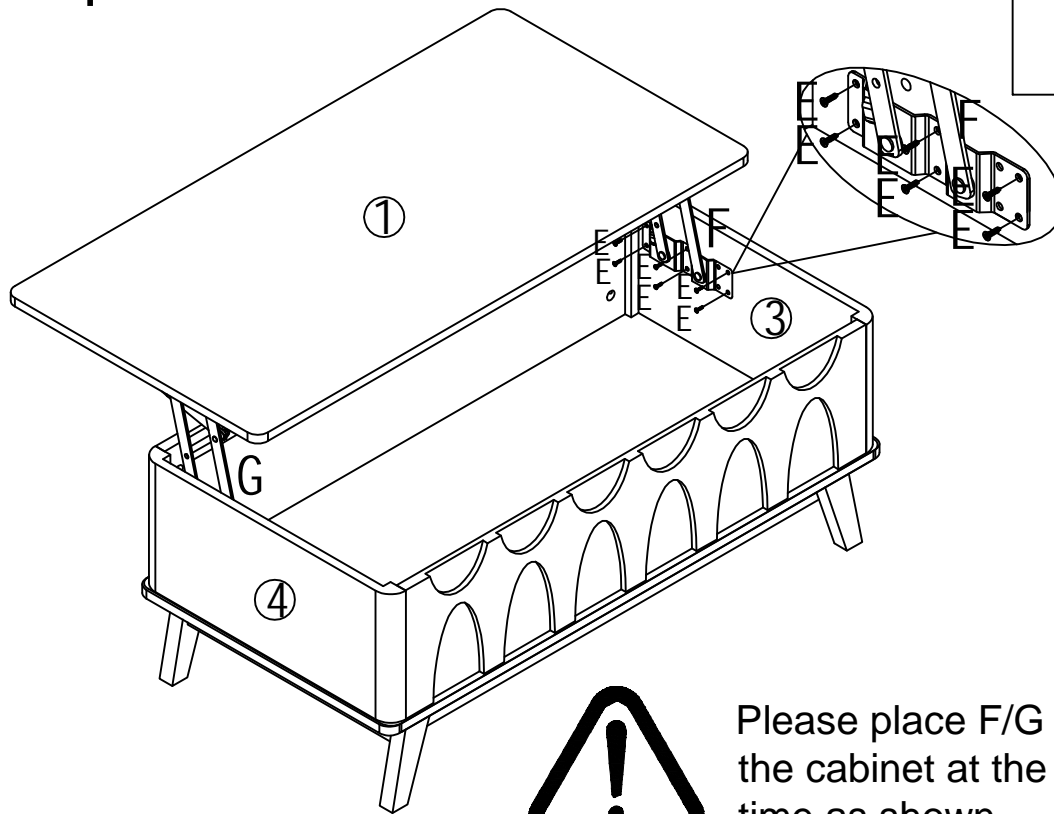
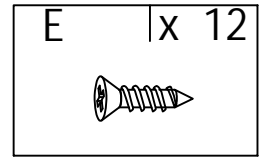

Please place F/G inside the cabinet at the same time as shown

# Step 14

