

OPERATING INSTRUCTIONS

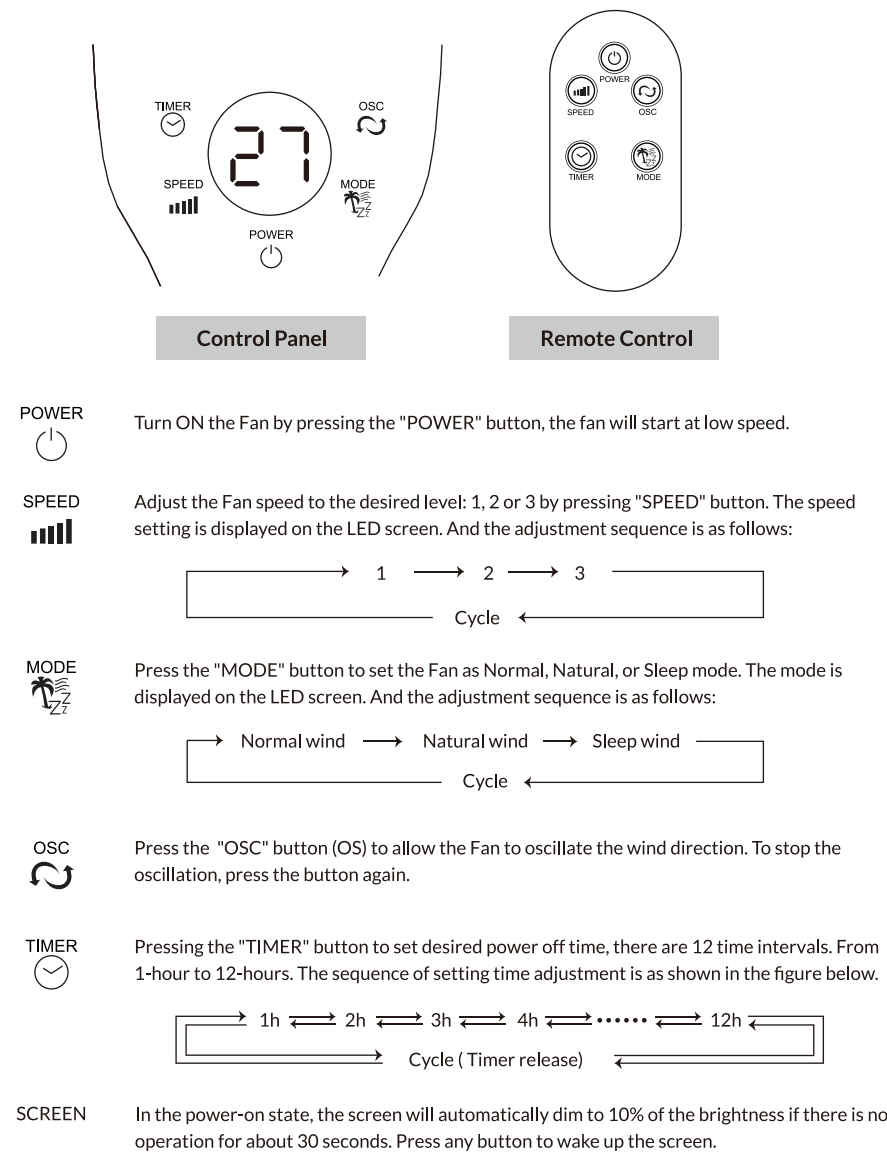

-6-

Replacing the Remote Control Battery

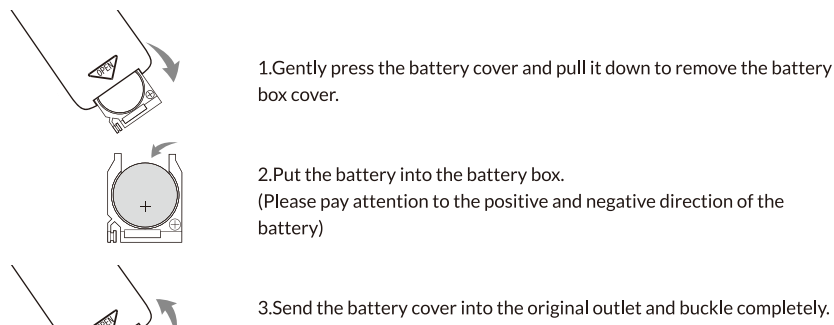

WARNING! Chemical Burn Hazard. Keep batteries away from children.

- This product contains a lithium button/coin cell battery. If a new or used lithium button/coin cell battery is swallowed or enters the body, it can cause severe internal burns and can lead to death in as little as 2 hours.
- Please remember to close your battery box all the time. If the battery box does not close securely, stop using the product, remove the batteries, and keep it away from children. If you think batteries might have been swallowed or placed inside any part of the body, seek medical attention immediately.
- The cells shall be disposed of properly, including keeping them away from children.
- Even used cells may cause injury.

Accessory: Remote Control

- Be sure to direct the remote control toward the receiver on the control panel.
- Use the remote control within 5 meters from the receiver. If the remote control is not directed towards the receiver; the effectiveness will be reduced.
- Do not place any obstacle between the receiver and remote control.
- Please treat your remote control with care. Knocking or dropping it will reduce its reliability.
- Please store the remote control safely when not in use.
- Remove battery from remote control before storage.

-7-

CLEANING & MAINTENANCE



ALWAYS UNPLUG THE UNIT BEFORE MOVING OR MAINTENANCE. DO NOT IMMERSE THE POWER CORD, PLUG AND THE UNIT INTO WATER OR RINSE UNDER THE TAP !

Caution: Do not use detergent, gasoline, benzene, thinner, or other solvents to clean the unit to avoid damage of the appliance.

- Unplug the unit and wait until the fan stop running before cleaning.
- Use a damp cloth to clean the surface of the fan.
- Use the vacuum cleaner to remove the dust inside the fan, it can use a soft brush for assistance. DO NOT use damp cloth to clean the inside parts of the fan.
- It is recommended to clean the fan every month.
- It is not recommended to take the fan apart, except the authorized agent or any agent qualified to undertake the service.
- If the fan will not be used for a long time, store it in the cool, dry, safety place and far away from children. Do not store the appliance in hot place and under sunshine.
- Unplug the unit before moving or maintenance. Maintenance can only be done by an authorized service agent, such as your local sales dealer or any agent qualified to undertake such service.
- If the unit requires external cleaning, make sure it is unplugged from the power supply. Use a soft tissue or dry cloth for general cleaning. To remove more persistent dirt or grime with a warm soapy dampened cloth. Do not use any solvents (such as thinners), and these may damage the plastic casing.

CAUTION:

The symbol on the product means that at unit cannot be worked or broken, the appliance must not be considered for normal waste but hazardous waste, and must be disposed of in specific recovery and disposal areas, as prescribed by the EC Directive 2002/96/EC (WEEE). By disposing of this product correctly, you can prevent negative consequences for the environment and for human health, due to the presence of potentially hazardous substances in the product.

SPECIFICATIONS

Model	Voltage	Frequency	Power	Noise
A12-FL-001-BK	120V	60Hz	50W	49dB

-8-

mollie

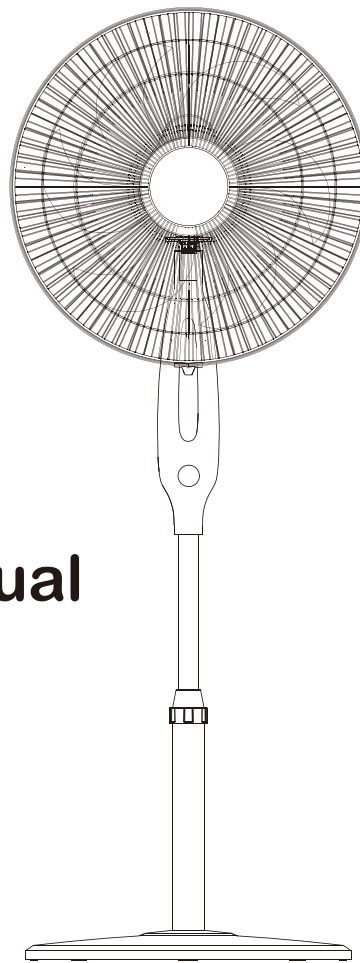

Instruction Manual

**PERESTAL FAN
A12-FL-001-BK**

- Thank you very much for purchasing our pedestal fan.
- Please read this instruction carefully before using this manual.
- For Household Use Only.



SAFETY INSTRUCTIONS

- Check the household voltage to ensure it matches the fan's rated specification before using. This fan is designed for a 120V~60Hz electric supply.
- Do not place the power cord under a cover. Arrange the power cord away from an area where it may be tripped over.
- Please place the fan on a flat, firm, safety surface before use.
- Disconnect the plug from socket when not in use, hold the plug and then pull it out. Do not pull the cord to pull out the plug.
- Please make sure that the fan will not meet any obstruction when oscillating.
- Do not put your fingers or anything else into the front case of the fan at any times. Please pay more attention when using the fan near children, to avoid children play with fan.
- Do not let hair, net curtains, tablecloth, clothes or curtains next to the inlet or outlet of the fan. They could be sucked into the fan, causing damage or injuries.
- Do not use the fan which found the cord or plug or the unit is broken.
- Periodically check the power cord of the fan. If the power cord is damaged, it must be repair by the manufacturer, or the after-sales service provider or a qualified person in order to avoid any danger.
- Do not use this fan outdoor.
- Do not use this fan in a damp area such as bathroom.
- Do not use this fan near the window or expose in the sun shine.
- Do not use this fan with any semi-conductors speed control.
- The fan should not be operated without a base nor used lying on its side.
- Do not operate the fan in an area where gasoline is used or stocked, painting or such flammable liquids.
- Unplug the unit before repair or moving, including for cleaning purpose.
- Do not leave the fan unattended, always unplug it when not in use.
- Use this fan only as it is described in this manual.
- Do not try to throw off this fan, and if you need maintenance, please contact or send the fan back to the agent.
- Keep the fan clean and maintain in good condition (use an authorized service agent).
- The appliance is not to be used by persons (including children) with reduced physical, sensory or mental capabilities, or lack of experience and knowledge, unless they have been given supervision or instruction (Only for IEC standard).
- Children being supervised not to play with the appliance (Only for IEC standard).
- This appliance can be used by children aged from 8 years or above, and persons with reduced physical, sensory or mental capabilities or lack of experience and knowledge if they have been given supervision or instruction concerning how to use the appliance in a safe way and understand the hazards involved. Children shall not play with the appliance. Cleaning and maintenance of the fan shall not be made by children without supervision (Only for EN standard).
- Once the fan is assembled, it is forbidden to disassemble the housing when cleaning.
- Maintenance can only be done by an authorized service agent such as your local dealer or any agent qualified to undertake the service.
- If the unit requires external cleaning, make sure it is unplugged from the power supply. Use a soft tissue or dry cloth for general cleaning. To remove more persistent dirt or grime with a warm soapy dampened cloth. Do not use any solvents (such as thinners), and these may damage the plastic casing.

-1-

PARTS DESCRIPTION

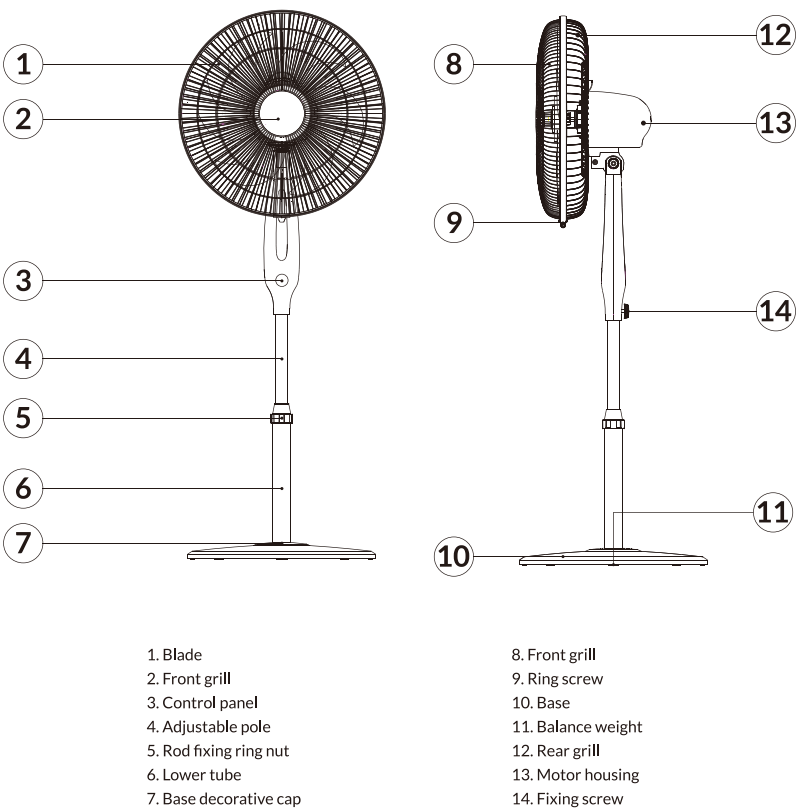

- Blade
- Front grill
- Control panel
- Adjustable pole
- Rod fixing ring nut
- Lower tube
- Base decorative cap
- Front grill
- Ring screw
- Base
- Balance weight
- Rear grill
- Motor housing
- Fixing screw

-2-

MAIN UNIT

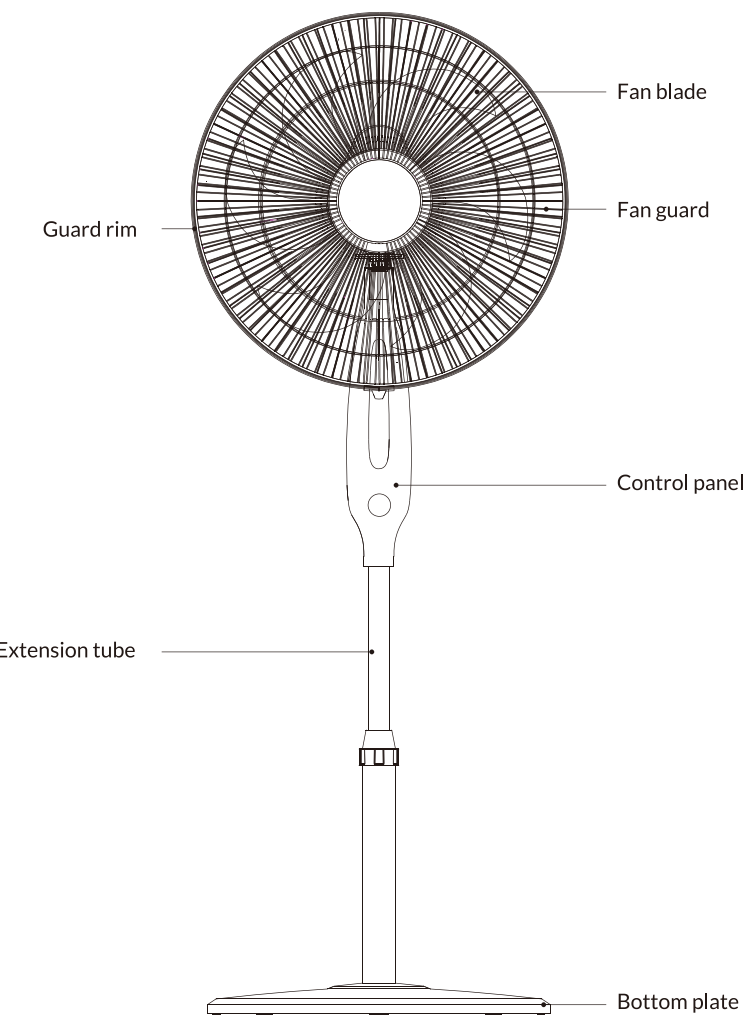

-3-

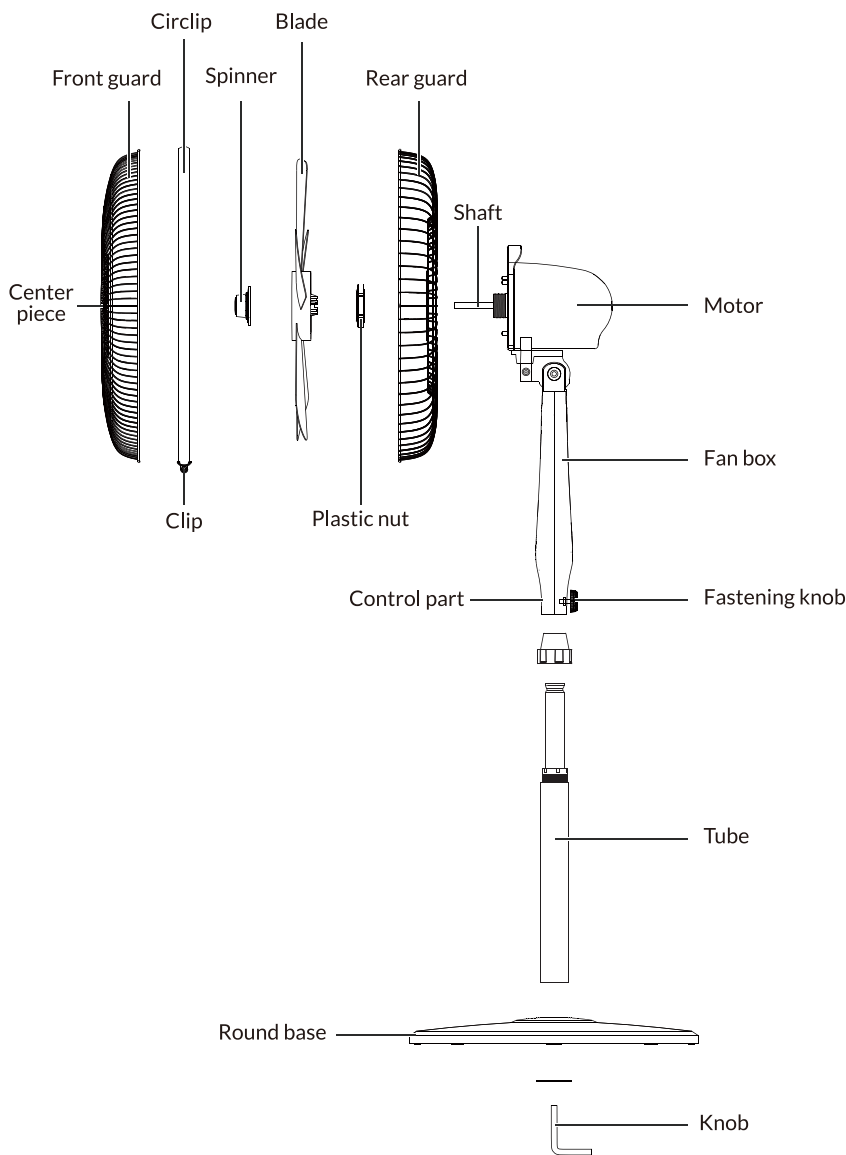

-4-

ASSEMBLY METHOD

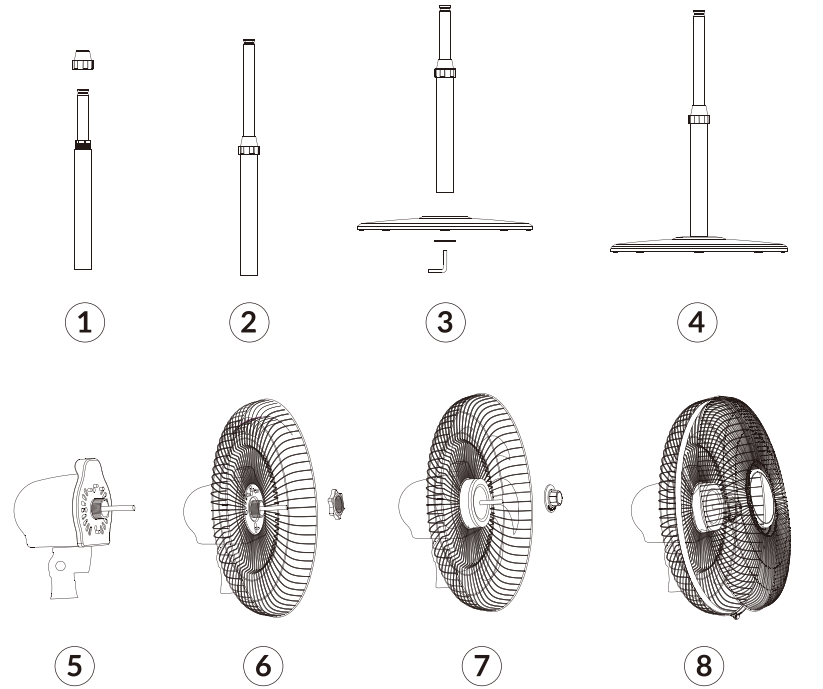

Please assemble correctly according to the following sequence.
Please keep the original packaging for future storage.

- Please find the corresponding lower tube according to the picture, and open rod fixing ring nut.
- Extend adjustable pole, tighten rod fixing ring nut.
- Unscrew the screw of the lower tube, and remove the screw, connect the lower tube to the base, and then tighten the screw from the base, so that the lower tube and the base are firmly connected.
- After the screw is tightened, it is firmly connected as in the fourth picture.
- Find the Motor. Loosen "Spinner" and "Plastic Nut" of the Motor.
- Please let "Rear Guard" throughout the shaft, meanwhile, let "Rear Guard" hole align with the Four hole of motor, Tighten "Plastic Nut".
- Please let "Blade" throughout the "shaft", and tighten "Spinner".
- Loosen the "Ring Screw", use the "ring" wrapped the "Front Guard", then align with "Rear Guard", finally, tighten the "Ring Screw".
- Please insert the motor into the extension tube, tighten Fixing screw.

-5-