

Installation Instruction

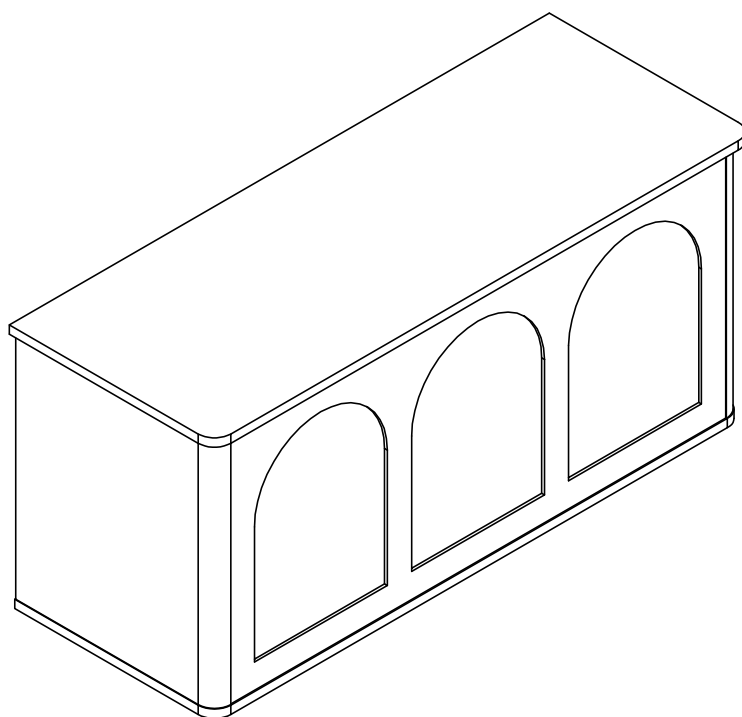

Assembling

What you need

- Use the packaging carton as a working surface to prevent product damage during assembly
- Phillips head screwdriver

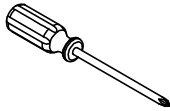

Weight Limitation

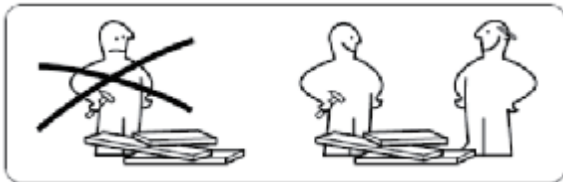

What' included

Code	Description	Qty
A	Cam Bolt M6X35MM	8
B	Cam Lock 15X9MM	8
C	Wooden Dowel M8X30MM	18
D	Screw M4X40MM	12
E	Hinge	3
F	Left flexed arm	1
G	Right curved arm	1
H	Screw M3X14MM	20
I	Hole position sticker	8
J	EVA	6
K	Silicone pad	4

The Hardwares

(A)

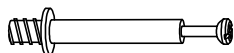

(B)



(C)

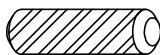

(D)

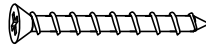

(E)



(F)

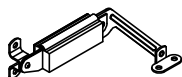

(G)

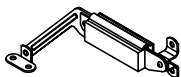

(H)



(I)

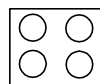

(J)



(K)



IMPORTANT:

1. Do not tighten bolts / screws completely until all bolts / screws are lined up and inserted into holes.
2. Do not over tighten screws and bolts to avoid stripping
3. Please use hand tools to assemble this product, you can also use power tools (please use power tools carefully)

Included Accessories

Code	Description	Qty
1	Cabinet Top	1
2	Bottom Panel	1
3	Left side plate	1
4	Right side plate	1
5	Front side panel	1
6	Rear side panel	1

The Accessoriess

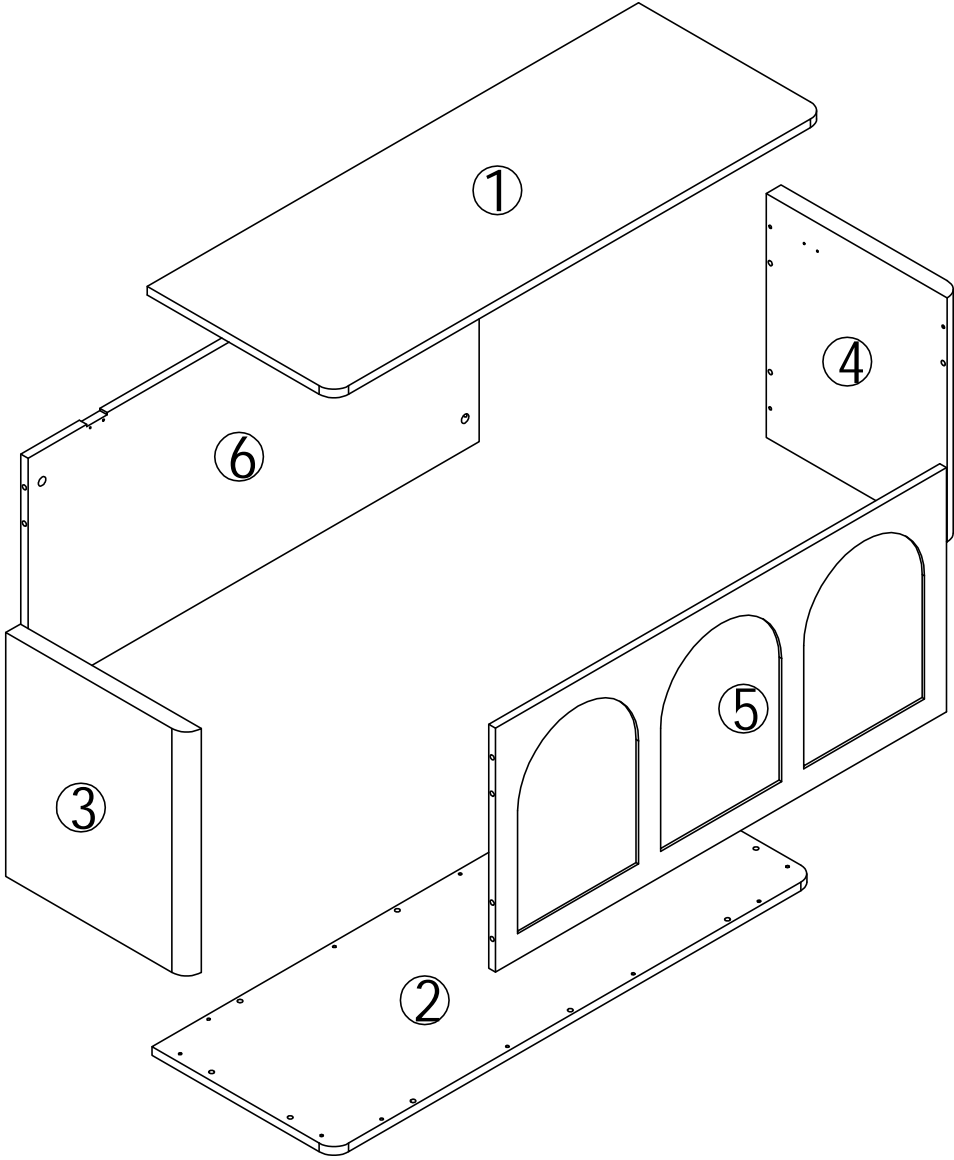

Step 1

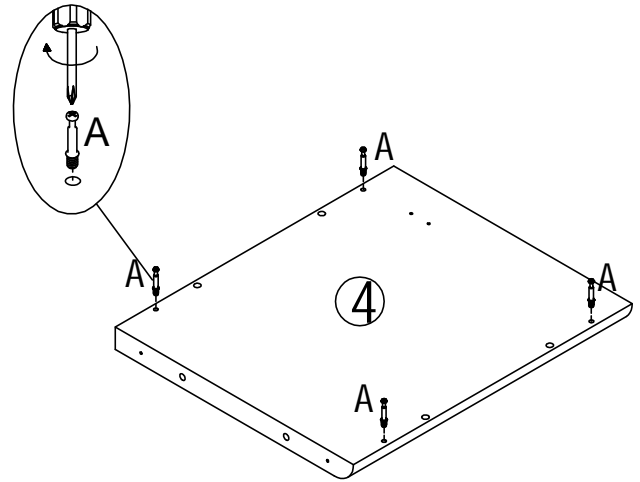
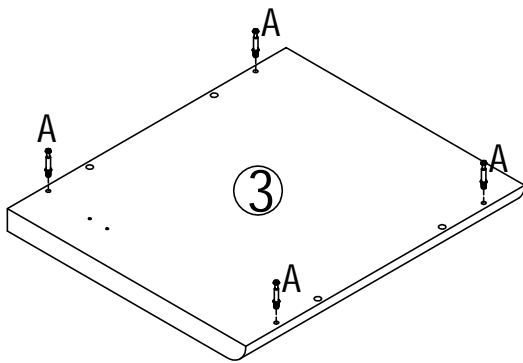
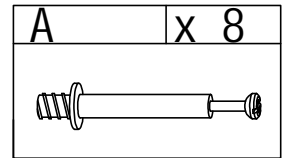

Step 2

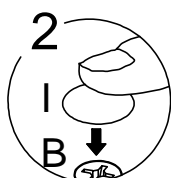
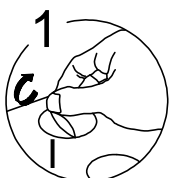
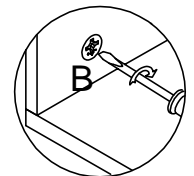
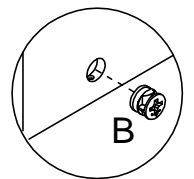
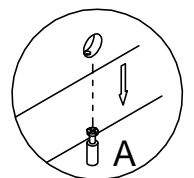
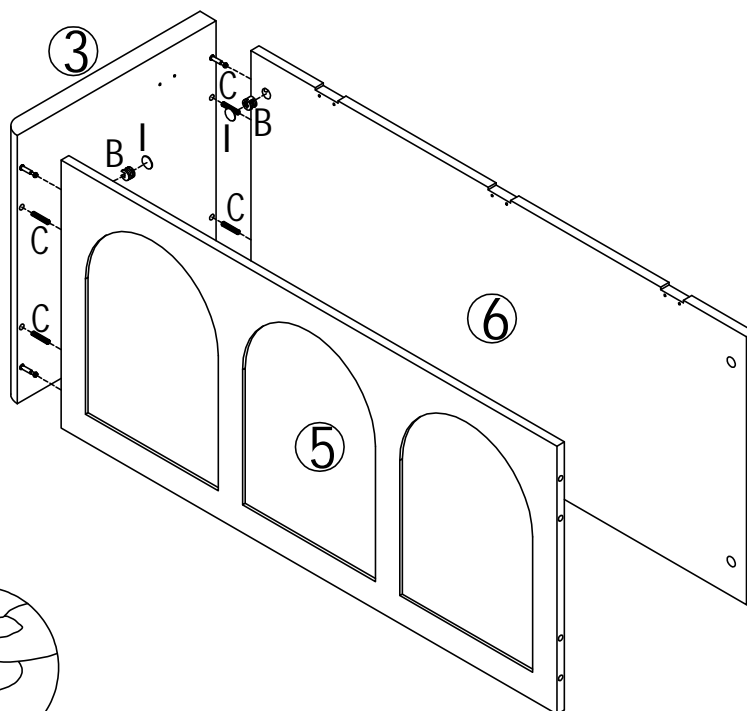
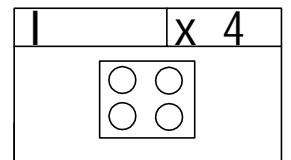
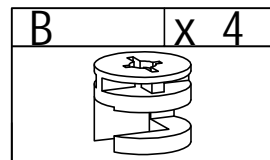
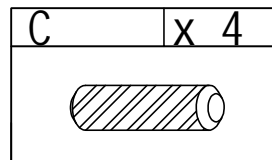

Step 3

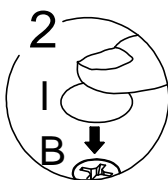
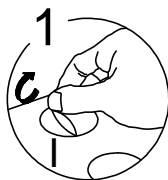
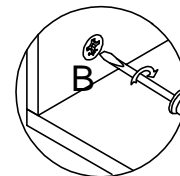
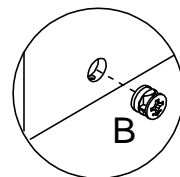
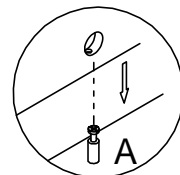
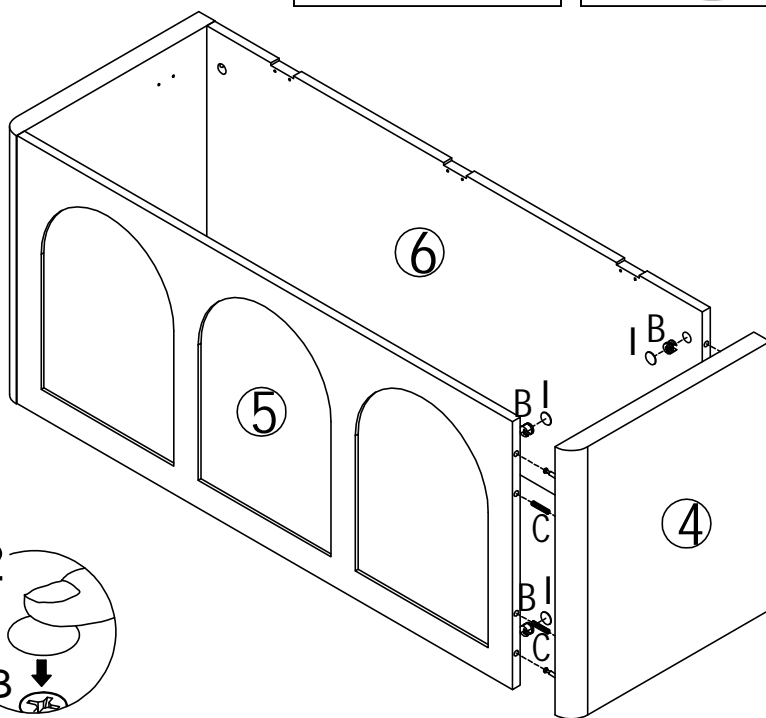
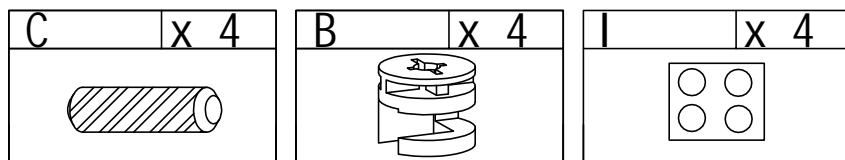

Step 4

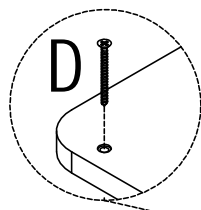
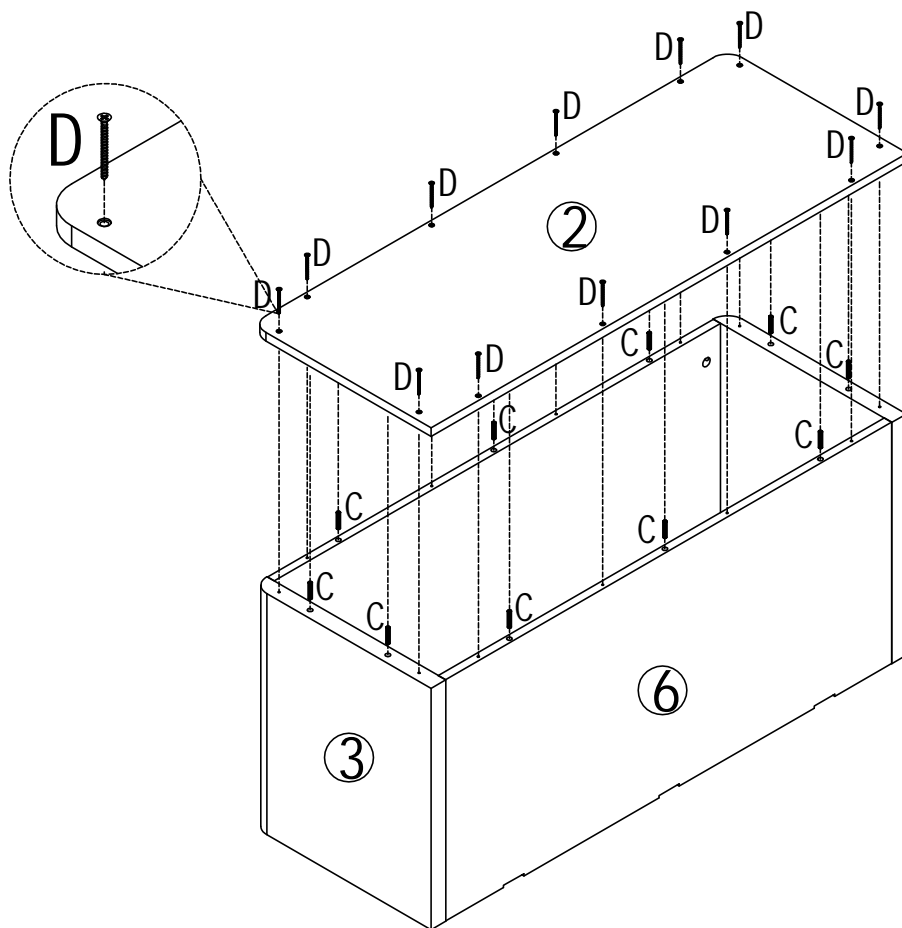
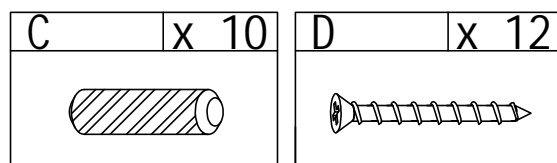

Step 5

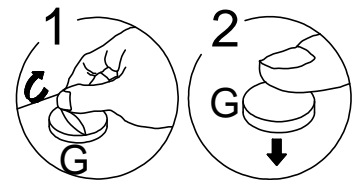
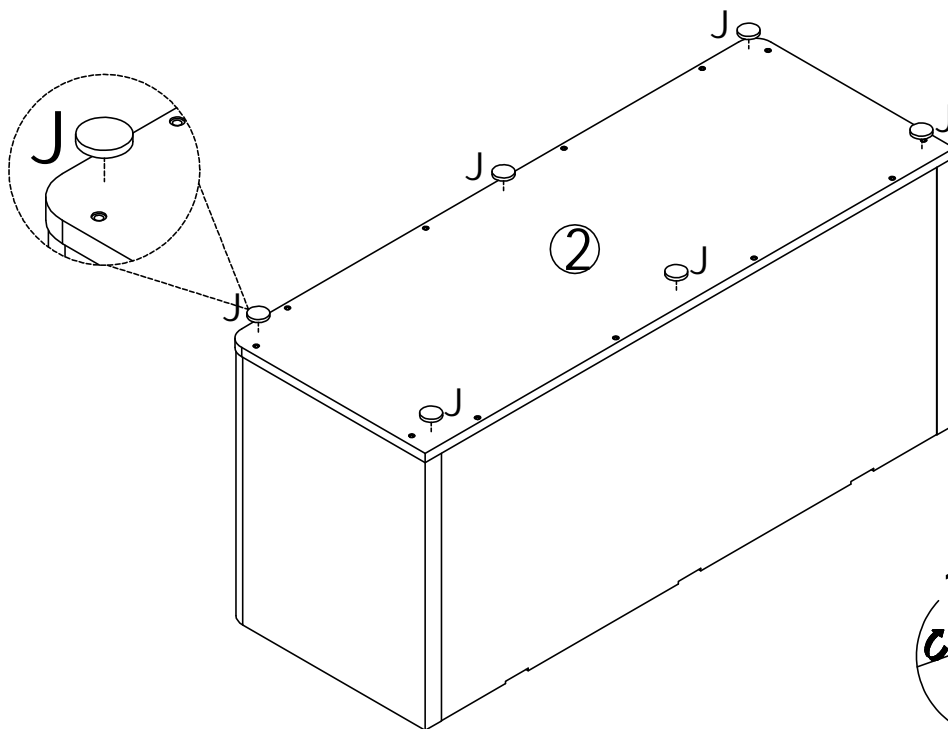
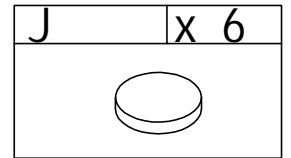

Step 6

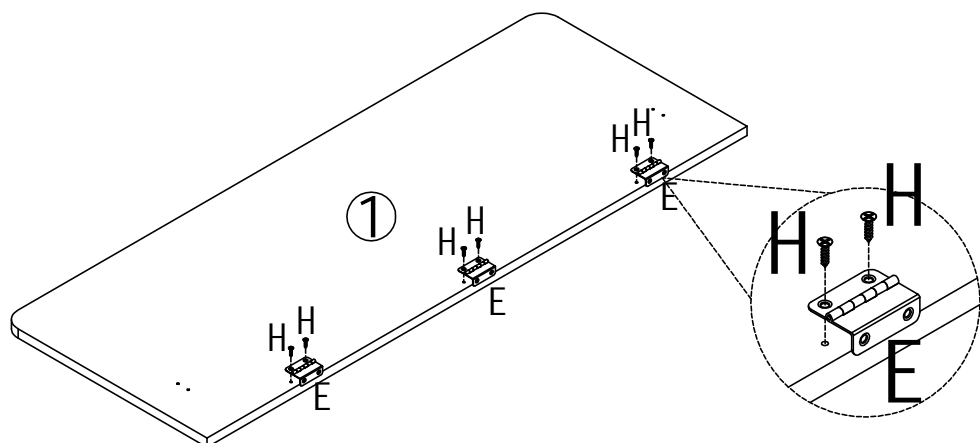
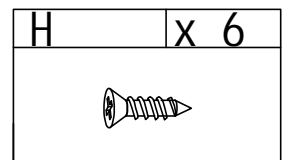
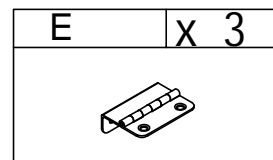

Step 7

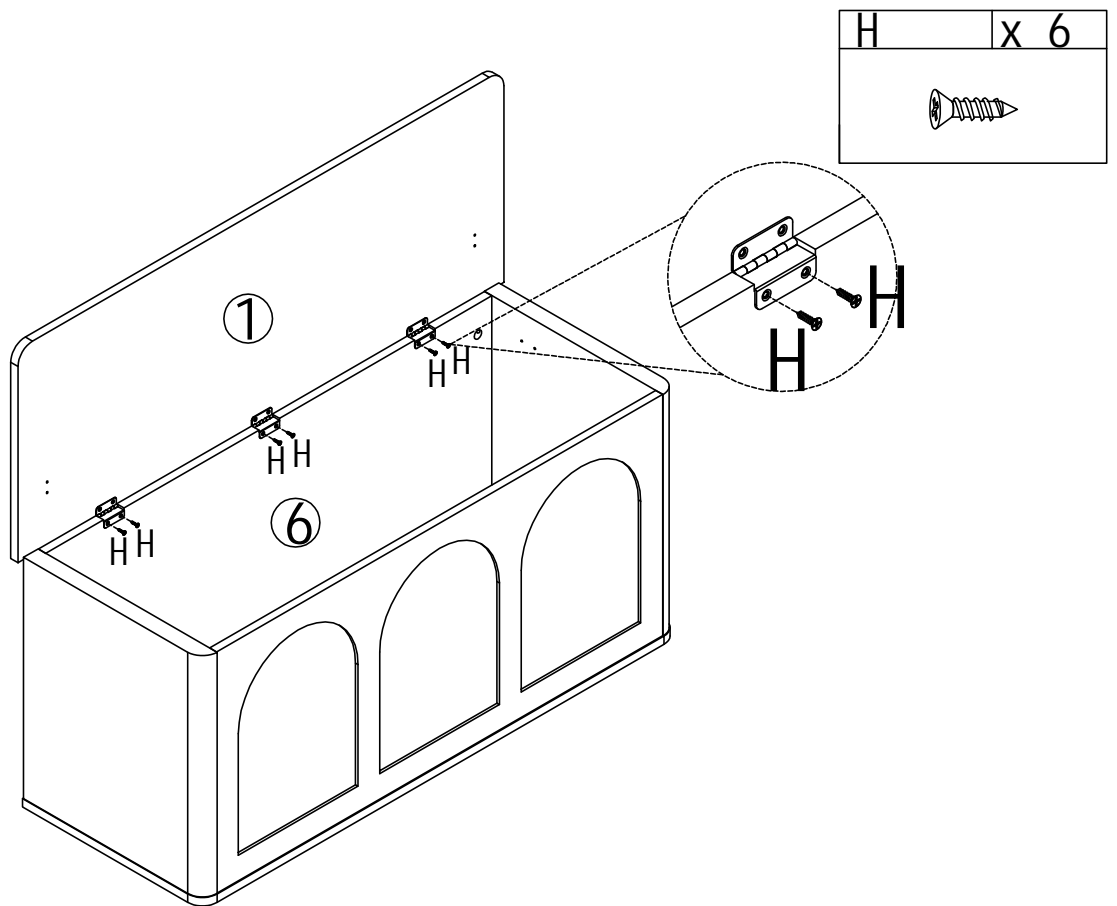

Step 8

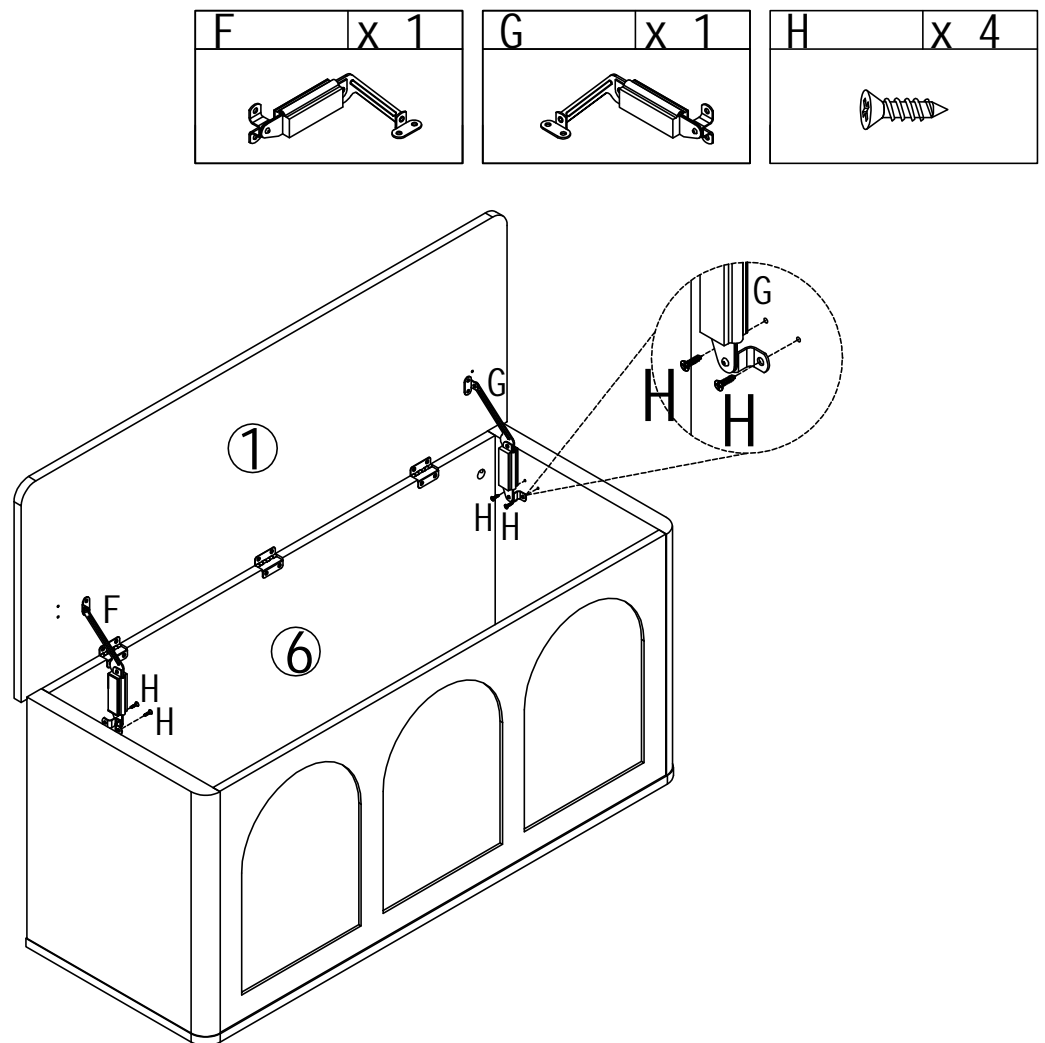

Step 9

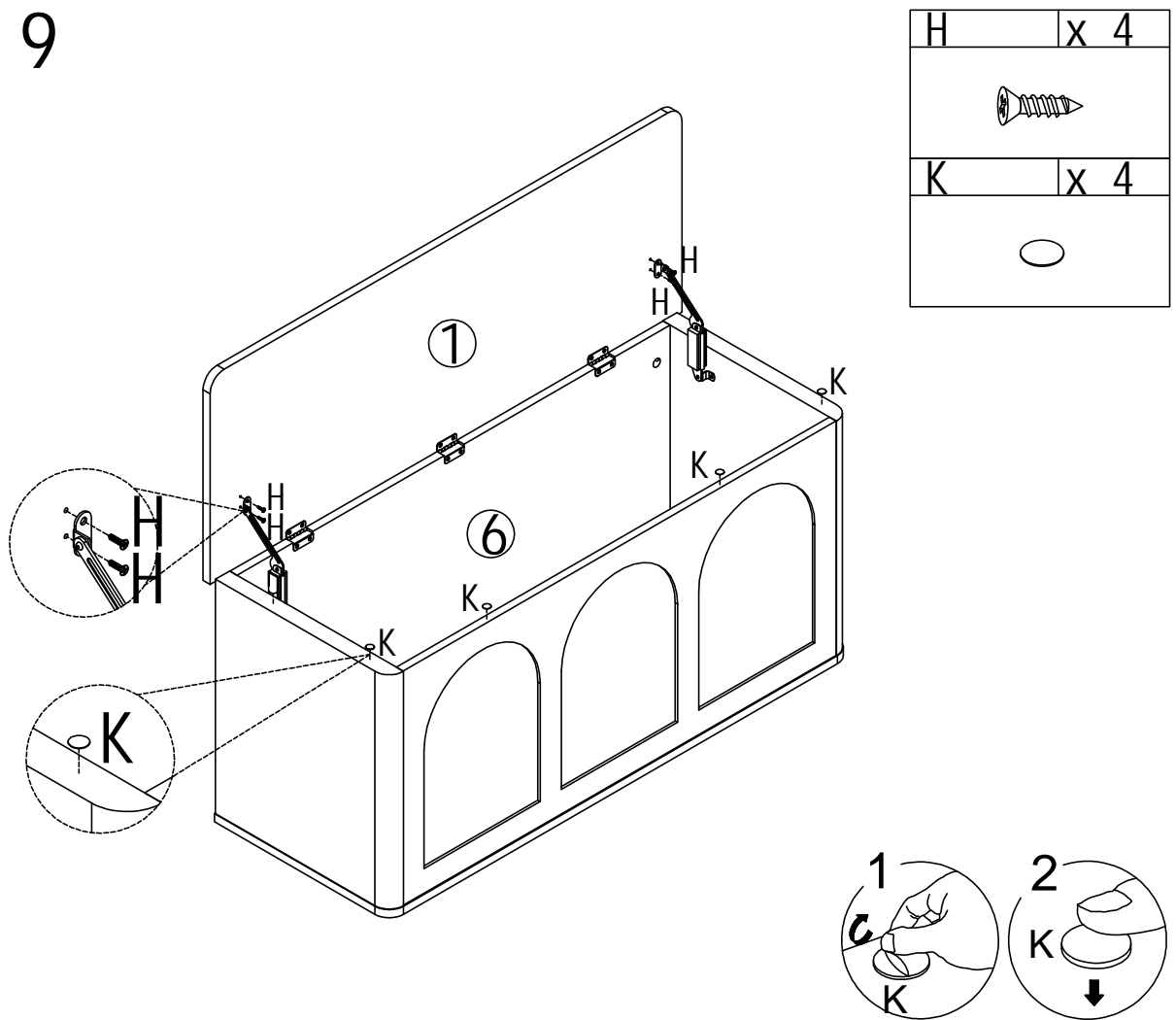

Step 10

