

# Assembly & Installation Instructions

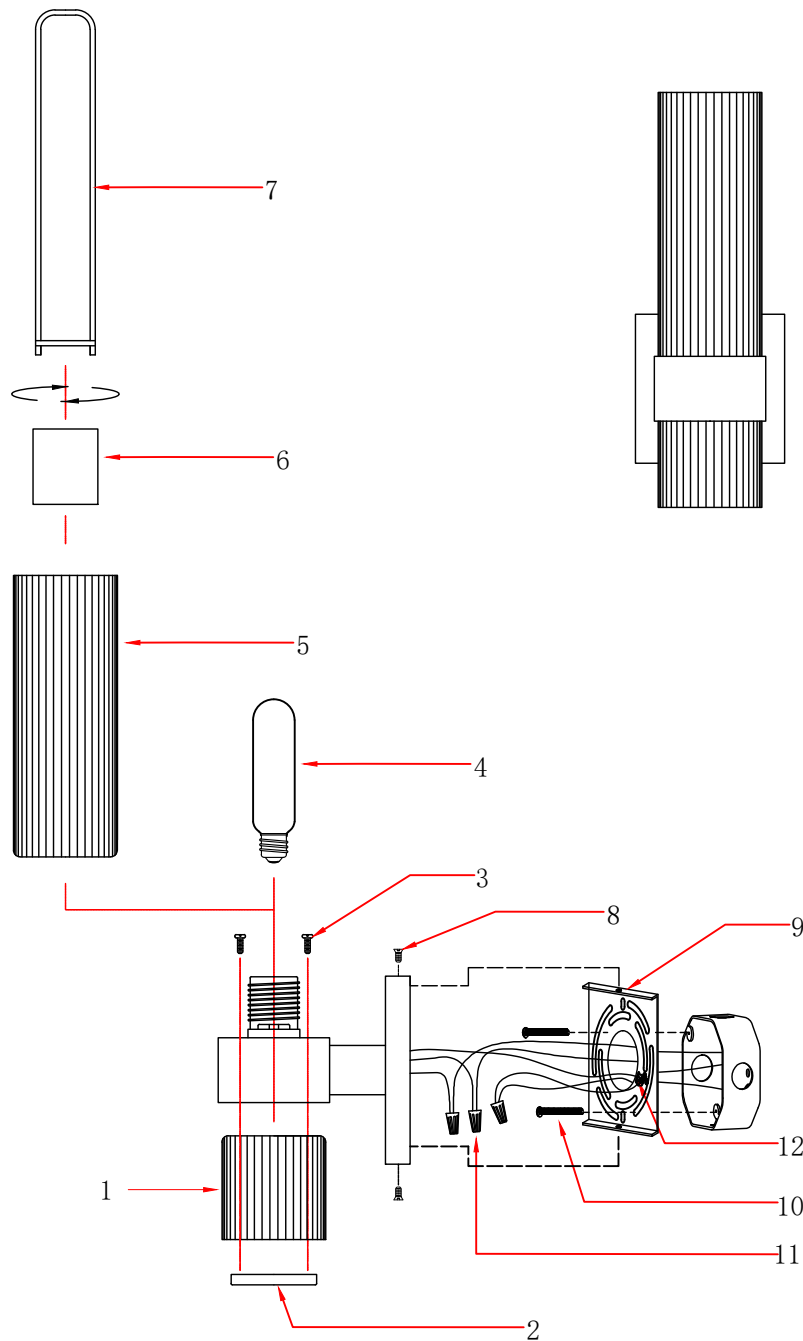

## PREPARATION before INSTALLATION:

1. If an existing fixture is being replaced, remove it and note to which wire in the outlet box the original fixture was attached.
2. Before discarding the carton, double-check the packaging to make sure all parts have been found.
3. This fixture was designed to be mounted on an octagon outlet box. The box must be securely mounted to the structure of the building.

## IMPORTANT:

1. **WARNING** - Disconnect power before relamping or wiring the fixture. Turn off the entire electrical circuit to which the lighting fixture is attached.
2. Installation and maintenance of this fixture should be completed by a licensed electrician.
3. Failure to install the fixture correctly could result in serious injury or death.
4. Read all instructions before starting installation.

## INSTALLATION STEPS:

- A. Remove the mounting bracket (9) from the fixture body, and secure the mounting bracket (9) to the junction box with two mounting screws (10).
  - B. Attach the short glass shade (1) to the fixture body using the round cover (2) and two screws (3).
  - C. Install the bulb (4) (not included) into the socket. Please refer to the warning label on the socket for the maximum wattage allowed. Then slide the long glass shade (5) over the bulb (4) and lamp holder. Use the supplied tool (7) to secure the socket ring (6) onto the lamp holder, making sure the long glass shade (5) is firmly fixed.
  - D. Connect the wires using wire nuts (11) as follows:  
Fixture BLACK wire to home LIVE wire.  
Fixture WHITE wire to home NEUTRAL wire.  
Attach the fixture ground wire and home ground wire to the mounting bracket (9) using the green screw (12).
- NOTE: The bare wire can NOT be exposed to prevent leakage.
- E. Carefully tuck wires back into the junction box, then attach the light fixture to the mounting bracket (9) with two screws (8).