

# Owner Manual

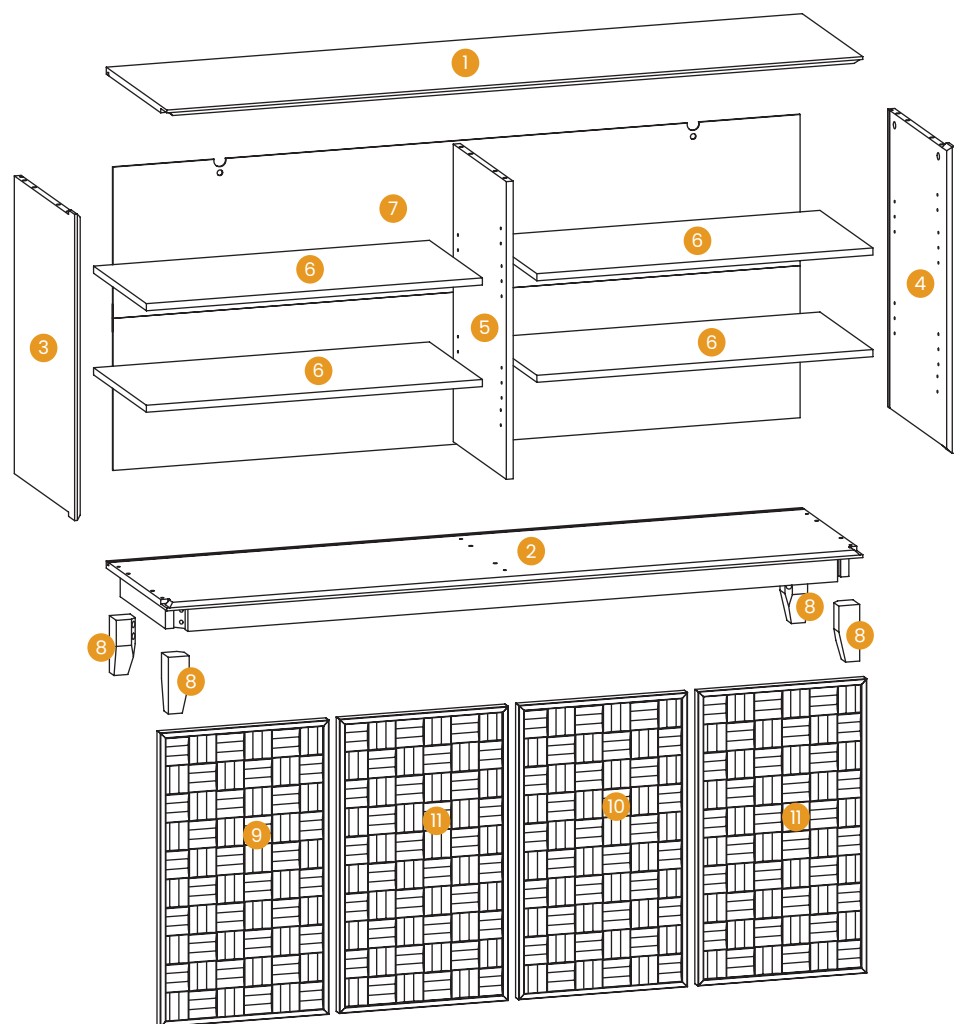

**STORAGE CABINET**

**TECHNICAL EXPLODED VIEW DIAGRAM**



**PANEL COMPONENTS INVENTORY**

PLEASE MAKE SURE ALL THE PARTS ARE INCLUDED.

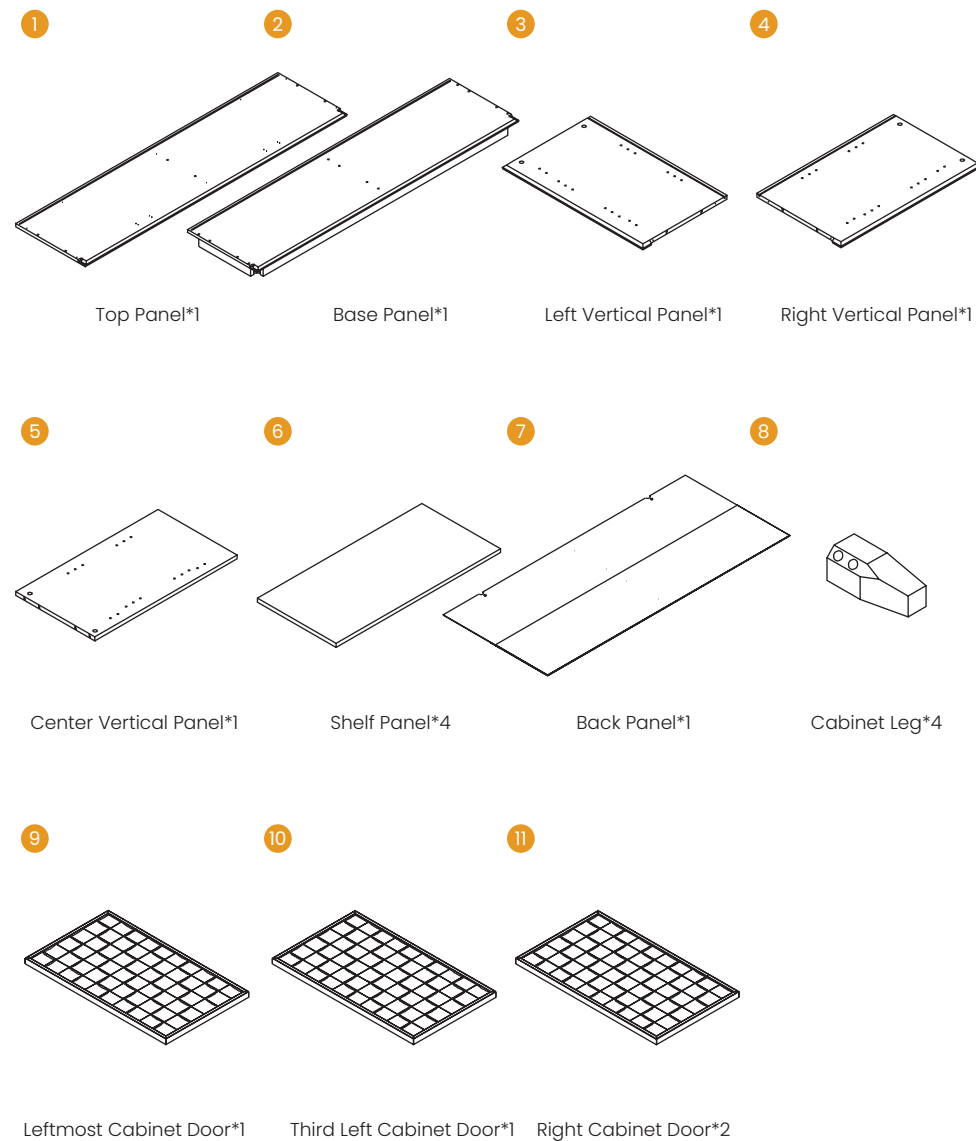

**HARDWARE COMPONENTS INVENTORY**

PLEASE MAKE SURE ALL THE PARTS ARE INCLUDED.

A

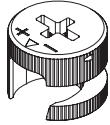

Large Hidden Cam\*6(+2)

B

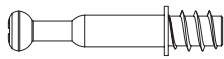

Cam Screw \*6(+2)

C

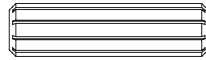

Wood Dowel  
ø8X30mm\*12(+2)

D



Flat Head Screw  
#6.5X1/2" \*8(+2)

E



Pan Head Screw  
#6\*1/2" \*8(+2)

F

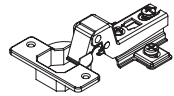

Large Bend Door Hinge\*4

G



Flat Head Screw  
#10x1-1/2" \*6(+2)

H

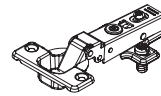

Mid Bend Door Hinge\*4

I

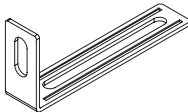

Wall Brackets\*2

J

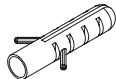

Expansion Wall Plug\*2

K

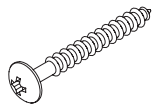

Pan Head Screw  
#10x1-1/2" \*2

L

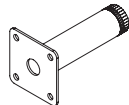

Support Foot\*1

M

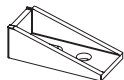

Bracket\*4

N



Hex Head Screw  
M6x55mm \*8(+2)

O



Flat Washers\*8(+2)

P



Spring Washers\*8(+2)

**HARDWARE COMPONENTS INVENTORY**

PLEASE MAKE SURE ALL THE PARTS ARE INCLUDED.

Q

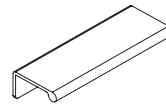

Pull\*4

R

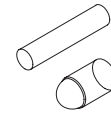

Rubber Sleeve Metal Pin\*16(+3)

S

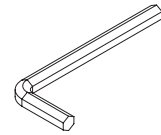

L-Wrench \*1

T

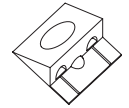

Back Connector\*8(+2)

U

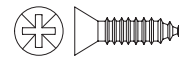

Back Flat Head Screw  
#6\*5/8" \*8(+2)

V



Pan Head Screw  
#10\*1/2" \*10(+2)

W

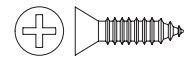

Flat Head Screw  
#8\*5/8" \*16(+3)

X



Felt Disc\*4

BEFORE YOU GET STARTED, A FEW POINTERS:



Having a friend to help makes assembly extra-easy



Mind the important safety information

**ASSEMBLY INSTRUCTIONS**

**Important:**

1. Before assembly, arrange all panel components and hardware fittings in sequential order and verify quantity counts.
2. If WOOD DOWEL joints exhibit loose fit, apply wood adhesive (customer-supplied) to enhance fastener bond strength.
3. Please install HIDDEN CAM and CAM SCREW according to the installation method shown in the diagram below.

Torsionally tighten CAM SCREW until threads are no longer visible

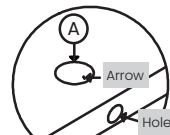
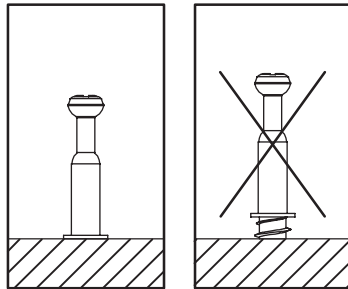

The arrow in the HIDDEN CAM must point toward the hole in the edge of the board.

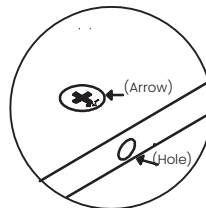
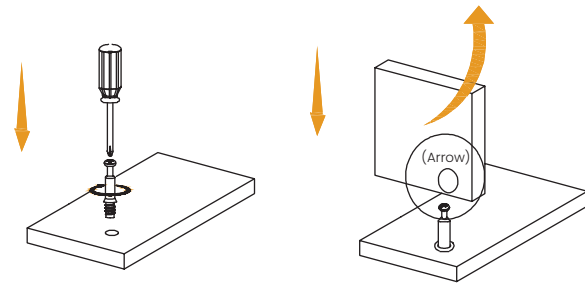

The arrow in the HIDDEN CAM must point toward the hole in the edge of the board

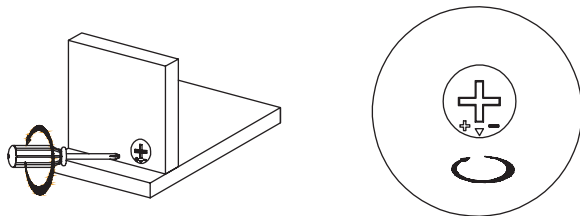

**ASSEMBLY INSTRUCTIONS**

**STEP 1** Install 4 Brackets(M) And 2 Wall Brackets(I) On The Top Panel (#1), Then Secure With 6 Cam Screws(B).

Notes:

1. Align Bracket(M)'S Long Right-Angle Side With Panel #1, Short Side Facing The Non-Grooved End
2. Orient Wall Bracket(I)'S Short Side Toward The Grooved End Of Panel #1, With Right-Angle Vertices Flush With Panel Edges
3. Ensure Cam Screws Are Not Inserted Into Wood Dowel Holes Shown In Illustration.

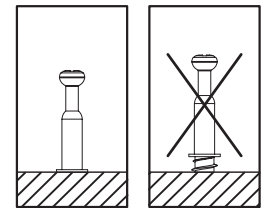
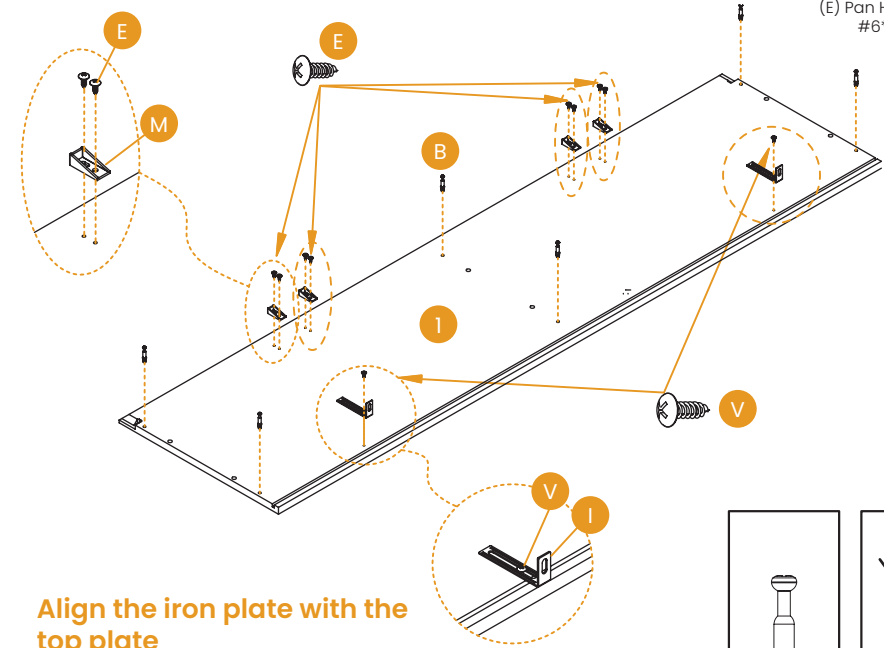
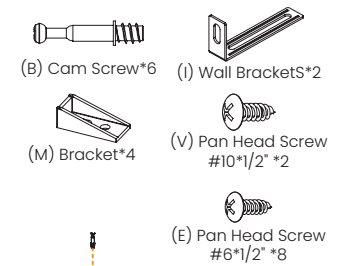

**ASSEMBLY INSTRUCTIONS**

**STEP 2** Insert 2 Wood Dowels At Both Ends Of Left Vertical Panel (#3) And Right Vertical Panel (#4).

Note: Avoid Inserting Wood Dowels Into Cam Adjustment Holes.



(C) Wood Dowel  
ø8X30mm\*8

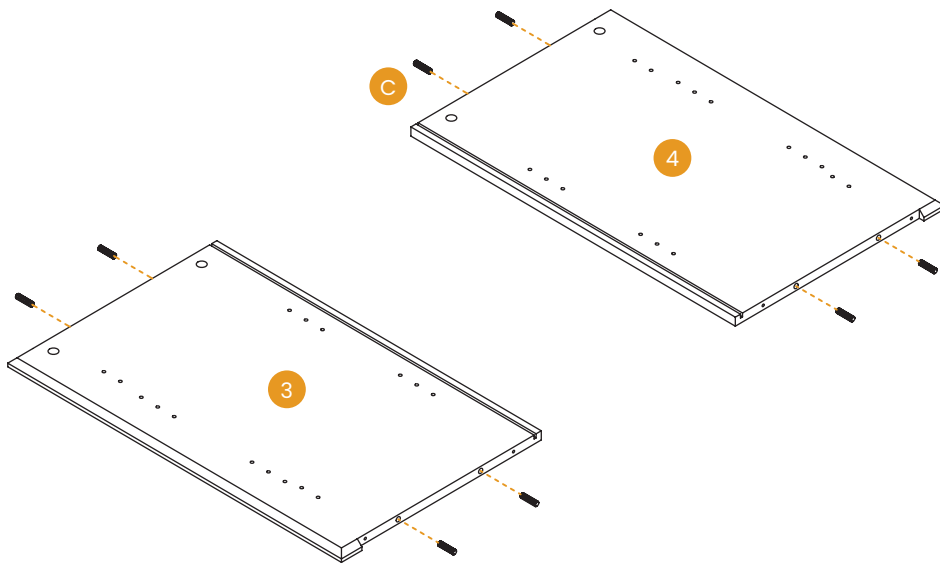

**ASSEMBLY INSTRUCTIONS**

**STEP 3** Install 2 Wood Dowels At Both Ends Of Middle Vertical Panel (#5). Adhere Felt Pads (X) To Cabinet Legs (#8) Using Backing Adhesive.

Note: Keep Wood Dowels Clear Of Cam Holes.



(C) Wood Dowel  
ø8X30mm\*4



(X) Felt Disc\*4

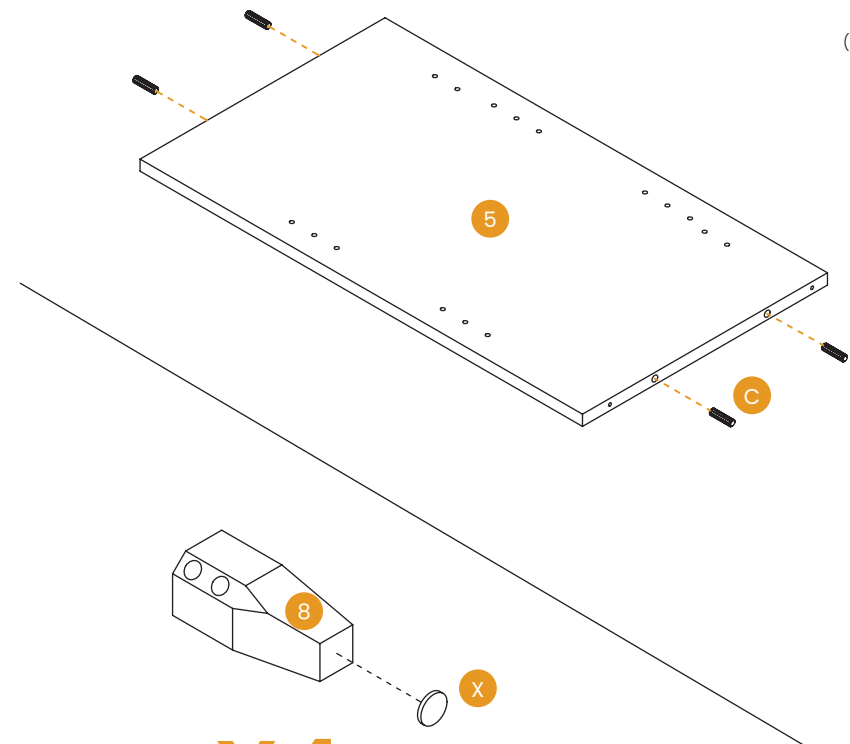

**X4**

## ASSEMBLY INSTRUCTIONS

**STEP 4** Secure Panels #3, #4, And #5 To Top Panel (#1) Using Large Hidden Cams (Per Illustration).

Notes:

1. Align Grooves Of #3/#4 Panels With #1'S Grooves.
2. Orient Non-Edge-Banded Side Of #5 Toward #1'S Grooves.

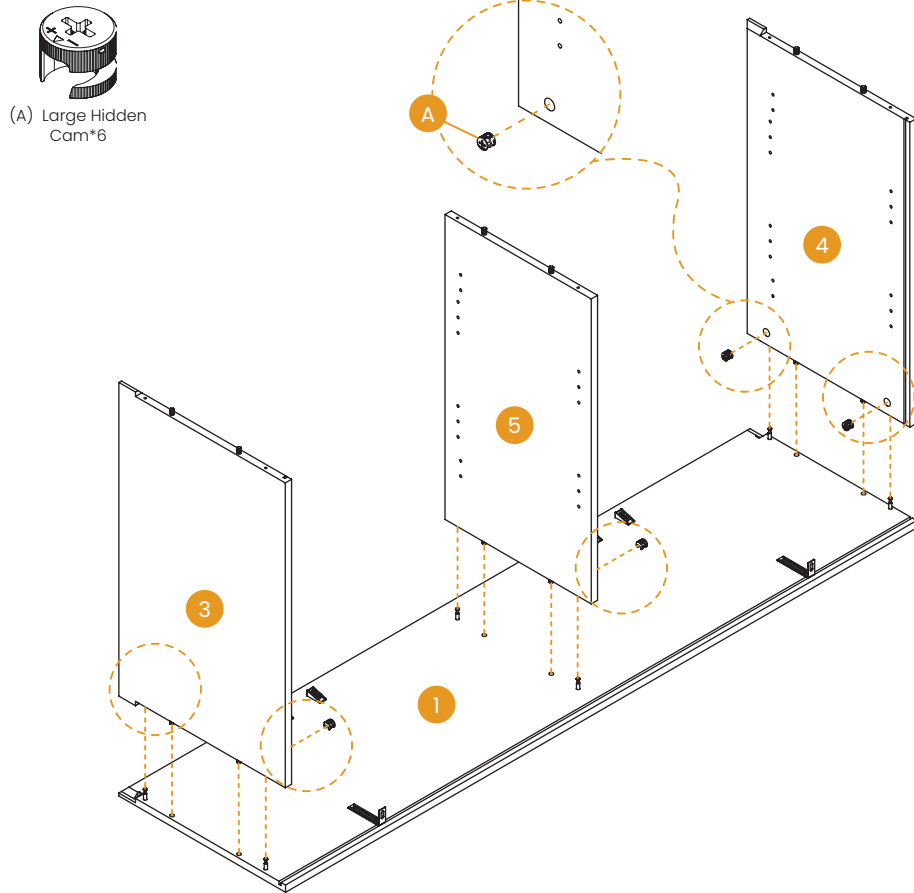

## ASSEMBLY INSTRUCTIONS

**STEP 5** Unfold Back Panel (#7) And Insert Into Grooves.

Note: Install With Adhesive-Taped Side Facing Outward And Notched Edge Downward.

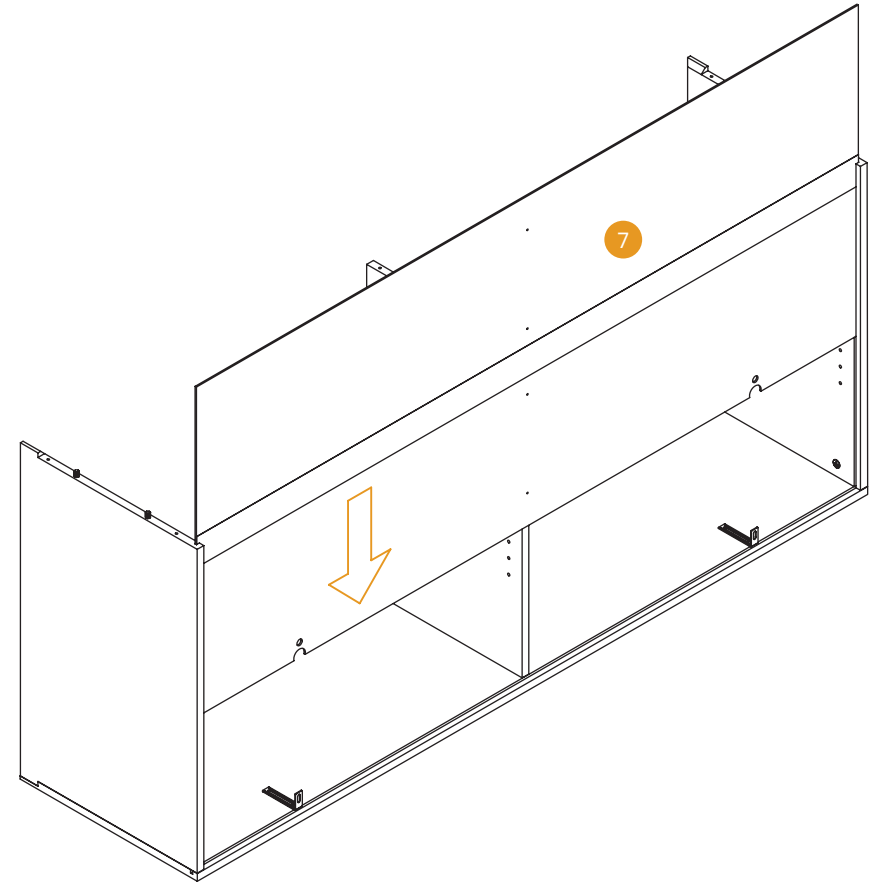

**ASSEMBLY INSTRUCTIONS**

**STEP 6** Position Base Panel (#2) Onto Assembled Unit.

Note: Ensure #2'S Grooves Engage With Back Panel (#7).

(G) Flat Head Screw  
#10x1-1/2" \*6

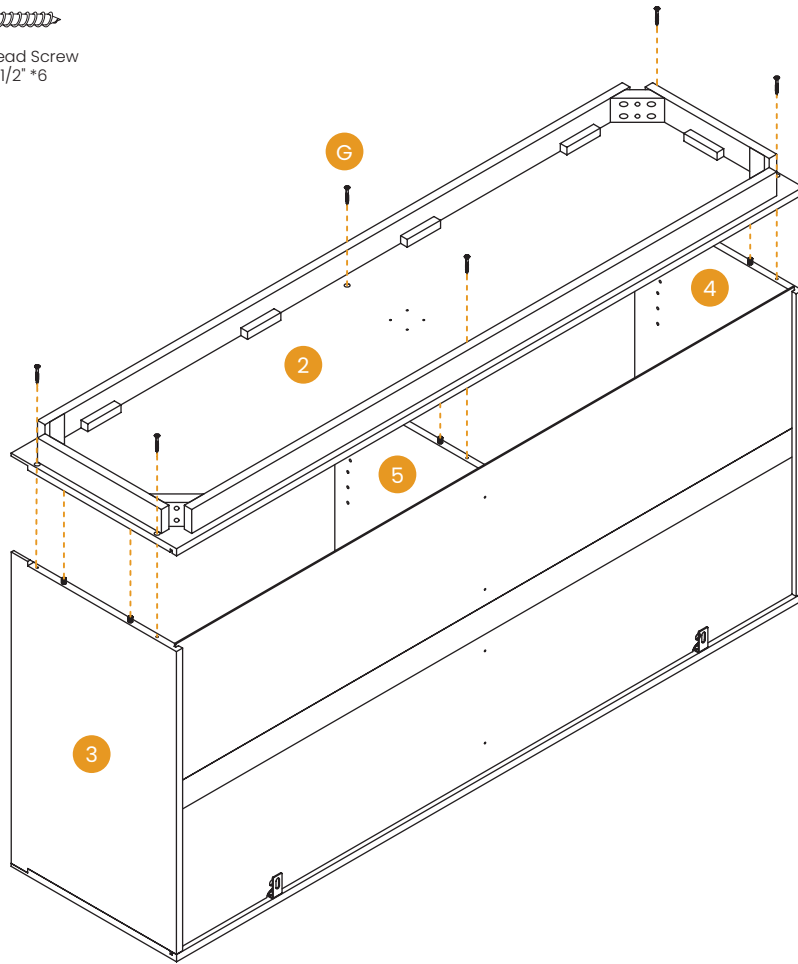

**ASSEMBLY INSTRUCTIONS**

**STEP 7** Install Support Foot (L), Then Attach 4 Cabinet Legs (#8).

Note: Adjust Height Using Support Foot'S Threaded Screws.

(S) L-Wrench \*1  
(O) Flat Washers \*8  
(N) Hex Head Screw M6x55mm \*8  
(P) Spring Washers \*8  
(L) Support Foot \*1  
(V) Pan Head Screw #10\*1/2" \*4

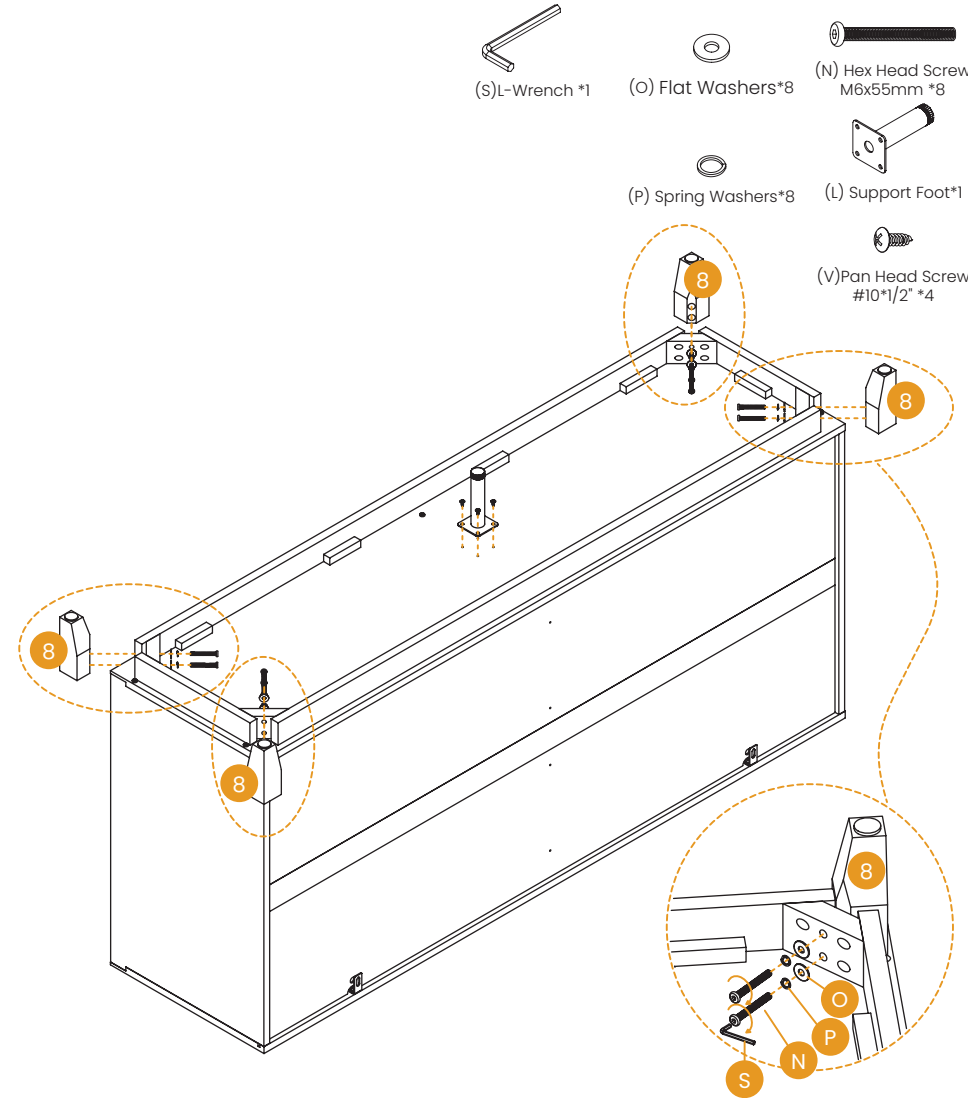

**ASSEMBLY INSTRUCTIONS**

**STEP 8** Insert Rubber-Sleeved Metal Pins (R) Into Vertical Panels, Then Position Shelf (#6).

Notes:

- 1. Use 4 Co-Planar Pins Per Shelf.
- 2. Avoid Hinge Mounting Holes.
- 3. Orient Edge-Banded Side Outward.

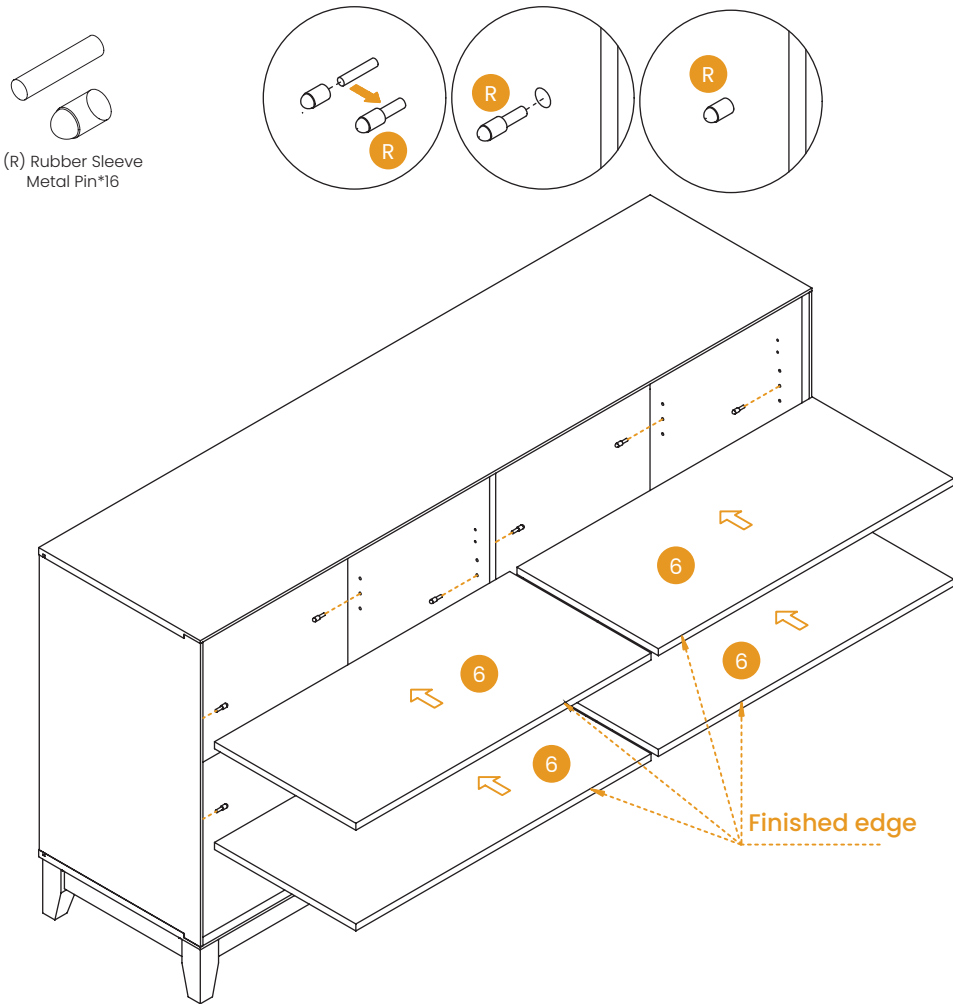

**HINGE-DOOR POSITION RELATIONSHIP DIAGRAM**

Installation Reminder:

Door positions, numbers, and hinge types must match. Please follow the diagram for correct assembly.

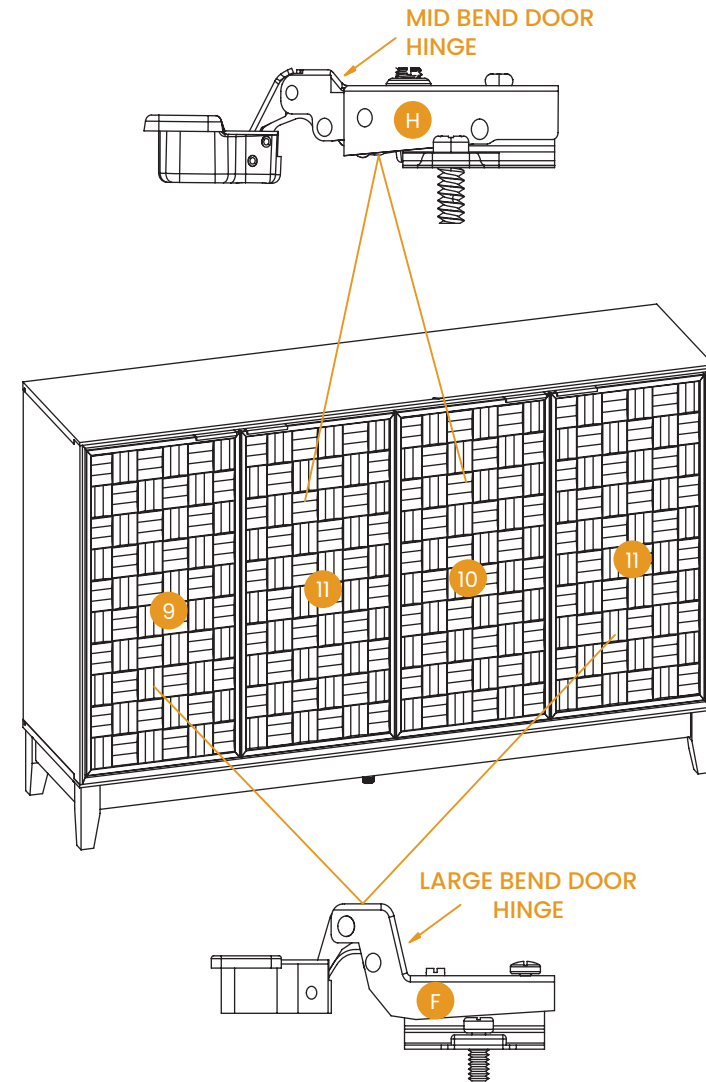

## ASSEMBLY INSTRUCTIONS

- STEP 9** Match Hinges And Doors Per Specification:
- (1) Leftmost Door = Panel 9 + F-Type Hinge.
  - (2) 2Nd Left Door = Panel 11 + H-Type Hinge.
  - (3) 3Rd Left Door = Panel 10 + H-Type Hinge.
  - (4) Rightmost Door = Panel 11 + F-Type Hinge.

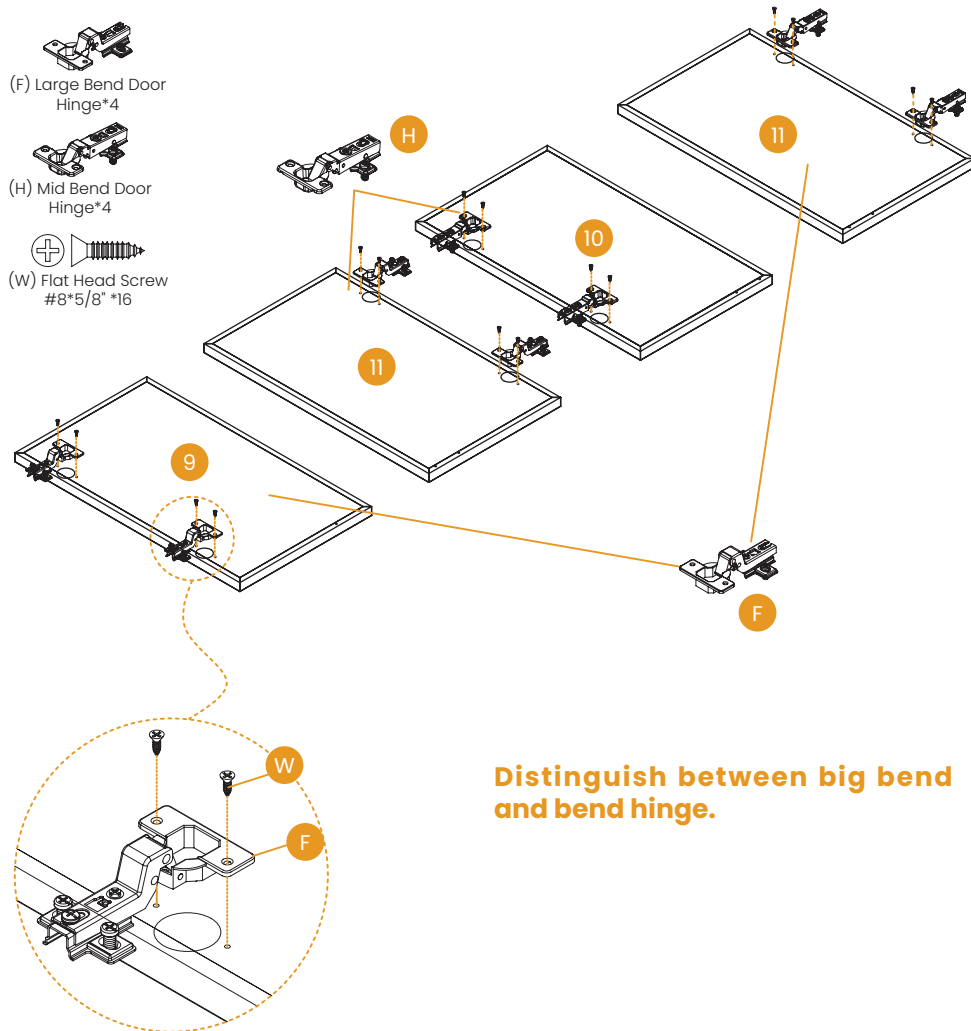

## ASSEMBLY INSTRUCTIONS

- STEP 10** Install Leftmost (Panel 9+F-Hinge) And Rightmost Doors (Panel 11+F-Hinge), Then Attach Handles.

## Notes:

- 1.Tighten Each Screw To 30% Engagement.
- 2.Progress To 50% → 80% → Full Tightening Sequentially.

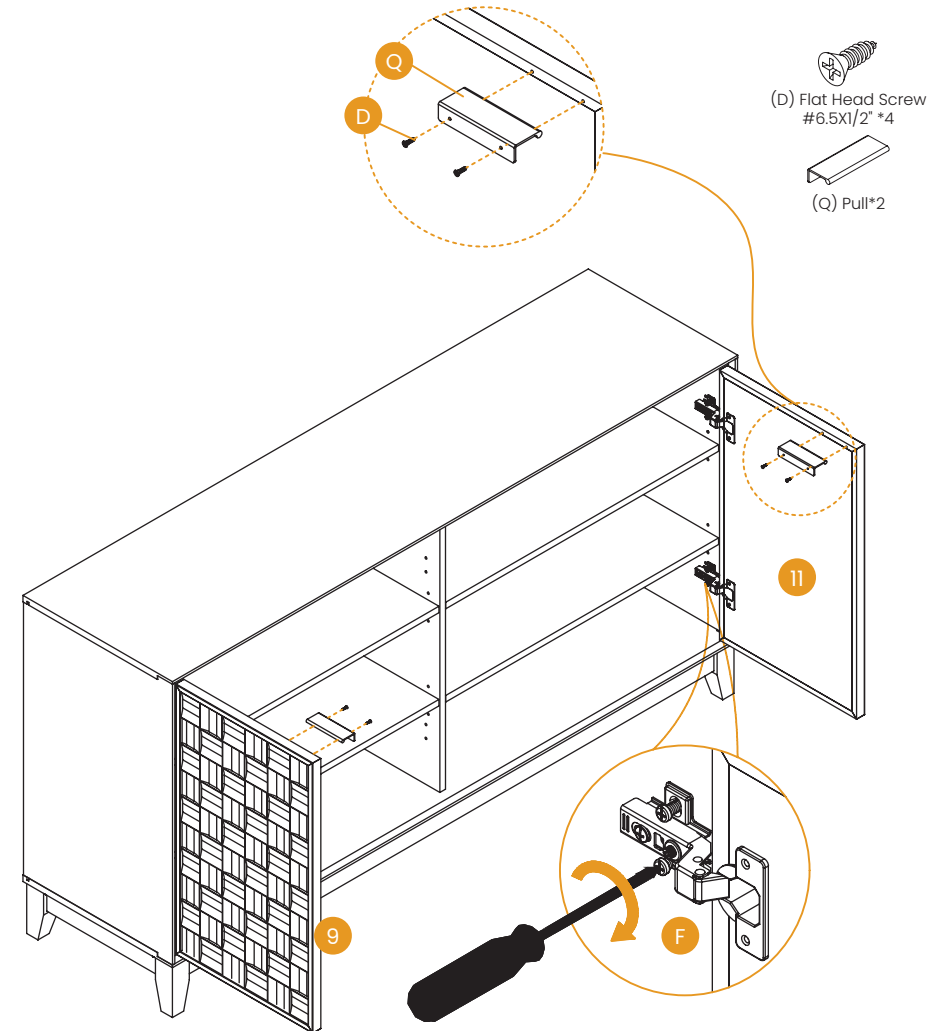

**ASSEMBLY INSTRUCTIONS**

**STEP 11** Mount 2Nd Left (Panel11+H-Hinge) And 3Rd Left Doors (Panel10+H-Hinge), Then Install Handles.

Notes:

- 1.Tighten Each Screw To 30% Engagement.
- 2.Progress To 50% → 80% → Full Tightening Sequentially.

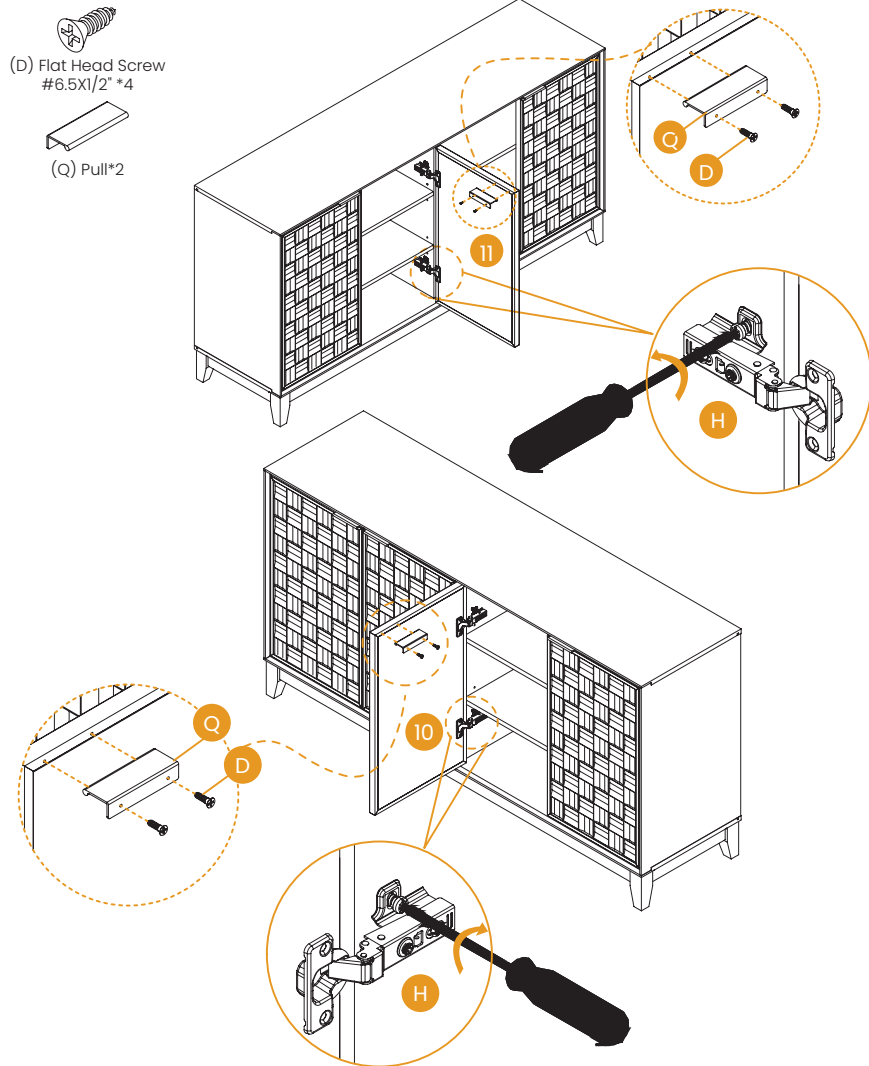

**ASSEMBLY INSTRUCTIONS(HOW TO ADJUST THE HINGE)**

**TO ADJUST YOUR DOORS TO MAKE THE GAPS MORE EVEN (OPTIONAL).**

**STEP 1**

Open the door.

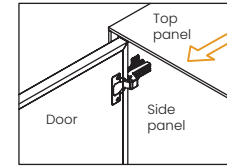

**STEP 2**

Adjust the door panel to be flush with side panel and top panel edge. Loosen the screw indicated a little, adjust the hinge to right position (see step 2a & 2b), then tighten the screw.

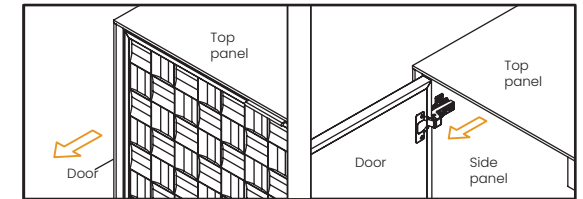
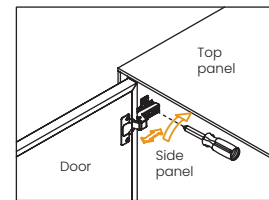

**STEP 2a** MOVE DOOR OUT Pull the hinge forward a little.

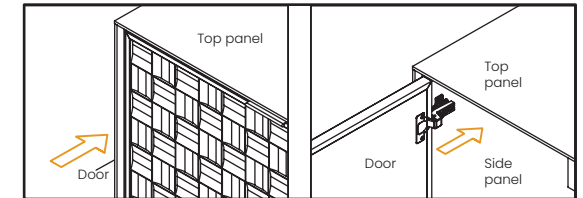

**STEP 2b** MOVE DOOR IN Push the hinge back a little.

**STEP 3**

Adjust the gap between door panel and side panel. Loosen or tighten the screw indicated a little to adjust the gap between the door panels, adjust the hinge to right position (see step 3a & 3b).

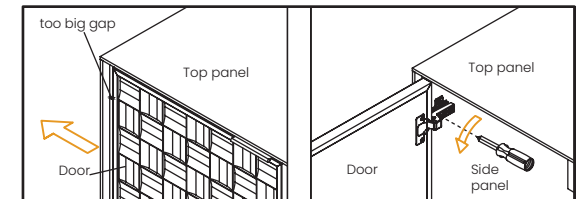
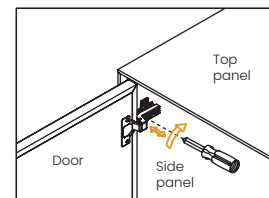

**STEP 3a** MOVE DOOR LEFT Turn the screw clockwise a little as shown to make the gap small.

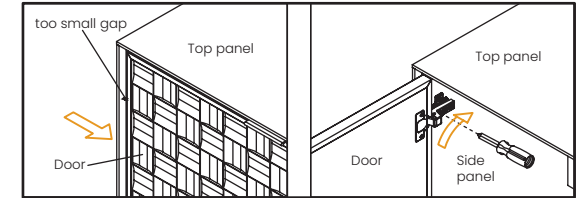

**STEP 3b** MOVE DOOR RIGHT Turn the screw counterclockwise a little as shown to make the gap big.

## ASSEMBLY INSTRUCTIONS

**STEP 12** Secure With 4 Pan Head Screws #10x1/2" (V) And Install 8 Back Connectors.

Note: Engage Back Connectors Into Back Panel Slots.



(T) Back Connector\*8

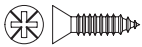

(U) Back Flat Head Screw #6\*5/8" \*8



(V) Pan Head Screw #10\*1/2" \*4

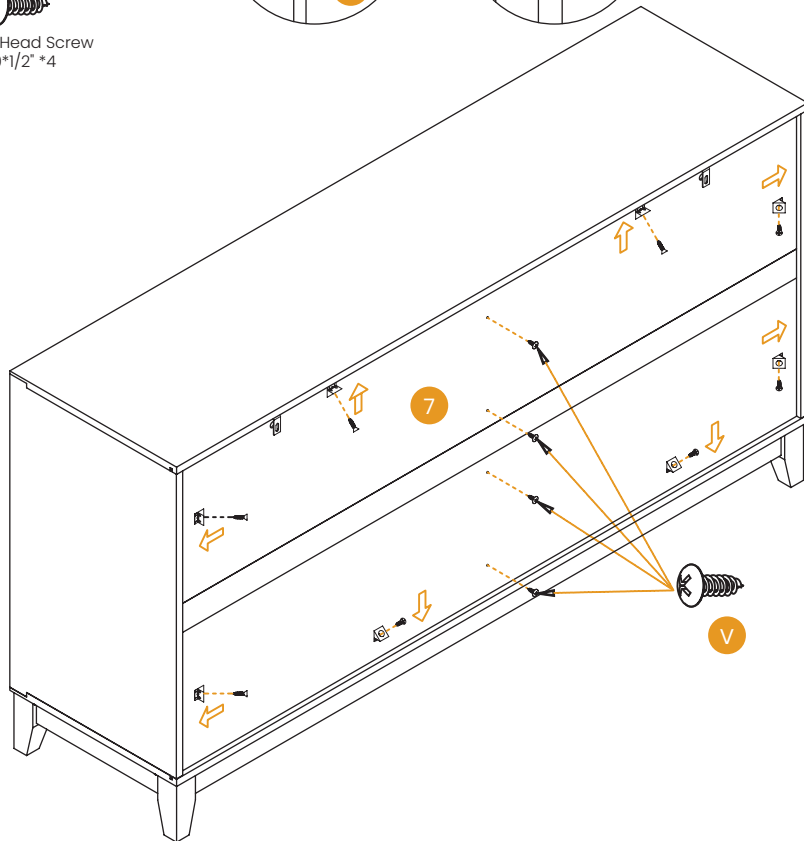
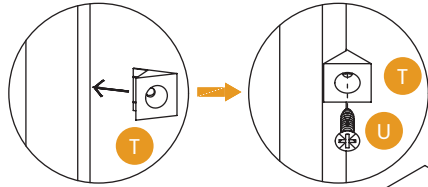

## ASSEMBLY INSTRUCTIONS

**STEP 13** Wall-Mounting Procedure:

- 1.Open All Doors
- 2.Remove Rubber-Sleeved Metal Pins
- 3.Extract Shelves
- 4.Secure Cabinet To Wall Anchors

Shelf Height Adjustment:

Repeat Steps 1-3 From Wall-Mounting Procedure To Reposition Pins.

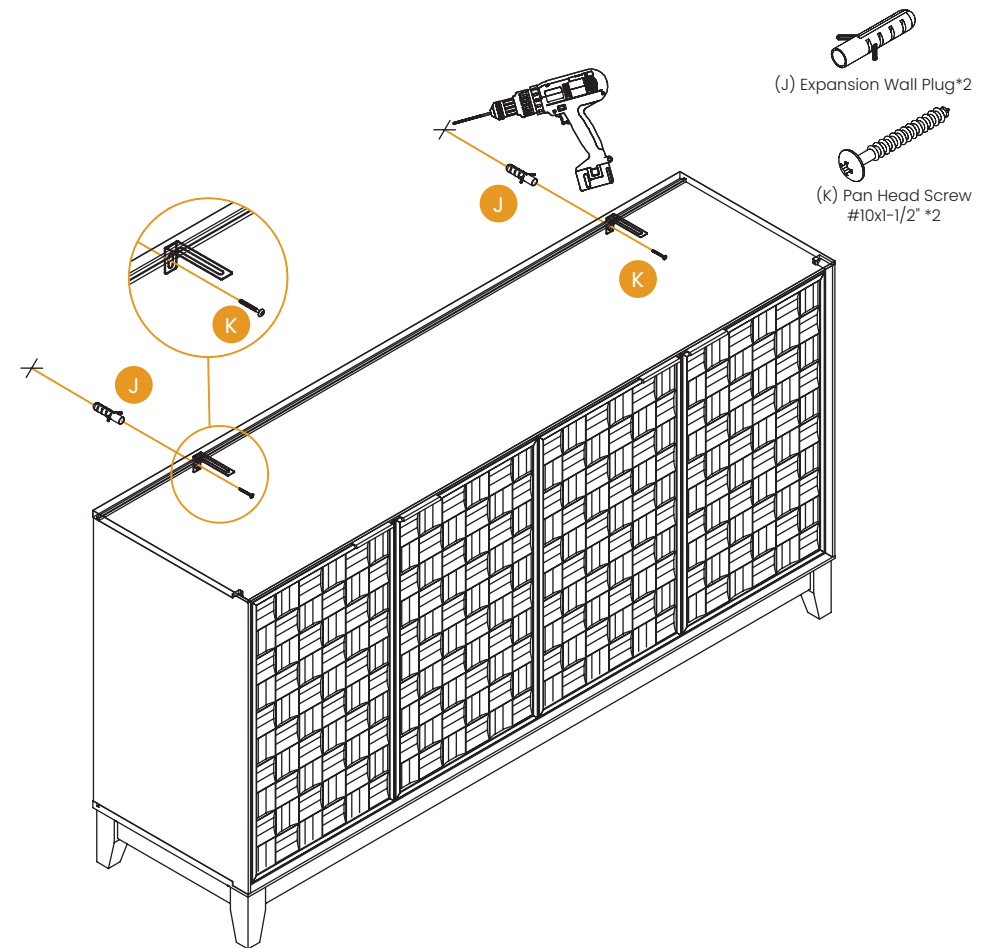

(J) Expansion Wall Plug\*2

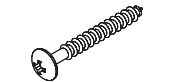

(K) Pan Head Screw #10x1-1/2" \*2

**LIMITED WARRANTY**

This promises to repair or replace any product that is found to be defective in material or workmanship within one year from the date of original purchase, as long as you, the original purchaser, still own it. This is your sole and exclusive remedy under this warranty, subject to the provisions outlined below.

**EXCLUSIONS**

This warranty does not apply to, and no other warranty applies to:

- Normal wear and tear, which is to be expected over the course of ownership.
- Misuse, abuse, or excessive use of the product.
- Modifications or attachments to the product that are not approved .
- Products that were not installed, used, or maintained in accordance with the product instructions and warnings.
- Products used for rental purposes or unauthorized retail activities.

**RETURN POLICY**

We offer a 30-day return policy, meaning that all products purchased through this website may be returned to us within that timeframe. You must contact us within 30 days of receiving the product(s), and they must be returned to us without any undue delays.

**CONDITIONS:**

- Returned products must be in the same condition as received and returned in their original packaging.
- If the product is not faulty (i.e., if you change your mind or are unhappy with the product for another reason), you are responsible for the cost of return shipping. You must ensure the package arrives safely to us, so we recommend using a courier service that offers tracking.
- If the product is faulty when received, please contact us, and we will assist you with the return, covering the shipping costs in this case.

**LIMITED WARRANTY**

- We reserve the right to offer partial refunds for returned products that are not in unused condition, are damaged, or have missing parts not due to our error.

**HOW RETURNS WORK**

To request a return, please fill out the contact form on our website and attach a copy of your invoice as proof of purchase, along with the reason for the return.

We will provide the return address for the product as soon as possible. Once the returned product is received and inspected, we will provide a specific resolution.

If the return is approved, the refund amount will be automatically credited to your original payment method.

**MAINTENANCE INSTRUCTIONS**

Dust and clean up spills immediately using a clean, non-colored, lint-free cloth.



For indoor use only. Do not place the furniture outside.



Do not place hot items directly on the furniture surface without using a protective barrier.



Do not place furniture near heating or cooling vents (keep at least 3 feet away)



Do not place furniture in direct sunlight.