

9

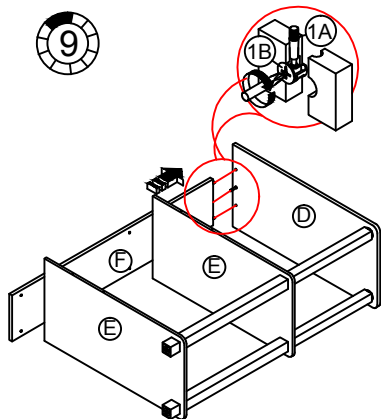

10

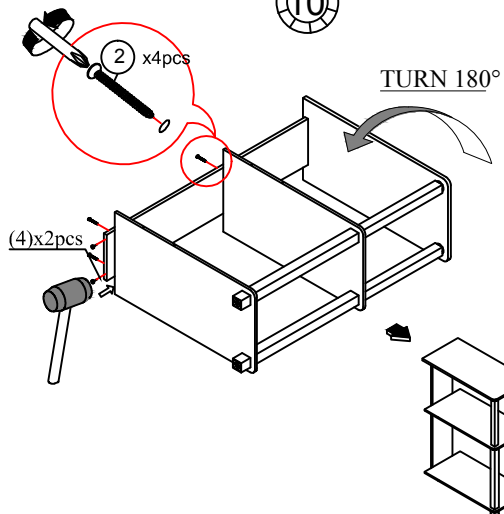

TURN 180°

11

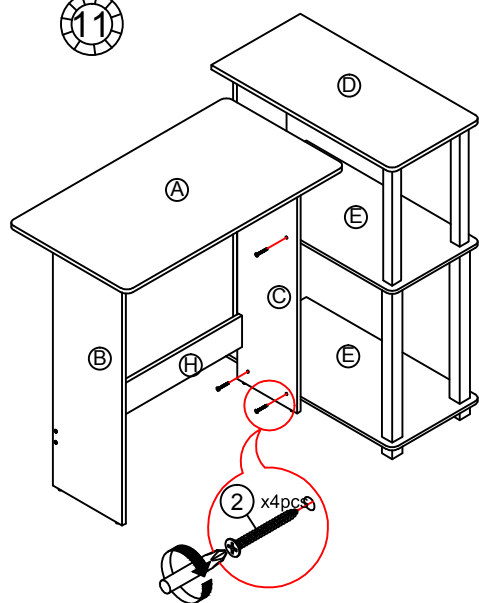

Recommended Maximum Weight

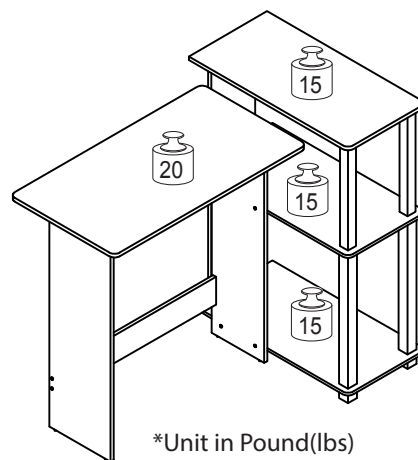

*Unit in Pound(lbs)

WARNING:

>This unit has been designed to support the maximum loads shown. Exceeding these load limits could cause sagging, instability, product collapse, and/or serious injury.

>DO NOT allow children to climb on unit.

>Put heavier items on lower shelves.

Assembly Instruction

Corner Computer Desk

00:30

Approx. 30 minutes



Recomm. 1 Person

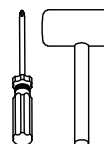

Tool Required

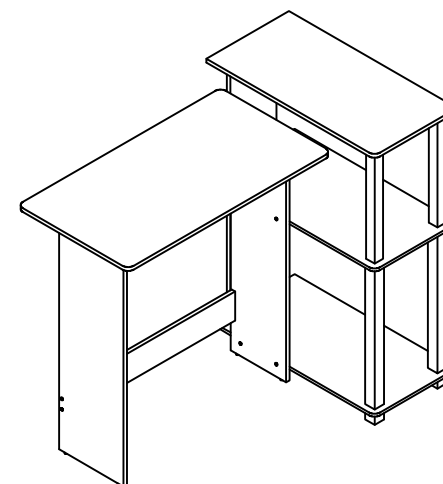

Customer Support

NEED HELP? For replacement requests or product inquiries, please contact our Customer Service Team by emailing us. Thank you for selecting us!



HARDWARE & PARTS LIST

NO	PARTS LIST	QTY
A	TOP PANEL	1pc
B	LEFT SIDE PANEL	1pc
C	RIGHT SIDE PANEL	1pc
D	SIDE TOP PANEL	1pc
E	SIDE SHELF PANEL	2pcs
F	BACK PANEL	1pc
G	TOP SUPPORT PANEL	2pcs
H	LEG SUPPORT PANEL	1pc

NO	HARDWARE LIST	QTY
1	MINIFIX + HOUSING 1A 1B	1set
2	LONG C/B SCREW	16pcs
3	DOWEL	6pcs
4	NAIL LEG	6pcs
5	EXTRA LONG SQUARE POLE	2pcs
6	LONG SQUARE POLE	2pcs
7	SQUARE LEG	2pcs
8	L BRACKET	4pcs
9	SMALL C/B SCREW	8pcs

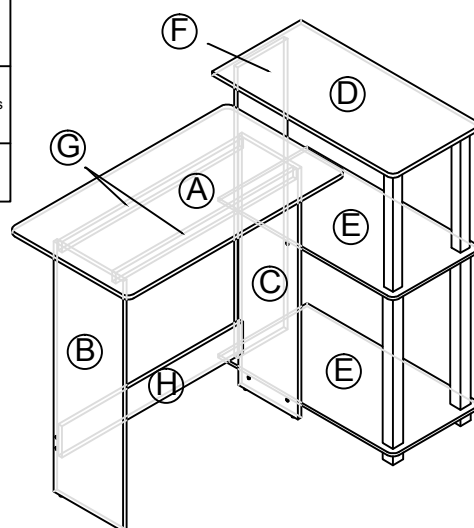

USEFUL HINTS BEFORE YOU START:

1. Read each step carefully before starting.
2. It is important that each step is performed in correct order to avoid difficulties.
3. Identify, sort and count the parts before assembly.
4. Assemble your furniture on packaging cardboard to prevent scratch or damage.
5. Clean the product with mild cleanser using soft damped cloth. Do not use harsh or abrasive cleanser.
6. Using incompatible hardware might cause damage to product.

