



Solo Latch™

Raise and lock all four corners at once with just one hand.

SET-UP

CONTENTS

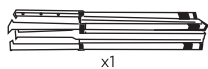
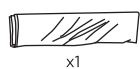

1
x4

STEP 1

Open your gazebo as shown below, and attach the top fabric on the frame with the Velcro on the corners.

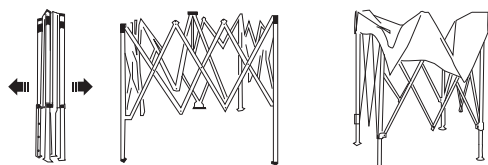

STEP 2

Position yourself under the gazebo and lift the Solo Latch hub until it clicks into the center pole.

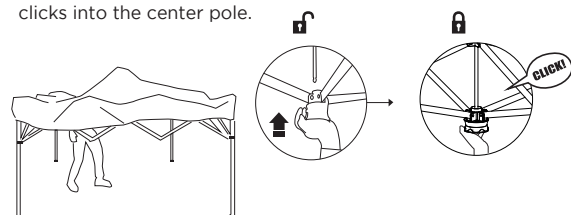

STEP 3

Gently pull out the legs, stage by stage until the spring button pops in position. There are three height selections to choose from. You may lower the height by sliding the legs back. Drop the sun block fabric wall and secure to the legs.

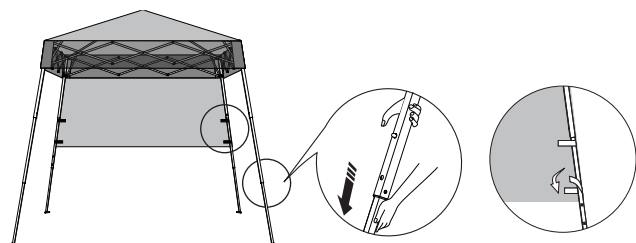

STEP 4

Stake down your gazebo feet with the 4 included stakes.

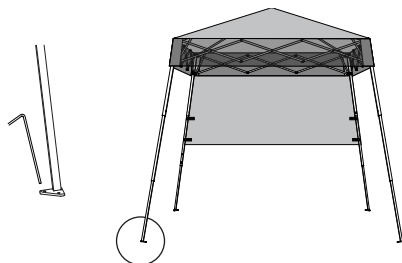

TAKE DOWN

STEP 1

Remove tent pegs from each pole. Detach the sun block wall from legs. Release the spring button lock and shorten the legs.

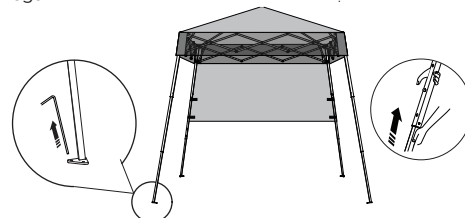

STEP 2

Position yourself under your gazebo and turn in an anti-clockwise motion on the Solo Latch hub to release the locking mechanism. Pull the Solo Latch hub downwards until it is separated from the center pole.

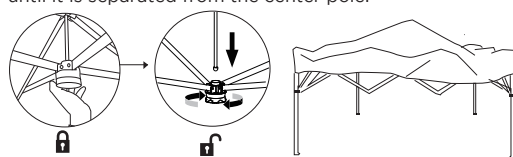

STEP 4

Get out from underneath the gazebo. Hold one leg and lift it up. Then, push the frame inward until it is fully closed.

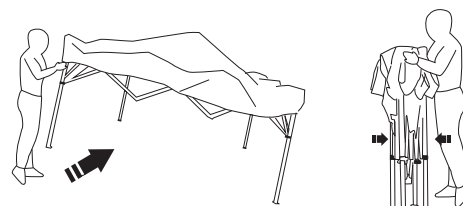

Take care not to pinch your fingers when taking the Gazebo up or down

It is your responsibility to read and save these instructions before attempting to set up your Instant Gazebo.

We would also like to suggest that you follow these safety precautions, care and maintenance tips when using your Gazebo.

1. Never set up or continue to use in any rain, wind or stormy conditions, especially lightning storms. Damage can occur to your gazebo and put you and others in potential danger.
2. We suggest that you take your time in order to avoid bending the frame or pinching your fingers or hands while opening and closing the frame.
3. Avoid setting up your gazebo on steep inclines.
4. Do not use your gazebo for permanent shelter. It is designed for temporary use only.
5. Keep your gazebo away from heat and flames at all times. Do not barbecue or build fires under your gazebo.
6. Never leave your gazebo unattended.
7. Hand wash the gazebo using only mild soap and water. Never use harsh detergents, abrasives or bleach.

Do not machine wash.

8. Never fold or store your gazebo when it is wet or damp. Let it dry completely to avoid mildew.