

USE AND MAINTENANCE

- Use on level surfaces only
- Because this product needs assembly, it is prone to working itself loose from time to time depending on the use. Please take the time to check that all connections are still tight and working properly for safety.
- Only clean using a damp cloth and mild detergent, do not use bleach or abrasive cleaners.

Kids Push Back Recliner

PART LIST

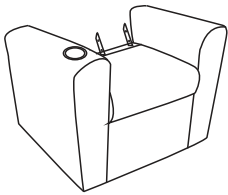

A - Chair Base x1

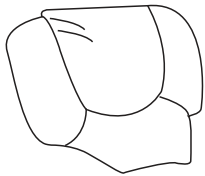

B - Back x1



C - Leg x4

Assembly Instructions

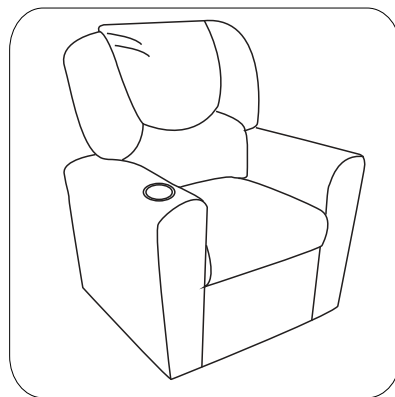
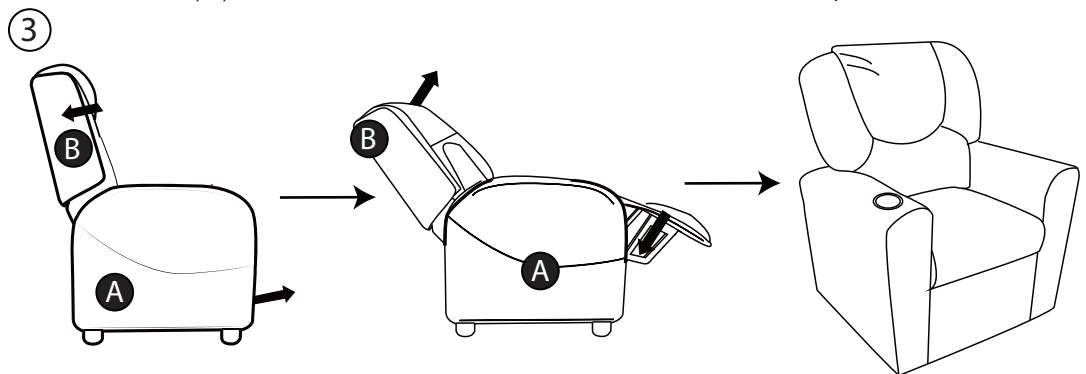
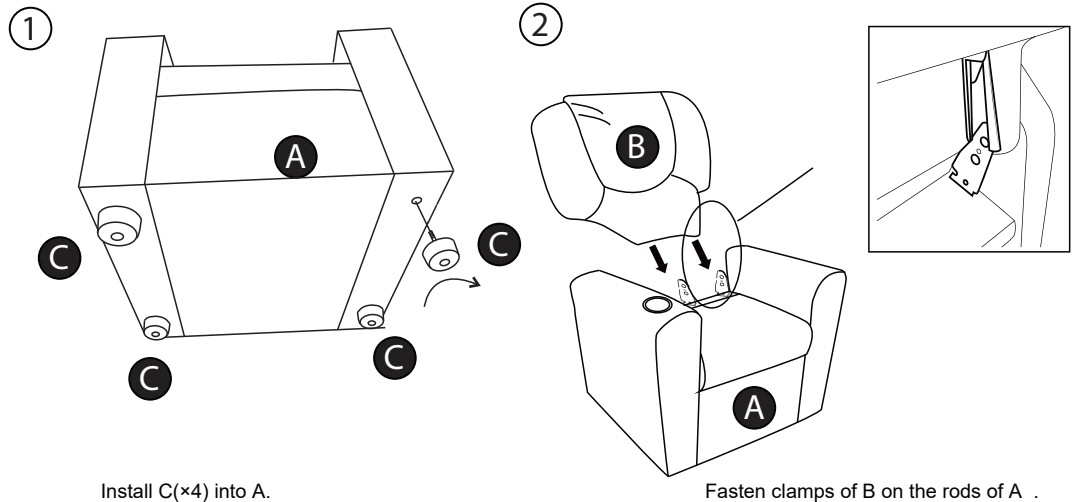

Congratulations! Setup of your new Kids Push Back Recliner is Complete!
Keep these instructions for future reference.

TO REMOVE

